

Tower Unit

450 Appliance Tower 2 Door, 1 Drawer + 2 or 3 Bin (Door, Drawer, Solid Top, 5 Legs) - Fitting Guide

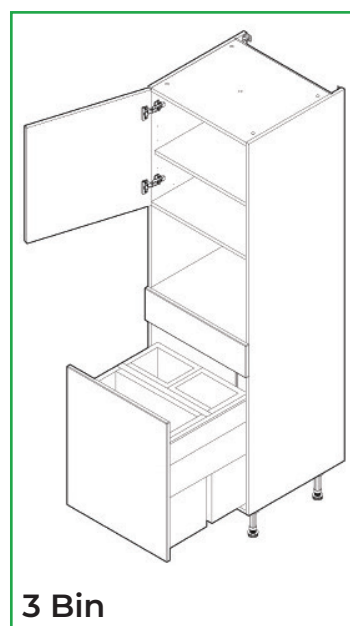

Unit Parts

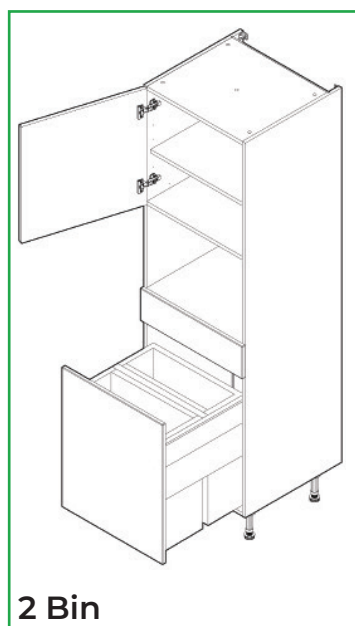

30x
15mm Screws

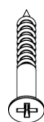

6x
30mm Screws



24x
Cover Caps

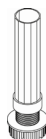

5x
Legs



5x
Leg Brackets



2x
Plinth Clips

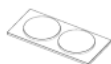

5x
Door Buffers



2x
L-Brackets



12x
Shelf Pegs



1x
Shelf

Tools Required



Drill



Jigsaw



Mallet



Screwdriver



Clamp



Spirit Level



Tape Measure

Remember to take care when unpacking. Please keep your workspace clean, clear and tidy when working. This will help keep all items safe from any damage. Any un-needed cardboard or plastic should be flattened down and placed in the bin.

A minimum of two people will be needed to lift the unit.

Removing the drawer, fixtures and fittings

Remove all fixtures and fittings from the drawer and keep on a clean and level surface and grouped by product.

Before installing the unit, remove the drawer. This is done by pulling the drawer all the way out, and then pulling the front of the drawer upwards.

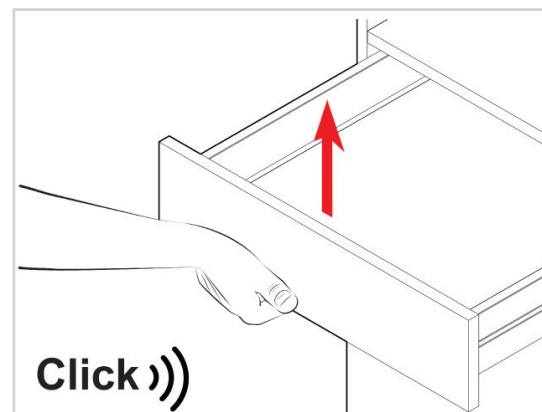

Place any drawers on top of a piece of leftover cardboard to protect them from damage.

Removing the frontal

Before installing the unit, remove the frontal by pulling the release catch.

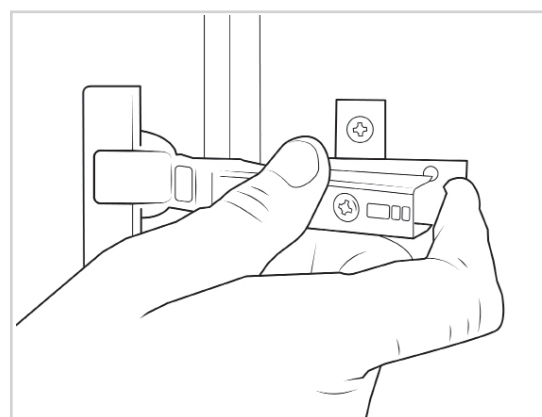

Removing the fixtures and fittings

Remove all content so the unit is empty

To remove the bins from inside the unit pull out the door and lift the bins out.

Take all fixtures and fittings out of the unit. These should be kept on a clean and level surface and grouped by product.

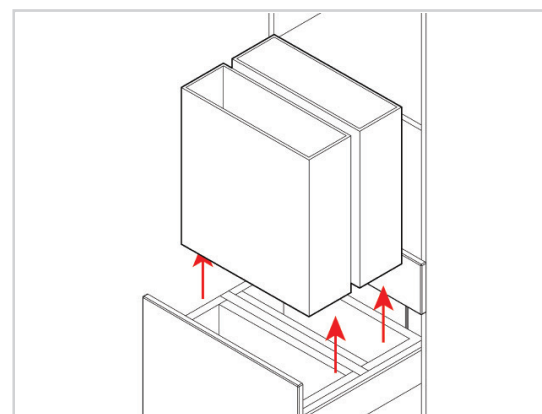

Taping the frontal

Add low-adhesive masking tape to the front of the unit over the frontal. This is to prevent the bin mechanism from moving while fitting the unit.

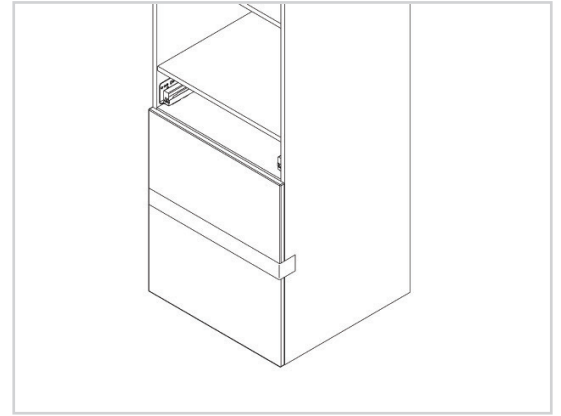

Positioning the leg brackets

Locate the leg brackets and position, as shown in the diagram. Ensure the leg brackets are rotated so the flange covers the outer edge, as this provides support for the edge of the unit.

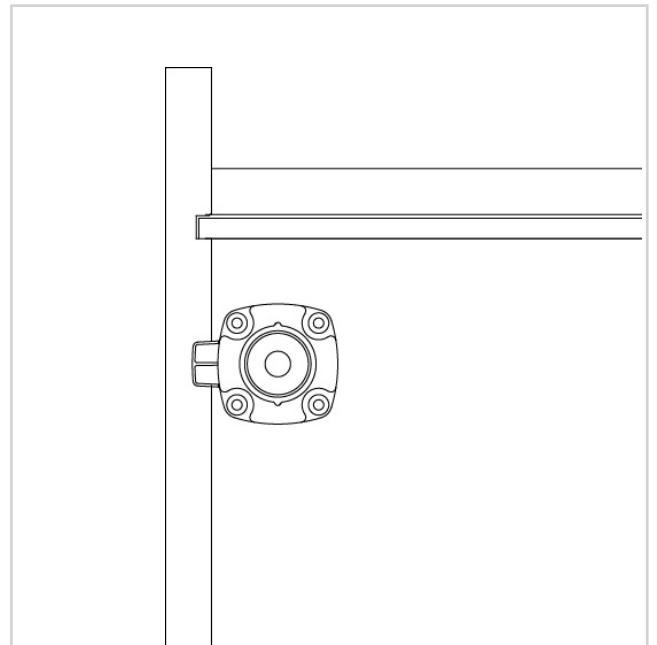
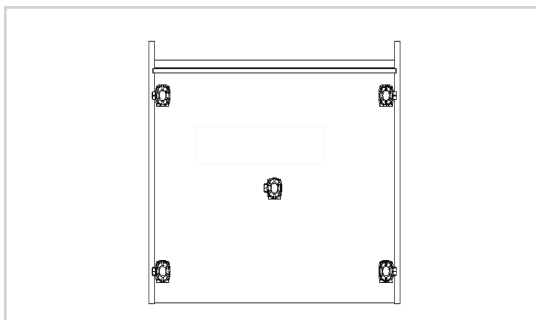

Fixing the leg bases

Secure each of the leg brackets into place with **4x15mm** screws per bracket.

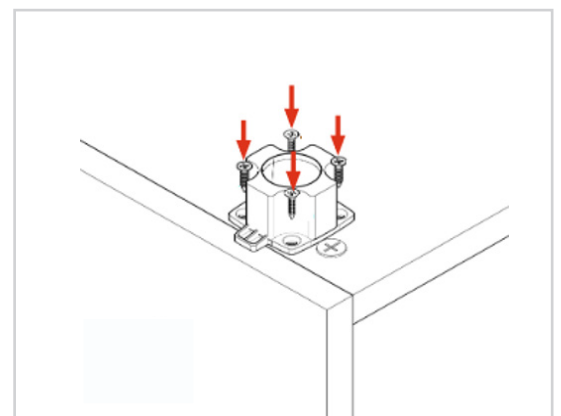

Inserting the legs

Push each leg firmly down into the leg bracket. Adjusting each leg to **155mm**.

Adjust the legs to the correct height by turning clockwise or anti-clockwise.

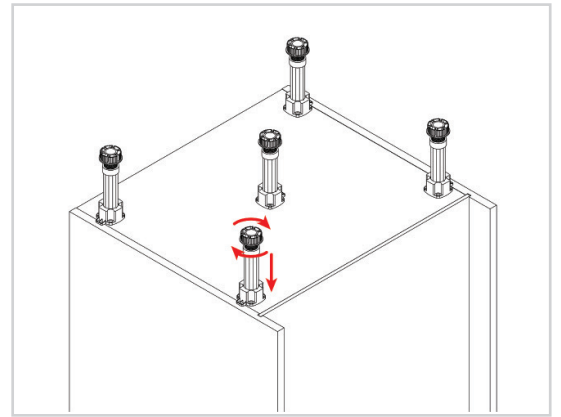

Securing the L-bracket

Secure each of the L-brackets to the upper rear of the unit using **2x15mm** screws on each side.

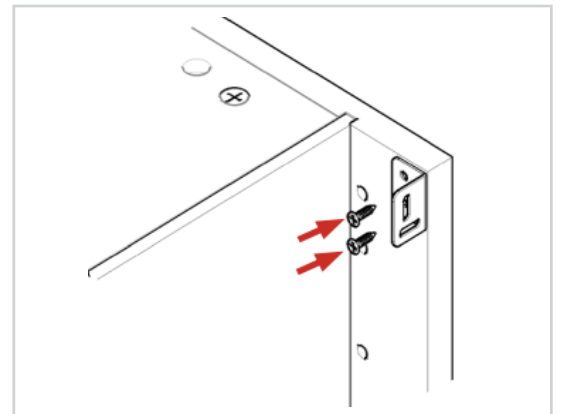

Removing the transport panel

Slide the transport panel out from the back of the unit and discard the panel.

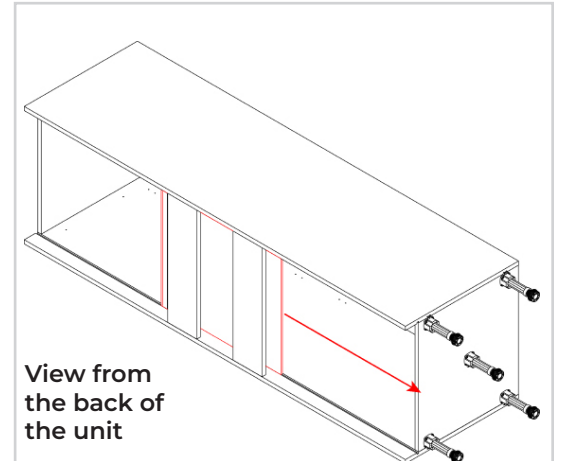

Notching out the side panels (when required)

In order to allow for any horizontal pipework running behind the unit, some units will require the back of unit's side to be notched out.

Create a notch for the horizontal pipes at the back of the end panels using a jigsaw.

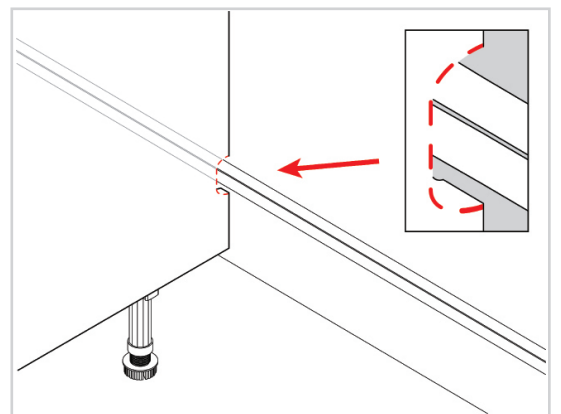

Lifting the unit into place

When lifting the unit into place do **not** tilt as this can damage the legs.

Place the unit against the wall and align it with the wall markings that will have been drawn during the room preparation stage.

Use a spirit level to ensure the unit is level from front to back, left to right, and diagonally. Adjust the legs if required.

The leg height can be adjusted by turning the foot of the leg clockwise or anti-clockwise.

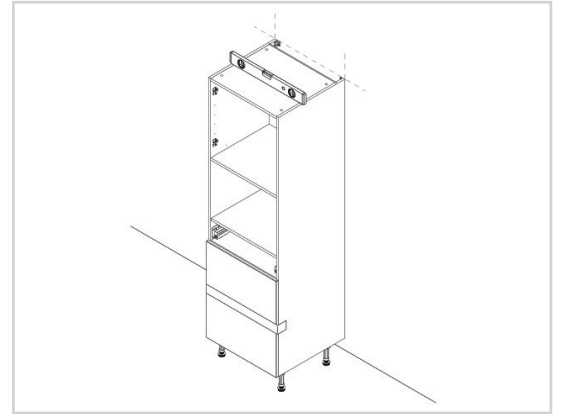

No screws or wall plugs are provided for the wall attachment due to variations in wall materials, thickness, and construction.

Before drilling into the wall you MUST check for any hidden services or pipework within the walls.

Attaching the tower unit to the wall

Fix the unit to the wall through the L-brackets as shown in the image (fixings are not provided).

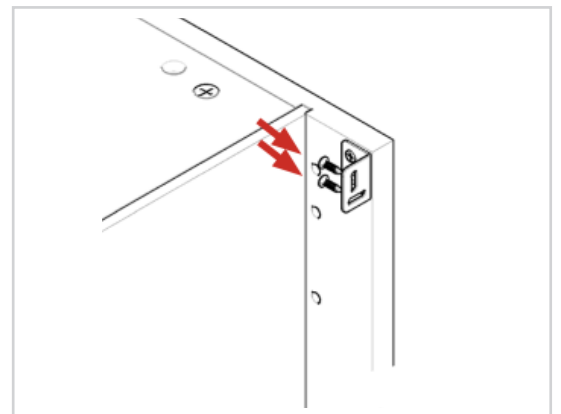

Securing to adjacent units

Clamp together the two units, checking the front edges are level and flush.

Using the screws provided, **1x30mm** screw should be fixed into each corner of the carcass side.

The screws can be concealed by placing them behind the shelf or behind the hinge plates. The cover caps can be used to hide any visible screw heads that remain.

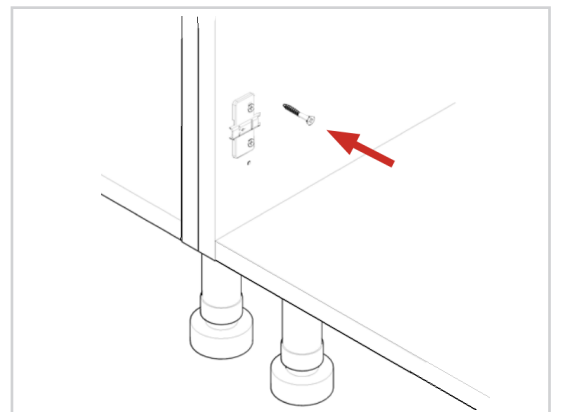

Placing the shelf into position

Position the shelf pegs into the pre-drilled holes.

Place the shelf into position so the pin of the shelf peg is inserted into the pre-drilled holes.

The shelf touches the back panel when installed, if there is a gap between the back panel and shelf then the shelf has been installed back to front and the shelf needs to be rotated.

Remove the masking tape from the bin frontal.

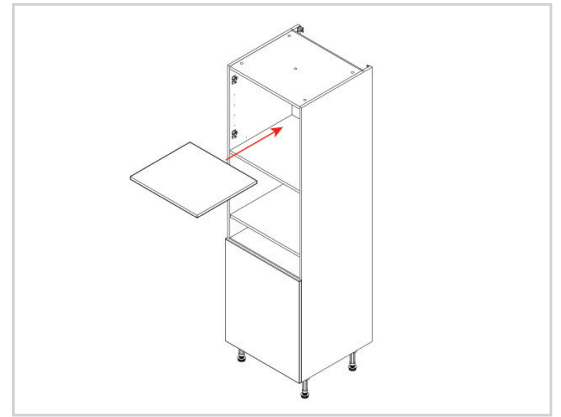

Inserting the drawer

Slide the drawer onto the runners, make sure the runner mechanism and the drawer sides' groove line up.

Push the drawer back into the unit after it has been positioned on the runners; you should hear a click.

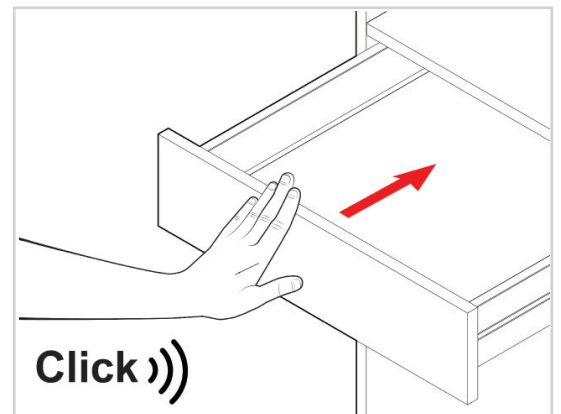

Attaching the frontal

The frontal should be re-attached to the unit by clipping the hinges onto the hinge plates. The bar of the hinge needs to be positioned into the hooks on the hinge plate. Then the rear of the hinge pushed to the hinge plate until it clicks.

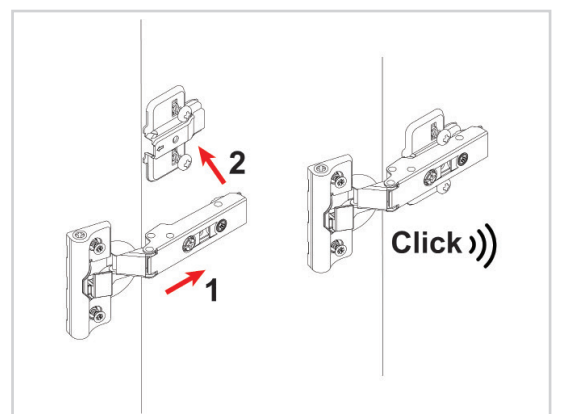

Adding the buffers

Add **1x** door buffer at each side of the unit where the shelf is positioned, as shown in the diagram.

Position the remaining door buffers on the unit where the frontals meet the carcass as shown in the diagram.

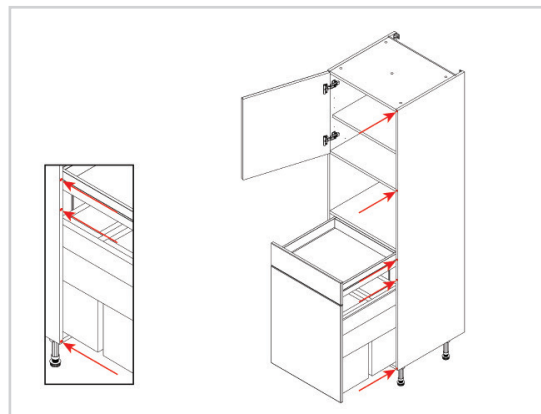

Adjusting the frontal

To adjust the hinges, use a screwdriver as required at points **1, 2, and 3**.

Point 1 - Will secure the frontal in place.

Point 2 - Will adjust the height of the frontal. Loosen the screw at point 1 and turn the screw at point 2. To raise the door, turn the screw point 2 clockwise, to lower it, turn it anti-clockwise.

Point 3 - Will adjust the angle between the frontal and the cabinet vertically.

Loosen the screw at point **1** to tilt the top of the door outwards, turn the screw at point **3** clockwise. To tilt the door inward, turn screw **2** anti-clockwise (repeat evenly on both sides of the door).

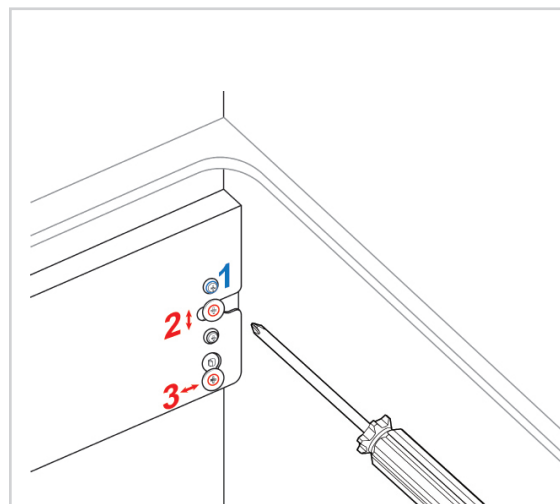

Placing the bins into position

Place the bins back into position within the unit.

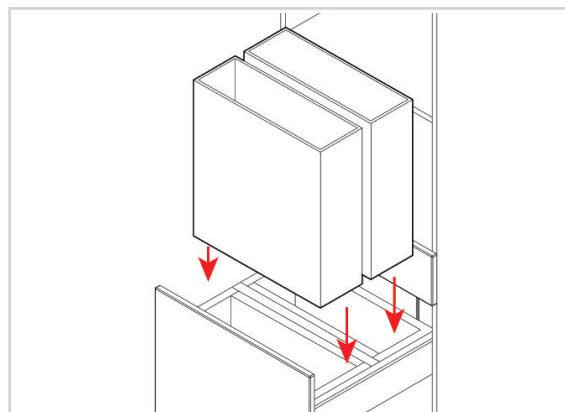

Cleaning the unit

Finally, the unit should be thoroughly cleaned to remove any debris that may have accumulated during the installation.

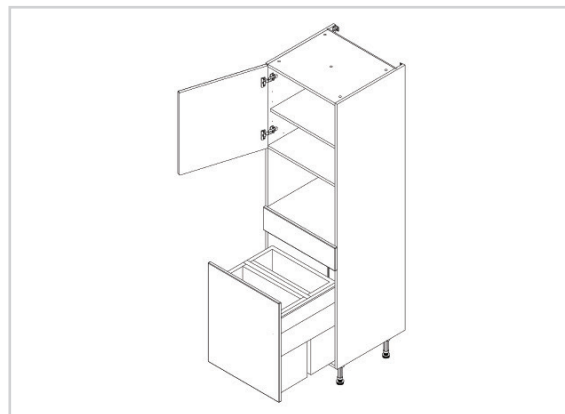

Store the plinth clips and the remaining 15mm screws.
These will be used later when attaching the plinth.

For door and drawer alignment please review the following installation guides:
Door - Door Frontal Hinge Adjustment
Drawer - Drawer Adjustment