

Base Cabinet

Cooktop Base (Drawer, Open Top, 4 Legs) - Fitting Guide

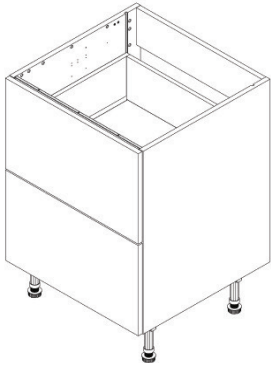

2 Drawers

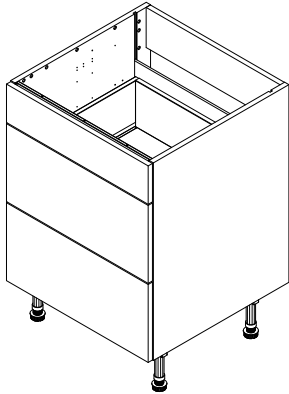

3 Drawers with non - opening drawer

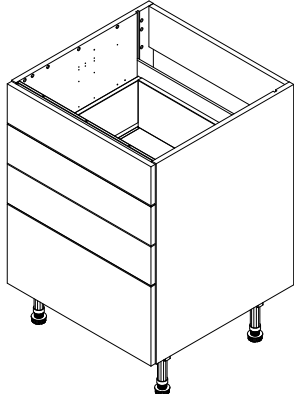

4 Drawers with non - opening drawer

Cabinet Parts



32x
5/8" Screws

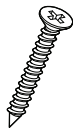

6x
1 1/4" Screws



18x
Cover Caps

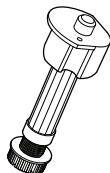

4x
Legs

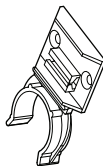

2x
Toe Kick Clips

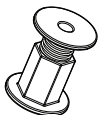

1x
Space Plug



5x
Door Buffers

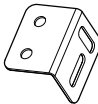

2x
L-Brackets



Drawer Cover Caps

Tools Required

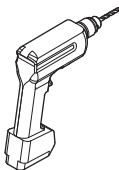

Drill



Stud Finder

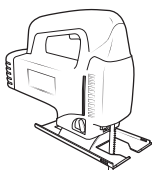

Jigsaw



Mallet

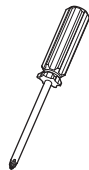

Screwdriver

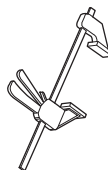

Clamp

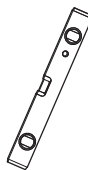

Spirit Level

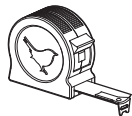

Tape Measure

Remember to take care when unpacking. Please keep your workspace clean, clear, and tidy when working. This will help keep all items safe from damage. Any waste cardboard or plastic should be flattened down and placed in the trash can.

A minimum of two people will be needed to lift the cabinet.

Removing the drawer, fixtures, and fittings

Remove all fixtures and fittings from the drawer and keep them on a clean, level surface, grouped by product.

Before installing the cabinet, remove all the drawers. This is done by pulling the drawer all the way out and then pulling the front of the drawer upwards.

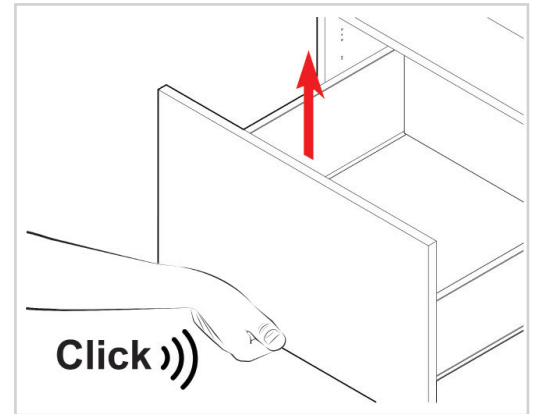

Place the drawers on top of a piece of leftover cardboard to protect them from damage.

Securing the legs

Secure each of the cabinet legs to the cabinet using **2x 5/8"** screws per leg.

Make sure the legs are positioned as seen in the image to support the end panel.

Set the leg height to **4 9/16"**. The leg height can be adjusted by turning the foot of the leg clockwise or anti-clockwise.

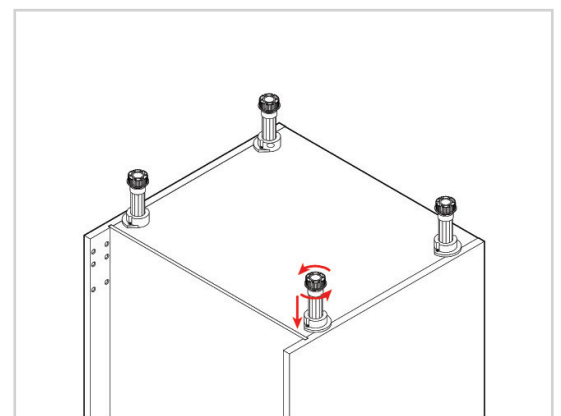

Lifting the cabinet into place

When lifting the cabinet into place, do **not** tilt, as this can damage the legs.

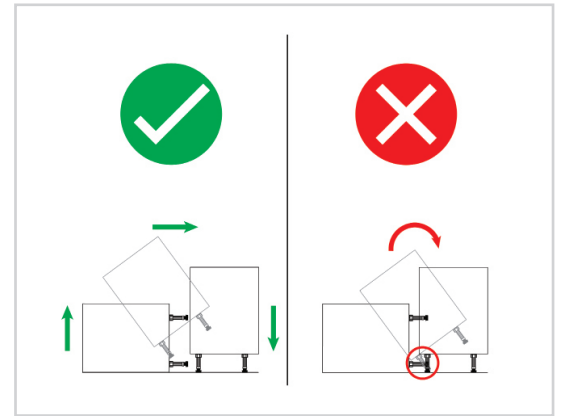

Notching out the side panel (if required)

In order to allow for any horizontal pipework running behind the cabinet, some cabinets will require the back of the cabinet side to be notched out.

Create a notch for the horizontal pipes at the back of the end panels using a jigsaw.

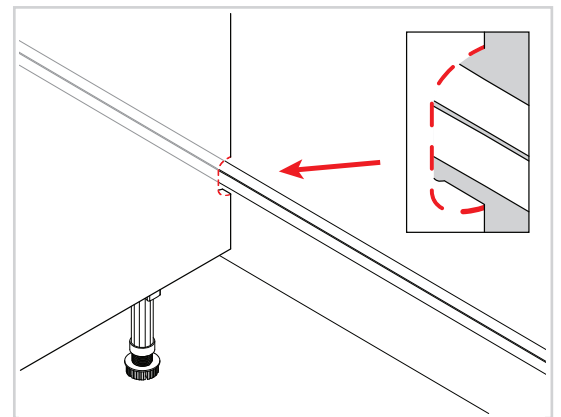

Locating the stud

Using a stud finder, locate the studs where the cabinet will be installed and mark the wall where the cabinet will sit.

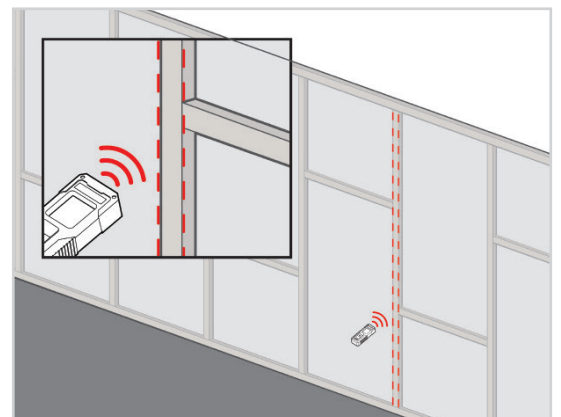

For help on determining the sort of wall you have, please refer to the “Room Preparation Guide.”

Sliding the cabinet into place

Slide the cabinet against the wall and align it with the wall markings and the services.

Use a spirit level to ensure the cabinet is level from front to back, left to right, and diagonally. Adjust the legs if required.

The leg height can be adjusted by turning the foot of the leg clockwise or anti-clockwise.

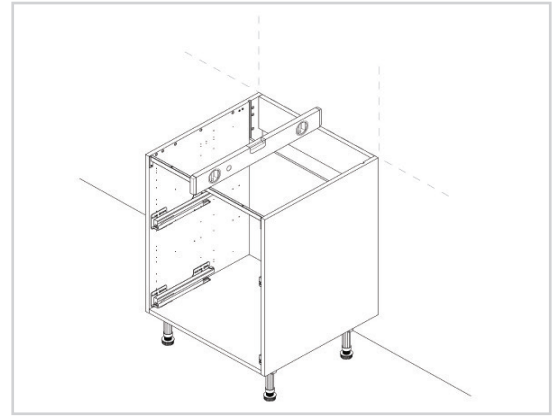

Finding the center point

Find the center point measurement of the rear top rail and lightly mark this position.

Transfer the measurement onto the wall at the cabinet markings, which were drawn at the room preparation stage.

This will be the position of the wall fixing.

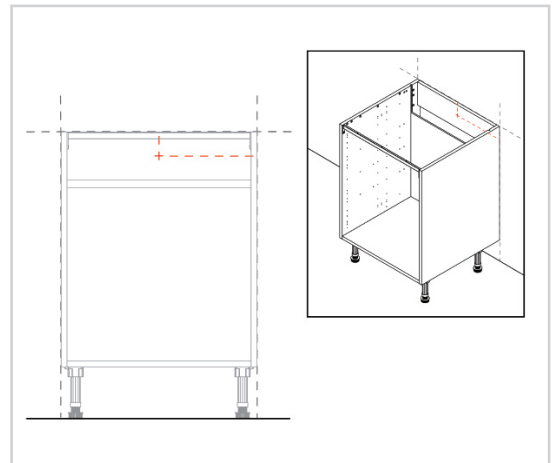

Before drilling into the wall, you MUST check for any hidden services or pipework within the walls.

Drilling the cabinet and wall

Drill a hole through both the rear top rail and the wall at the marked locations.

For guidance on the appropriate wall fixing/screws for each wall type, please consult the **"Room Preparation Guide."**

Once complete, lift and move the cabinet away from the wall, then drill a pilot hole at the marked position.

Lift and reposition the cabinet, ensuring it is level and in line with the wall markings.

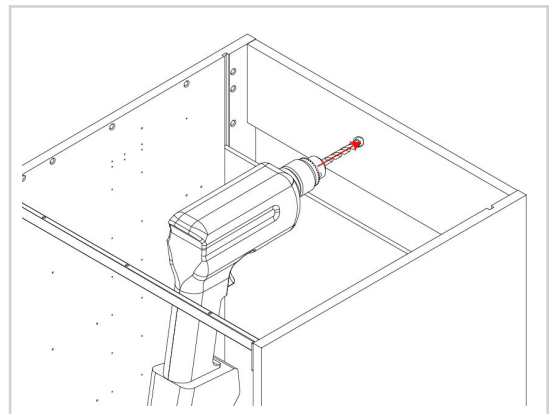

No screws or wall plugs are provided for attaching the cabinet to the wall. This is due to variations in wall construction.

Inserting the screws

Insert the screws into the drilled hole and tighten to the wall.

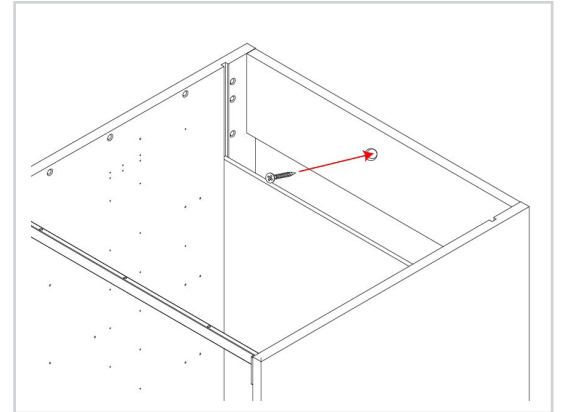

Securing adjacent cabinets

Any adjacent cabinets need to be secured using the **1 1/4"** screws provided. Screw to the rear of both hinge plates and to the rear of the cabinet at the top and bottom.

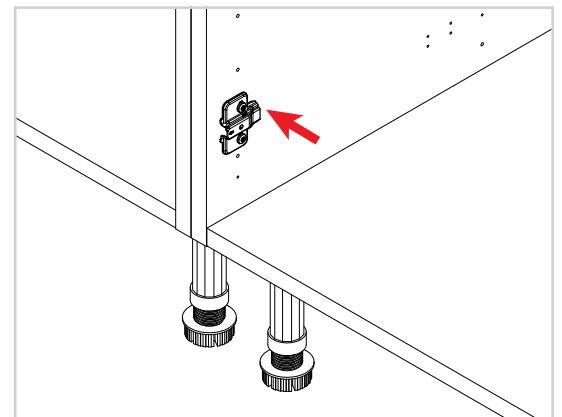

Inserting the drawers

Slide the drawer onto the runners and make sure the runner mechanism and the drawer sides' groove line up.

Push the drawer back into the cabinet after it has been positioned on the runners; you should hear a click.

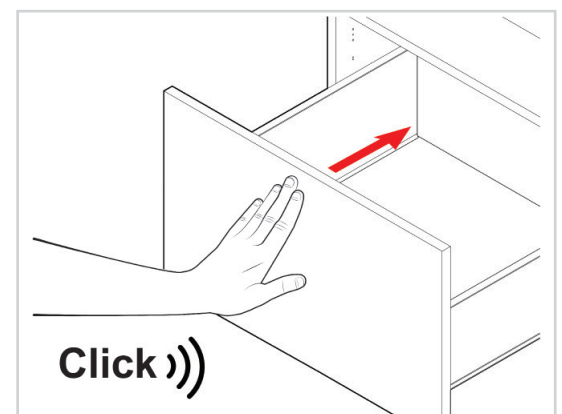

Adding the drawer buffers

Add **1x** door buffer to each side of each drawer along the cabinet edge, as shown in the image.

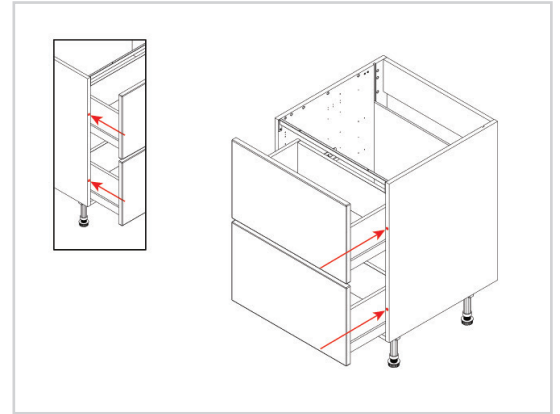

Cleaning the cabinet

Finally, the cabinet should be thoroughly cleaned to remove any debris that may have accumulated during the installation.



Store the toe kick clips and the remaining 5/8" screws.
These will be used later when attaching the toe kick.

Store the L-brackets.
These will be used later when installing the countertop (laminated or timber).

For drawer alignment please review the following installation guide:
Drawer - Drawer Hinge Adjustment