

WALL CABINET

Decorative Range Hood - Fitting Guide

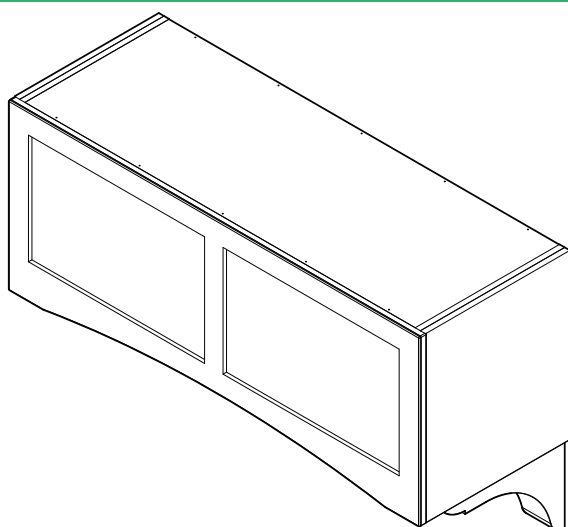

Traditional Style

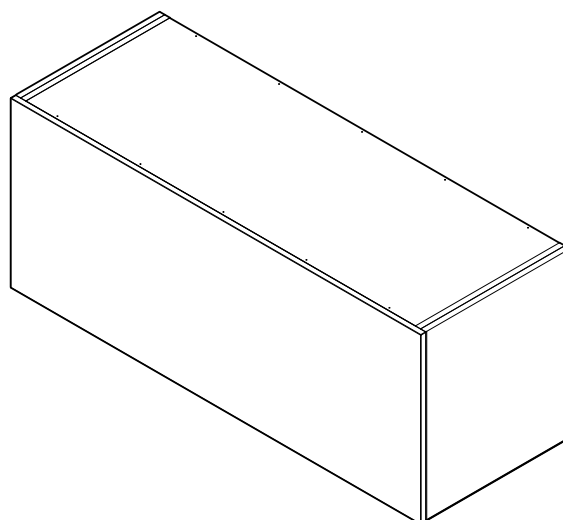

Modern Style

Cabinet Parts



16x
1 1/4" Screws

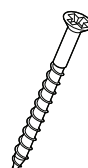

8x
1 3/4" Screws

Tools Required

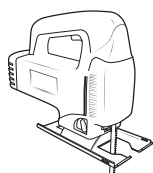

Jigsaw

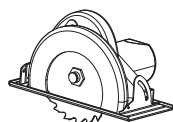

Circular Saw

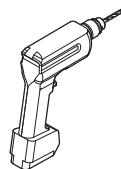

Drill



Hole Saw Bit

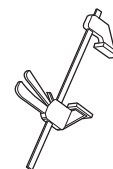

Clamp

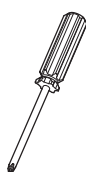

Screwdriver

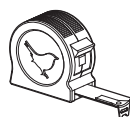

Tape Measure



Silicone & Caulk

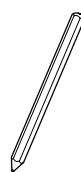

Pencil



Masking Tape



Spirit Level



Before installing any wall cabinets, ensure the wall construction is strong enough to support the weight of the fully loaded cabinet and that appropriate fixings are used.

If you are unsure, seek professional advice before proceeding.

Remember to take care when unpacking. Please keep your workspace clean, clear, and tidy when working. This will help keep all items safe from damage. Any waste cardboard or plastic should be flattened down and placed in the trash can.

A minimum of two people will be needed to lift the cabinet.

Removing the fittings

Remove all content so the cabinet is empty.

All fittings should be kept on a clean and level surface.

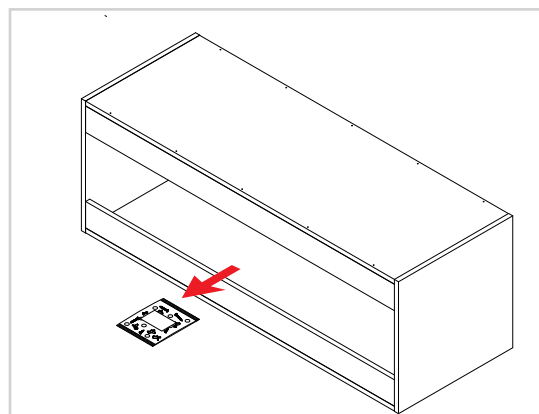

Finding the dimensions for the range hood cut out

Place the cabinet upside down and add masking tape to the bottom of the cabinet.

Mark the bottom of the cabinet on the masking tape, using either the dimensions found in the manufacturer's instructions or the template supplied (only certain range hoods).

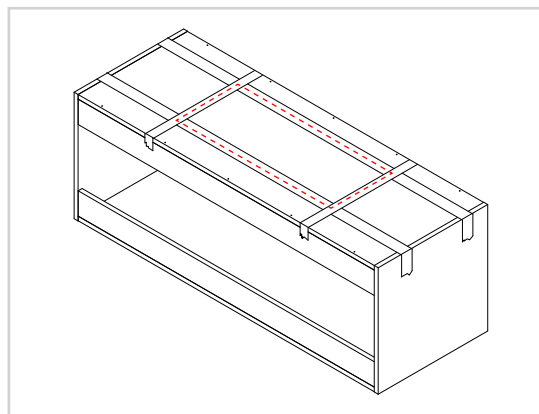

Drilling the cabinet

Drill a hole at each corner of the marking.

Make sure to stay inside the lines.

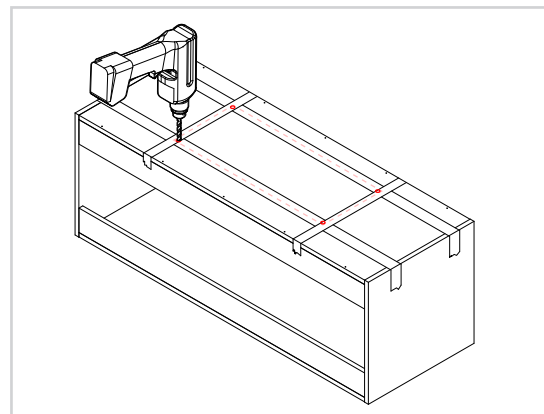

Cutting the cabinet

Start at one of the drilled corners and cut the markings with a jigsaw.

After the cut is complete, remove the masking tape.

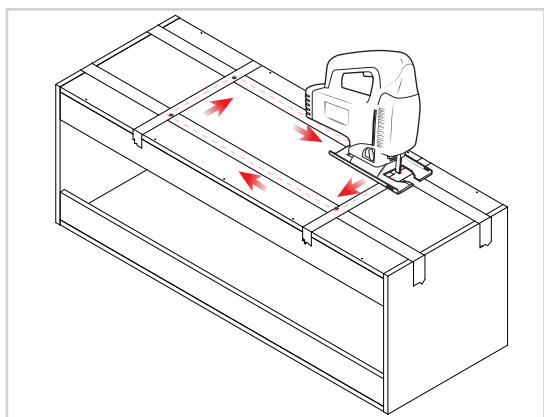

The next few steps are for ducting range hoods only.

This installation guide requires the ductwork to be completed before installing the hood.

Finding the dimensions for the ducting cut out

Choose whether to place the range hood ducting -

A - Out the top of the cabinet

B - Out the rear of the cabinet

Then cover that side of the cabinet with masking tape. Determine the ducting's dimensions and mark them on the masking tape.

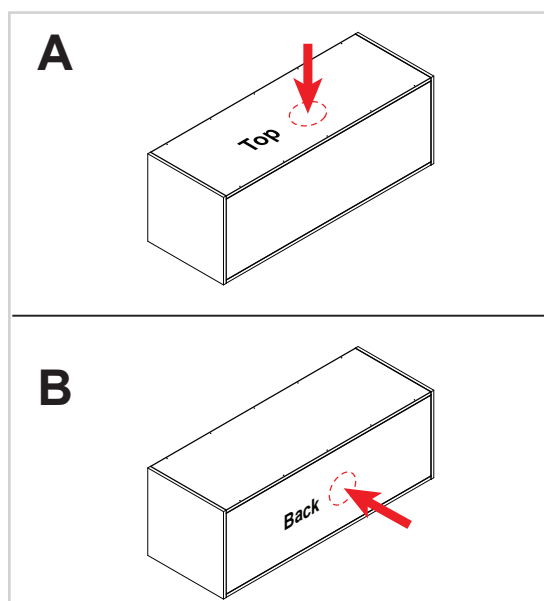

Drilling the top or back panel

Drill a hole using the correct holesaw for the size of the pipe at the marked locations, as shown in the image.

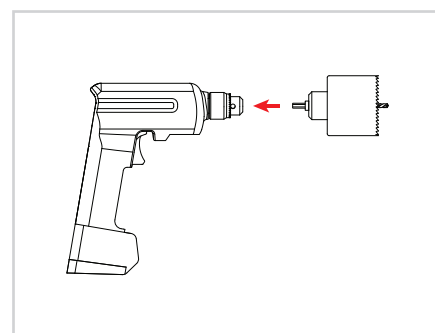
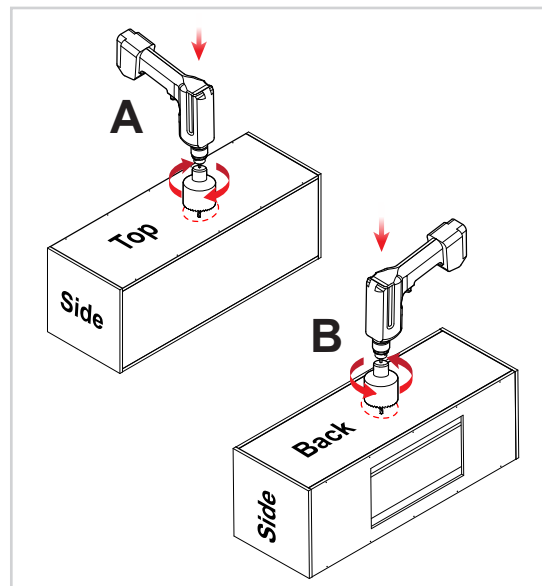

Locating the studs

Using a stud finder, locate the studs where the cabinet will be installed and mark the wall above and below where the cabinet will sit.

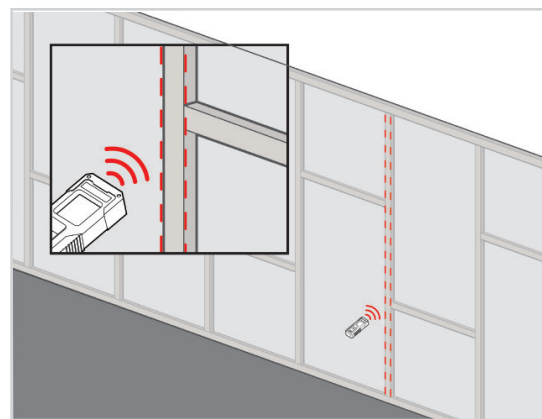

For help on determining the sort of wall you have, please refer to the “Room Preparation Guide.”

No screws or wall plugs are provided for attaching the cabinet to the wall. This is due to variations in wall construction.

Before drilling into the wall you MUST check for any hidden services or pipework within the walls.

Securing the cabinet to the wall

Align the top of the cabinet with the marks made during the preparation guide stage. Check that the cabinet is level before fixing it in place.

Secure the cabinet to the wall by driving screws through the back panel, use four screws along the top and four along the bottom.

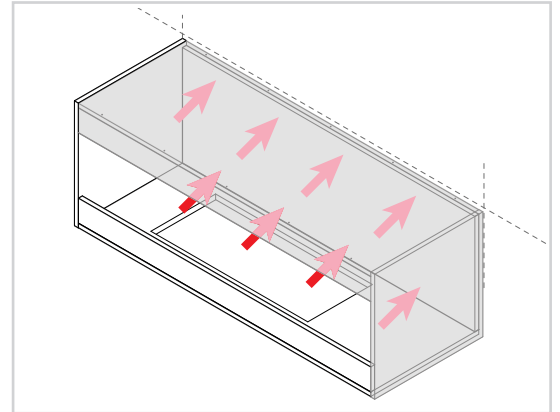

Finding the height of the décor panels

Use the calculations below to determine the required height and width of the décor panel:

1. Height: Measure from the top of the frontal to the bottom of the cabinet.

2. Width: Measure from the wall to the back edge of the frontal.

If the décor panel needs scribing to fit against the wall, please refer to the “**Décor Panel – Wall Décor Panel**” guide for detailed instructions.

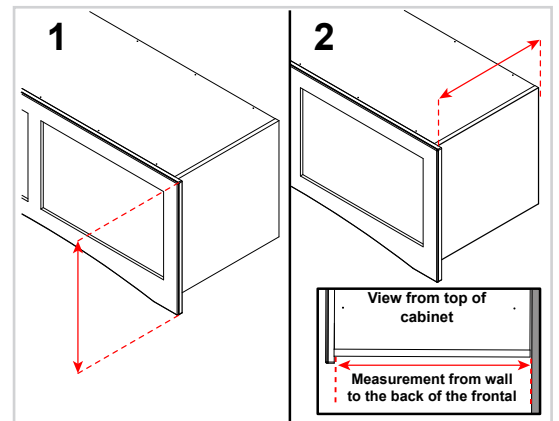

Cutting the décor panels to size

Cut along the markings on the décor panel with a saw to get the correct-sized décor panel required.

A circular saw should be used on a straight cut and a jigsaw on any other cut.

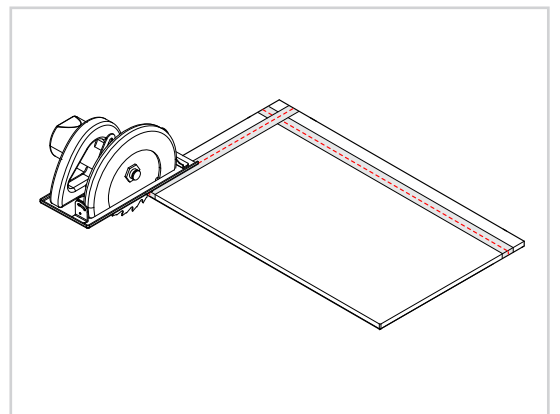

Securing the décor panels

Clamp the décor panels to the side of the cabinet. Secure each of the décor panel by inserting **1x1 1/4"** screw into each of the **4** corners inside the cabinet.

Where possible, position the screws behind shelf locations or behind hinge plates to keep them hidden. Use the supplied cover caps to conceal any screw heads that remain visible.

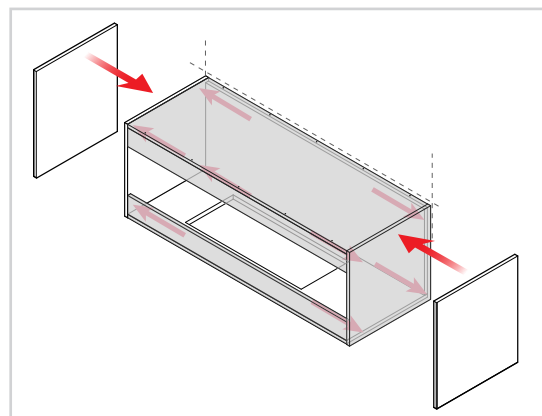
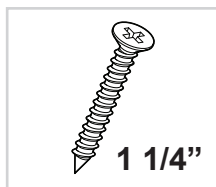

Ensure the two cut edges are positioned facing upward and toward the back of the cabinet.

Sealing the décor panel

Now that the décor panel is fastened to the wall cabinet, the clamps can be removed.

Using silicone, seal the edges of the décor panel along the wall. Following the instructions provided on the product label.

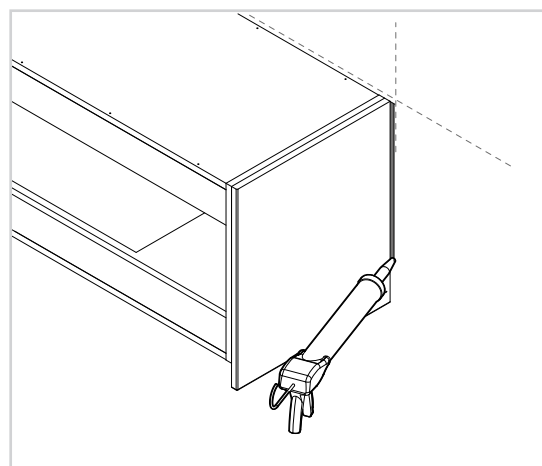

Attaching the corbel (Traditional style only)

Ensure the corbel is positioned tight against the wall and sits flush with the inside face of the décor panel, as shown.

Secure each corbel by fixing **4x1 3/4"** screws through the bottom panel of the cabinet into the corbel.

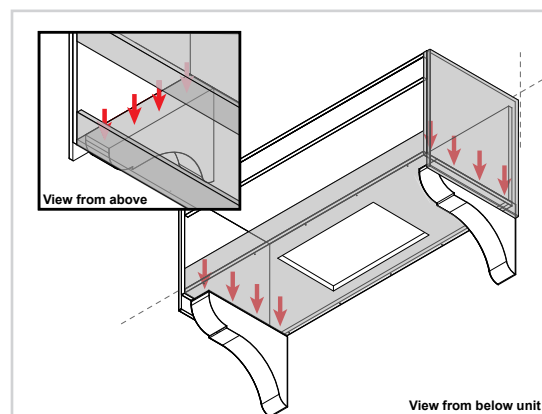

Applying the caulk (If required)

If the wall is not straight, a gap may appear between the wall and the corbel. Apply caulk to fill this gap, following the instructions provided on the product label.

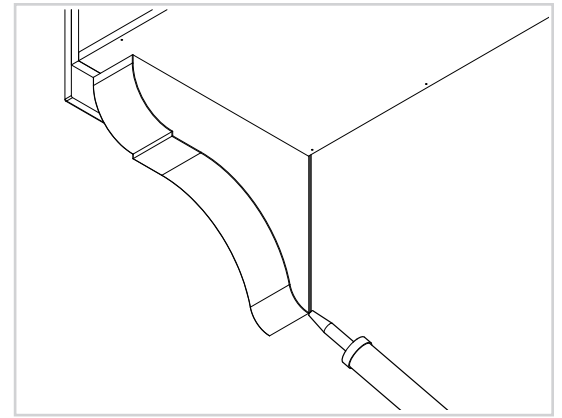

A minimum of two people will be needed.

Fixing the range hood frontal

Hold the range hood frontal so it sits flush with the top of the cabinet and is aligned with both sides.

From inside the cabinet, secure the frontal by driving screws through the internal rails into the back of the panel, using the **8x1 1/4"mm** screws provided.

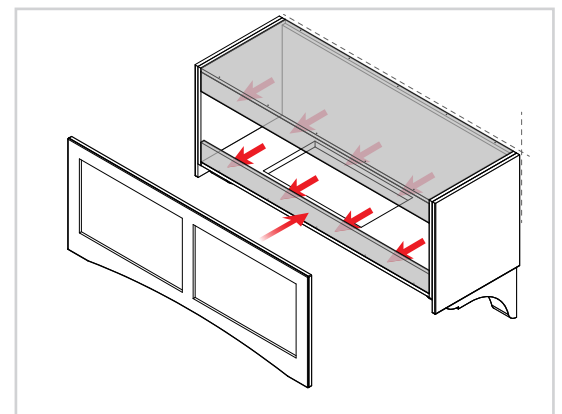
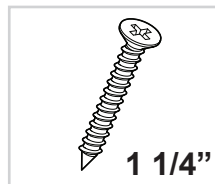

Measure carefully and ensure you screw into the thickest section of the range hood frontal to avoid the screws going through to the front.