

Vanity Tower Cabinet

Tower (Door, Drawer, Solid Top, 4 Legs) - Fitting Guide

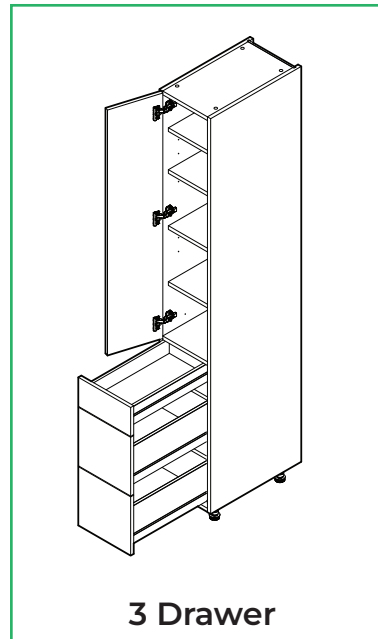

Cabinet Parts

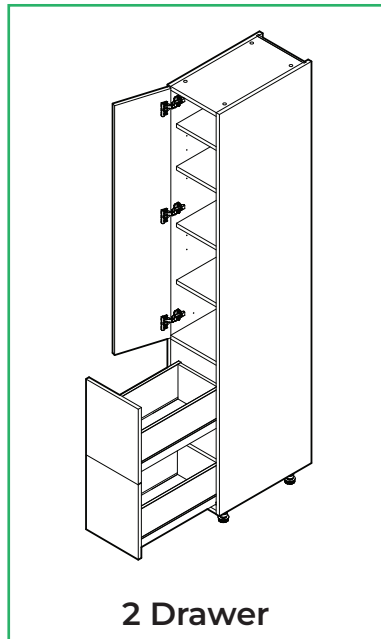

8x
5/8" Screws

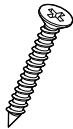

12x
1 1/4" Screws



Cover
Caps



4x
Legs

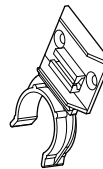

2x
Toe Kick Clips

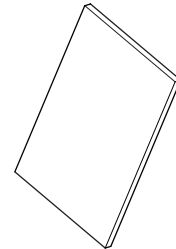

4x
Shelves



16x
Shelf Pegs



Drawer Cover
Caps



Door
Buffers

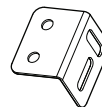

2x
L-Brackets

Tools Required

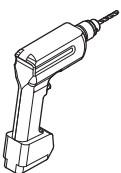

Drill



Stud Finder

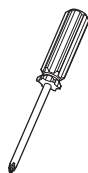

Screwdriver



Mallet

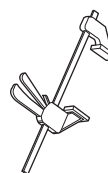

Clamp

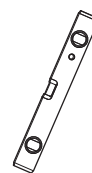

Spirit Level

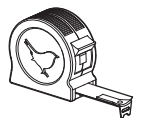

Tape Measure

Remember to take care when unpacking. Please keep your workspace clean, clear, and tidy when working. This will help keep all items safe from damage. Any waste cardboard or plastic should be flattened down and placed in the trash can.

A minimum of two people will be needed to lift the cabinet.

Removing the drawer, fixtures, and fittings

Remove all fixtures and fittings from the drawer and keep them on a clean, level surface, grouped by product.

Before installing the cabinet, remove all the drawers. This is done by pulling the drawer all the way out and then pulling the front of the drawer upwards.

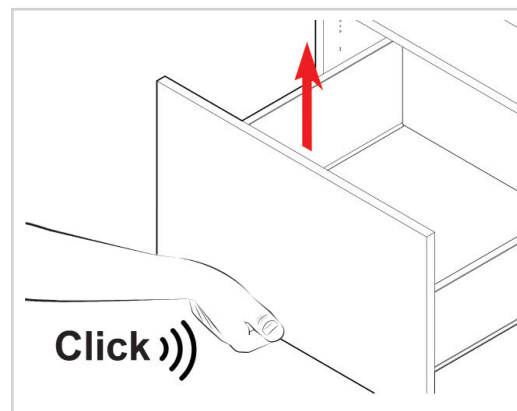

Place the drawers on top of a piece of leftover cardboard to protect them from damage.

Removing the frontal

Before installing the cabinet, remove the frontal by pulling the release catch.

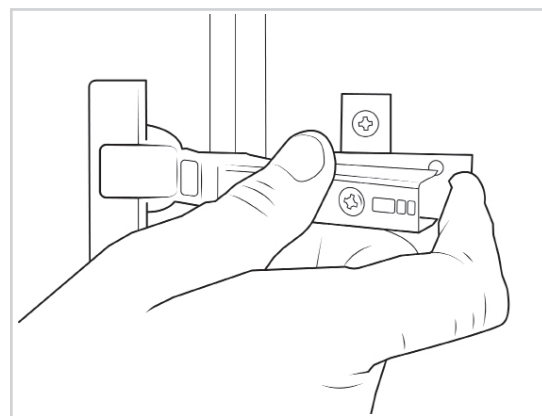

Removing the fittings

Remove all content so the cabinet is empty.

All fittings should be kept on a clean, level surface.

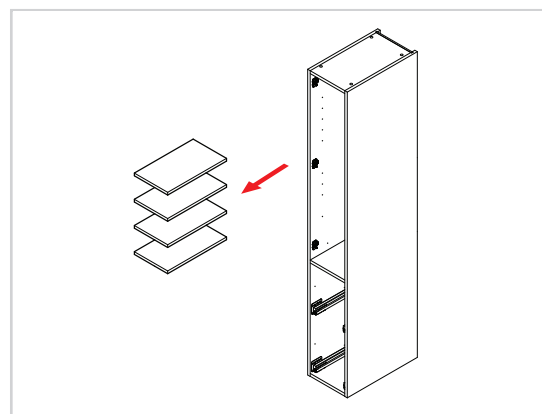

Securing the legs

Secure each of the cabinet legs to the cabinet using **2x5/8"** screws per leg.

Make sure the legs are positioned as seen in the image to support the end panel.

Set the leg height to **3"**. The leg height can be adjusted by turning the foot of the leg clockwise or anti-clockwise.

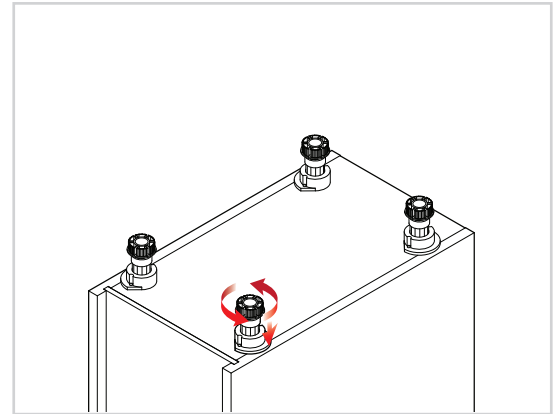

For help on determining the sort of wall you have, please refer to the "Room Preparation Guide."

Locating the stud

Using a stud finder, locate the studs where the cabinet will be installed and mark the wall where the cabinet will sit.

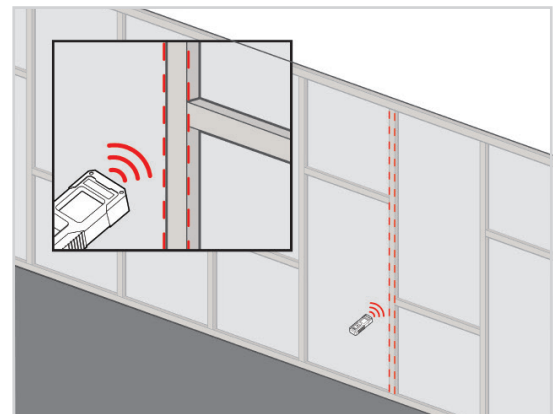

Lifting the cabinet into place

When lifting the cabinet into place, do **not** tilt, as this can damage the legs.

Place the cabinet against the wall and align it with the wall markings that will have been drawn during the room preparation stage.

Use a spirit level to ensure the cabinet is level from front to back, left to right, and diagonally. Adjust the legs if required.

The leg height can be adjusted by turning the foot of the leg clockwise or anti-clockwise.

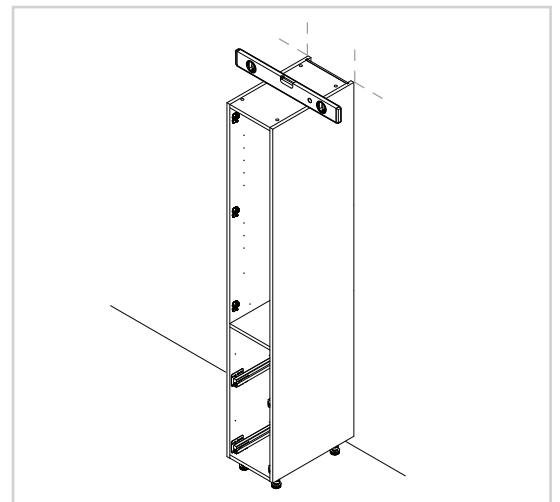

Before drilling into the wall, you **MUST** check for any hidden services or pipework within the walls.

No screws or wall plugs are provided for attaching the cabinet to the wall. This is due to variations in wall construction.

Securing the cabinet

Secure the cabinet in **2** places along the top rail, and **2** places along the bottom rail, where the studs are located.

Use appropriate fixings.

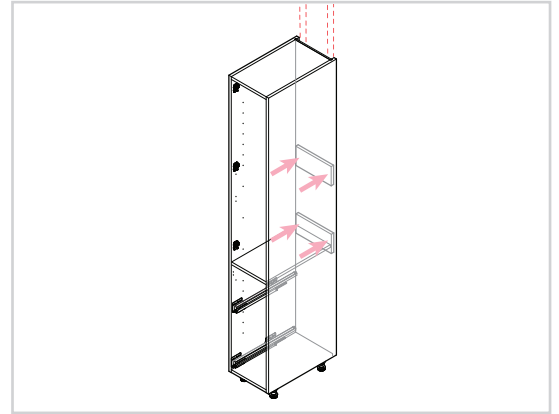

Securing adjacent units

To secure an additional cabinet, screw **2** holes at the front of the cabinet, just behind the hinge plates, and **2** screws at the rear of the cabinet at the top and bottom, using **1 1/4"** screws.

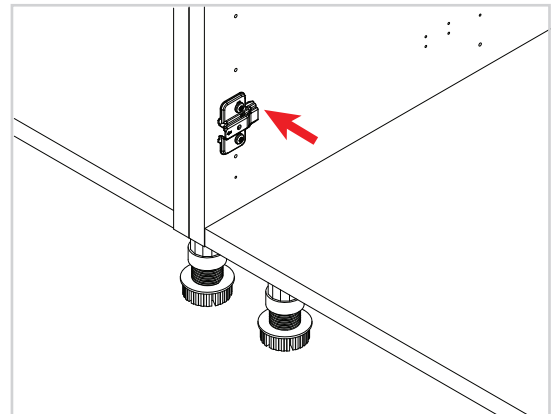

Inserting the drawers

Slide the drawer onto the runners and make sure the runner mechanism and the drawer sides' groove line up.

Push the drawer back into the cabinet after it has been positioned on the runners; you should hear a click.

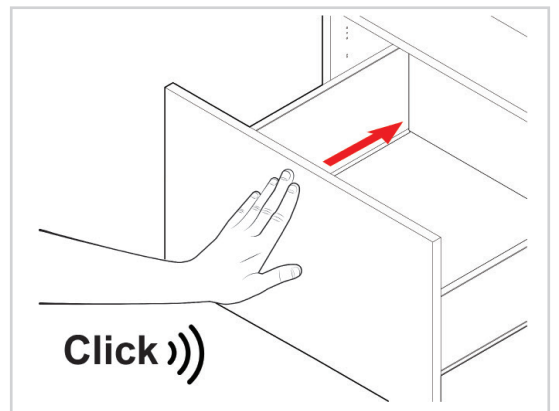

Placing the shelf into position

Position the shelf pegs into the pre-drilled holes.

Place the shelves into position so the pin of the shelf peg is inserted into the pre-drilled holes.

The shelf touches the back panel when installed, if there is a gap between the back panel and shelf, then the shelf has been installed back to front, and the shelf needs to be rotated.

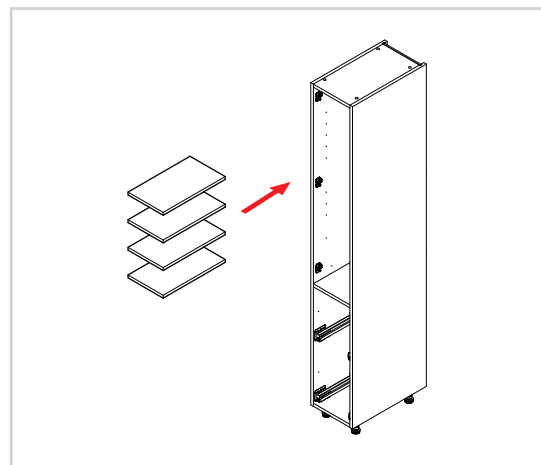

Attaching the frontal

The frontal should be re-attached to the cabinet by clipping the hinges onto the hinge plates.

The bar of the hinge needs to be positioned into the hooks on the hinge plate. Then the rear of the hinge is pushed to the hinge plate until it clicks.

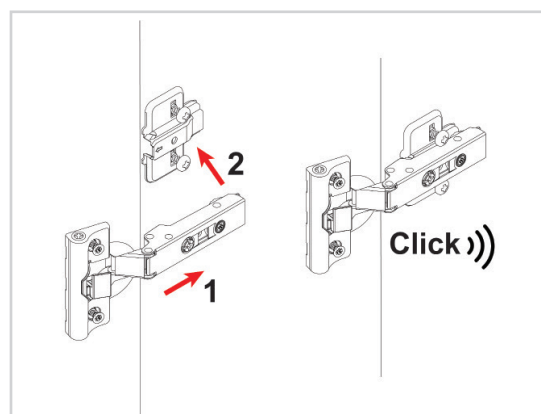

Adding the door buffers

Add **1x** door buffer to each side of each drawer along the carcass edge.

Position **2x** door buffers at the top and bottom of the carcass where the frontal's corners will meet the carcass, as illustrated in the image.

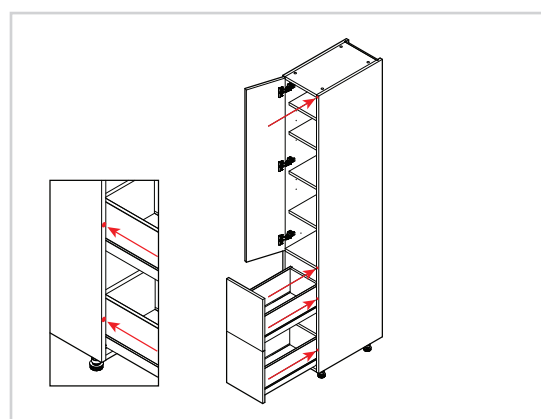

Cleaning the cabinet

Finally, the cabinet should be thoroughly cleaned to remove any debris that may have accumulated during the installation.

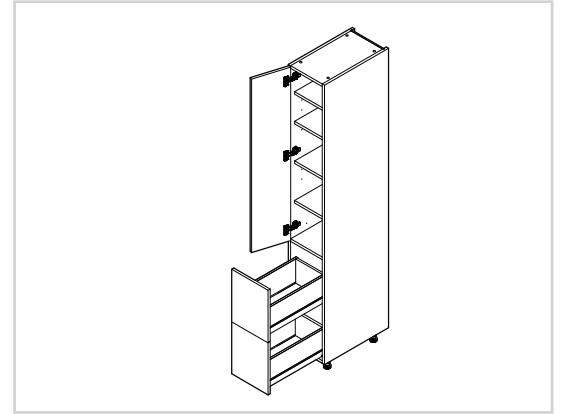

Store the toe kick clips and the remaining 5/8" screws.
These will be used later when attaching the toe kick.

For door and drawer alignment please review the following installation guides:

Door - Door Hinge Adjustment
Drawer - Drawer Hinge Adjustment