



SURFACE MOUNT QUICKSTART GUIDE

Box Contents

- (1) Installation Guide
- (1) Surface Mount Bezel (a)
- (1) Mounting Bracket (b)
- (1) Suction Cup (c)
- (4) Mounting Screws (d)
- (1) Security Tool (e)

System Components (Sold Separately)

- (1) PoE Splitter (70718) (f)
- (1) PoE Injector (70719) (g)
- (International Adapters Included)

For Advanced Installation

iPort offers an elegant solution to integrate iPad onto any surface. For advanced surface installation applications such as masonry, concrete, and glass, please view our application note for installation on our website, www.iportproducts.com. For drywall and wood installation, please proceed to the installation steps noted below.

Installation

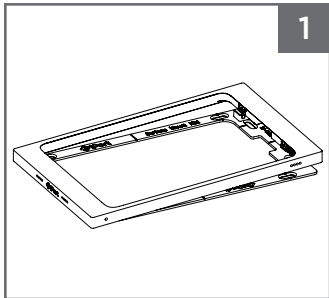

To decouple the (a) bezel from the (b) mounting bracket, place the (a) bezel face up on a flat and smooth surface. With one hand, hold the (b) mounting bracket in place. With your opposite hand, lift the right edge of (a) bezel and then the left to decouple the magnets.

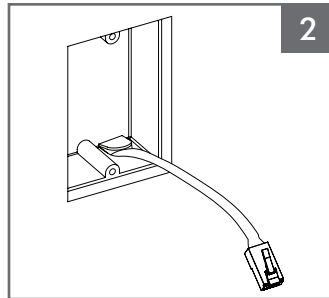

For retrofit installation, locate an existing low-voltage electrical box. For new construction, choose a location for a electrical box. The PoE Splitter can be used with US, UK and Euro single gang electrical boxes. NOTE: The Surface Mount can be installed in portrait or landscape orientation with a single gang electrical box.

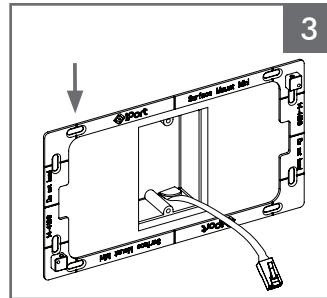

Install the (b) mounting bracket on the wall with the (b) bracket surrounding the electrical box. Use the centerlines as a guide to install the (d) mounting screws. Using the recommended screwdriver and mounting screws, install the first screw in the upper left hand corner.

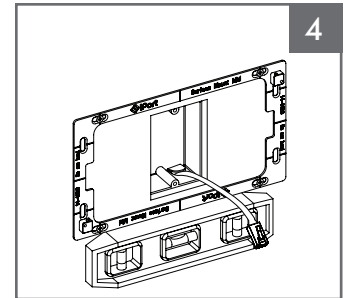

Level the (b) mounting bracket over wiring location and fasten (b) bracket with the remaining (d) screws using a Phillips screwdriver.

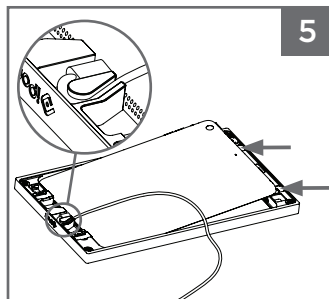

Plug in the lightning to USB cable into the iPad and lower the iPad face down into the bezel with the cable on the left hand side. Carefully wrap the iPad cable around the metal loop located on the (a) bezel. To lock the iPad in place, deploy the second and third toggle located on the right side of the Surface Mount (a) bezel.

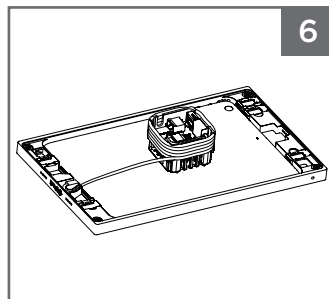

Connect the USB connector to the USB port located on the (f) PoE splitter. Tightly wrap the remaining iPad cable around the (f) PoE splitter.

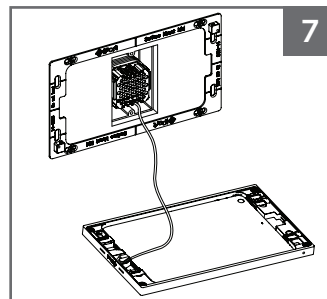

Connect the appropriate power source identified in the Power and Wiring Guide (found in (f) PoE splitter box). Place PoE splitter into the single gang box located in the wall with the iPort logo facing out.

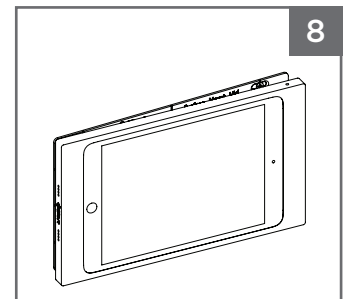

The Surface Mount (a) bezel will attach to the (b) mounting bracket with internal magnets.