

SPECTRE

VEHICLE IDENTIFICATION - AVI

SCALABLE LONG RANGE READER



BENEFITS

- Smooth & secure parking access control
- Multi-lane long-distance identification
- Optimised installation costs
- Backward compatible & interoperable

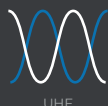

- Add Your Logo
- Casing colors
- Skin effect personalization

Accept the challenge of fast-track security at your vehicle gates.

No more queues thanks to the SPECTRE UHF identification reader! It combines dynamic, elegant design with the latest technologies for security and scalability.

SMOOTH AND SECURE VEHICLE ACCESS CONTROL

The SPECTRE reader rewrites the rules of security, making it more instinctive.

It offers top level security by enabling you to sign your UHF credentials, while using encryption methods that are recognized and recommended by independent specialized bodies in information security (ANSSI).

The identification performance - up to 14 m / 45.9 ft* - offers exceptional reading convenience and reliability for smooth vehicle access.

SIMPLIFIED SCALABLE INSTALLATION

Up to 4 antennas can be connected to the SPECTRE reader to cover all security issues and all configurations: management of a mixed fleet of vehicles (light, heavy, motorcycles, etc.), identification on wide lanes or even distinct access control for 4 lanes of vehicles.

Your reader is configured in few seconds via USB/micro USB cable or UHF card. Its QuickSet mounting system is compatible with the VESA 75 x 75 standard and enables optimal installation, regardless of site configuration.

GREEN CONCEPTION

Its green design means that SPECTRE reads fully passive credentials (no batteries). The reader can be operated by a ground loop or a presence sensor.

STANDING THE TEST OF THE TIME

The SPECTRE is the most robust on the market, with an enhanced vandal-proof structure IK10 certified to withstand knocks and malicious acts.

It is IP66 and designed for outdoor installation in harsh environments: vibration, dust, heavy rain, sea air, etc.

BETTER BY DESIGN

The strong lines and elegant style give the SPECTRE reader an extremely stealthy character to enhance your car park solutions. Its slimline design and lightness blend perfectly into all your installation environments.

The high-intensity LED, visible by day and night, makes it highly user-friendly.



◀ SPECTRE VIDEO

DESIGNED & MADE IN FRANCE

SMARTER SECURITY ANSWERS



See the legal notices on the back.

SPECIFICATIONS

Operating frequency/standards	UHF - 2 versions: - 865 - 868 MHz: 866 MHz ETSI (Europe), Morocco (n°ANRT/DG/n°7-10 regulation), etc. - 902 - 928 MHz: 915 MHz FCC Part 15 (USA), Australia, New Zealand, etc.																
Chip compatibility	EPC1 Gen 2 / ISO18000-63																
Functions	Read only signed EPC / Read Write																
Antenna(s)	1 to 4 antenna(s) Several possible configurations: - 1 integrated antenna + up to 3 external antennas - up to 4 external antennas																
Reading distances*	Up to 14 m / 45.9 ft with ETA tag and TeleTag® passive tag <i>The reading distance may vary depending on the type of vehicle, installation conditions and local regulations allowed.</i> <i>A national regulatory restriction that only allows 500mW ERP (e.g. Morocco - regulation n°ANRT/DG/n°7-10) gives performances up to 3m.</i>																
Communication interfaces	- TTL: protocol ISO2 (Data Clock) or Wiegand - RS232 with communication protocol SSCP® - RS485 with communication protocols SSCP®, OSDPT™ V1 (plain communication) & V2 (SCP secure communication)																
Inputs / Outputs (I/O)	4 inputs (to manage the reader activation, ground loop, presence sensor...) / 4 outputs (to external traffic lights control...)																
Light indicator	LED 7 colors (green, red, blue, orange, purple, turquoise, white) - OSDPT™ 4 colors (green, red, blue, orange)																
Power requirement	Typ. 1 A / 12 VDC																
Power supply	9 VDC to 36 VDC (12 VDC typical)																
Material	Antenna: ABS and polycarbonate (ABS-PC) / Reader: aluminum																
Dimensions (h x w x d) / Weight	348.7 x 279.2 x 45.1/83.6 mm / 13.7" x 11" x 1.8"/3.3" (general tolerance following ISO NFT 58-000 standard) - 2.65 kg / 93.5 oz																
Operating temperatures	- 25°C to + 60°C / - 13°F to + 140°F - Indoor / outdoor - Humidity: 5 - 95 %																
Resistance	IP66 - Weather-resistant with waterproof electronics / Reinforced vandal-proof structure IK10																
Mounting	- Adjustable wall-mounting kit - Pole-mounted Compliant with VESA 75 x 75 universal mounting kits (optional)																
Compliant cables	TNC Reverse coaxial cables (optional) - 1.5, 3, 9 and 12 m / 4.9, 9.8, 29.5 and 39.4 ft to connect antennas - Cables can be connected in series																
Certifications	CE, FCC & UL																
Part numbers	<p>Reader version with integrated antenna:</p> <p>x: versions = 4 - 865 - 868 MHz 5 - 902 - 928 MHz</p> <table> <tr> <td>Read only TTL</td> <td>SLA-Rx1-A/U04-xx/1</td> </tr> <tr> <td>Read only RS232</td> <td>SLA-Rx2-A/U04-5AB/1</td> </tr> <tr> <td>Read only RS485</td> <td>SLA-Rx3-A/U04-7AB/1</td> </tr> <tr> <td>Read write SSCP® RS232</td> <td>SLA-Wx2-A/U04-5AA/1</td> </tr> <tr> <td>Read write SSCP® RS485</td> <td>SLA-Wx3-A/U04-7AA/1</td> </tr> <tr> <td>Read write OSDPT™ RS485</td> <td>SLA-Wx3-A/U04-7OS/1</td> </tr> </table> <p>Morocco versions: add an M at the end of the reference.</p> <p>Antenna version:</p> <table> <tr> <td>865 - 868 MHz</td> <td>ANT-SPECTRE-A</td> </tr> <tr> <td>902 - 928 MHz</td> <td>ANT-SPECTRE-B</td> </tr> </table>	Read only TTL	SLA-Rx1-A/U04-xx/1	Read only RS232	SLA-Rx2-A/U04-5AB/1	Read only RS485	SLA-Rx3-A/U04-7AB/1	Read write SSCP® RS232	SLA-Wx2-A/U04-5AA/1	Read write SSCP® RS485	SLA-Wx3-A/U04-7AA/1	Read write OSDPT™ RS485	SLA-Wx3-A/U04-7OS/1	865 - 868 MHz	ANT-SPECTRE-A	902 - 928 MHz	ANT-SPECTRE-B
Read only TTL	SLA-Rx1-A/U04-xx/1																
Read only RS232	SLA-Rx2-A/U04-5AB/1																
Read only RS485	SLA-Rx3-A/U04-7AB/1																
Read write SSCP® RS232	SLA-Wx2-A/U04-5AA/1																
Read write SSCP® RS485	SLA-Wx3-A/U04-7AA/1																
Read write OSDPT™ RS485	SLA-Wx3-A/U04-7OS/1																
865 - 868 MHz	ANT-SPECTRE-A																
902 - 928 MHz	ANT-SPECTRE-B																

DISCOVER OUR COMPATIBLE TAG RANGE

For more security and user comfort, a wide range of services and options is available: windscreen mounting kit for TeleTag®, serigraphy, sequential or physical printing, self-destructible label...

TeleTag® has been designed to be installed especially behind the windscreen. Thanks to its smart mounting system, it can be installed either permanently or in a removable way.



TeleTag®
Windscreen tag



ETA
Windscreen label



CCT
UHF or dual frequency cards

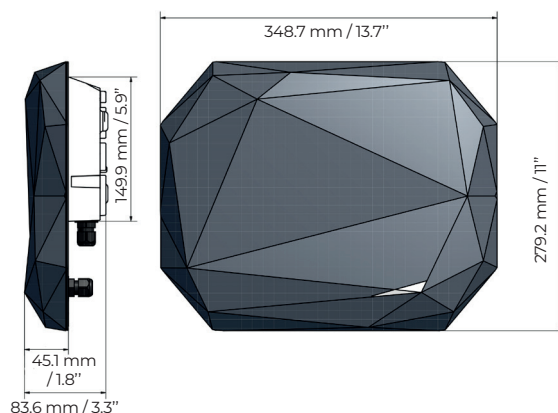
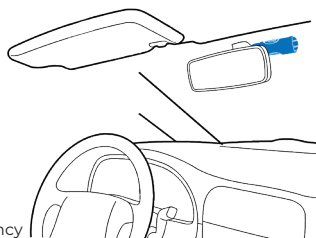

* Caution: Information on communication distances: measured at the center of the antenna, depending on vehicle positioning, antenna configuration, reader installation environment, power supply voltage and local regulations allowed. External disturbances may cause reading distances to be reduced. Reading performance depends on the positioning of the tag and the type of windshield. Athermal windscreens may affect reading performance. It is imperative to place the tag in the saving zones.

Legal statements: STid is a trademark of STid SAS. All other trademarks are property of their respective owners.

This document is the exclusive property of STid. STid reserves the right to stop any product or service for any reason and without any liability - Noncontractual photographs.

© STid 2020, all right reserved/ Flyer_Spectre_SLA_V21.LUS

Headquarters / EMEA

13850 Gréasque, France
Tel.: +33 (0)4 42 12 60 60

PARIS-IDF

92290 Châtenay-Malabry, France
Tel.: +33 (0)1 43 50 11 43

STid UK Ltd.

Gallows Hill, Warwick CV34 6UW, UK
Tel.: +44 (0) 192 621 7884

NORTH AMERICA

Irving, Texas 75063-2670, USA
Tel.: +1 877 894 9135

LATINO AMERICA

Cuauhtémoc, 06600 CDMX, México
Tel.: +52 (55) 5256 4706

MIDDLE EAST

Dubai Digital Park, DSO, UAE
Tel.: +971 521 863 656

info@stid.com
www.stid-security.com

SPECTRE
NANO

UHF & BLUETOOTH® MULTI-TECHNOLOGY READER

MIXED VEHICLE & DRIVER IDENTIFICATION



BENEFITS

- Hands-free identification of the vehicle and/or the driver
- Highly adaptable and secure identification
- Visual and audio user feedback
- Interoperable and multi-protocol

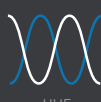

- Add your logo
- Casing color options

SPECTRE nano, the most compact UHF and Bluetooth® reader on the market, improves the user experience while securing and eliminating vehicle access lines.

MULTI-TECHNOLOGY AT THE SERVICE OF INSTINCTIVE IDENTIFICATION

SPECTRE nano facilitates access control for vehicles and drivers with different profiles (visitors, employees, tenants, etc.) thanks to multiple identification technologies.

Passive UHF technology

The reader provides UHF identification up to 6 m*.

The passive credentials (without battery) require no maintenance and have an unlimited life span.

Bluetooth® Smartphones

The reader offers many identification modes - long distance, hands-free or Proximity - to make your access control both secure and instinctive!

Fully integrated into the STid Mobile ID® ecosystem, SPECTRE nano allows users to use their virtual card for both parking and pedestrian access.

Mixed identification

SPECTRE nano reads heterogeneous identifiers:

- the virtual card for smooth management of visitor and employee access,
- the UHF windshield tag for tracking vehicle fleets
- both simultaneously for vehicle and driver identification.

SECURITY CONTROLLED FROM END-TO-END

The reader benefits from the highest levels of security, guaranteeing the authenticity and confidentiality of data, using encryption methods recognized and recommended by independent organizations (ANSSI, FIPS, etc.):

- Encrypted / signed credentials to ensure anti-cloning and anti-replay protection.
- EAL5+ certified key storage.
- Self-protection function to erase security keys.
- Secure end-to-end bidirectional communication using SSCP® and Open Supervised Device Protocol (OSDP™) protocols.

EASY TO INSTALL

The reader can be configured in seconds via USB cable, UHF / virtual card, or protocol. Its VESA 75 x 75 standard compatible mounting system allows for optimal wall or pole installation regardless of the site configuration.

STANDING THE TEST OF TIME

It integrates a reinforced anti-vandal structure IK10 to resist shocks and malicious acts. IP65, it is designed for outdoor installation in harsh environments: vibration, dust, heavy rain, saline environments, etc.

APPLICATIONS

- Parking access: tertiary, administration, communities, industries...
- Shared vehicle management
- Sensitive sites
- Visitor management
- Two-wheeler identification
- Bus stations (...)

DESIGNED & MADE IN FRANCE

SMARTER SECURITY ANSWERS



*See the legal notices on the back.

CHARACTERISTICS

Operating frequency/Standards	UHF - 2 versions: - 865 - 868 MHz : 866 MHz ETSI (Europe), Morocco (regulation n°ANRT/DG/h°7-10), etc. - 902 - 928 MHz : 915 MHz FCC Part 15 (USA), Australia, New Zealand, etc. Bluetooth®
Chip Compatibilities	EPC1 Gen 2 / ISO18000-63 STid Mobile ID® (Bluetooth® virtual card) 4 possible configurations: UHF only, UHF or Bluetooth®, UHF then Bluetooth®, Bluetooth® then UHF
Functions	Read only EPC (UHF) / CSN (Bluetooth®) or secure EPC encrypted / signed (UHF) / private ID (Bluetooth®) Controlled by protocol (read/write)
Communication interfaces	- Standard TTL output: ISO2 protocol (Clock&Data) or Wiegand - RS232 with SSCP® v1 & v2 secure communication protocols - RS485 with SSCP® v1 & v2 secure communication protocols; OSDP™ v1 (plain text) and v2 (Secure Channel Protocol)
Antenna	Integrated antenna with circular polarization
RF power	Up to 27 dBm (adjustable power)
Reading distances*	Up to 6 m with ETA tag and TeleTag® passive tag Up to 20 m with a Bluetooth® smartphone Adjustable reading range on each reader <i>The reading range may vary depending on the type of vehicle, the installation conditions and the local regulations allowed.</i>
Data protection	Yes - Software protection and EAL5+ certified crypto processor for secure key storage
Light indicator	1 LED 7 colors (green, red, blue, orange, purple, turquoise, white) Configurable by card (classic or virtual with STid Settings application), software, or controlled by external command (0V)
Audio indicator	Integrated buzzer with adjustable intensity Configurable by card (classic or virtual with STid Settings application), software, or controlled by external command (0V) depending on interface. Can be activated / deactivated by jumper
Input / Output (I/O)	1 input (for control by ground loop / presence detector...) - 1 output (to control traffic lights...)
Relay	1 power relay of 24 VDC 2A (control of a barrier...)
Power requirement	900 mA / typically 12 VDC / 1.5 A / 12 VDC max
Power supply	From 9 VDC to 36 VDC (typically 12 VDC)
Connectors	8-pin plug-in screw terminal block (0.1") and cable gland
Materials	ABS and polycarbonate (ABS-PC) / Aluminum
Dimensions (h x w x d) / Weight	185 x 230 x 35 mm / 7.2" x 9" x 1.4" / 1.25 kg / 35.3 oz
Operating temperatures	From - 30°C to + 60°C / From - 22°F to + 140°F
Storage temperatures	From - 40°C to + 65°C / From - 40°F to + 149°F
Tamper function	Detection of the opening of the cover by infrared sensor and mechanical switch with possibility of erasing the keys and/or message to the controller
Protection / Resistance	IP65 certified - Weather, water, and dust resistant / Humidity: 5 - 95% / IK10 certified vandal-proof front face structure
Mounting	Supplied with wall mounting bracket Compliant with VESA 75 x 75 universal mounting kits (optional) - Adjustable wall-mounting kit - Pole-mounted
Certifications	CE (Europe), FCC (USA), IC (Canada) and UL

Part numbers	Read only - TTL SNA-Rx1-A/BT4-xx/1
x: versions = 4 - 865 - 868 MHz; 5 - 902 - 928 MHz	Secure read only - RS232 SNA-Rx2-A/BT4-5AB/1
	Secure read only - RS485 SNA-Rx3-A/BT4-7AB/1
	Operates using SSCP® protocol v1 & v2 - RS232 SNA-Wx2-A/BT4-5AX/1
	Operates using OSDP® protocol v1 & v2 - RS485 SNA-Wx3-A/BT4-7AX/1
	Operates using OSDP™ protocol v1 & v2 - RS485 SNA-Wx3-A/BT4-7OS/1

DISCOVER OUR CREDENTIALS AND OUR ERGONOMIC MANAGEMENT TOOLS



TeleTag® & ETA
UHF windshield
tags and labels



CCT & PCG
UHF or dual frequency
cards and key fobs



The STid Mobile ID® application
Smartphones /
Bluetooth® connected watches



ULTRYS programming kit
and SSCP® and OSDP™ protocols



STid Mobile ID® Online Portal
Web-based platform for remote
management of your virtual cards

* Attention: information on communication distances: measured at the center of the antenna, depending on the positioning of the vehicle, the antenna configuration, the installation environment of the reader, the supply voltage, and the local regulations in effect. External disturbances can cause the reading range to decrease. The reading performance depends on the positioning of the tag and the type of windshield. Impervious windshields can affect reading performance. It is imperative to place the tag in the resist zones.

Legal Notice: STid, STid Mobile ID® and SSCP® are registered trademarks of STid SAS. All trademarks mentioned in this document belong to their respective owners. All rights reserved - This document is the sole property of STid. STid reserves the right, at any time and without notice, to make changes to this document and/or to stop marketing its products and services. The photographs are non-contractual.

© STid 2021, all right reserved / Flyer_Spectre_SNA-AVL-V1.0_US

Headquarters / EMEA

13850 Gréasque, France
Tel.: +33 (0)4 42 12 60 60

PARIS-IDF Office

92290 Châtenay-Malabry, France
Tel.: +33 (0)1 43 50 11 43

STid UK Ltd.

Gallows Hill, Warwick CV34 6UW, UK
Tel.: +44 (0) 192 621 7884

NORTH AMERICA Office

Irving, Texas 75063-2670, USA
Tel.: +1 877 894 9135

LATINO AMERICA Office

Cuauhtémoc, 06600 CDMX, México
Tel.: +52 (55) 5256 4706

MIDDLE EAST Office

Dubai Digital Park, DSO, UAE
Tel.: +971 521 863 656

info@stid.com
www.stid-security.com