

AvAI o  
n

  
PARISI  
BATHWARE

*Just*  
BATHROOMWARE

semirecessed basin



Manufactured by   
PARISI  
BATHWARE

2.66.0

January 2011

## semirecessed basin



The Avalon is a soft edge semi recessed basin with a wide generous bowl.

Code: PMP57820 (NTH)  
 PMP57821 (1TH)  
 PMP57823 (3TH)

### Tap Hole Options

0, 1 or 3 tap holes as standard.

### Waste Outlet

32mm standard plug and waste to be ordered separately (see technical data sheets 2.99.0 for options available)

### Bowl Capacity

9 litres to overflow.

### Overflow

Standard - positioned at the rear of the bowl.

### Installation Instructions

It is recommended that the basin be installed using a flexible sealant. (Epoxy type glues must not be used. To do so may void product warranty). For ease of cleaning it is suggested that the minimum distance between the wall and the rear of the basin be 50mm. Please be advised that this basin is **not glazed** on the underside.

### Colour

White only.

### Packing Details

15 kg. Supplied in one carton.

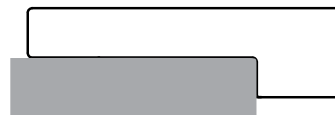
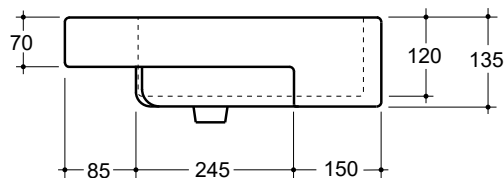
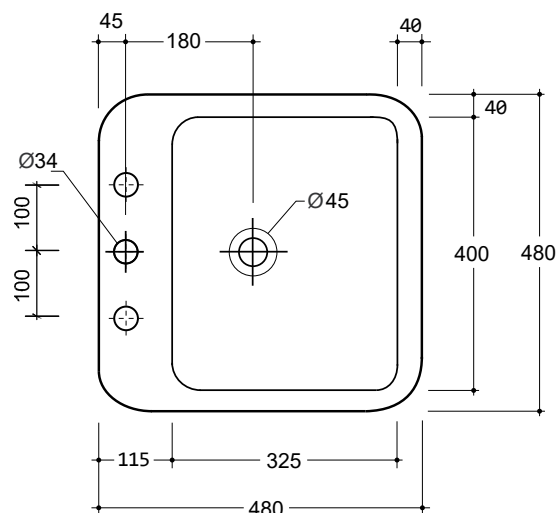

Manufactured by

