



# DEWATERING & CONSTRUCTION



**GAS DETECTION  
VALVES**

**INSTRUMENTATION**

**FLUID SEALING**

**HOSE**

**FITTINGS**

**NZSafetyBlackwoods**

TECHNICAL SOLUTIONS

0800 832 732



[nzsafetyblackwoods.co.nz](http://nzsafetyblackwoods.co.nz)





## EF637 Corrugated Water Suction Hose

A short length suction and delivery soft ended hose, ideally suited for temporary or permanent water transfer applications.

### Features

- Highly flexible compared to standard water suction hoses
- Easy to handle lengths
- Soft 'cuffed' ends for ease of fitting insertion

**Reinforcement:** High tensile textile braid with embedded wire helix

**Inner Tube:** Black NR/SBR Blend

**Cover:** Black NR/SBR Blend

**Safety Factor:** 3:1

**Temperature Range:** -20°C to +80°C



Nominal Size ID*	Nominal Size ID	Weight	Working Pressure	Length	Code	Code
mm	inch	kg/m	psi (@ 20°C)	m	Hose, per length	Hose Assembly, with Bauer Type B Couplings
76	3	0.54	150	3	460011	460899
76	3	0.54	150	6	460012	460900
102	4	0.60	150	3	460013	460901
102	4	0.60	150	6	460014	460902
152	6	0.67	150	3	460015	460903
152	6	0.67	150	6	460016	460904
203	8	0.94	150	3	460017	460905
203	8	0.94	150	6	460018	460906

\* Up to 12" (305mm) available on request \*\*Available as a bare hose or a hose assembly with Bauer Type B couplings.

2

## Custom Built Hose Assemblies

### Need a customised hose solution?

Our Technical Solutions team has the capability and expertise to help specify and customise hose to suit your requirements. All hoses can be hand built to suit your specifications and can be fully tested and certified before dispatch.

### Hose Capabilities:

- Dock and bunkering hose
- Slurry hose
- Wine transfer hose
- Acid and chemical transfer hose
- Large bore pump suction hose
- Road sweeper hose
- Dewatering and layflat hose
- Hot and cold water suction and delivery hose
- Firefighting hose
- And more!



**FOR MORE INFORMATION CONTACT OUR TECHNICAL SOLUTIONS TEAM**



## EF640 EPDM Water Suction & Delivery Hose

A suction and delivery hose designed for the transfer of domestic or industrial water, light slurries or liquid manure.

### Features

- Good cold weather flexibility
- Constant working pressure throughout the size range
- Abrasion resistant cover

**Reinforcement:** High tensile textile cord with embedded steel wire helix

**Inner Tube:** Black smooth EPDM

**Cover:** Black wrapped EPDM - abrasion and ozone resistant

**Safety Factor:** 3:1

**Temperature Range:** -20°C to +80°C

**Max Coil Length:** 20m



Nominal Size ID*	Nominal Size ID	Nominal Size OD	Bend Radius	Weight	Working Pressure	Code
mm	inch	mm	mm	kg/m	psi (@20°C)	Hose, per meter
19	¾	27	125	0.69	150	460019
25	1	35	150	0.80	150	460020
32	1¼	42	200	0.96	150	460021
38	1½	48	220	1.11	150	460022
51	2	61	240	1.50	150	460023
63	2½	75	355	1.96	150	460024
76	3	88	460	2.40	150	460025
102	4	114	610	3.30	150	460026
152	6	166	800	6.70	150	460027

\*Up to 12" (305mm) available on request.

## EXITFLEX EF682 Water Delivery Hose

A sturdy water delivery hose for use in all sectors of industry, including agriculture, mining, general industry and aquaculture.

### Features

- Good cold flexibility
- Outer cover has good resistance to atmospheric conditions

**Reinforcement:** High tensile cord

**Inner Tube:** Black NR/SBR Blend

**Cover:** Black NR/SBR Blend

**Temperature Range:** -25°C to +85°C

**Max Coil Length:** 20m



Nominal Size ID*	Nominal Size ID	Nominal Size OD	Bend Radius	Weight	Working Pressure	Code
mm	inch	mm	mm	kg/m	psi (@20°C)	Hose, per metre
19	¾	29	220	0.64	145	460028
25	1	36	310	0.87	145	460029
32	1¼	43	360	1.13	145	460030
38	1½	48	470	1.14	145	460031
51	2	62	600	1.69	145	460032
63	2½	78	760	2.74	145	460033
76	3	90	910	3.07	145	460034
102	4	115	1230	3.88	145	460035

\*Up to 12" (305mm) available on request.





## Blue General Purpose Layflat Hose

Sunnyhose

General purpose hose suitable for temporary water supply or drainage, for drip irrigation, construction, industrial or agricultural applications.

### Features

- Smooth tube provides low friction loss
- Ultraviolet inhibitors reduce aging and weather checking
- Hose lays straight with minimal elongation under pressure

**Reinforcement:** High Tensile Textile Cord  
**Inner Tube:** Blue Homogeneous PVC  
**Cover:** Blue Homogeneous PVC

**Safety Factor:** 3:1  
**Temperature Range:** -20°C to +54°C  
**Max Coil Length:** 100m



Nominal Size	Nominal Size	Wall Thickness	Weight	Working Pressure	Code	Code
mm	inch	mm	kg/m	psi (@20°C)	Hose, per Metre	Hose Assembly, 20m with camlocks
25	1	1.20	0.165	101	05641865	441752
32	1 ¼	1.20	0.190	101	05641882	-
40	1 ½	1.25	0.205	72	08751212	441753
50	2	1.30	0.270	65	01331419	484216
65	2 ½	1.50	0.380	58	00512019	-
75	3	1.70	0.530	58	02966812	441754
100	4	1.75	0.705	58	00434954	441755
150	6	1.95	1.175	43	00435454	-
200	8	2.20	1.785	43	04819158	-

\*Available as a bare hose or a hose assembly with aluminium camlocks. Custom made assemblies available on request.

## Red Heavy Duty Layflat Hose

Sunnyhose

Heavy duty abrasion resistant hose, suitable for water drainage at open pit mines and civil engineering/dam construction sites in mountains, or other areas, where water must be moved to significantly higher or lower elevations.

### Features

- Smooth tube provides low friction loss
- Heavy duty
- Excellent abrasion resistance

**Reinforcement:** High Tensile Textile Cord  
**Inner Tube:** Red PVC  
**Cover:** Red PVC

**Safety Factor:** 3:1  
**Temperature Range:** -20°C to +54°C  
**Max Coil Length:** 100m



Nominal Size	Nominal Size	Wall Thickness	Weight	Working Pressure	Code	Code
mm	inch	mm	kg/m	psi (@20°C)	Hose, per metre	Hose Assembly, 20m with camlocks
40	1 ½	1.90	0.29	145	04820154	441756
50	2	2.05	0.42	145	04820256	441757
65	2 ½	2.15	0.54	145	04820358	-
75	3	2.25	0.66	130	04820461	441758
100	4	2.55	1.00	130	04820558	441759
150	6	2.95	1.68	101	04820654	-
200	8	2.95	2.20	72	05641916	-

\*Available as a bare hose or a hose assembly with aluminium camlocks. Custom made assemblies available on request.

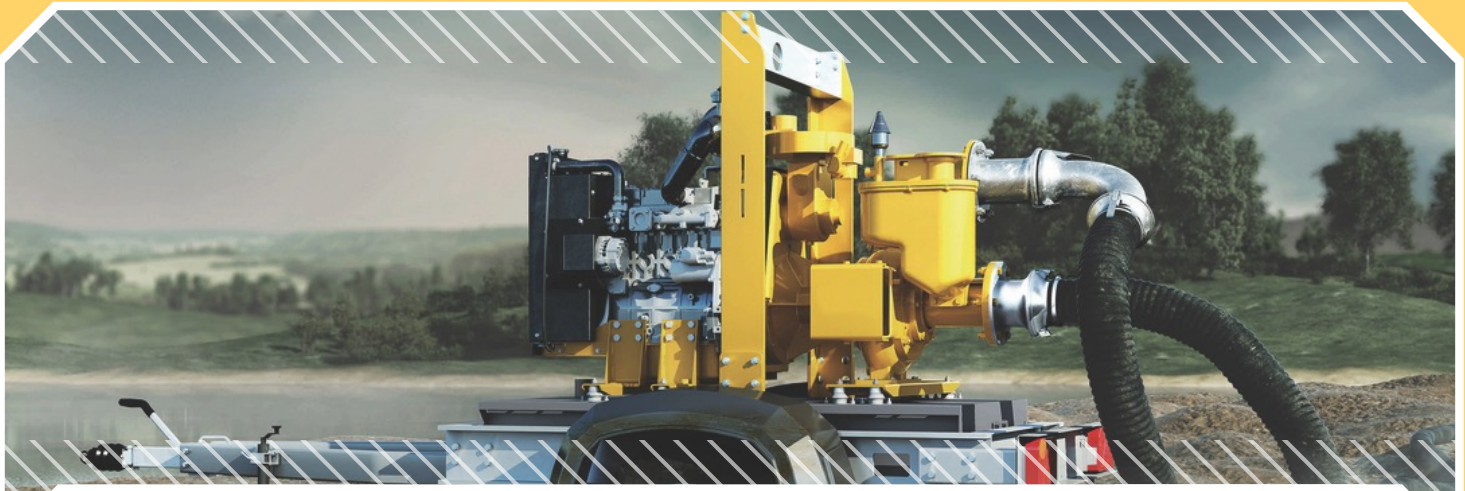

**OPTIMA**  
Don't opt for anything less.

A general purpose rubber covered layflat hose, used for the transfer of water in the pump hire and civil construction industries. Other applications include; dewatering, temporary bypass lines, irrigation installations as well as pumping of sludge and liquid fertilizer.

**Features**

- Abrasion resistant
- UV stabilised
- Non-conductive

**Reinforcement:** High strength circular woven textile braid  
**Inner Tube:** Black Nitrile  
**Cover:** Black Nitrile

**Temperature Range:** -30°C to +80°C  
**Max Coil Length:** 100m



Nominal Size ID*	Nominal Size ID	Wall Thickness	Weight	Working Pressure	Code	Code	Code
					Hose, per metre	Hose, 20m Coil	Hose Assembly, 20m with Bauer Type B Couplings
mm	inch	mm	kg/m	psi (@20°C)			
51	2	2.0	0.31	150	460036	-	460894
76	3	2.5	0.45	150	460037	-	460895
102	4	2.5	0.68	150	460038	460041	460896
152	6	3.0	0.95	150	460039	460042	460897
203	8	3.0	1.65	150	460040	460043	460898

\*Up to 10" (254mm) available on request \*\*Available as a bare hose or a hose assembly with Bauer Type B couplings. Custom made assemblies available on request.

**Gorilla Multi-Purpose Rubber Hose**

A premium-quality, multipurpose industrial hose for high pressure compressed air service lines. Suitable for stationary or mobile compressors operating pneumatic tools in construction, agriculture, quarries, mines, railroads, factories and the oil and gas industry.

**Features**

- Non-conductive cover
- High oil resistance inner tube and cover
- Ideal for use with claw style safety couplings

**Reinforcement:** Braided Synthetic Yarn  
**Inner Tube:** Nitrile Synthetic Rubber  
**Cover:** Yellow Carbryn Synthetic Rubber  
**Safety Factor:** 4:1  
**Temperature Range:** -29°C to +88°C



**GET YOUR CUSTOM BUILT ASSEMBLIES WITH CLAW COUPLINGS**  
Available on request



Nominal Size ID	Nominal Size ID	Nominal Size OD	Weight	Working Pressure	Max Coil Length	Code
mm	inch	mm	kg/m	psi (@20°C)	m	Hose, per metre
10	3/8	18.6	0.33	500	152.4	04109621
12	1/2	22.6	0.42	500	152.4	04109638
19	3/4	30.2	0.61	500	152.4	04109672
25	1	37.8	0.86	500	137.2	04109689
32	1 1/4	45.6	1.18	500	137.2	05636510
38	1 1/2	51.8	1.27	500	91.44	05636527



- Able to be quickly and easily assembled with 3 movements, providing a leak proof connection in both suction and pressure applications
- Spherical construction ensures an efficient seal at angular deviations of up to 30 degrees
- Quick action fittings with four parts: Male Ball, Closure Ring, Female Socket and Sealing Ring

**Material:** Zinc Plated Steel



Nominal Size	Nominal Size	Code Male Ball x Hose Tail	Code Female x Hose Tail (incl Seal)	Code Closure Rings	Code Replacement Seals
51	2	460783	460788	460793	460798
76	3	460784	460789	460794	460799
102	4	460785	460790	460795	460800
152	6	460786	460791	460796	460801
203	8	460787	460792	460797	460802

### Male to Flanged Table D/E

- Ideal for creating a connection point for female Bauer Type B couplings to flanges typically to fixed, or mobile plant and machinery

Nominal Size	Nominal Size	Table	Code
51mm	2 inch	D/E	<b>460803</b>
102mm	4 inch	E	<b>460805</b>
152mm	6 inch	E	<b>460806</b>
203mm	8 inch	E	<b>460807</b>



### Female to Flanged Table D/E

- Ideal for creating a connection point for male Bauer Type B couplings to flanges typically to fixed or mobile plant and machinery

Nominal Size	Nominal Size	Table	Code
51mm	2 inch	D/E	<b>460808</b>
76mm	3 inch	D/E	<b>460809</b>
102mm	4 inch	E	<b>460810</b>
152mm	6 inch	E	<b>460811</b>
203mm	8 inch	E	<b>460812</b>



### Female to Male BSPT

- Ideal for creating a connection point for male Bauer Type B couplings to female BSP threaded ends, typically to fixed or mobile plant and machinery

Nominal Size	Nominal Size	Code
51mm	2 inch	<b>460813</b>
76mm	3 inch	<b>460814</b>
102mm	4 inch	<b>460815</b>
152mm	6 inch	<b>460816</b>



### Male to Male BSPT

- Ideal for creating a connection point for female Bauer Type B couplings to female BSP threaded ends, typically to fixed or mobile plant and machinery

Nominal Size	Nominal Size	Code
51mm	2 inch	<b>460817</b>
76mm	3 inch	<b>460818</b>
102mm	4 inch	<b>460819</b>
152mm	6 inch	<b>460820</b>



### 45 Degree Elbow Male to Female

- Ideal for joining male and female Bauer Type B couplings where a 45 degree change in angle is required

Nominal Size	Nominal Size	Code
102mm	4 inch	<b>460821</b>
152mm	6 inch	<b>460822</b>



### 90 Degree Elbow Male to Female

- Ideal for joining male and female Bauer Type B couplings where a 90 degree change in angle is required

Nominal Size	Nominal Size	Code
102mm	4 inch	<b>460823</b>
152mm	6 inch	<b>460824</b>



### Y Joint Male Branch

- Ideal for joining male and female Bauer Type B couplings where two connections are required

Nominal Size	Nominal Size	Code
102mm	4 inch	<b>460825</b>
152mm	6 inch	<b>460826</b>



### Split Strainer

- Ideal for keeping debris out of suction hose and pumps
- Material: Aluminium

Nominal Size	Nominal Size	Code
102mm	4 inch	<b>460827</b>
152mm	6 inch	<b>460828</b>
203mm	8 inch	<b>460829</b>



### Male to Strainer

- Ideal for keeping debris out of suction hose and pumps where a female Bauer Type B Coupling is present

Nominal Size	Nominal Size	Code
102mm	4 inch	<b>460830</b>
152mm	6 inch	<b>460831</b>

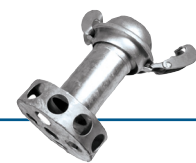

**NEED A CLAMP?** SHOP OUR EXTENSIVE CLAMPING RANGE TO FIND THE PERFECT CLAMP FOR YOUR APPLICATION

**SHOP THE RANGE**



### Camlock Type A Adaptor Female BSP

Nominal Size	Nominal Size	Code
19mm	¾ inch	03675102
25mm	1 inch	03522103
32mm	1¼ inch	03522307
38mm	1½ inch	03522404
51mm	2 inch	03522501
63mm	2½ inch	03522608
76mm	3 inch	03522705
102mm	4 inch	03522802
152mm	6 inch	460066



### Camlock Type B Coupler Male BSP

Nominal Size	Nominal Size	Code
19mm	¾ inch	03525003
25mm	1 inch	03525100
32mm	1¼ inch	03525207
38mm	1½ inch	03525304
51mm	2 inch	03525401
63mm	2½ inch	03525508
76mm	3 inch	03525605
102mm	4 inch	03525702
152mm	6 inch	460071



### Camlock Type C Coupler Hosetail

Nominal Size	Nominal Size	Code
19mm	¾ inch	03526400
25mm	1 inch	03526507
32mm	1¼ inch	03526604
38mm	1½ inch	03526701
51mm	2 inch	03526808
63mm	2½ inch	03526905
76mm	3 inch	03527001
102mm	4 inch	03527108
152mm	6 inch	03527205



### Camlock Type D Coupler Female BSP

Nominal Size	Nominal Size	Code
19mm	¾ inch	03527700
25mm	1 inch	03527807
32mm	1¼ inch	03527904
38mm	1½ inch	03528000
51mm	2 inch	03528107
63mm	2½ inch	03528204
76mm	3 inch	03528301
102mm	4 inch	03528408
152mm	6 inch	03725706



### Camlock Type E Adaptor Hosetail

Nominal Size	Nominal Size	Code
19mm	¾ inch	03529504
25mm	1 inch	03529601
32mm	1¼ inch	03529708
38mm	1½ inch	03529805
51mm	2 inch	03640603
63mm	2½ inch	03530001
76mm	3 inch	03530108
102mm	4 inch	03530205
152mm	6 inch	03530409



### Camlock Type F Adaptor Male BSP

Nominal Size	Nominal Size	Code
19mm	¾ inch	03530603
25mm	1 inch	03530700
32mm	1¼ inch	03530807
38mm	1½ inch	03620500
51mm	2 inch	03620607
63mm	2½ inch	03530904
76mm	3 inch	03531000
102mm	4 inch	03531107
152mm	6 inch	03620704



### Camlock Type DC Female Dust Cap

Nominal Size	Nominal Size	Code
32mm	1¼ inch	03619702
19mm	¾ inch	03726705
25mm	1 inch	03619605
38mm	1½ inch	03619809
51mm	2 inch	03619906
63mm	2½ inch	03620005
76mm	3 inch	03620102
102mm	4 inch	03620209
152mm	6 inch	03620306



### Camlock Type DP Male Dust Plug

Nominal Size	Nominal Size	Code
19mm	¾ inch	03680401
25mm	1 inch	03532203
32mm	1¼ inch	03532300
38mm	1½ inch	03532407
51mm	2 inch	03532504
63mm	2½ inch	03675801
76mm	3 inch	03532708
102mm	4 inch	03532805
152mm	6 inch	460076



### Camlock Type AA Adaptor

Nominal Size	Nominal Size	Code
51mm	2 inch	03299572
76mm	3 inch	03299589
102mm	4 inch	03299606



### Round Hole Strainer Female BSP

Nominal Size	Nominal Size	Code
38mm	1½ inch	05597665
51mm	2 inch	05597682
76mm	3 inch	05597699
102mm	4 inch	05597716
152mm	6 inch	05597733



### Combination Nipple Hose Mender

Nominal Size	Nominal Size	Code
19mm	¾ inch	05571230
25mm	1 inch	05571247
32mm	1¼ inch	05571264
38mm	1½ inch	05571281
51mm	2 inch	05571298
63mm	2½ inch	05571315
76mm	3 inch	05571332
102mm	4 inch	05571349



### Combination Nipple Male BSP

Nominal Size	Nominal Size	Code
38mm	1½ inch	05623913
51mm	2 inch	05623930
76mm	3 inch	05623964
102mm	4 inch	05623981
152mm	6 inch	05623998



# NZ SAFETY BLACKWOODS INDUSTRIAL HOSE & FITTINGS PRODUCT RANGE

## HOSES

- Rubber
- PVC Pressure
- PVC Suction
- Layflat
- Ducting
- Composite

## HOSE REELS

- Manual & Automatic Rewind

## PNEUMATICS

- Pneumatic Tube & Air Pipe
- Pneumatic Push-In
- Pneumatic Quick Couplings
- Pneumatic Accessories

## FITTINGS

- Camlocks
- Hose Tails
- Couplings
- Clamps
- Brass Screwed
- Pipe Fittings
- Stainless Steel Screwed
- Polypropylene/Nylon
- Guns & Nozzles

## VALVES

- Ball Valves
- Butterfly Valves
- Gate Valves
- Check Valves
- Diaphragm Valves

## INSTRUMENTATION

- Gauges
- Flow meters
- Level indicators
- Actuators

## RUBBER

- Insertion Rubber
- Rubber Sheet
- Matting

## ACCESSORIES & CONSUMABLES

- Thread Tapes, Adhesives, Pastes & Sealants
- Hose Protectors

8



## TALK TO OUR TECHNICAL SOLUTIONS TEAM TODAY

technicalsolutions@nzsafetyblackwoods.co.nz  
or visit one of our 33 Trade Centres nationwide



Find your nearest Trade Centre

HERE



**Sean Dhar**

Technical Sales & Operations Manager - North  
027 542 0566

sean.dhar@nzsafetyblackwoods.co.nz



**Tom Bainbridge**

Auckland - Central/South, Northland  
027 368 3479

tom.bainbridge@nzsafetyblackwoods.co.nz



**Jonathan Hicks**

Auckland - North/West  
021 897 571

jonathan.hicks@nzsafetyblackwoods.co.nz



**Sujit Ghosh**

Technical Projects (National)  
027 205 3941

sujit.ghosh@nzsafetyblackwoods.co.nz



**Craig Newport**

Waikato/Central North Island  
027 596 6020

craig.newport@nzsafetyblackwoods.co.nz



**Rodrigo Vila-Silva**

B.O.P./East North Island  
027 577 2089

rodrigo.vila-silva@nzsafetyblackwoods.co.nz



**Mahendra Pardeshi**

Taranaki/Lower North Island  
027 615 7201

mahendra.pardeshi@nzsafetyblackwoods.co.nz



**Tarn Mullaly**

Technical Sales & Operations Manager - South  
021 897 392

tarn.mullaly@nzsafetyblackwoods.co.nz

