

# Installation Guide

PERLATO

## Perlato Edge Wall Mount Vanities

### IMPORTANT

Before beginning installation, make sure that the vanity is the correct model and size and conduct a thorough inspection.

1. Measure width of vanity from inner left side to inner right side. Determine height by measuring distance from metal hooks to vanity base and adding desired distance from vanity base to floor. Mark wall appropriately.

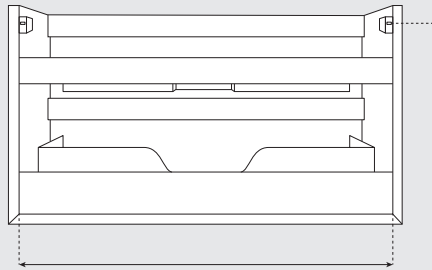

2. Drill mounting holes in wall and fasten wall brackets with screws.

Ensure brackets will be anchored to wall studs or reinforced wall for support.

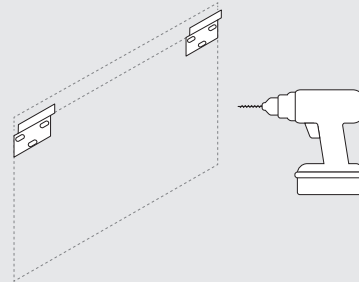

3. Remove drawers to facilitate installation process. Slide drawer forward, then gently tilt upwards and pull out completely.

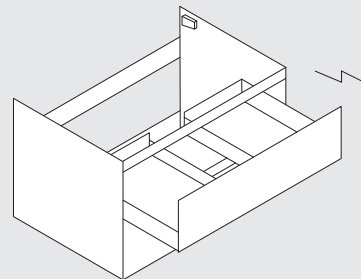

4. Hook vanity onto wall brackets. Mount support bracket onto wall directly under vanity base.

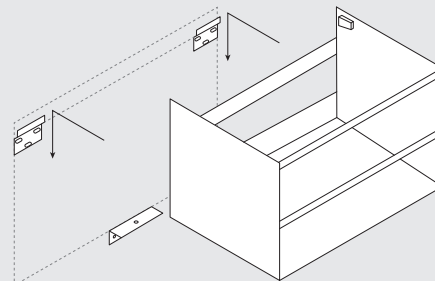

5. Adjust metal hooks if necessary to properly level vanity and secure it to wall.

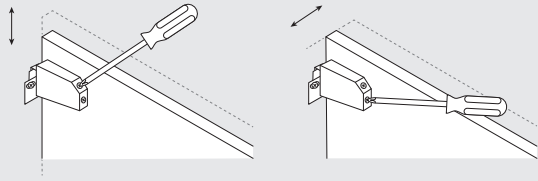

6. Attach faucet and drain to sink.

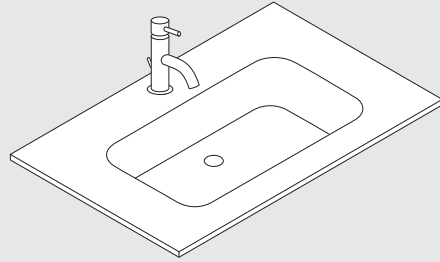

7. Spread non-acetic silicone sparingly along top rim of vanity. Position sink in place and use a cloth to wipe excess silicone.

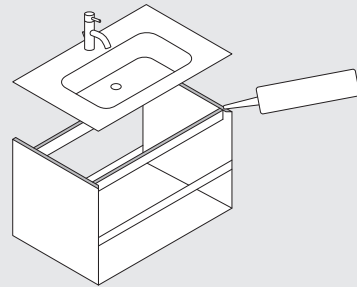

8. Connect water supply and drain lines. Run faucet and check for leaks.

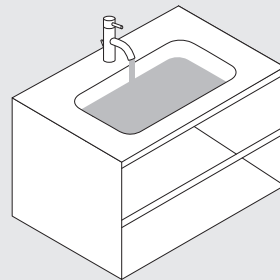

9. Slide drawers back onto tracks. If drawer front position needs adjustment, remove covers on drawer sides to access alignment mechanism.

**To align vertically**

Use setting *closest* to drawer front

**To align horizontally**

Use setting *farthest* from drawer front

