

Firenze

PTFRZ6732

67" L x 32¼" W x 23⅝" H

2 other sizes available

PTFRZ5930 59" L x 30" W x 23⅝" H
PTFRZ6331 63" L x 30¾" W x 23⅝" H



- Tub Finish White Gloss
- Drain and Overflow Finish White
 Polished Chrome
 Brushed Nickel
 Matte Black

- Material Acrylic
- Slope of Backrest 108°
- Water Depth 16⅞"
- Capacity 67G
- Weight 97lbs
- Shipping Weight 132lbs

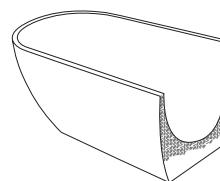

Foam Insulation *optional*

- Foam gives an added layer of solidity to the tub
- It reduces the noise level when filling
- It keeps the water warm longer

Firenze

PTFRZ6732

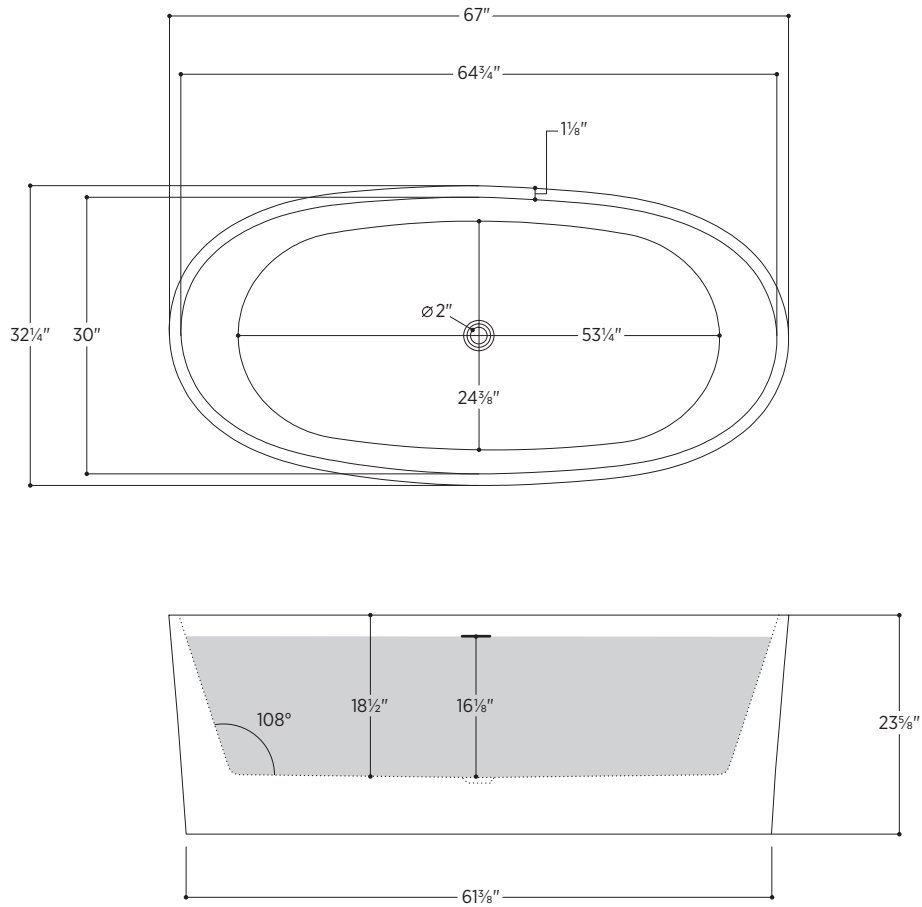

All measurements are approximate and for comparison only. Please note that these dimensions and specifications are subject to change without notice.

Install this product according to the installation guide. Floor support under bath must provide for a minimum of 995lbs (451kg). Installation may vary. Our products must be installed by certified professionals only and according to our installation guide, as well as federal, provincial/state and local building codes and regulations.

Codes/Standards Applicable:
Meets or exceeds ANSI/ASME standard Z124.1.2
and CAN/CSA B 45 requirements
IAPMO/UPC/cUPC

5 Year Warranty for Residential Use

