

MAZDA

6 GJ Wagon

02/13 > 08/16

6 GJ Sedan

02/13 > 08/16

6 GL Wagon

09/16 > 03/18

6 GL Sedan

09/16 > 03/18

Part No. 750002

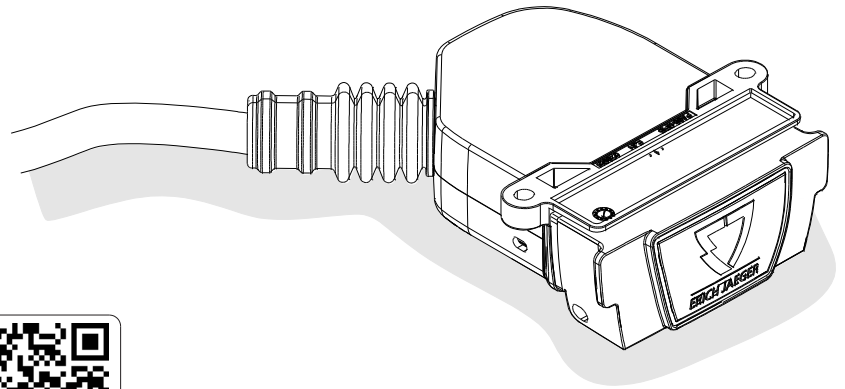

5 DDFCJ98 CERTIFIED AND TESTED WITH



**SPECTRUM™
BRAKE CONTROL**



Installation instructions

Reference:

The following information must be reviewed before beginning the assembly:

The installation instructions are to be thoroughly read.

The installation should be carried out by qualified personnel with the relevant technical knowledge. The vehicle manufacturers' current technical notices and information on retrofitting must be followed. The removal and replacement instructions found in the current repair manuals must be followed.

It must be ensured that the vehicle is technically suitable for the installation of a trailer hitch.

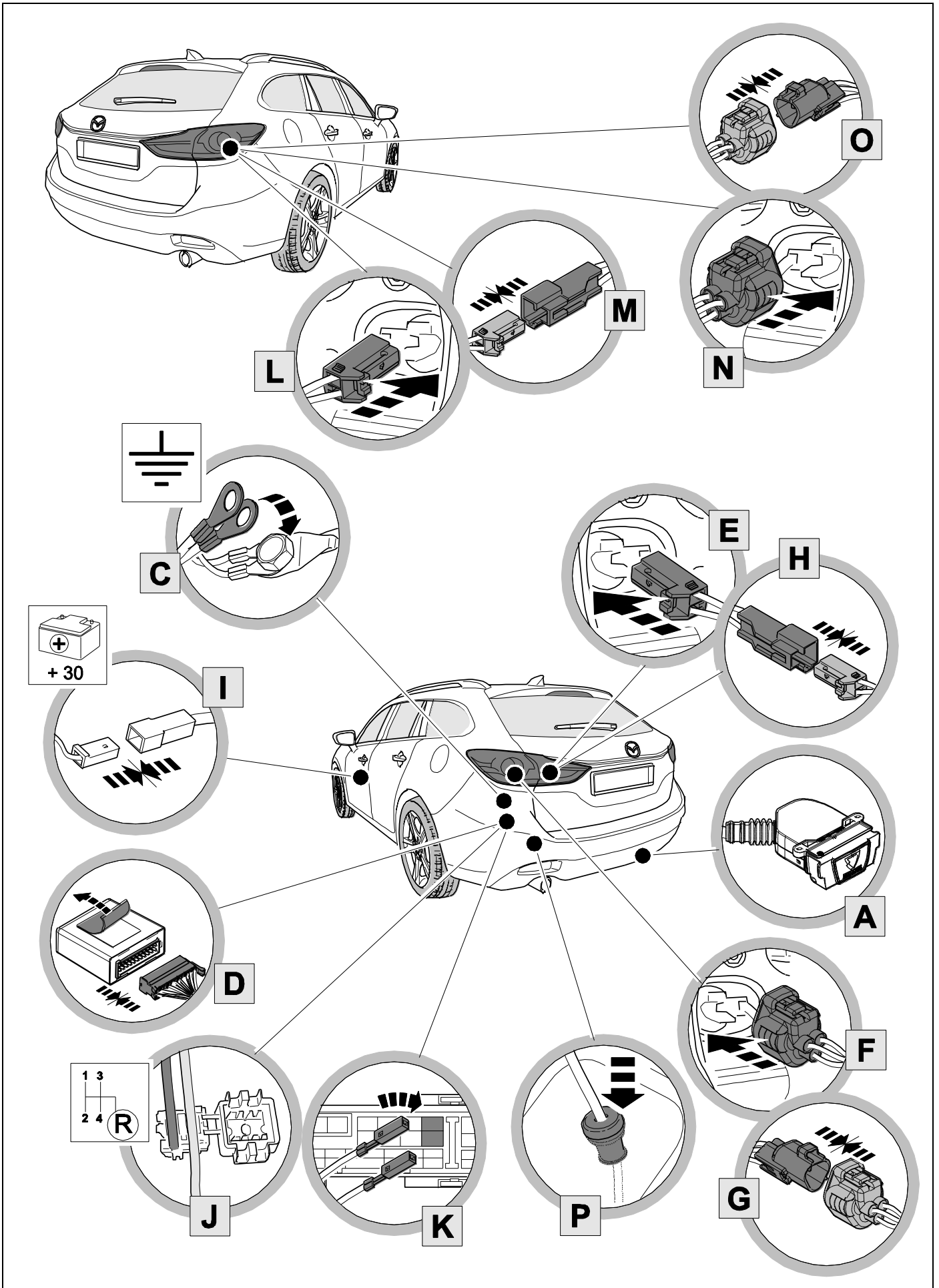

KIT

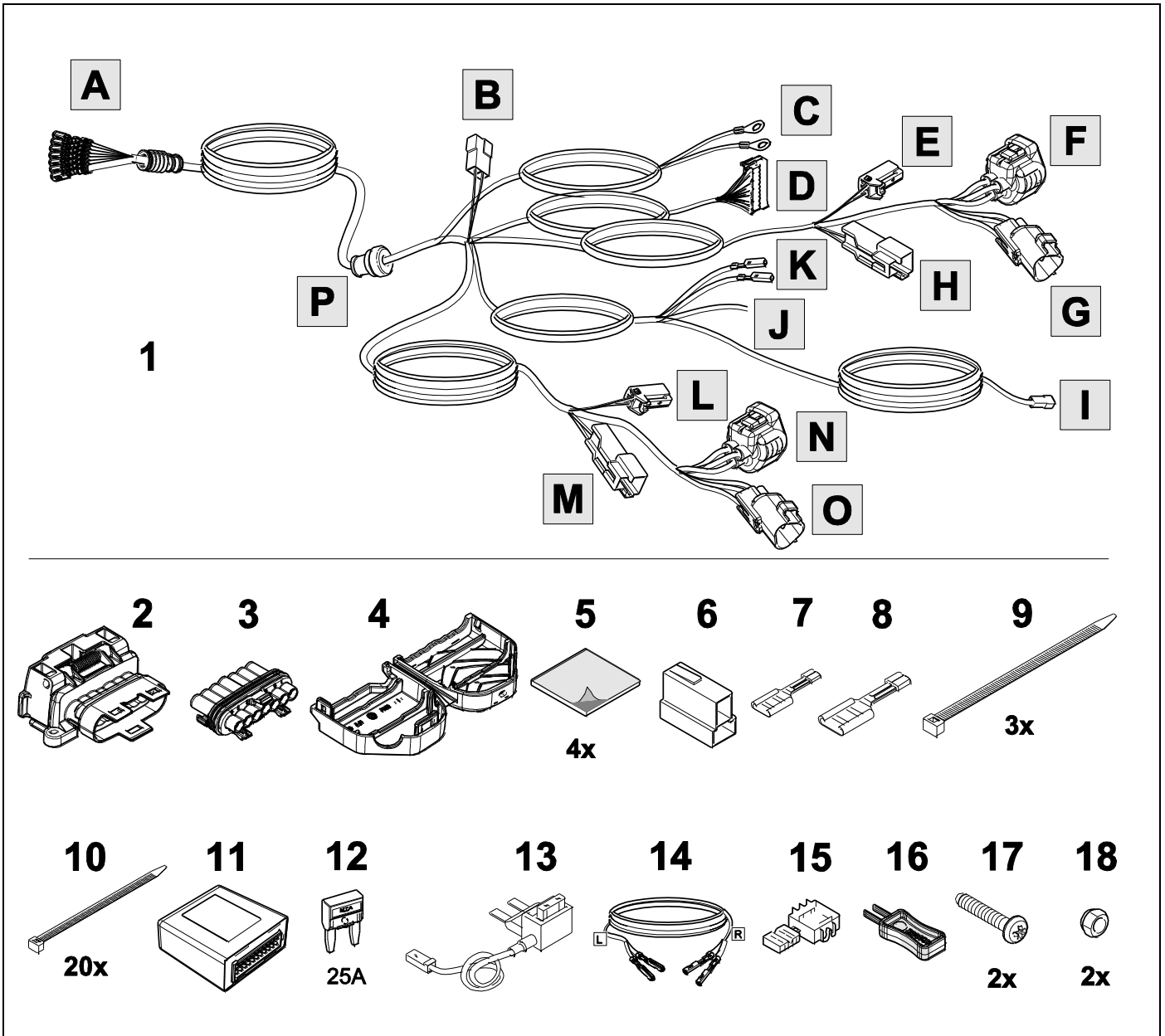

TOOLS

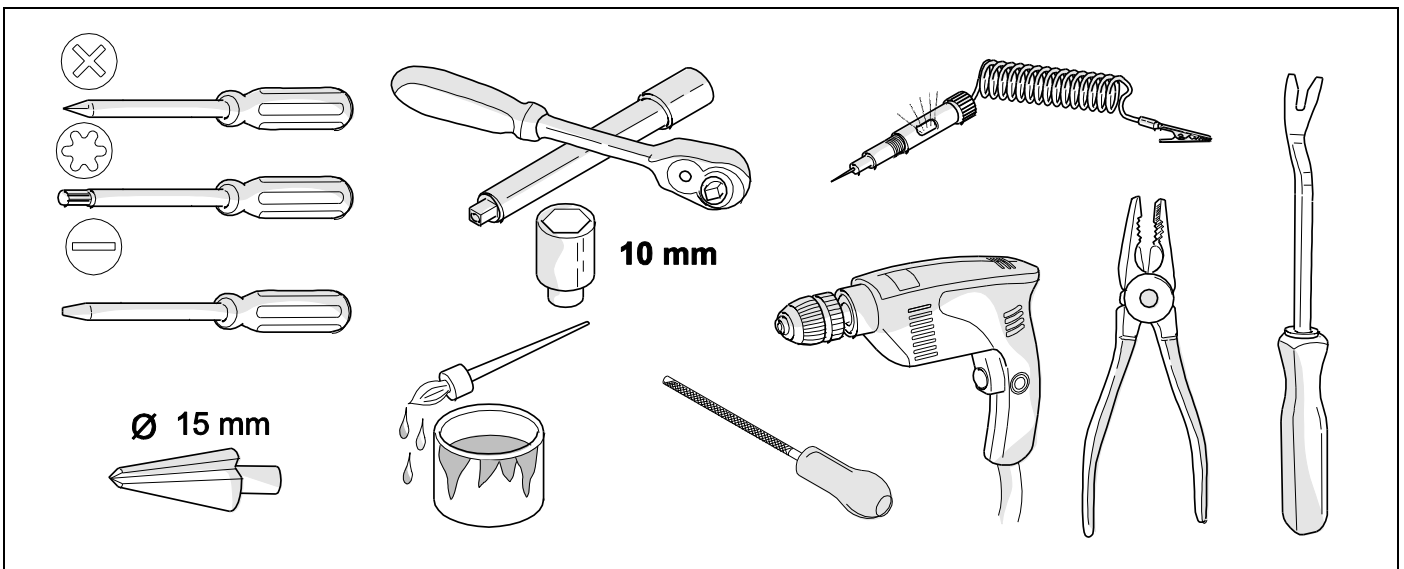

1

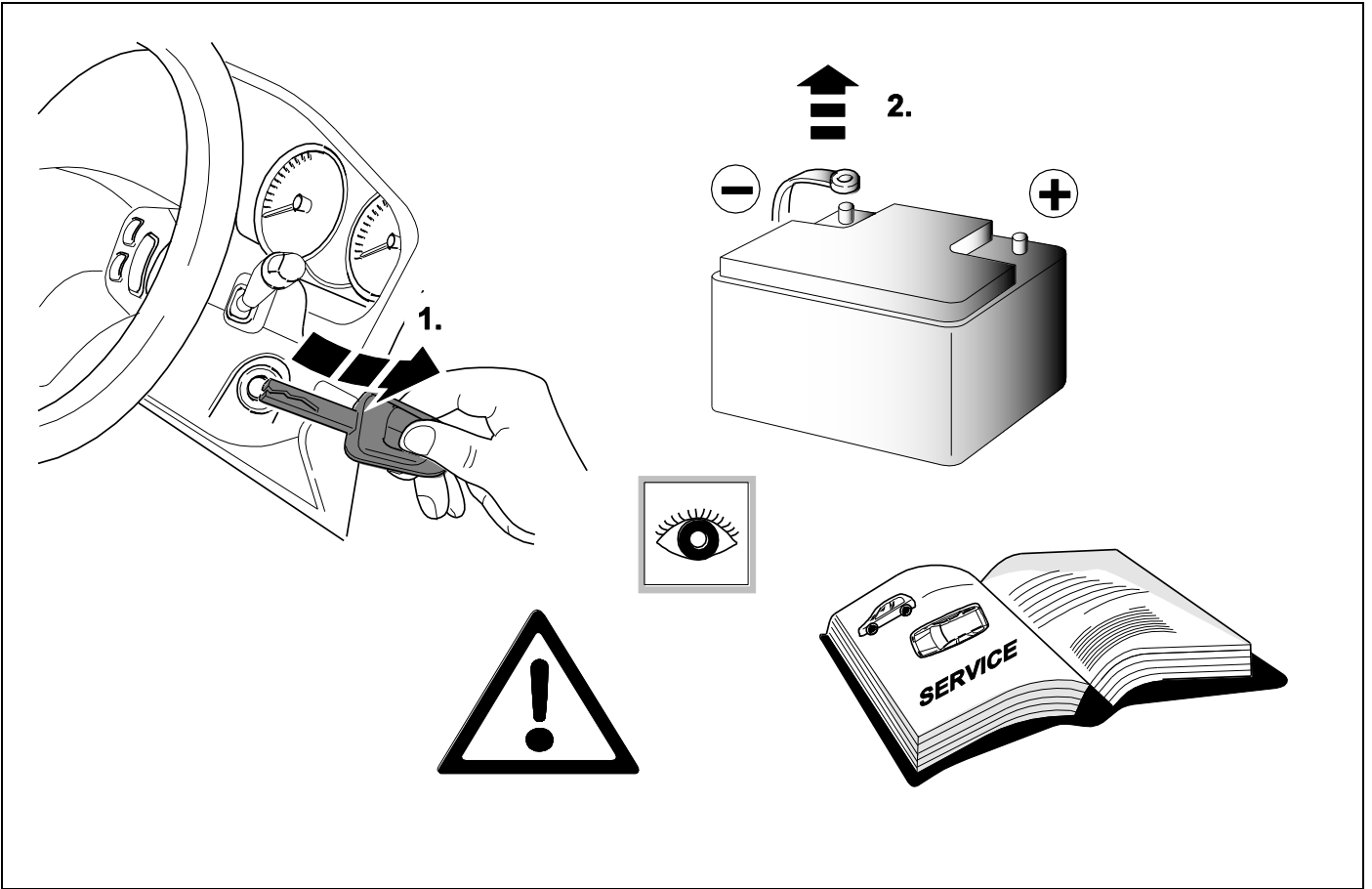

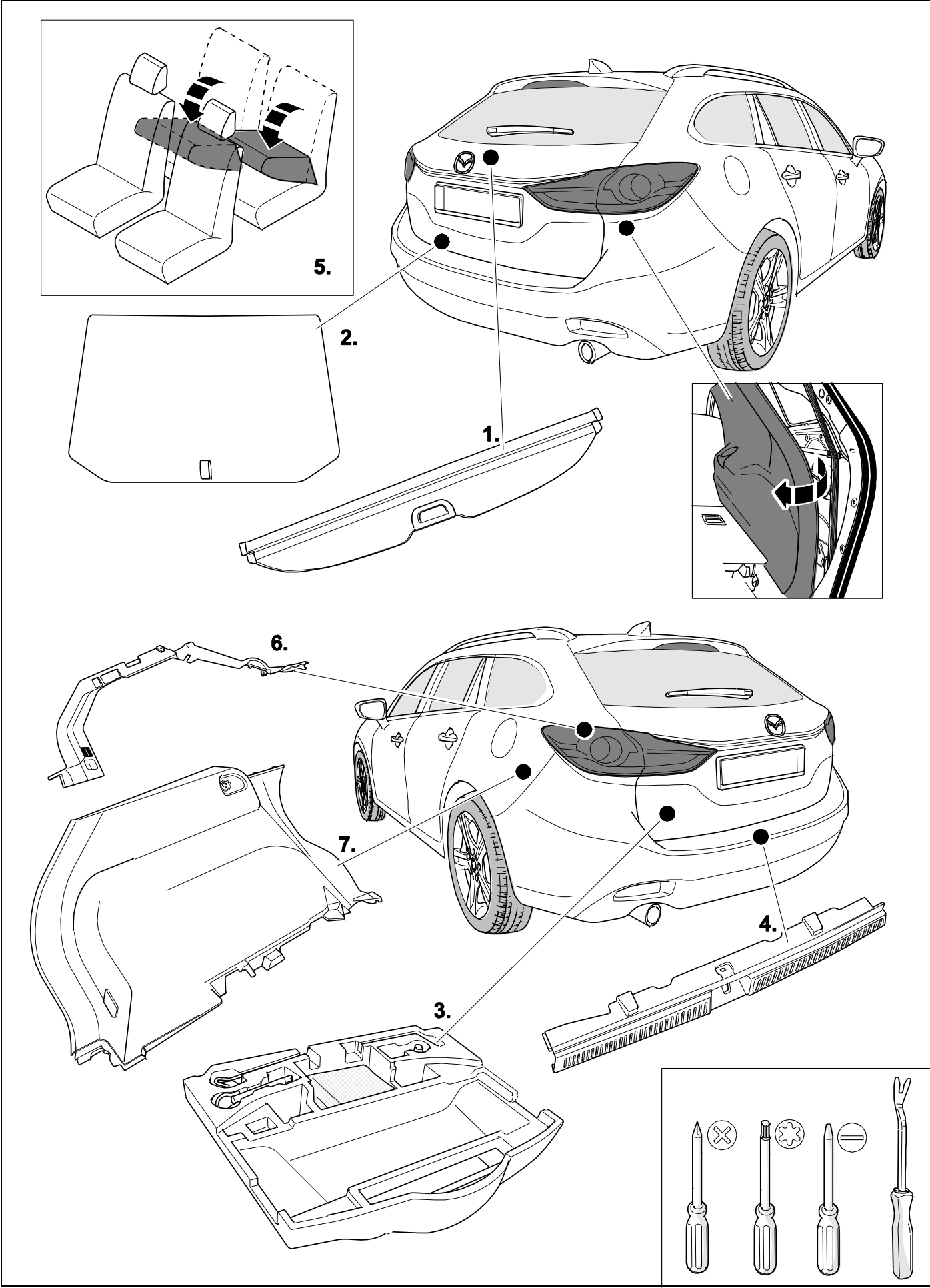

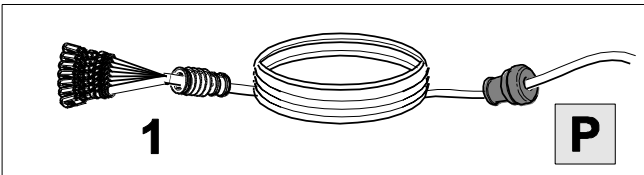
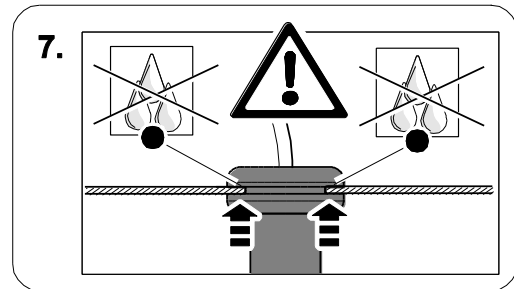
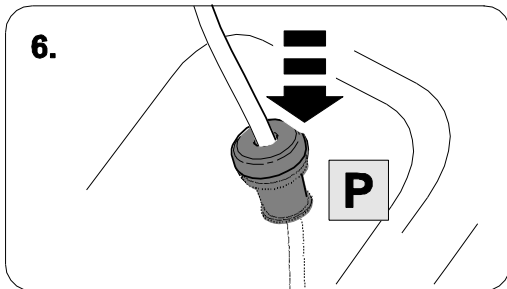
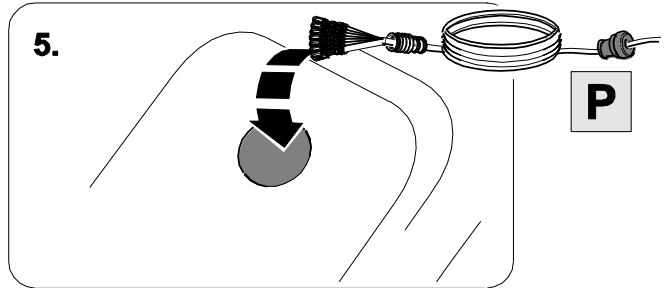
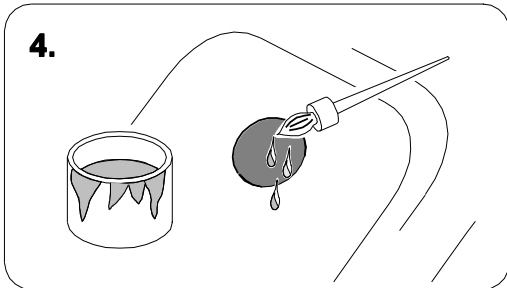
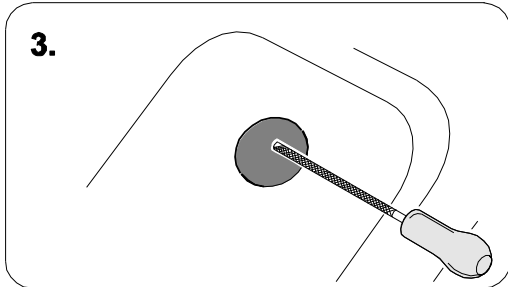
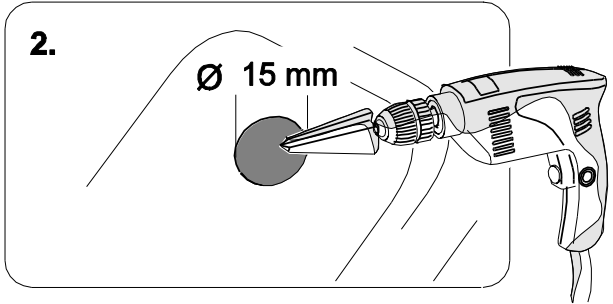
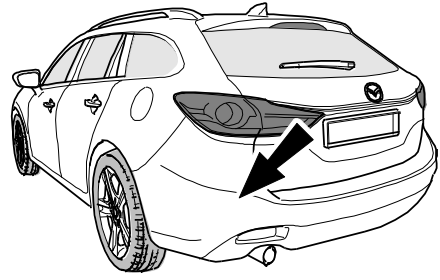
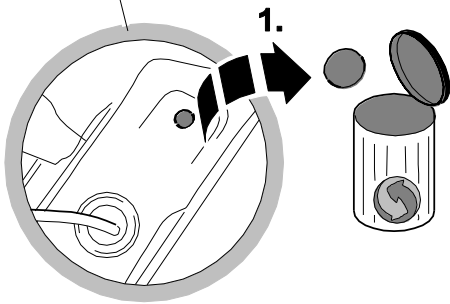
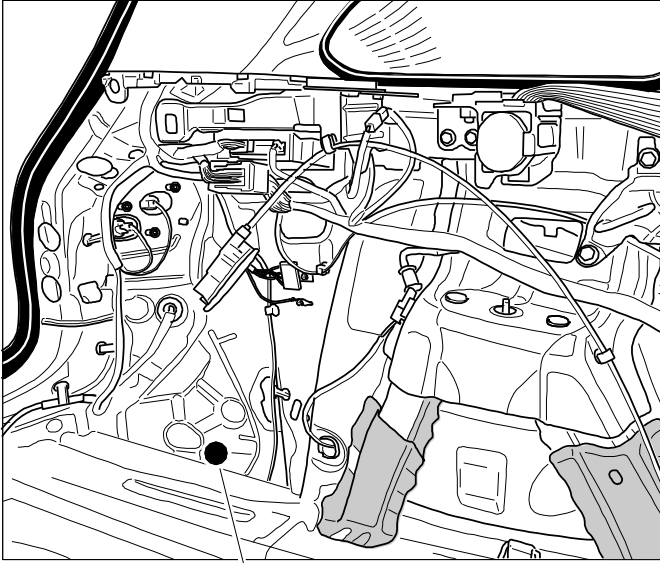



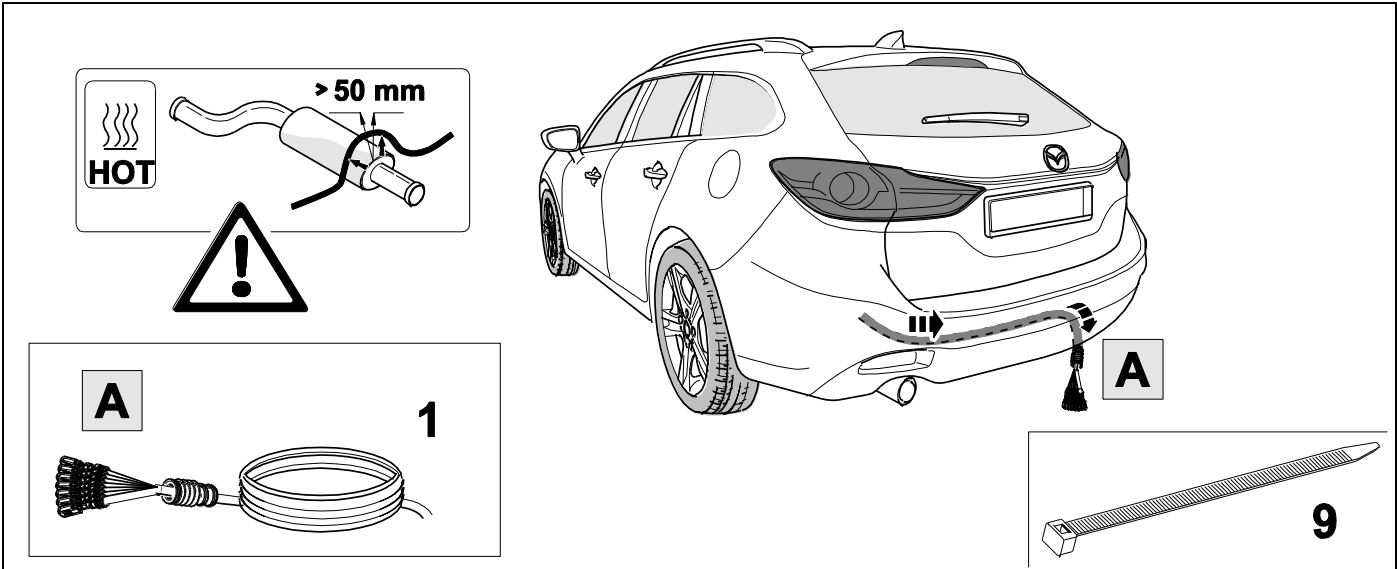

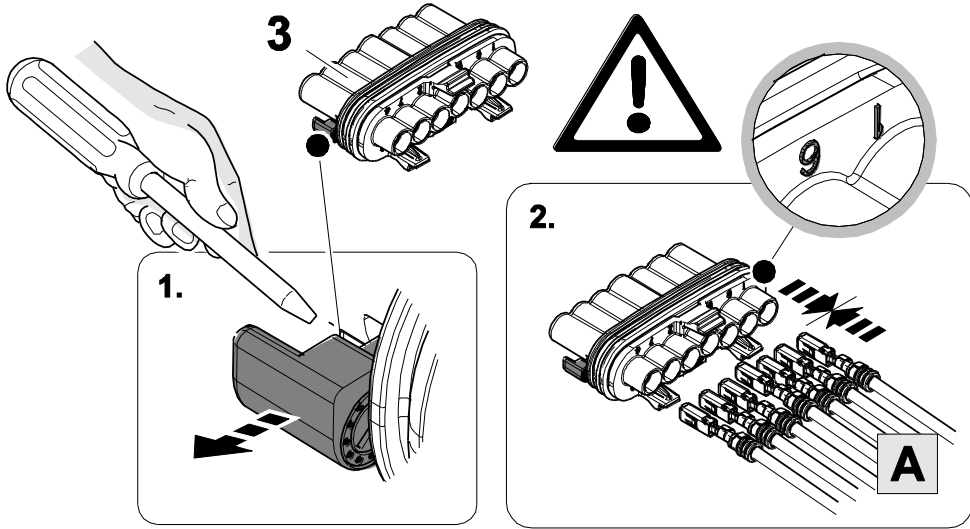

4

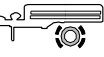



ye	1	
rd	6	
bu	5	
wh	3	
bk	2	
bn	7	
gn	4	

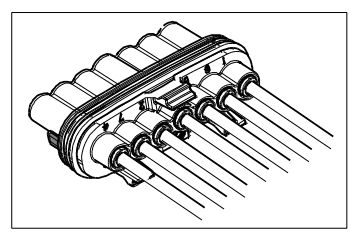
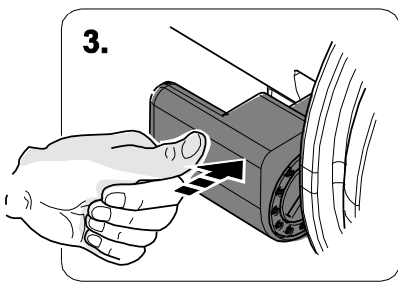
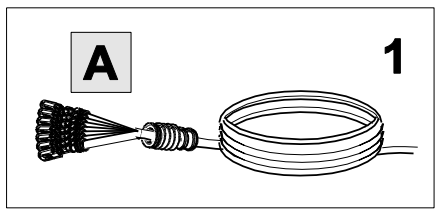

In case of wrong pin insert:

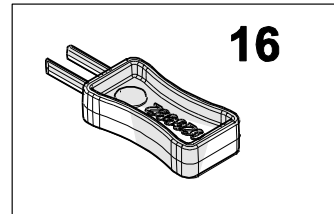
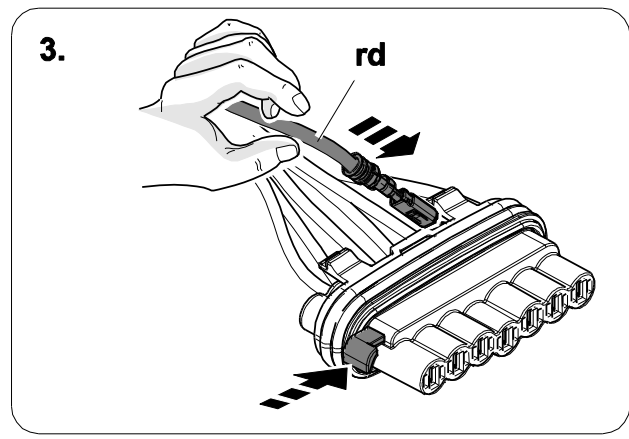
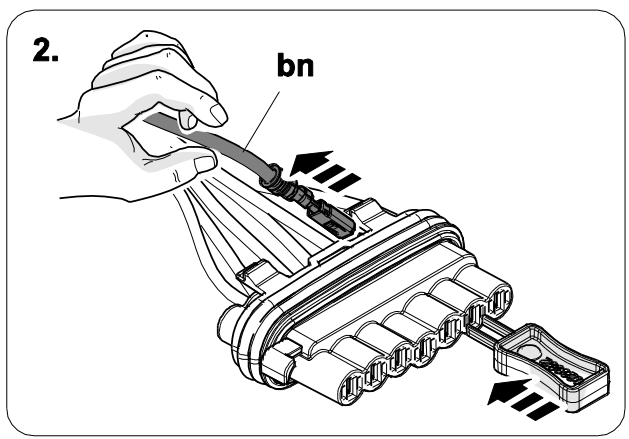
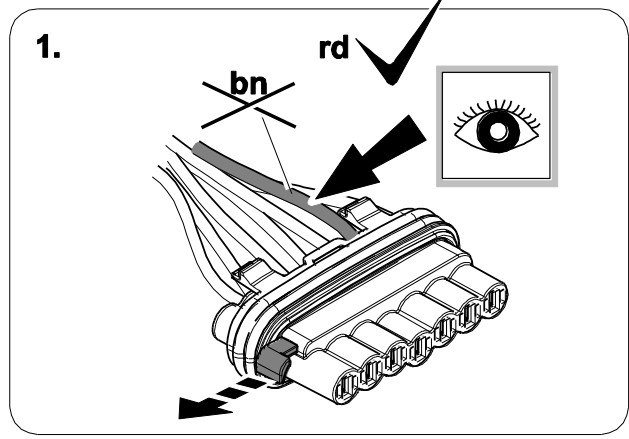

6

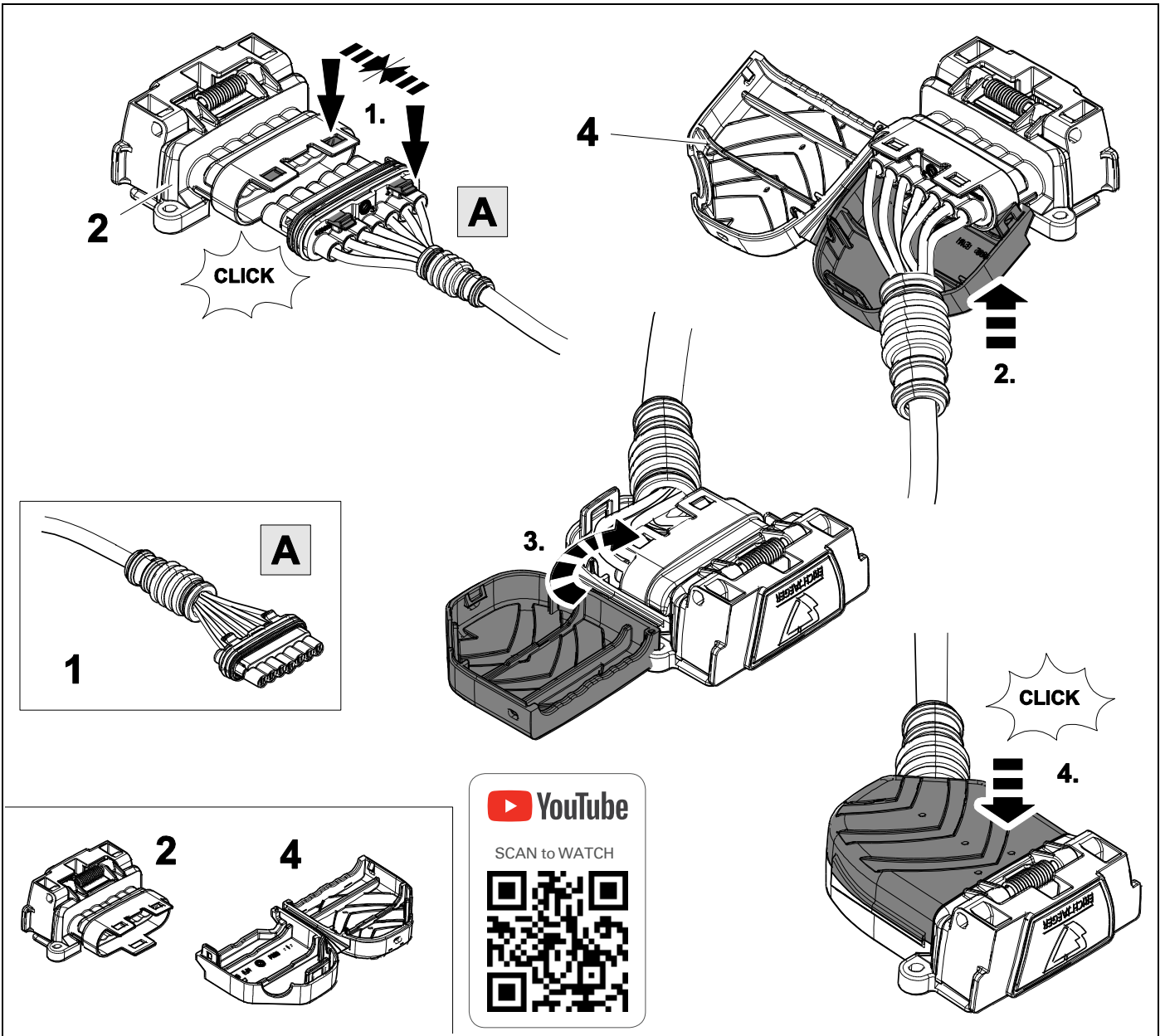

7

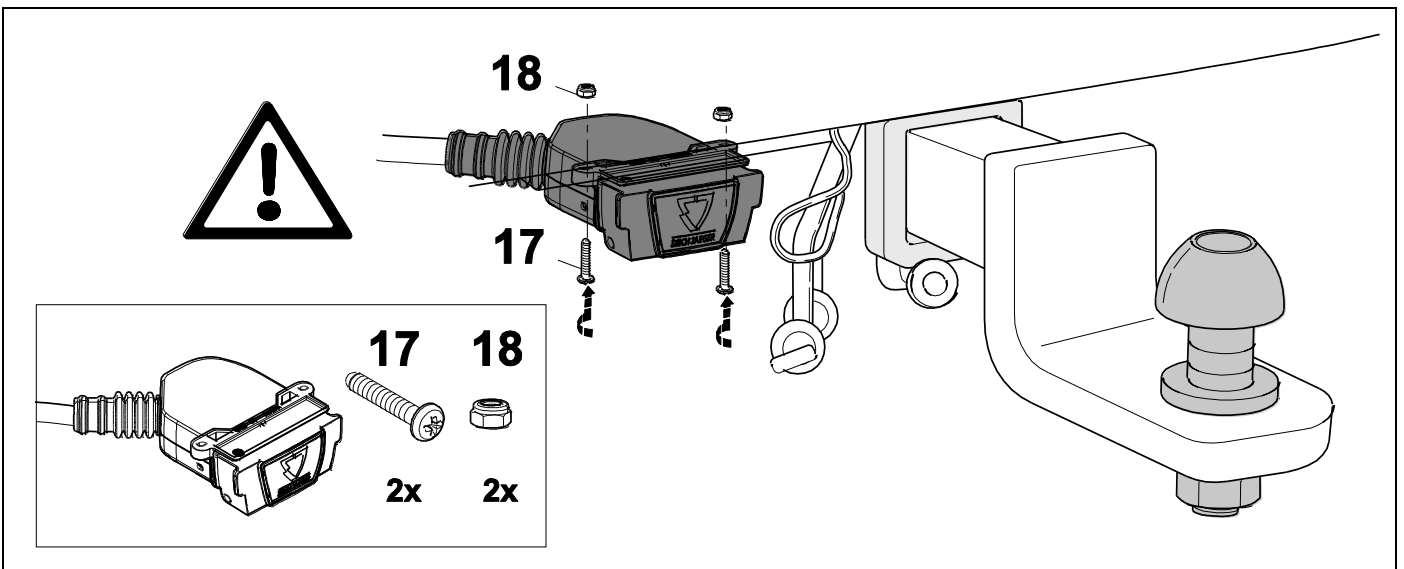

8



9

1	ye	
2	bk	
3	wh	
4	gn	
5	bu	
6	rd	
7	bn	

9	bk	wh	gy	gn	rd	bu	ye	bn	pu	or	no
---	----	----	----	----	----	----	----	----	----	----	----

	black	white	grey	green	red	blue	yellow	brown	purple	orange	not occupied
--	-------	-------	------	-------	-----	------	--------	-------	--------	--------	--------------

10

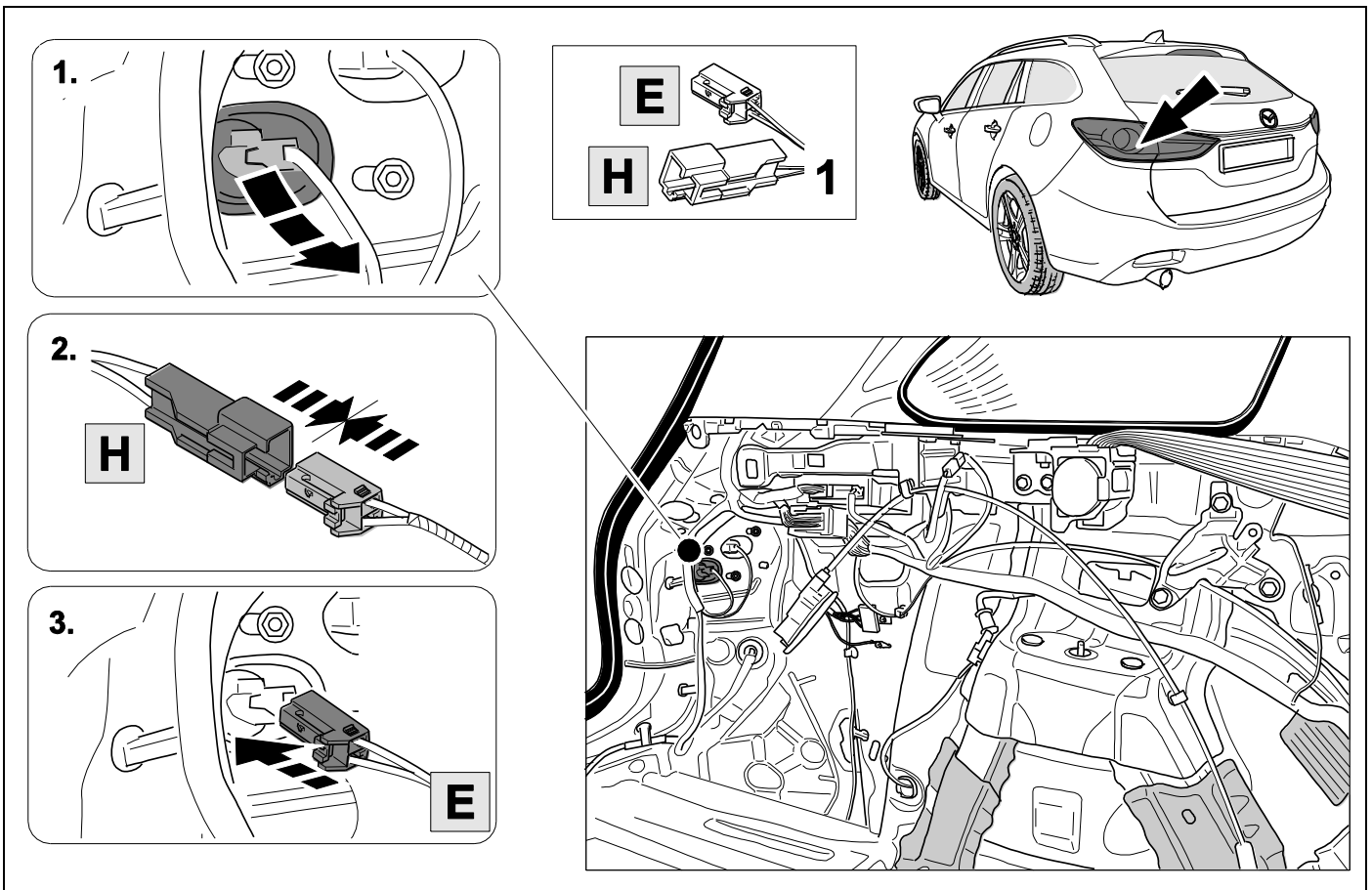

11

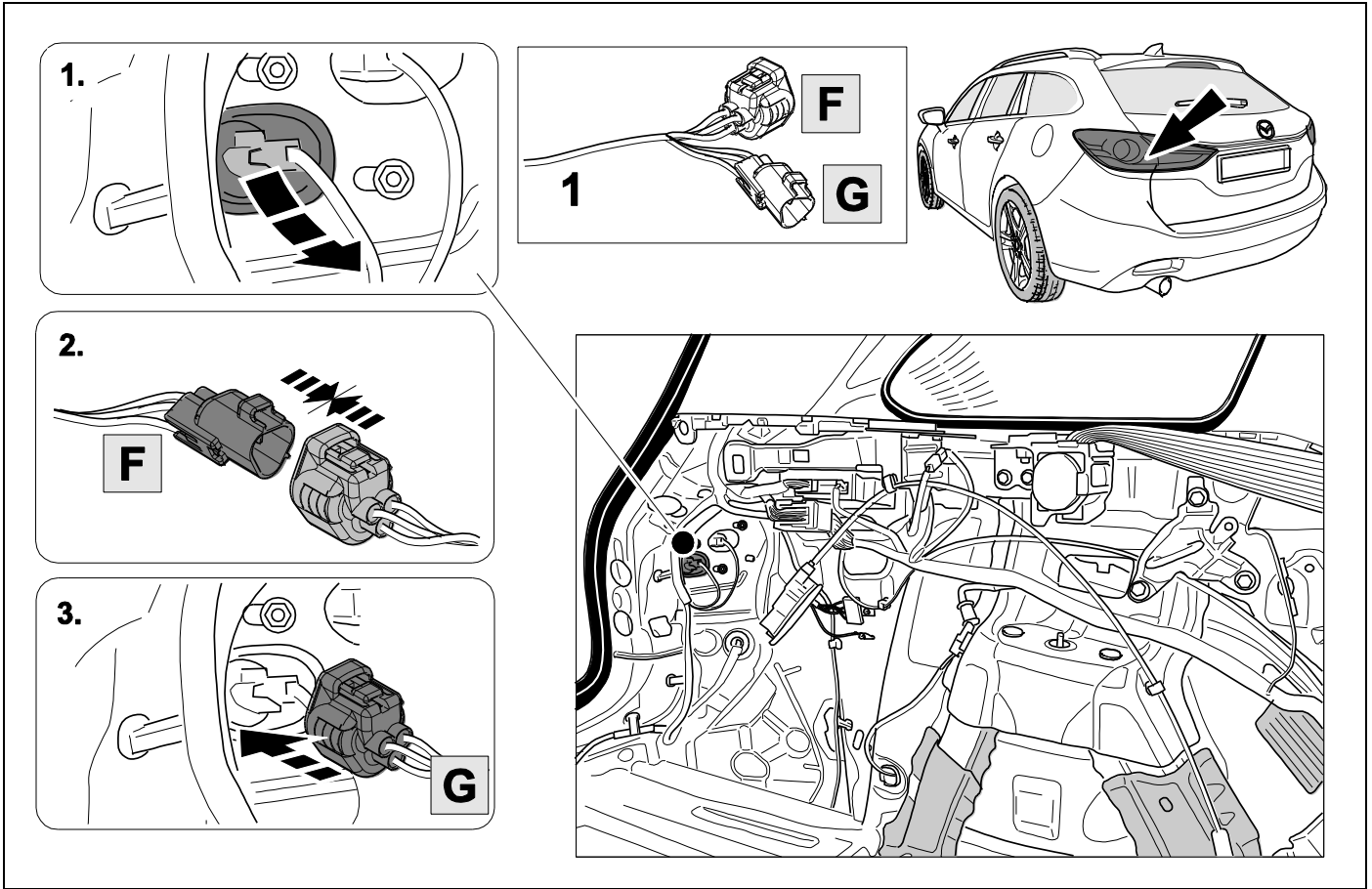

12

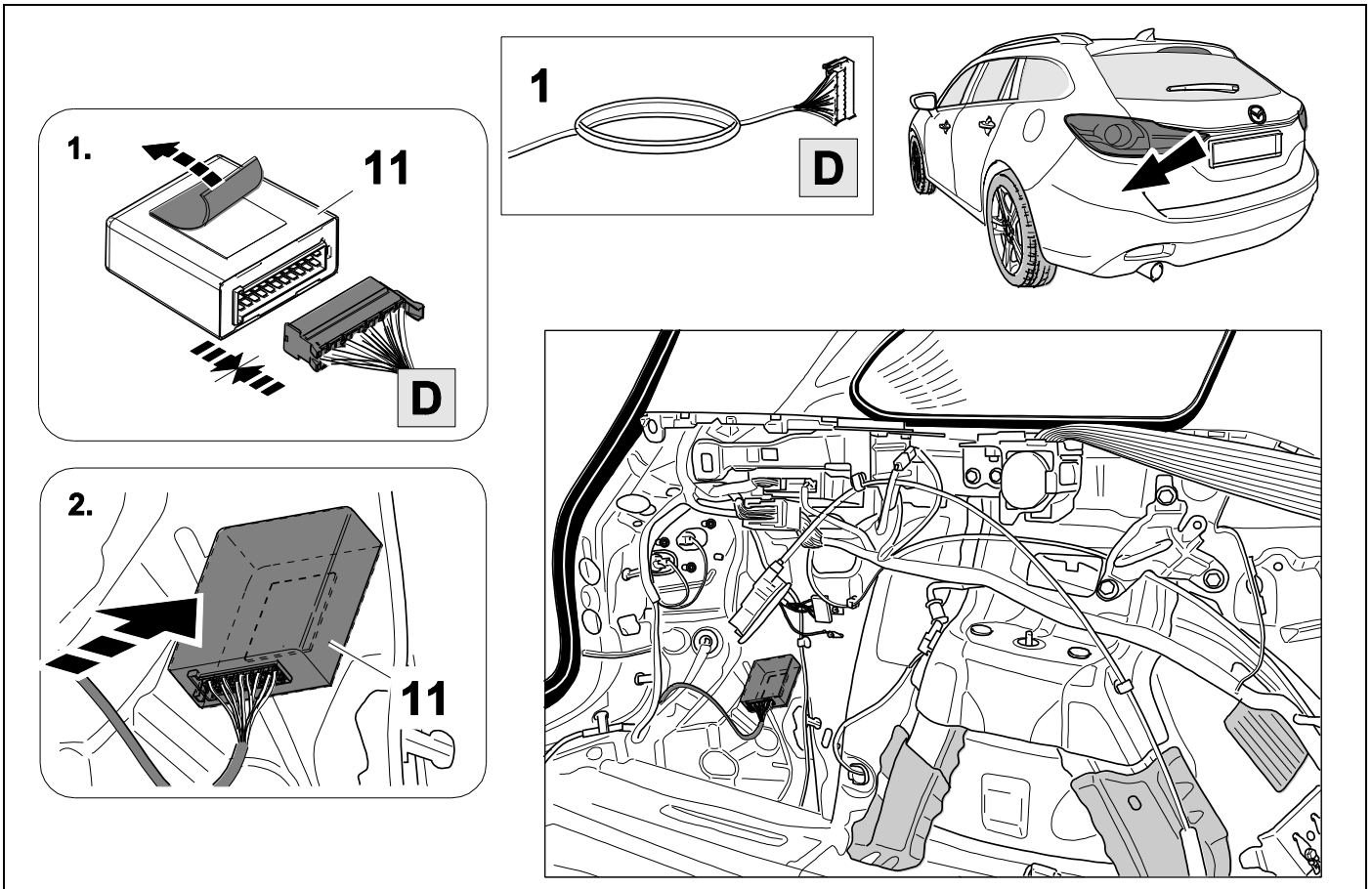

13

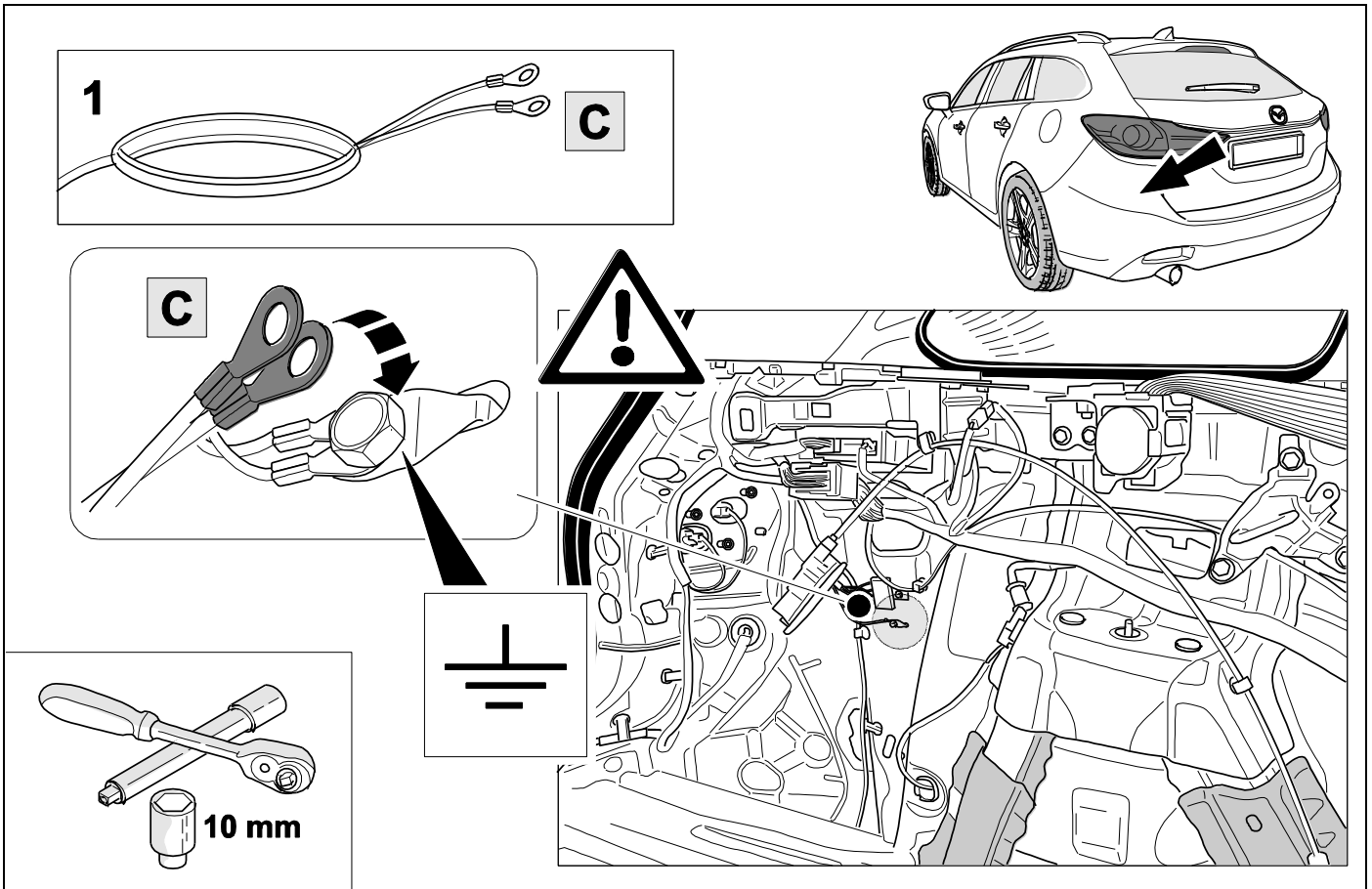

14

👁️ ⇒ 9

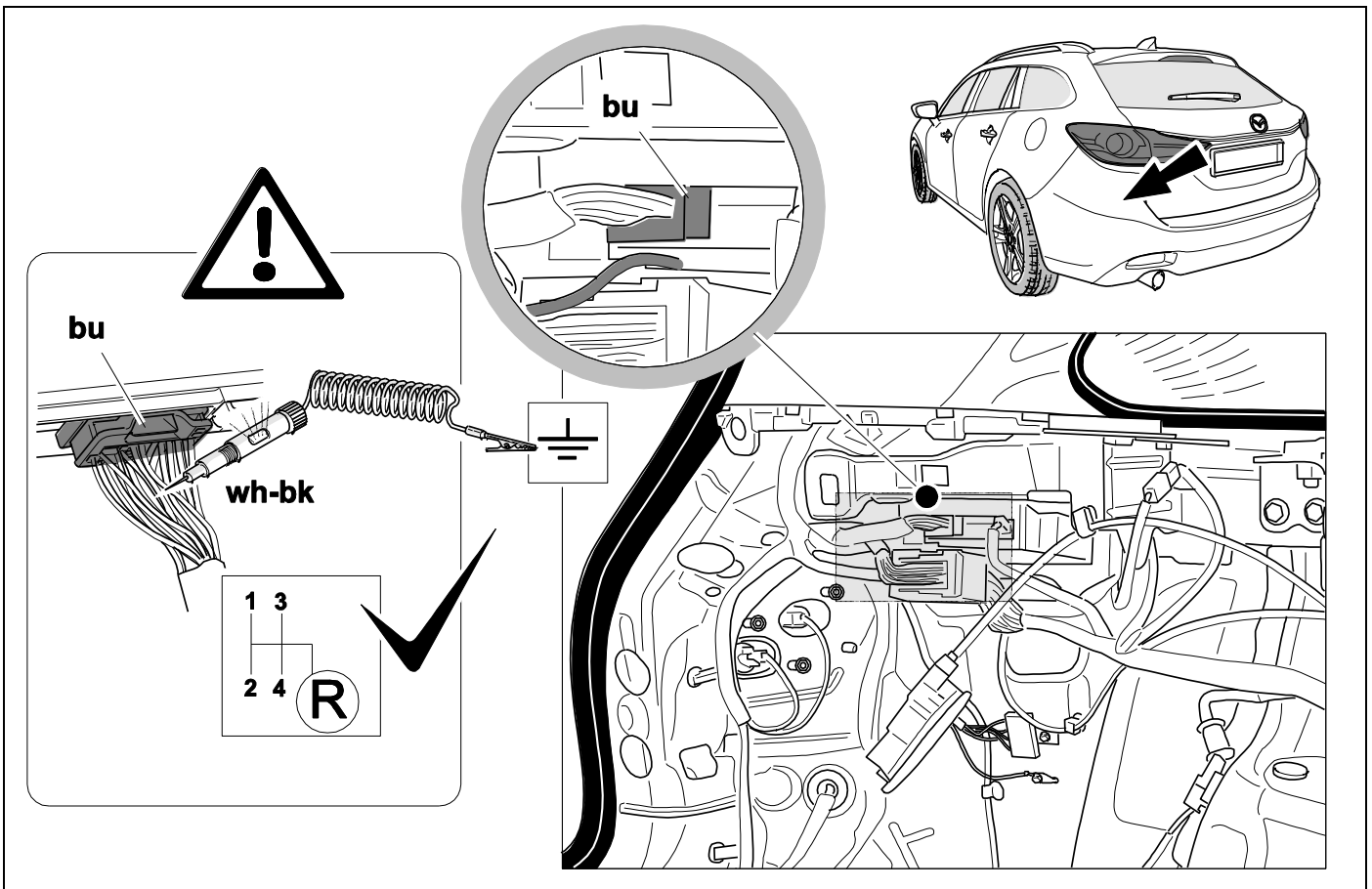

15



9

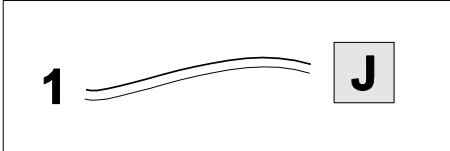
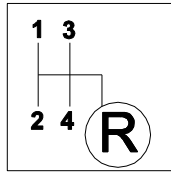
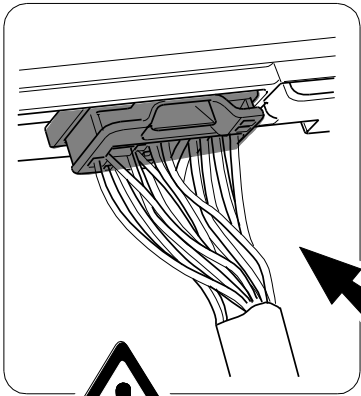

wh-bk

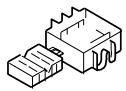
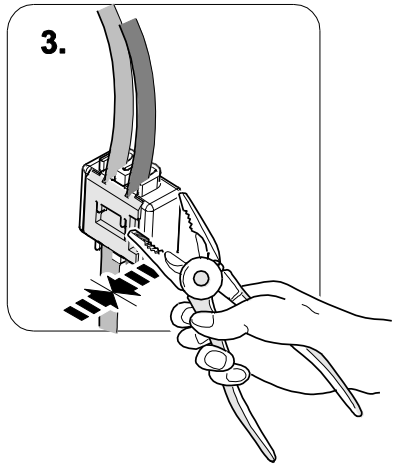
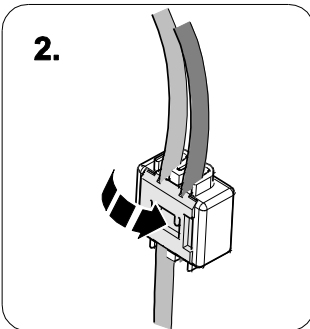
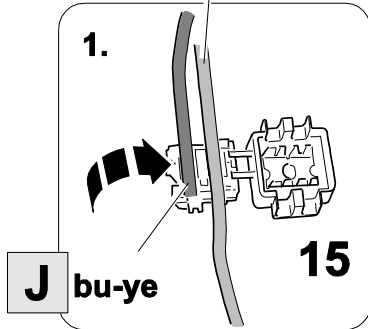

15

16

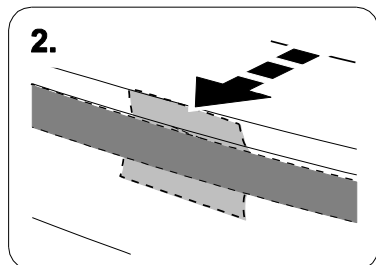
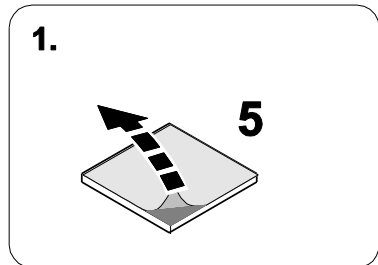
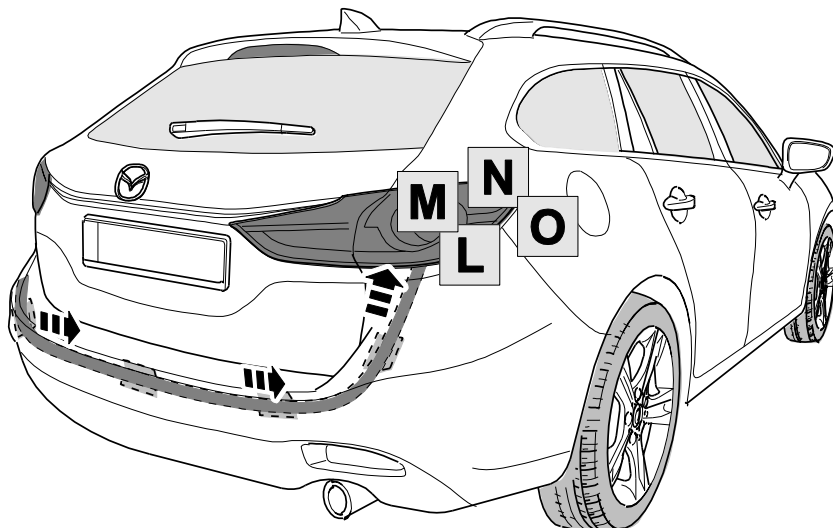
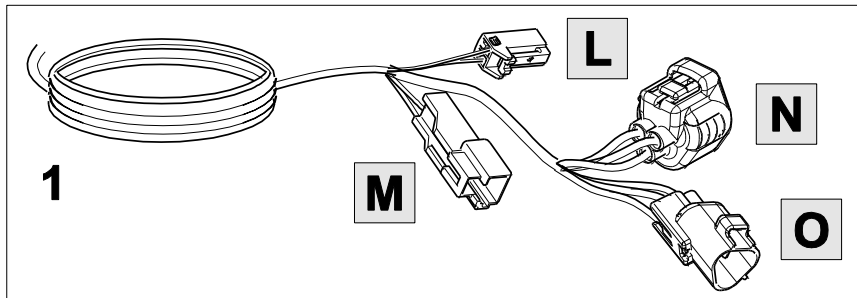

17

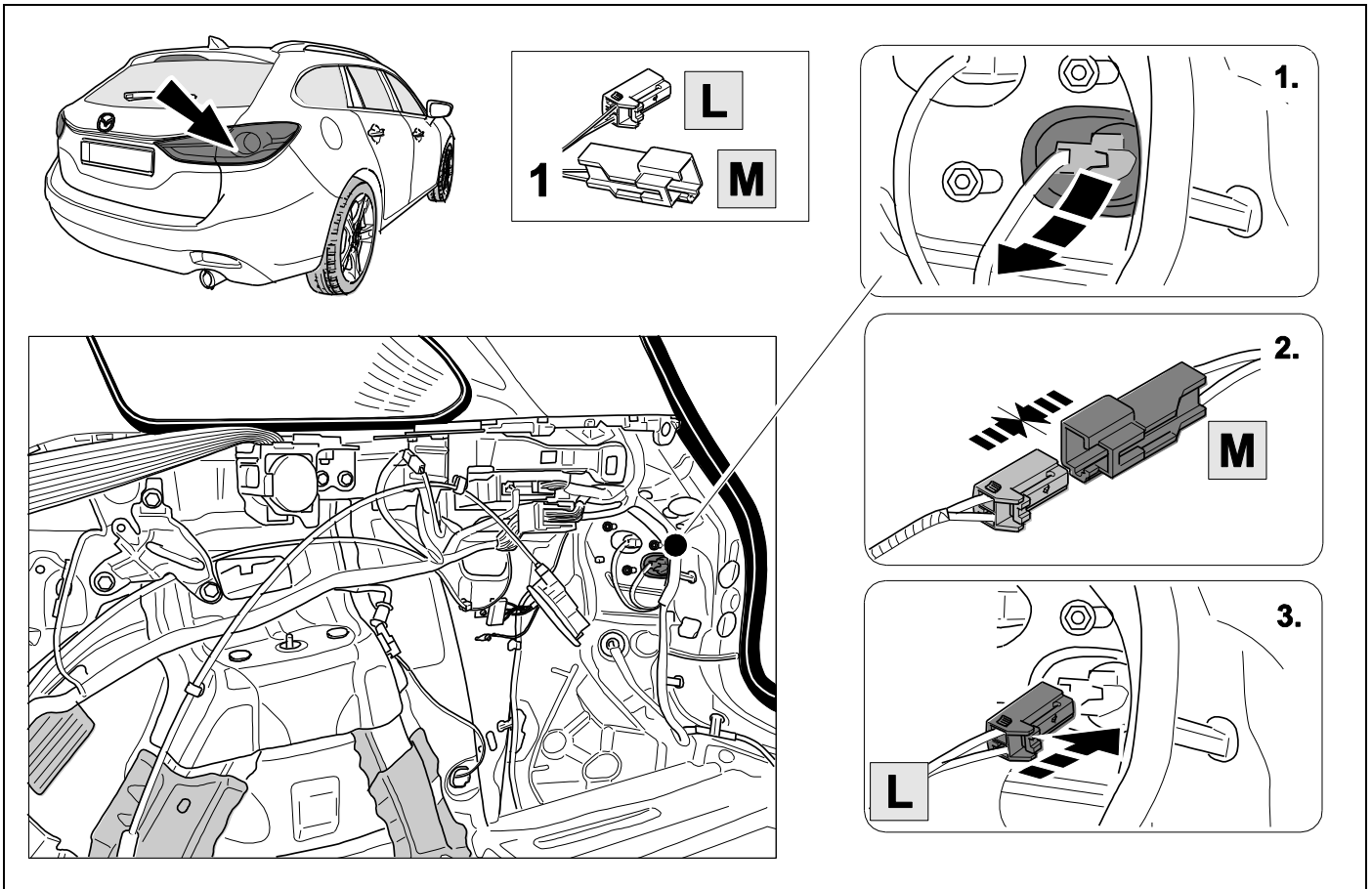

18

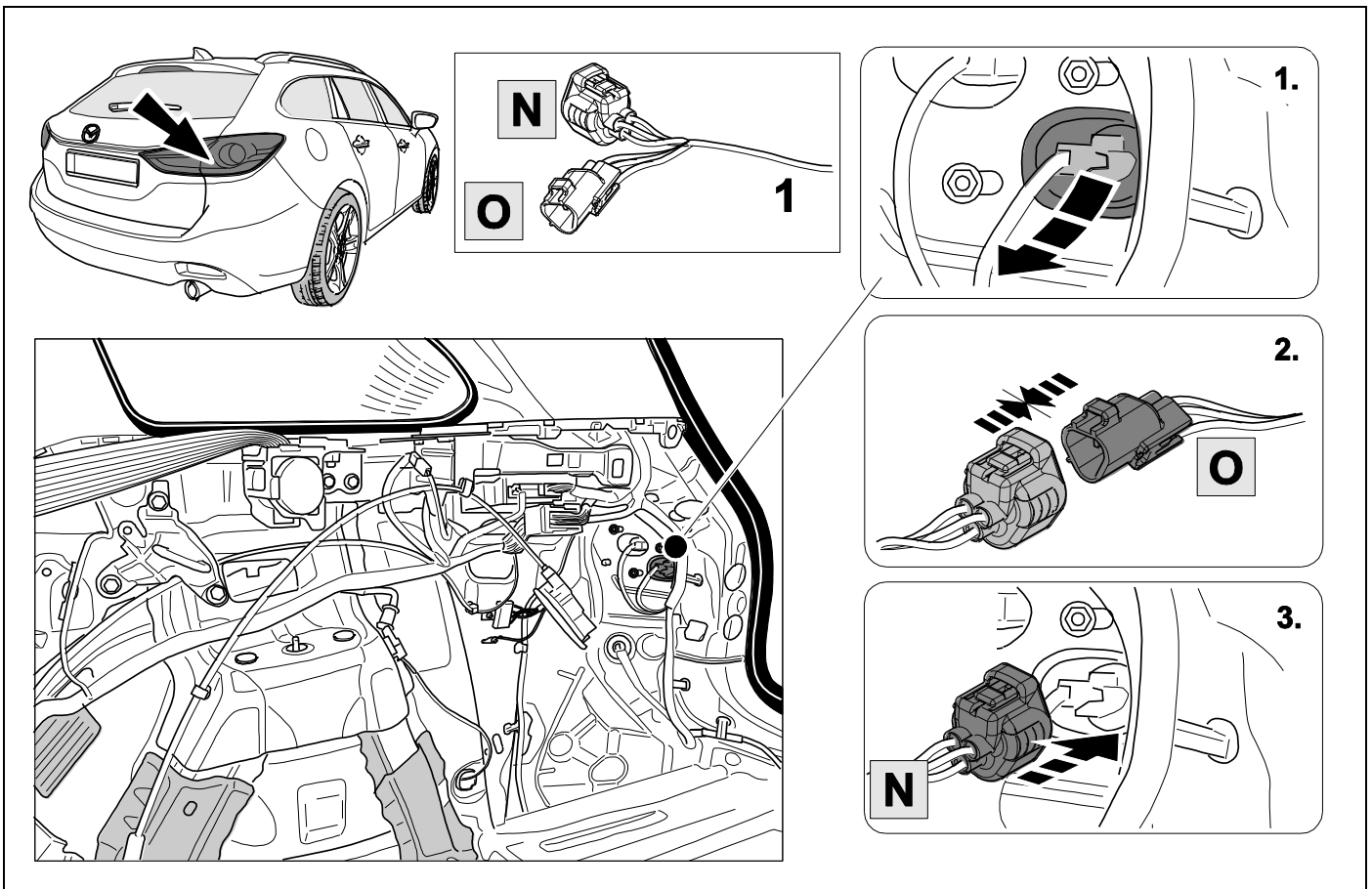

19

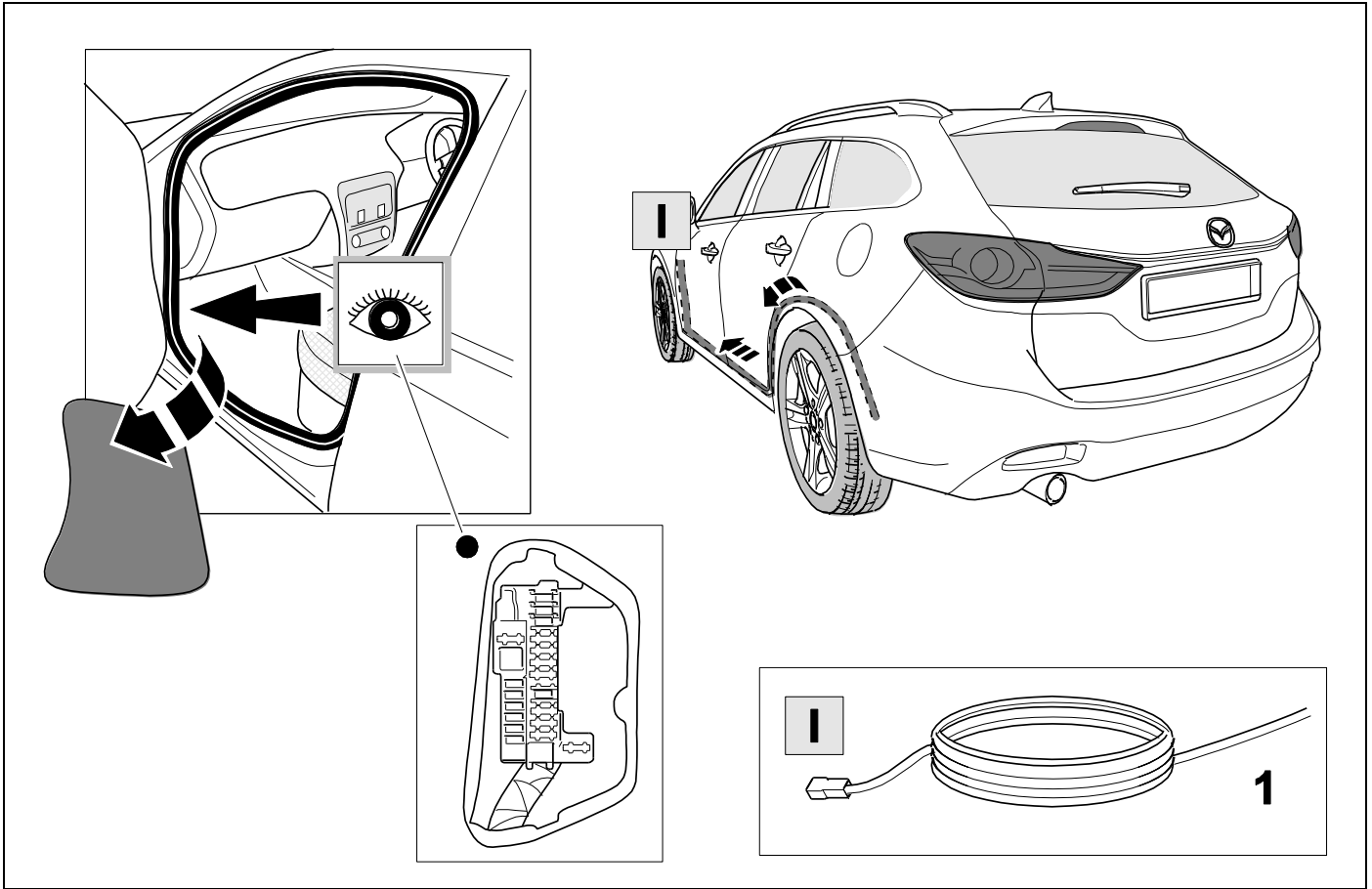

20



44

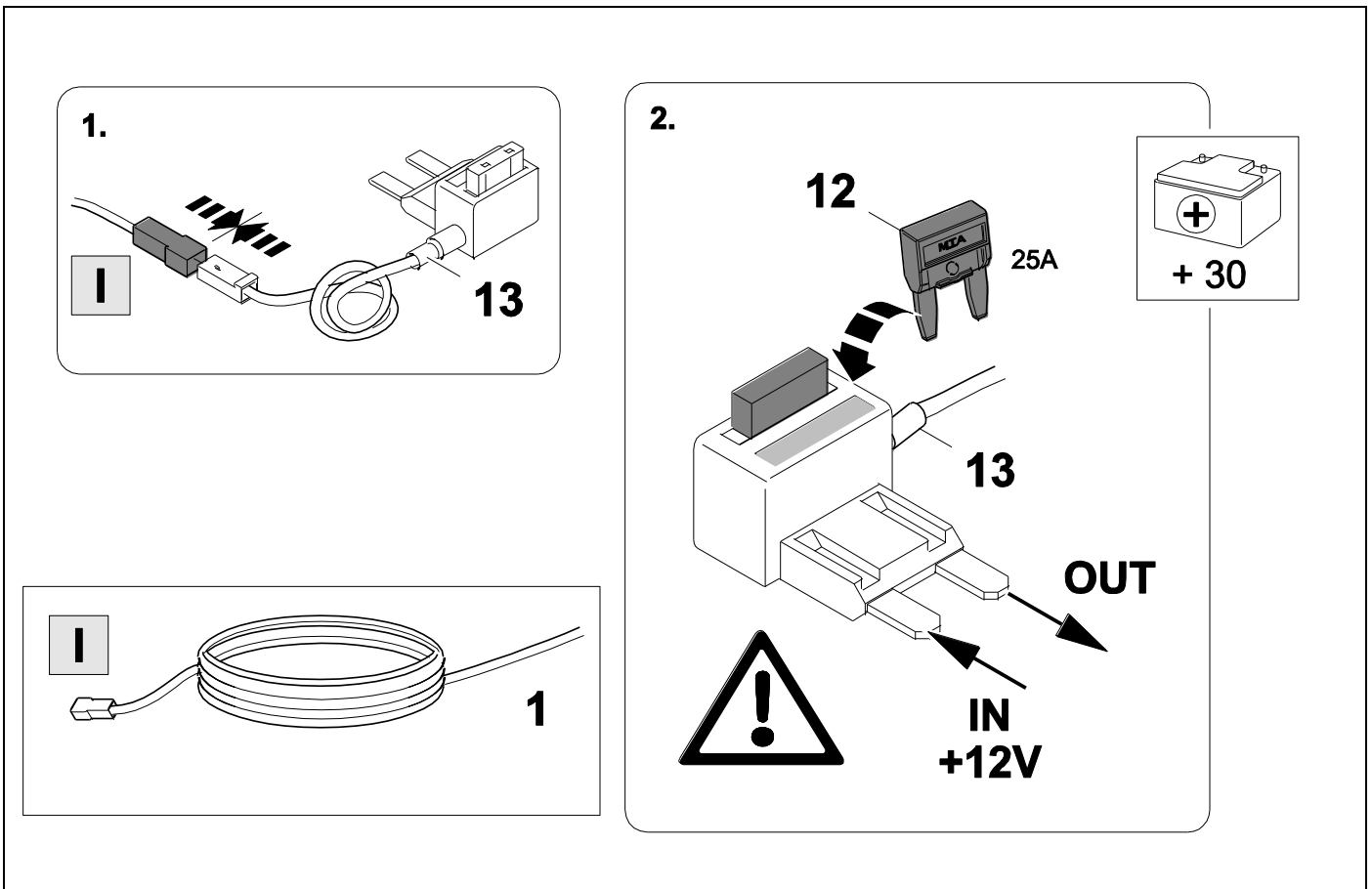

21



44

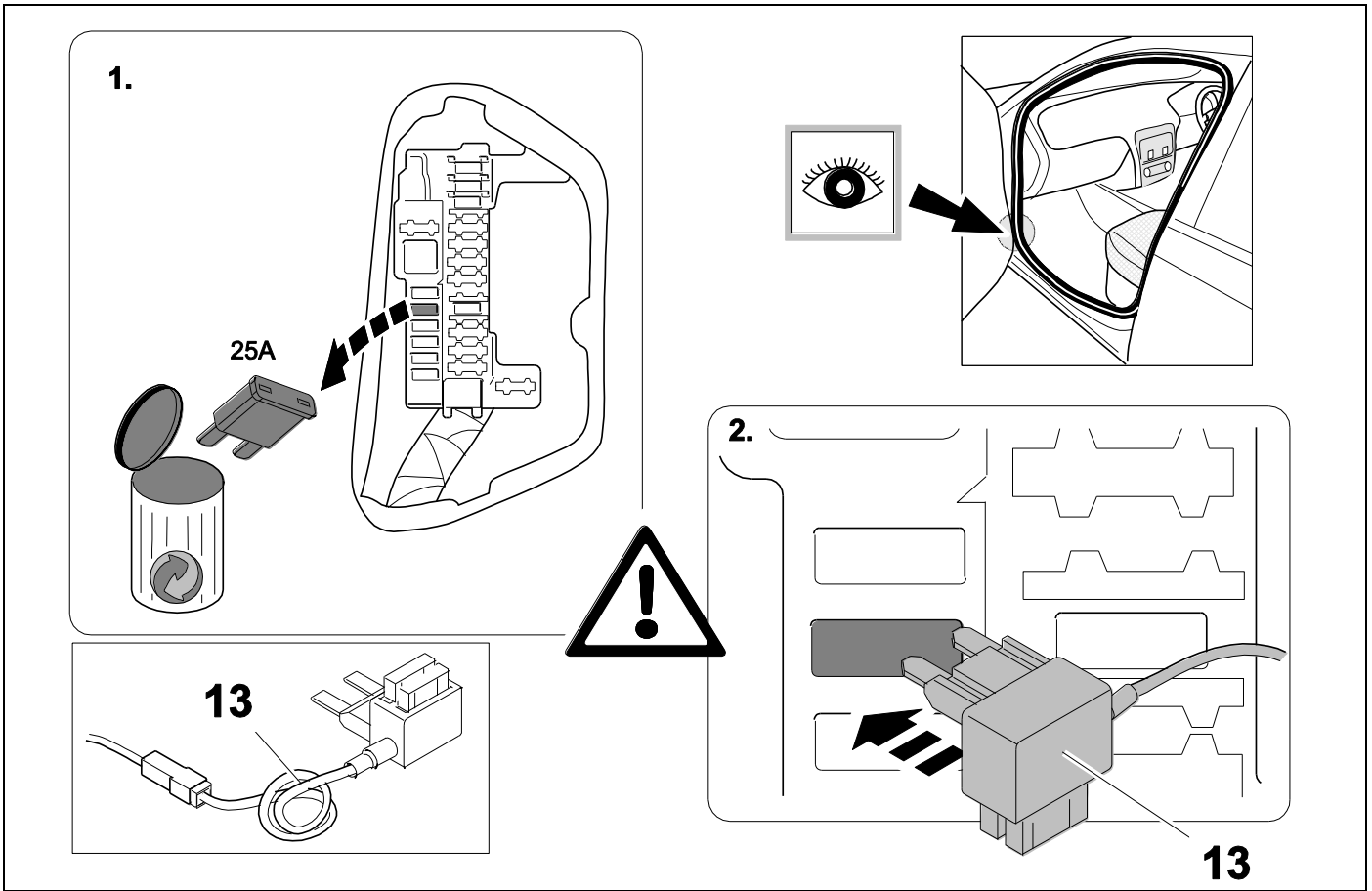

22 ALTERNATIV STEPS BY MODEL RANGE

ALTERNATIVE A MAZDA 6 GJ 02/13 > 08/16

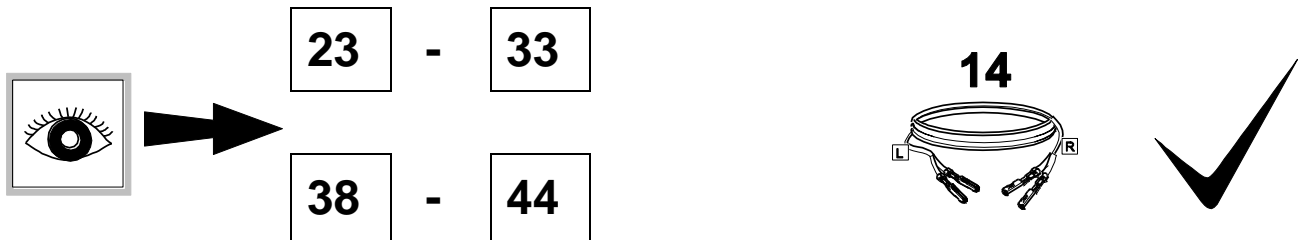

ALTERNATIVE B MAZDA 6 GL 09/16 >>

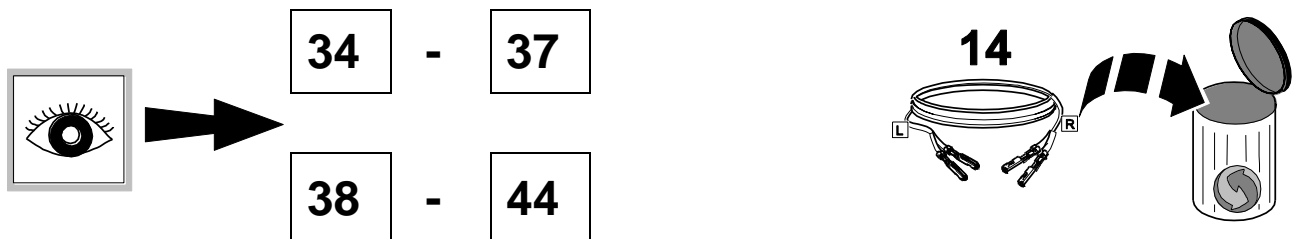

23 Without PDC

GJ MODEL OPTION 1

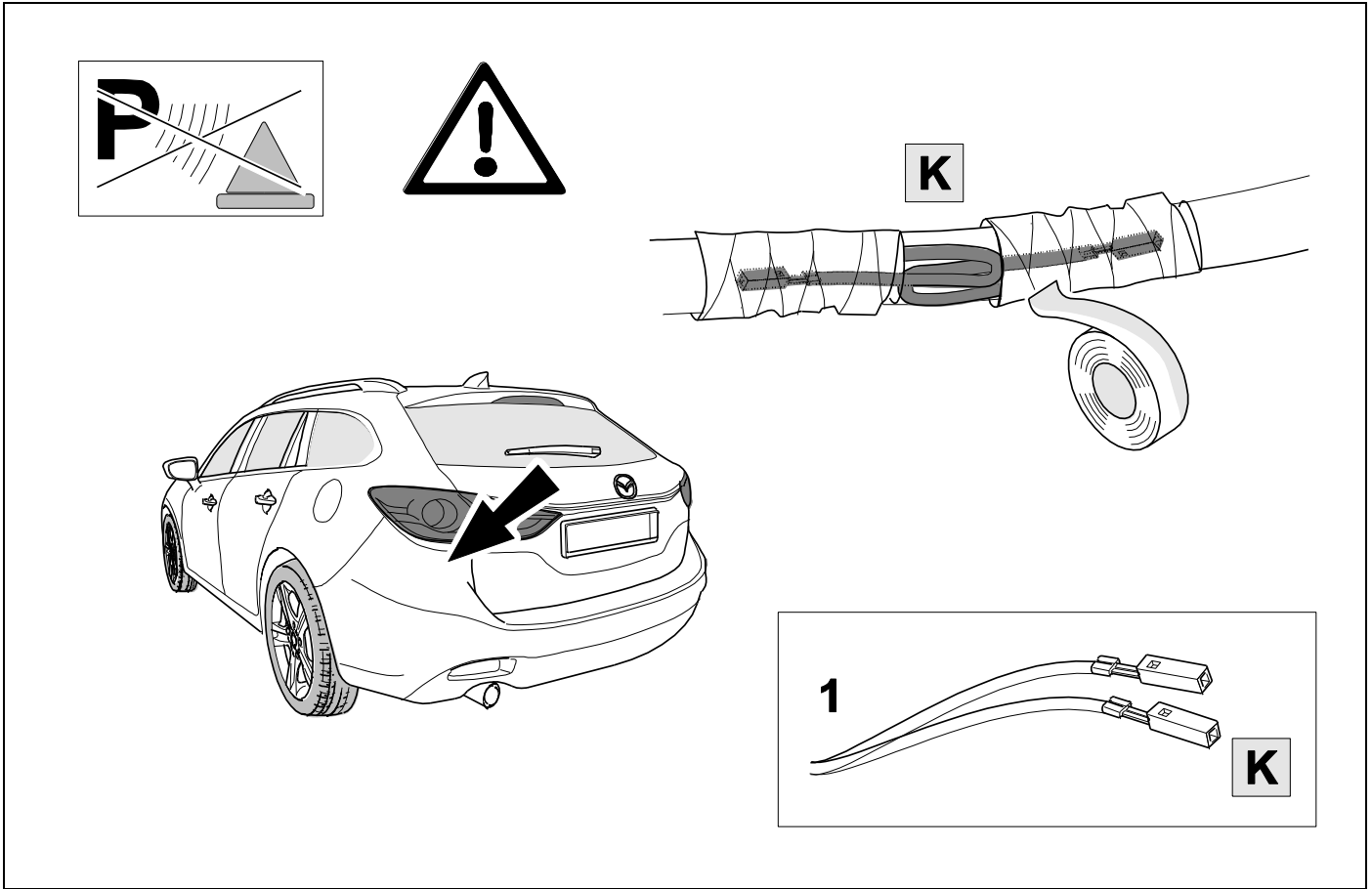

24 Without SCBS-R

GJ MODEL OPTION 2

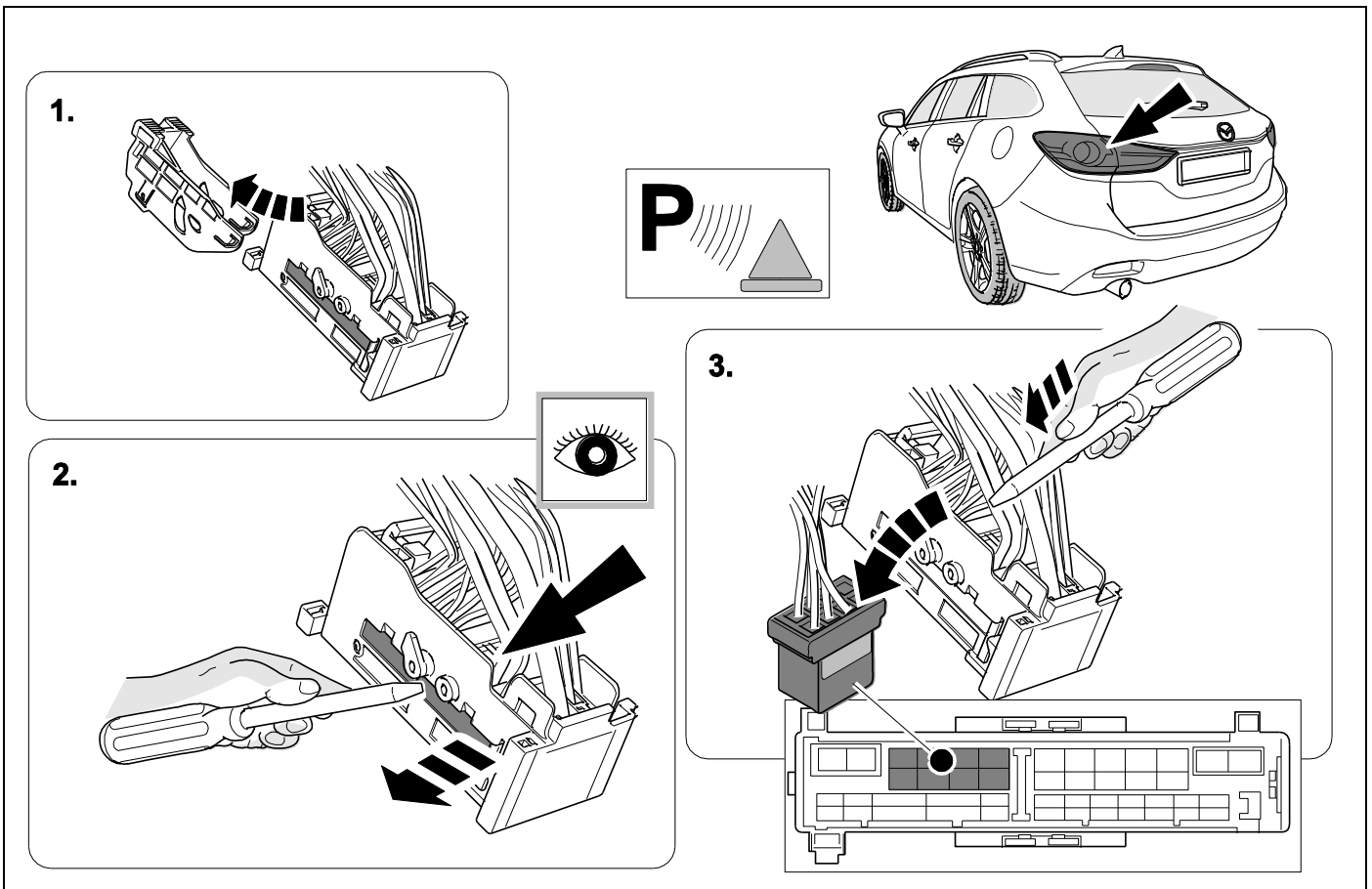

25 Without SCBS-R

GJ MODEL OPTION 2

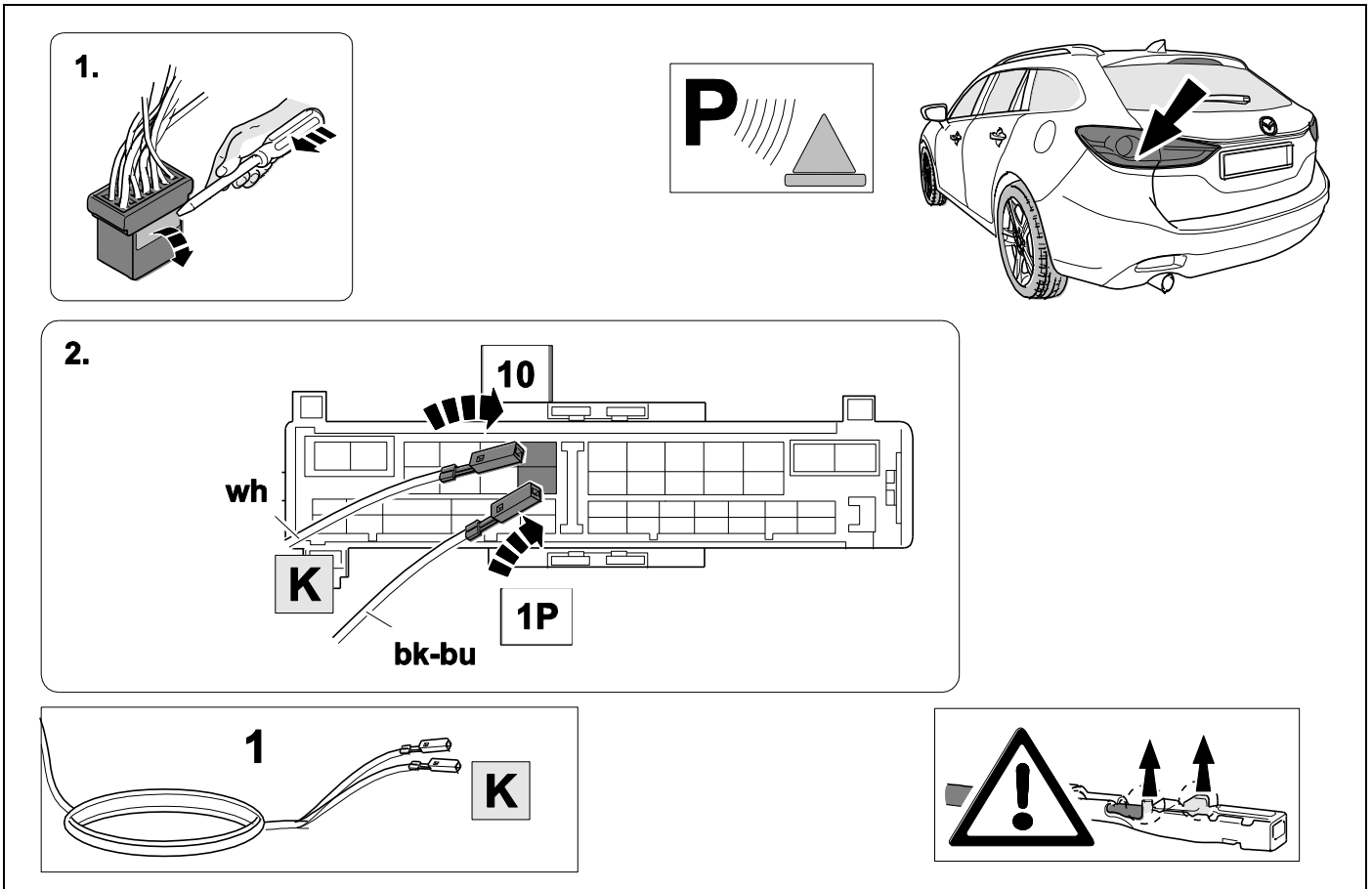

26 Without SCBS-R

GJ MODEL OPTION 2

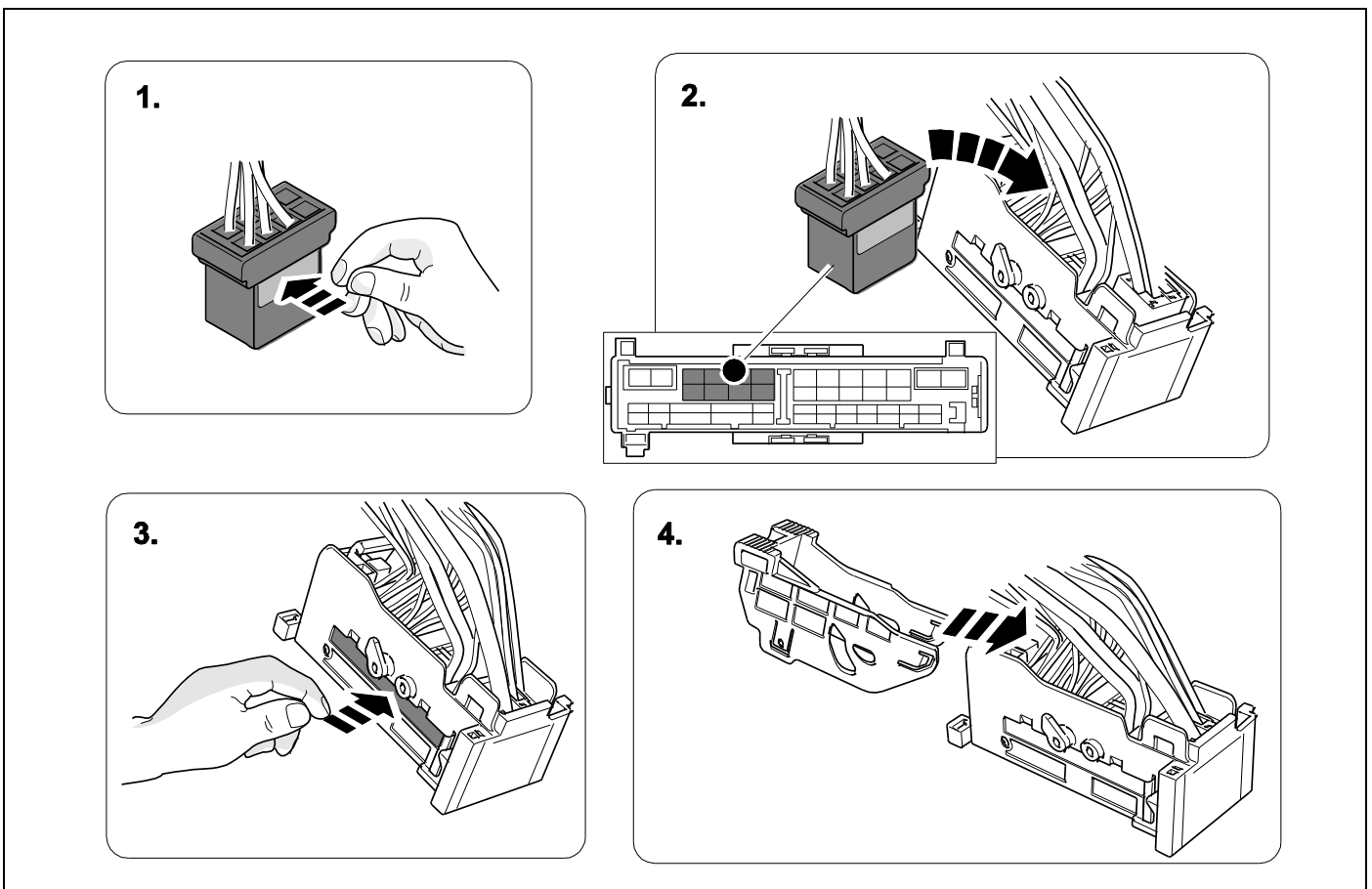

27 With SCBS-R

GJ MODEL OPTION 3

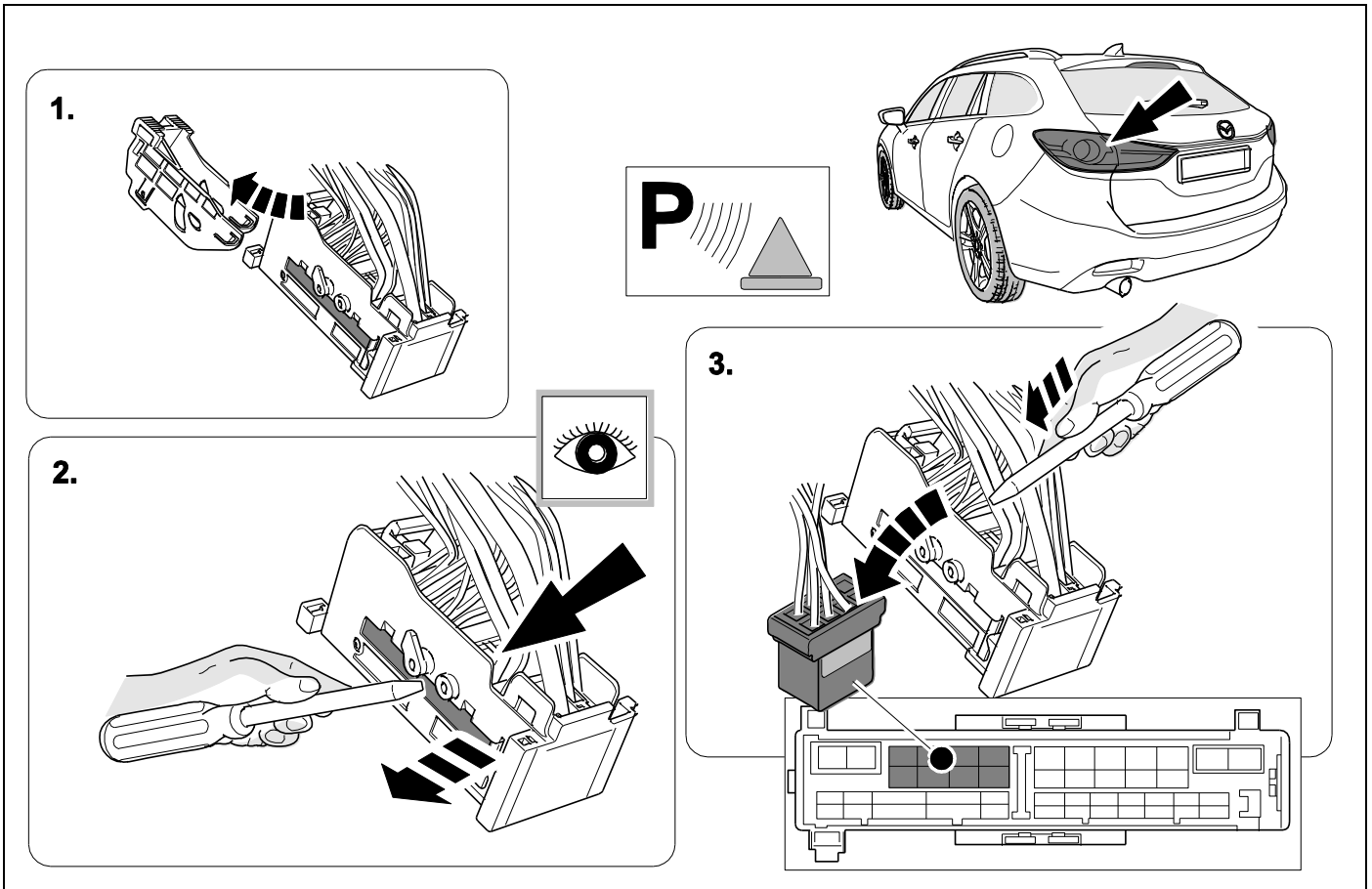

28 With SCBS-R

GJ MODEL OPTION 3

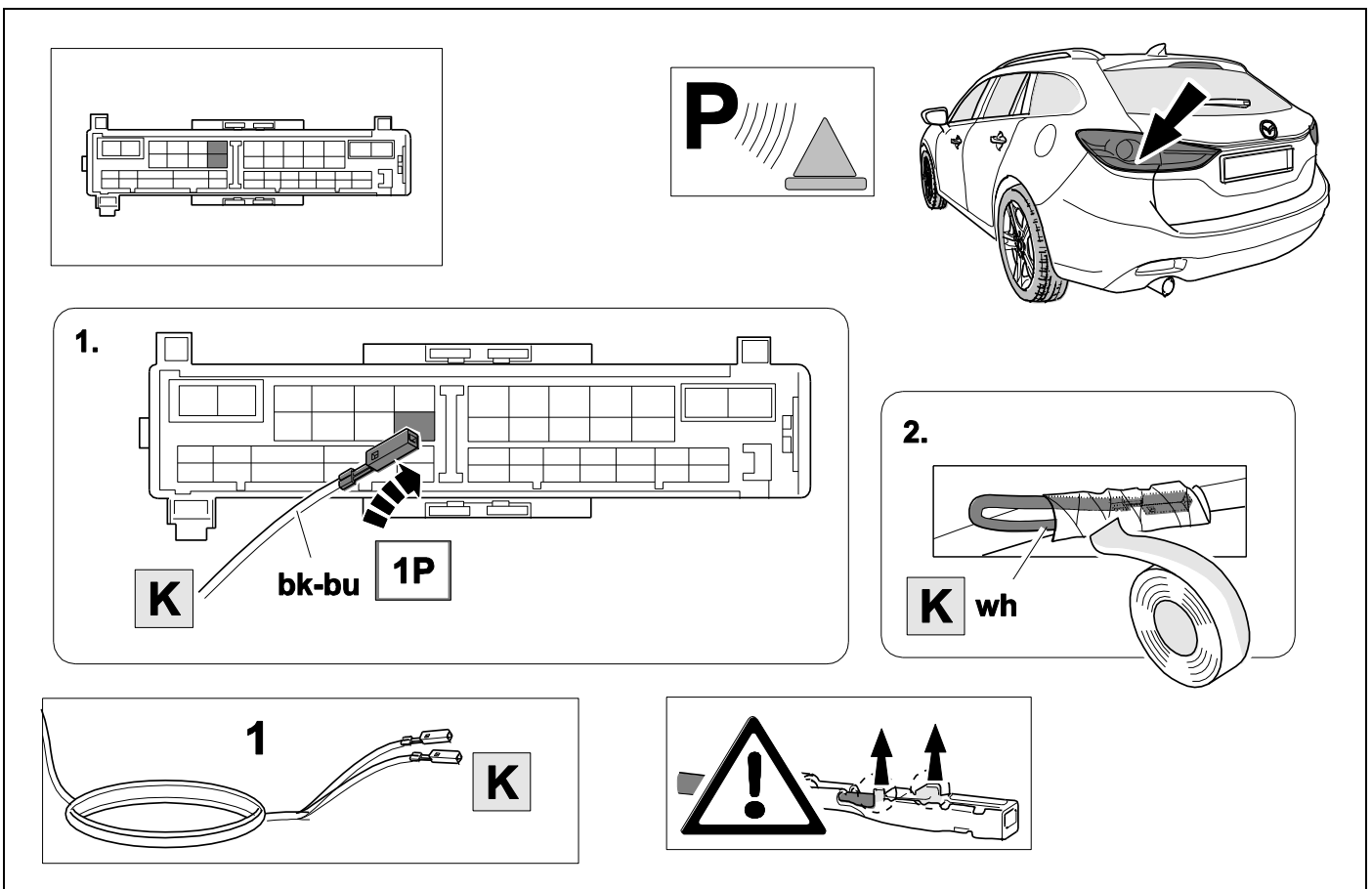

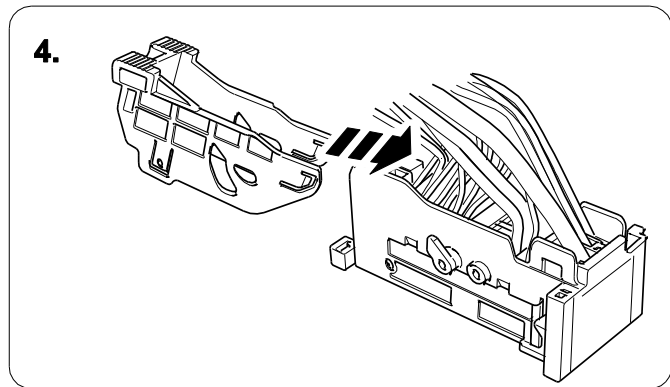
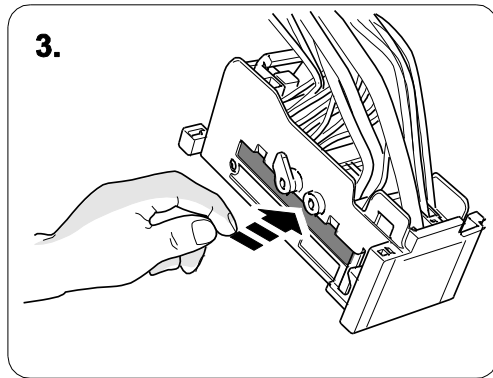
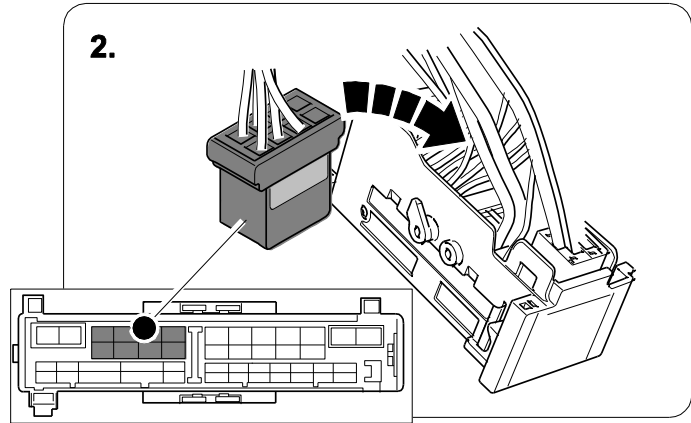
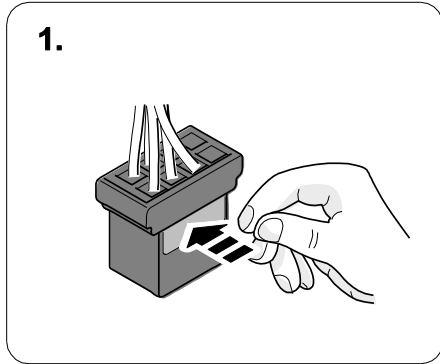

Disconnect the white 28 pin connector from the PDC Control Unit

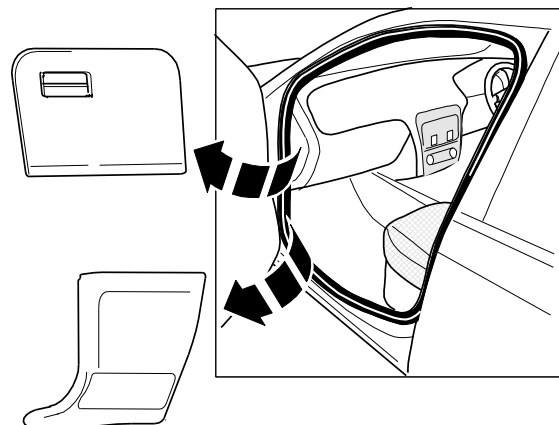
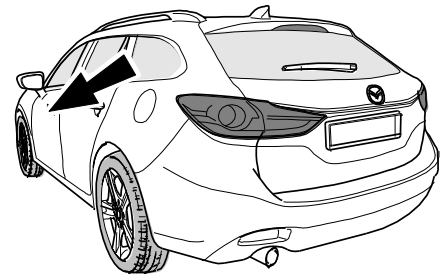
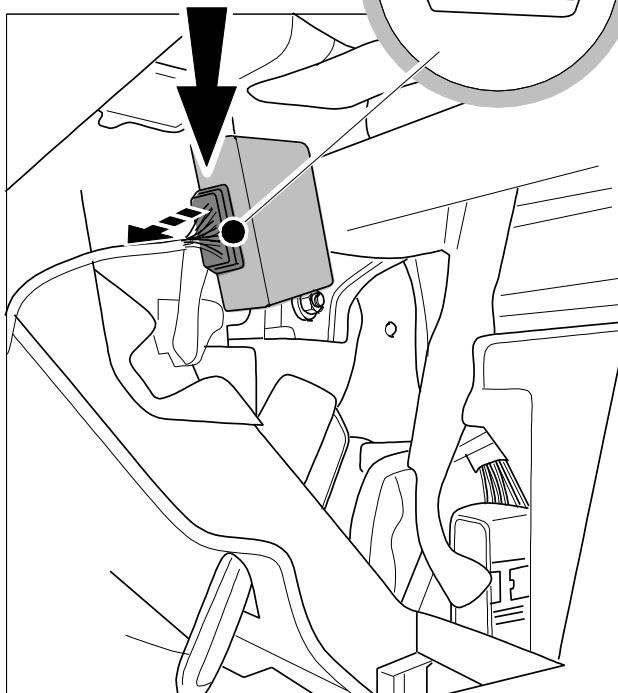
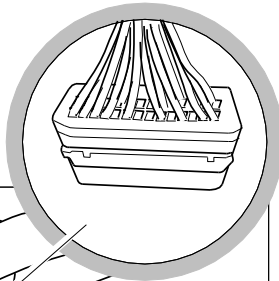

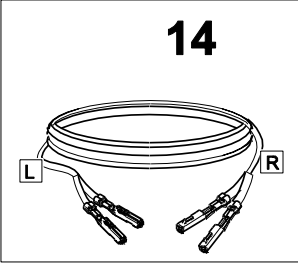
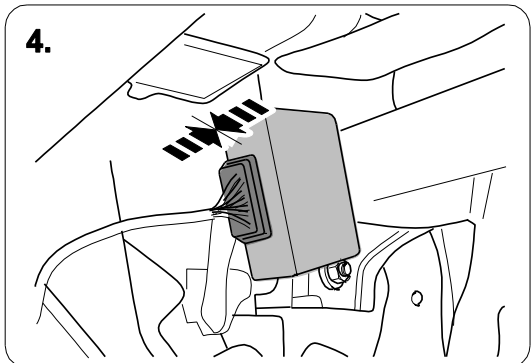
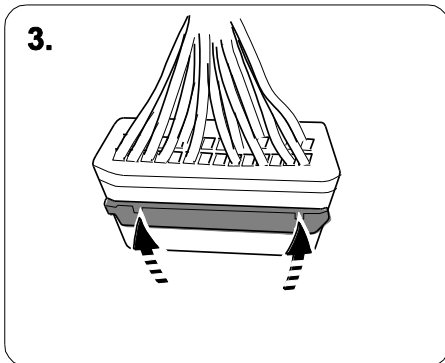
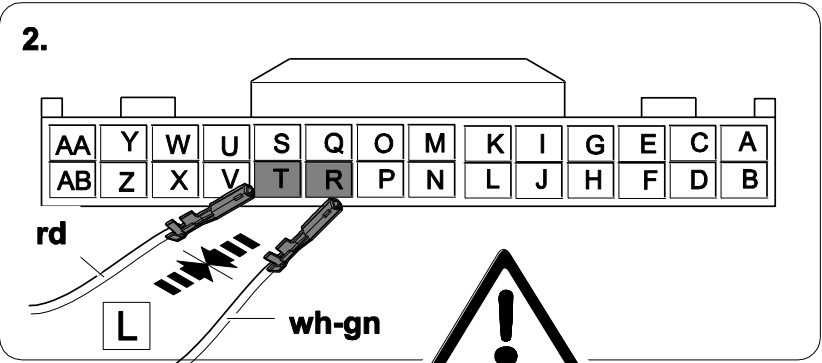
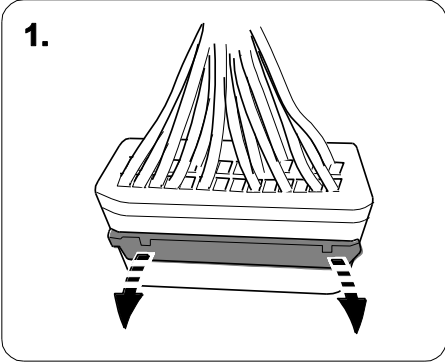

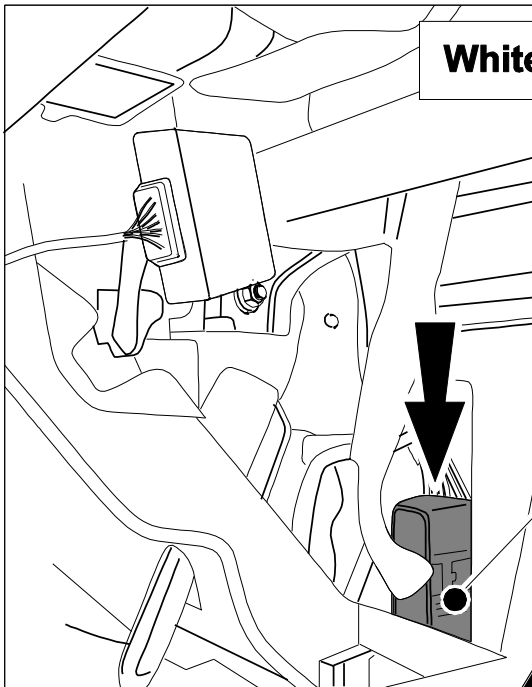

White 50 Pin Connector

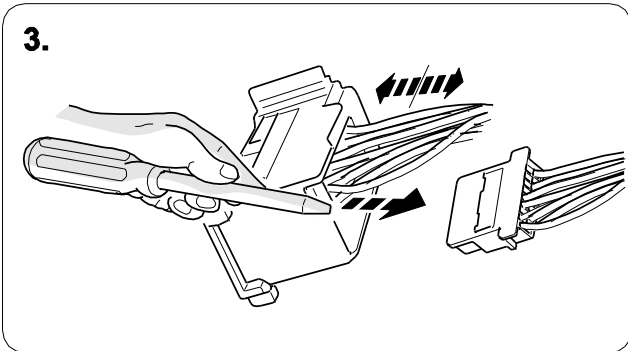
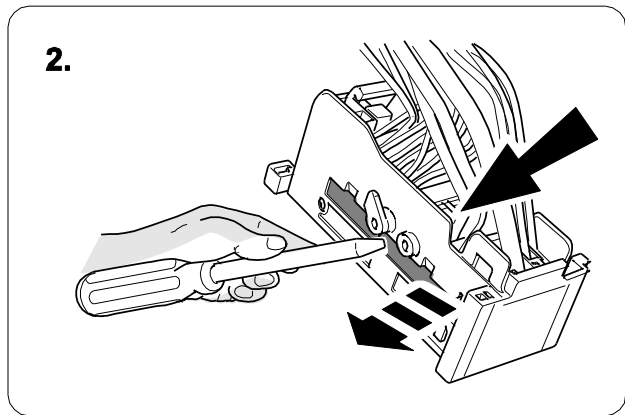
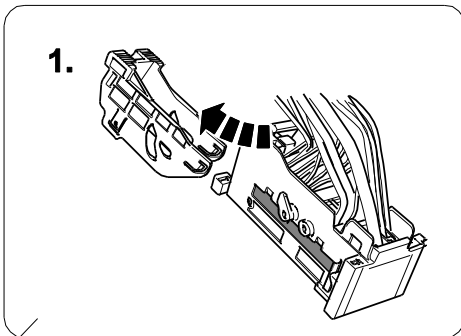
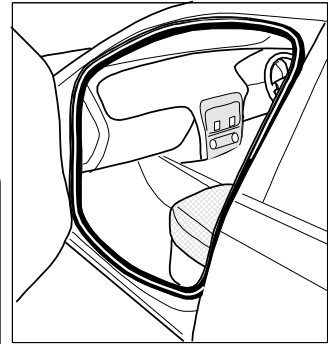

Remove the Gray 14 pin block from the main White 50 pin connector

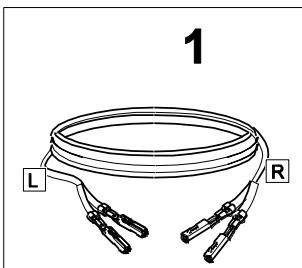
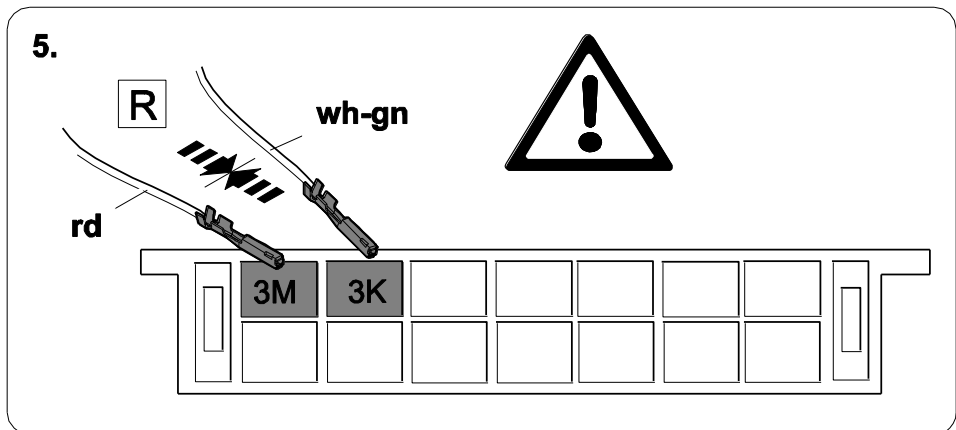
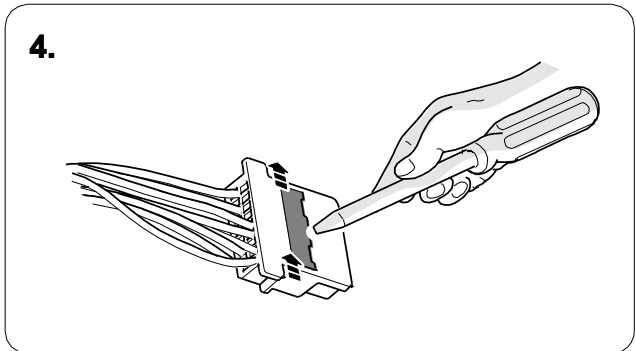

1.

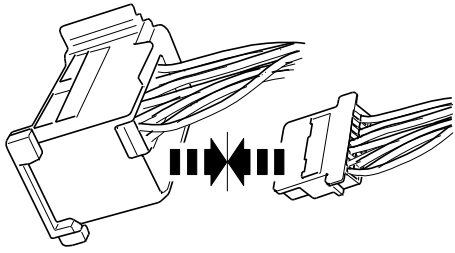

Close the secondary lock on the Grey 14 pin connector and refit back into the main white 50 pin connector

2.

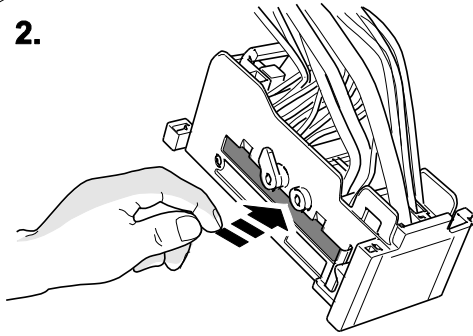

3.

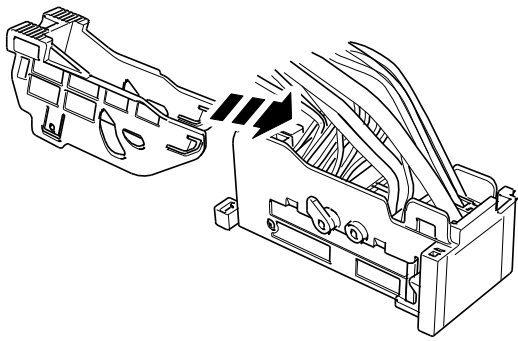

4.

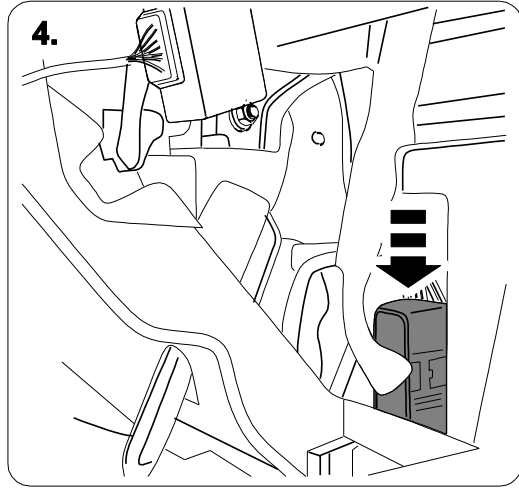

34 WITHOUT PDC

GL MODEL OPTION 1

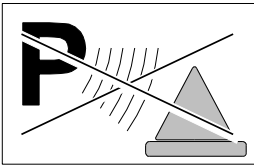

K

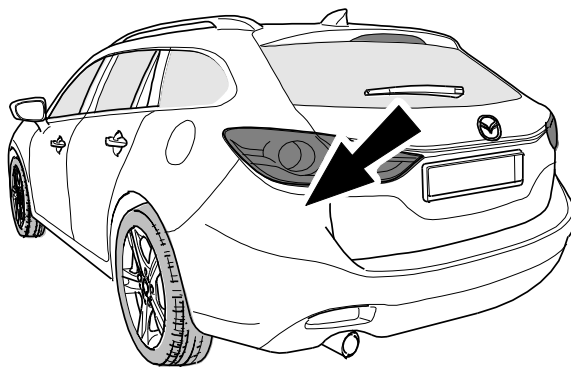
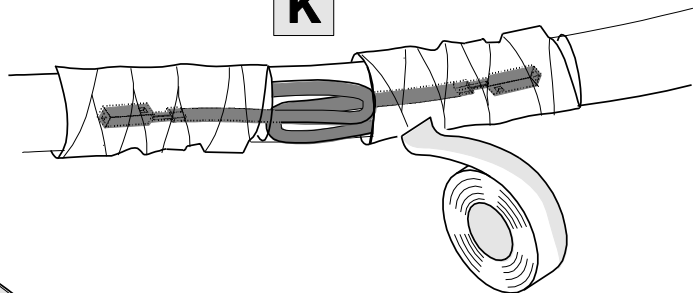

1

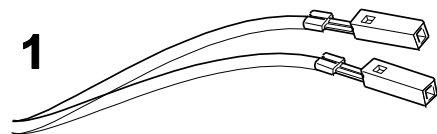

K

35 WITH PDC

GL MODEL OPTION 2

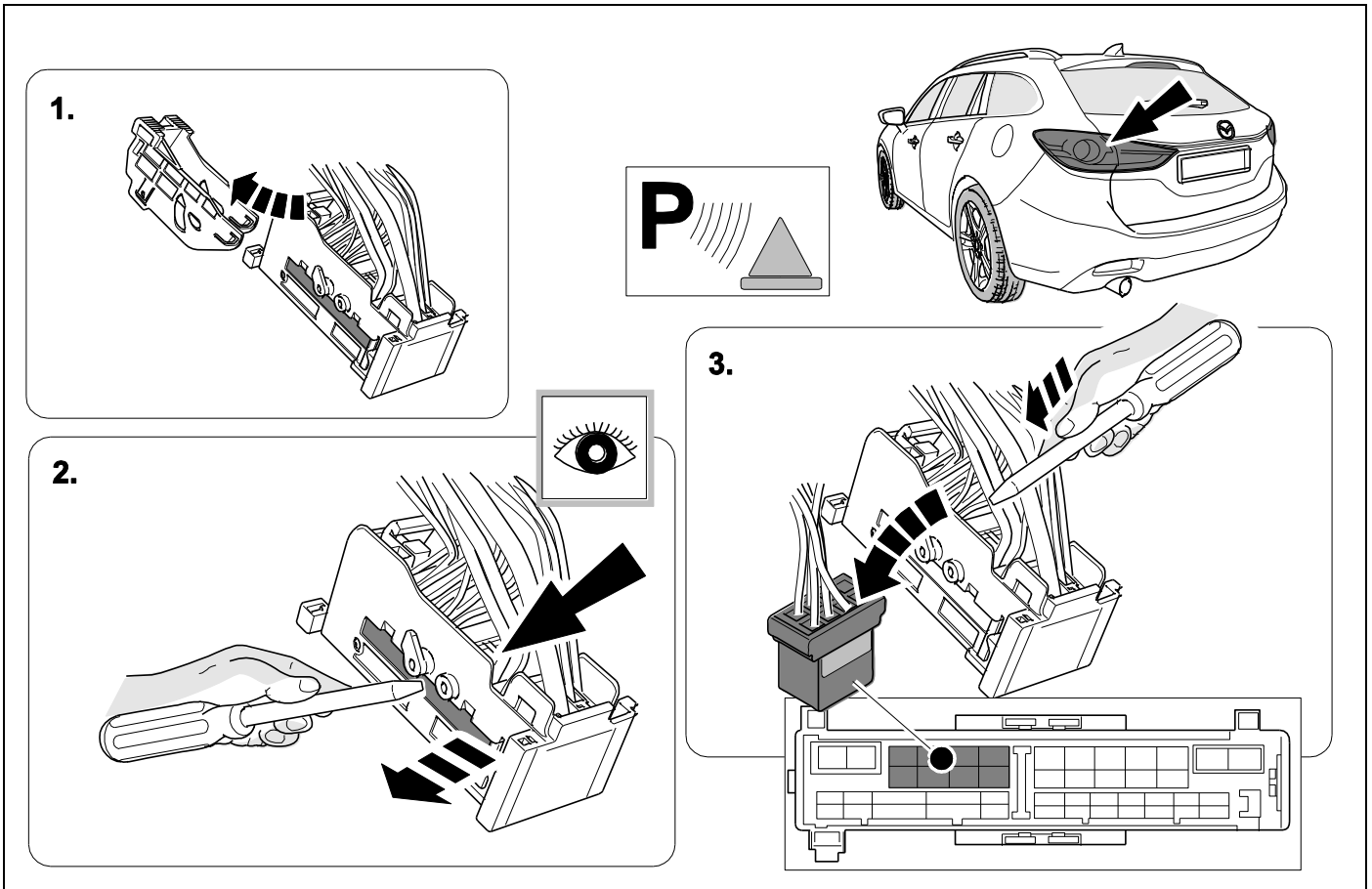

36 WITH PDC

GL MODEL OPTION 2

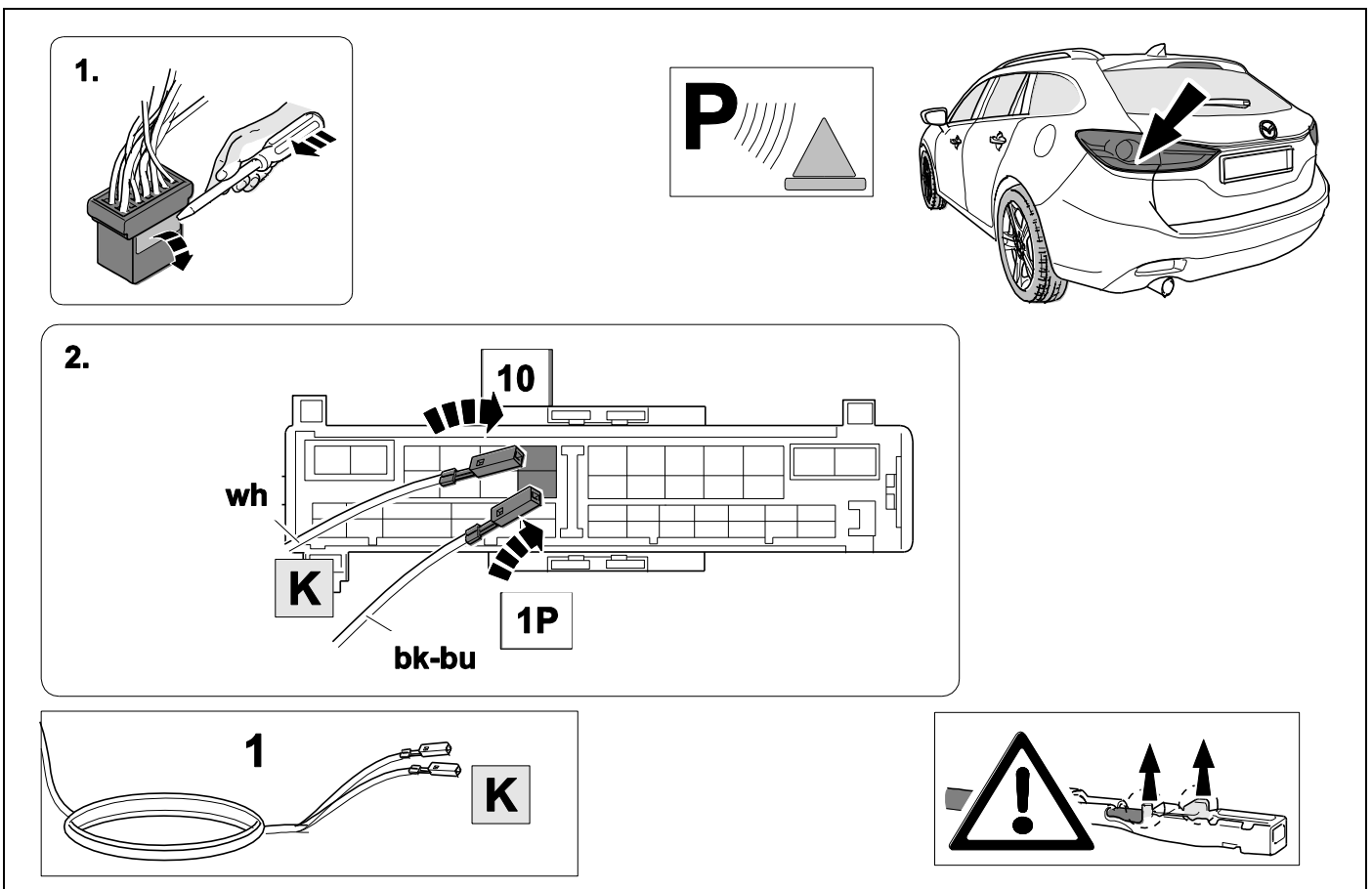

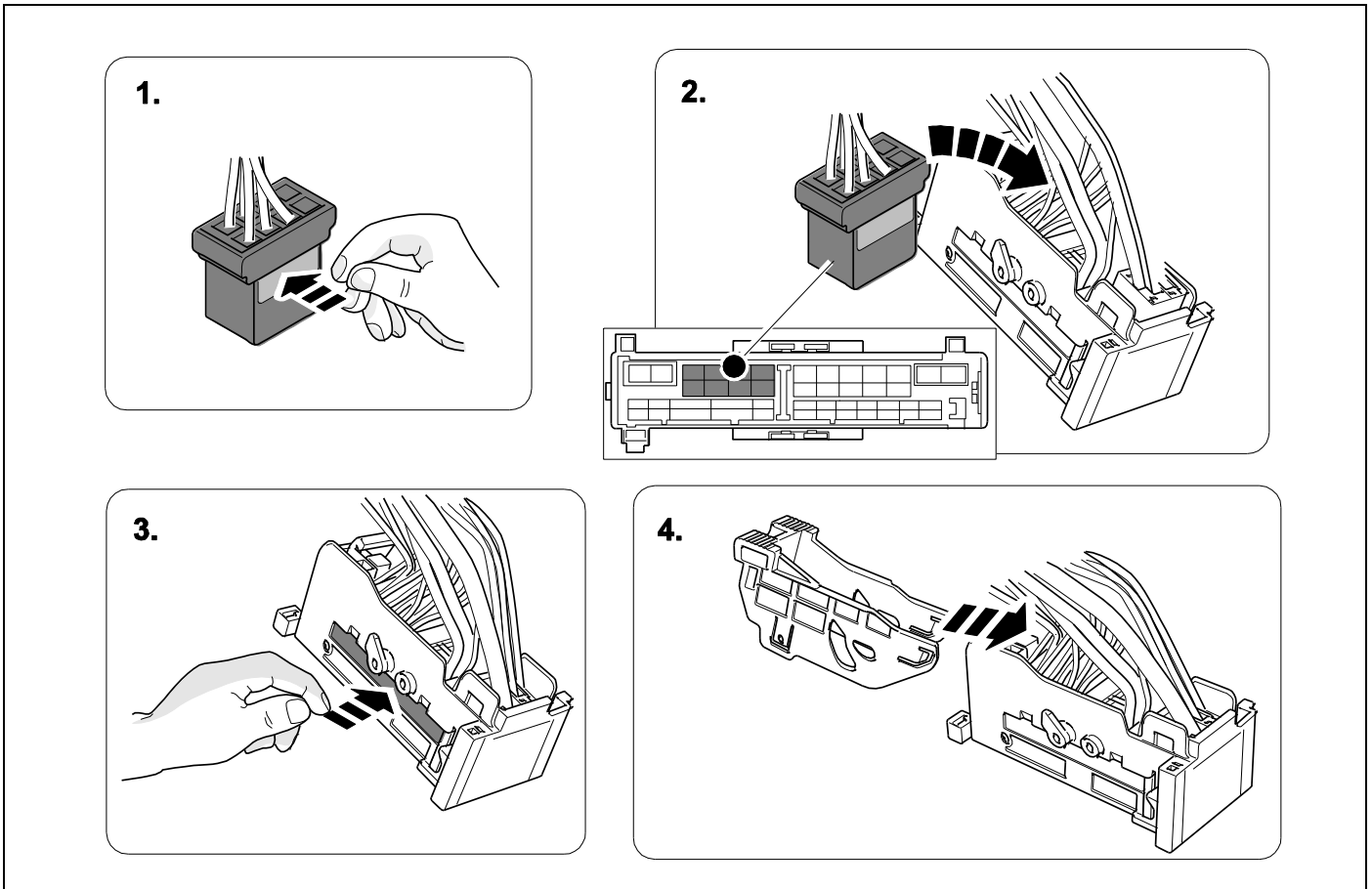

On models with "SCBS Reverse", when engaging reserve, a malfunction message may appear on the display as shown below, this is normal and is to advise the that the system is not active when towing.

PDC

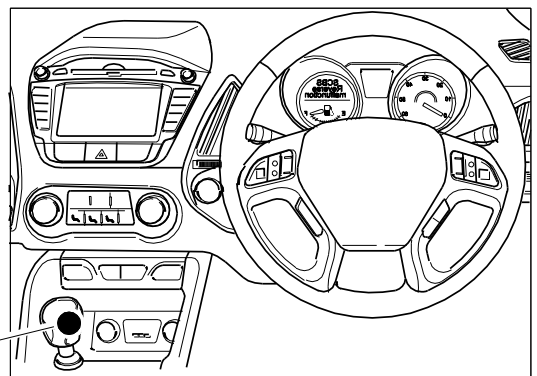
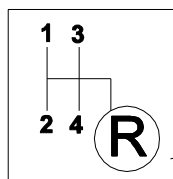
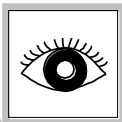
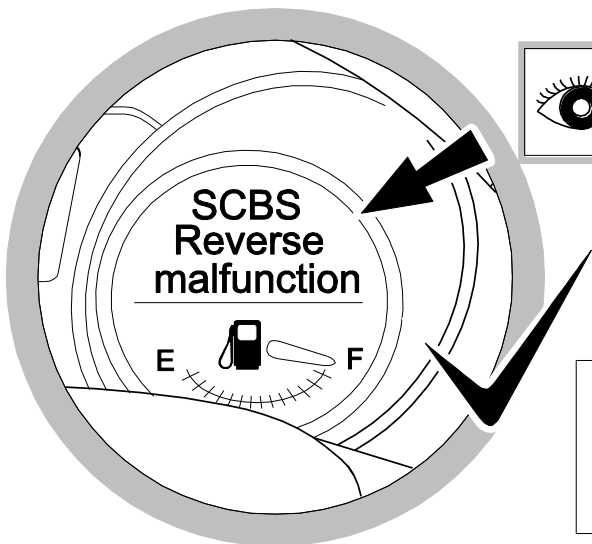
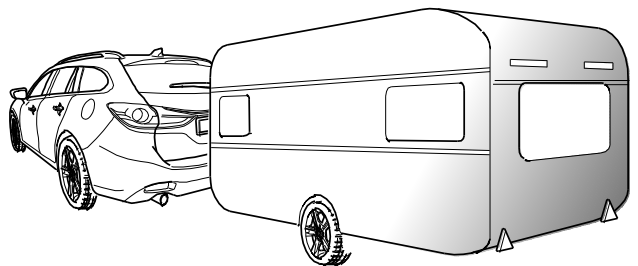

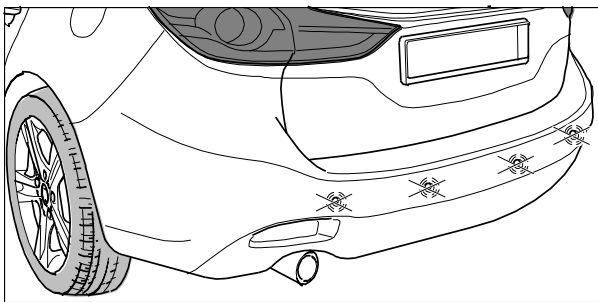
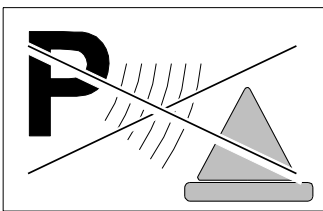
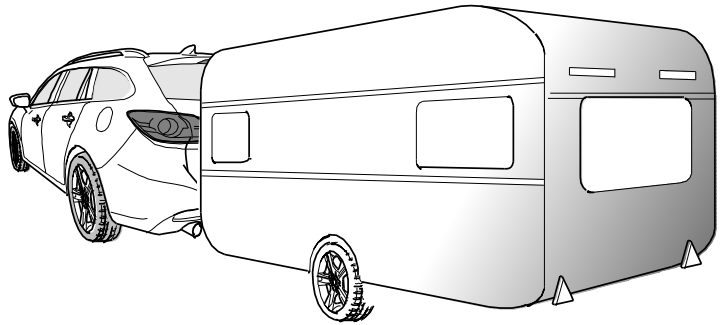
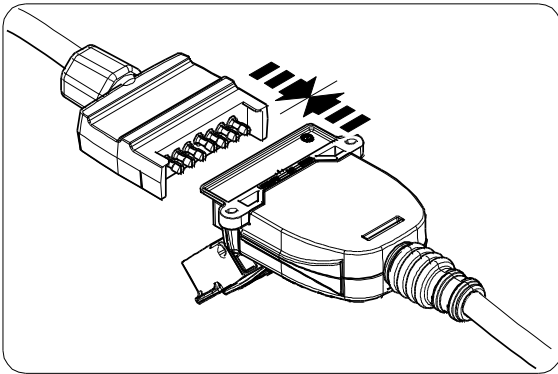

On the facelift GL models the PDC or SCBS-R system is not active while the parking brake is engaged.



In order to test automatic PDC and SCBS-R deactivation while stationary, plug in a trailer light tester or trailer and ensure the parking brake is disengaged. A deactivation message will be displayed as shown.

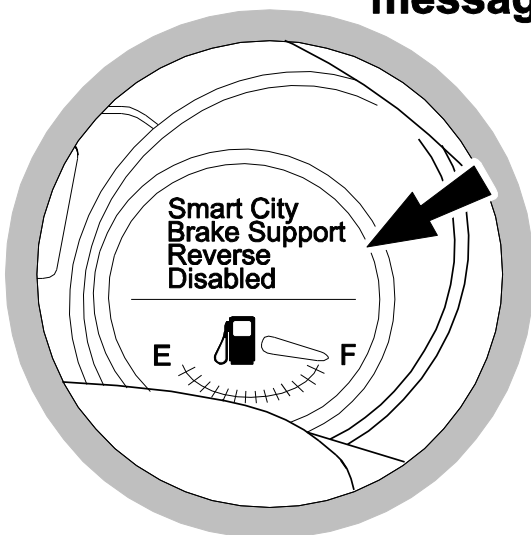



Trailer Brake Preparation

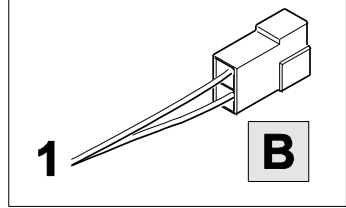
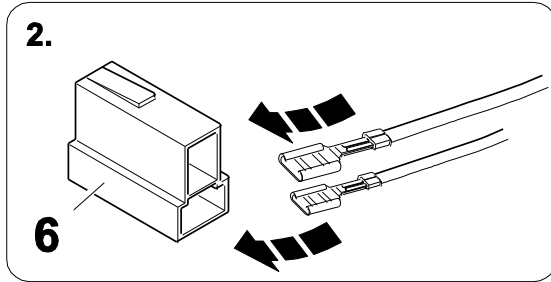
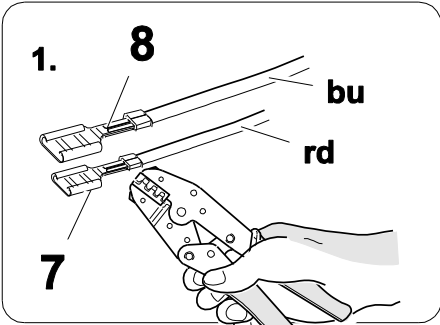

APPROVED, TESTED AND CERTIFIED TO BE USED WITH THE SPECTRUM BRAKE CONTROLLER.

USE OUR BRAKE CONTROLLER CONNECTION HARNESS 529008EJ

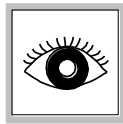
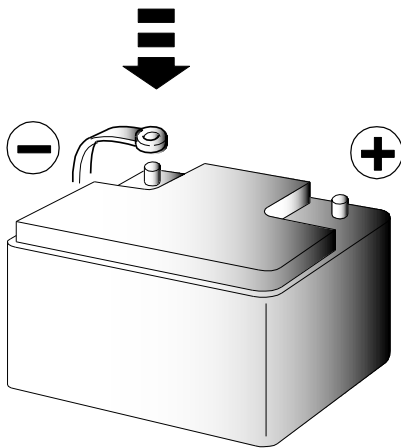
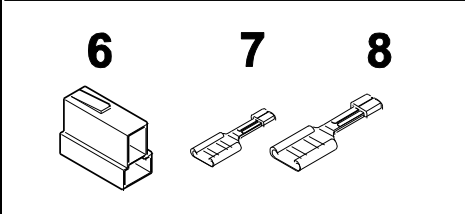
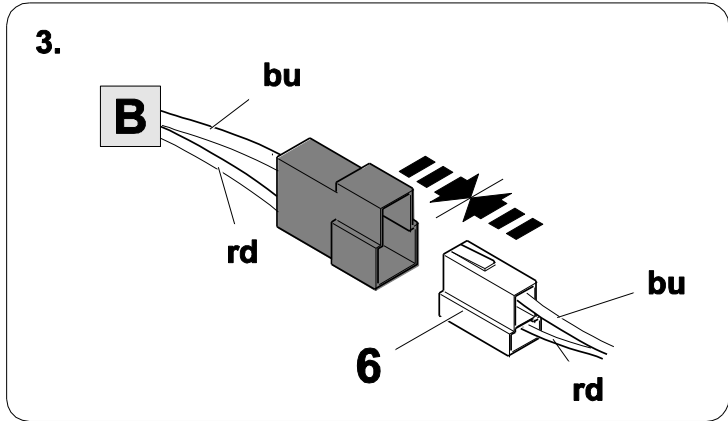

42

CHECK ALL LIGHTING FUNCTIONS

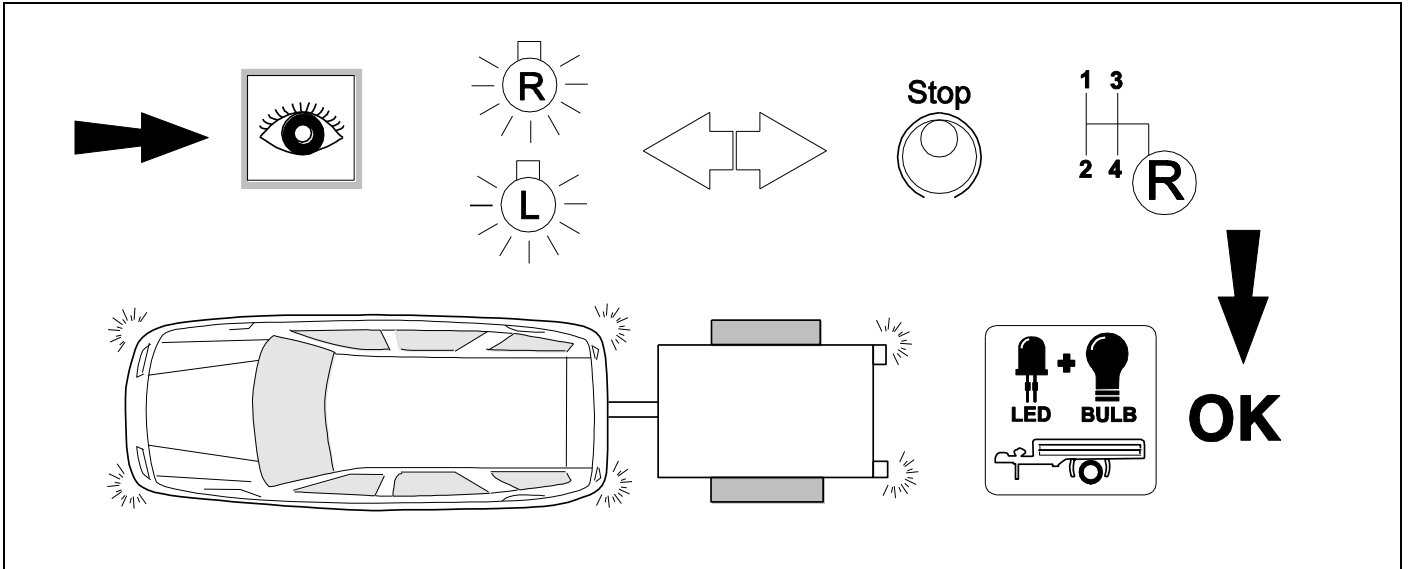

43

CHECK BULB OUT DETECTION

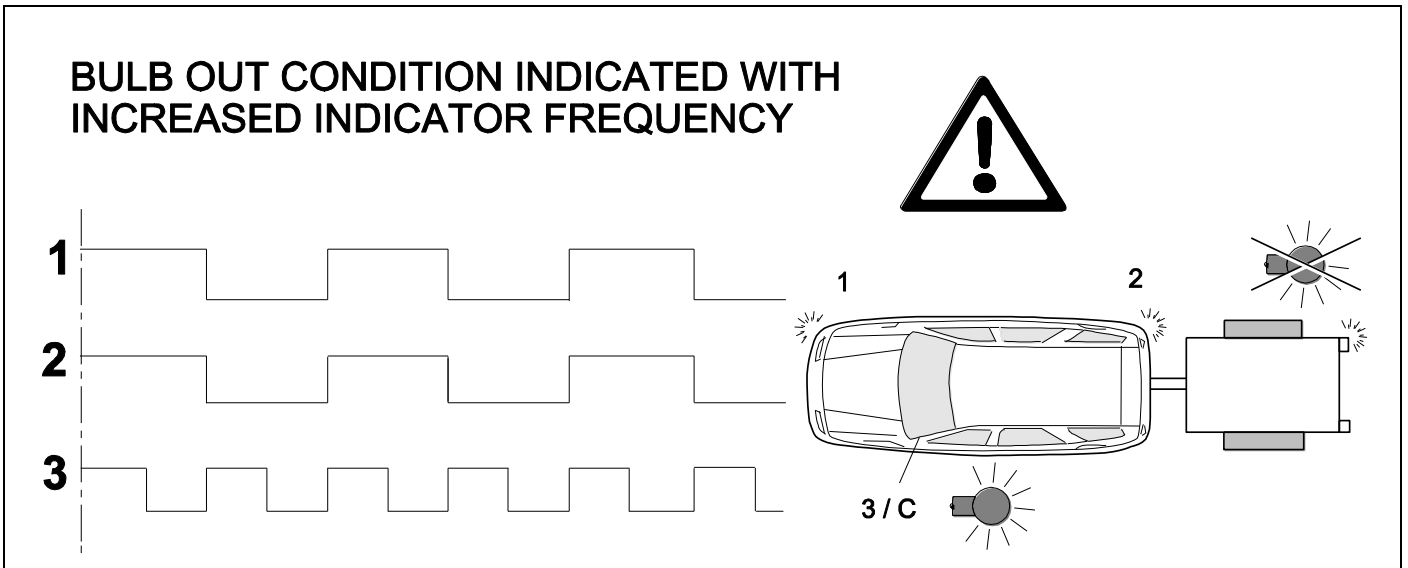

44

👁️ ⇒ 20 + 21

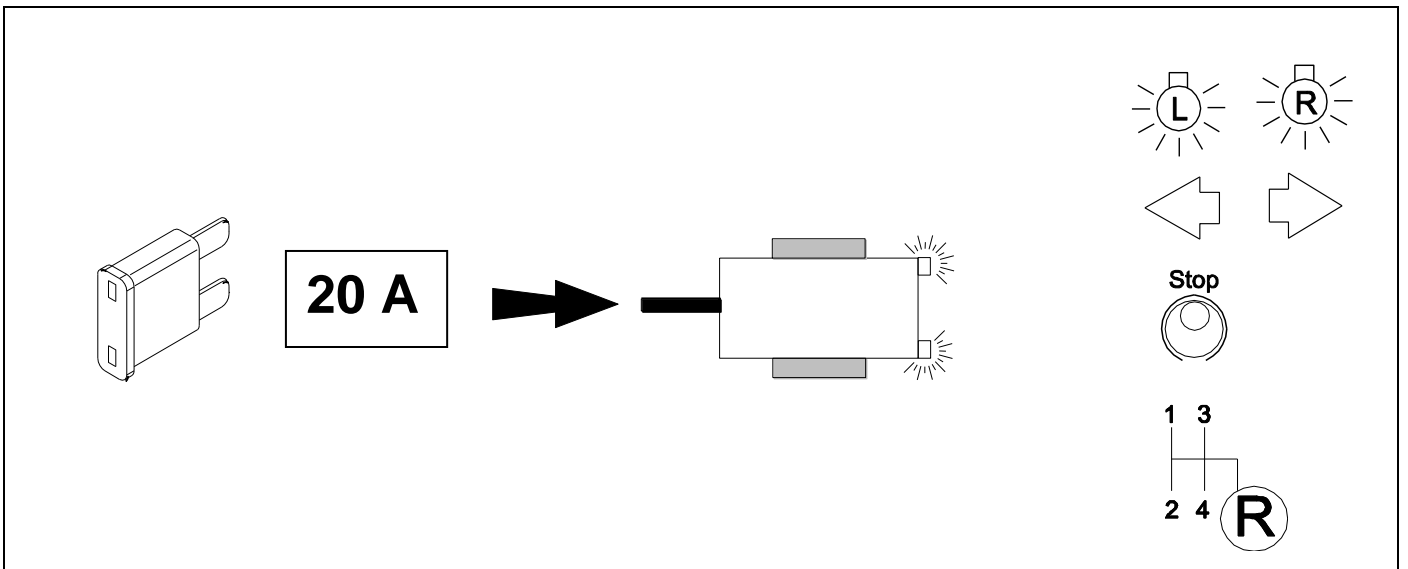

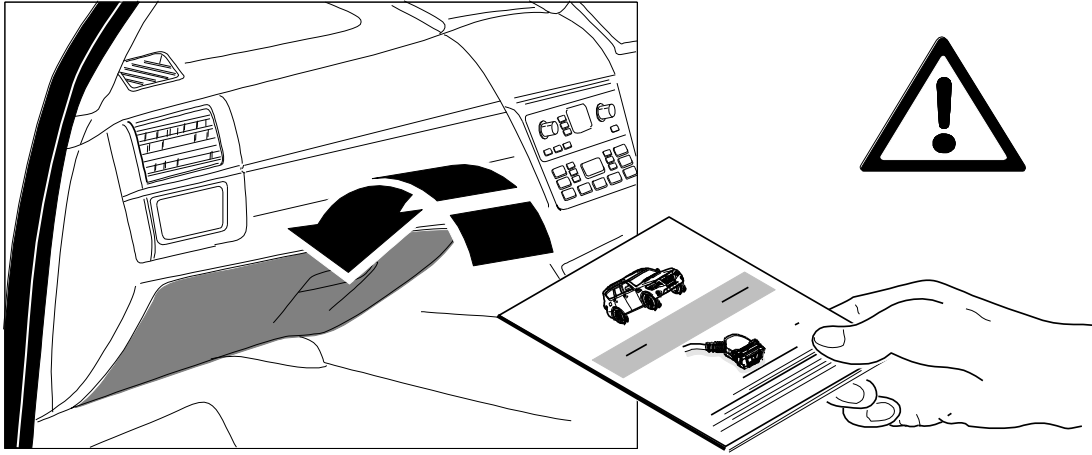

Subject to change in terms of construction, equipment and colour, and may contain errors.
The information and illustrations are non-binding.