

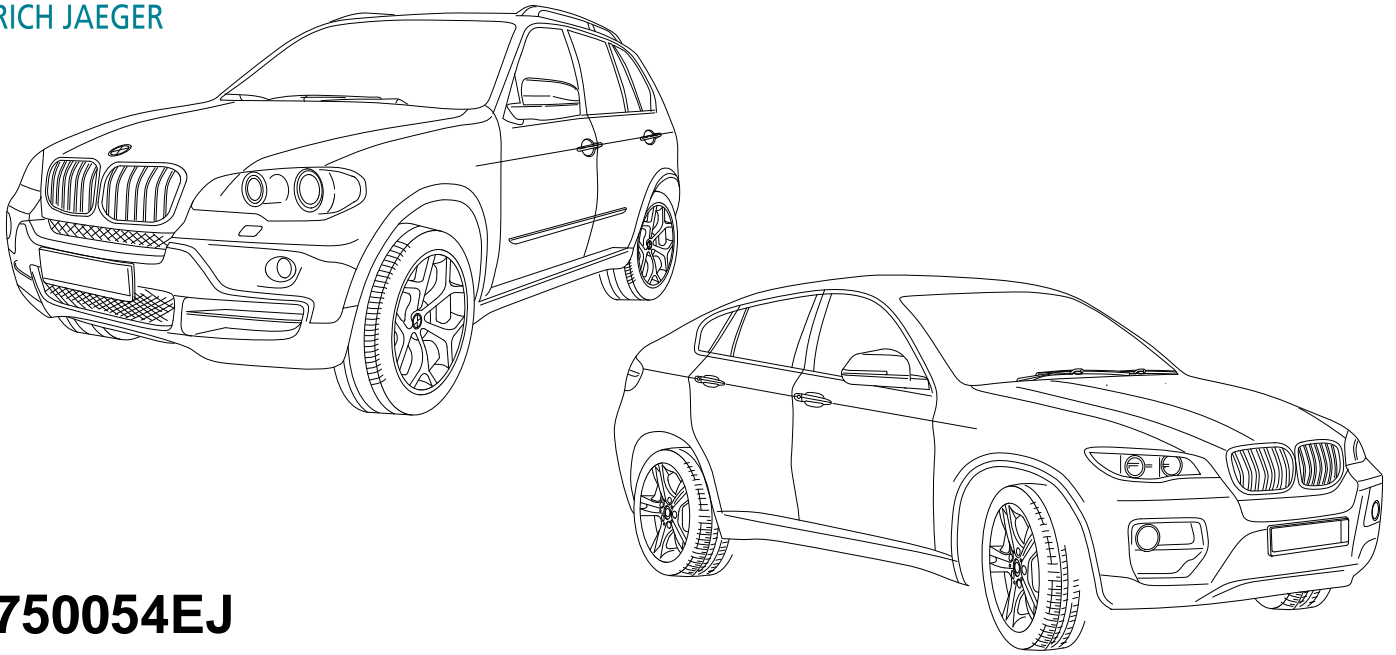

ERICH JAEGER

Installation instructions



750054EJ

BMW X5 E70

BMW X6 E71

03/07 >> 10/13

05/08 >> 11/14



SCAN FOR
LATEST
INSTRUCTIONS

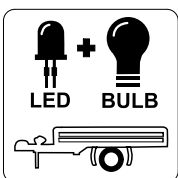
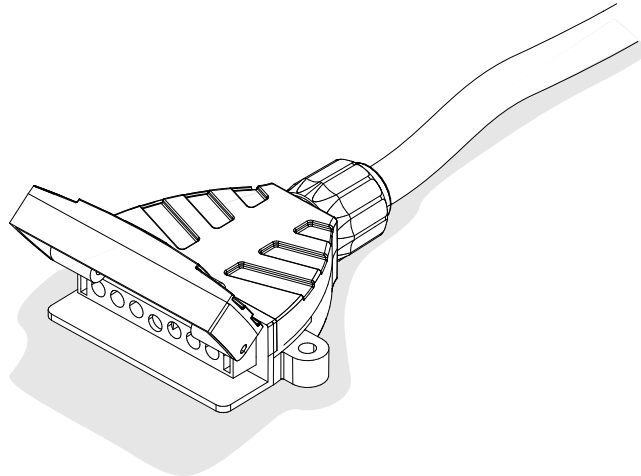

Reference:

The following information must be reviewed before beginning the assembly:

The installation instructions are to be thoroughly read.

The installation should be carried out by qualified personnel with the relevant technical knowledge. The vehicle manufacturers' current technical notices and information on retrofitting must be followed. The removal and replacement instructions found in the current repair manuals must be followed.

It must be ensured that the vehicle is technically suitable for the installation of a trailer hitch.

OPTION 2

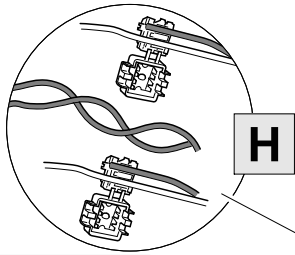

CAN-Wire

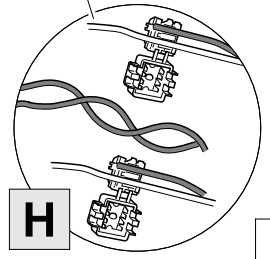
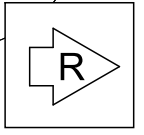
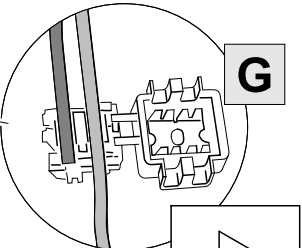
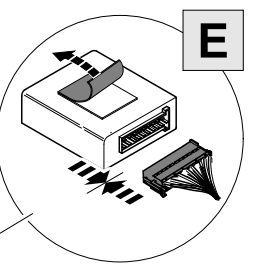
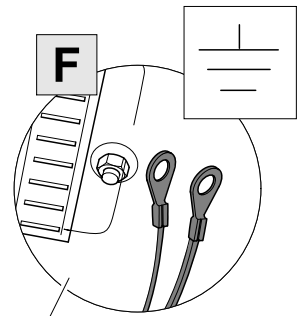
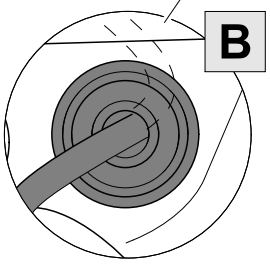
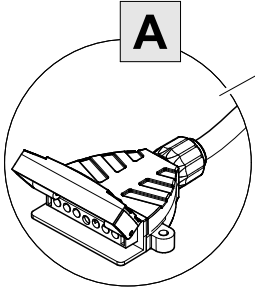
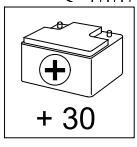
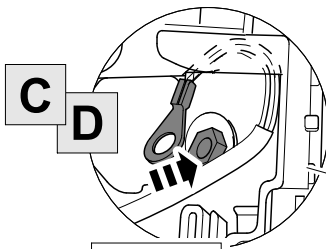
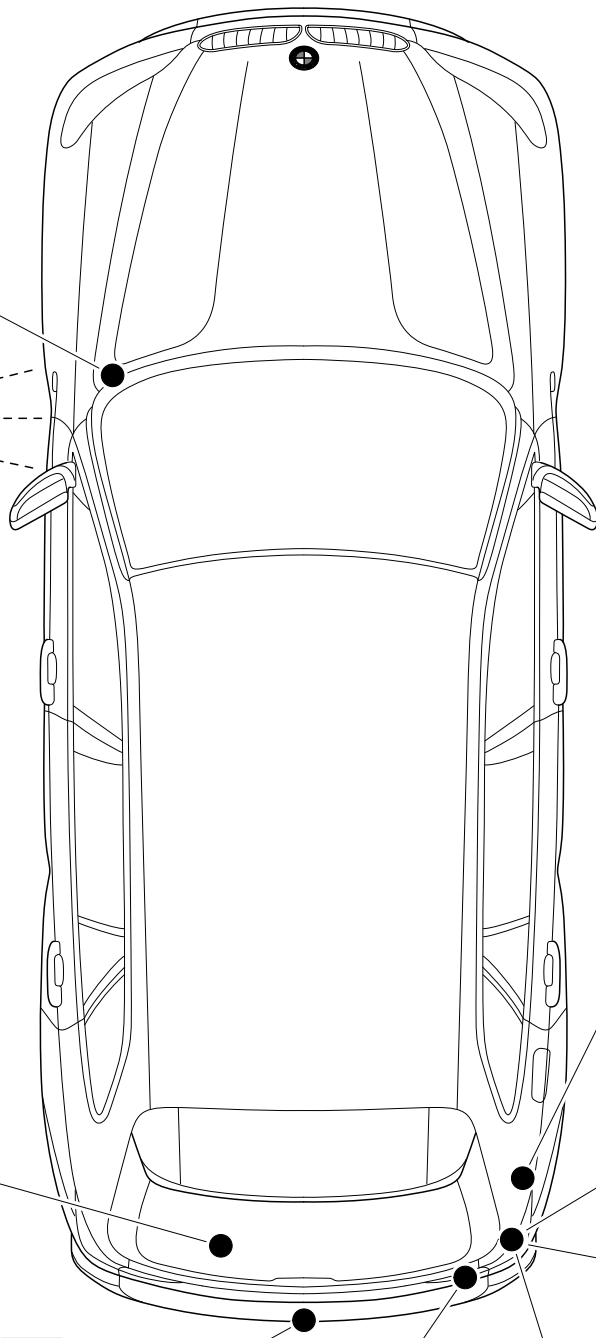
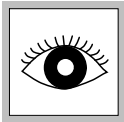

OPTION 1

CAN-Wire

KIT

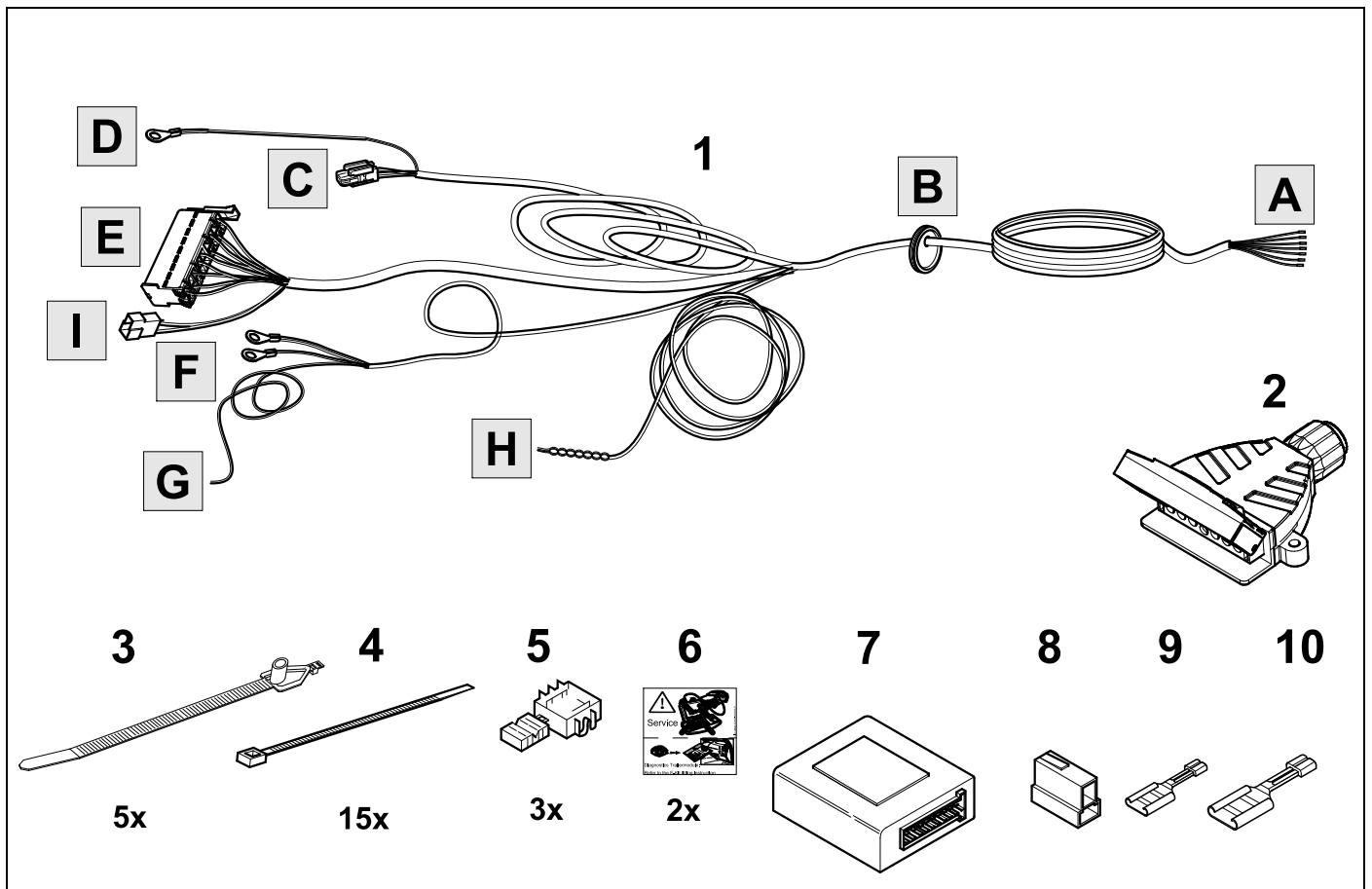

TOOLS

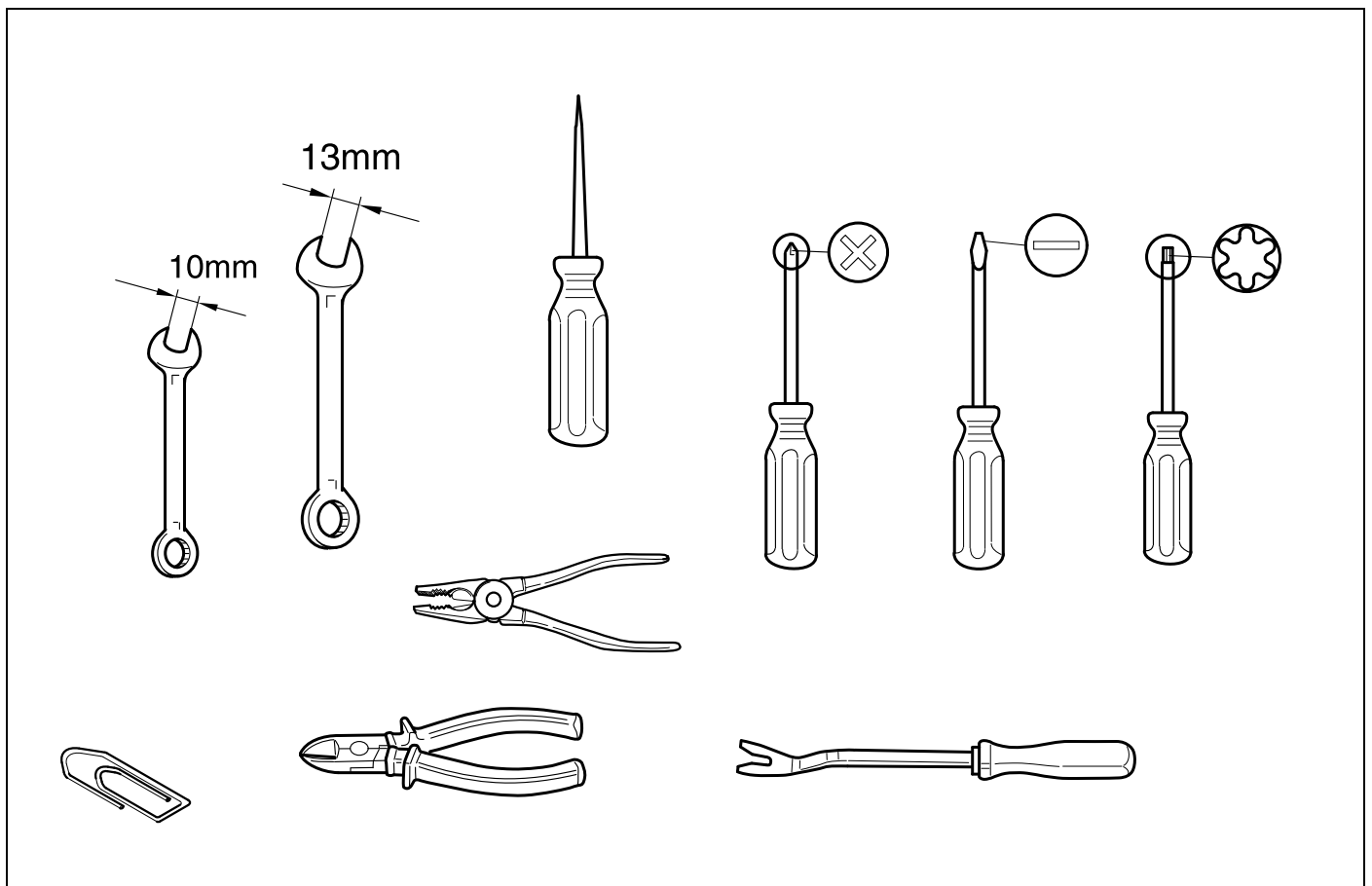

1

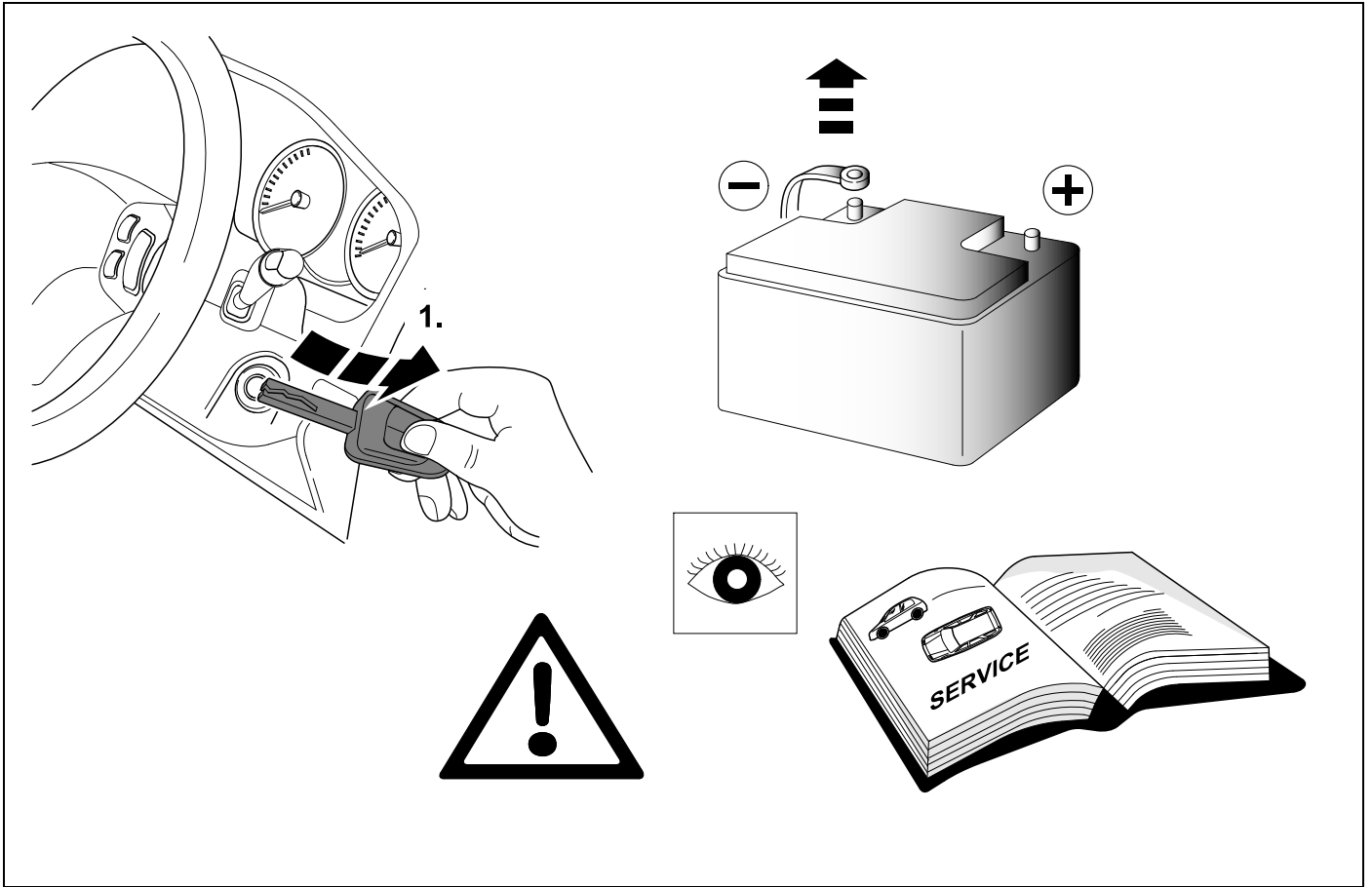

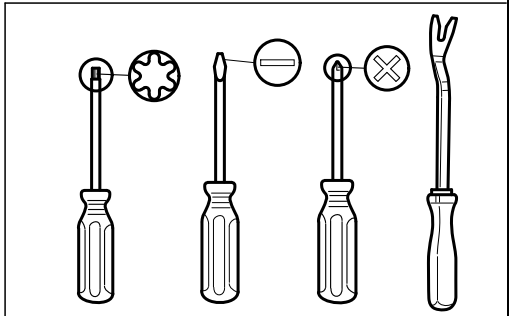
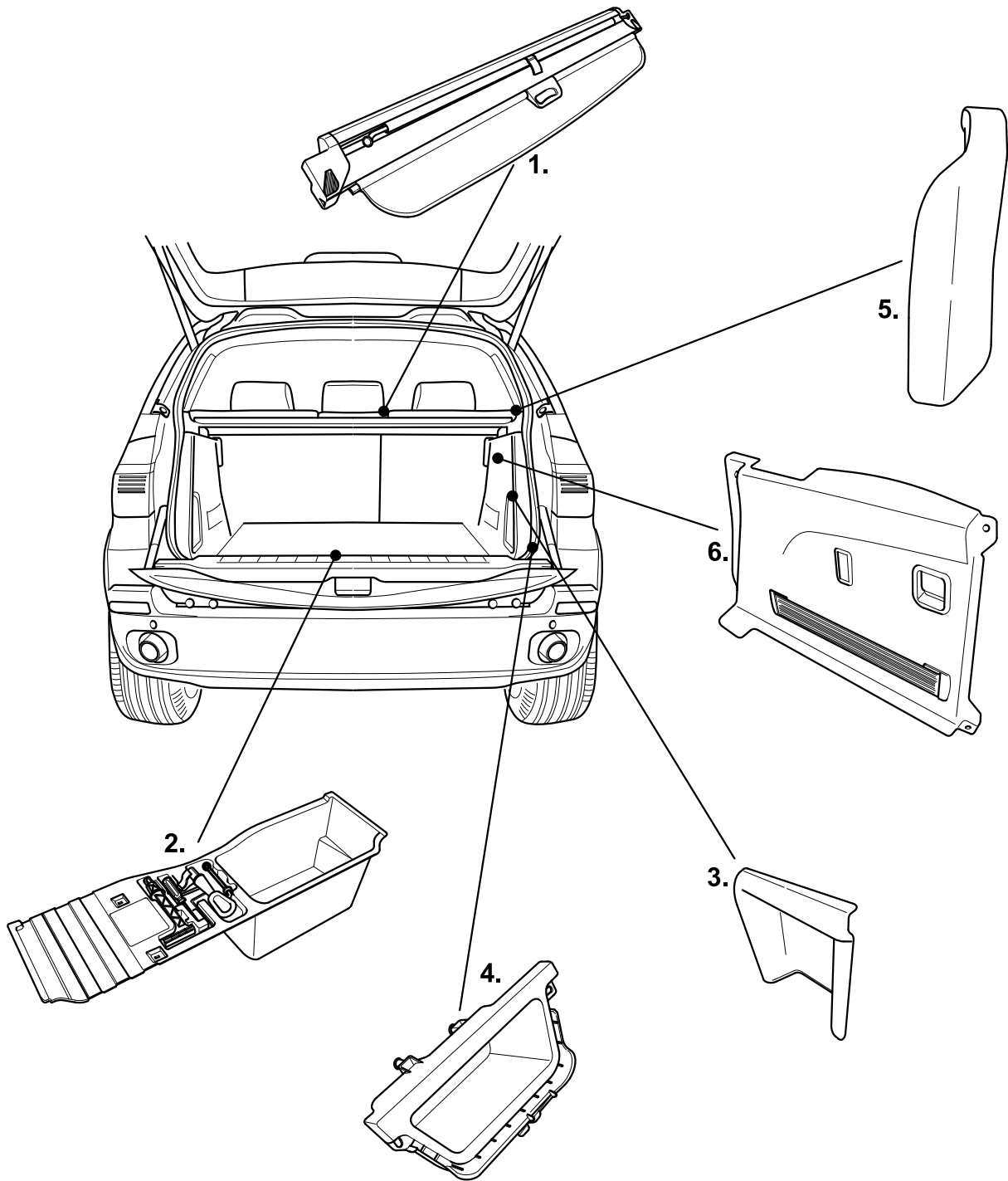

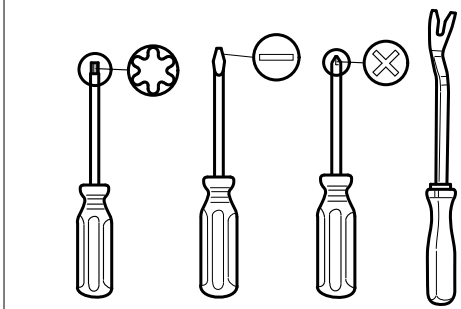
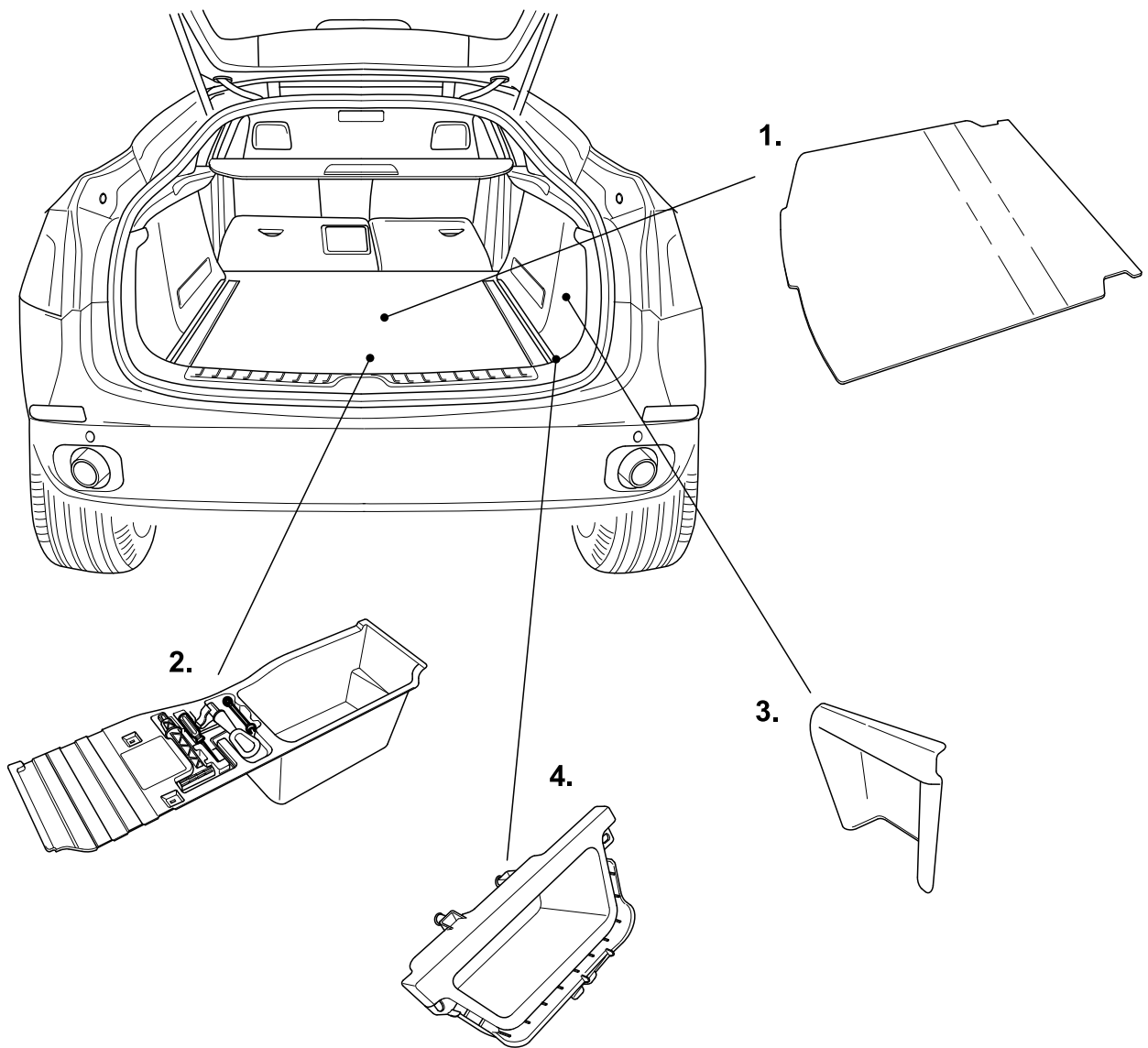

4

X5 / X6

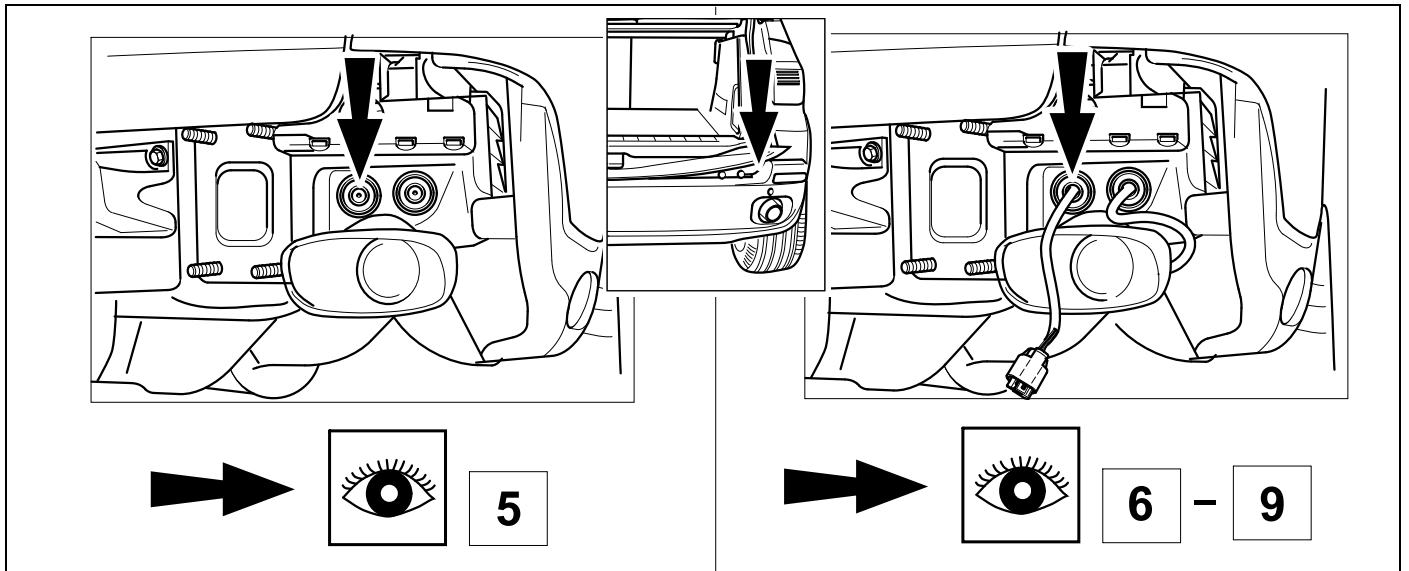

5

X5 / X6

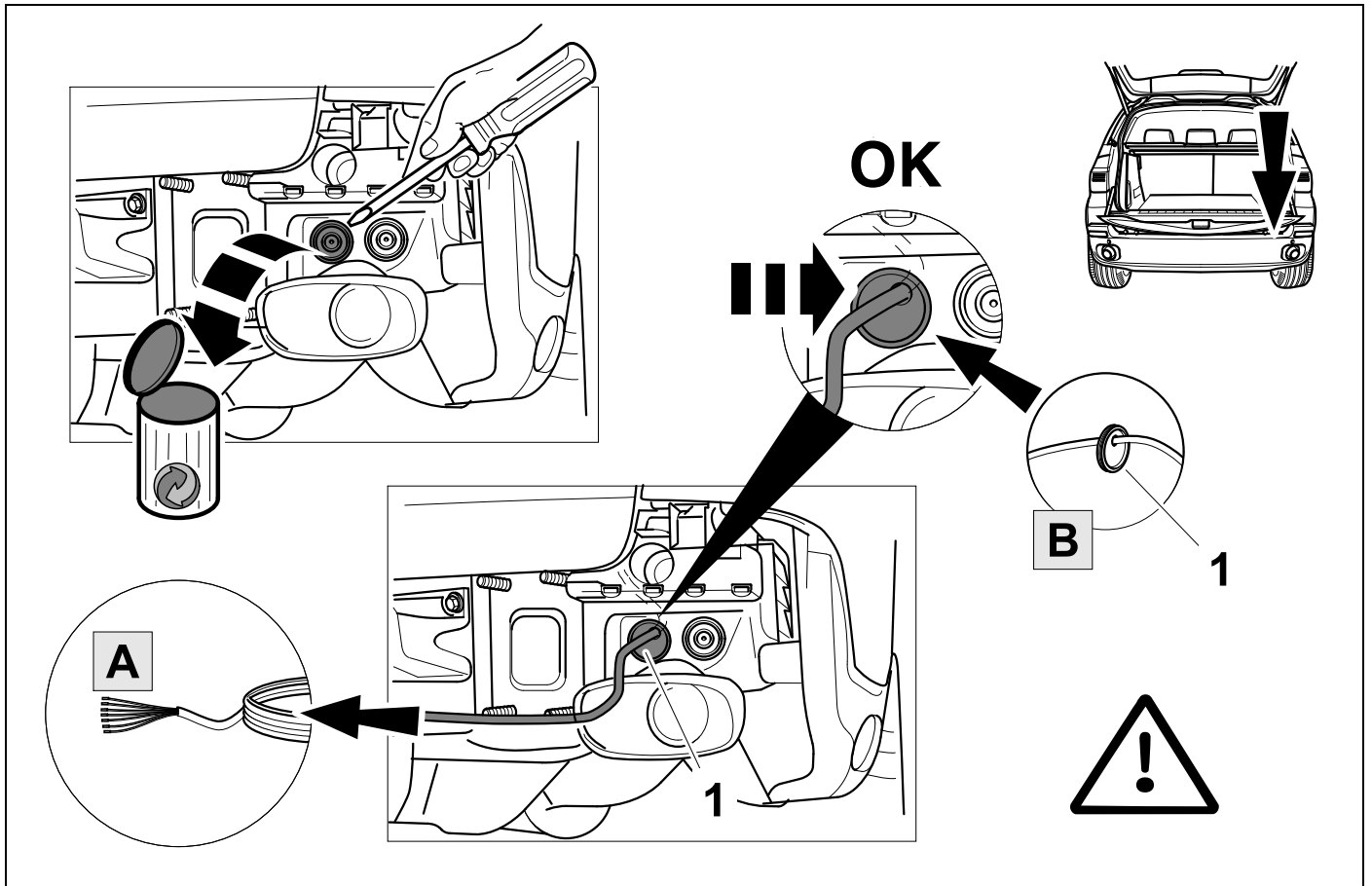

6

X5 / X6

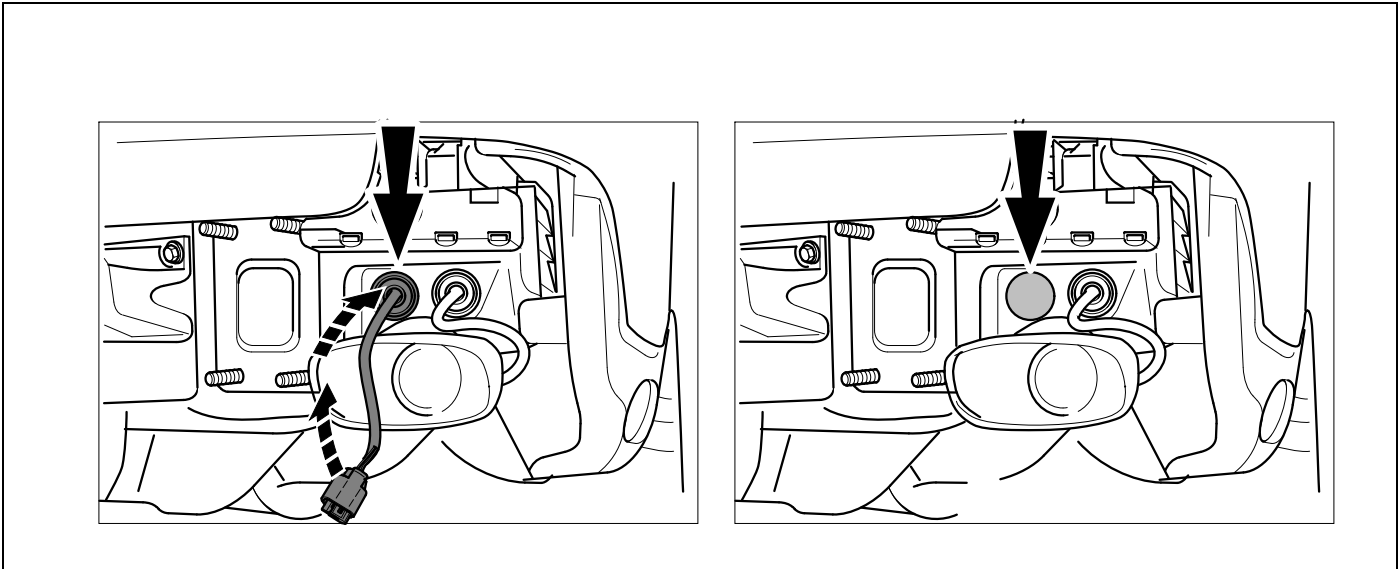

7

X5 / X6

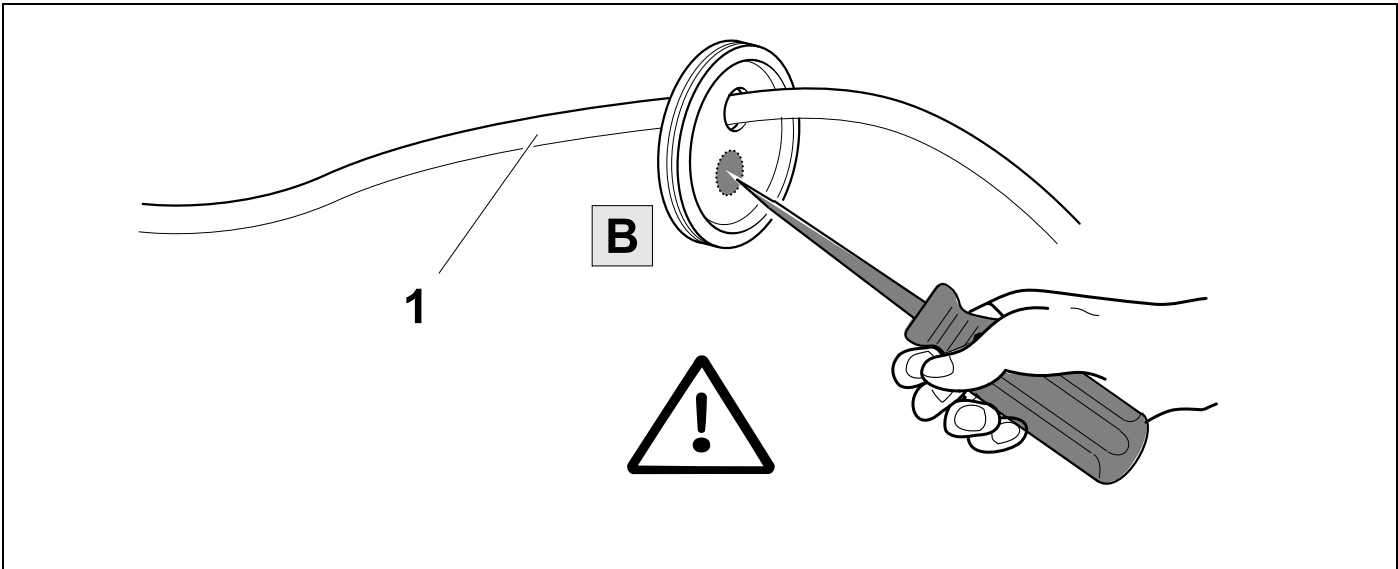

8

X5 / X6

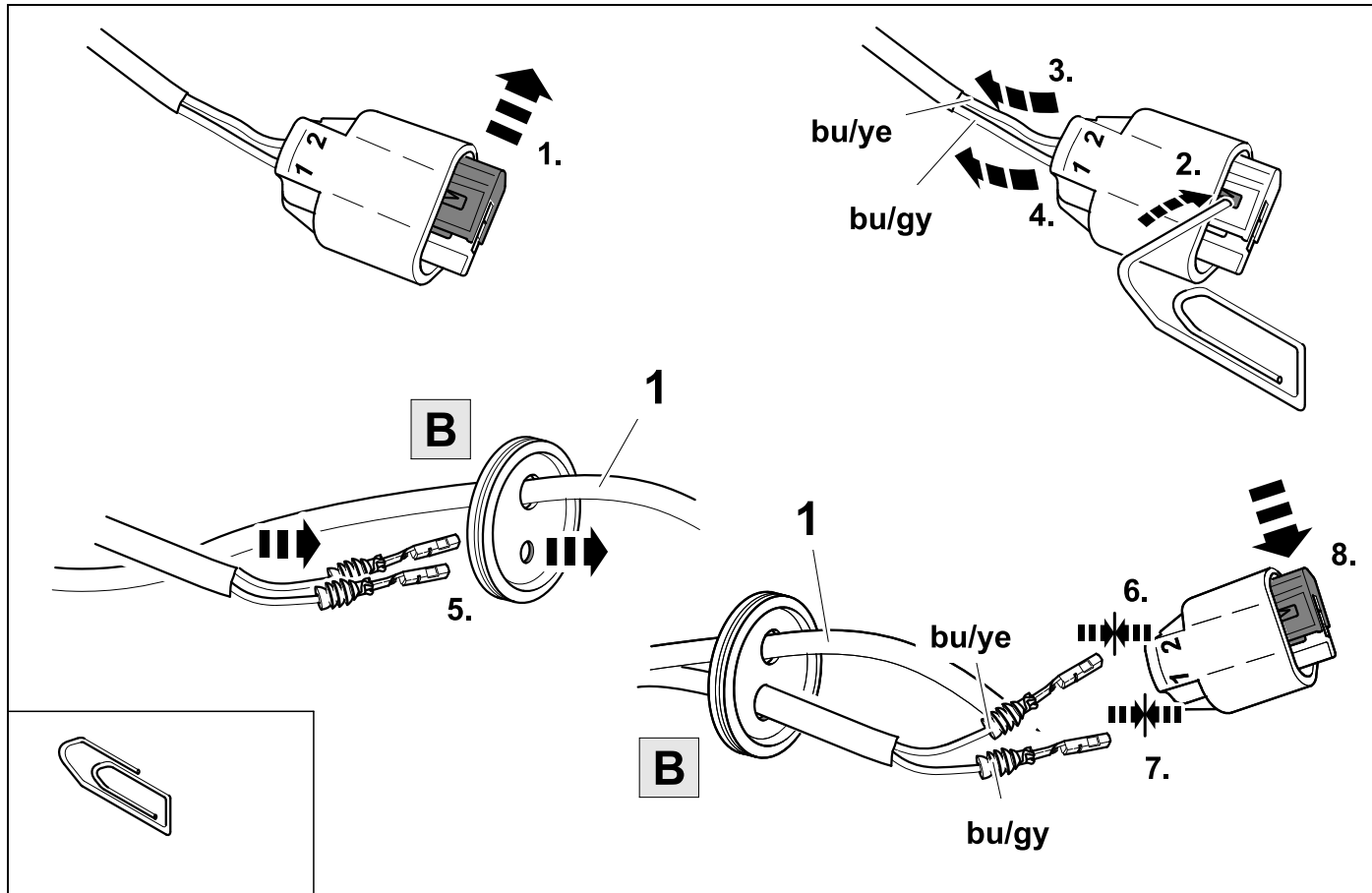

9

X5 / X6

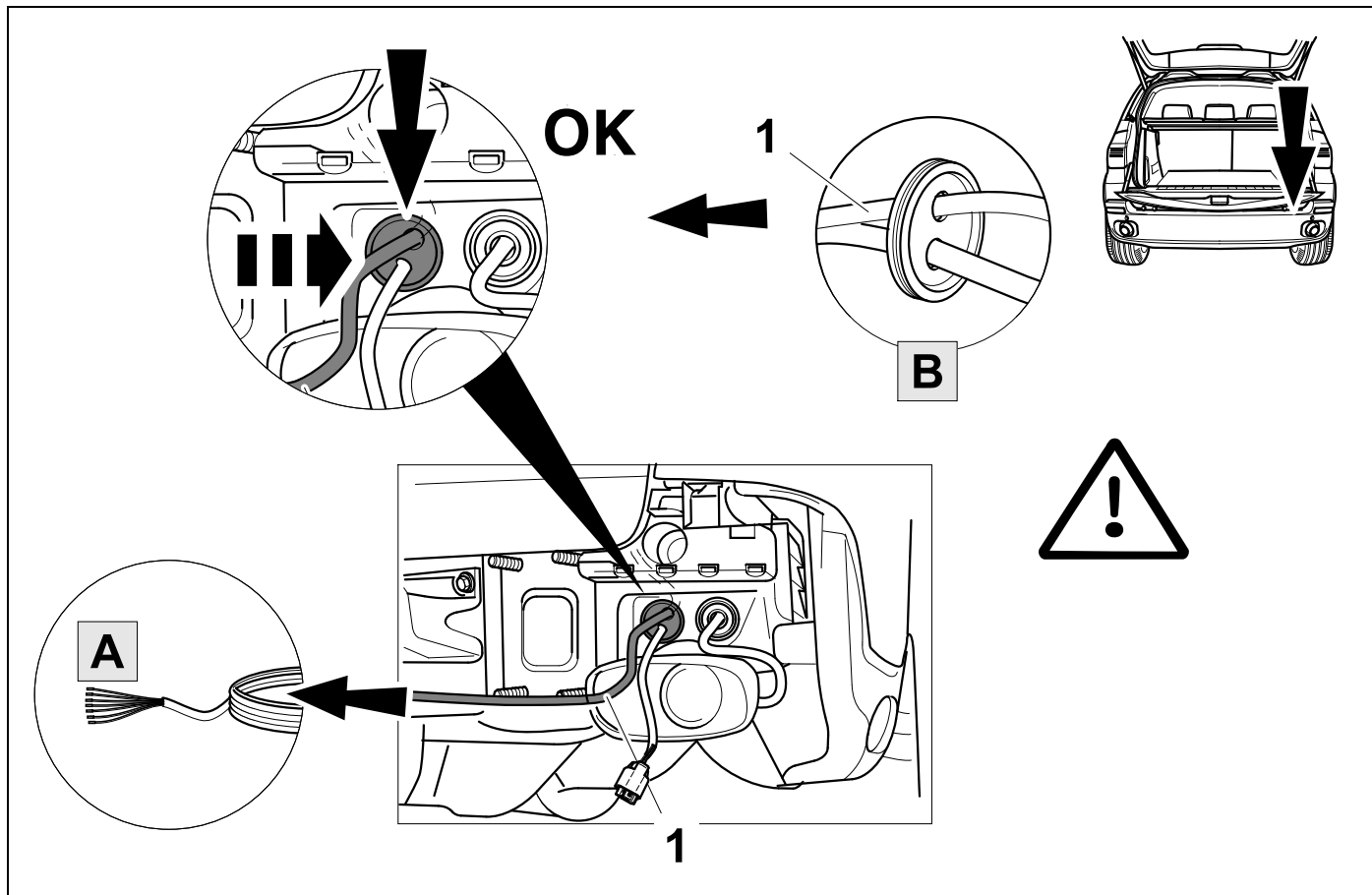

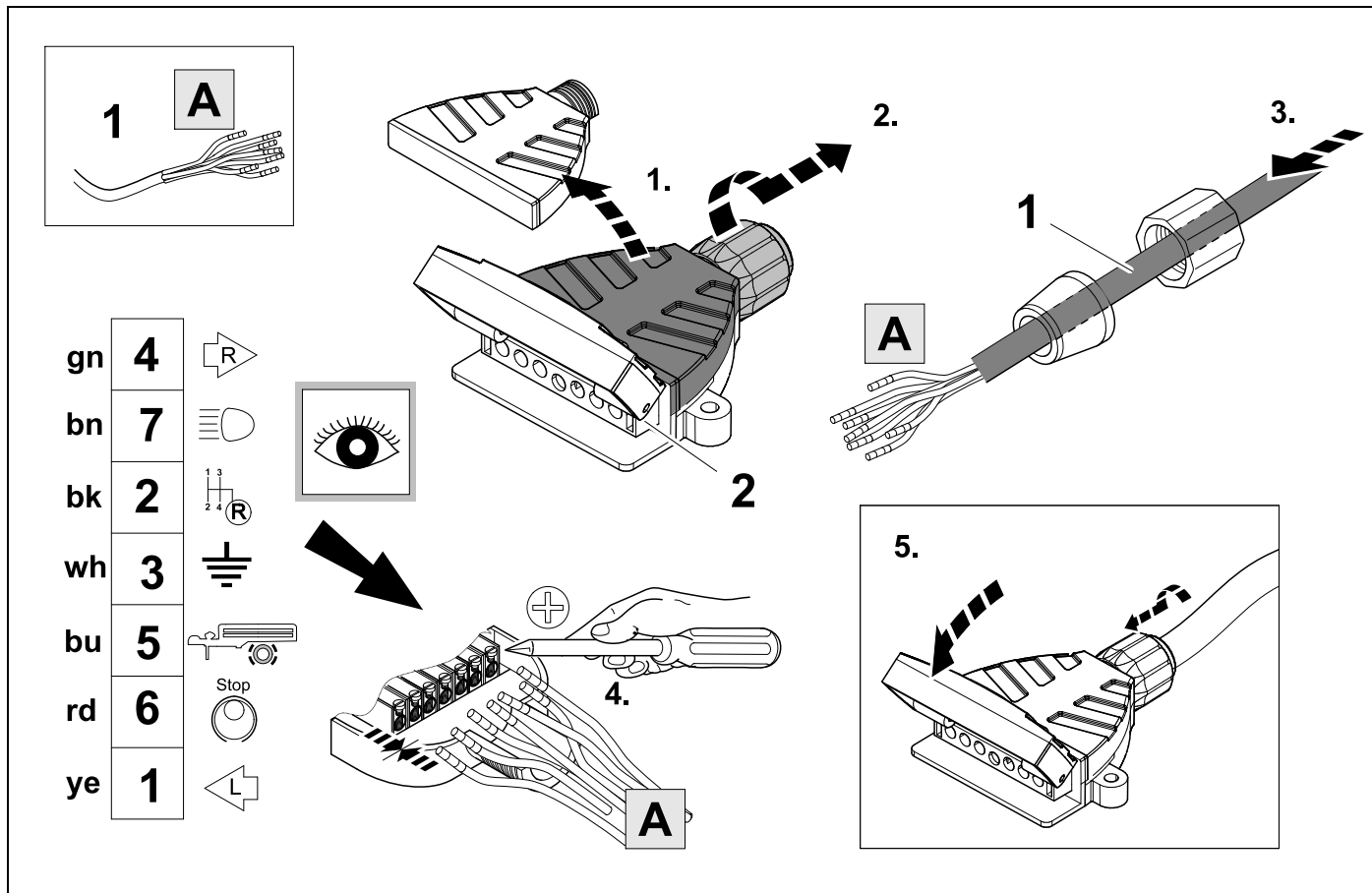
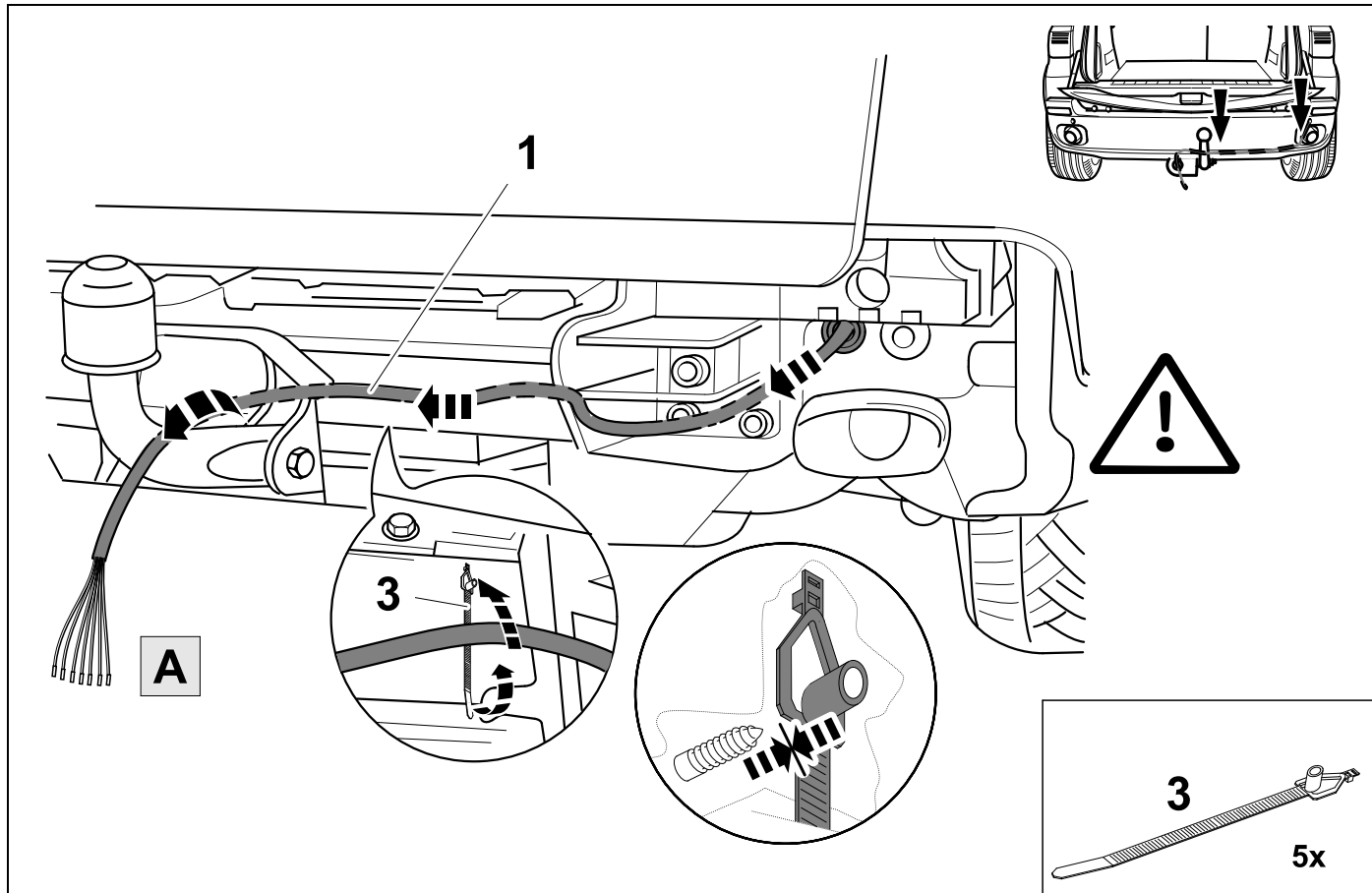

12

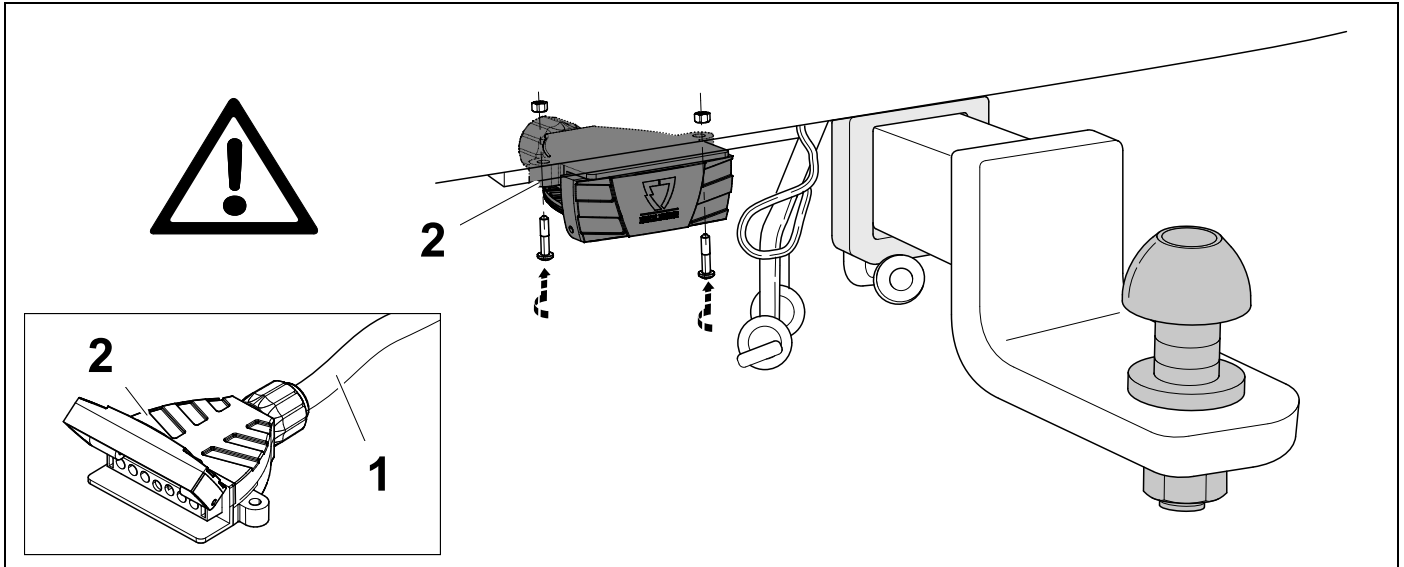

13



14

1	ye	
2	bk	
3	wh	
4	gn	
5	bu	
6	rd	
7	bn	

14	bk	wh	gy	gn	rd	bu	ye	bn	pu	or	no
----	----	----	----	----	----	----	----	----	----	----	----

	black	white	grey	green	red	blue	yellow	brown	purple	orange	not occupied
--	-------	-------	------	-------	-----	------	--------	-------	--------	--------	--------------

15

X5 / X6

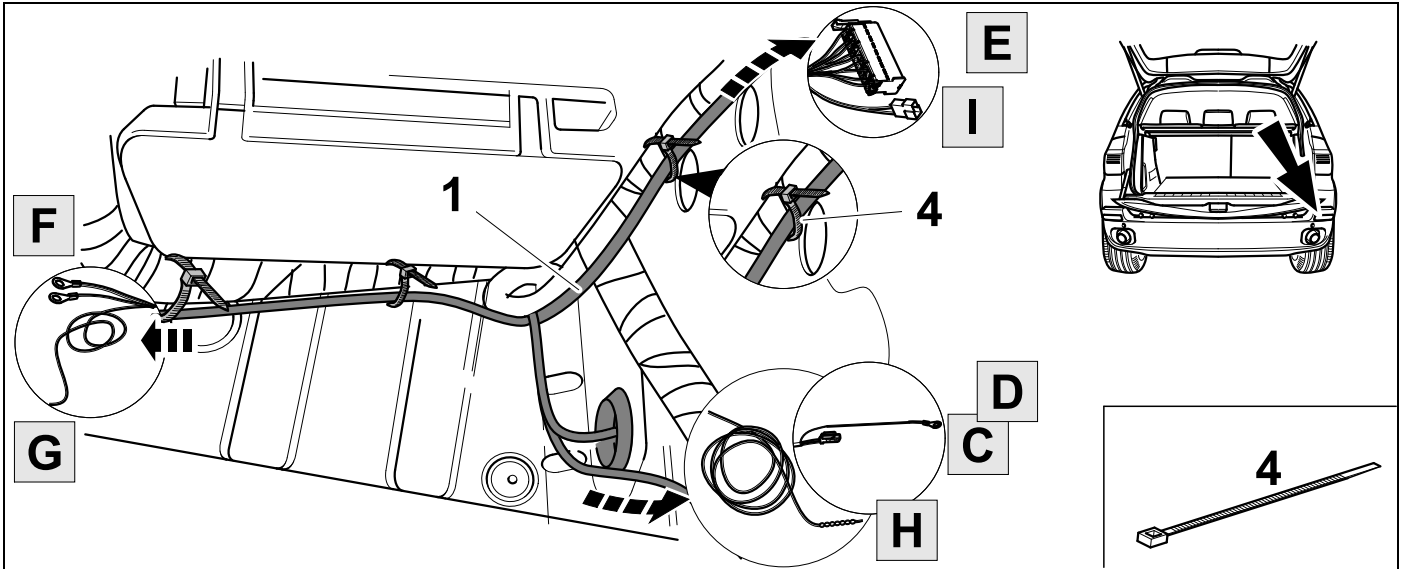

16

X5 / X6

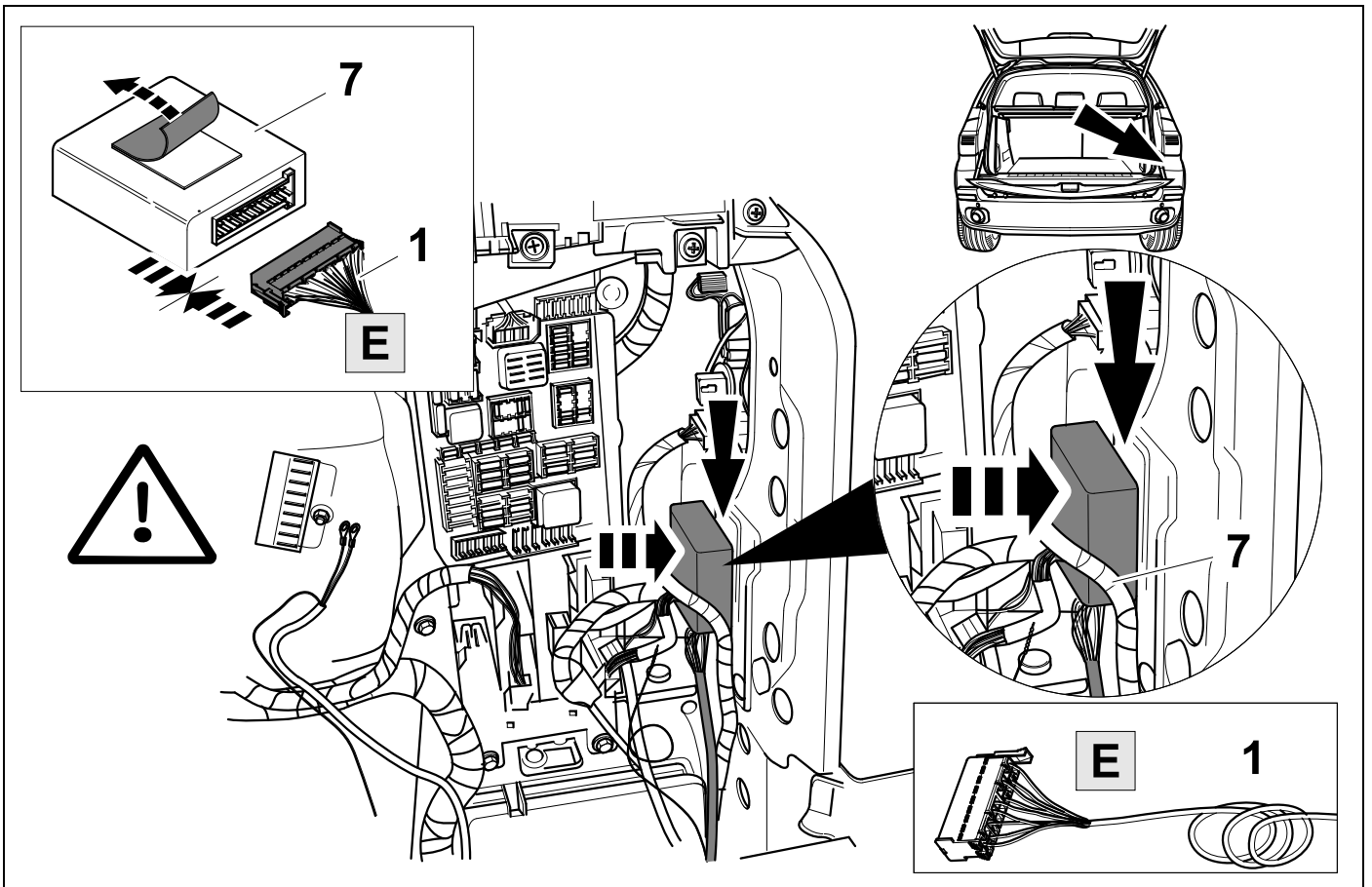

17

X5 / X6

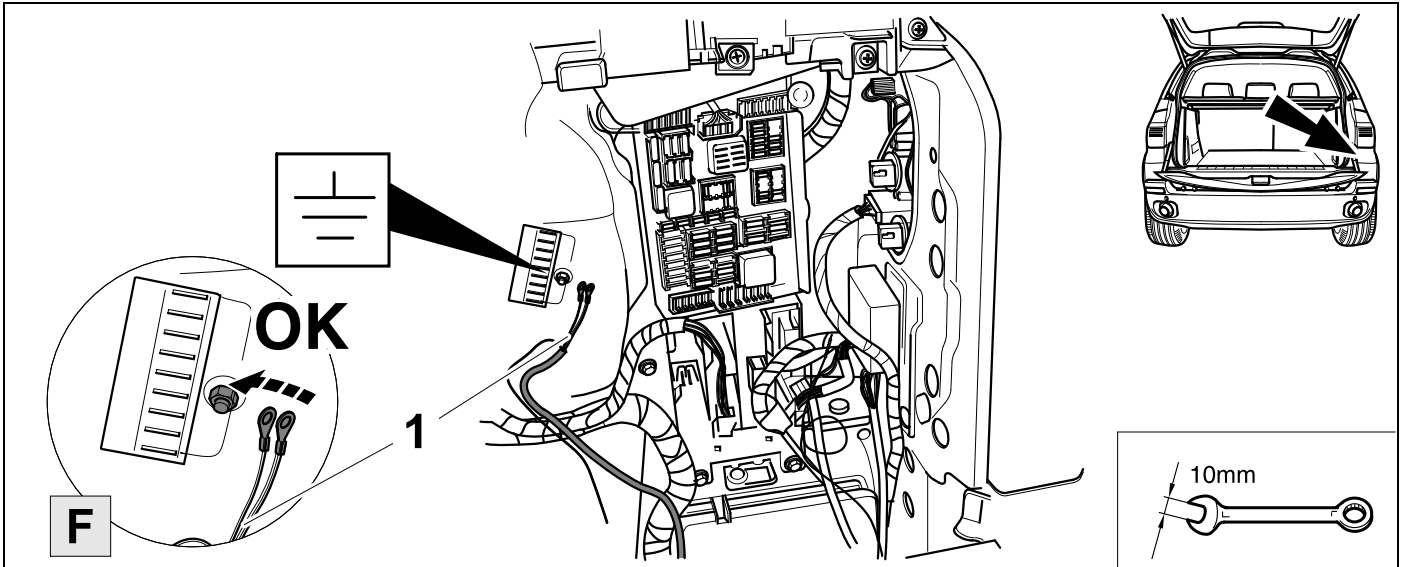

18

👁️ ⇒ 14

X5 / X6

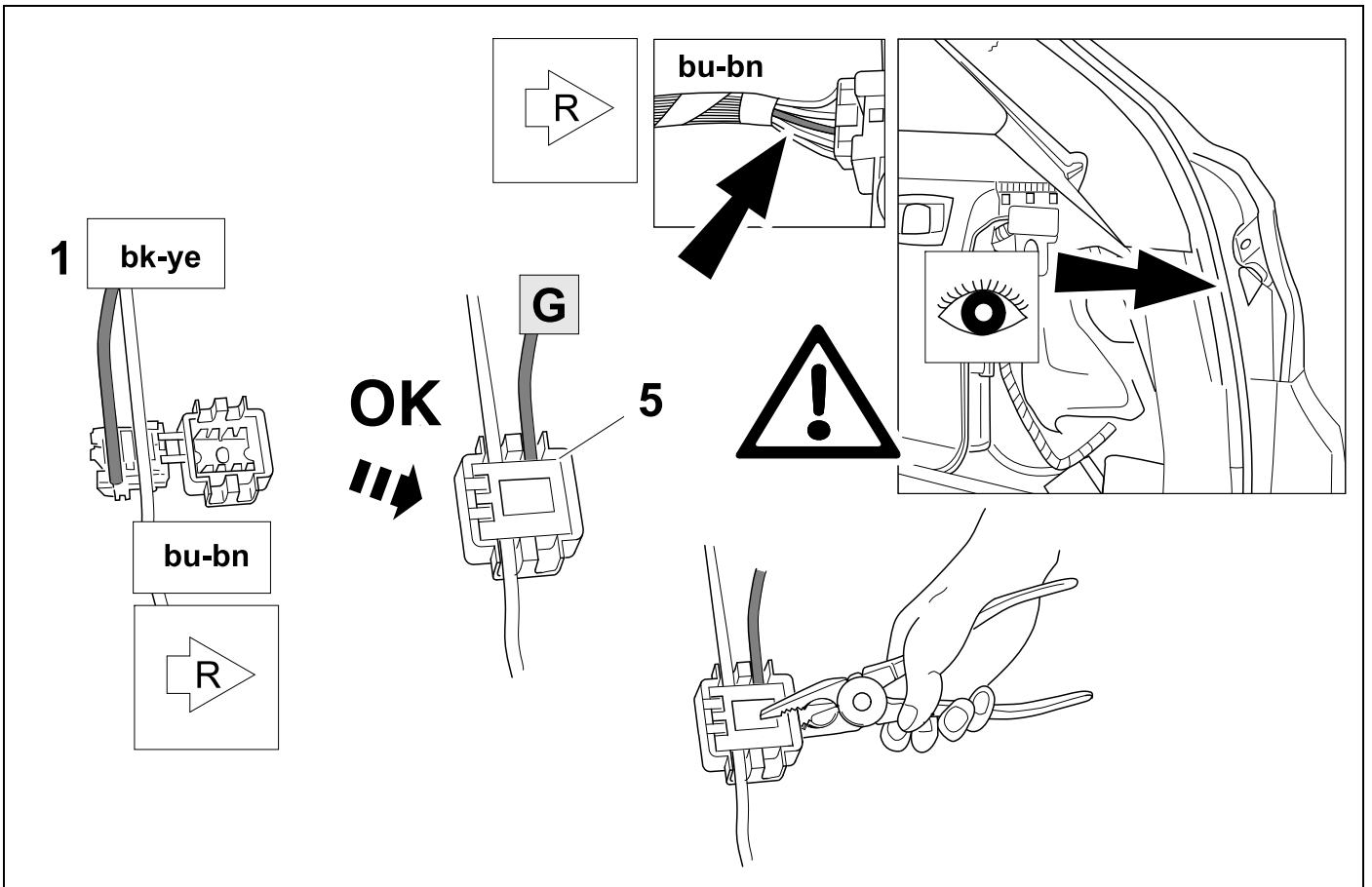

19



14

X5 / X6

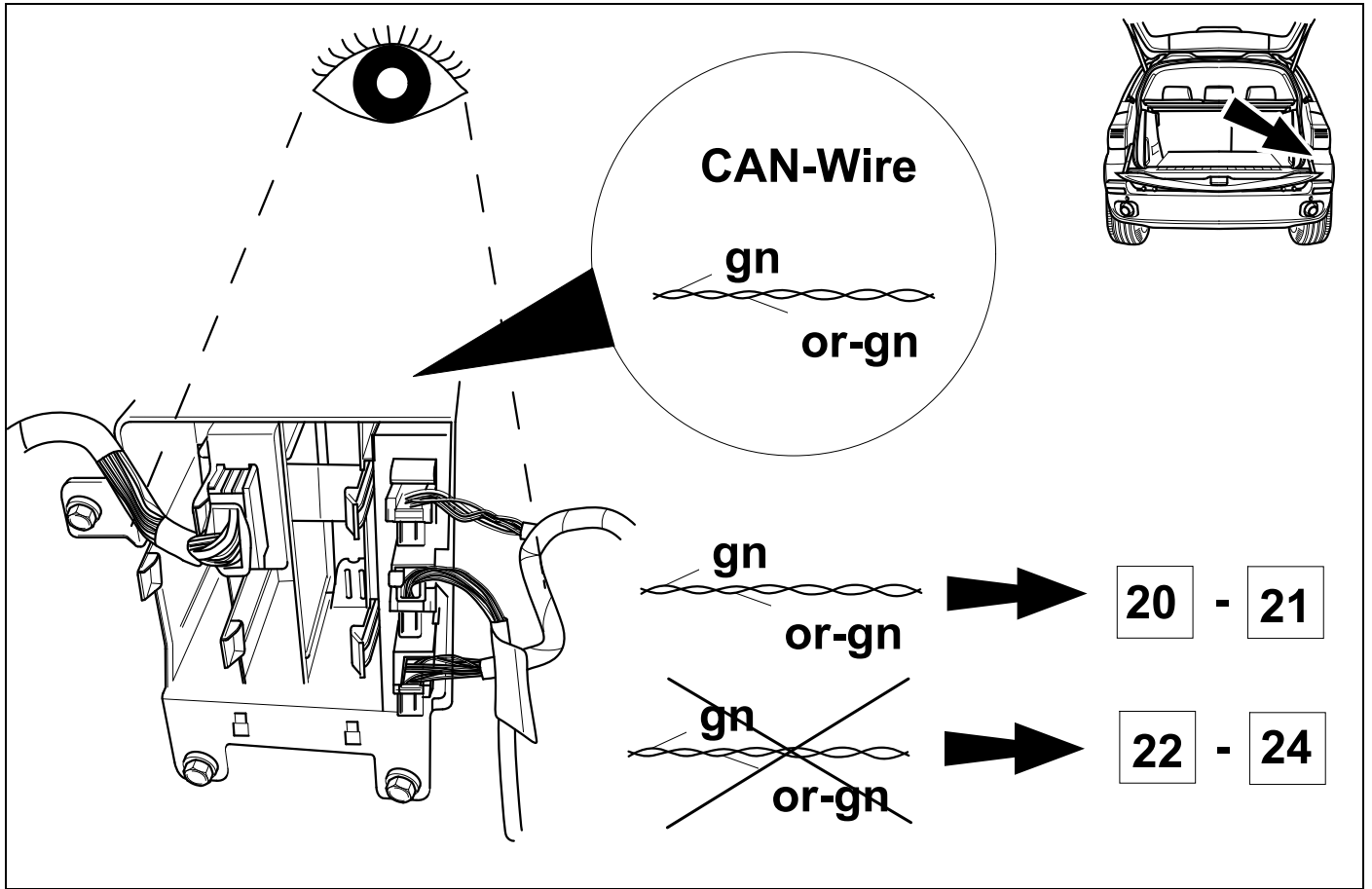

20



14

X5 / X6

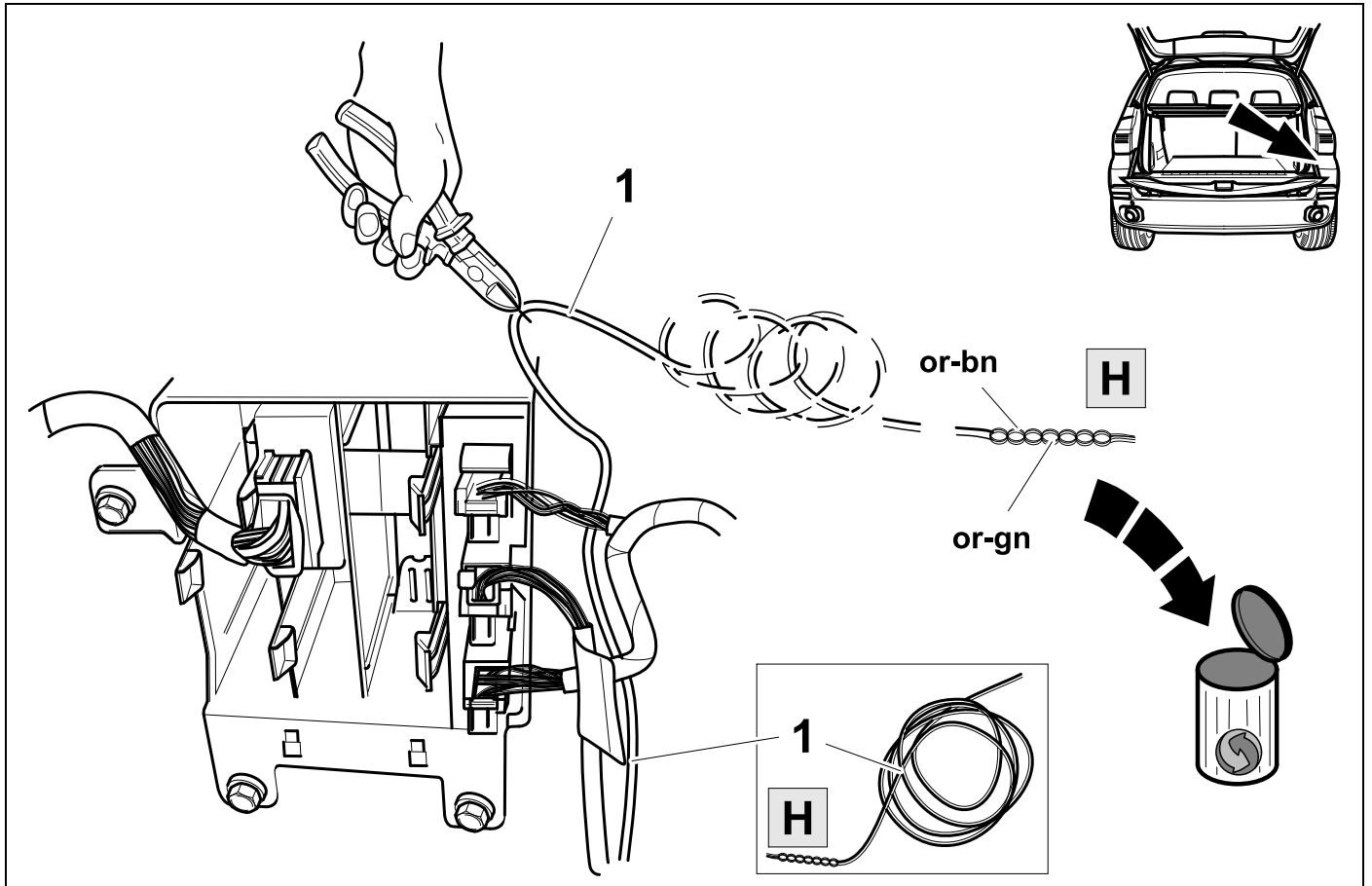

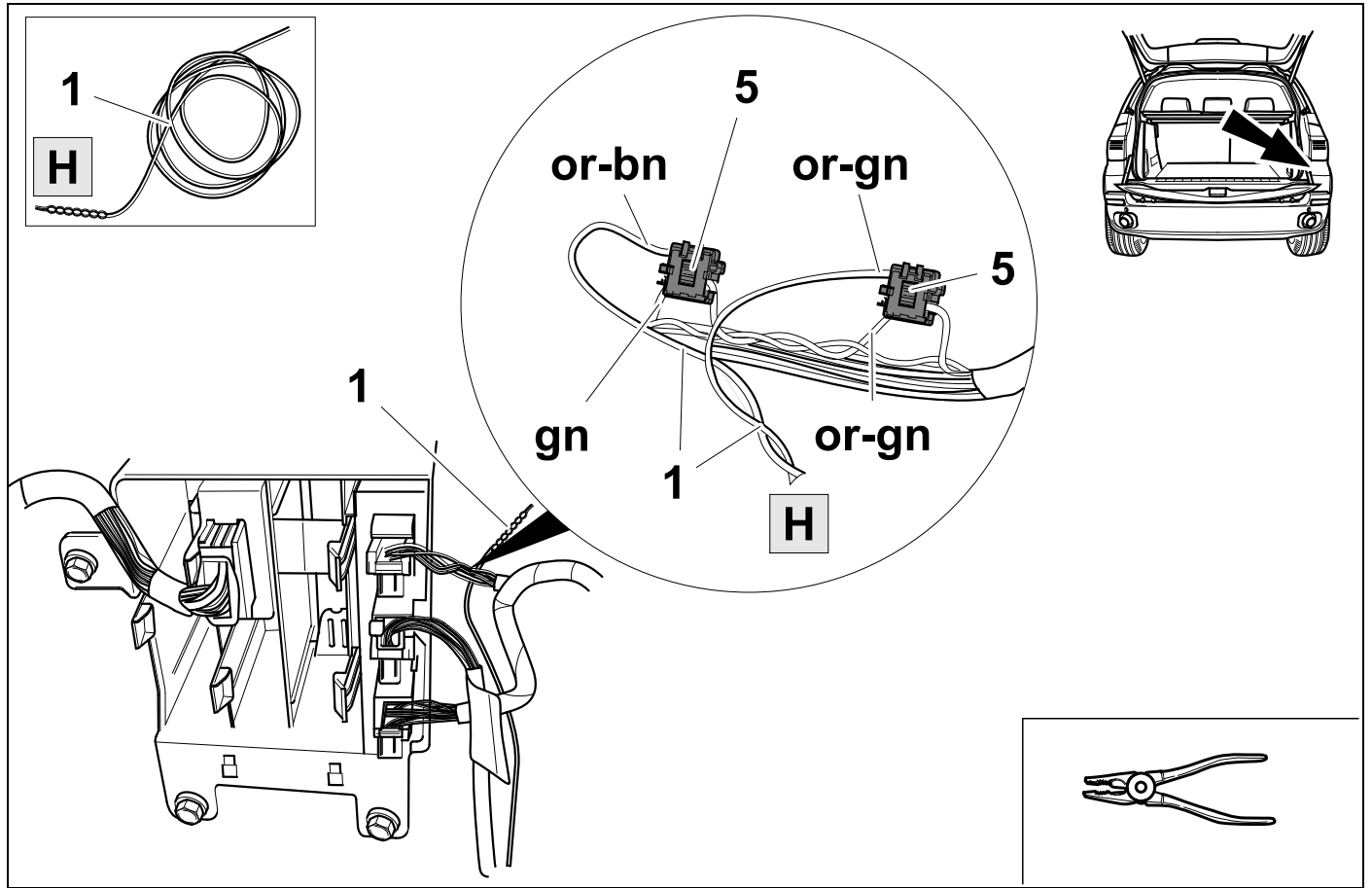

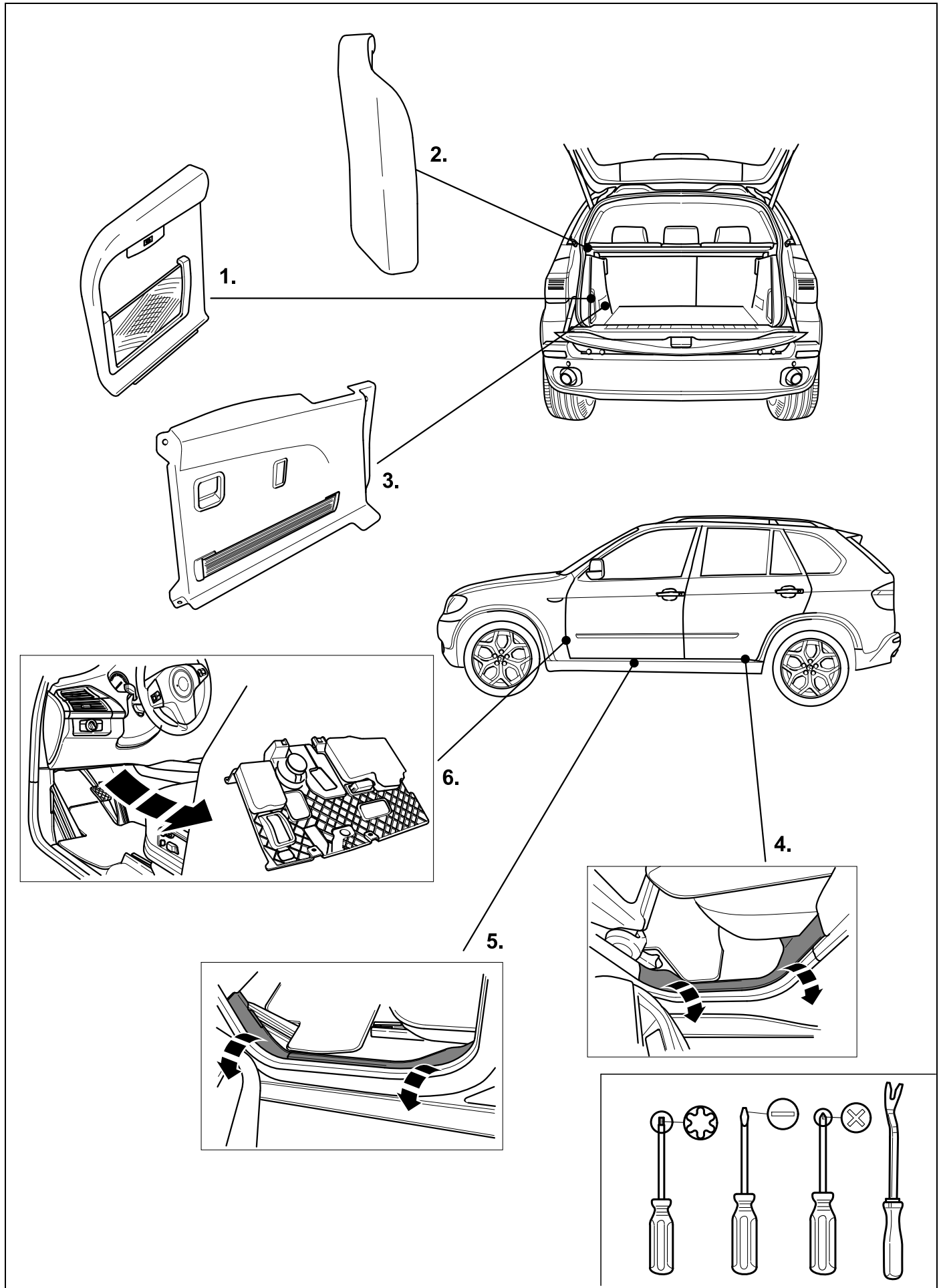

23

X5 / X6

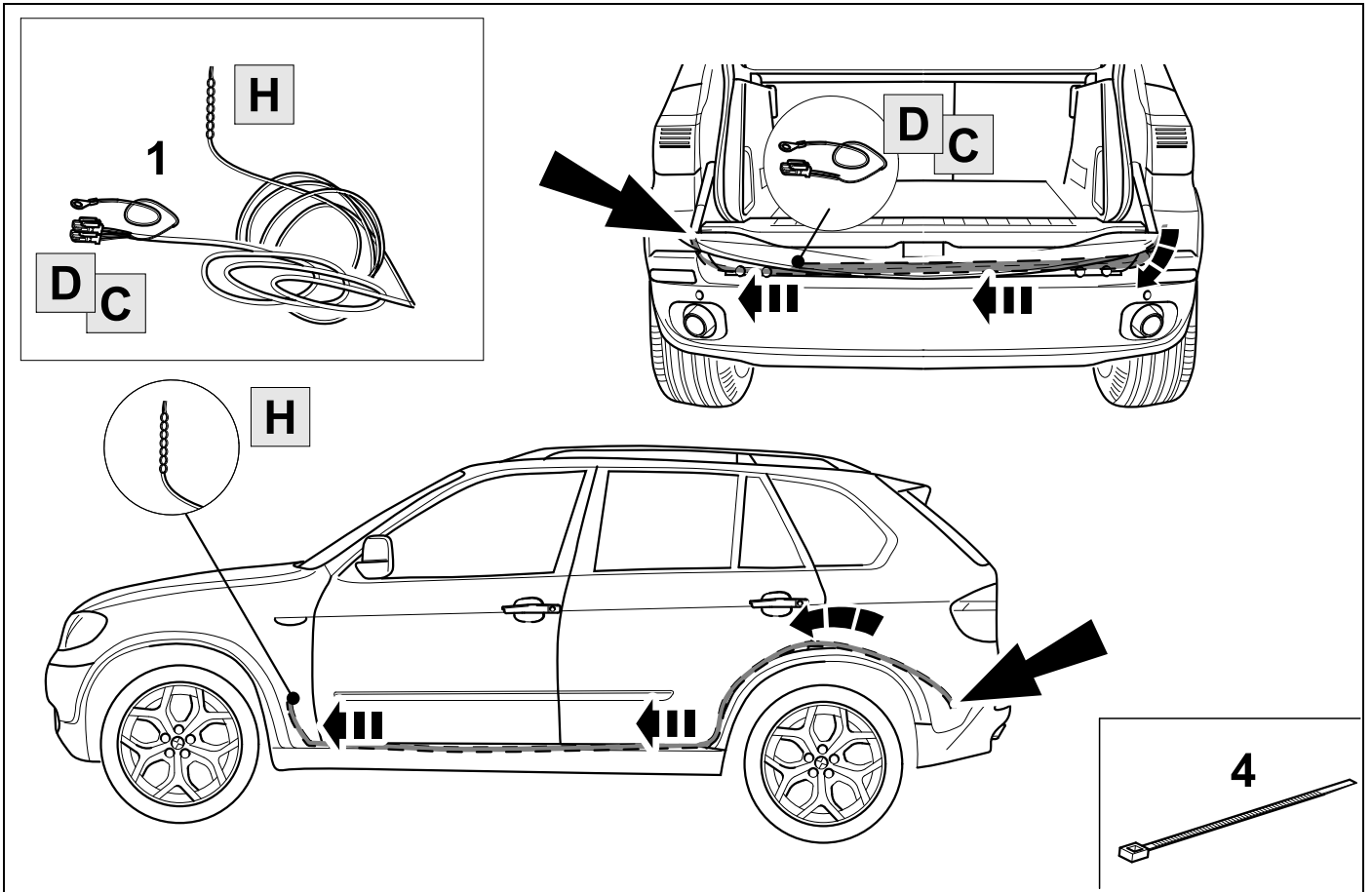

24

X5 / X6

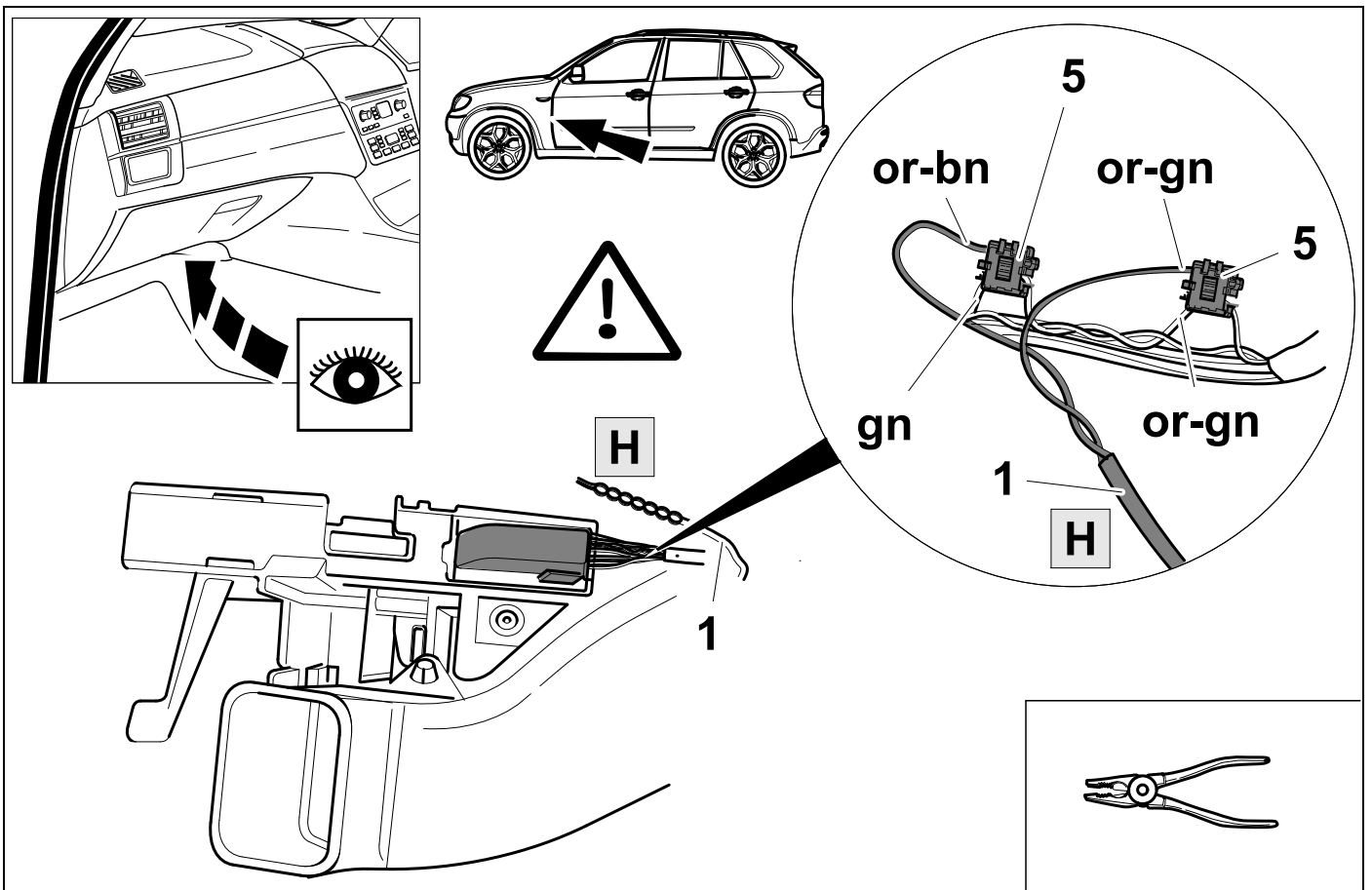

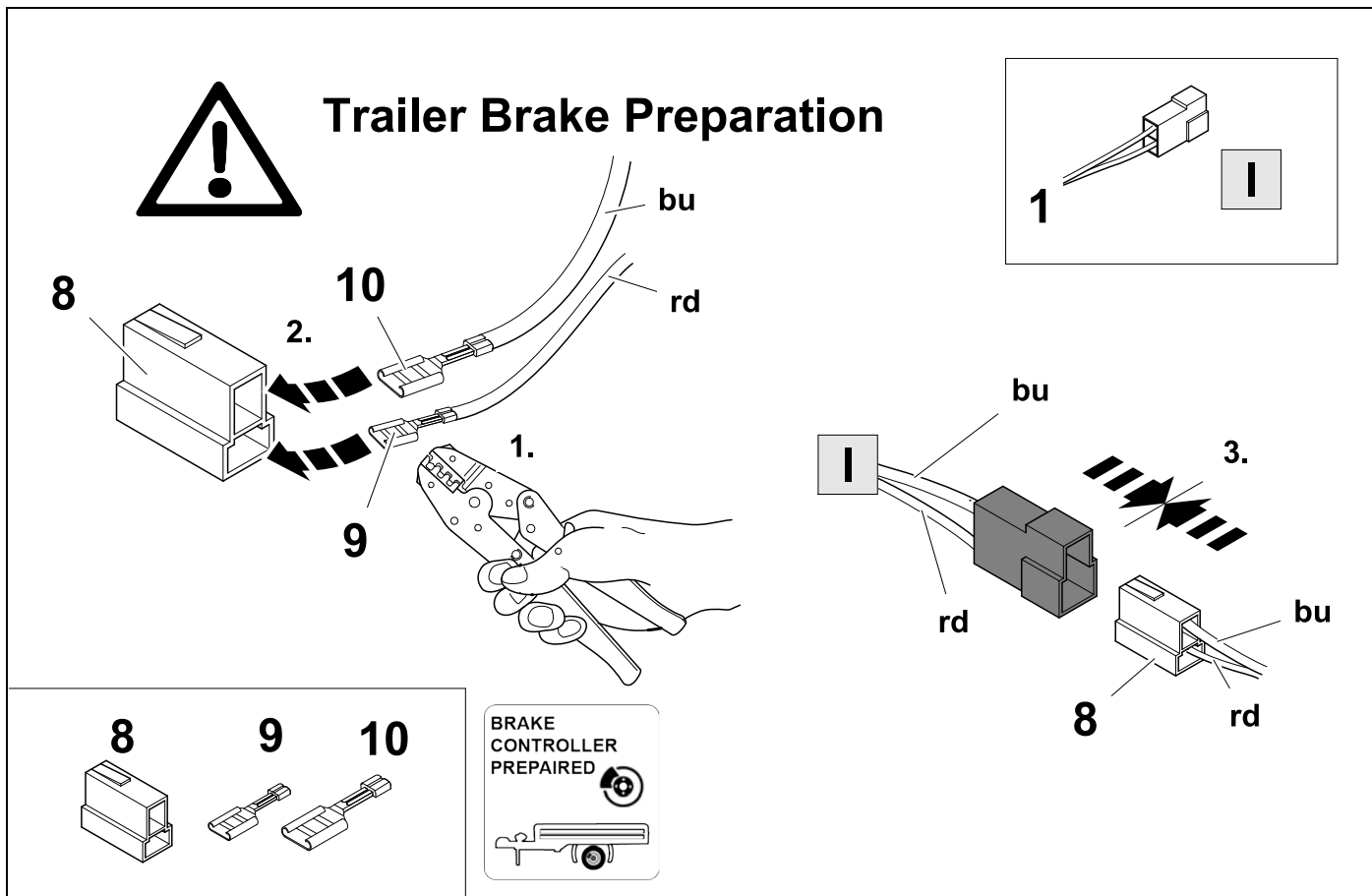
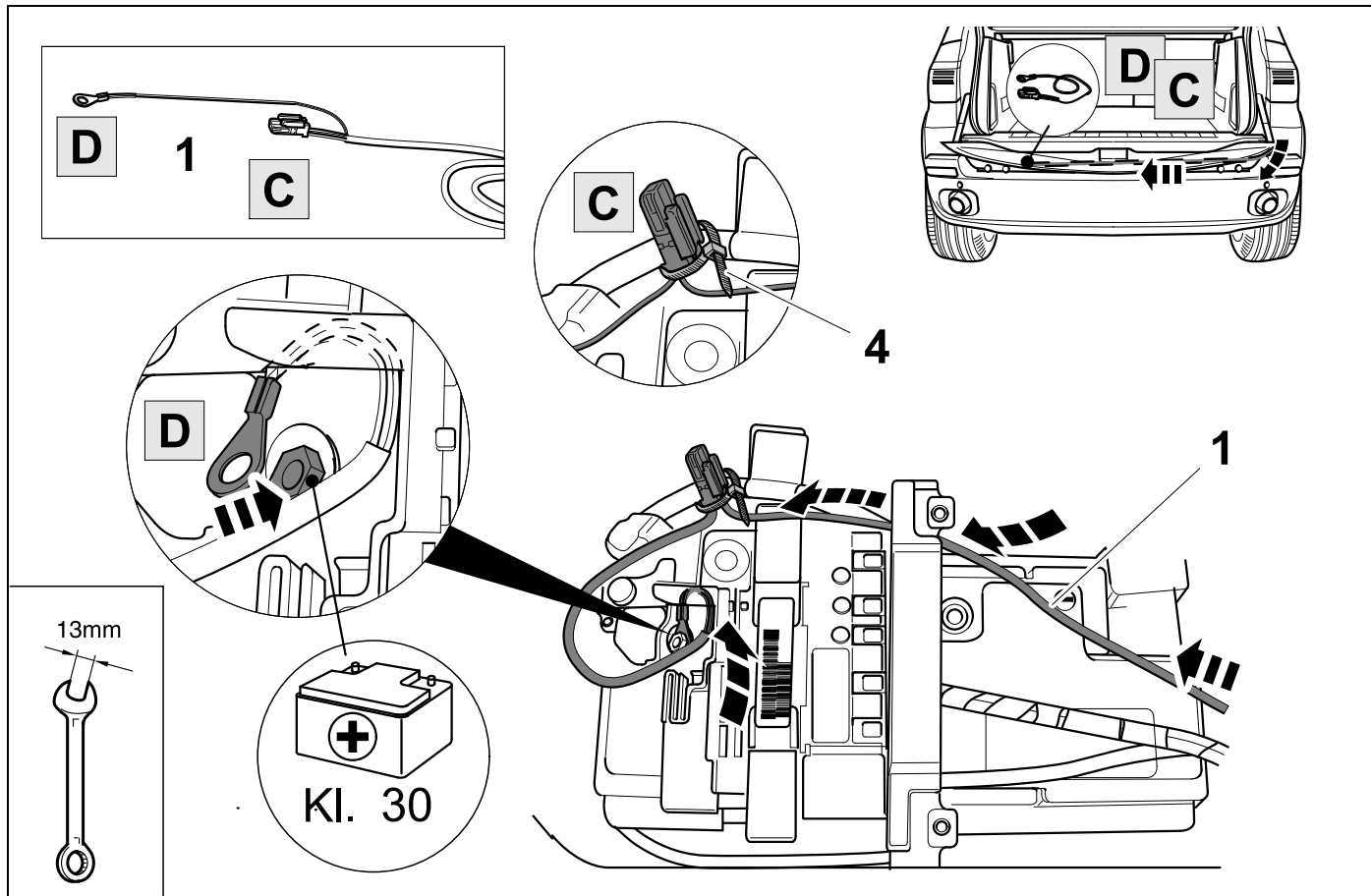

27

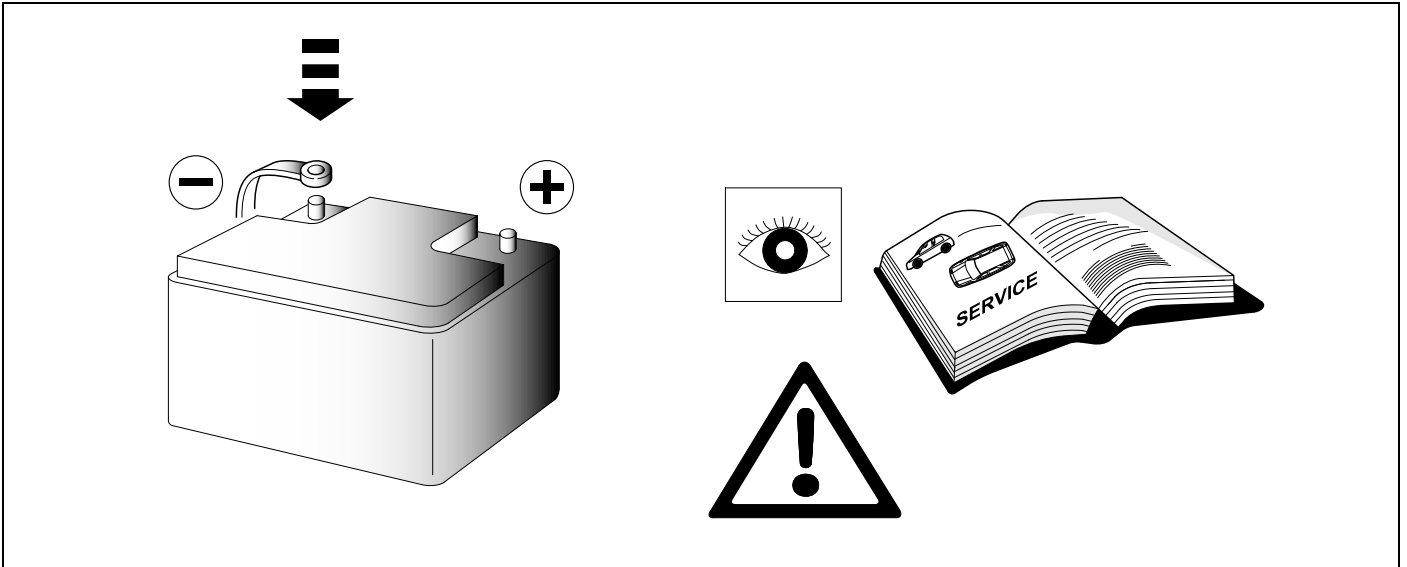

28 CHECK

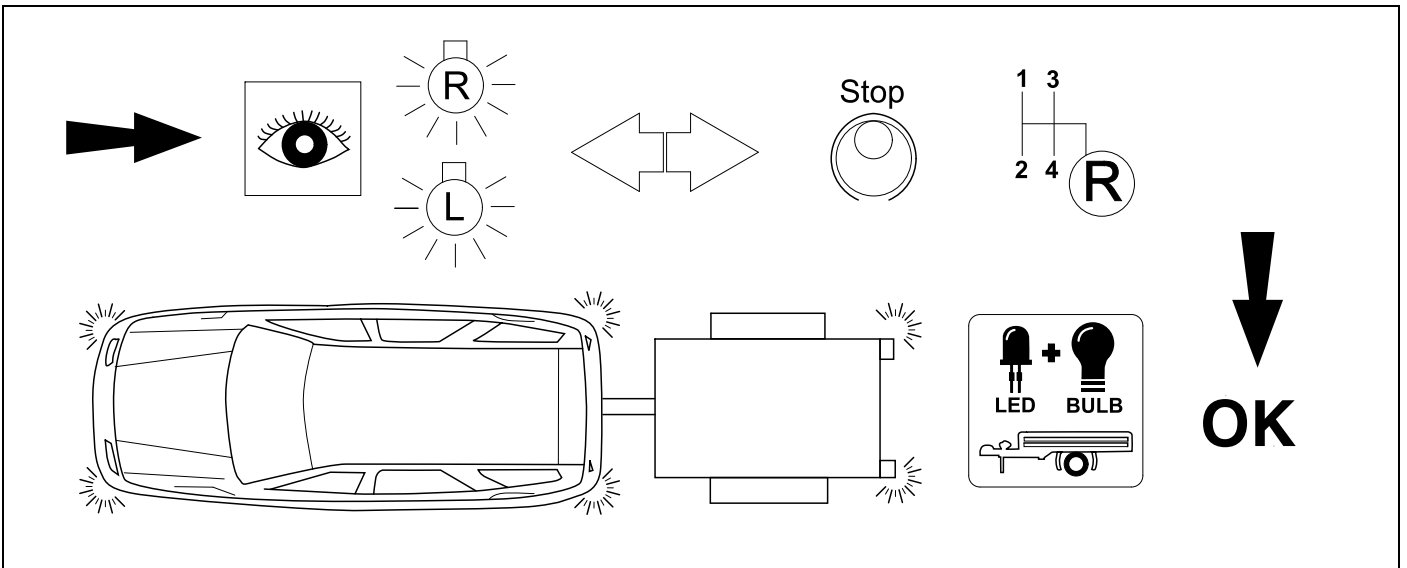

29 CHECK

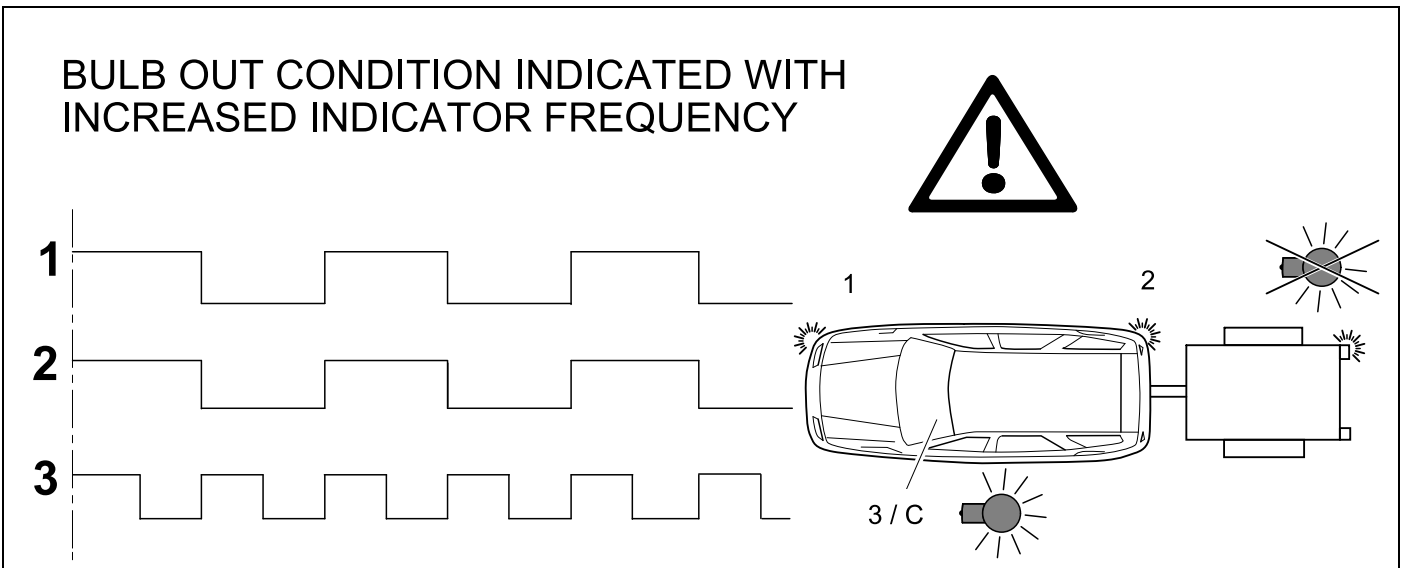

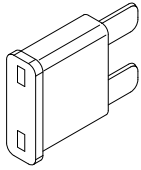

20 A

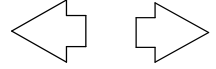
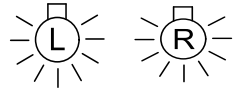
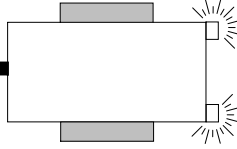

Stop

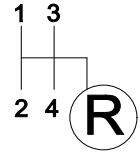

ISTA/P

Do not initialize the trailer module

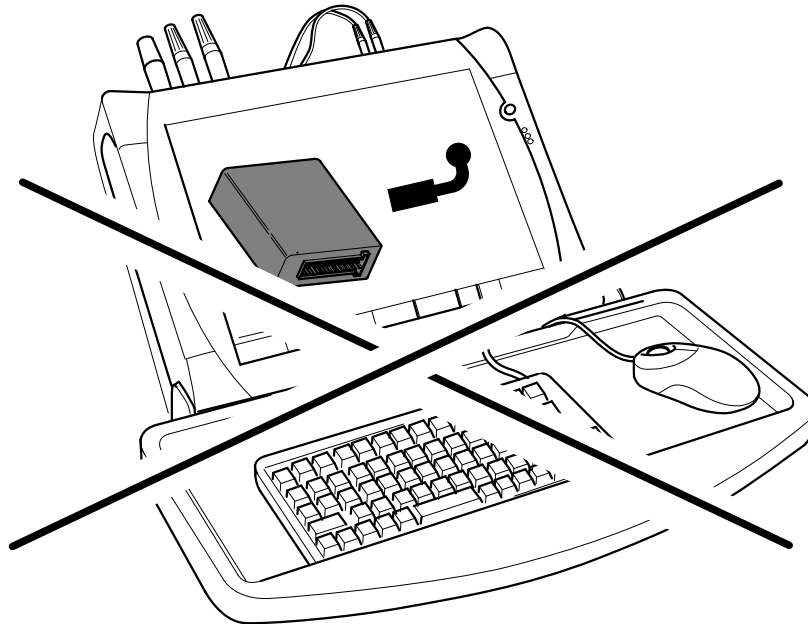

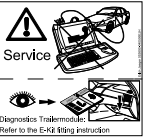

2x 6

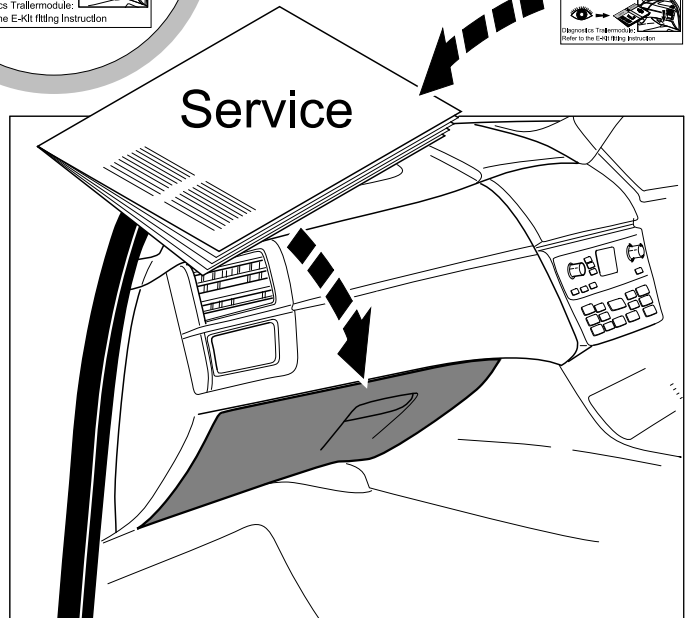
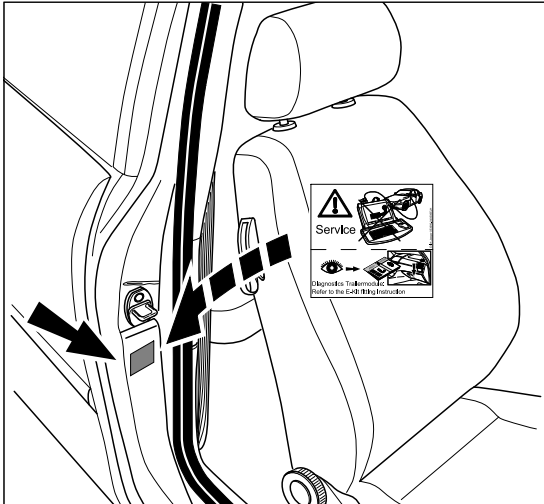
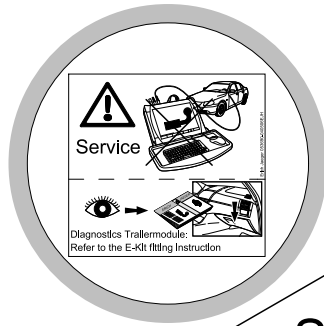

Status LED for self-diagnosis

Operation Support

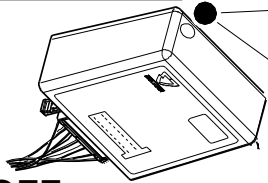
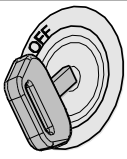

No CAN-Data =



Standby / Sleepmode



Ignition OFF

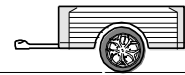
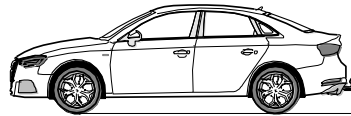
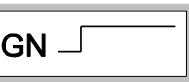
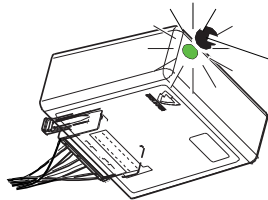

Ignition ON

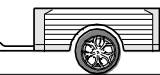
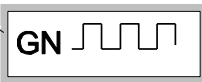
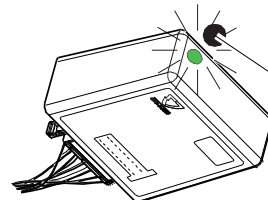

Ignition ON

Failure Support

CAN-Data Wire



1x max. 5 min.

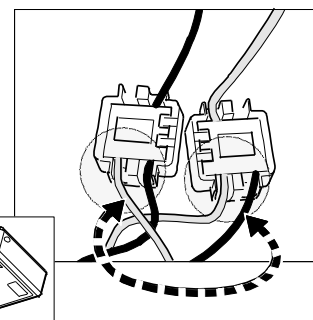
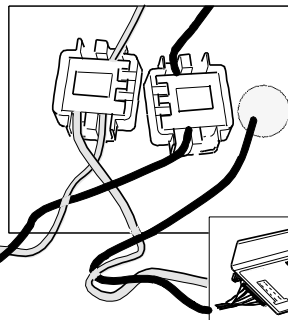
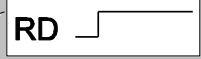
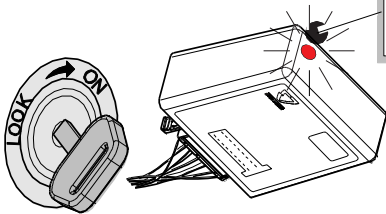

Ignition ON

Failure indicated by the module LED glowing red for a maximum of 5 minutes. If trailer connected the tail lights will also glow indicating failure of CAN signal.

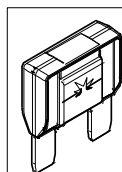
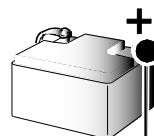
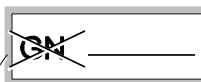
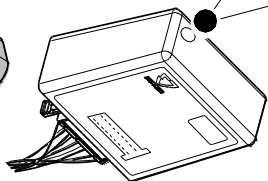
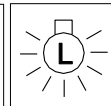
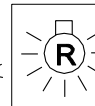

or

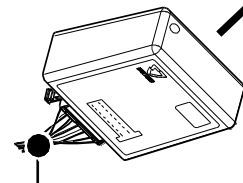

Ignition ON

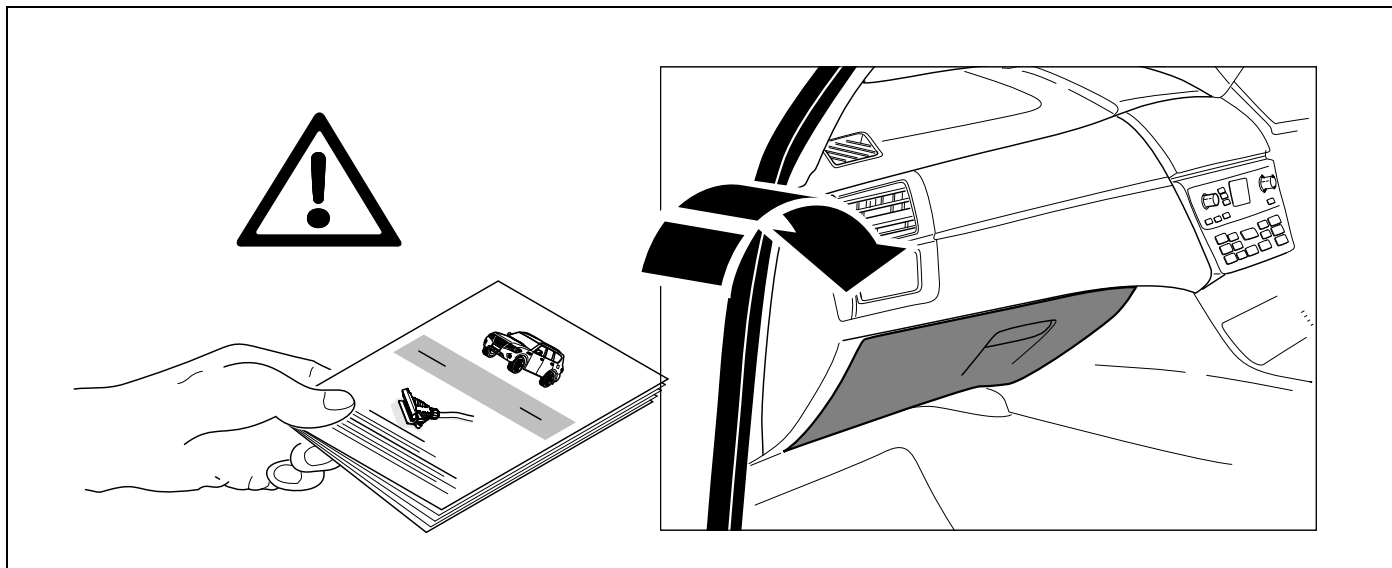

Subject to change in terms of construction, equipment and colour, and may contain errors.
The information and illustrations are non-binding.

Scan this for our full E-Kit catalogue

