

# Wiringkit



- D Einbauanleitung
- GB Installation instructions
- F Consignes de montage
- NL Montagehandleiding
- DK Montagevejledning
- N Monteringsinstruksjon
- S Installationsanvisning
- FIN Asennusohje
- I Istruzioni per il montaggio
- E Instrucciones de montaje
- P Instruções de montagem
- GR Οδηγίες εγκατάστασης
- CZ Návod k montáži
- SLO Navodilo za vgradnjo
- SK Montážny návod
- PL Instrukcja montażu
- TR Montaj talimatı
- H Beépítési útmutató
- HR Upute o ugradnji
- BUL инструкции за монтаж
- RO Instrucțiuni de montaj
- RU Инструкция по монтажу и установке
- LT Montavimo informacija
- LV Iemontēšanas pamacība
- EST Paigaldusjuhend

## 727537 19040510 MERCEDES BENZ

- **C-Class Saloon** W204 03/07 →
- **C-Class Estate** S204 12/07 →
- **C-Class Coupe** C204 06/11 →

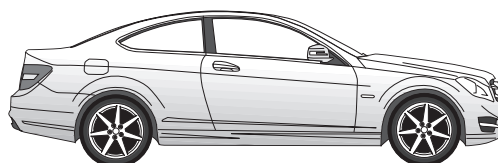
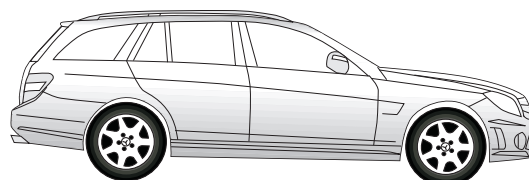
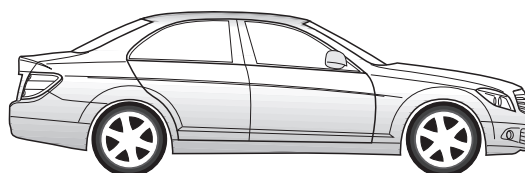

**BRiNK**<sup>®</sup>

Your perfect fit  
brink.eu

# IMPORTANT!



Installation of the towing electrics kit must be undertaken by a specialist workshop or an appropriately qualified person.

Before starting work, you must read the installation instructions through completely. After installing the towing electrics kit, the installation instructions should be kept with the vehicle service documentation.

All claims under the guarantee will lapse in case of improper use or modification of the towing electrics kit or any of its component parts. When driving without a trailer or load carrier, any adapter installed must be removed from the electrical socket. We reserve the right to alter the design, content or colour. We accept no liability for any errors in these instructions. All details and illustrations are non-binding.

In case of missing a rear fog lamp on the trailer, it should be retrofitted.

We accept no responsibility and give no guarantee for technical and electrical modifications made after the initial operation of the towing electrics kit by the vehicle manufacturer and which may lead, for example to malfunction of the trailer socket or its peripheries.

The trailer module is not diagnostics-capable. If the manufacturer's diagnostics processes or software-supported test mechanisms generate error reports directly or indirectly linked with trailer operation, the trailer module must be disconnected from the leads to the trailer socket and a new diagnostic process initiated.

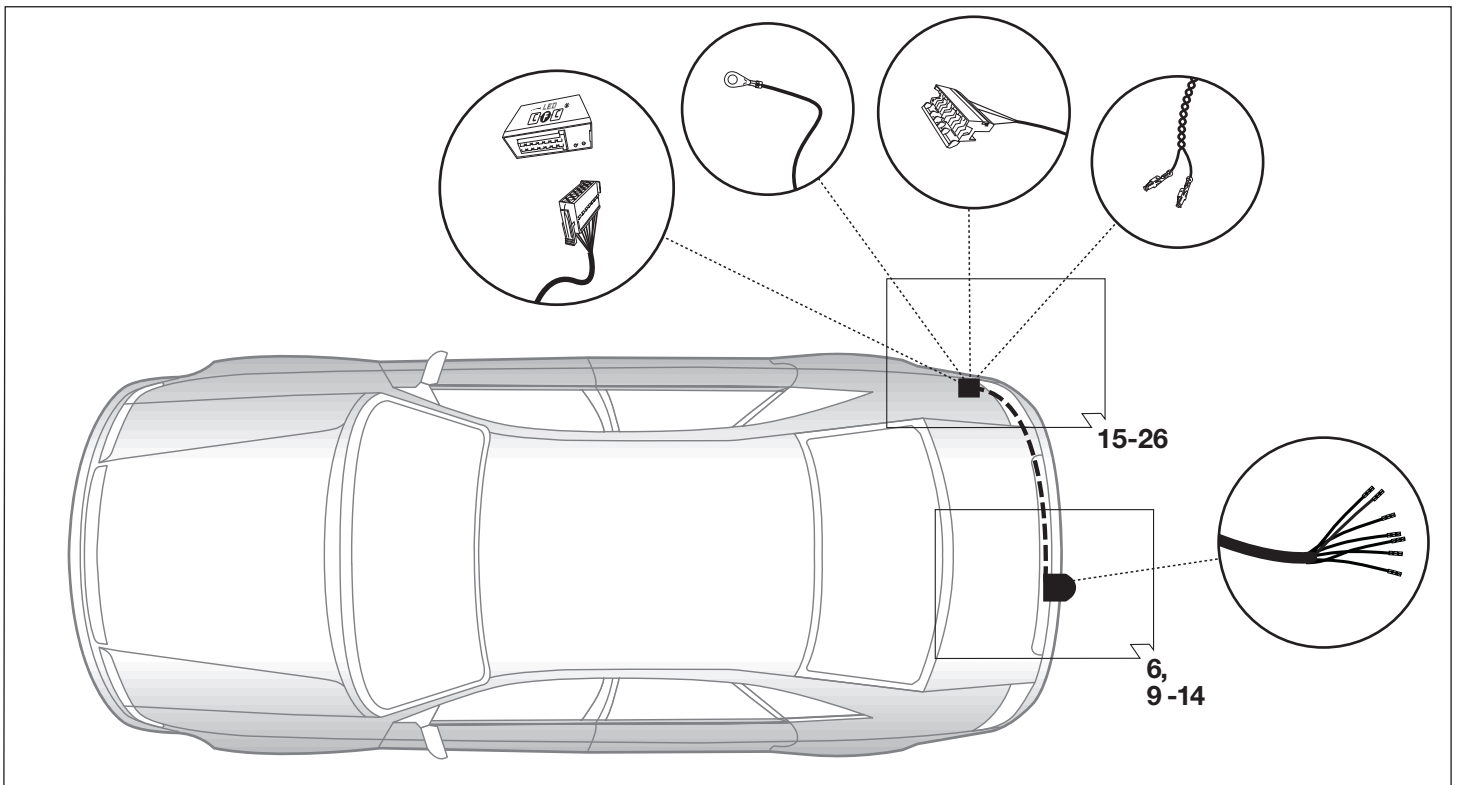
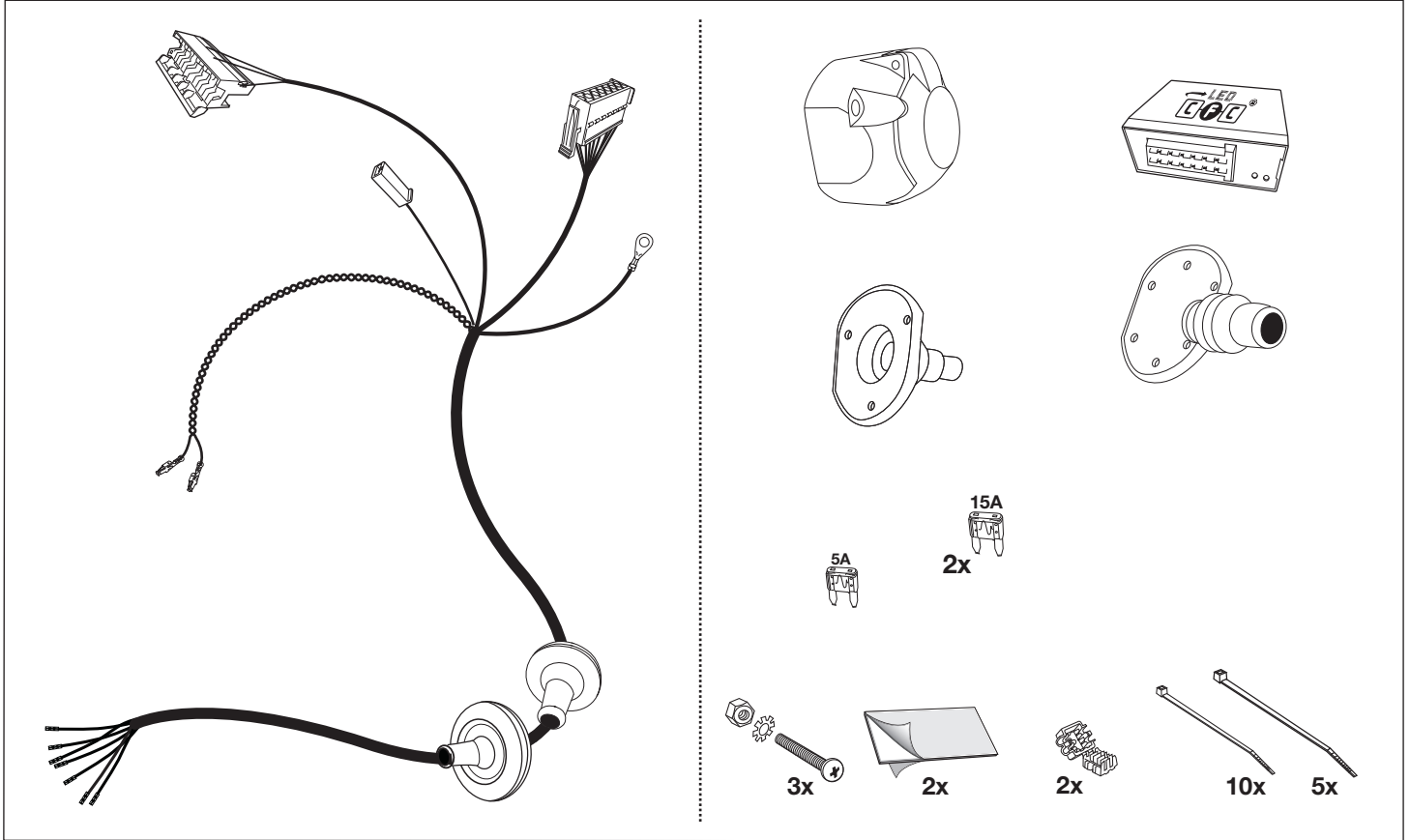

## SYMBOL EXPLANATION

|              |   |
|--------------|---|
|              | left (58-L) respectively<br>right (58-R) tail light             |
|              | stop light (54) /<br>high mounted, third stop light (54)        |
|              | turn signal indicator left                                      |
|              | turn signal indicator right                                     |
|              | rear fog light(s)   |
|              | reversing light(s)  |
|              | Permanent power supply /<br>13pin socket, chamber 9             |
|              | charging wire for trailer battery /<br>13pin socket, chamber 10 |
|              | trailer / trailer recognition                                   |
| <b>B+/30</b> | Permanent current power supply                                  |
|              | Ground or Earth (31)  |
|              | ground connection battery terminal lug                          |
|              | positive connection battery terminal lug                        |
|              | fuse / fuse capacity 20 Ampère                                  |

|  |   |
|--|---|
|  | cigarette lighter /<br>accessory socket |
|  | loudspeaker / buzzer                    |
|  | Park Distance Control                   |
|  | switch / source of function             |
|  | Connect together                        |
|  | Disconnect                              |
|  | Look at / See further information       |
|  | Look carefully at selected area         |
|  | Present / Occupied / OK                 |
|  | Not present / Not occupied / Not OK     |
|  | left                                    |
|  | right                                   |
|  | acoustic indication                     |
|  | attention / important advice            |

## Tools

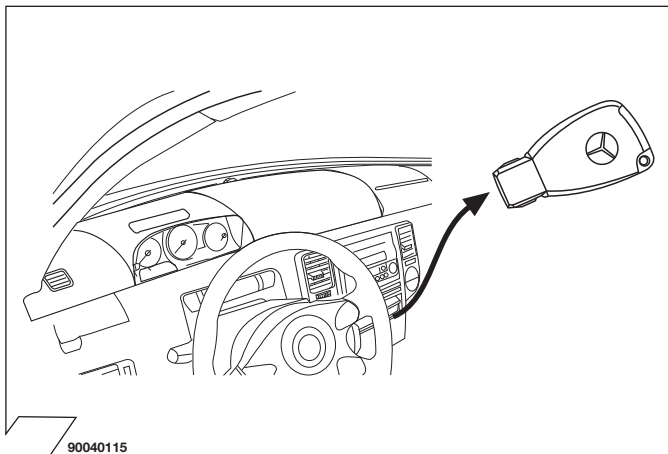
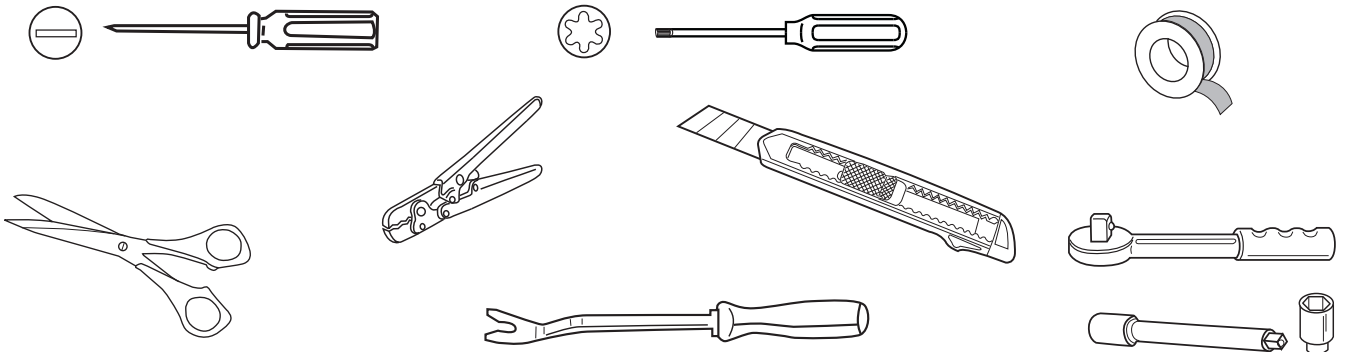

90040115

1

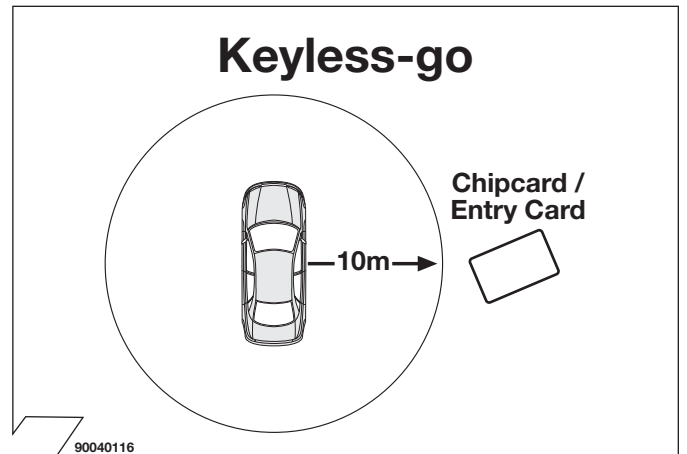

## Keyless-go

Chipcard /  
Entry Card

10m

90040116

2

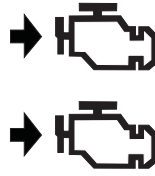
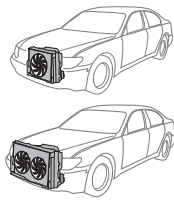

### ATTENTION!

The vehicle's cooling capacity may have to be increased when retrofitting a trailer coupling!  
You must observe the manufacturer's instructions!!

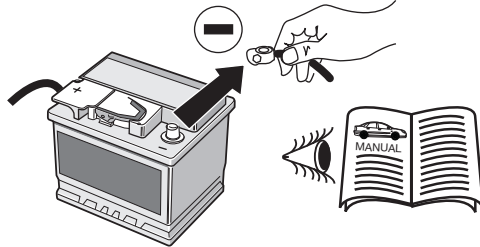

### ATTENTION!

In order to avoid mal-functions and damage to the vehicle's electrical system the earth terminal **must be disconnected** from the vehicle's battery **before starting work!**

Both the trailer module and the vehicle's control unit for the electrical system can be damaged during work on the data bus connections if the battery is not disconnected!

Please pay attention to the manufacturer's instructions when disconnecting and reconnecting the vehicle's battery!

3

### C-Class W204 Saloon



### C-Class C204 Coupe



1.

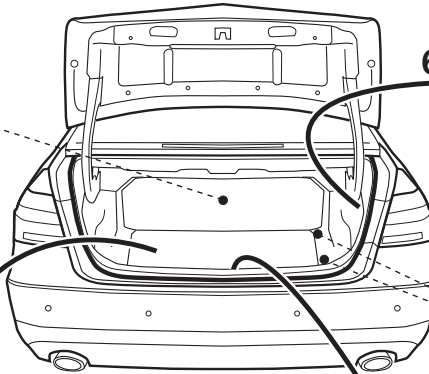

2.

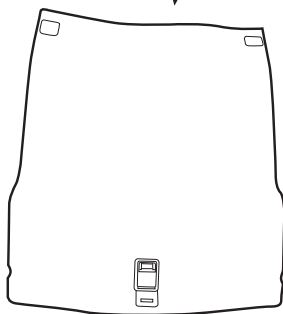

6.

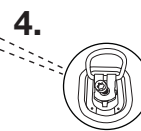
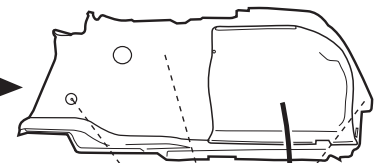

5.

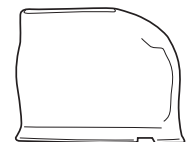

3.

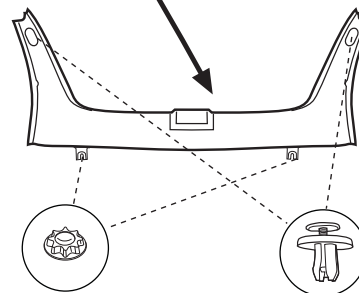

4

# C-Class S204 Estate

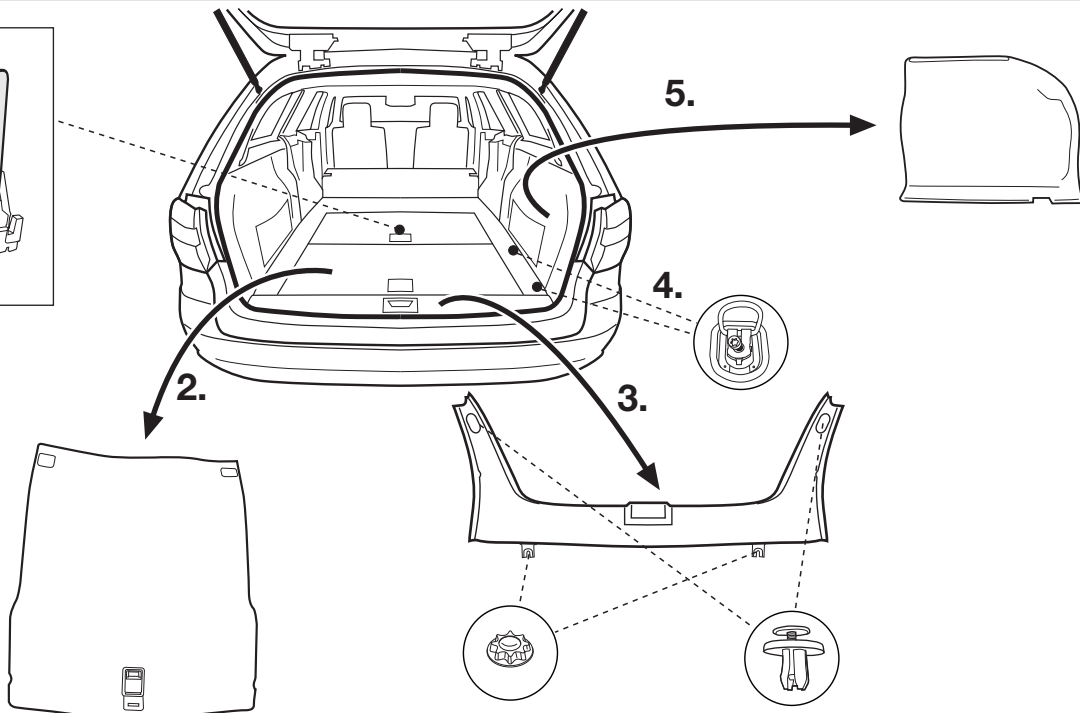
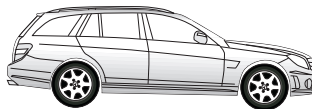

5

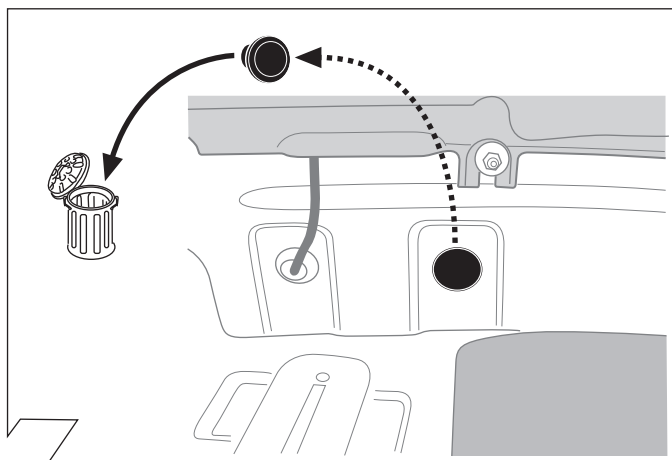

6

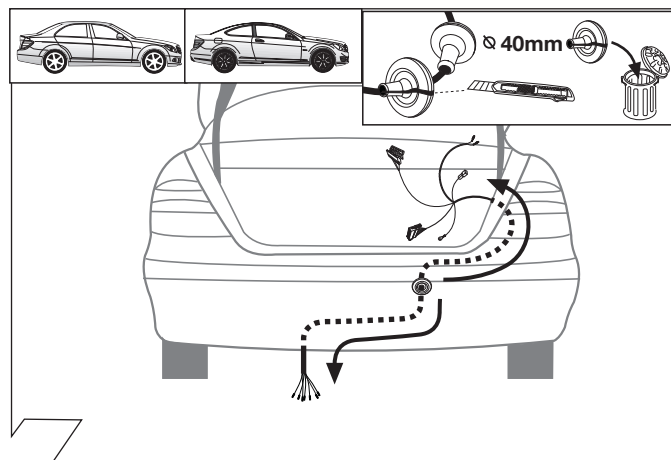

7

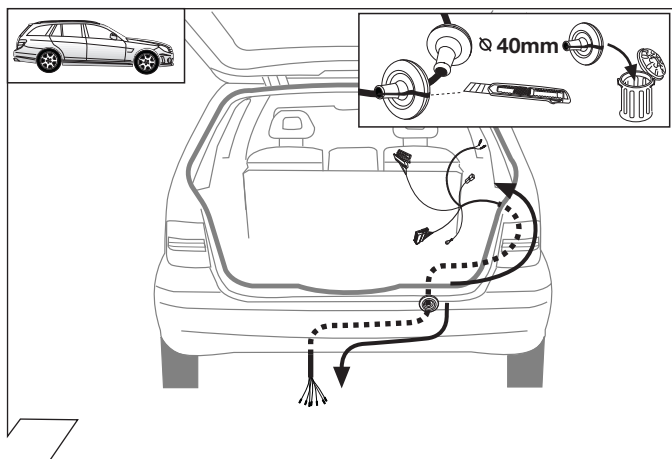

8

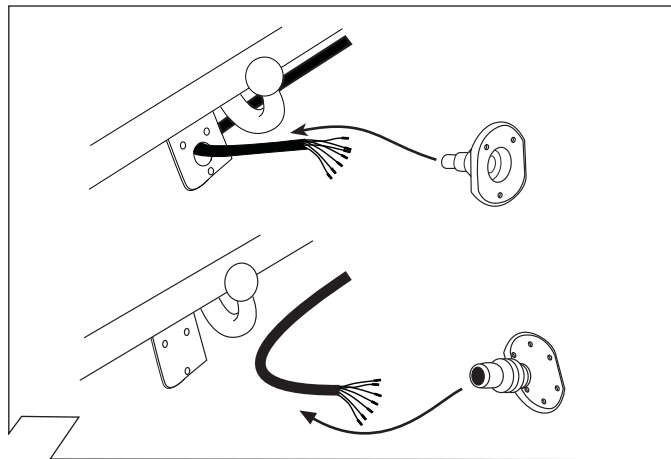

9

| ISO 1724 | Belegung der Steckdose / Maximale Ausgangsleistung<br>Socket configuration / Maximum power output<br>Correspondance des contacts de la prise / Puissance de sortie maxima<br>Abbinamento della presa / Uscita di alimentazione massima<br>Indeling van de steekdoos / maximaal uitgangsvermogen |       |     |  |
|----------|---|-------|-----|--|
|          | 1/L   | BK/WT | 21W |  |
|          | 2   | WT    | 42W |  |
|          | 3/31  | BR    |     |  |
|          | 4/R   | BK/GN | 21W |  |
|          | 5/58-R  | GY/RD | 52W |  |
|          | 6/54  | BK/RD | 63W |  |
|          | 7/58-L  | GY/BK | 52W |  |

10

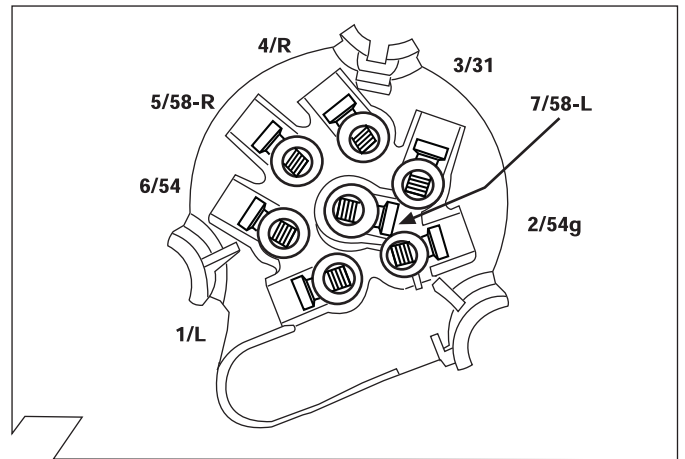

11

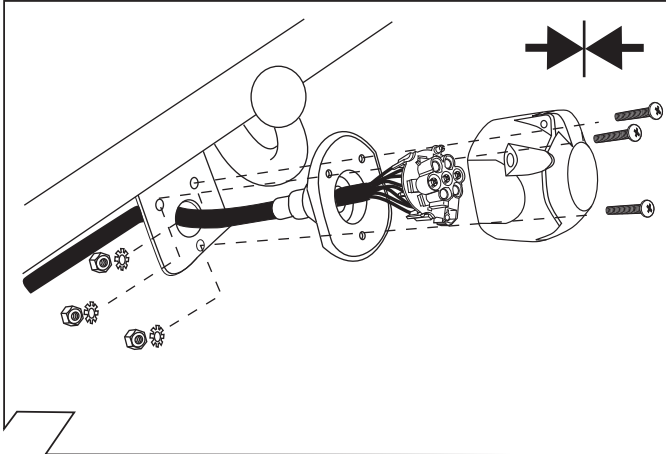

12

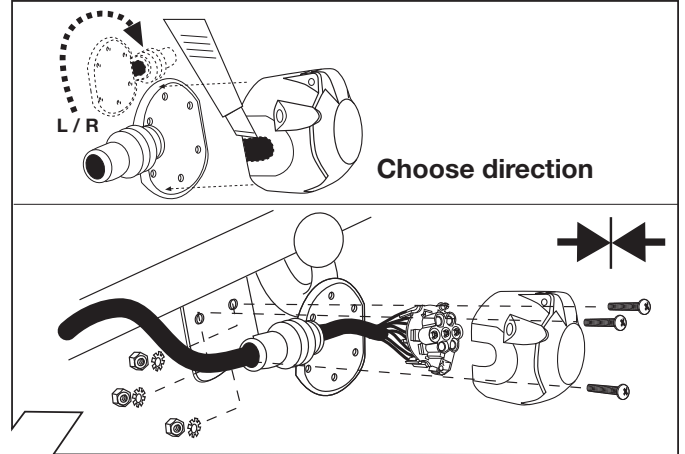

13

|           | (GB)   | (D)     | (E)      | (F)    | (I)       | (P)         | (NL)   | (DK)   | (N)     | (S)     | (FIN)     | (CZ)     | (H)       | (PL)         | (GR)      | (RUS)      |
|-----------|--------|---------|----------|--------|-----------|-------------|--------|--------|---------|---------|-----------|----------|-----------|--------------|-----------|------------|
| <b>BK</b> | Black  | Schwarz | Negro    | Noir   | Nero      | Preto       | Zwart  | Sort   | Svart   | Svart   | Musta     | Černá    | Fekete    | Czarny       | μαύρος    | черный     |
| <b>RD</b> | Red    | Rot     | Rojo     | Rouge  | Rosso     | Vermelho    | Rood   | Rød    | Rød     | Röd     | Punainen  | Červená  | Piros     | Czerwony     | κόκκινος  | красный    |
| <b>GN</b> | Green  | Grün    | Verde    | Vert   | Verde     | Verde       | Groen  | Grøn   | Grønt   | Grön    | Vihreä    | Zelená   | Zöld      | Zielony      | πράσινος  | зеленый    |
| <b>OR</b> | Orange | Orange  | Naranja  | Orange | Arancione | Laranja     | Oranje | Orange | Orange  | Orange  | Oranssi   | Oranzová | Narancs   | Pomarańczowy | πορτοκαλί | оранжевый  |
| <b>VT</b> | Violet | Violett | Violeta  | Violet | Viola     | Violeta     | Violet | Violet | Fiolett | Violett | Violetti  | Fialová  | Ibolya    | Fioletowy    | βιολέτα   | фиолетовый |
| <b>PK</b> | Pink   | Pink    | Pink     | Rose   | Rosa      | Cor-de-Rosa | Paars  | Pink   | Pink    | Rosa    | Pinkki    | Ružová   | Rózsaszín | Różowy       | Μωβ       | розовый    |
| <b>BL</b> | Blue   | Blau    | Azul     | Bleu   | Blu       | Azul        | Blauw  | Blá    | Blátt   | Blá     | Sininen   | Modrá    | Kék       | Niebieski    | μπλε      | синий      |
| <b>YL</b> | Yellow | Gelb    | Amarillo | Jaune  | Giallo    | Amarelo     | Geel   | Gul    | Gult    | Gul     | Keltainen | Zlutá    | Sárga     | Zólyt        | κίτρινος  | желтый     |
| <b>WT</b> | White  | Weiss   | Blanco   | Blanc  | Bianco    | Branco      | Wit    | Hvid   | Hvitt   | Vit     | Valkoinen | Bílá     | Fehér     | Biały        | λευκός    | белый      |
| <b>BR</b> | Brown  | Braun   | Marrón   | Brun   | Marrone   | Marrom      | Bruin  | Brun   | Brunt   | Brun    | Ruskea    | Hnědá    | Barna     | Brazowy      | καφέ      | коричневый |
| <b>GY</b> | Grey   | Grau    | Gris     | Gris   | Grigio    | Cinzeno     | Grijs  | Grå    | Grått   | Grå     | Harmaa    | Sedá     | Szürke    | Szary        | Γκρι      | серый      |

14

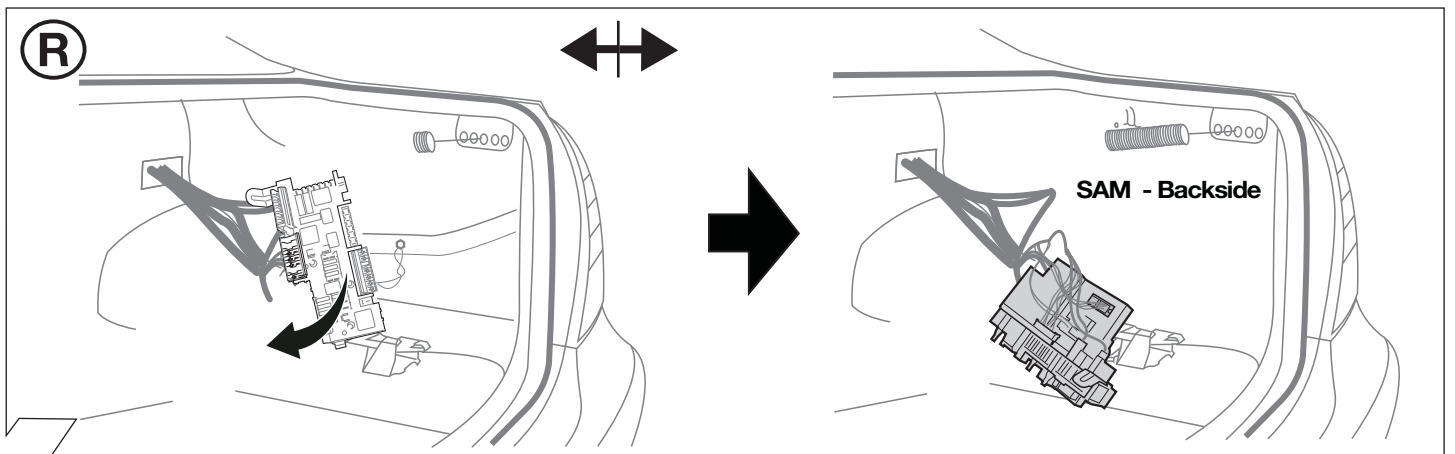

15

connector 28 pin BL available



17 - 22  
25 - 36

connector 28 pin BL not available



21 - 36

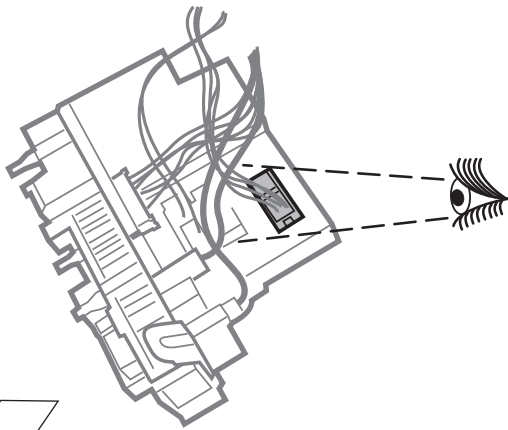

16

(R)

connector 28 pin BL

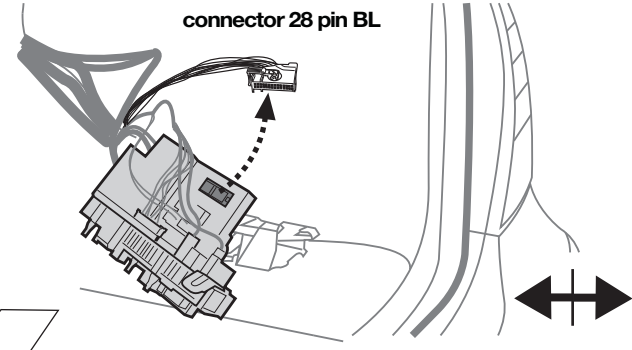

17

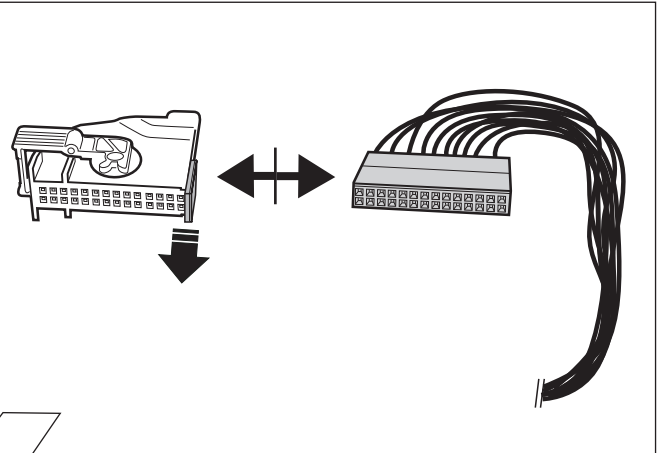

18

### CAN-Data wire

chamber 9 YL

BK chamber 10

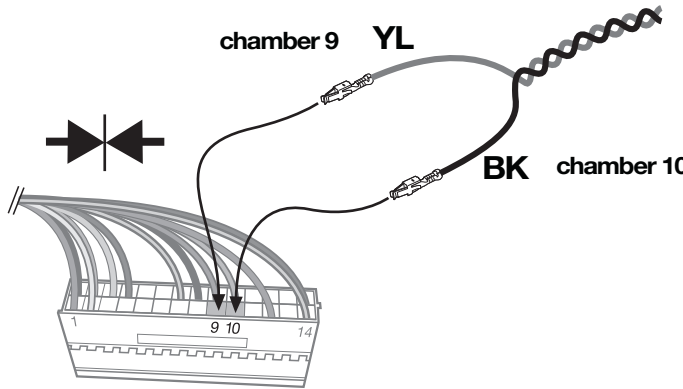

**Wichtig!**  
Unbedingt Hinweise  
aus Bild 3 beachten!

19

(R)

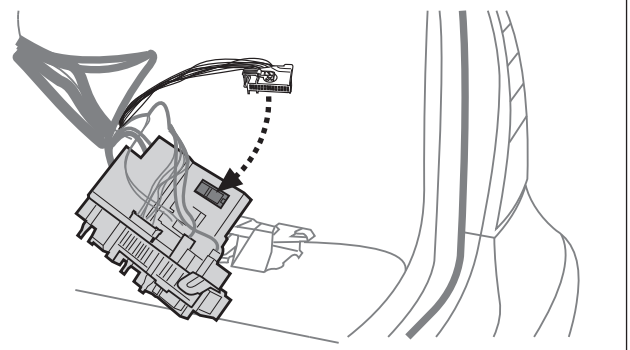
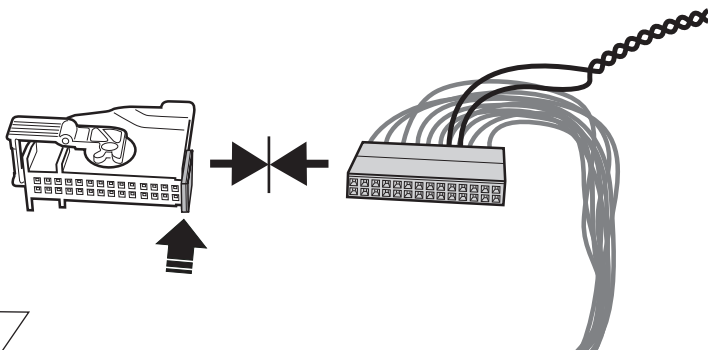

20



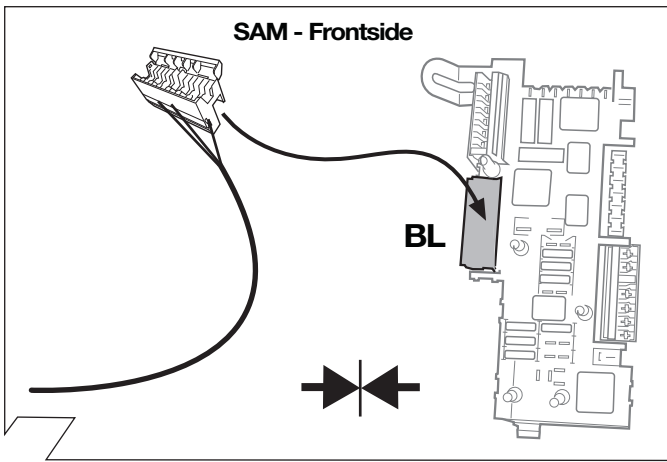

21

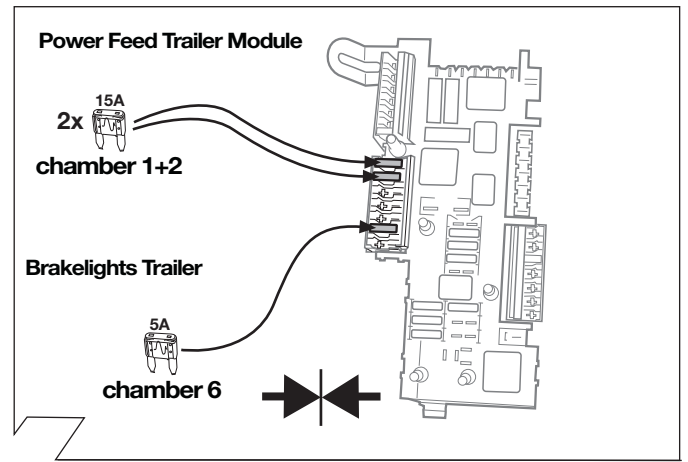

22

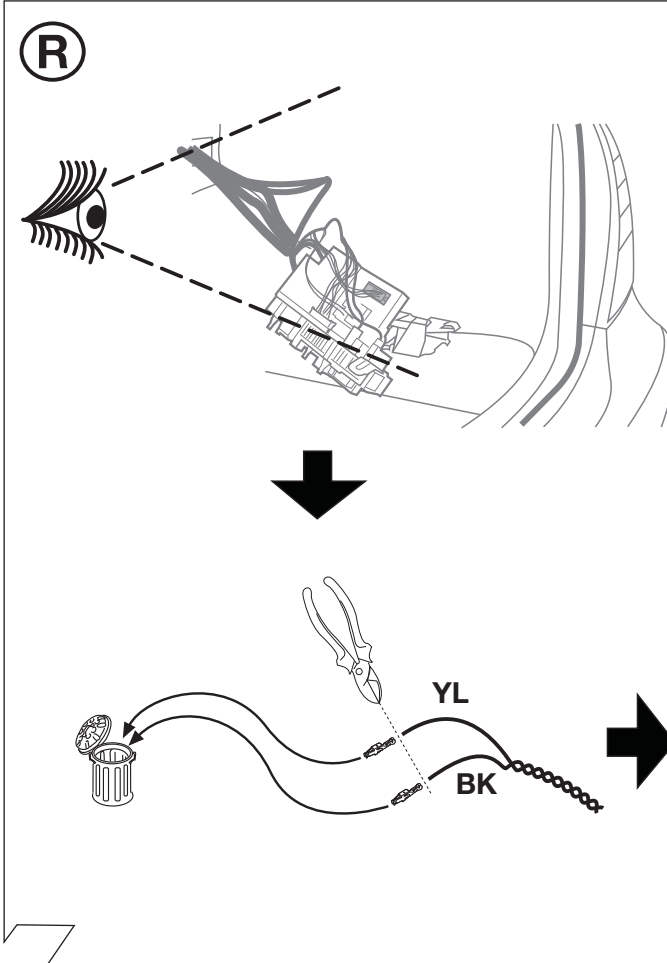

23

Important!  
Please note  
informations  
in picture 3!

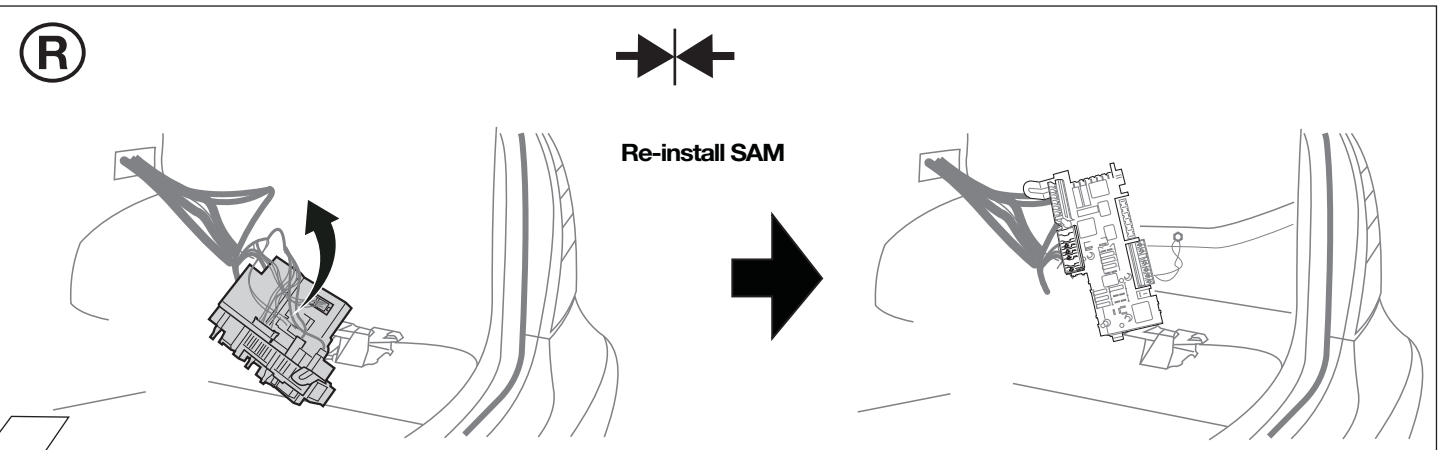
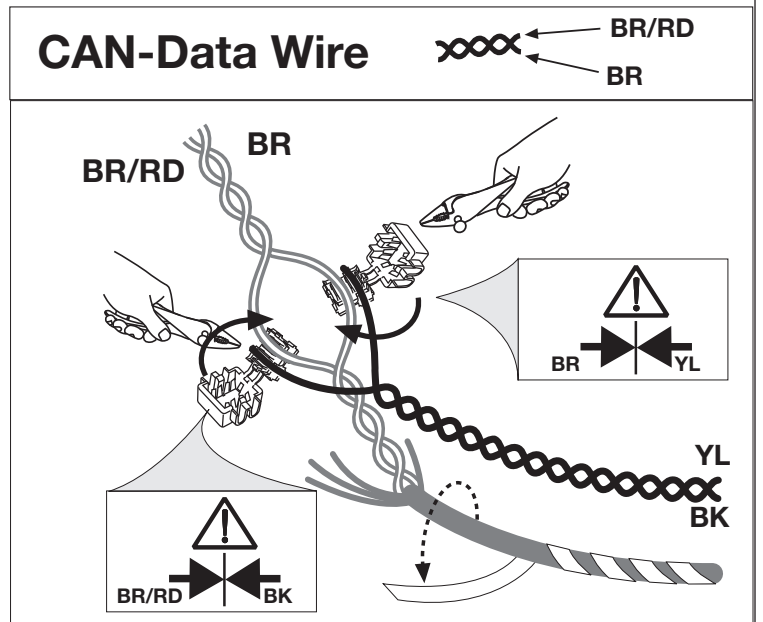

24



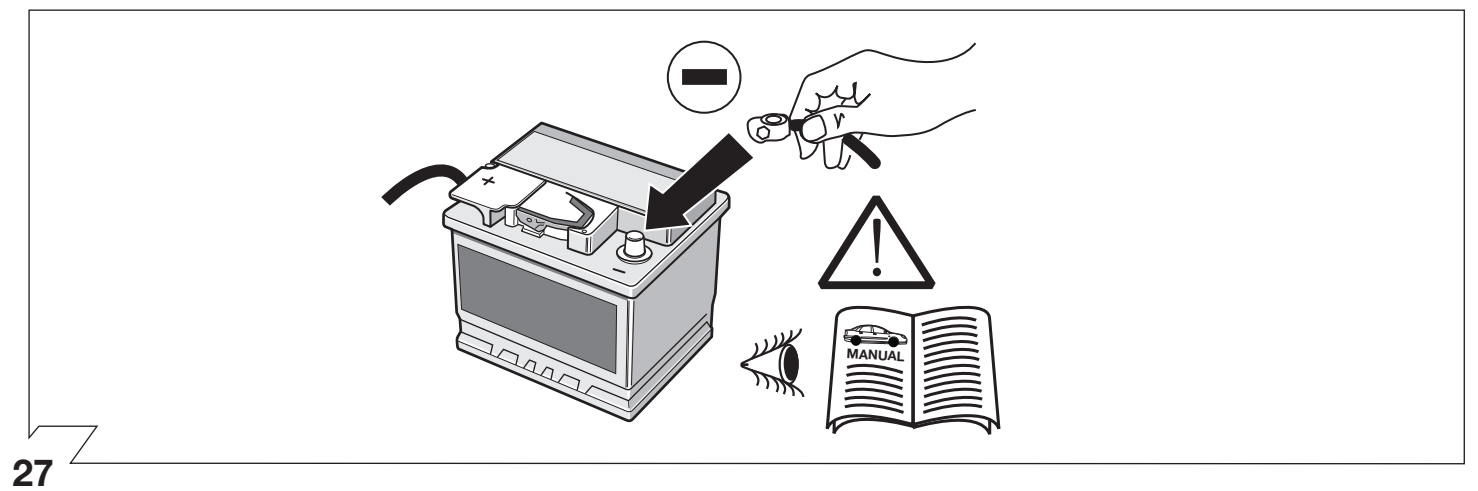
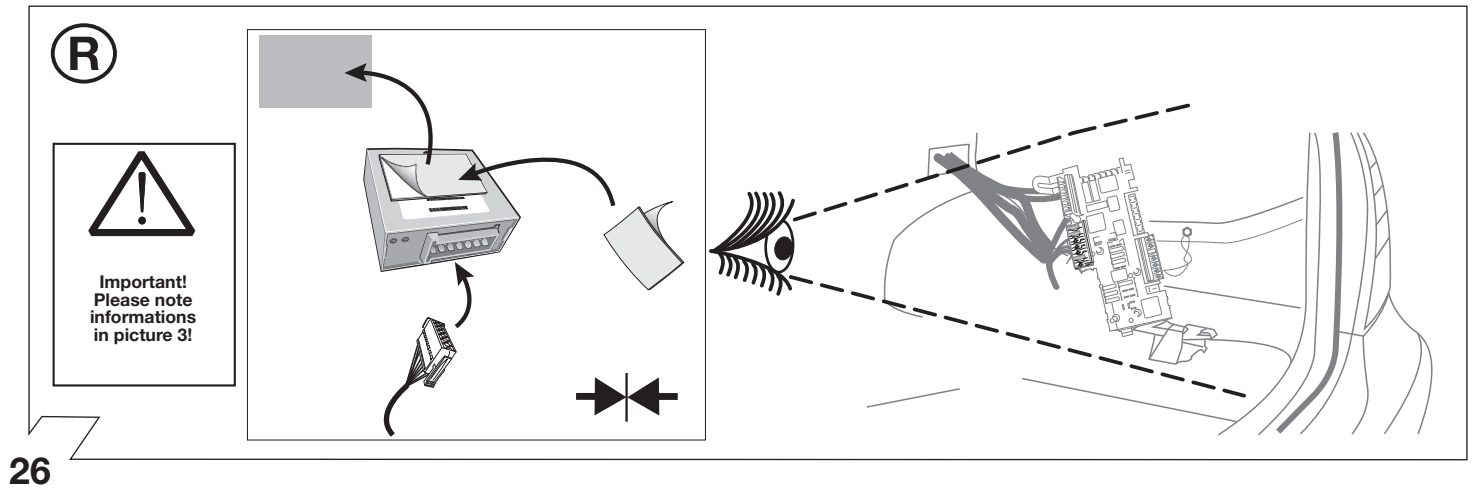
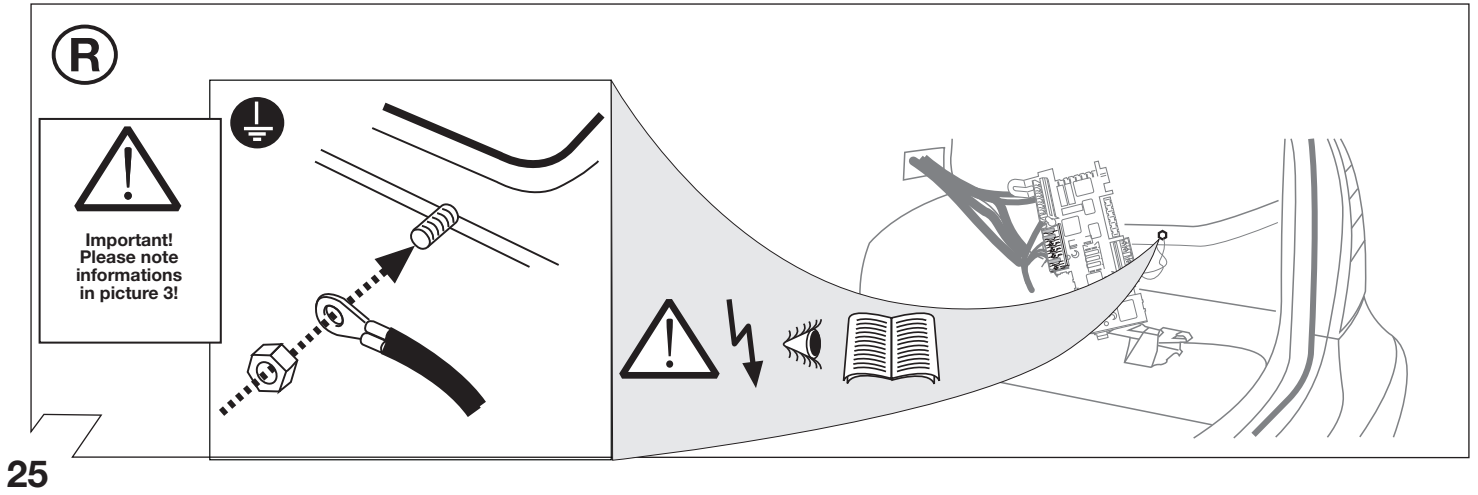

Programming

page 11

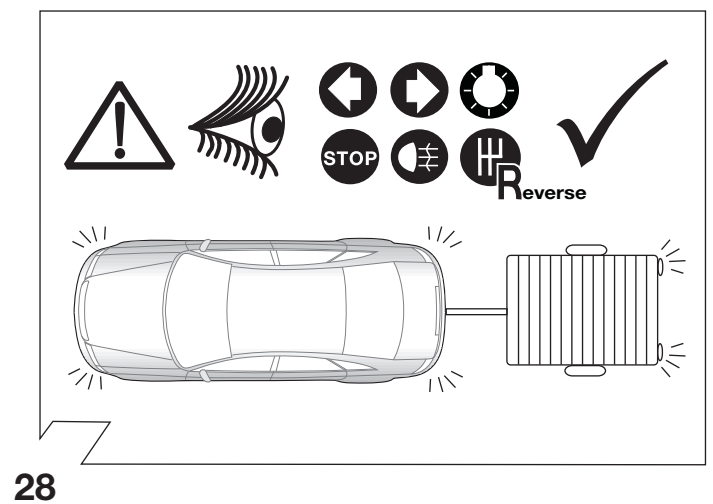



29

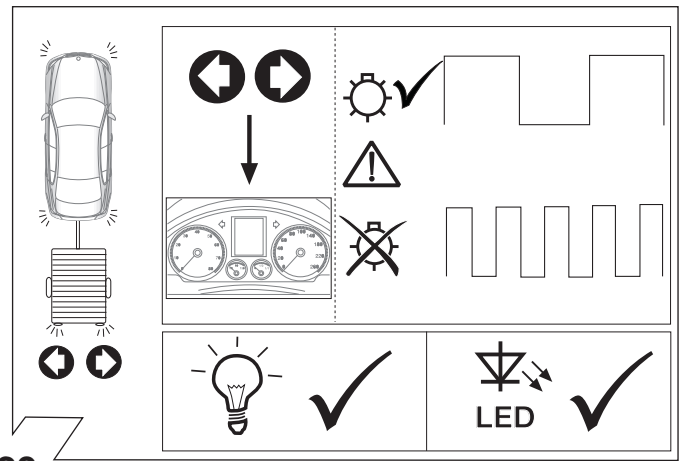

30

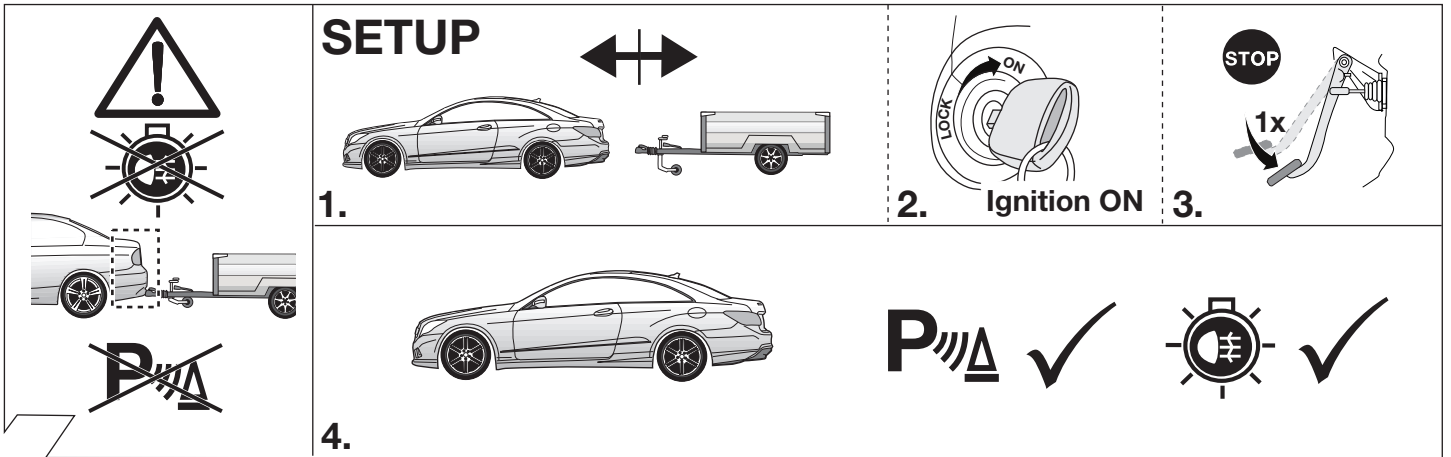

31

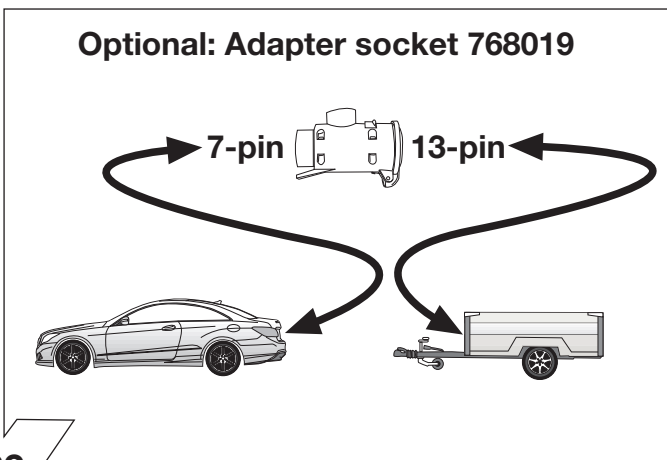

32

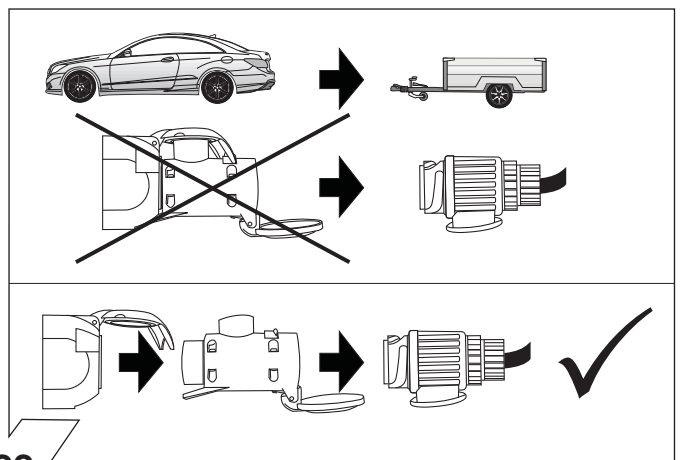

33

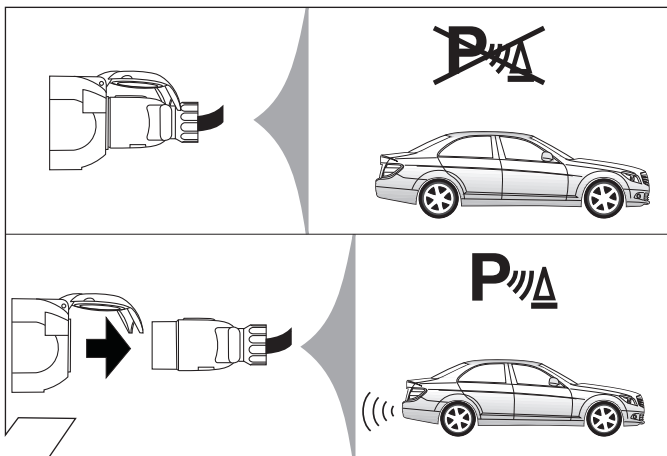

34

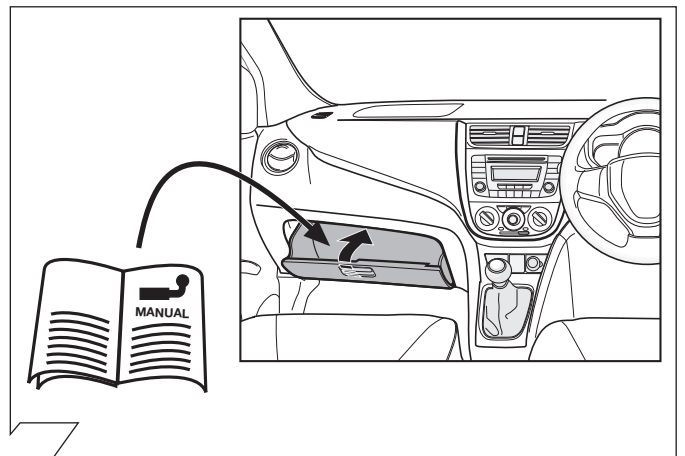

35

## Set up trailer operation

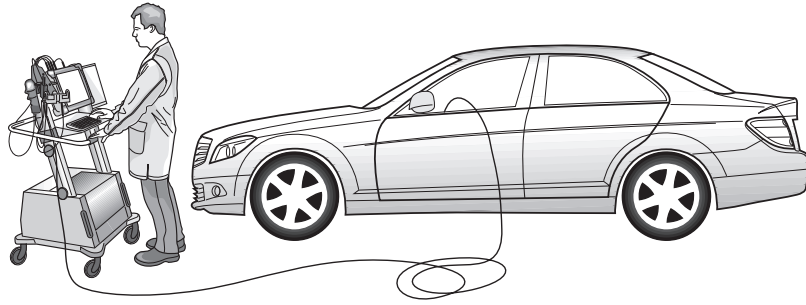

**The activation of the trailer functions  
has to be carried as follows:**

1. Connect computer to car
2. Start program
3. Click "Special functions"
4. Click "Input for retrofits or conversions"
5. Enter you user name and password
6. Write 550 in the upper (+) field
7. Accept and close the program.
8. Start the program again
9. Click "Controllers View"
10. Click "CGW" (Central Gateway)
11. Click "Adjust"
12. On the left side: click Configuration  
SCN encoding
13. Go online a wait a few seconds
14. In the middle of the list shown there is an  
entry 550 (with a + alongside).
15. Accept
16. Done

## Diagnosis function of control LEDs

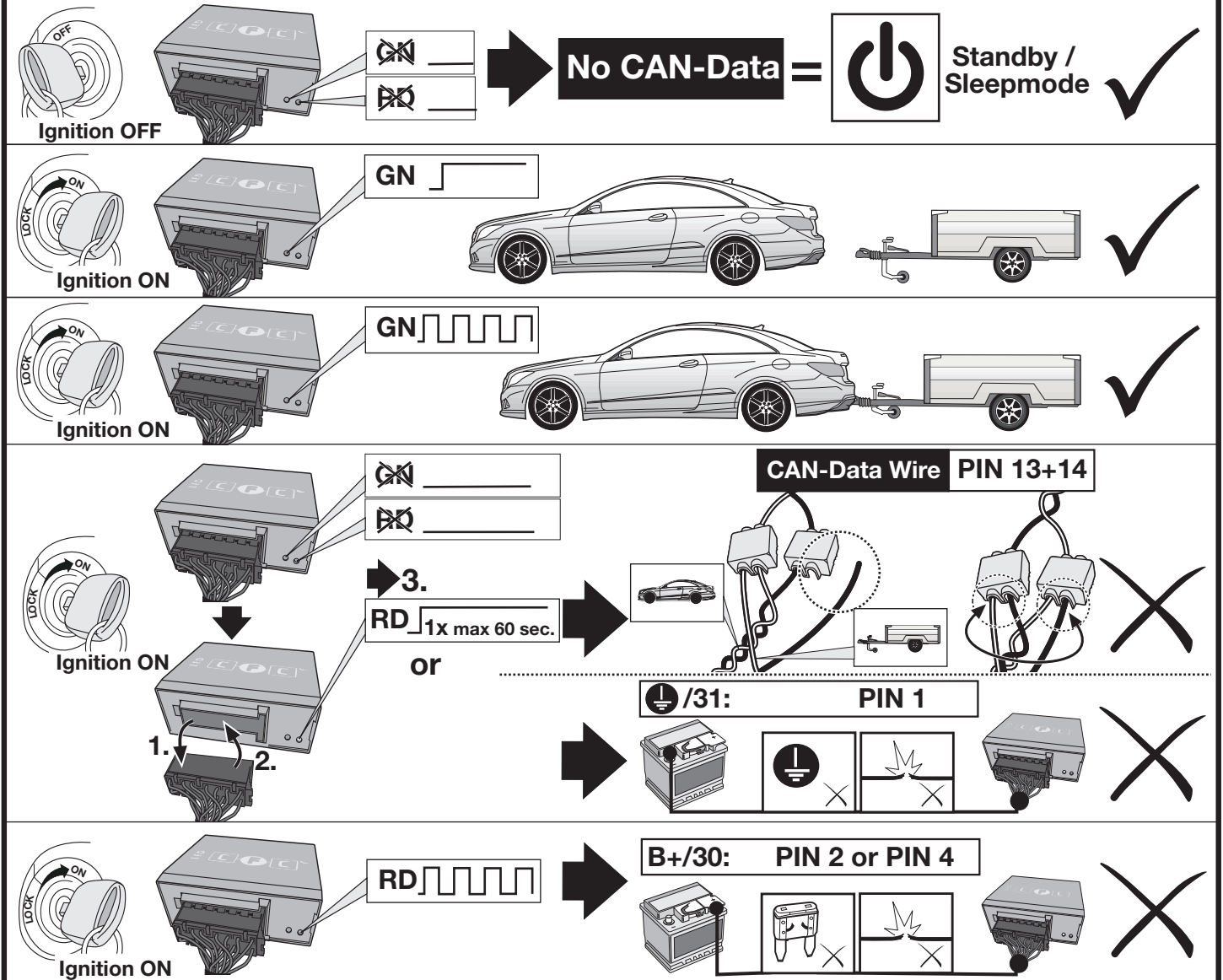

### Indicator failure detection and lamp substitution if the trailer indicators fail

The failure of a single or on both trailer indicators will be shown depending on the type of vehicle and electric kit installed as follows:

- Increase in the flashing frequency
- Text message in the Display / combi-instrument
- Activated control lamp for light failure
- Audible warning via Buzzer or Voice-Message

If an indicator fails the left or right rear light compensates the faulty indicator by flashing at the correct frequency! (▶ lamp substitution).