

Fitting Instructions



SKU

PRODUCT

T2C549

TAG Standard Duty Towbar to suit Mitsubishi ASX (07/2010 - on)



Scan for latest
version of these
instructions

SPECIFICATIONS

- Towbar Class: Standard Duty
- Towing Capacity: 1050kg
- Fit with wiring harness EL5540

IN THIS GUIDE

- Fitment Instructions
- Torque Settings
- Warranty Info

Step-By-Step Instructions

Warning:

Safety First: Always use correct safety equipment.

This towbar is NOT to be drilled, cut, welded or modified in any way.

Check the surrounding area before drilling into chassis or body panels for fuel lines, wiring harnesses and other components that may be a hazard.

General:

Before fitting this towbar read fitting instructions and check installation hardware is correct.

Check that the towbar is suitable for the vehicle and be wary of any changes to the vehicle design that may conflict with the fitting of this towbar.

After drilling, blow any filings clear, remove any swarf and treat exposed metal with a rust inhibitor.

If this vehicle requires a bumper cut out, please check to make sure that you measure twice and check twice before cutting any panels as some bumper profiles can change.

If you are not sure then ask your towbar supplier.

Tighten all bolts as specified on the last page.

Towbar Fitting Instructions

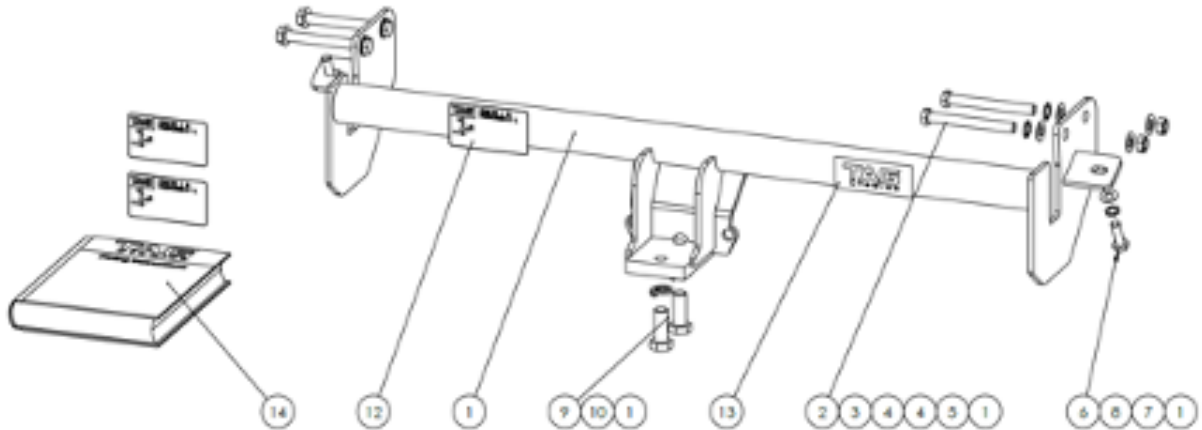

Spanners (16 & 18mm), Sockets (16 & 18mm), Torque Wrench, Air saw or similar, flexible ruler, Pry bar or similar, File, Ratchet Strap

ITEM NO.	DESCRIPTION	QTY.	ITEM NO.	DESCRIPTION	QTY.
1	Towbar Assembly – T2C549	1	8	M10 Shakeproof Washer	2
2	M12x1.75x110 Bolt	4	9	M16x2x40 Bolt	2
3	M12 Shakeproof Washer	4	10	M16 Spring Washer	2
4	M12 Flat Washer	8	NOT SHOWN	TAG D-Shackle	1
5	M12x1.75 Nut	4	12	TAG Compliance plate	3
6	M10x1.25x35 Bolt	2	13	TAG STICKER - 100 X 40	1
7	M10 Flat Washer	2	14	Fitting Instruction	1

Towbar Fitting Instructions



Step 1. Lower Exhaust & Remove Tow Hook

- a. Lower the exhaust from 2x rubber hangers to allow more space to install the towbar, suspend towbar with a strap or similar in order to avoid damaging the exhaust. Remove 3x M10 Bolts to remove shipping hook. Discard Tow Hook.

Tools: Pry Bar or similar, 16mm spanner/socket, Ratchet strap

Step 2. Fit Towbar

Position towbar in place on the vehicle. Loosely attach Fasteners:

- a. 4 x M12x1.75x110 long bolts with flat washers, shake-proof washers and nuts, use chassis spacer plate between the bar and the chassis
- b. 2 x M10x1.25x35 bolts with flat washers and shake-proof washers, into captive nuts

Tools: 18 & 16mm Spanner/Socket, Torque Wrench

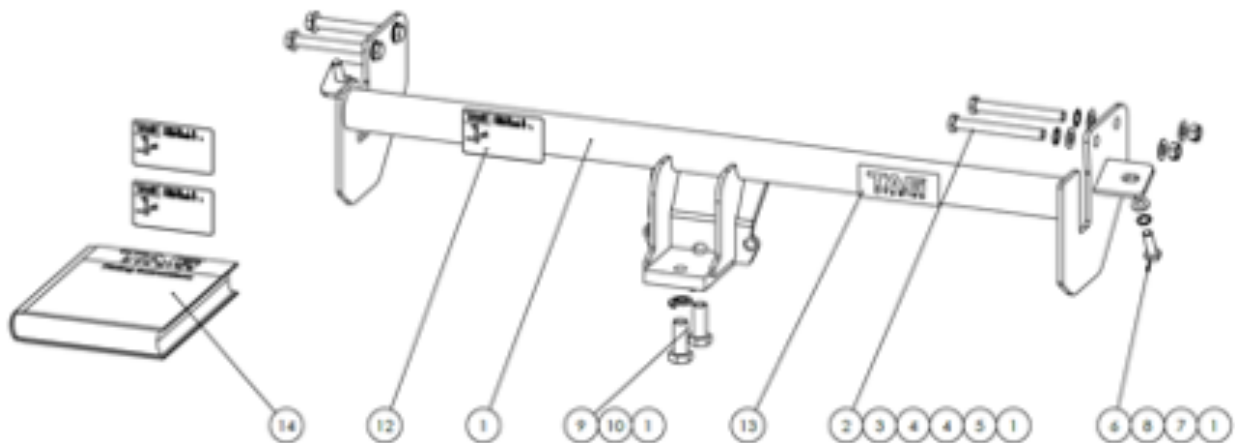

Step 3. Perform Bumper Cut (if required), Raise Exhaust & Torque Bolts

A bumper cut may be required on some models. Before torquing bolts check to see if a bumper cut is required.

If clearance is needed, using the bottom of the bumper as a reference line and the centre of the bumper as the centreline (Centreline is a protruding plastic line) use a flexible ruler to mark out a 70mm high and 100mm wide rectangle ensuring that the ruler is pressed into the curvature of the bumper

After performing the bumper cut as needed a file may be used to clean the edges up.

Torque all bolts to specifications listed in the table.

Tools: Air saw or similar, Ruler, File

Step 4. Apply Door Sticker

Apply one of the compliance labels to the pillar of the driver's door. Leave the remaining label & the fitting instructions in the vehicle handbook.



Torque table for bolt tightening

Diameter	Pitch	Grade	Torque	Unit
M8	1.25	8.8	29	Nm
M10	1.25	8.8	57	Nm
M10	1.50	8.8	44	Nm
M12	1.25	8.8	101	Nm
M12	1.50	8.8	97	Nm
M12	1.75	8.8	77	Nm
M14	2.00	8.8	122	Nm
M16	2.00	8.8	190	Nm
Imperial Bolt Torque Settings				
3/8"	UNC	8	44.75	Nm
1/2"	UNC	8	108.5	Nm

TAG Warranty Statement

SWD warrants your TAG Towbar for its full product life under the following conditions:

- You can show proof of purchase.
- The towbar has been correctly installed by a suitably qualified installer.
- The towbar has not been modified or abused in any way and has only been used for the purpose intended.
- The towbar was not fitted second hand to your vehicle.

The extent of this warranty includes materials and workmanship used in the manufacture of the towbar and is to the equivalent value of current, full replacement cost.

Nothing stated or implied in this warranty limits in any way, the statutory rights that you may have.

To make a claim visit the original installer in the first instance or, if you are unable to or are not satisfied with their help, then contact us direct by phone on 1300 669122 or visit www.swd.com.au