

Fitting Instructions



SKU

PRODUCT

T7P717

FIAT DUCATO MOTORHOME WITH ALKO EXTENSIONS



Scan for latest
version of these
instructions

SPECIFICATIONS

- Towbar Class: Heavy Duty
- Towing Capacity: 1500kg

IN THIS GUIDE

- Fitment Instructions
- Torque Settings
- Warranty Info

Towbar Fitting Instructions



Step-By-Step Instructions

Warning:

- This product is for towing purposes only and must only be loaded as shown in your vehicle Owner's Manual.
- This towbar is NOT to be drilled, cut, welded, or modified in any way.
- Check behind chassis rail and body panels before drilling to ensure no hazards are present
- All load ratings shown are under the assumption your trailer has a functional braking system installed
- When installed in positions other than the one depicted in these instructions the Tow Ball Mount may interfere or obstruct certain features of your vehicle (tailgate opening, Chassis clearance, etc.)

General:

- Before fitting this towbar read fitting instructions and check installation hardware is correct.
- Check that the towbar is suitable for the vehicle and be wary of any changes to the vehicle design that may conflict with the fitting of this towbar. (Tray, Canopy, Suspension etc.)
- After drilling, blow any filings clear, remove any swarf and treat exposed metal with a rust inhibitor.
- The high tensile fasteners supplied with this product are an integral feature to achieving the specified rating, if replacement is required ensure that fasteners of the same grade (8.8) & quality are used. Contact an authorised TAG distributor or the TAG fitment centre - (07) 3208 3022 - if further information is required.

Towbar Maintenance and Care:

It is recommended, when not in use, the Tow Ball Mount assembly and class 4 Pin and Clip is stored inside the car away from moisture to prevent standing water from forming rust. Inspect to ensure, on regular basis, fasteners are torqued to the specifications below and in good condition.

Ensure that the fitting instructions are read and understood prior to fitment

Place these instructions in the vehicle's glovebox after installation is completed

Towbar Fitting Instructions

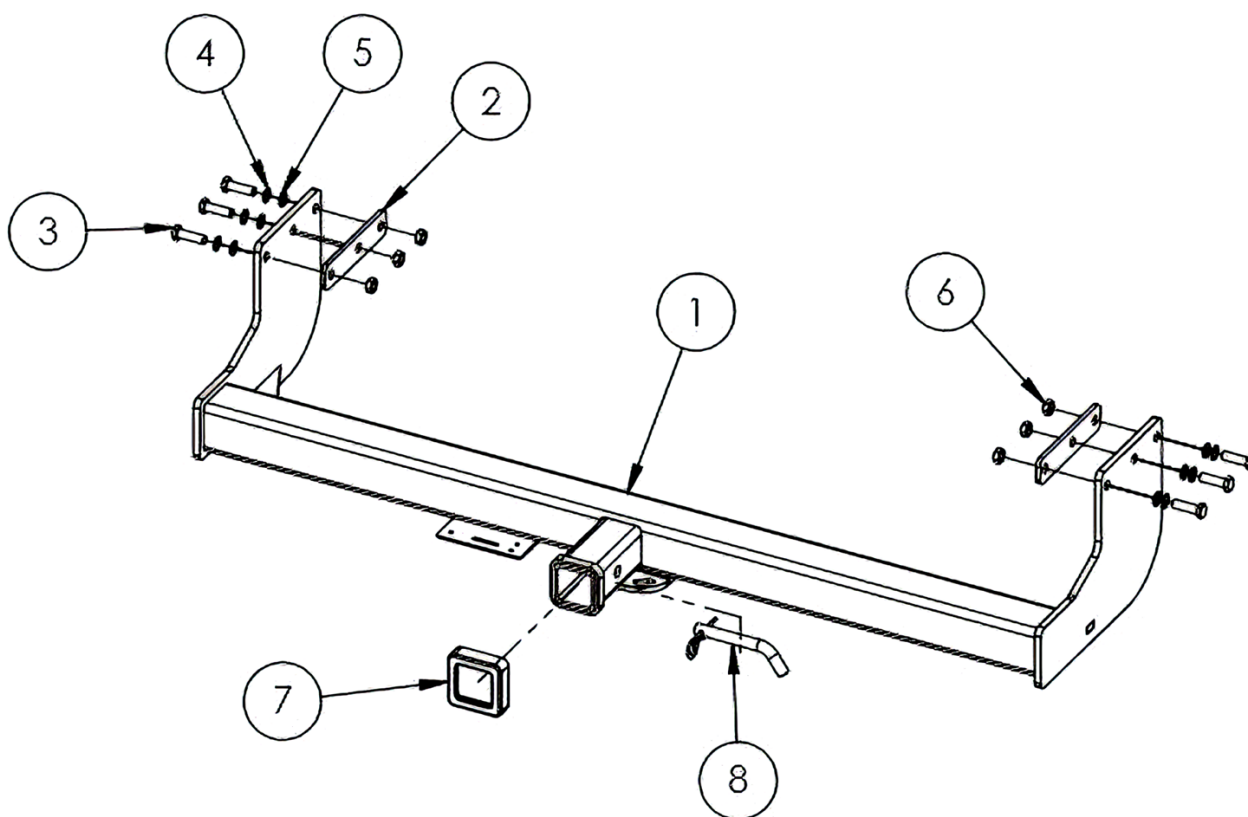



Tools Required:
Spanners/Sockets, Torque Wrench, Drill

Kit Contents					
Item No.	Description	Qty	Item No.	Description	Qty
1.	Towbar	1	6.	M12x1.25 Nut	6
2.	Chassis Plate	2	7.	Hitch Collar Cover	1
3.	M12x1.25x40 Bolt	6	8.	Class 4 Pin & Clip	1
4.	M12 Shake Proof Washer	6	---	D-Shackle	2
5.	M12 Flat Washer	6	---	Spare Compliance Sticker	

Towbar Fitting Instructions

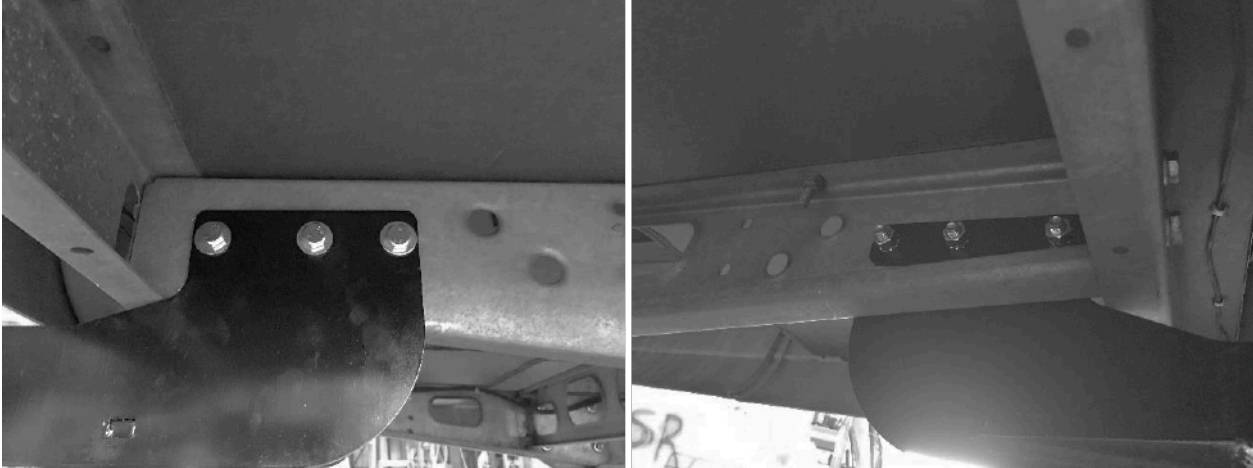

Step 1	Fit Towbar to Vehicle		
			
Instructions	Tools	Fasteners/Torques	
<p>With two people lift towbar to rear of the vehicle. Fix towbar to chassis using 3x M12 hardware on each side, with the chassis plates inside the chassis rails. Only tighten finger tight at this stage.</p> <p>If only 2 holes are present in the chassis rail, fix the towbar through these holes, then using the towbar as a template, drill the missing hole with a 13mm</p>	<p>Spanner/Sockets, Drill, Torque Wrench</p>	<p>M12 = 100Nm</p>	

Step 2	Apply Sticker to Door Jamb		
			
Instructions	Tools	Fasteners/Torques	
<p>Apply Towbar info label to the inside of the driver's side door Jamb.</p>	<p>N/A</p>	<p>N/A</p>	

TAG Warranty Statement

SWD warrants your TAG Towbar for its full product life under the following conditions:

- You can show proof of purchase.
- The towbar has been correctly installed by a suitably qualified installer.
- The towbar has not been modified or abused in any way and has only been used for the purpose intended.
- The towbar was not fitted second hand to your vehicle.

The extent of this warranty includes materials and workmanship used in the manufacture of the towbar and is to the equivalent value of current, full replacement cost.

Nothing stated or implied in this warranty limits in any way, the statutory rights that you may have.

To make a claim visit the original installer in the first instance or, if you are unable to or are not satisfied with their help, then contact us direct by phone on 1300 669122 or visit www.swd.com.au