

Fitting Instructions



SKU

T7P744

PRODUCT

TAG Heavy Duty Towbar & Rear Step for LDV G10 (04/2015 - on)

SPECIFICATIONS

- Towbar Class: CL 4 Heavy Duty
- Towing Capacity: 1500kg
- Tow ball Weight: 150kg
- Approx. Fitment Time: 90 Minutes



Scan for latest version of these instructions

TOOLS REQUIRED

- Spanners
- Sockets
- Air Saw or similar.
- Trim Removal Tool
- Torque Wrench

IN THIS GUIDE

- Fitment Instructions
- Torque Settings
- Warranty Info

Towbar Assembly

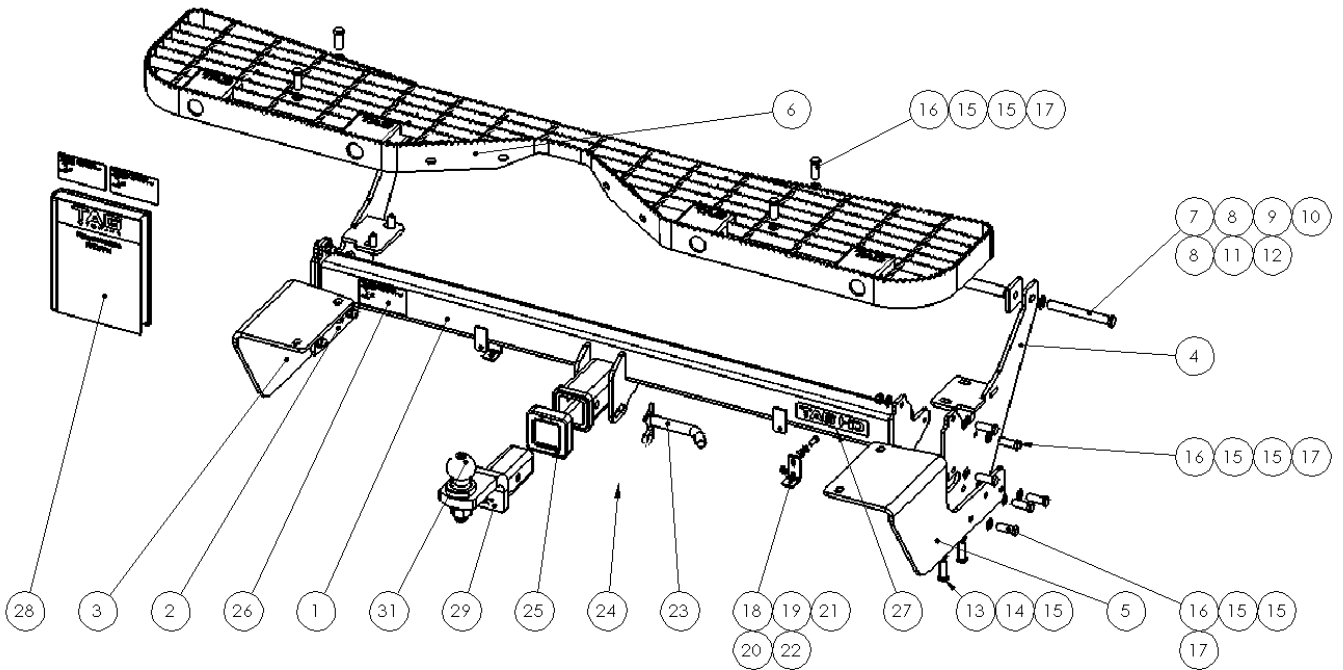

Item No.	Description	QTY.	Item No.	Description	QTY.
1	Main Bar Assembly	1	16	M10 x 1.25 x 35 Bolt	16
2	End Plate Assembly	1	17	M10 x 1.25 Nut	16
3	Step Mount	1	18	Bumper Tab	2
4	End Plate Assembly	1	19	M6 x 1.0 x 20 Set Screw	2
5	Step Mount DS	1	20	M6 Flat Washer	2
6	TAG Rear Step with Towing Relief	1	21	M6 Shakeproof Washer	2
7	M12 x 1.75 x 130 Hex Bolt	2	22	M6 x 1.00 Flange Serrated Nut	2
8	M12 Flat Washer	4	23	Class 4 Pin & Clip	1
9	Top Plate - 50x50x8	2	24	D-Shackle - 10mm. 1000kg	2
10	Crush Tube	2	25	TAG Hitch Cover	1
11	M12 Shakeproof Washer	2	26	TAG Compliance Sticker	3
12	M12 x 1.75 Nut	2	27	TAG HD Sticker 150 x 33mm	1
13	M10 x 1.5 x 35 Bolt	4	28	Fitting Instruction	1
14	M10 Shakeproof Washer	4	29	TAG Tow Ball Mount - L4120	1
15	M10 Flat Washer	36	30	50mm TAG Tow Ball with Flat edge	1

Important Information



Warning:

- This product is for towing purposes only and must only be loaded as shown in your vehicle Owner's Manual.
- This towbar is NOT to be drilled, cut, welded, or modified in any way.
- Check behind chassis rail and body panels before drilling to ensure no hazards are present.
- All load ratings shown are under the assumption your trailer has a functional braking system installed.
- When installed in positions other than the one depicted in these instructions the Tow Ball Mount may interfere or obstruct certain features of your vehicle (tailgate opening, Chassis clearance, etc.)

General:

- Before fitting this towbar read fitting instructions and check installation hardware is correct.
- Check that the towbar is suitable for the vehicle and be wary of any changes to the vehicle design that may conflict with the fitting of this towbar. (Tray, Canopy, Suspension etc.)
- After drilling, blow any filings clear, remove any burrs and treat exposed metal with a rust inhibitor.
- The high tensile fasteners supplied with this product are an integral feature to achieving the specified rating, if replacement is required ensure that fasteners of the same grade (8.8) & quality are used. Contact an authorised TAG distributor or the TAG fitment center - (07) 3208 3022 - if further information is required.

Towbar Maintenance and Care:

It is recommended, when not in use, the Tow Ball Mount assembly and class 4 Pin and Clip is stored inside the car away from moisture to prevent standing water from forming rust. Inspect to ensure, on regular basis, fasteners are torqued to the specifications below and in good condition.

Ensure that the fitting instructions are read and understood prior to fitment, Following the fitment place these instructions in the vehicle's glovebox after installation is completed.

Metric Bolt Torque Settings

Diameter	Pitch	Grade	Torque	Unit		Diameter	Pitch	Grade	Torque	Unit
M8	1.25	8.8	29	Nm		M12	1.25	10.9	125	Nm
M10	1.25	8.8	57	Nm		M12	1.50	10.9	105	Nm
M10	1.50	8.8	44	Nm		M14	1.25	10.9	195	Nm
M12	1.25	8.8	101	Nm		M14	1.50	10.9	165	Nm
M12	1.50	8.8	97	Nm		M16	1.25	10.9	295	Nm
M12	1.75	8.8	77	Nm		M16	1.50	10.9	250	Nm
M14	2.00	8.8	122	Nm		50mm Tow Ball	N/A	N/A	300	Nm
M16	2.00	8.8	190	Nm		70mm Tow Ball	N/A	N/A	750	Nm

Installation Instructions



Step 1: Remove Rear Bumper

Note to installer: Fitting of this step will inhibit the correct function of the reverse sensors. It is recommended that the provided RSM Kit be used to relocate the OEM reverse sensors onto the step & wiring extended.

- a. Remove 2x plastic scrivets from wheel arch.
- b. Repeat on opposite side.
- c. Open tailgate and remove 1x screws on each side fastening the bumper.
- d. Remove 5 plastic scrivets from the underside of the bumper. One each side behind wheel arch and 3 across the rear.
- e. Remove 2x M10 bolts from the impact beam and the bottom of each chassis rail.
- f. ****Impact beam removes with the bumper.**
- g. Beginning at each wheel arch, carefully peel bumper away from body. Disconnect the bumper harness on the PS.
- h. Separate the impact beam from the bumper. Discard impact beam.



Step 2: Fit Towbar

- Mount endplate up to the bottom of each chassis where the impact beam was fastened. Insert 2x M10x 1.5x 35 bolts with flat & shakeproof washers loosely. Repeat on opposite side.
- Insert 8mm flat plate between the upper arm of endplate and chassis rail. Insert M12x 1.75x 130 bolt with flat washer from outside. Insert 16 \emptyset crush tube over bolt and into chassis from inside and fasten loosely with flat & shakeproof washer & nut. Repeat on opposite side.
- Lift main bar assembly up to end plates and insert 3x M10x 1.25x 35 bolts with flat washers. Fasten loosely with flat washers & nuts.
- Beginning at the chassis, fasten all bolts to the torque specification on page 3.
- Attach the bent bumper tabs to the main bar with 1x M6x 1.0 x20 bolts, flat & shakeproof washers & flange nuts per side. Leave loose.

Step 3: Cut Bumper

Note: The towbar installer is ultimately responsible for the location & quality of the bumper cut. To avoid mistakes, please use the following measurements as a guide only. We suggest making small incremental cuts and regularly test-fitting the bumper to ensure an accurate and tidy appearance. The additional application of rubber pinch-weld around the cut edge ensures a neat & tidy look.

- Establish the centre of the bumper.
- Mark the cut-out 90mm wide x 76mm deep from the bottom lip of the bumper. See diagram.
- Cut the bumper using an air hacksaw or other suitable cutting device.
- De-burr all cut edges.
- Refit bumper in reverse of steps 1a-e.
- Secure the bottom of the bumper to the bumper tabs using the existing plastic scrivenets.
- Tighten the M6 bolts on the main bar.

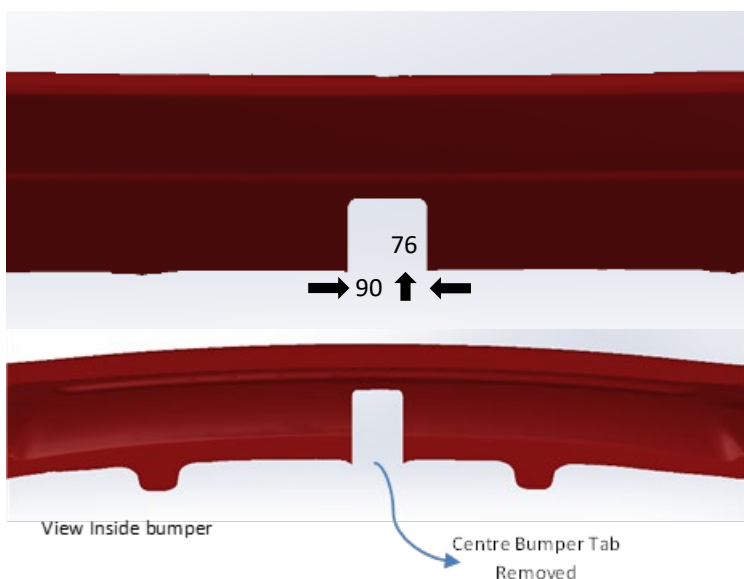

Installation Instructions



Step 4: Complete Towbar & Apply Spare Compliance Label

- a. Lift the step mount to the outside of the towbar end plate and insert M10x1.25x35 bolts with flat washers. Fasten loosely with M10x1.25 nuts with flat washers. Repeat on opposite side.
- b. Lift step onto the step mounts and insert M10x1.25x30 bolts with washers into holes of step. Fasten loosely with m10x1.25 nuts & flat washers.
- c. Align step with bumper & fasten all bolts to the torque specification on page 3.
- d. Attach TAG Hitch cover with rubber mallet carefully to prevent breaking.
- e. Attach Tow ball to Ball Mount and slide hitch into towbar and secure with Pin and Clip if you are going to tow straight away, alternatively secure Ball Mount in a safe place inside your car.
- f. Apply one of the compliance labels to the pillar of the driver's door. Leave the remaining label and the fitting instructions in the vehicle handbook.



TAG Warranty Statement



SWD warrants your TAG Towbar for its full product life under the following conditions:

- You can show proof of purchase.
- The towbar has been correctly installed by a suitably qualified installer.
- The towbar has not been modified or abused in any way and has only been used for the purpose intended.
- The towbar was not fitted second hand to your vehicle.

The extent of this warranty includes materials and workmanship used in the manufacture of the towbar and is to the equivalent value of current, full replacement cost.

Nothing stated or implied in this warranty limits in any way, the statutory rights that you may have.

To make a claim visit the original installer in the first instance or, if you are unable to or are not satisfied with their help, then contact us direct by phone on 1300 669122 or visit www.swd.com.au.