

Fitting Instructions



SKU

TXR793

PRODUCT

TAG Extreme Recovery Towbar for Toyota Landcruiser VDJ79 Single & Dual Cab – (08/2012 - on)

SPECIFICATIONS

- Towbar Class: CL 7 Extreme Recovery
- Towing Capacity: 4500kg
- Tow ball Weight: 450kg
- Recovery Point WLL: 4500kg (Cab Chassis) 4000kg (Style Side)
- Approx. Fitment Time: 30 Minutes



Scan for latest
version of these
instructions

TOOLS REQUIRED

- Spanners
- Sockets
- Torque Wrench

IN THIS GUIDE

- Fitment Instructions
- Torque Settings
- Warranty Info

Towbar Assembly

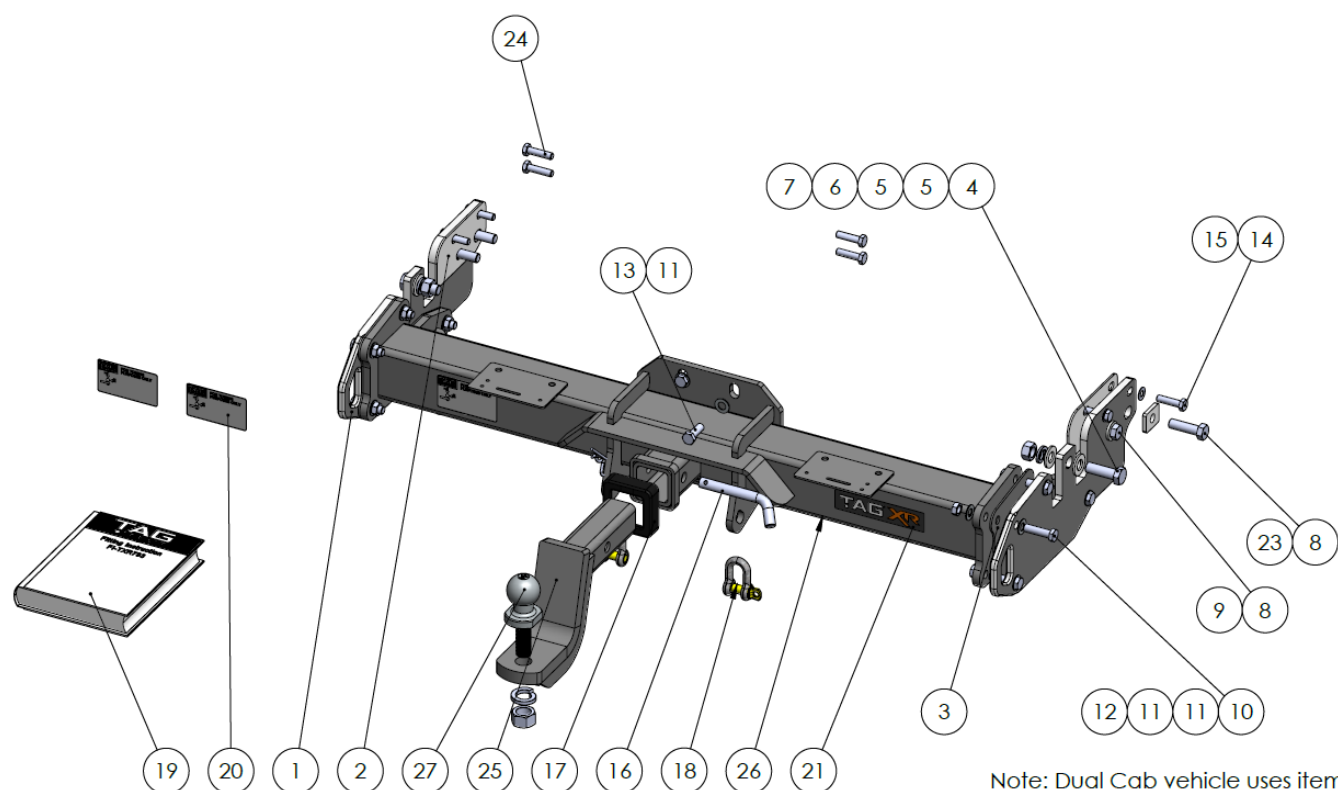

Note: Dual Cab vehicle uses item 14,
Single Cab vehicle uses item 24

Item No.	Description	QTY.	Item No.	Description	QTY.
1	Heavy Duty End Plate with Recovery Point	2	15	M10 FLAT WASHER FLAT ROUND ZINC CLEAR	4
2	Chassis mount spacer TXR793	2	16	Class 4 Pin & Clip	1
3	End Cap Spacer	2	17	TAG Hitch Cover	1
4	M16 x 1.5 x 50 Hex Set Screw	2	18	D-Shackle - 13mm Thick, 2000kg, Carbon Steel	2
5	M16 Flat Washer	4	19	Fitting Instruction	1
6	M16 SPRING WASHER ZINC CLEAR	2	20	TAG Compliance Sticker	3
7	M16x1.5 Nut	2	21	TAG XR Sticker 150 x 33mm	1
8	M14 x 1.5 x 50 Hex Set Screw	4	22	Tag WLL Sticker (Blank)	1
9	BM14 FLAT WASHER FLAT ROUND ZINC CLEAR	2	23	Top Plate - 40x32x6	2
10	M12 x 1.25 x 45 Hex Bolt	8	24	M10x1.5x40 Bolt	4
11	M12 Flat Washer Zinc Clear	18	25	POWDER COATED BALL MOUNT	1
12	M12x1.25 Nut	8	26	Weld Assembly TXR793	1
13	M12 x 1.25 x 35 Hex Bolt	2	27	50mm TAG Tow Ball with Flat edge - Chrome	1
14	M10X40 1.25 PITCH B/O GR8.8 ZINC CLEAR HEX HEAD GRADE 8.8	4			

Note: The setup listed will only achieve a 3500kg towing capacity, to achieve the maximum towing capacity of 4500kg you must first fit a higher rated Tow Ball (UNT011) and Tow Ball Mount (UNTTBM450).

Important Information



Warning:

- This product is for towing purposes only and must only be loaded as shown in your vehicle Owner's Manual.
- This towbar is NOT to be drilled, cut, welded, or modified in any way.
- Check behind chassis rail and body panels before drilling to ensure no hazards are present.
- All load ratings shown are under the assumption your trailer has a functional braking system installed.
- When installed in positions other than the one depicted in these instructions the Tow Ball Mount may interfere or obstruct certain features of your vehicle (tailgate opening, Chassis clearance, etc.)

General:

- Before fitting this towbar read fitting instructions and check installation hardware is correct.
- Check that the towbar is suitable for the vehicle and be wary of any changes to the vehicle design that may conflict with the fitting of this towbar. (Tray, Canopy, Suspension etc.)
- After drilling, blow any filings clear, remove any burrs and treat exposed metal with a rust inhibitor.
- The high tensile fasteners supplied with this product are an integral feature to achieving the specified rating, if replacement is required ensure that fasteners of the same grade (8.8) & quality are used. Contact an authorised TAG distributor or the TAG fitment center - (07) 3208 3022 - if further information is required.

Towbar Maintenance and Care:

It is recommended, when not in use, that the Tow Ball Mount assembly and class 4 Pin and Clip is stored inside the car away from moisture to prevent standing water from forming rust. Inspect to ensure, on regular basis, fasteners are torqued to the specifications below and in good condition.

Ensure that the fitting instructions are read and understood prior to fitment
Place these instructions in the vehicle's glovebox after installation is completed.

Metric Bolt Torque Settings										
Diameter	Pitch	Grade	Torque	Unit		Diameter	Pitch	Grade	Torque	Unit
M8	1.25	8.8	29	Nm		M12	1.50	8.8	97	Nm
M10	1.25	8.8	57	Nm		M12	1.75	8.8	77	Nm
M10	1.50	8.8	44	Nm		M14	2.00	8.8	122	Nm
M12	1.25	8.8	101	Nm		M16	2.00	8.8	190	Nm

Step 1: Fit Towbar

PLEASE NOTE:

This towbar fits both Single Cab & Dual Cab models BUT there are some minor variations between each chassis you must be aware of.

1. Chassis & body-mount point tab on towbar end plate:
 - Dual cab - body mount hole must be drilled in chassis.
 - Single cab - body mount hole has a captive thread in chassis.
 - If replacing other manufacturer towbar, **TAG** towbar may not align with previously drilled hole.

⚠ **Due to Toyota weld inconsistency, a packer is not provided or required** between the chassis & end plate at this point.
 2. At the forward-most end of the chassis plates the two top-most are:
 - Dual cab - 2 x M10 x **1.5** bolts. (see also Point 3)
 - Single cab - 2 x M10 x **1.25** bolts.
 3. **Dual Cab ONLY**, the forward-most, lower bolt (M14) is 4mm lower than the other. **Single cab** both bolts (M14) are in line with each other. Hence the bigger hole & square washer provided!
- a. Ensure all hardware is in the kit and correct before you begin.
 - b. Align endplate with 3mm packer to chassis & fasten loosely with M14 & M10 bolts to forward-most holes. Repeat on opposite side.
 - c. Loosely secure the main bar assembly to the endplates with 8 X M12 x 1.25 x 45 flat washers & nuts.
 - d. Insert the included packer plates if a gap larger than 3mm on either side is present.
 - e. Secure the main bar to the chassis cross member with 2 X M12 x 1.25 x 35 bolts & flat washers.
 - f. Align the body-mount tab on the endplate with the chassis captive and loosely fasten with M16 bolt & washer. If no hole is present, use the body mount tab as a guide and drill a M16 hole in chassis. Fasten loosely with M16 bolt with flat & spring washers & nut. Repeat on opposite side.
 - g. Beginning at the chassis, tighten all bolts according to the torque specifications (pg. 3).



Installation Instructions



Step 2: Complete Towbar & Apply Spare Compliance Label

- a. Attach TAG Hitch cover with rubber mallet carefully to prevent breaking.
- b. Attach Tow ball to Ball Mount and slide into receiver. Secure with Pull pin and Clip if you are going to tow straight away. Alternatively, secure the Ball Mount in a safe place inside your vehicle.
- c. Apply one of the compliance labels to the pillar of the driver's door. Leave the remaining label and the fitting instructions in the vehicle handbook.



TAG Warranty Statement



SWD warrants your TAG Towbar for its full product life under the following conditions:

- You can show proof of purchase.
- The towbar has been correctly installed by a suitably qualified installer.
- The towbar has not been modified or abused in any way and has only been used for the purpose intended.
- The towbar was not fitted second hand to your vehicle.

The extent of this warranty includes materials and workmanship used in the manufacture of the towbar and is to the equivalent value of current, full replacement cost.

Nothing stated or implied in this warranty limits in any way, the statutory rights that you may have.

To make a claim visit the original installer in the first instance or, if you are unable to or are not satisfied with their help, then contact us direct by phone on 1300 669122 or visit www.swd.com.au.