

Fitting Instructions



SKU

T7T809

PRODUCT

**TAG Heavy Duty Towbar
for Toyota Kluger (03/2021 - on)**

SPECIFICATIONS

- Towbar Class: CL 4 Heavy Duty
- Towing Capacity: 2000kg
- Tow ball Weight: 200kg
- Approx Fitment Time: 90 Minutes



Scan for latest
version of these
instructions

TOOLS REQUIRED

- Spanners
- Sockets
- Air Saw or similar.
- Trim Removal Tool
- Torque Wrench

IN THIS GUIDE

- Fitment Instructions
- Torque Settings
- Warranty Info

Towbar Assembly

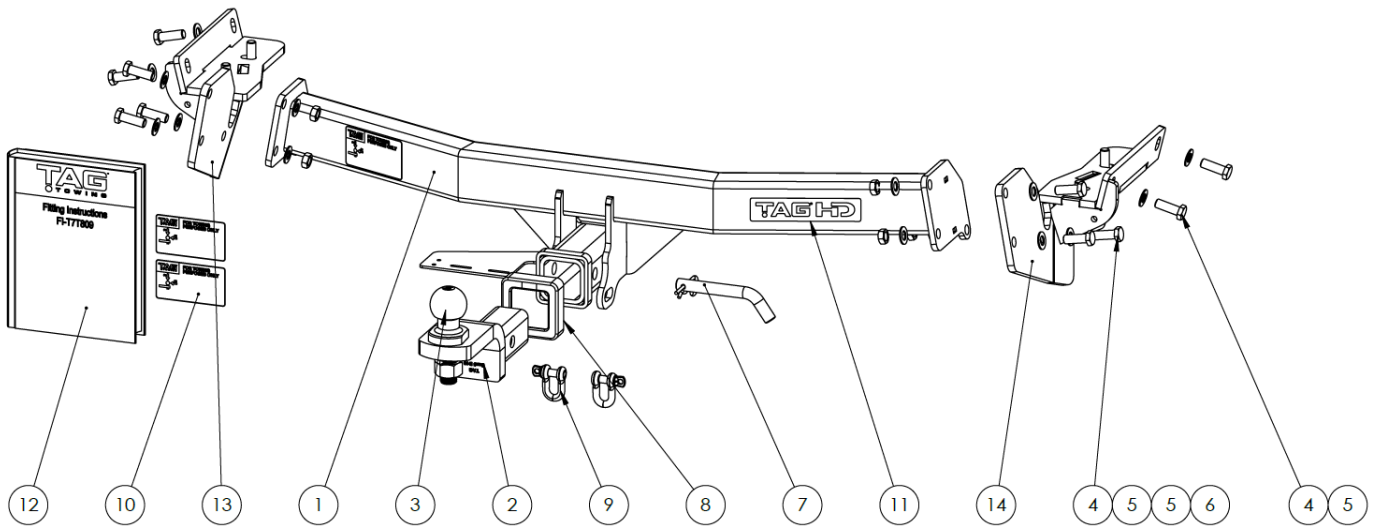

Item No.	Description	QTY.	Item No.	Description	QTY.
1	Welded Main Bar Assembly for T7T809	1	8	Cover Hitch Receiver Collar TAG	1
2	TAG Tow Ball Mount - L4120	1	9	D-Shackle - 10mm. 1000kg,	2
3	50mm TAG Tow Ball with Flat Edge	1	10	TAG Compliance Sticker	3
4	M12 x 1.25 x 35 Bolt	14	11	TAG HD Sticker 150 x 33mm	1
5	M12 Flat Washer	20	12	Fitting Instruction	1
6	M12x1.25 Nut	6	13	Under Chassis Assembly	1
7	Class 4 Pin & Clip	1	14	Under Chassis Assembly DS	1

Important Information



Warning:

- This product is for towing purposes only and must only be loaded as shown in your vehicle Owner's Manual.
- This towbar is NOT to be drilled, cut, welded, or modified in any way.
- Check behind chassis rail and body panels before drilling to ensure no hazards are present.
- All load ratings shown are under the assumption your trailer has a functional braking system installed.
- When installed in positions other than the one depicted in these instructions the Tow Ball Mount may interfere or obstruct certain features of your vehicle (tailgate opening, Chassis clearance, etc.)

General:

- Before fitting this towbar read fitting instructions and check installation hardware is correct.
- Check that the towbar is suitable for the vehicle and be wary of any changes to the vehicle design that may conflict with the fitting of this towbar. (Tray, Canopy, Suspension etc.)
- After drilling, blow any filings clear, remove any burrs and treat exposed metal with a rust inhibitor.
- The high tensile fasteners supplied with this product are an integral feature to achieving the specified rating, if replacement is required ensure that fasteners of the same grade (8.8) & quality are used. Contact an authorised TAG distributor or the TAG fitment center - (07) 3208 3022 - if further information is required.

Towbar Maintenance and Care:

It is recommended, when not in use, that the Tow Ball Mount assembly and class 4 Pin and Clip is stored inside the car away from moisture to prevent standing water from forming rust. Inspect to ensure, on regular basis, fasteners are torqued to the specifications below and in good condition.

Ensure that the fitting instructions are read and understood prior to fitment
Place these instructions in the vehicle's glovebox after installation is completed.

<i>Metric Bolt Torque Settings</i>										
Diameter	Pitch	Grade	Torque	Unit		Diameter	Pitch	Grade	Torque	Unit
M8	1.25	8.8	29	Nm		M12	1.25	10.9	125	Nm
M10	1.25	8.8	57	Nm		M12	1.50	10.9	105	Nm
M10	1.50	8.8	44	Nm		M14	1.25	10.9	195	Nm
M12	1.25	8.8	101	Nm		M14	1.50	10.9	165	Nm
M12	1.50	8.8	97	Nm		M16	1.25	10.9	295	Nm
M12	1.75	8.8	77	Nm		M16	1.50	10.9	250	Nm
M14	2.00	8.8	122	Nm		50mm Tow Ball	N/A	N/A	300	Nm
M16	2.00	8.8	190	Nm		70mm Tow Ball	N/A	N/A	750	Nm

Step 1: Remove Rear Bumper

- a. Open the tailgate and lower the spare wheel.
 - b. Remove the plastic covers from each of the taillights and 3x hex head screws from each side. Pull the taillights rearward and disconnect the wiring harness.
 - c. Remove 2x screws and one plastic scrivet from each wheel arch.
 - d. Remove 2x bolts from behind the mudflap and remove the mudguard.
 - e. Remove 1x screw and 1x scrivet from the upper edge of each wheel arch.
 - f. Under the DS rear, remove 1 bolt, 3x screws and 3x scrivets. Remove the cover.
 - g. Under the PS rear, remove 2x screws, 4x scrivets. Unscrew the 2 plastic nuts from the body to remove the cover.
 - h. Remove the shipping hooks from the chassis on both sides. Discard all.
 - i. Remove the two plastic thread covers from the outside of each chassis rail. Discard all.
 - j. Beginning at each wheel arch, carefully unclip the bumper from the body. Disconnect the wiring harness on the DS.
 - k. Remove 6x nuts fastening the crash bar to the rear panel. Discard all.
- l. Removal of some of the joint sealant where the outside of each chassis rail meets the rear panel may be required to aid fitment of the towbar end plates.**

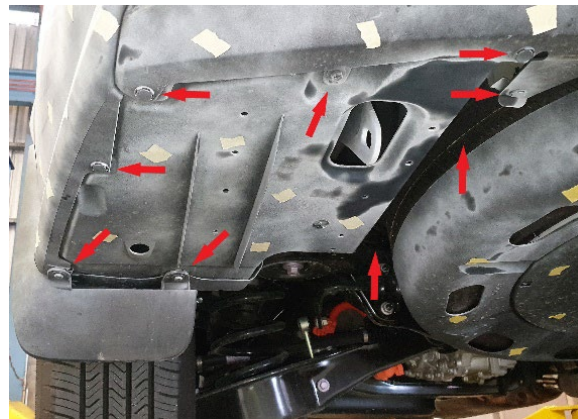

Step 2: Fit Towbar

- a. Lift the endplates up to the bottom of each chassis and insert M12x 35 bolts with washers into all holes. Fasten loosely.
- b. Lift main bar assembly up to end plates and insert the remaining 3x M12x 35 bolts with washers per side. Loosely secure with nuts and flat washers.

Tighten all bolts to the torque specification on page 3



Step 3: Cut Bumper

Note: The towbar installer is ultimately responsible for the location & quality of the bumper cut. To avoid mistakes, please use the following measurements as a guide only. We suggest making small incremental cuts and regularly test fit the bumper to ensure an accurate and tidy appearance. The additional application of rubber pinch-weld around the cut edge ensures a neat & tidy look.

- a. Establish the centerline of the bumper and mark.
- b. Mark the bumper cut 45mm either side of centerline & along the 1st contour line of the bumper. See picture 1.
- c. The plastic fin (**directly above the receiver cut-out**) and two tabs of the inner bumper trim must also be removed. Remove the corresponding bumper tabs from the outer skin at their fold lines on the bottom edge of the bumper. See picture 1, 2 & 3.
- d. The PS splash guard must also be trimmed. See picture 4 & 5.
- e. Cut the bumper & splash guards with an air saw or similar. Deburr all cut edges.
- f. Reinstall bumper in reverse of steps 1a-k.
- g. Attach plastic hitch surround.
- h. Insert ball mount & secure with pull pin & clip.

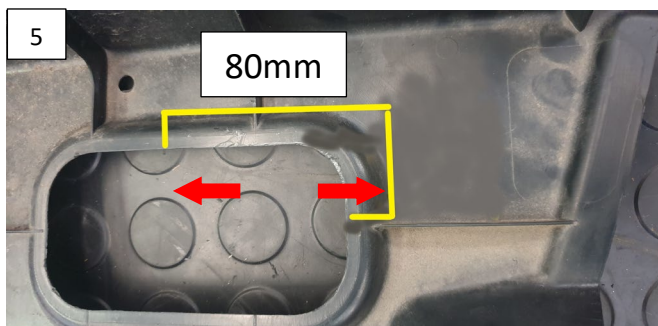
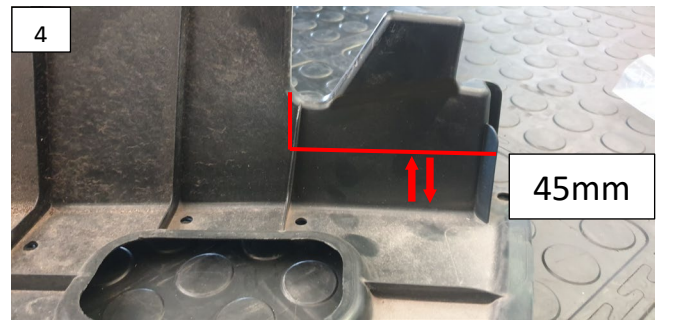
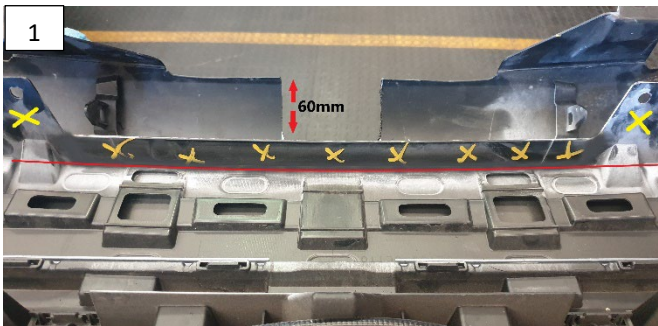

Step 4: Apply Compliance Label

- a. Attach TAG Hitch cover with rubber mallet carefully to prevent breaking.
- b. Attach tow ball to ball mount and slide into receiver. Secure with Pull pin and Clip if you are going to tow straight away. Alternatively, secure the Ball Mount in a safe place inside your vehicle.
- c. Apply one of the compliance labels to the pillar of the driver's door. Leave the remaining label and the fitting instructions in the vehicle handbook.



SWD warrants your TAG Towbar for its full product life under the following conditions:

- You can show proof of purchase.
- The towbar has been correctly installed by a suitably qualified installer.
- The towbar has not been modified or abused in any way and has only been used for the purpose intended.
- The towbar was not fitted second hand to your vehicle.

The extent of this warranty includes materials and workmanship used in the manufacture of the towbar and is to the equivalent value of current, full replacement cost.

Nothing stated or implied in this warranty limits in any way, the statutory rights that you may have.

To make a claim visit the original installer in the first instance or, if you are unable to or are not satisfied with their help, then contact us direct by phone on 1300 669122 or visit www.swd.com.au.