

Fitting Instructions



SKU

T4C608

PRODUCT

**TAG Heavy Duty Towbar
for Mitsubishi Outlander
(11-2012 to 08-2021)**

SPECIFICATIONS

- Towbar Class: CL 4 Heavy Duty
- Towing Capacity: 2000kg
- Tow ball Weight: 200kg
- Approx. Fitment Time: 60 Minutes



Scan for latest
version of these
instructions

TOOLS REQUIRED

- Spanners
- Sockets
- Air Saw or similar.
- Trim Removal Tool
- Torque Wrench

IN THIS GUIDE

- Fitment Instructions
- Torque Settings
- Warranty Info

Towbar Assembly

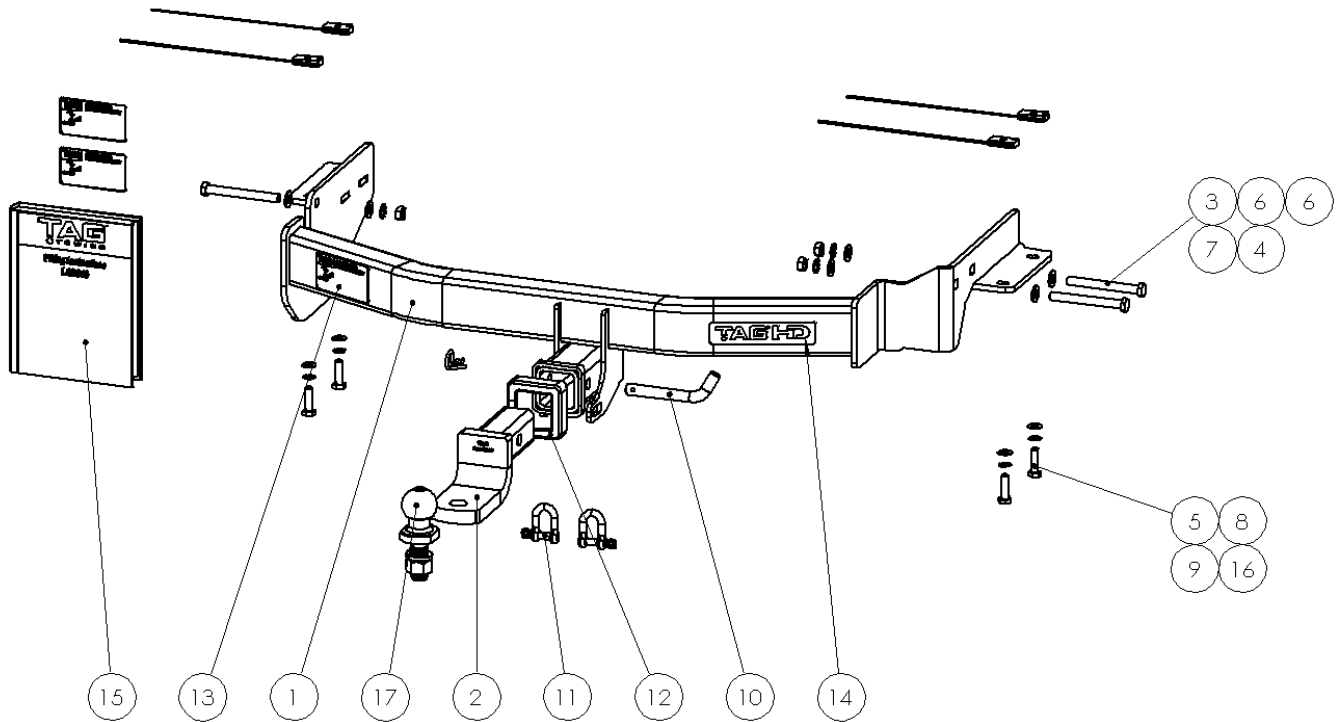

Item No.	Description	QTY.	Item No.	Description	QTY.
1	Towbar Assembly	1	10	Class 4 Pin & Clip	1
2	TAG Tow Ball Mount - L4120	1	11	TAG D-Shackle - 10mm, 1000kg,	2
3	M12 x 1.5 x 110 Bolt	3	12	TAG Hitch Cover	1
4	M12 x 1.5 Nut	3	13	TAG Compliance Sticker	3
5	M10 x 1.5 x 35 Bolt	4	14	TAG HD Sticker 150 x 33mm	1
6	M12 Flat Washer	6	15	Fitting Instruction	1
7	M12 Shakeproof Washer	3	16	Top Plate Assembly	4
8	M10 Shakeproof Washer	4	17	TAG Tow Ball Chrome 50mm 3.5 Tonne	1
9	M10 Flat Washer	4			

Important Information



Warning:

- This product is for towing purposes only and must only be loaded as shown in your vehicle Owner's Manual.
- This towbar is NOT to be drilled, cut, welded, or modified in any way.
- Check behind chassis rail and body panels before drilling to ensure no hazards are present.
- All load ratings shown are under the assumption your trailer has a functional braking system installed.
- When installed in positions other than the one depicted in these instructions the Tow Ball Mount may interfere or obstruct certain features of your vehicle (tailgate opening, Chassis clearance, etc.)

General:

- Before fitting this towbar read fitting instructions and check installation hardware is correct.
- Check that the towbar is suitable for the vehicle and be wary of any changes to the vehicle design that may conflict with the fitting of this towbar. (Tray, Canopy, Suspension etc.)
- After drilling, blow any filings clear, remove any burrs and treat exposed metal with a rust inhibitor.
- The high tensile fasteners supplied with this product are an integral feature to achieving the specified rating, if replacement is required ensure that fasteners of the same grade (8.8) & quality are used. Contact an authorised TAG distributor or the TAG fitment center - (07) 3208 3022 - if further information is required.

Towbar Maintenance and Care:

It is recommended, when not in use, that the Tow Ball Mount assembly and class 4 Pin and Clip is stored inside the car away from moisture to prevent standing water from forming rust. Inspect to ensure, on regular basis, fasteners are torqued to the specifications below and in good condition.

Ensure that the fitting instructions are read and understood prior to fitment, Following the fitment place these instructions in the vehicle's glovebox after installation is completed.

Metric Bolt Torque Settings

Diameter	Pitch	Grade	Torque	Unit		Diameter	Pitch	Grade	Torque	Unit
M8	1.25	8.8	29	Nm		M12	1.25	10.9	125	Nm
M10	1.25	8.8	57	Nm		M12	1.50	10.9	105	Nm
M10	1.50	8.8	44	Nm		M14	1.25	10.9	195	Nm
M12	1.25	8.8	101	Nm		M14	1.50	10.9	165	Nm
M12	1.50	8.8	97	Nm		M16	1.25	10.9	295	Nm
M12	1.75	8.8	77	Nm		M16	1.50	10.9	250	Nm
M14	2.00	8.8	122	Nm		50mm Tow Ball	N/A	N/A	300	Nm
M16	2.00	8.8	190	Nm		70mm Tow Ball	N/A	N/A	750	Nm



Step 1: Remove Rear Bumper

- a. Lift the tailgate and remove 4x M10 bolts from the top inside section of the bumper. Retain bolts.
- b. Remove and retain M10 bolt & plastic scrivenets from each wheel. Repeat on opposite side.
- c. Remove and retain the plastic scrivenets from the rear-most bottom edge of bumper.
- d. Beginning at each wheel arch, carefully separate the bumper from the body and remove.
- e. Disconnect the sensor harness if fitted.
- f. Remove the exhaust from the rear-most hangers.
- g. Lower spare wheel.
- h. Remove crush cones from each side and discard.

Step 2: Fit Towbar

- a. Lift towbar and align to chassis.
- b. Insert M12 x 1.5 x 110 bolts through the sides of subframe and loosely fasten with nuts and washers provided. [Some adjustment to the towbar may be required enabling it to fit between the subframe].
- c. Insert 4 x M10 bolts with washers into captive nuts in bottom of chassis.
- d. Tighten all bolts according to the torque specification on page 3.

Step 3: Cut Bumper

Note: The towbar installer is ultimately responsible for the location & quality of the bumper cut. To avoid mistakes, please use the following measurements as a guide only. We suggest making small incremental cuts and regularly test fit the bumper to ensure an accurate and tidy appearance. The additional application of rubber pinch-weld around the cut edge ensures a neat & tidy look.

- a. Establish the centre of the bumper.
- b. Mark the cut-out 90mm wide x 115mm deep from the bottom lip of the bumper.
- c. Cut the bumper using an air hacksaw or other suitable cutting device.
- d. De-burr all cut edges.
- e. Refit bumper in reverse of steps 1a-g.

Step 4: Complete Towbar & Apply Spare Compliance Label

- a. Attach TAG Hitch cover with rubber mallet carefully to prevent breaking.
- b. Attach Tow ball to Ball Mount and slide into receiver. Secure with Pull pin and Clip if you are going to tow straight away. Alternatively, secure the Ball Mount in a safe place inside your vehicle.
- c. Apply one of the compliance labels to the pillar of the driver's door. Leave the remaining label and the fitting instructions in the vehicle handbook.



TAG Warranty Statement



SWD warrants your TAG Towbar for its full product life under the following conditions:

- You can show proof of purchase.
- The towbar has been correctly installed by a suitably qualified installer.
- The towbar has not been modified or abused in any way and has only been used for the purpose intended.
- The towbar was not fitted second hand to your vehicle.

The extent of this warranty includes materials and workmanship used in the manufacture of the towbar and is to the equivalent value of current, full replacement cost.

Nothing stated or implied in this warranty limits in any way, the statutory rights that you may have.

To make a claim visit the original installer in the first instance or, if you are unable to or are not satisfied with their help, then contact us direct by phone on 1300 669122 or visit www.swd.com.au.