

---

**Nissan Pulsar**

**Hatch**

**(2013-0N)**

---



Fit with wiring harness part No. xxxxxx

**Part number T2D617**

Maximum towing capacity 1200 kg

Maximum ball load 120 kg

Bar weight 14 kg

## Fitting Instructions

**Warning:**

Safety First: Always use correct safety equipment.

This towbar is NOT to be drilled, cut, welded or modified in any way.

Check the surrounding area before drilling into chassis or body panels for fuel lines, wiring harnesses and other components that may be a hazard.

**General:**

Before fitting this towbar read fitting instructions and check installation hardware is correct.

Check that the towbar is suitable for the vehicle and be wary of any changes to the vehicle design that may conflict with the fitting of this towbar.

After drilling, blow any filings clear, remove any swarf and treat exposed metal with a rust inhibitor.

If this vehicle requires a bumper cut out, please check to make sure that you measure twice and check twice before cutting any panels as some bumper profiles can change.

If you are not sure then ask your towbar supplier.

Tighten all bolts as specified on the last page.

NISSAN PULSAR HATCH (2013-ON)

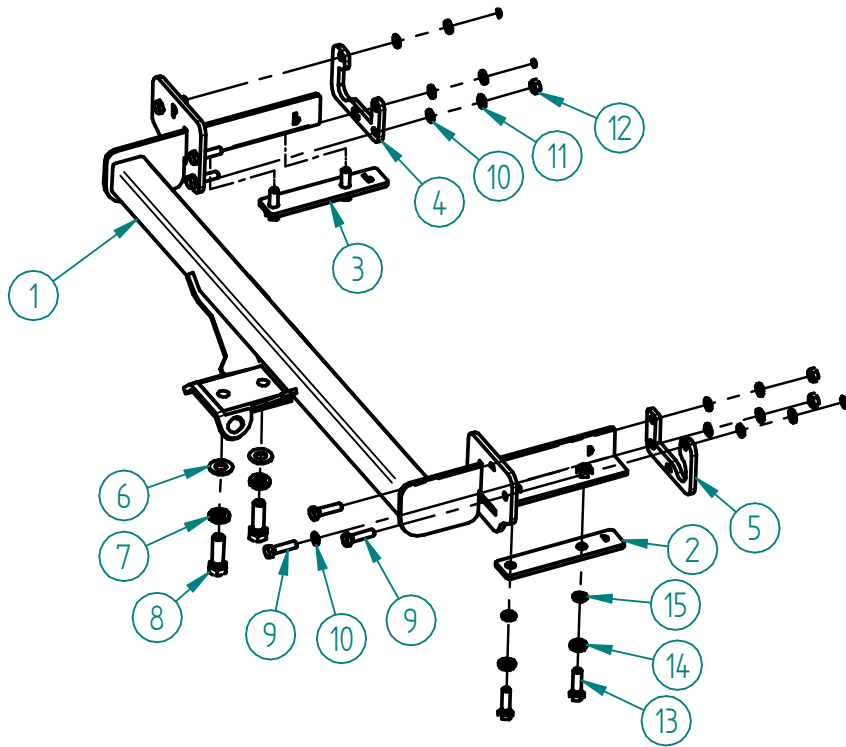

Scheme1

T2D617 Hardware KIT	
Item	Quantity
1. Towbar	1
2. Plate D	1
3. Plate P	1
4. Backplate P	1
5. Backplate D	1
6. M16 flat washer	2
7. M16 spring washer	2
8. M16 x 50 bolt	2
9. M10 x 30 x 1.5 pitch bolt	6
10. M10 flat washer	8
11. M10 spring washer	6
12. M10 x 1.5 nut	6
13. M12 x 35 x 1.5 pitch bolt	4
14. M12 spring washer	4
15. M12 flat washer	4
16. L270 tongue	1
17. Compliance plate	1
18. Door sticker	1

**1.**

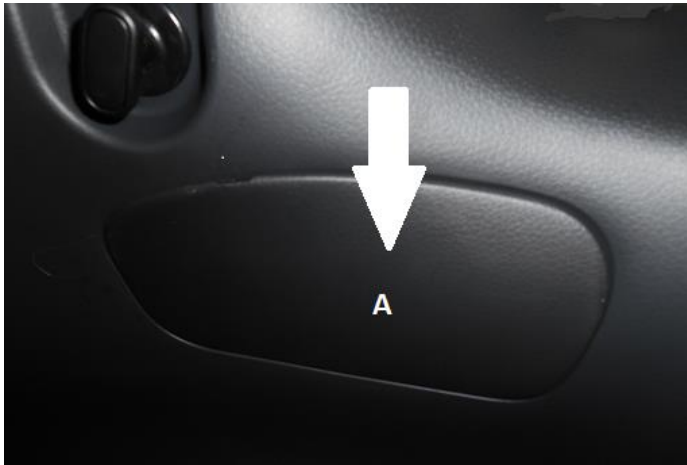

Pic.1

1.1 For undoing taillights remove covers from inside of the boot on the left and right hand side (Pic.1)

**2.**

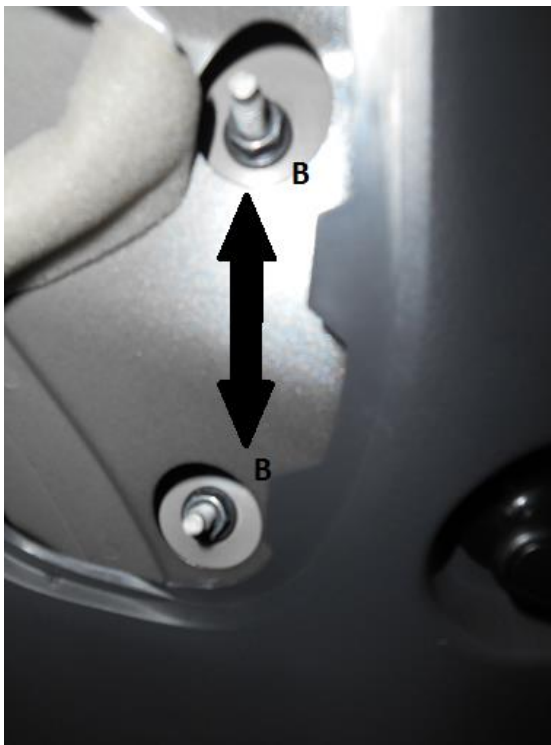

Pic.2

2.1 Remove nuts B from left and right hand side (Pic.2)

2.2 Undo wiring harness from taillights and pull them straight out

NISSAN PULSAR HATCH (2013-ON)

3.

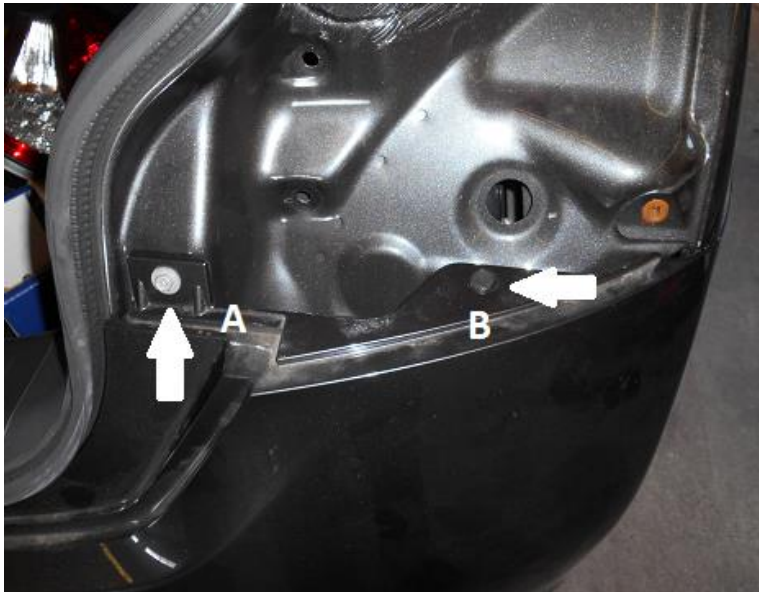

Pic.3

3.1 For removing the pumper bar undo screw A and scrivet B from both sides (Pic.3)

4.



Pic.4

4.1 Remove bumper bar scrivets and bumper bar (Pic.4)

NISSAN PULSAR HATCH (2013-ON)

5.



Pic.5

5.1 Remove and discard shock absorbing foam

6.



Pic.6

6.1 Remove and discard crash cans from both sides

**7.**



Pic.7

7.1 Open up chassis rail cavity, use chassis rail inside as a guide

7.2 Remove any swarf and treat exposed metal with a rust inhibitor

**8.**

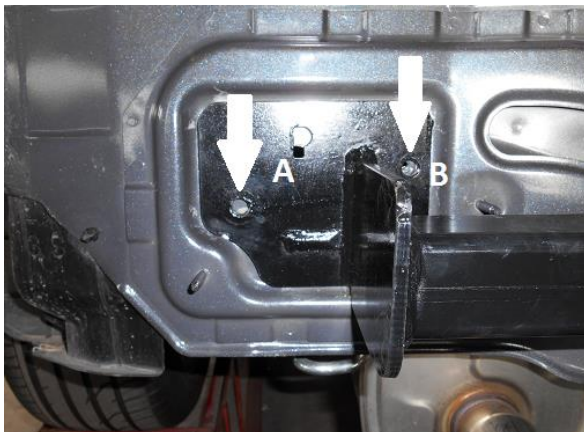

Pic.8

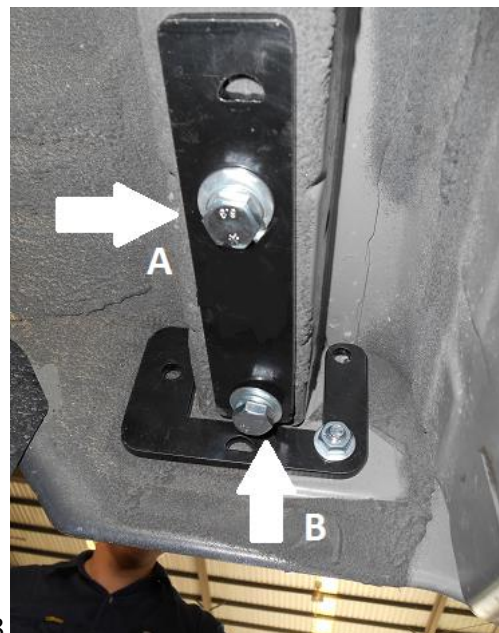

Pic.9

8.1 Slide towbar endplates into the chassis rail (Pic.8) and match the holes in the towbar endplate and chassis rail (Pic.9). Tighten bolts loosely.

8.2 Mark holes A and B (Pic.8) and drill two holes into the beaver panel.

8.3 Mount Backplate P and Backplate D (Scheme 1 and Pic.9)

**9.**

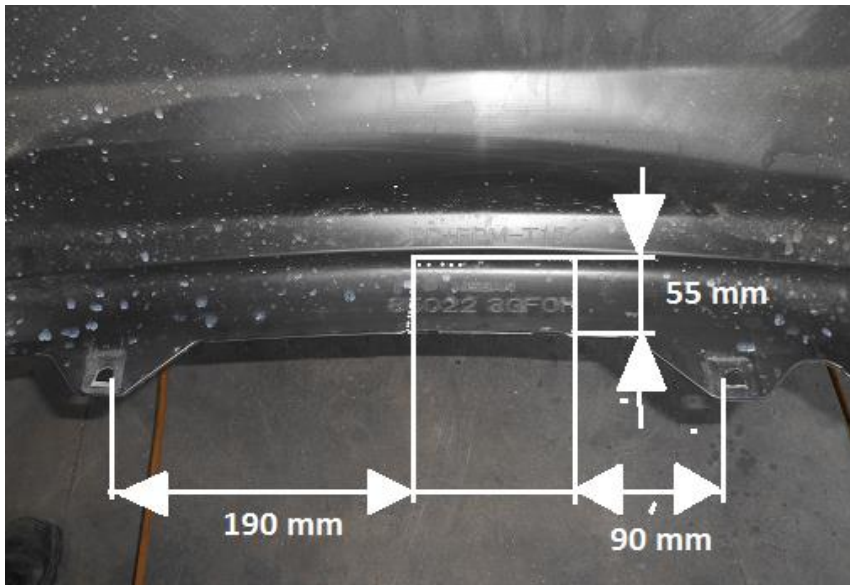

Pic.10

9.1 Make the cut out into the bumper bar

MEASUREMENT GIVEN FROM THE INSIDE OF THE BUMPER BAR

**10.**

10.1 Fit supplied compliance plate to the towbar and door sticker inside of the driver's door pillar.

10.2 Refit the bumper bar and tail lights in reverse order

10.3 Mount the lug mount to the towbar

**Torque table for bolt tightening**

<b>Metric GRADE 8.8</b>	<b>UNC GRADE 8</b>
M6 - 12.5 Nm	3/8 - 50 Nm
M8 - 30 Nm	1/2 - 125 Nm
M10 - 60 Nm	5/8 - 245 Nm
M12 - 103 Nm	
M14 - 167 Nm	
M16 - 270 Nm	