

Fitting Instructions



SKU

UNT364

PRODUCT

Towbar Wiring Harness for HAVAL H6 SUV (02/21 to 05/25) Petrol & HEV

SPECIFICATIONS

- Approx. Fitment Time: 60 Minutes
- Dealer Coding Required: No
- RPA override: Yes (Optional Auto)
- Plug & Play: Yes (splicing required for auto RPA disable)

*Not compatible with 2025-on Facelift models



Scan for latest version of these instructions

TOOLS REQUIRED

- Spanners
- Sockets
- Side Cutters
- Screw Drivers

IN THIS GUIDE

- Fitment Instructions
- Warnings
- Warranty Info

Important Information



Warning:

- **This unit is designed to bypass the electronic control module in the vehicle.**
- **This unit will not require dealer coding.**
- The power source wire is for 12volt only. This can be taken directly to the battery or to a constant power source. This wire must have a 10-amp blade fuse housing attached. Please check that a 10-amp fuse is installed.
- **THE 10AMP FUSE MUST NEVER BE REMOVED AND CANNOT BE CHANGED FOR A HIGHER AMP FUSE.**
- If your vehicle has a dedicated towbar fuse within the fuse box, this is to remain as well – no fuse is ever to be removed or cut out.
- Make sure to inform the customer that there is a 10-amp blade fuse on the power source wire wherever you have made the connection, in the event the fuse needs to be replaced. **Kindly show them where they can access it.**
- Please give this copy of the instructions to your customer.
- Contact an authorised TAG distributor or the TAG fitment center - (07) 3208 3022 - if further information is required.

7 Pin Flat Plug & Socket

PIN No.	CIRCUIT	COLOUR
1	Left-hand turn	Yellow
2	Reversing signal	Black
3	Earth return	White
4	Right-hand turn	Green
5	Service brakes	Blue
6	Stop lamps	Red
7	Rear lamps, clearance & side marker lamps	Brown



7 Pin Plug



7 Pin Socket

Step 1: Install Wiring Harness

1. For petrol vehicles, in the engine bay, disconnect the negative battery terminal.
2. For HEV/PHEV models the battery is located in the rear luggage compartment.
3. Open the tail gate.
4. Remove the 2 caps and 2 bolts securing each of tail light assemblies.



5. Carefully dislodge the tail light assemblies and disconnect the connectors before removing both tail light assemblies. Put them aside.
6. Remove 2x scrivenets for the rear luggage compartment rear edge scuff trim.
7. Carefully dislodge the rear scuff trim by firmly pulling up. Set aside.
8. Fold down the rear passenger seats.
9. Remove the luggage compartment floor to expose the spare tyre and tools (petrol) or battery pack & battery management module (HEV).
10. On the spare tyre, unscrew the wingnut and plate and remove the spare tyre and set aside.
11. Remove the tools then remove the plastic nuts to remove the polystyrene insert.

Petrol



HEV



Installation Instructions



12. Remove any screws and bolts which secure the Left Hand Side rear luggage compartment trim.
13. Dislodge the Left Hand Side rear luggage compartment trim by firmly pulling on its edges towards the centre of the vehicle.



14. Push the Left Hand Side tail light grommet and connector into the vehicle through the grommet hole.
15. On the trailer harness, find the 14-way connector and feed through the tail light grommet hole including the earth branch, power branch and 10 way connector up until the 40mm grommet on the trailer harness.
16. Seat the grommet into the tail light grommet hole and ensure it makes a good seal.

Feed trailer harness through grommet hole

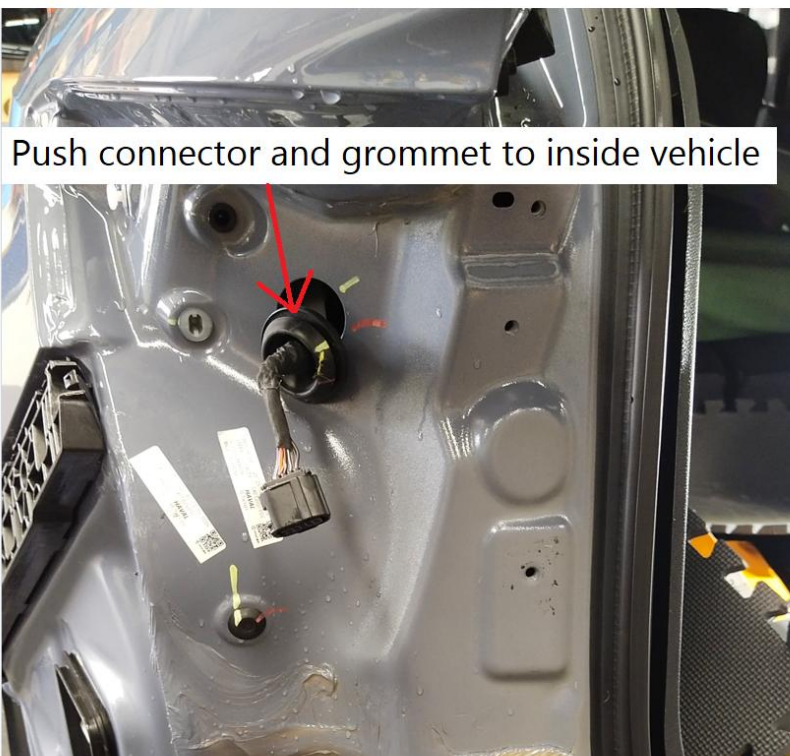

Push connector and grommet to inside vehicle

Installation Instructions



17. Inside the vehicle behind the Left Hand Side luggage compartment trim, connect the 14 way connector to the mating connector on the trailer harness ECU (1).
18. Connect the 10 way connector to the mating 10-way connector of the Left Hand Side tail lamp (2) vehicle harness which was pushed in, in step. 14

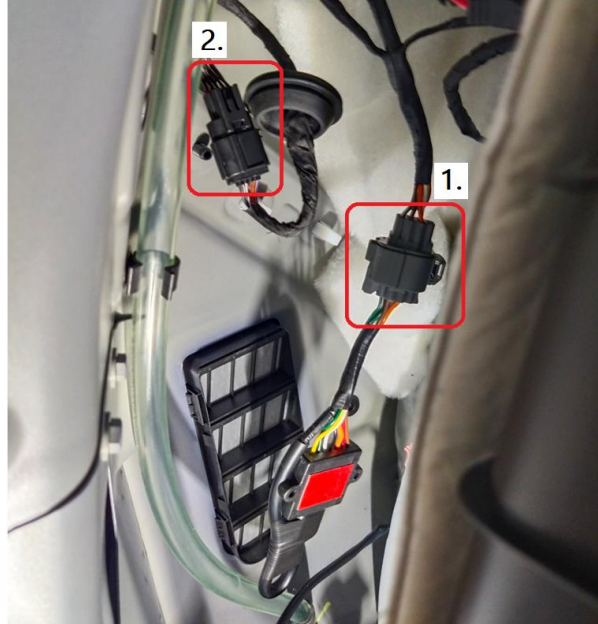

19. On the outside of the vehicle. Route the Right Hand Side branch of the trailer harness towards the Right Hand Side Tail Lamp connectors.
20. Connect the Right Hand Side tail light connector to the mating connector on the trailer harness.

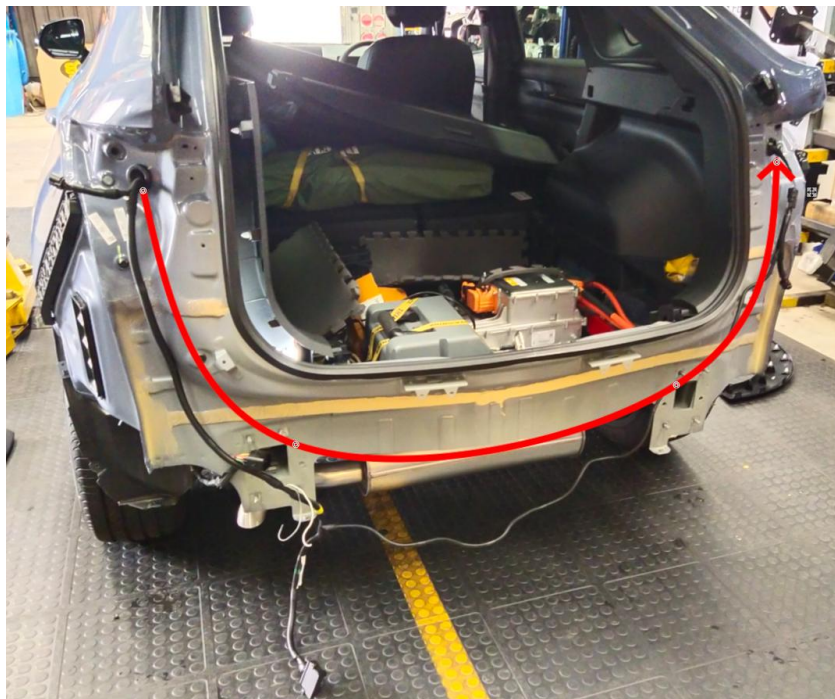

Installation Instructions



21. Behind the Left Hand Side luggage trim panel, find a suitable flat location to mount the ECU.
22. Clean the area with an alcohol cleaning pad (not supplied).
23. Peel back the double sided tape on the back of the ECU then stick the ECU to the previously cleaned area. Hold for at least 15 seconds to ensure good adhesion.
24. Locate the vehicle rear Electronic Module in the vicinity of the Left Hand Side Luggage area.

Petrol



HEV



25. Open the positive (+) terminal cover of the module.
26. Connect the trailer harness Power Supply wire ring terminal (branch with fuse and fuse holder). to positive terminal of the vehicle module.
27. Connect the trailer harness Earth Ring Terminal to one of the studs of the Vehicle Module mounting points.

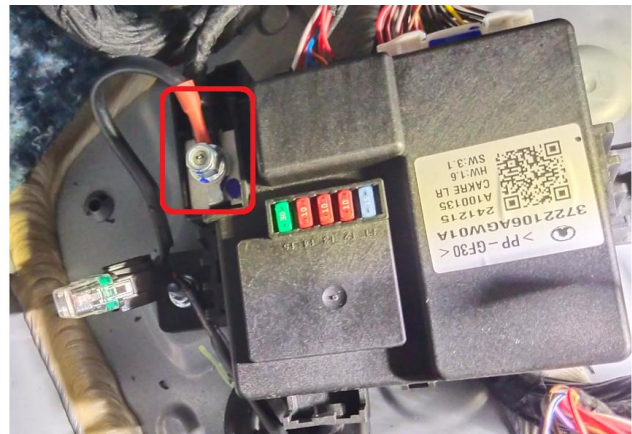
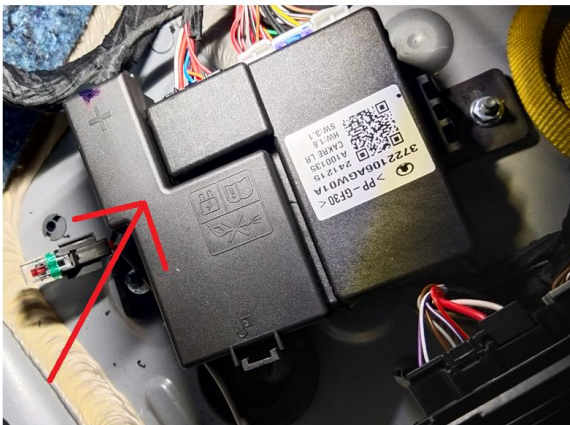

Installation Instructions



For implementing auto RPA cutoff – take the following steps:

NOTE: These steps require cutting and splicing the trailer harness into the vehicle bumper harness. The RPA wires (Grey & Grey/Black) may need to be extended.

This harness uses a “Normally Closed” 7-Pin Flat Socket with Reed Switch (TAG PNo. UNT032RS)

28. Locate the bumper harness connector on the left hand side of the vehicle.



Installation Instructions



For Haval H6 build date prior to 06/21:

29. Peel back the tube/tape to gain easier access to the wires.
30. Locate the **Black/Yellow wire on pin 5**. Cut it 100mm back from the connector. Strip, crimp and seal the trailer harness Grey and Grey/Black wires to the bumper harness Black/Yellow wire (1 Wire going to each side of the Black/Yellow wire).

For Haval H6 build date after 07/21:

31. Peel back the tube/tape to gain easier access to the wires.
32. Locate the **Red/Yellow wire on pin 6**. Cut it 100mm back from the connector. Strip, crimp and seal the trailer harness Grey and Grey/Black wires to the bumper harness Red/Yellow wire (1 Wire going to each side of the Red/Yellow wire).

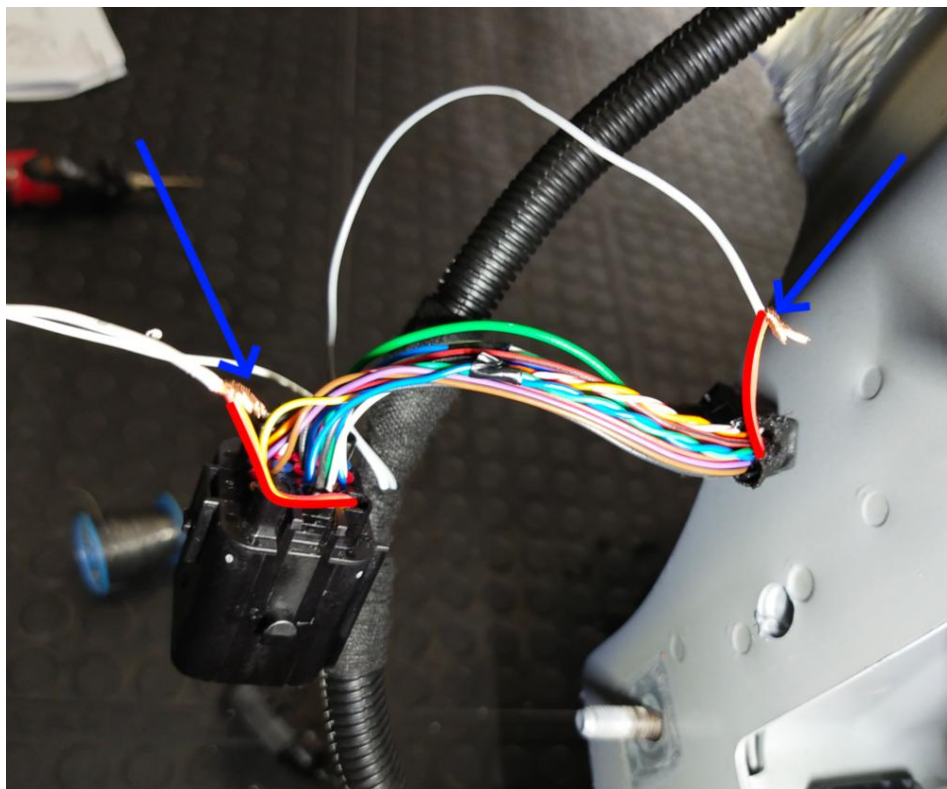
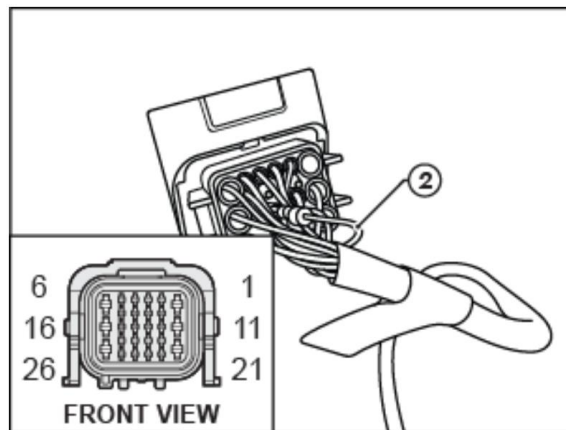

Installation Instructions



33. Tidy up the trailer harness installation with PVC tape & cable ties.



34. Connect the bumper bar harness and the tail lights.

35. Reconnect the positive terminal of the battery

36. Test the function of the harness with a light test board.

37. Test the function of the rear parking sensors

38. Fasten the 7-pin flat plug to the plug mount on the towbar.

39. Place these instructions in the vehicle glove box.

40. Inform customer of the location of the fuse (on the power supply branch near vehicle control module).

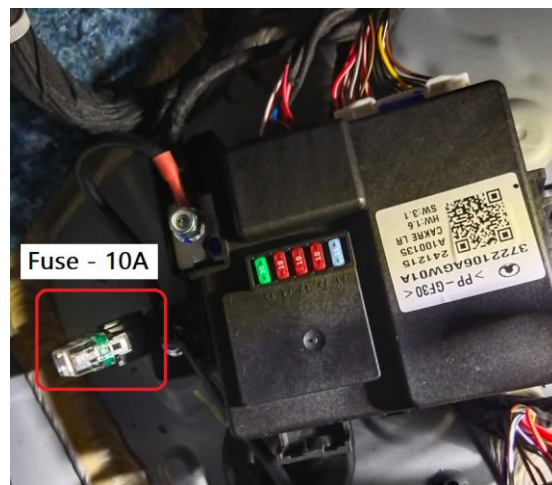

TAG Warranty Statement



SWD warrants your TAG Harness for its full product life under the following conditions:

- You can show proof of purchase.
- The harness has been correctly installed by a suitably qualified installer.
- The harness has not been modified or abused in any way and has only been used for the purpose intended.
- The harness was not fitted second hand to your vehicle.

The extent of this warranty includes materials and workmanship used in the manufacture of the harness and is to the equivalent value of current, full replacement cost.

Nothing stated or implied in this warranty limits in any way, the statutory rights that you may have.

To make a claim visit the original installer in the first instance or, if you are unable to or are not satisfied with their help, then contact us direct by phone on 1300 669122 or visit www.swd.com.au.