

Grab Bar

# 4560

Also 4561, 4562, 4563, 4564, 4565

### Features

- Solid brass construction
- Two-post design
- Complements Columnar product series

### Codes / Standards Compliance

Meets or exceeds the following at date of manufacture:

- All applicable US Federal and State material regulations
- ADA

### Colors / Finishes

- PN: Polished Nickel
- SN: Satin Nickel
- PC: Polished Chrome
- ORB: Oil Rubbed Bronze
- Other: NA



### Specified Model

Model	Description	Colors   Finishes
4560	12" Grab Bar	<input type="checkbox"/> PN <input type="checkbox"/> SN <input type="checkbox"/> PC <input type="checkbox"/> ORB
4561	16" Grab Bar	<input type="checkbox"/> PN <input type="checkbox"/> SN <input type="checkbox"/> PC <input type="checkbox"/> ORB
4562	18" Grab Bar	<input type="checkbox"/> PN <input type="checkbox"/> SN <input type="checkbox"/> PC <input type="checkbox"/> ORB
4563	24" Grab Bar	<input type="checkbox"/> PN <input type="checkbox"/> SN <input type="checkbox"/> PC <input type="checkbox"/> ORB
4564	32" Grab Bar	<input type="checkbox"/> PN <input type="checkbox"/> SN <input type="checkbox"/> PC <input type="checkbox"/> ORB
4565	36" Grab Bar	<input type="checkbox"/> PN <input type="checkbox"/> SN <input type="checkbox"/> PC <input type="checkbox"/> ORB

### Product Specification: Add "Length Indicator and Color / Finish" suffix to Model number, below.

The Grab Bar shall be made of solid brass construction. Grab Bar shall complement Ginger Columnar product series. Grab Bar shall be Ginger Model 456\_\_\_\_/\_\_\_\_.

# 4560, 4561, 4562, 4563, 4564, 4565

Product Dimensions (units are in inches)

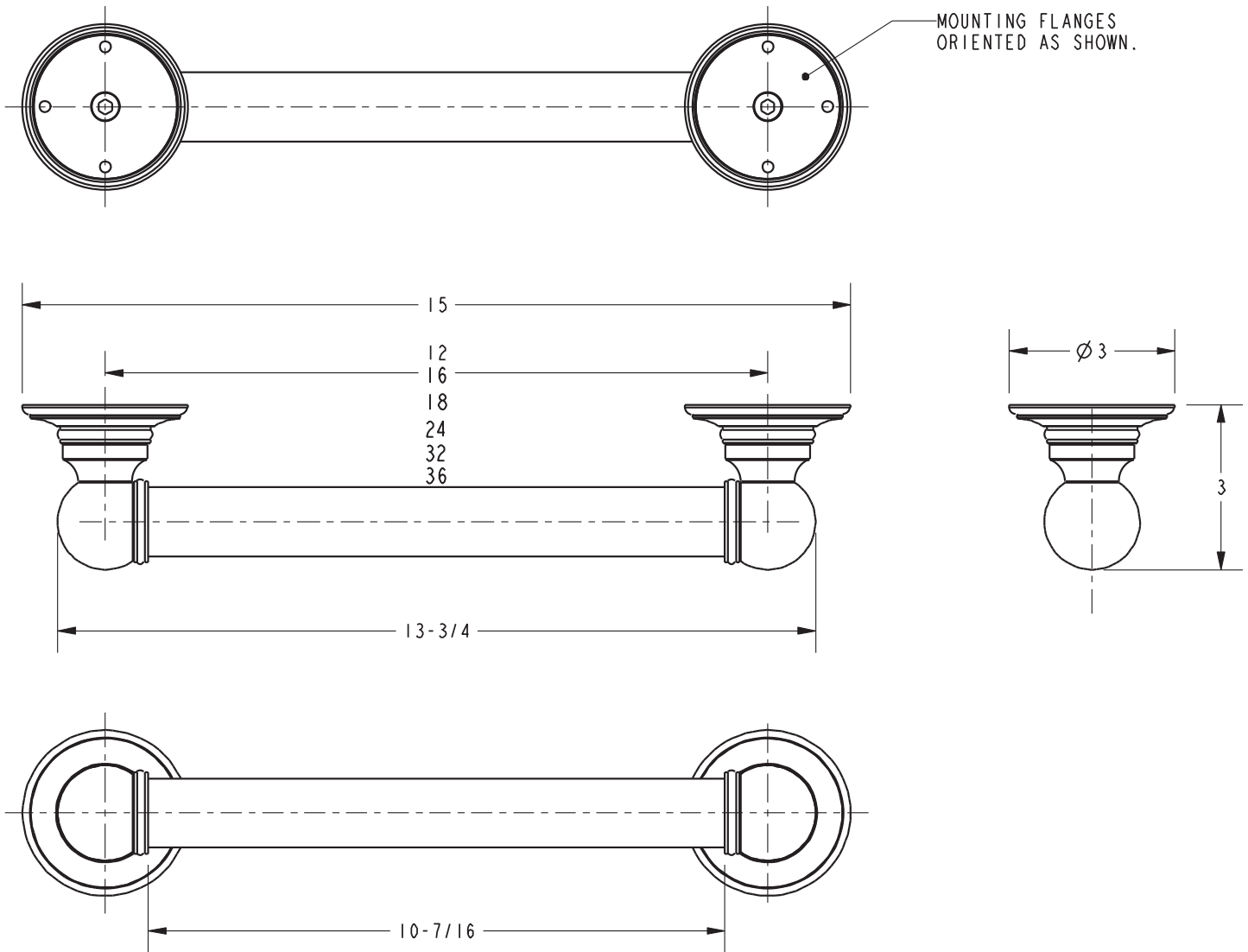

 MEETS OR EXCEEDS ASTM F446 STANDARDS AND CONFORMS TO ADA GUIDELINES.

Columnar Grab Bar  
**4560, 4561, 4562, 4563, 4564, 4565**

page 2 of 2 spec\_4560, 4561, 4562, 4563, 4564, 4565

**GINGER**

t: 949.417.5207 | www.gingerco.com  
©2010 Brasstech, Inc.