

M Collection
Wall-mount vanity
18" height

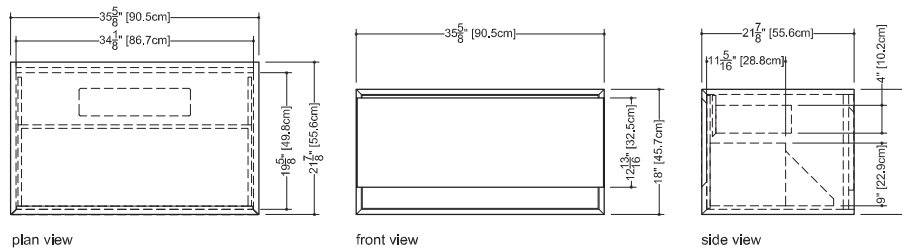

Furniture

Wall-mount vanity M 3618 WM – 1 drawer – 36" length 21 7/8" depth x 35 5/8" length x 18" height – 557 x 905 x 457 mm



Finishes and colors

| | |
|------------|----------------------|
| oak | matte lacquer* |
| natural | white |
| white | light grey |
| wenge | blue steel |
| light grey | sand |
| blue steel | hemp |
| sand | |
| hemp | |
| smoked | |
| walnut | high gloss lacquer** |
| natural | white |
| chocolate | |

- 45 degree bevel cuts precluding the need for drawer hardware
 - all natural wood veneer on dimensionally stable MDF core
 - AWI rated level 5 marine grade finish for moisture resistance and durability (industry's highest finishing class)
 - finished vanity interiors in addition to front and sides finished vanity interiors in addition to front and sides
 - solid maple dovetailed drawer
 - divider for storage
 - drawer within a drawer
 - slow closing ball bearing glides
 - special wall preparation recommendations
- The distance between studs should not exceed 16". Each stud should be reinforced vertically by 2"x3" wooden studs and horizontally with 2"x6" wooden studs at a height of 30" all along the width of the vanity.

* ATTENTION: Vessel sink not recommended with this finish

** ATTENTION: High-Gloss finish on sides and drawer facade only. Bottom and interior in white mat. This finish should only be ordered with an integrated countertop (vessel sink not recommended)

WETSTYLE cannot be held responsible for any technical errors and reserves the right to make revisions without notice.

Approximate measurement.
The manufacturer accepts ±(6.35mm) variance.

www.WETSTYLE.CA - Montreal - Canada
Tel. 450.536.9000 - 1 888.536.9001 - Fax. 450.536.0202

