



DEC305 Cosmo 60" Double Sink Vanity Set



**Design Element**  
Bath Furniture



### Designer's Pick Collection

A vertical pattern created by the long cabinet doors, a striking meld of matte and glossy blacks, and the contrast created by satin nickel hardware and frosty-white porcelain under-mount sinks all work together to create a double sink vanity with futuristic panache and a richness in shapes, textures, and contrast. The solid oak frame, solid oak panels with water-resisting treatments, and granite countertop back up the strength of the visual design with physical robustness and longevity. Hidden pull-out drawers inside of the two soft-closing double-door storage cabinets provide flexible storage options for this full-sized vanity.

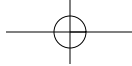

# Cosmo 60" Double Sink Vanity Set

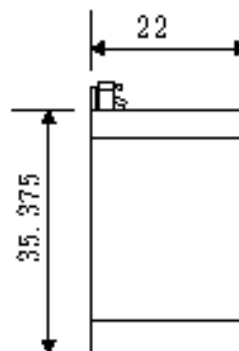
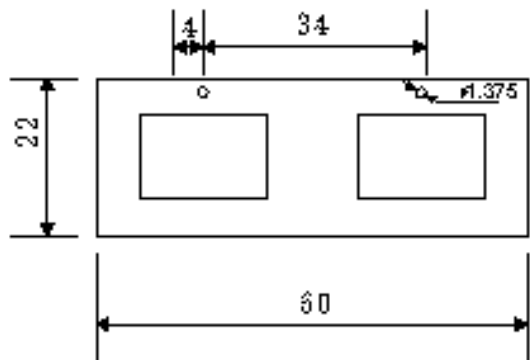
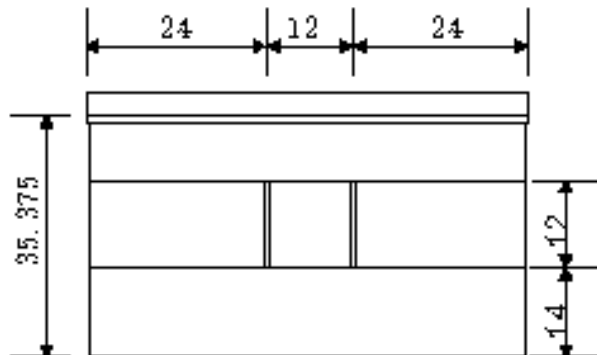
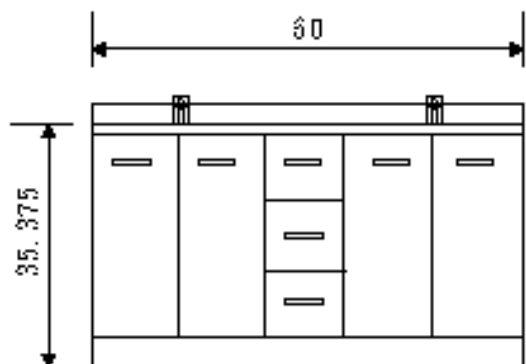

## DEC305 Product Features

- Solid Hardwood Construction
- Galaxy Black Granite Countertop
- Rectangular Under-Mount Sinks
- Polished Chrome Pup-Up Drains
- Two Soft-Closing Double Doors
- Three Functional Drawers and Two Double Door Cabinets with a Hidden Pull-Out Drawer in Each
- Satin Nickel Finish Hardware
- Mirrors and Faucets Not Included
- Dimensions: 60"W x 22"D x 34"H

## Related Product

- Cosmo 60" Double Sink Vanity Set (DEC305)



**Design Element**  
Bath Furniture

8715 Boston Place  
Rancho Cucamonga, CA 91730

[www.DesignElementUSA.com](http://www.DesignElementUSA.com)