



Elena 1

66" x 31.75" x 21.75"

GENERAL SPECIFICATIONS:

Material - Engineered Solid Stone (ESS®)

Installation - Freestanding

Flat rim version may also be undermounted. Must specify on order.

Rolled rim version cannot be undermounted

Not recommended as a tub / shower combination.

Soaker Weight - 212 lbs / 96 kg

Air Bath Weight - 242 lbs / 110 kg

Maximum Fill - 95 gal to overflow

NOTE: Filling this tub to the maximum may require an above average size or dedicated water heater.

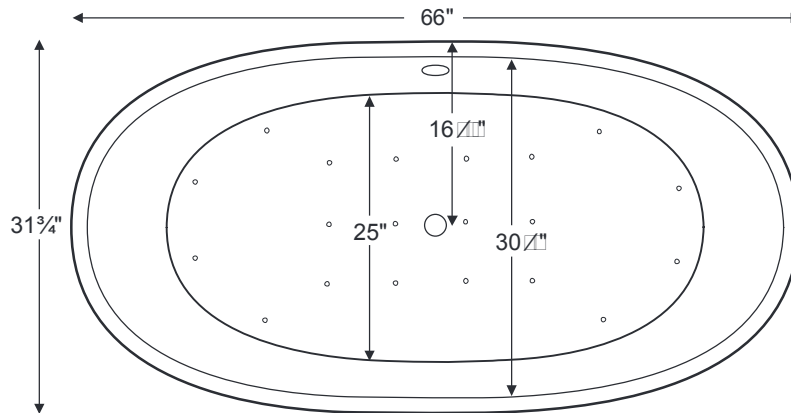

SEE IMPORTANT ORDERING & INSTALLATION INFORMATION BELOW
Shown above as an Air Bath.

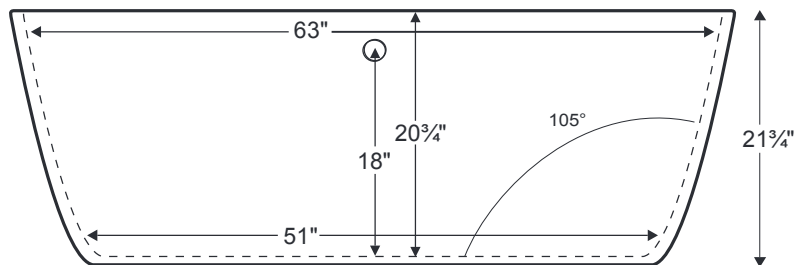

IMPORTANT:
Pedestal base increases overall tub height by 3".



One-piece pedestal base is included with air bath package and increases overall tub height by 3". Not available for soaker package.

ELECTRICAL SPECIFICATIONS:

Required Electrical Service 110 Volt
Air Bath 1-15 amp GFCI

CSA Certified C/US; ANSI Z124.1

See the "Boutique Collection Tubs Installation & Operation Manual" included with tub delivery or go to mtibaths.com/support/installation_operation/manuals for all the information necessary to install and operate the tub.

MTI's Customer Service Department is available Monday-Friday 8am-6pm EST at 800-783-8827 or customerservice@mtibaths.com to answer any questions pertaining to ordering or installation.

IMPORTANT ORDERING & INSTALLATION INFORMATION:

- Requires partial or complete sub-floor drain installation. See installation manual for important installation information.
- Tub includes a pedestal base for air bath package only and increases overall height by 3".
- Also available, Elena 3 (model #220), with integrated overflow and pedestal. See p. A-55.
- Air baths require job site preparations for remote mounting the blower and required check valve. Check valve must be installed higher than the rim of the tub. The keypad is shipped loose and may be mounted on a nearby wall or decking. A waterproof remote control is also included. Please read installation manual prior to ordering.
- Tub is pre-drilled with an overflow, but can be specified without (see local codes).
- Requires use of a wall-mounted or freestanding tub filler.
- Measurements are $\pm 1/2"$ and are subject to change without notice.
- Options and accessories are packaged inside the tub crate for delivery.
- Data herein supersedes all prior to publication date shown below.