

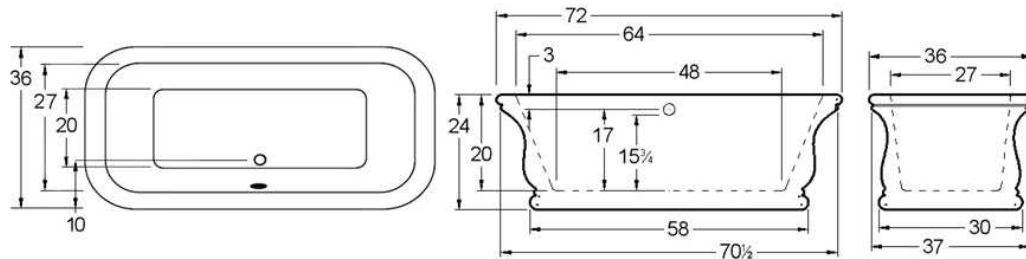

FOB: N. Hollywood, CA)



Airbath System II

Blower must be remotely located

(Diagram is required for custom blower connection locations)

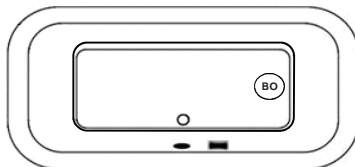

LEGEND:



BLOWER OUTLET



REMOTE CONTROL (INVISIBLE MAGNETIC HOLDER)

STANDARD EQUIPMENT:

- Americh Remote Control
- Integral Waste & Overflow with Polished Chrome trim Available with polished brass, polished nickel, satin nickel or oil rubbed bronze trim at no additional charge if specified at the time of order. Requests after order is shipped are subject to a \$75 list charge for trim

INSTALLATION TIPS

- Install according to Owner's Manual and local codes.
- Hot water supply should be 65-75% of tub capacity or greater.
- Always consult your local plumber for recommendations as installations will vary.

DIMENSIONS:

72" x 36" x 24" deep (1829 x 916 x 533 mm)

Gallon to Overflow = 85 (Liters = 322)

Height to Overflow = 15 3/4" (400 mm)

MATERIAL: Polymer Composite (White and Biscuit Only)

TUB FLOOR: Non-Textured

UNDERMOUNT: No

ELECTRICAL REQUIREMENTS

Americh recommends one 20 amp ground fault circuit interrupter (GFCI) for each power supply provided with the bathtub.

OPTIONAL ACCESSORIES

- Pillows: 13" - Angle
- Linear Overflow
- Stainless steel chain and stopper kit

CODES AND COMPLIANCE

Americh products meet or exceed the following standards:

- Underwriters Laboratories (UL)
- Underwriters Laboratories - Canada (cUL)
- Canadian Standards Association - (CSA)
- ANSI Z124.1 • ANSI A112-19.7 • ANSI A112.19.8

Contact Americh for additional approvals.