

NEWPORT BATH

Wall Tub Spout **220**

Features

- Solid brass construction
- 4-15/16" (12.5 cm) spout length
- 3/4" NPT inlet fitting

Codes / Standards Compliance

Meets or exceeds the following at date of manufacture:

- All applicable US Federal and State material regulations

Colors / Finishes

- 15: Polished Nickel
- 15S: Satin Nickel
- 26: Polished Chrome
- 10B: Oil Rubbed Bronze
- Other: Refer to the Newport Brass catalog for additional color/finish options.

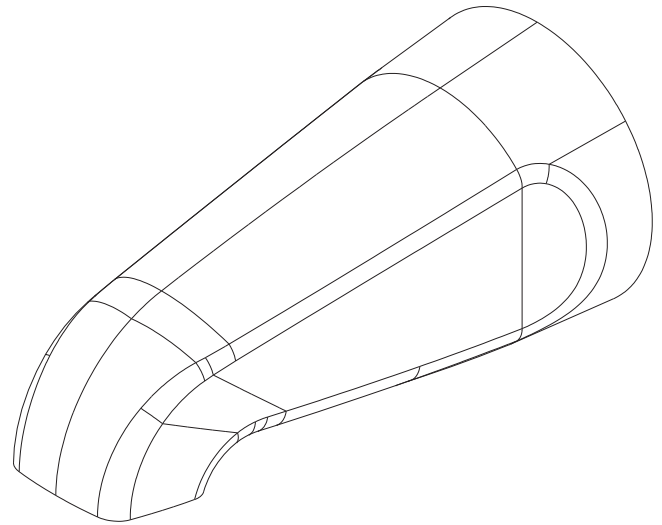

Specified Model

Model	Description	Colors Finishes
220	Wall Tub Spout	<input type="checkbox"/> 15 <input type="checkbox"/> 15S <input type="checkbox"/> 26 <input type="checkbox"/> 10B <input type="checkbox"/> Other

Product Specification: Add Length Indicator and/or "Color / Finish" Suffix to Model Number Below.

The Wall-Mounted Tub Spout shall be made of solid brass construction. Tub spout shall have a length of 4-15/16" (12.5 cm) and incorporate a 3/4" NPT inlet fitting. Tub Spout shall be Newport Brass Model 220/____.

220

Product Dimensions *(units are in inches)*

