

#### TECHNICAL SPECIFICATIONS

#### FEATURES:

- Solid brass construction
- High quality finishing
- Swarovski crystal quality
- 9" spout C to C
- Separated diverter
- CSA approved
- Flow rate: 12 gpm

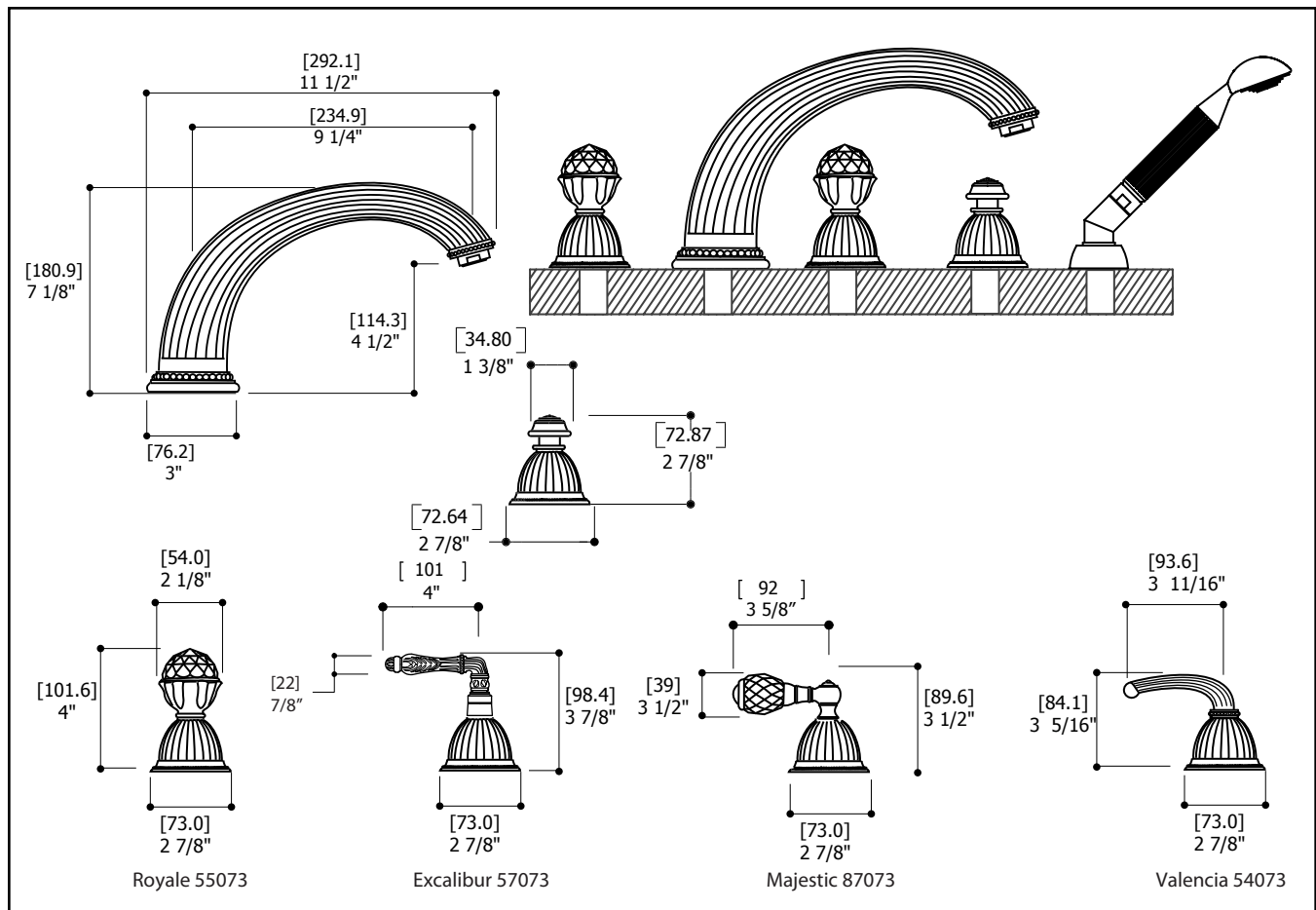

### SERVICE PARTS

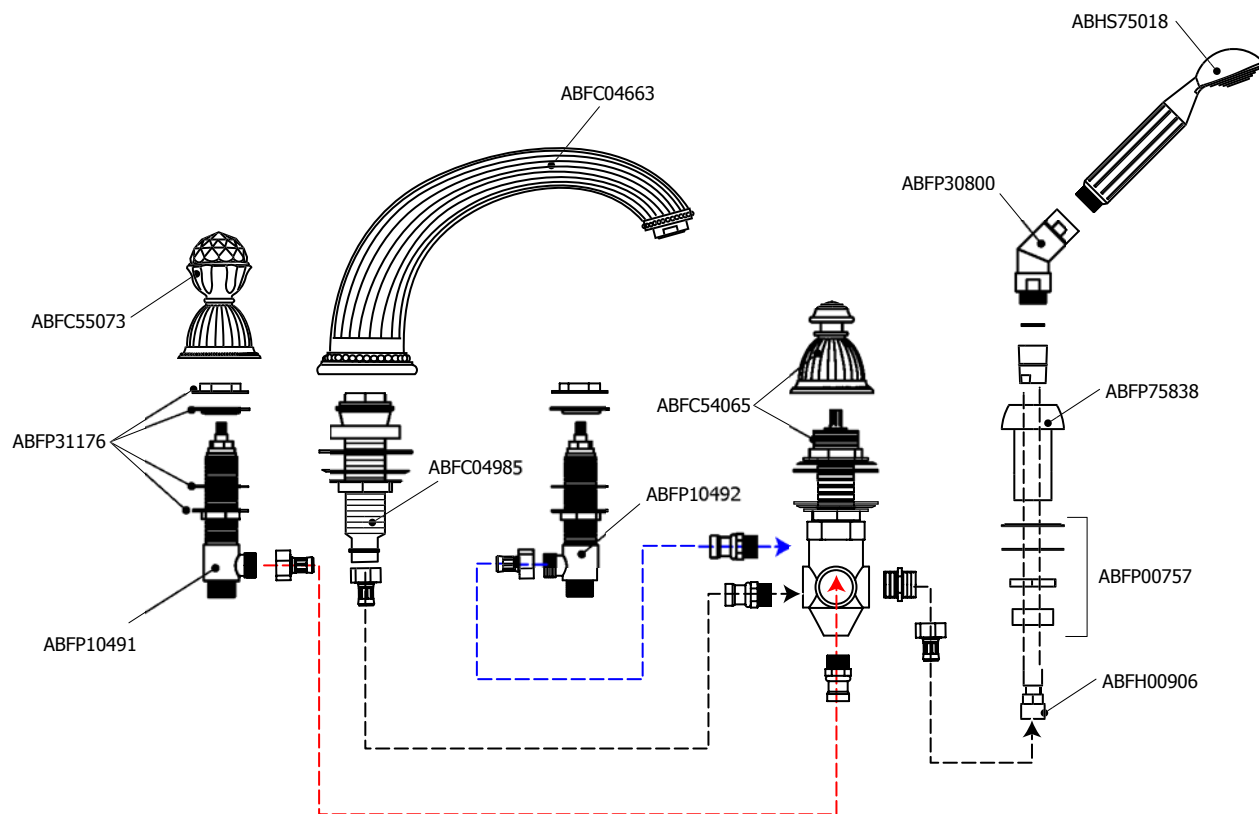

#### FICHE TECHNIQUE

#### CARACTÉRISTIQUES:

- Fabriqué en laiton massif
- Placage très résistant
- Crystal Swarovski
- Déversement projeté 9 1/4"
- Déviateur séparé
- CSA
- Débit: 12 gpm

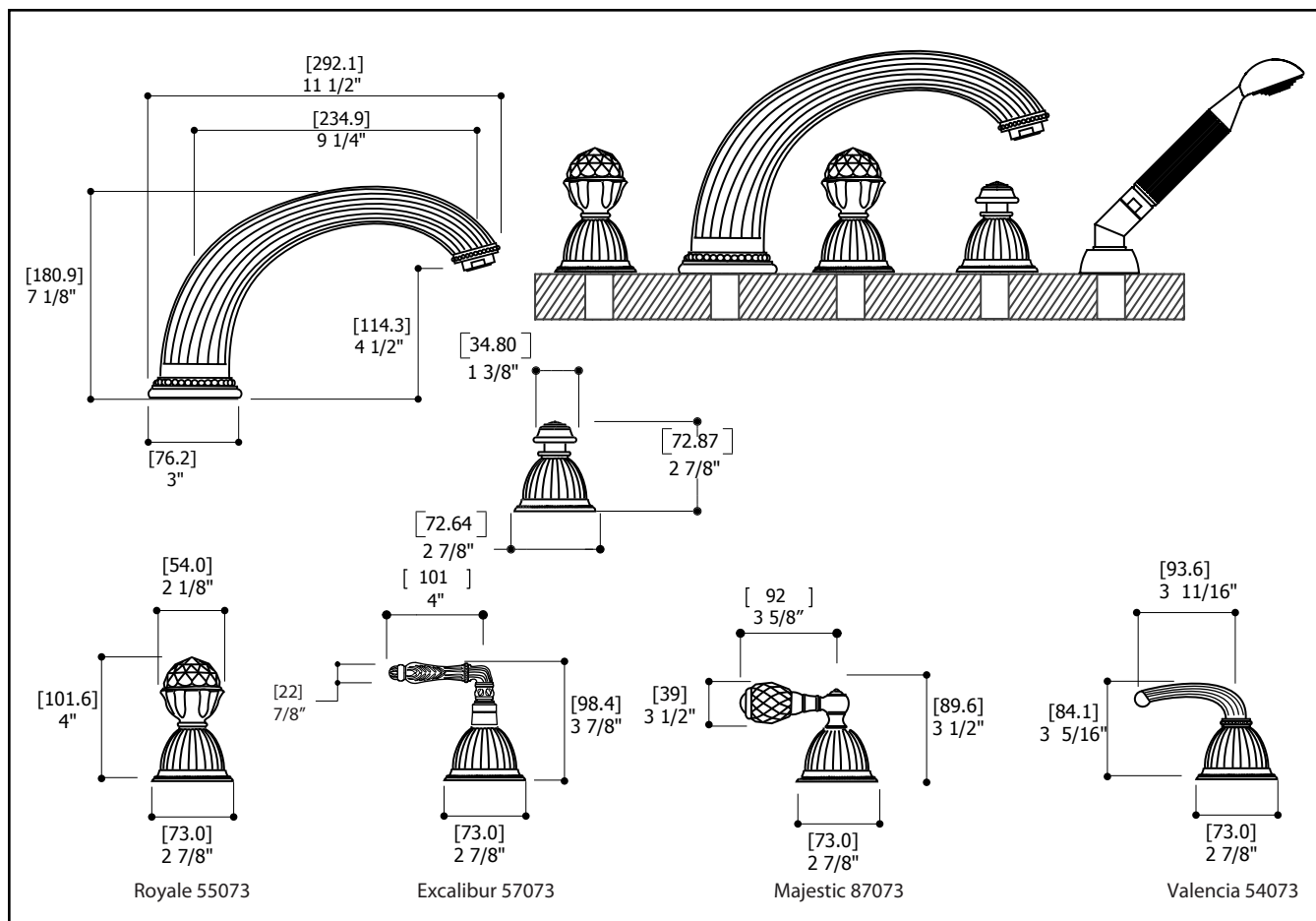

SCHÉMA DES PIÈCES

