

TUB FILLER WITH DIVERTER AND HAND SHOWER

Cat. No.
4023



Shower Head
not included

Features:

- ▶ Code Gooseneck Spout
- ▶ Hand-held Shower and Cradle
- ▶ Check Valve in Handshower
- ▶ Includes 59" hose
- ▶ 1/4 turn ceramic disc cartridges
- ▶ 3 3/8" Centers
- ▶ Includes 6" Wall Support
- ▶ For Cast Iron Tub Use Only (4024 for Acrylic Tub)

Finishes:

- CP Polished Chrome
- BN Brushed Nickel

W: 9"
H: 12"
D: 9 1/2"
Riser Height: 60"

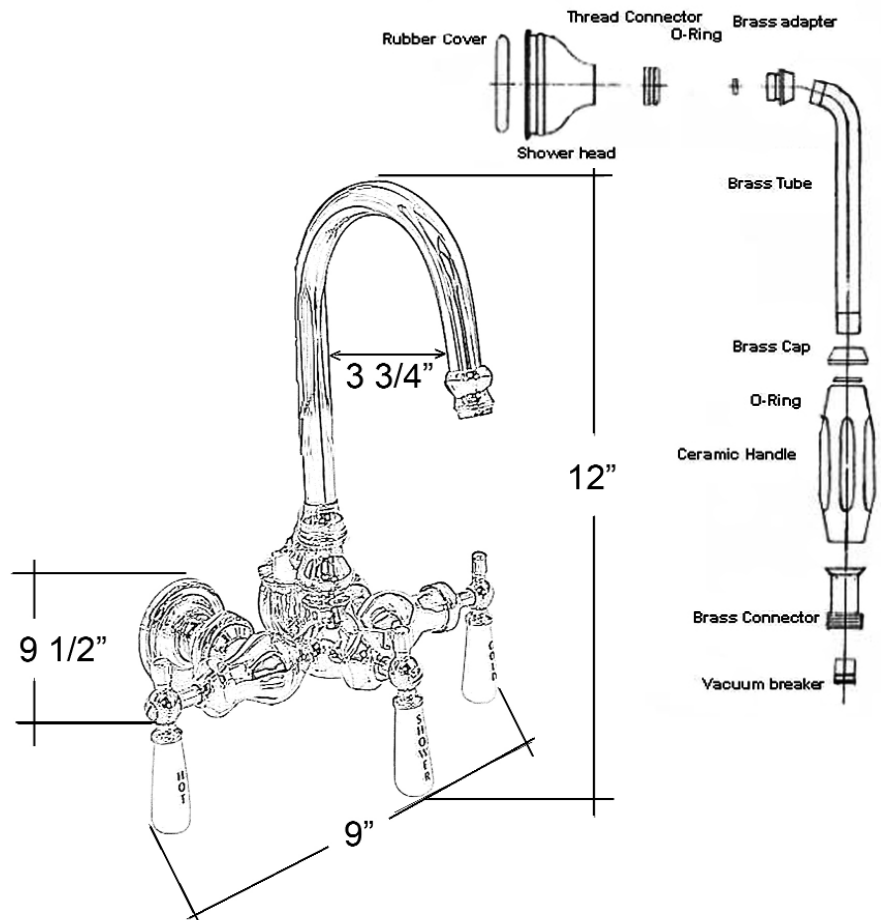

Dimensions of fixture are nominal and may vary. Dimensions and specifications subject to change without notice.