

6. Remove the power trim cylinders (aft end) from the drive unit. The front mounting hardware may be removed for ease of disassembly. It is not necessary to disconnect the hydraulic hoses.

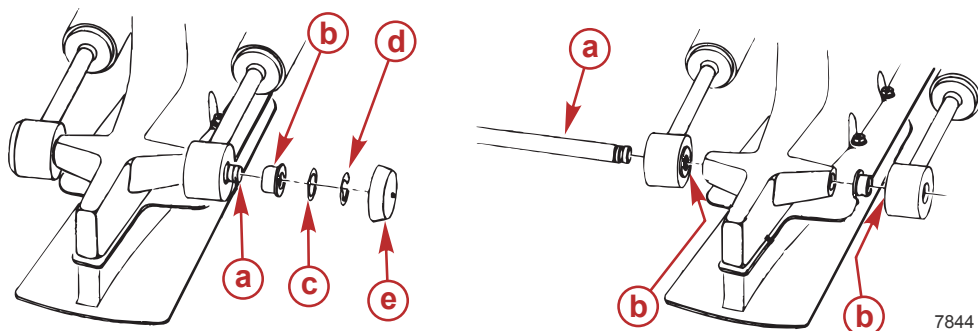

- a - Aft anchor pin
b - Bushing (port and starboard) (4)
c - Flat washer (port and starboard) (2)
d - E-ring clip (port and starboard) (2)
e - Plastic caps (port and starboard) (2)

7. Remove the six locknuts and five washers that hold the drive unit to the transom unit, and remove the sterndrive unit.

⚠ CAUTION

Improperly removing or installing the sterndrive can result in injury. Use a hoist, or other approved lifting device, to properly secure and guide the sterndrive.

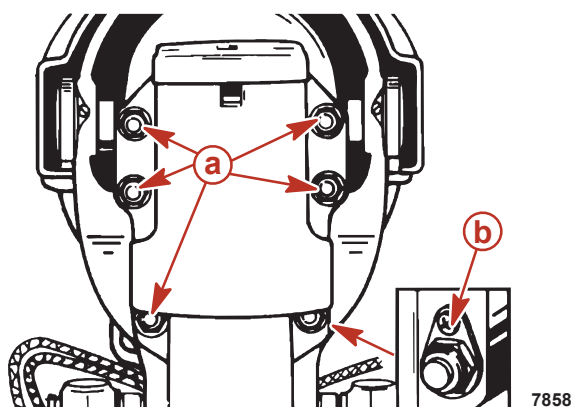

- a - Locknut and flat washers
b - Locknut and continuity circuit washer

8. Remove the bell-housing gasket, water-passage O-ring, and the bell-housing-bore rubber gasket.

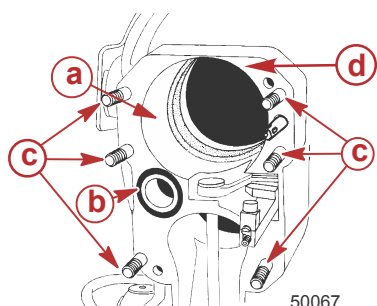

- a - Rubber gasket
b - Water-passage O-ring
c - Studs
d - Bell-housing gasket surface

Sterndrive Installation

1. Install and align the engine. Refer to the appropriate engine service manual for the proper procedure.
IMPORTANT: The rubber gasket must be properly positioned and glued into the bell-housing bore before installing the drive unit or else water may leak into the boat.
2. Ensure that the rubber gasket and water-passage O-ring are properly positioned in the bell housing.

3. Coat the entire length of the studs and threads with the specified lubricant.

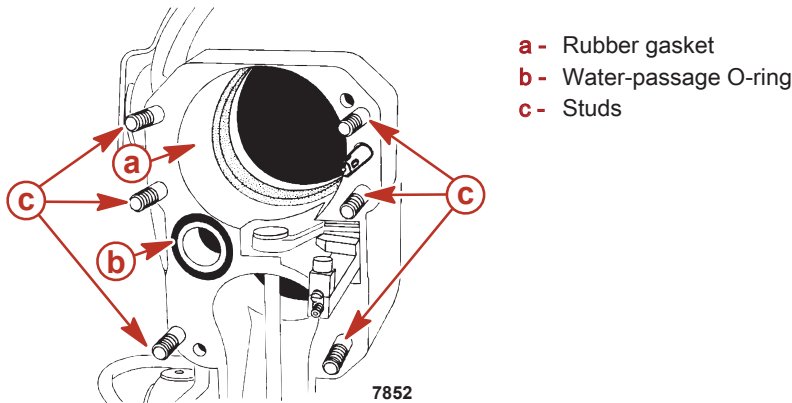

Tube Ref No.	Description	Where Used	Part No.
95	2-4-C with PTFE	Bell-housing studs and threads	92-802859A 1

4. Grease the U-joint O-rings and driveshaft splines.

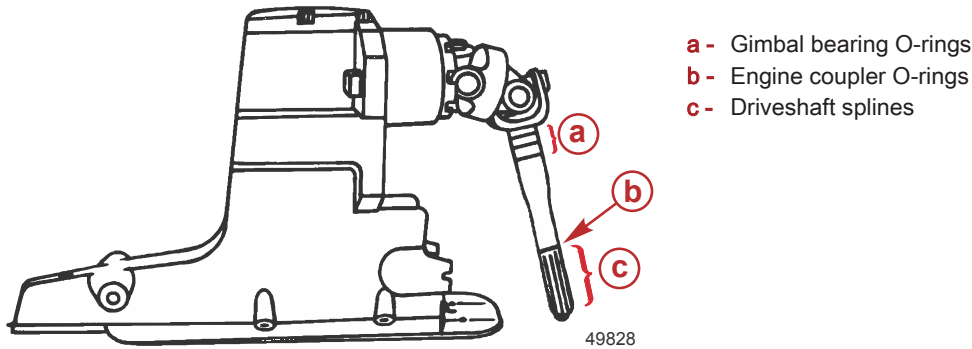

Tube Ref No.	Description	Where Used	Part No.
91	Engine Coupler Spline Grease	U-joint O-rings and driveshaft splines	8M0071842

5. Position the bell-housing shift shaft coupler so that the slot in the coupler is positioned straight fore and aft. Do this by placing the remote control shift lever in forward gear position for the right-hand drive unit or reverse gear position for the left-hand drive unit.

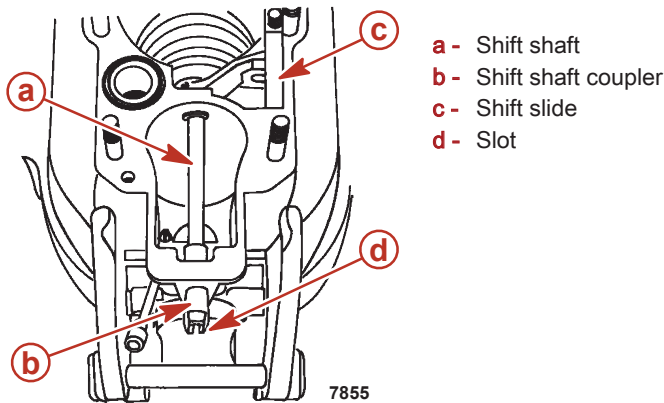

IMPORTANT: The shift slide assembly is free to rotate on the core wire. Ensure that the shift slide remains in an upright position and is properly engaged with the shift shaft lever roller while installing the drive unit.

6. Place the gasket on the bell housing.

7. Snap the shift slide stabilizer tool onto the stud directly below the shift slide and position it as shown. Engage the shift shaft lever roller into the shift slide assembly.

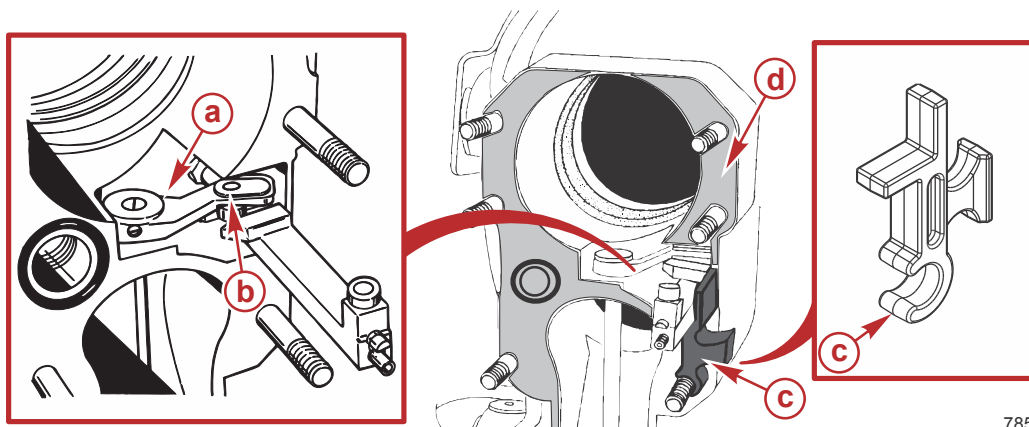

7859

- a - Shift shaft lever
b - Roller
c - Shift slide stabilizer tool
d - Gasket

Shift Slide Stabilizer	91-865232
------------------------	-----------

8. Position the drive unit shift shaft so that it is straight forward by turning the shift shaft clockwise while simultaneously turning the propeller shaft counterclockwise.

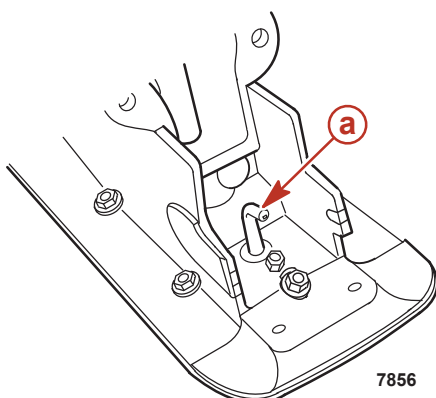

- a - Drive unit shift shaft

7856

IMPORTANT: Install the right-hand and left-hand drive units on the appropriate transom assembly when making dual engine installations. The left-hand rotation drive unit can be identified by the decal on the backside of the upper driveshaft housing, which reads: "Alpha One - Counter Rotation."

9. Install the sterndrive unit as follows:

⚠ CAUTION

Improperly removing or installing the sterndrive can result in injury. Use a hoist, or other approved lifting device, to properly secure and guide the sterndrive.

- Position the trim cylinder straight back (over the top of the anti-ventilation plate). Be careful not to scratch the anti-ventilation plate or the trim cylinders.
- Guide the U-joint shaft through the gimbal bearing and into the engine coupler while simultaneously guiding the shift slide into the driveshaft housing. Ensure that the shift slide remains upright and engaged with the bell housing shift shaft lever.
- Remove the shift shaft slide stabilizer tool.
- Slide the drive unit all the way into the bell housing.

IMPORTANT: If the drive unit will not slide all the way into the bell housing, ensure that the shift shaft and couplers are positioned properly. Do not force the drive unit into position.

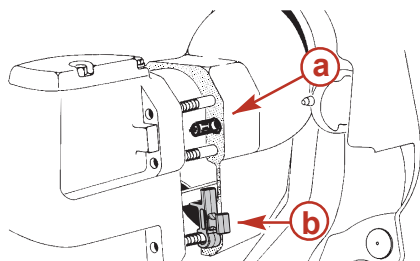

- a -** Gasket
- b -** Shift slide and stabilizer tool

7857

- e. If necessary, rotate the propeller shaft counterclockwise on a standard-rotation drive (clockwise on a counterrotation drive) slightly to help align the U-joint shaft splines with the engine coupler splines while sliding the sterndrive into the bell housing.
10. Secure the sterndrive to the bell housing using the fasteners as shown. First, hand-tighten the fasteners; then, working in a crisscross pattern, tighten the fasteners to the specified torque.

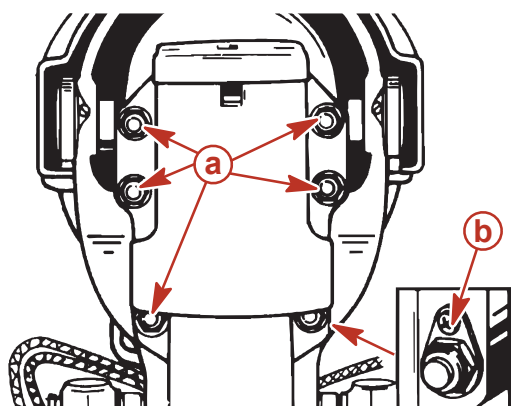

- a -** Locknut and flat washers
- b -** Locknut and continuity circuit washer (no flat washer at this location)

7858

Description	Nm	lb-in.	lb-ft
Sterndrive unit fasteners	68	–	50

11. Return the remote control shift lever to the neutral position.

Trim Cylinder Installation

1. If it has been removed, install the trim cylinders' forward mounting hardware.
2. Coat the area in the trim cylinder between the bushings with 2-4-C with PTFE.

Tube Ref No.	Description	Where Used	Part No.
 95	2-4-C with PTFE	Trim cylinder hardware	92-802859A 1

3. Replace the anchor pin and install the bushings and washers.
4. Attach the E-rings and plastic caps to the end of the anchor pin.

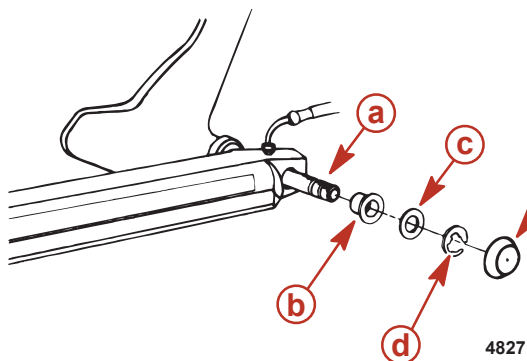

- a -** Front anchor pin
- b -** Bushing (port and starboard) (4)
- c -** Flat washer (port and starboard) (2)
- d -** E-ring clip (port and starboard) (2)
- e -** Plastic caps (port and starboard) (2)

4827

5. Install the trim cylinders' rear mounting hardware.

6. Coat the area in the trim cylinder between the bushings with lubricant.

Tube Ref No.	Description	Where Used	Part No.
 95	2-4-C with PTFE	Trim cylinder hardware	92-802859A 1

7. Replace the anchor pin and install the bushings and washers.
8. Attach the E-rings and plastic caps to the end of the anchor pin.

NOTE: The inboard grooves of the aft anchor pin are for E-ring clips, and wider, outboard grooves are for securing plastic caps.

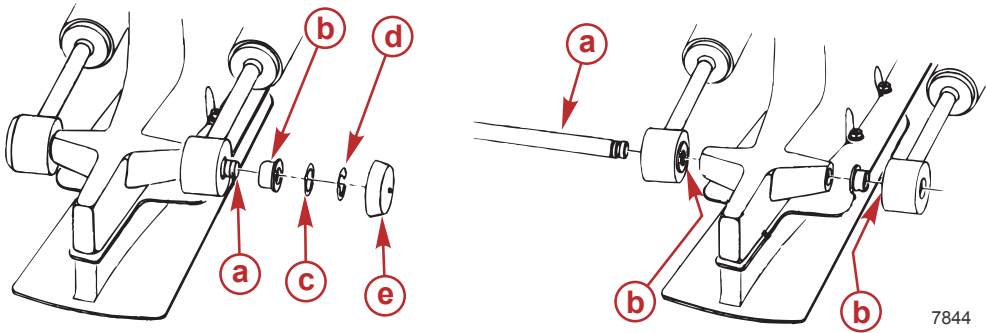

- a - Aft anchor pin
- b - Bushing (port and starboard) (4)
- c - Flat washer (port and starboard) (2)
- d - E-ring clip (port and starboard) (2)
- e - Plastic caps (port and starboard) (2)

Tube Ref No.	Description	Where Used	Part No.
 95	2-4-C with PTFE	Trim cylinder	92-802859A 1

Connect the Speedometer Cable

1. Raise the drive to the trailer limit in order to gain access to the area between the gimbal housing and the sterndrive, immediately atop the transom end of the anti-ventilation plate.
2. Connect the speedometer fittings as follows:
 - **Model years 1997-1/2 and prior:** Align the plastic fittings; then, push down and turn clockwise to engage the locking device.

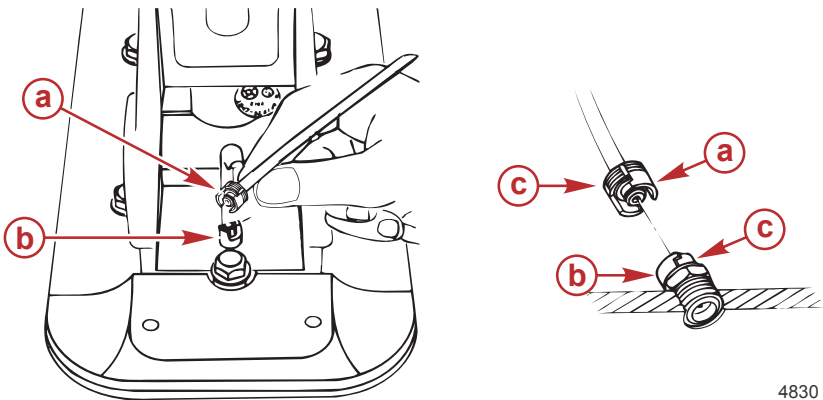

**Model years 1997-1/2 and prior
speedometer connector**

- a - Speedometer connector, male end
- b - Speedometer connector, female end
- c - Alignment slots

- **Model years 1998 and newer:** Push the release button and slide the female portion of the speedometer connector over the male portion.

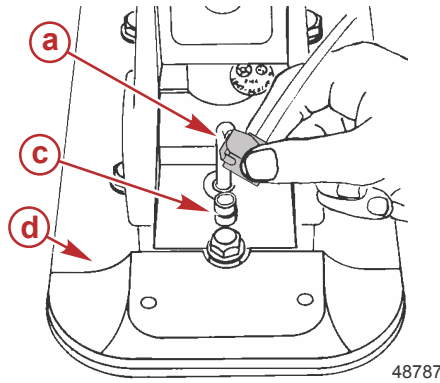
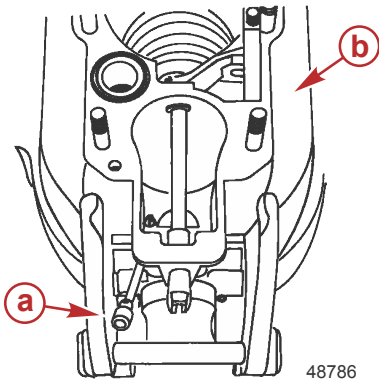

1998 and newer model speedometer connector

- a** - Speedometer connector, female end
- b** - Bell housing
- c** - Speedometer connector, male end
- d** - Drive unit
- e** - Release button

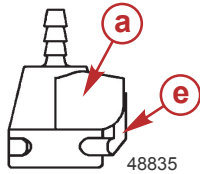

Remote Control Shift Cable Adjustment (Drive Unit Installed)

NOTE: The illustrations on the following pages show models that have a shift plate that is mounted on the exhaust elbow. The shift mechanism components on the 3.0L model are located on the top of the valve cover or on the starboard harness bracket. The procedure for making the adjustments is the same.

IMPORTANT: Shift cable adjustment for a right-hand (RH) rotation drive unit is different than the procedure for adjusting a left-hand (LH) rotation drive unit. Be sure to refer to the appropriate procedure when performing the following steps.

IMPORTANT: The drive unit must be installed before performing the following procedure.

IMPORTANT: Do not run the engine while performing these steps.

1. Remove the remote control shift cable and shift assist assembly, if installed.

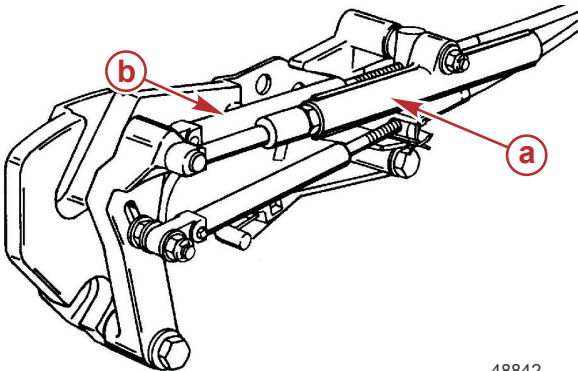

With shift assist assembly

- a** - Shift assist assembly
- b** - Remote control shift cable