

IMPORTANT: Engine alignment tool must slide in and out of the engine coupler and the gimbal bearing with little or no friction.

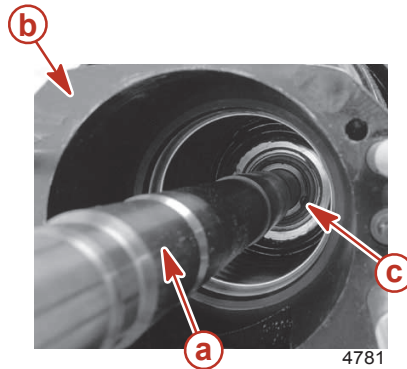

a - Alignment tool
b - Gimbal housing

c - Gimbal bearing

Bravo Sterndrive Installation

1. If applicable, remove trim cylinder support and dust cover from bell housing studs. (Retain elastic stop nuts and flat washers.)

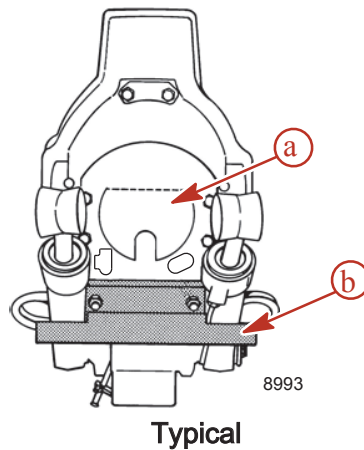

a - Dust cover

b - Trim cylinder support

2. Remove gear lube monitor cap. Fill the gear lube monitor to the "OPERATING RANGE".

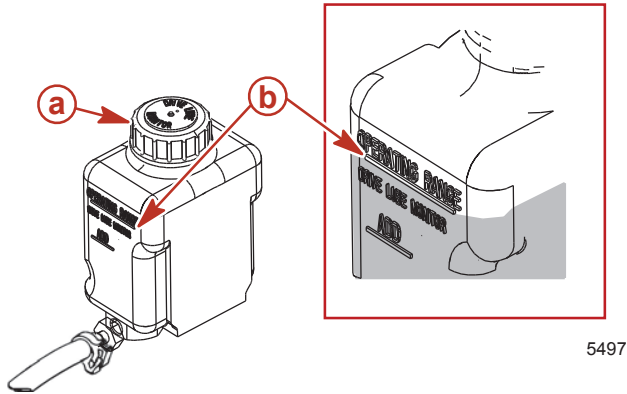

Gear lube monitor

a - Gear lube monitor cap **b** - "OPERATING RANGE" line

Tube Ref No.	Description	Where Used	Part No.
 87	High Performance Gear Lubricant	Gear Lube Monitor	92-858064K01

3. To purge air from the system, push in on the dribble valve stem until the new gear lube appears.

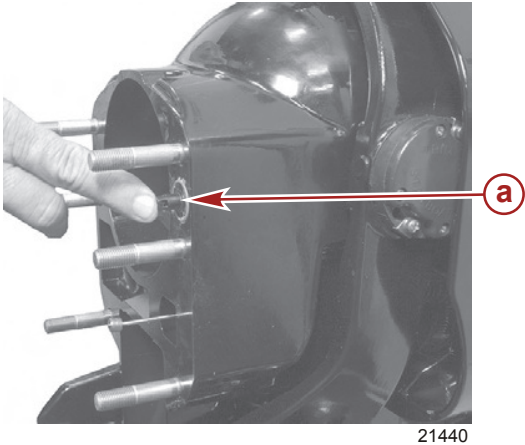

a - Dribble Valve

4. Release the dribble valve.

5. If the gear lube monitor is below the (full) line: Fill the gear lube monitor to the "OPERATING RANGE" (full) line with specified fluid. Do not overfill.

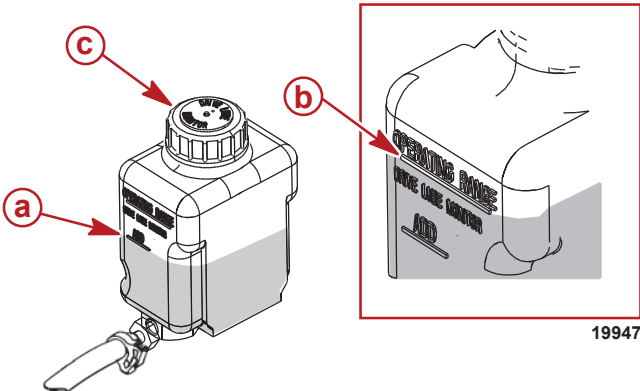

Gear lube monitor

- a** - Gear lube level at the "ADD" mark **c** - Cap
b - Gear lube level at the "OPERATING RANGE"

Tube Ref No.	Description	Where Used	Part No.
 87	High Performance Gear Lubricant	Gear Lube Monitor	92-858064K01

6. Install the gear lube monitor cap. Ensure that the rubber gasket is inside the monitor cap. Do not overtighten the cap.

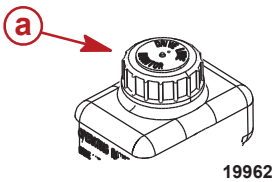

- a** - Gear lube monitor cap

7. Coat the O-rings on the sterndrive U-joint with lubricant

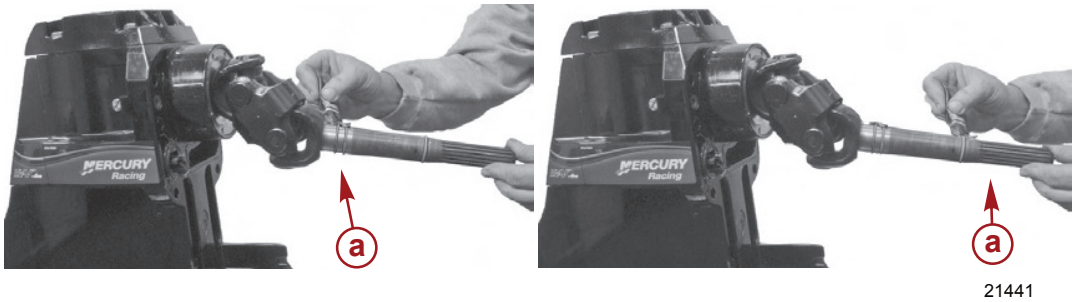



- a** - O-rings

8. Coat the splines on the sterndrive U-joint with lubricant.

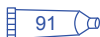

21442

a - Splines

Tube Ref No.	Description	Where Used	Part No.
 91	Engine Coupler Spline Grease	U-joint O-rings	92-802869A 1
 91	Engine Coupler Spline Grease	Driveshaft splines	92-802869A 1

9. Ensure that the U-joint bellows are clean and free of debris.

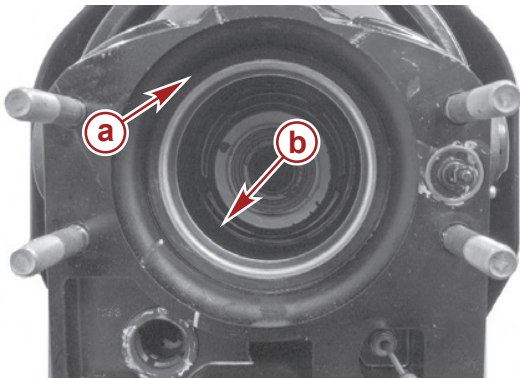

21456

Bell housing of the transom assembly

a - U-joint bellows edge

b - U-joint bellows

10. Lubricate the bell housing studs.

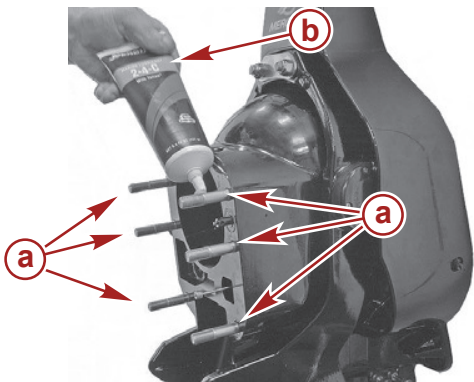

21457

a - Bell Housing Studs (6)

b - Tube of lubricant

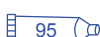
Tube Ref No.	Description	Where Used	Part No.
 95	2-4-C Marine Lubricant with Teflon	Bell housing studs	92-802859A 1

11. Lubricate the shift linkage O-ring.



a - Shift linkage O-ring

Tube Ref No.	Description	Where Used	Part No.
 95	2-4-C with Teflon	O-ring	92-802859A 1

12. Lubricate the water passage seal.

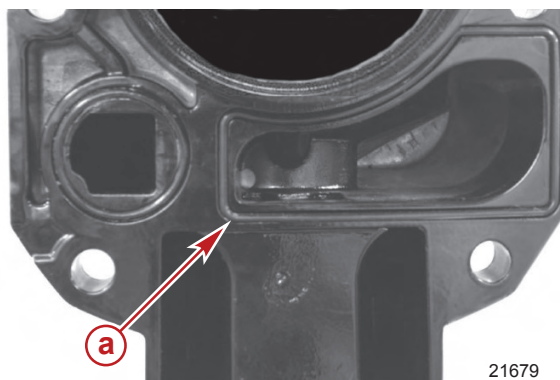

a - Water passage seal

Tube Ref No.	Description	Where Used	Part No.
 95	2-4-C Marine Lubricant with Teflon	Water passage seals	92-802859A 1

13. Pull out the shift linkage as far as it moves. Jaws will open.

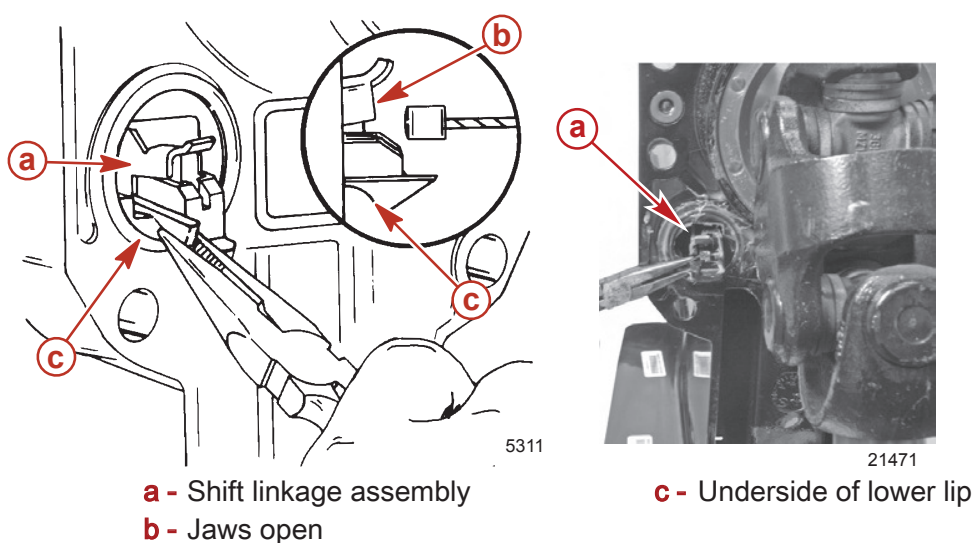

IMPORTANT: As the sterndrive is inserted into the entry of the bell housing, the shift cable must be closely checked to ensure that it enters the jaws of the shift linkage assembly of the sterndrive.

14. Place remote control in NEUTRAL position.

NOTE: As bell housing shift cable enters the shift linkage assembly, it pushes the assembly back into the sterndrive housing, and the jaw closes, securing the cable, as shown in steps "A", "B" and "C."

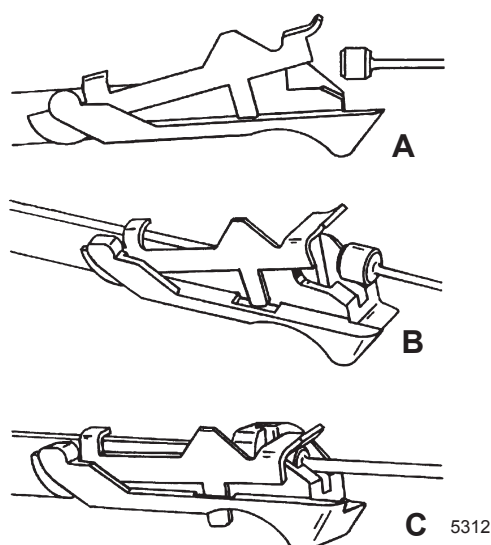

IMPORTANT: If bell housing shift cable does not line up to properly enter jaws of shift linkage assembly, use your hand to guide the cable into place while installing the sterndrive.

15. Place driveshaft housing in position on bell housing and install sterndrive, as follows:

- a. Remove the nuts from the trim cylinders.

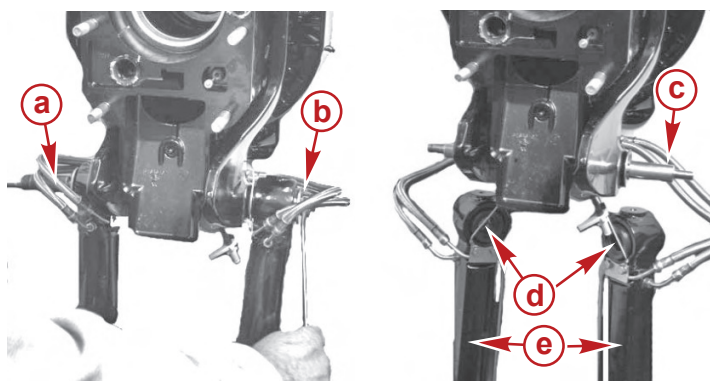

21521

- a** - Socket
b - Wrench
c - Anchor pin

- d** - Ground wires
e - Trim cylinders

- b. Position the sterndrive so that the universal joint shaft aligns with the bell housing bore.

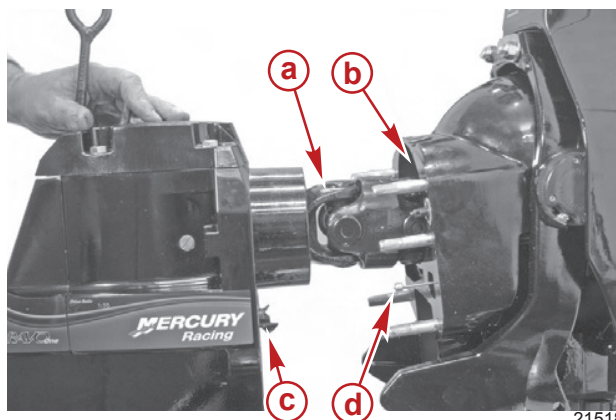

21518

- a** - Universal joint
b - Bell housing

- c** - Shift linkage
d - Shift cable

- c. Guide the U-joint shaft through the bearing in gimbal housing and into the engine coupler. Ensure that shift linkage jaws engage the bell housing shift cable assembly.

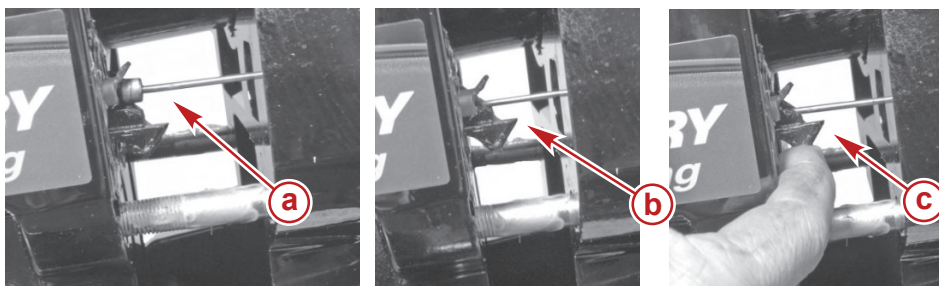

21519

- a** - Shift cable
b - Shift linkage jaws open

- c** - Shift linkage jaws engage the shift cable

- d. If necessary, rotate the propeller shaft COUNTERCLOCKWISE slightly (using a propeller) to align U-joint shaft splines with splines in engine coupling, then slide sterndrive all the way into bell housing.

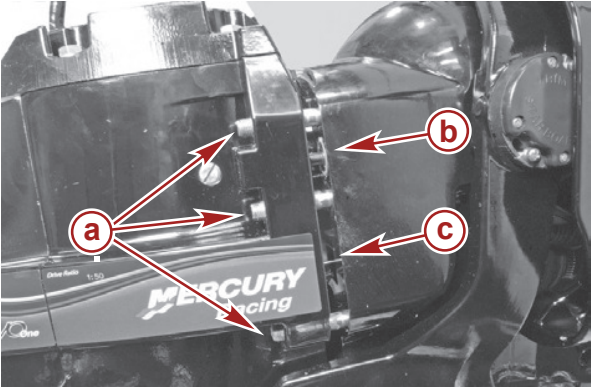

21520

- a** - Bell housing studs
b - Dribble valve
c - Shift cable

16. Secure sterndrive to bell housing with 5 flat washers and 6 locknuts. Start from the center and torque the nuts.

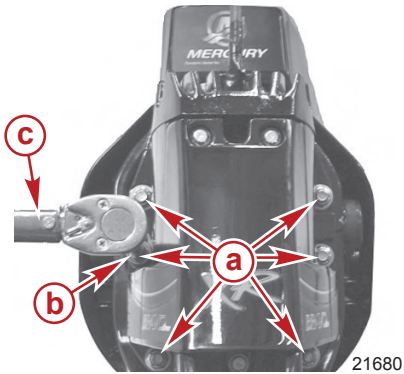

21680

- a** - Locknut (6) flat washers (5)
b - Ground plate (washer not used here)
c - Torque wrench

Description	Nm	lb. in.	lb. ft.
Sterndrive fasteners	68		50

TRIM CYLINDER INSTALLATION

1. Install the mounting hardware of the trim cylinder forward as shown
2. Lubricate anchor pin threads to prevent threads from galling.

3. Hand thread locknuts onto the pin. Do not tighten at this time.

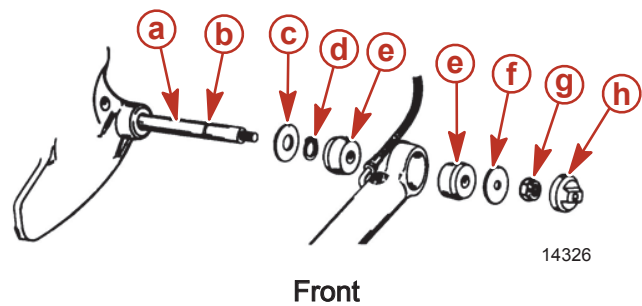

- a** - Anchor pin

b - Retainer clip groove

c - Flat washer (large I.D.)

d - Retainer clip
- e** - Bushing

f - Flat washer (small I.D.)

g - Locknut

h - Plastic cap

Tube Ref No.	Description	Where Used	Part No.
	2-4-C Marine Lubricant with Teflon	Anchor pin threads	92-802859A 1

IMPORTANT: On Bravo One, Two, and Three Models the trim-in limit insert must be properly positioned before installing the trim cylinder anchor pin in the following steps.

NOTE: Ensure that the trim-in limit insert is reinstalled in the same position as before removal of the sterndrive. If you are not sure of the original position, contact the boat manufacturer for their recommendation. Refer to Special Information at the front of this section before reinstalling the trim-in limit insert.

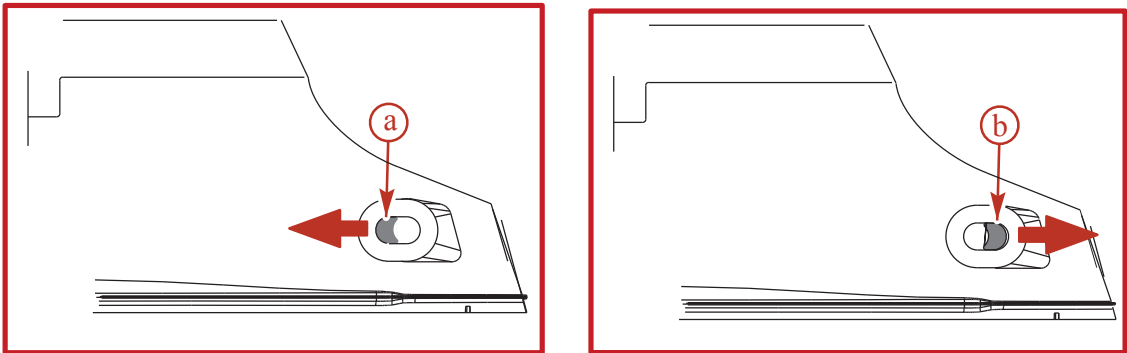

- a** - Trim-in limit insert Bravo One and Two (positioned forward)
- b** - Trim-in limit insert Bravo Three (positioned aft)

4. Install the mounting hardware of the trim cylinder aft as shown.
5. Lubricate anchor pin threads to prevent the threads from galling.
6. Hand-thread locknuts onto the anchor pin.

IMPORTANT: The position of the trim-in limit insert on the Bravo Three sterndrive should only be changed after the boat has been properly tested. Contact the boat manufacturer if you are not sure of the original position for a particular boat application.

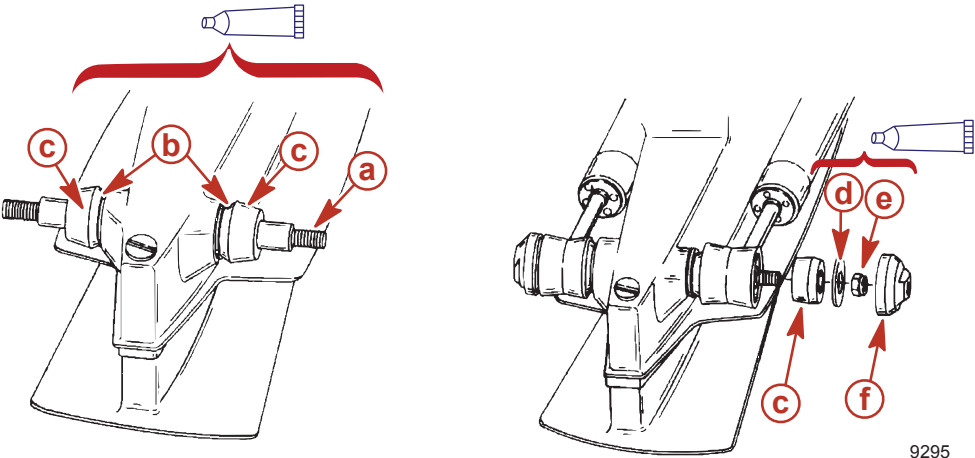

- a** - Aft anchor pin
- b** - Larger flat washers (2)
- c** - Bushings (4)

- d** - Small ID flat washers (2)
- e** - Locknuts (2)
- f** - Plastic caps (2)

Tube Ref No.	Description	Where Used	Part No.
 95	2-4-C Marine Lubricant with Teflon	Trim cylinder hardware	92-802859A 1

- 7. Tighten the locknuts until the washer and locknut contact the shoulder on the anchor pin.
- 8. Install plastic caps and tighten hand-tight only.

NOTE: Upon installation of hardware apply lubricant to all components except plastic caps.

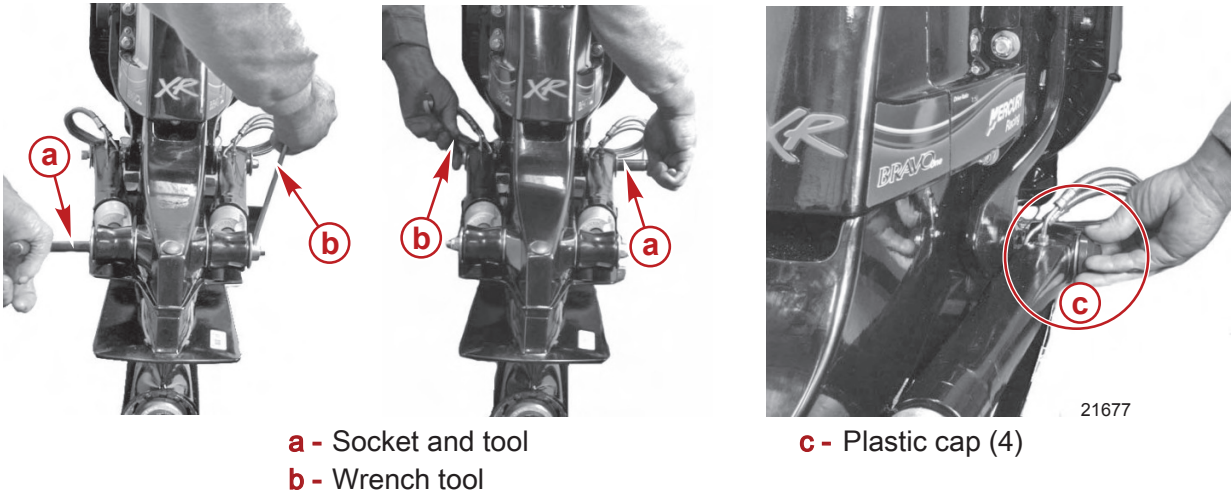

- a** - Socket and tool
- b** - Wrench tool

- c** - Plastic cap (4)

Speedometer Connections - Bravo Models

- 1. Raise sterndrive to gain access to area between gimbal housing and sterndrive, immediately atop the transom end of the anti-ventilation plate.

2. Insert speedometer tube fitting into opening on topside of anti-ventilation plate, in position shown.

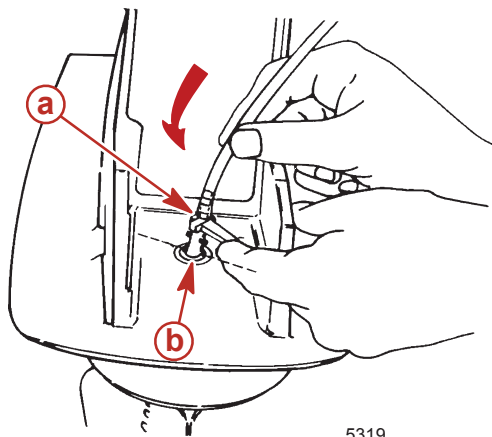

a - Tube fitting

b - Opening

3. With fitting fully seated, turn handle to left to a tightly seated position, as shown.

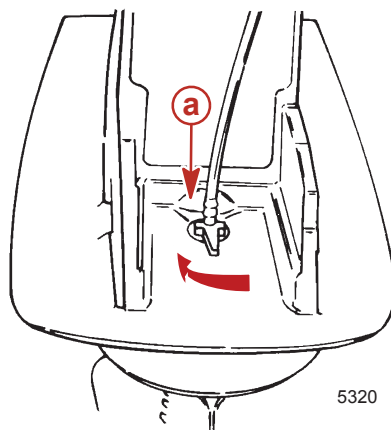

a - Fitting installed (handle pointing forward)

Bravo Sterndrive Shift Check (Engine Running)

⚠ WARNING

Rotating propellers can cause serious injury or death. Never operate the boat out of the water with a propeller installed. Before installing or removing a propeller, place the drive unit in neutral and engage the lanyard stop switch to prevent the engine from starting. Place a block of wood between the propeller blade and the anti-ventilation plate.

This test requires sufficient water supply to your engine and sterndrive.

1. Check sterndrive for proper gear shift with boat out of water.