

INSTALLATION INSTRUCTIONS



MINI MODERN HANGER



MINI MODERN HANGER

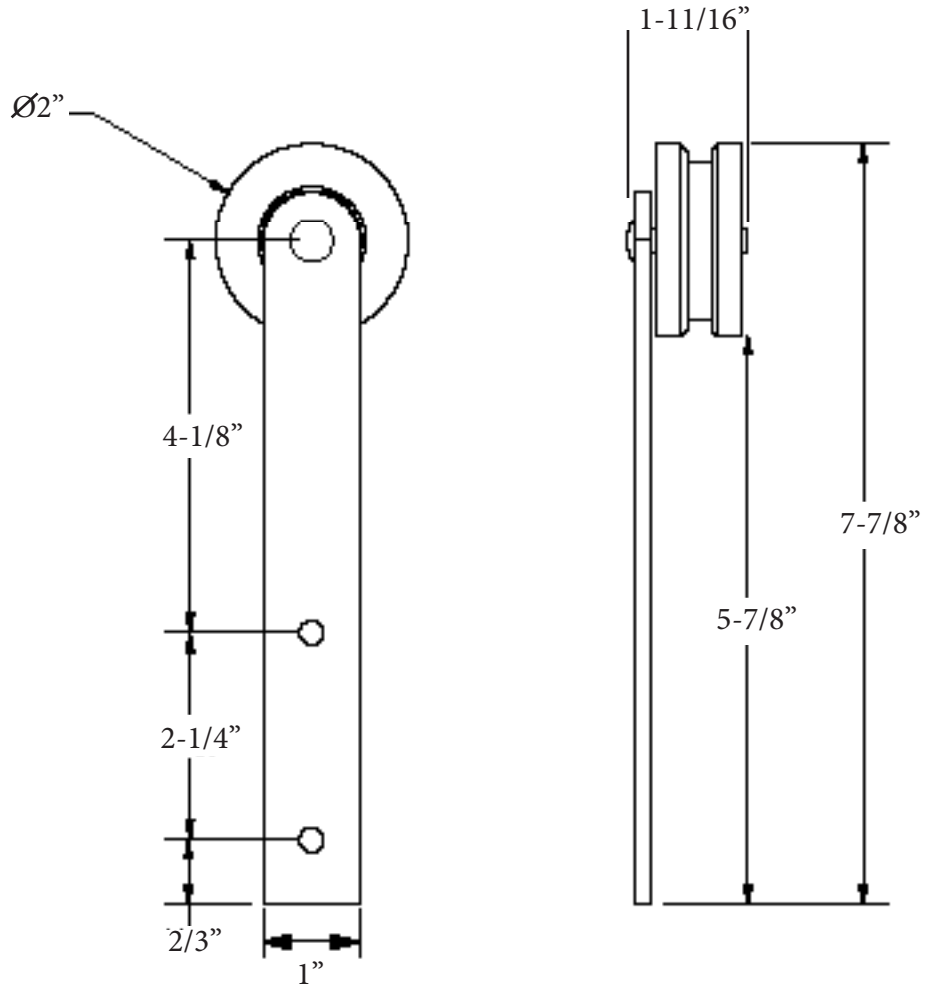

INSTALLATION INSTRUCTIONS

Tools Needed

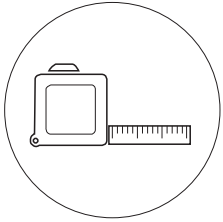

Tape Measure

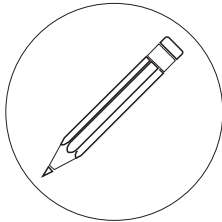

Pencil

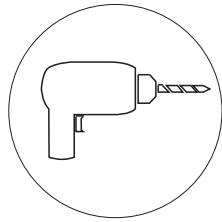

Drill with 1/8", 1/4" and 3/8" bits, 1-1/8" spade bit and Phillips drill bit

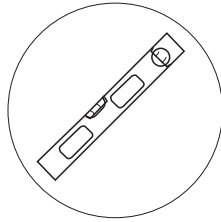

Short Level

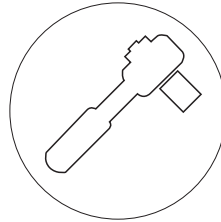

Ratchet with 9/16" and 5/8" sockets

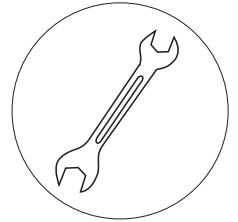

9/16" and 5/8" open end and ratcheting wrench

Parts Included

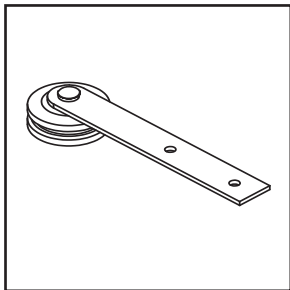

Hanger Assembly

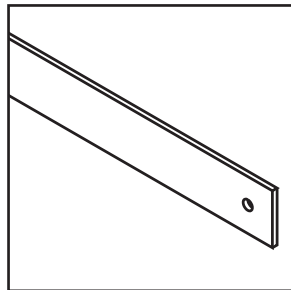

Track

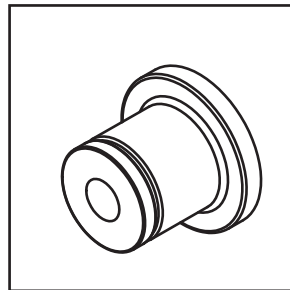

Adjustable Spacers

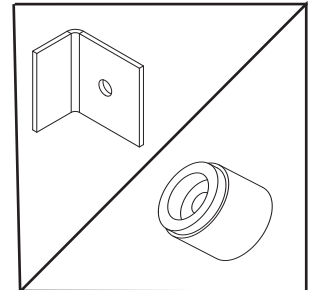

Hard Stops or Lag Soft Stops

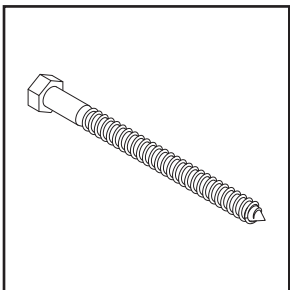

Lag Screws

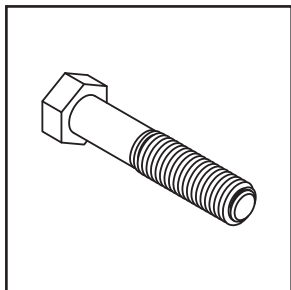

Hex Bolts

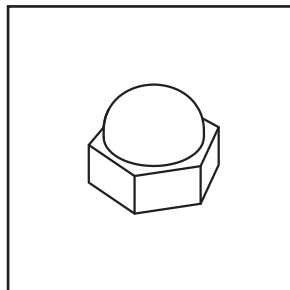

Acorn Nuts

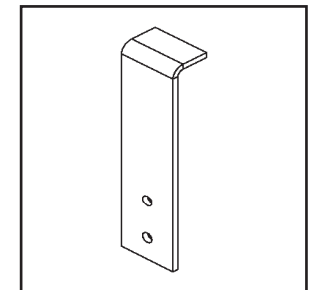

Anti-jump Brackets

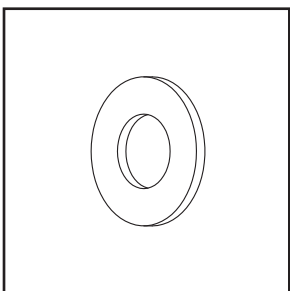

1" Washers

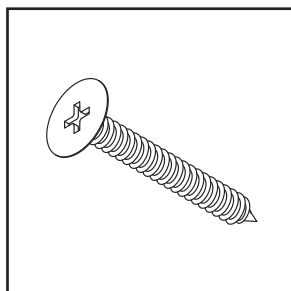

Grabber Screws

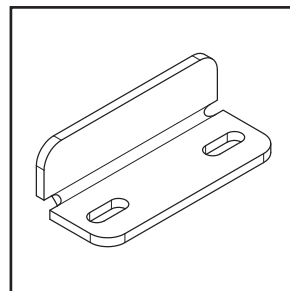

Door Guide

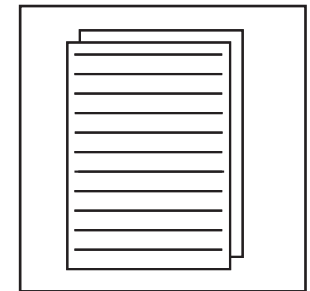

Instructions



INSTALLATION INSTRUCTIONS

1. Measuring and Marking Your Hanger Holes

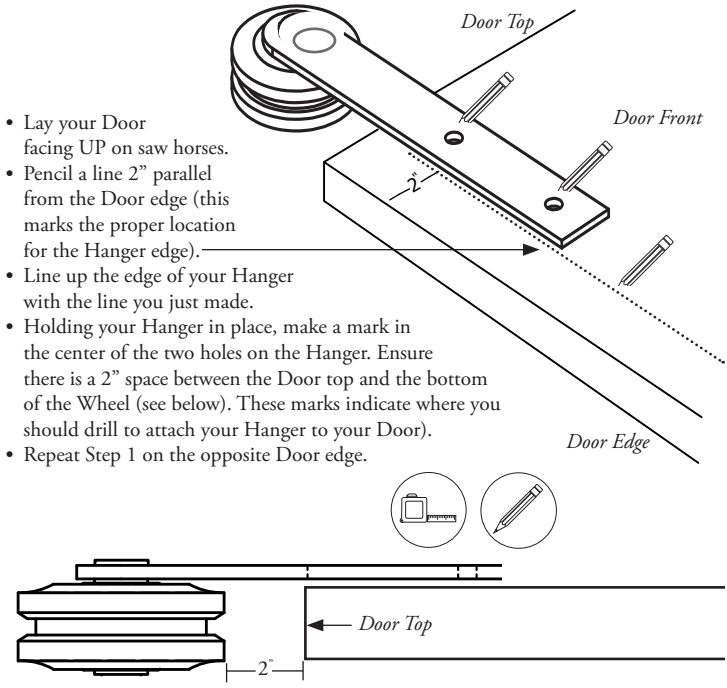

- Lay your Door facing UP on saw horses.
- Pencil a line 2" parallel from the Door edge (this marks the proper location for the Hanger edge).
- Line up the edge of your Hanger with the line you just made.
- Holding your Hanger in place, make a mark in the center of the two holes on the Hanger. Ensure there is a 2" space between the Door top and the bottom of the Wheel (see below). These marks indicate where you should drill to attach your Hanger to your Door.
- Repeat Step 1 on the opposite Door edge.

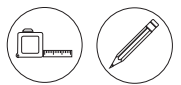

2. Drilling Pilot Holes

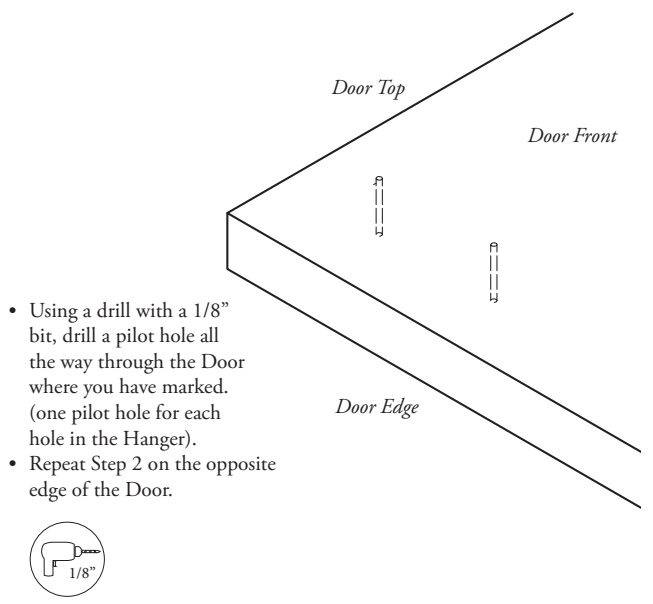

- Using a drill with a 1/8" bit, drill a pilot hole all the way through the Door where you have marked. (one pilot hole for each hole in the Hanger).
- Repeat Step 2 on the opposite edge of the Door.



3. Drilling Countersink Holes

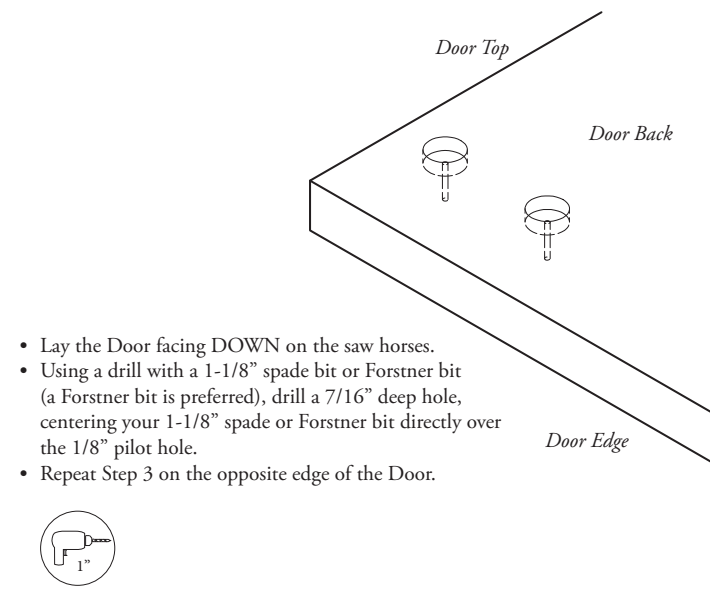

- Lay the Door facing DOWN on the saw horses.
- Using a drill with a 1-1/8" spade bit or Forstner bit (a Forstner bit is preferred), drill a 7/16" deep hole, centering your 1-1/8" spade or Forstner bit directly over the 1/8" pilot hole.
- Repeat Step 3 on the opposite edge of the Door.



4. Drilling Lag Screw Holes

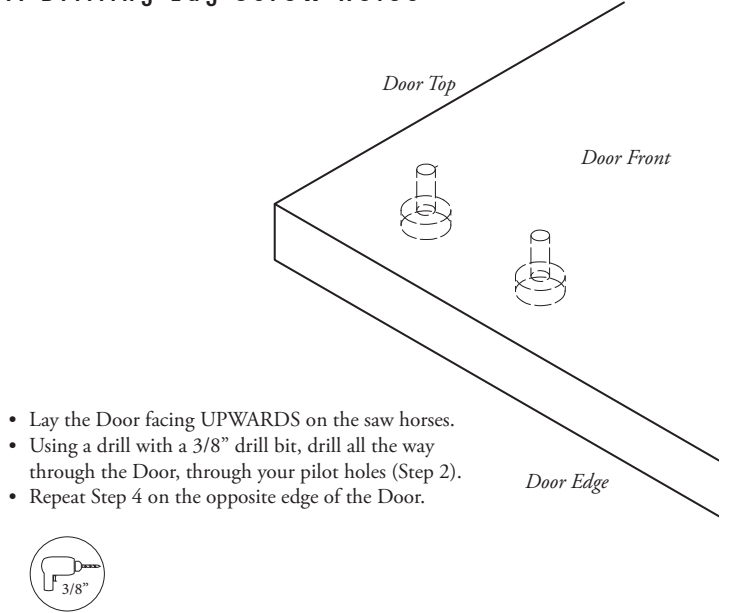

- Lay the Door facing UPWARDS on the saw horses.
- Using a drill with a 3/8" drill bit, drill all the way through the Door, through your pilot holes (Step 2).
- Repeat Step 4 on the opposite edge of the Door.



INSTALLATION INSTRUCTIONS

1. Installing Your Hanger Assembly To Your Door

- Thread the Hex Bolts with the Washers through the back of the Door.
- Thread the Hanger assembly through the Hex Bolts on the front of the Door.
- Holding Hex Bolts in place using a ratchet with a 5/8" socket, lightly tighten your Acorn Nuts by hand.

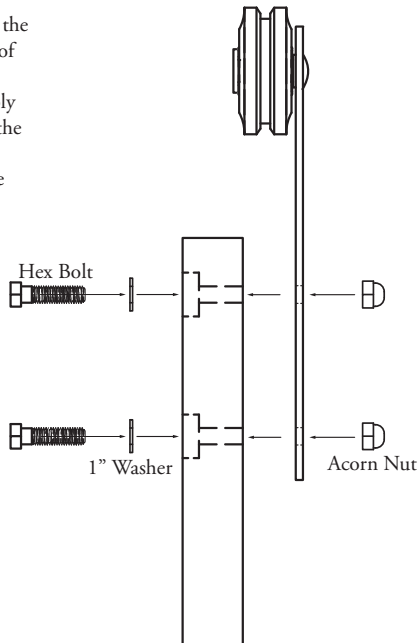

2. Tightening Your Hanger Assembly

- Using a 9/16" wrench for the Acorn Nut and a ratchet with a 5/8" socket and for the Hex Bolt, gently tighten, being careful not to damage your Hanger or Acorn Nuts.
- Repeat Steps 1 and 2 on the opposite edge of the Door.

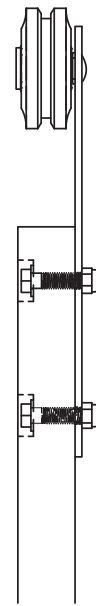

Measuring for Track Position

IMPORTANT!

If you are installing our Flat Track System, proceed. If you are installing either a Tube, Box, Bypass, J Track, or Ceiling Mount Track System, go to www.rusticahardware.com and download Installation Instructions specific to your Track System.

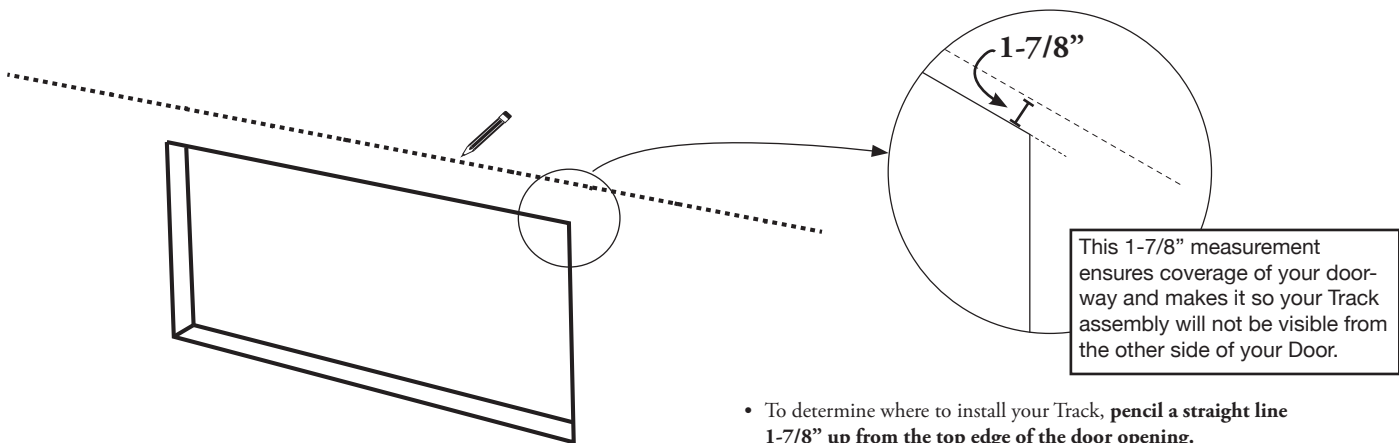

- To determine where to install your Track, **pencil a straight line 1-7/8" up from the top edge of the door opening.** This measurement is how high up on your wall (from the top of your opening up) you should install the Track.
- This is where you will mark a horizontal line on your wall parallel to the finished floor, the same length of your Track.



INSTALLATION INSTRUCTIONS

1. Marking and Drilling Track Holes

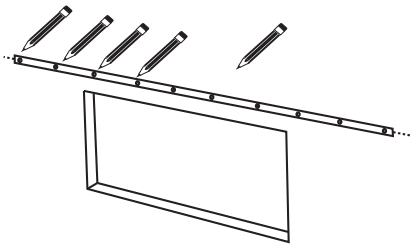

- Hold up your Track so that the marked line from the previous step is visible through the Track holes.
- Mark an intersecting line in the center point of each of the Track holes.
- Set the Track down.
- Using a drill with 1/4" drill bit, drill out your marked Track holes.*

**Be sure you are drilling into wall studs. If your track holes are not lining up with your studs, you will need to install your Track onto a header. The header needs be attached to your wall through the studs. This will provide the stability your wall needs to hold the weight of your Door or Shutter.*



2. Hanging Your Track

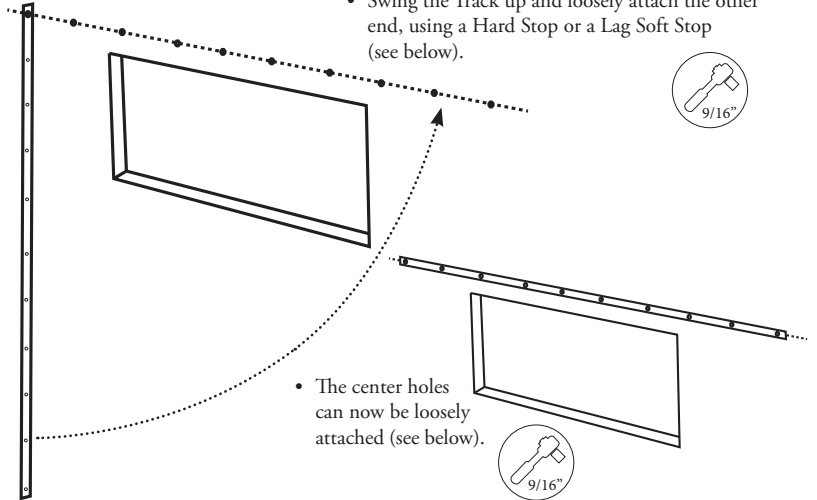

- Loosely attach one end of the Track using a Hard Stop or a Lag Soft Stop (see below).
- Swing the Track up and loosely attach the other end, using a Hard Stop or a Lag Soft Stop (see below).

- The center holes can now be loosely attached (see below).



3. Hole Installation

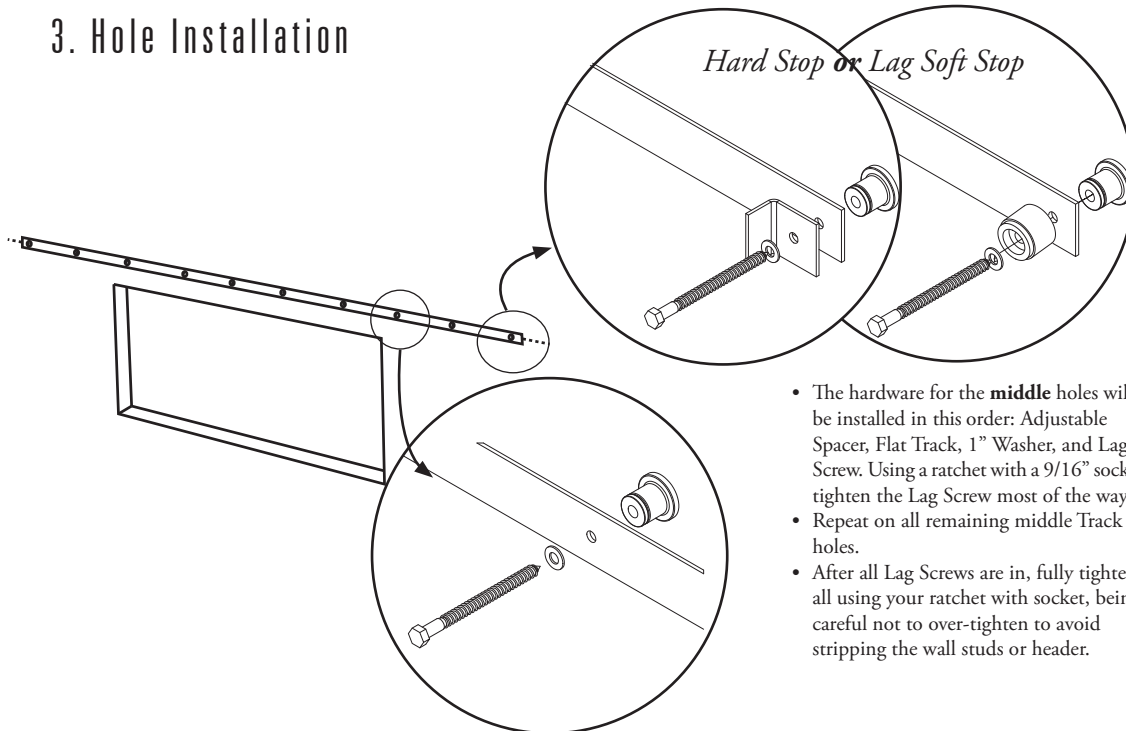

- The **outside** holes will be installed with a either a Hard Stop **or** a Lag Soft Stop.
- In this order: Adjustable Spacer, Flat Track, [Hard **or** Lag Soft] Stop, 1" Washer, and Lag Screw.



- The hardware for the **middle** holes will be installed in this order: Adjustable Spacer, Flat Track, 1" Washer, and Lag Screw. Using a ratchet with a 9/16" socket, tighten the Lag Screw most of the way.
- Repeat on all remaining middle Track holes.
- After all Lag Screws are in, fully tighten all using your ratchet with socket, being careful not to over-tighten to avoid stripping the wall studs or header.



INSTALLATION INSTRUCTIONS

1. Hanging Your Door

- Lift your Door up to your Track at a slight angle.
- Carefully rest both Wheel grooves onto the top of the track.
- Guide the Door to the resting position.

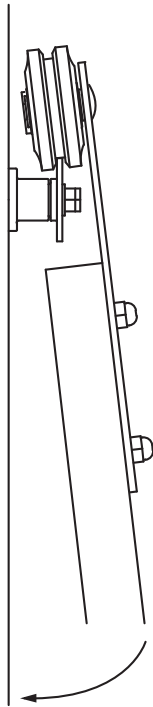

2. Align Anti-jump Bracket

- Place the Anti-jump Bracket against the outside edge of the Door so that there is a $1/16$ " to $1/8$ " space between the top of the Anti-jump Bracket and the bottom edge of the Track. With a pencil, mark the center of each hole. Repeat on other side.

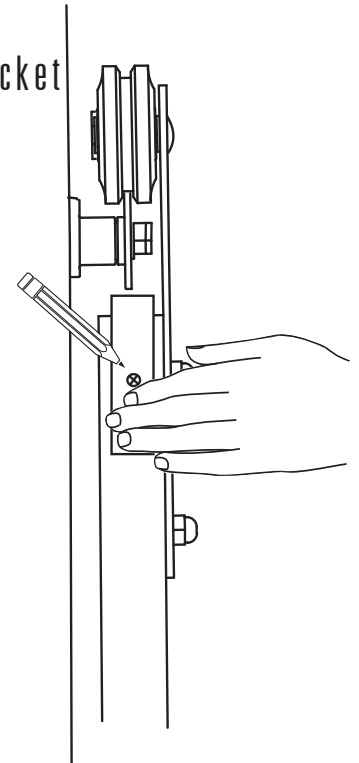

3. Attach Anti-jump Bracket

- Using a drill with a Phillips bit, attach the Anti-jump Bracket with Grabber Screws. Repeat on other side.

