



# **RUSTICA LOCK**

## **ASSEMBLY INSTRUCTIONS**



## RUSTICA LOCK Recommended Tools

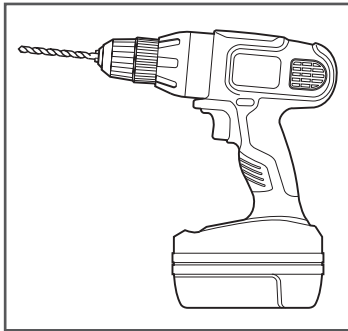

Drill with 1/8" Drill Bit

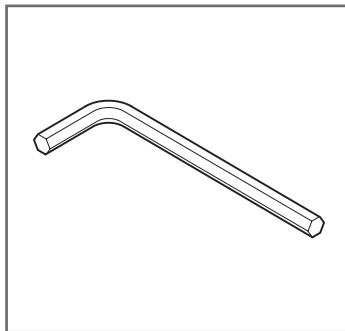

1/8" Allen Wrench

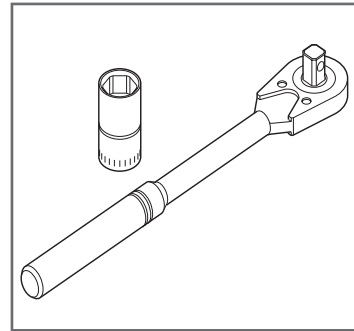

9/16" Socket Wrench

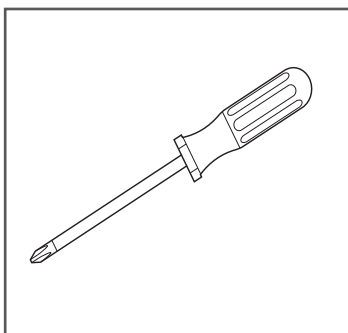

Large and Small Phillips  
Screw Drivers

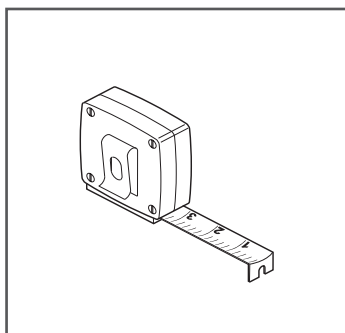

Tape Measure

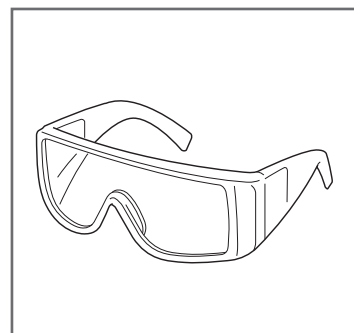

Safety Glasses

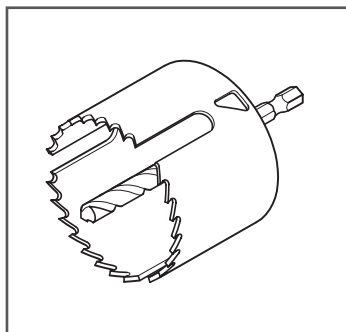

2 1/2" Hole Saw with  
Pilot Bit

**USE TEAMWORK - WE RECOMMEND TWO PEOPLE  
WHEN REMOVING OR HANGING A DOOR.**

# RUSTICA LOCK Parts

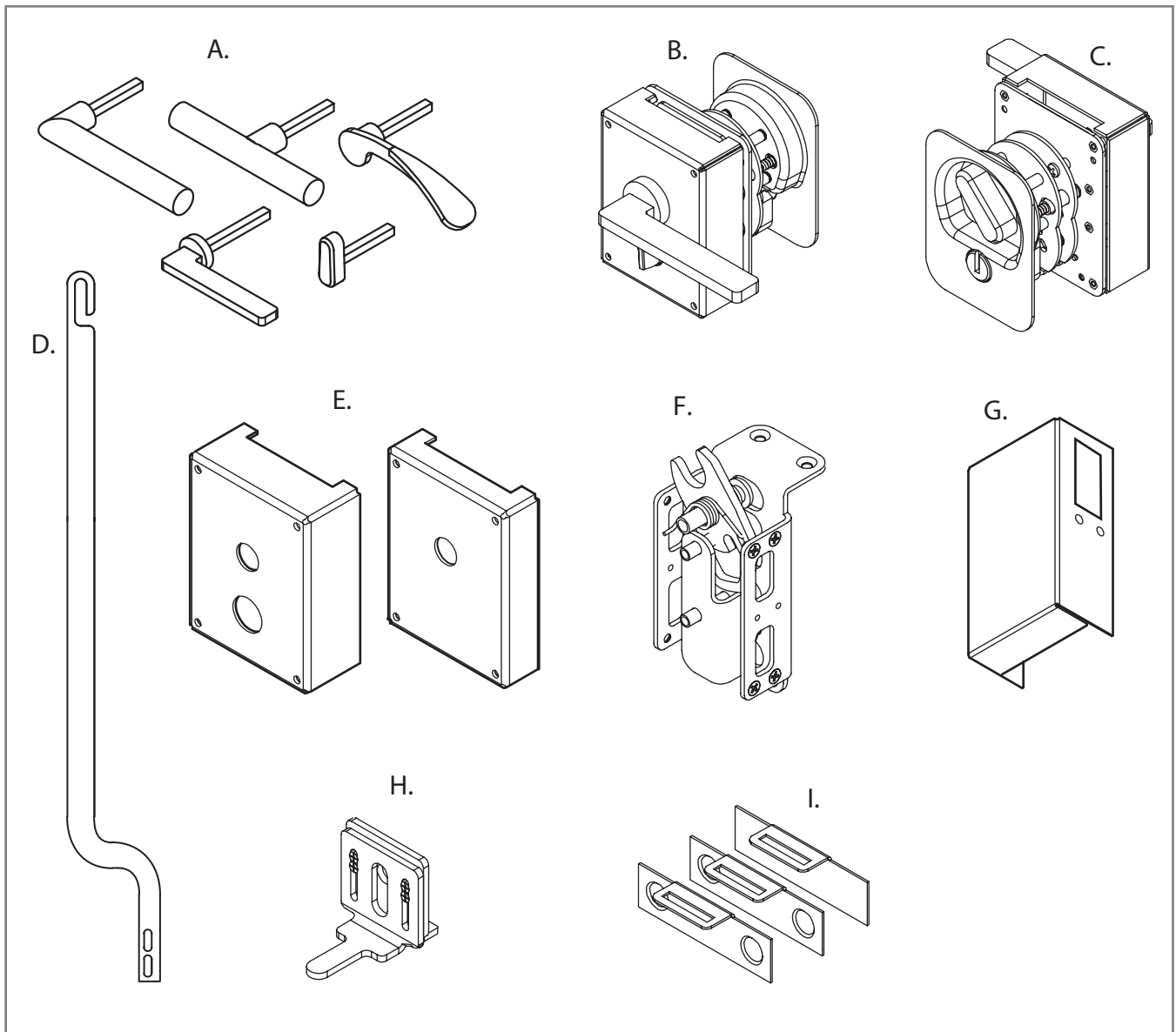

Parts	QTY
A. Door Handle	1
B. Door Lock - Front Assembly	1
C. Door Lock - Rear Assembly	1
D. Lock Rail	1
E. Door lock Front Cover Assembly	1
F. Top Latch Assembly	1
G. Latch Cover	1
H. Door Stop	1
I. Lock Rail Guides	3

## FIRST THINGS FIRST

If you already own a Rustica door, you will need to remove it from its track. It is recommended that you uninstall it with the help of another person.

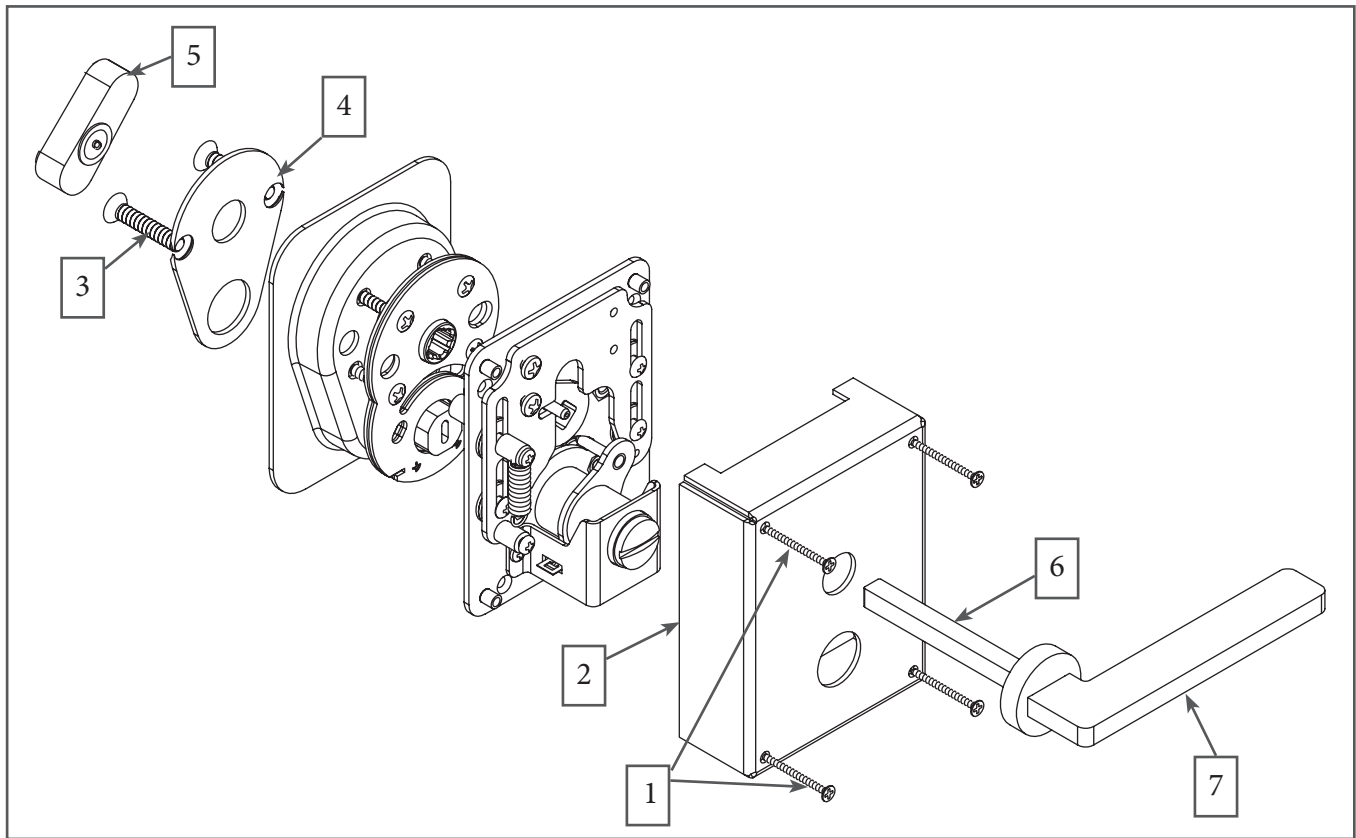

Figure 1

The door lock and handle mechanism is shipped assembled. In order to install it on the door, you will need to disassemble the lock.

1. Remove the four 4-40 screws (1) from the front cover (2) of the door lock (Figure 1).
2. Remove the two 10-32 screws (3) from the cosmetic plate (4) on the back of the door lock.
3. Remove the handle hold (5) from the handle shaft (6) by loosening the set screw with an 1/8" Allen wrench.
4. Remove the handle (7) and handle shaft (6) from the top hole of the lock.

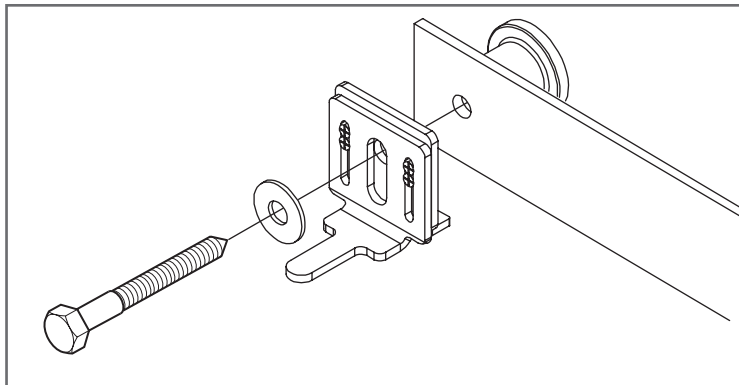

Figure 2

## DOOR STOP INSTALLATION

5. For existing tracks with door stops (H), ensure the door stop is installed on the side the door will lock. For new tracks, select the side the door will lock and install the door stop using the lag bolt and washer provided with the track system (Figure 2).

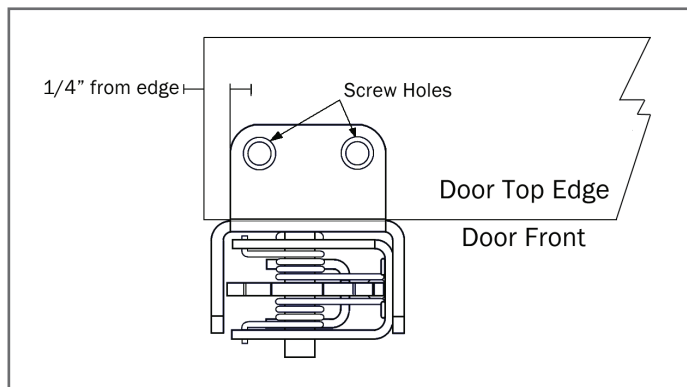

Figure 3

## LATCH INSTALLATION

6. Lay the door on a flat, stable surface ensuring the side the latch is to be installed on is facing up (Figure 3).

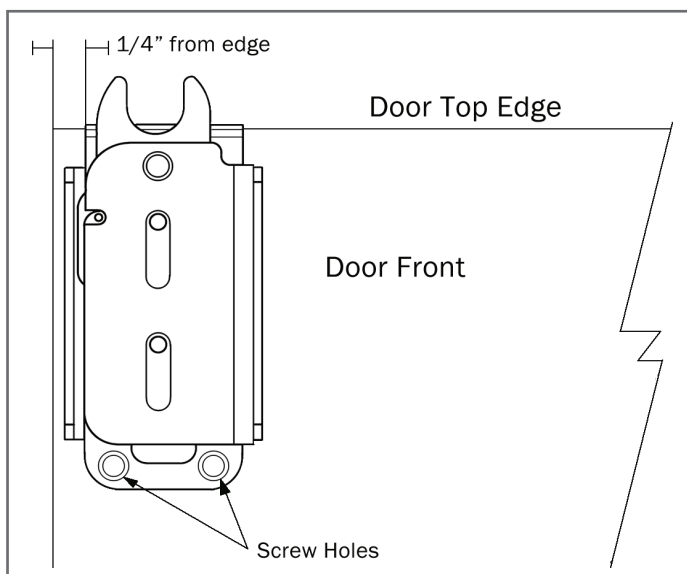

Figure 4

7. Position the latch plate 1/4 " from the edge of the door (Figures 3 & 4). Mark the hole placement for the latch on the top door edge and the front of the door. Drill pilot holes for screws.

8. Fasten the latch on the top and on the front of the door using 4 flat head Phillips screws (provided).

## LOCK INSTALLATION PREPARATION

### NOTE:

Verify the Lock Length ( as ordered from the Rustica website) before you begin drilling!

9. Beginning at the top of the door, measure the lock length (overall length). Make a mark with a pencil on the door (Figure 5).

10. Measure  $3\frac{1}{2}$ " in from the edge of the door where the mark is located. Make another mark and call it 'A'.

11. Measure  $\frac{3}{4}$ " directly below your second mark. Make another mark and call it 'B'.

12. Using an  $\frac{1}{8}$ " drill bit, drill a pilot hole through mark 'A' and mark 'B'. Ensure each hole goes completely through the door. Hold the drill carefully so the holes are drilled as straight as possible.

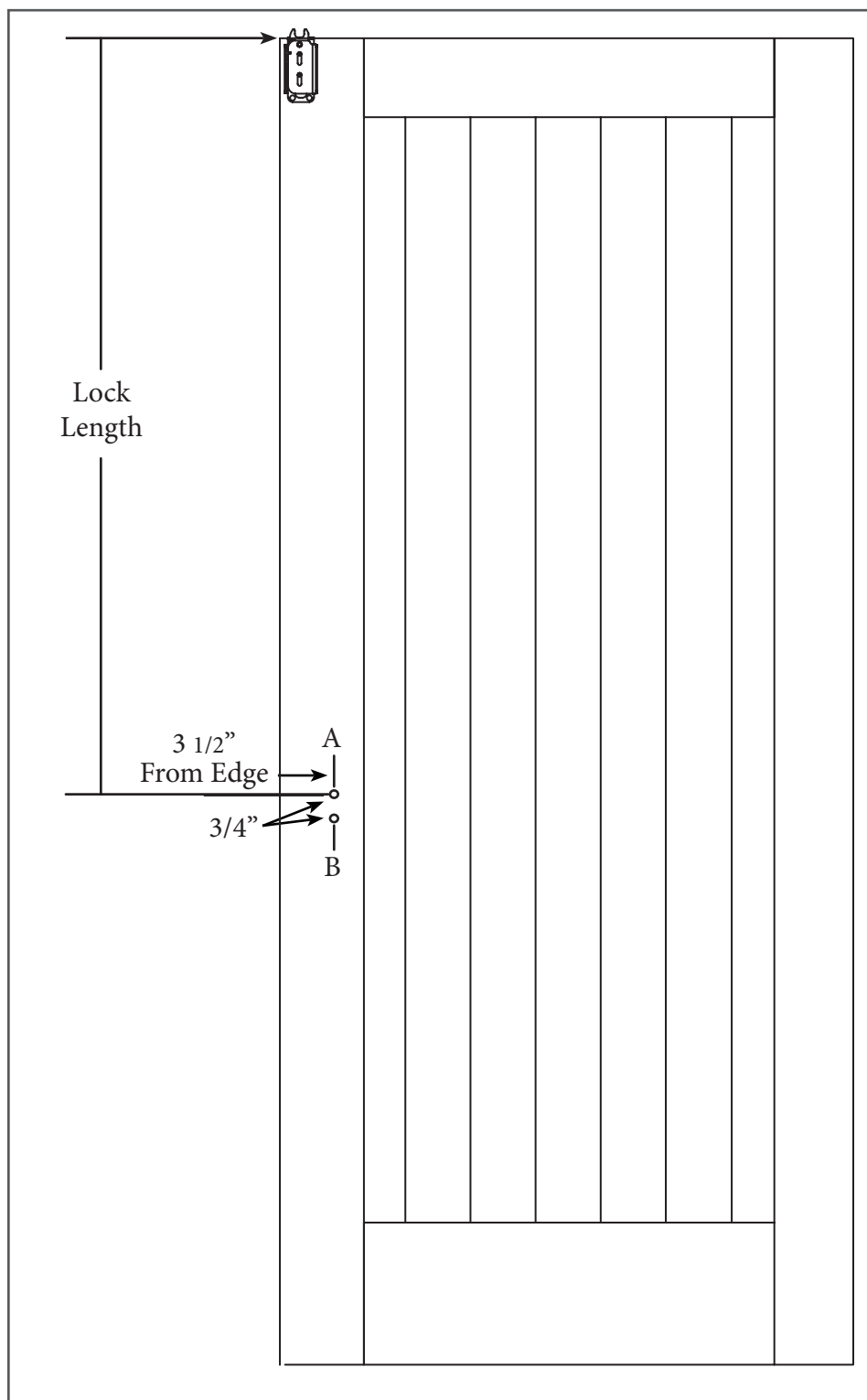

Figure 5

**NOTE:**

At 2 1/2" hole saw with pilot bit is necessary for the following procedures.

**CAUTION:**

Upon completing the drilling process, the hole saw bit will be VERY HOT. Handle with care to avoid burns.

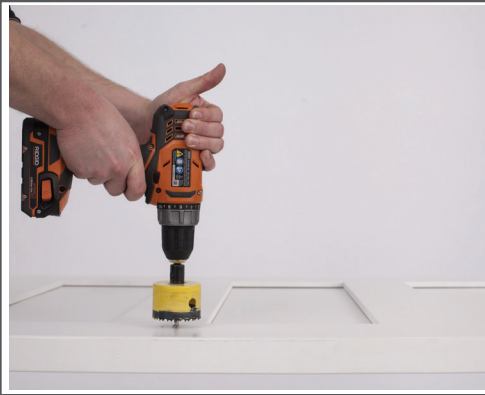
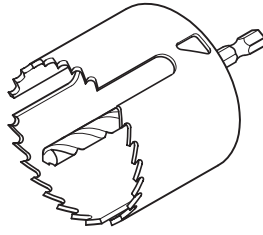

Figure 6



Figure 7



Figure 8

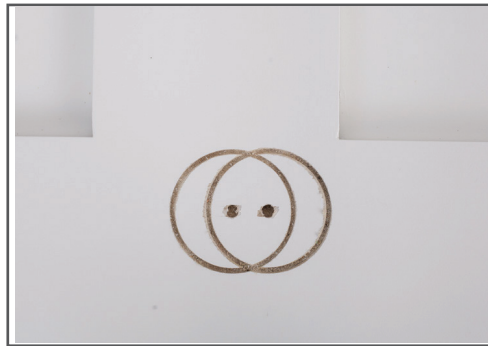

Figure 9



Figure 10



Figure 11

13. Center the hole saw and bit over the top of the pilot hole (Figure 6). Drill to a depth of 1/4".

14. Lift the drill and position the hole saw and bit over the lower hole. Drill down to a depth of 1/4" (Figure 7).

15. Lift the drill and return to the upper hole. Repeat the process of steps 13 and 14 until the drill bit pierces through the door (Figures 8,9).

16. Turn the door over and repeat steps 13 and 14 until the saw hole has passed completely through the door (Figures 10,11).

17. Clean the surface around the hole and re-hang the door on its track.

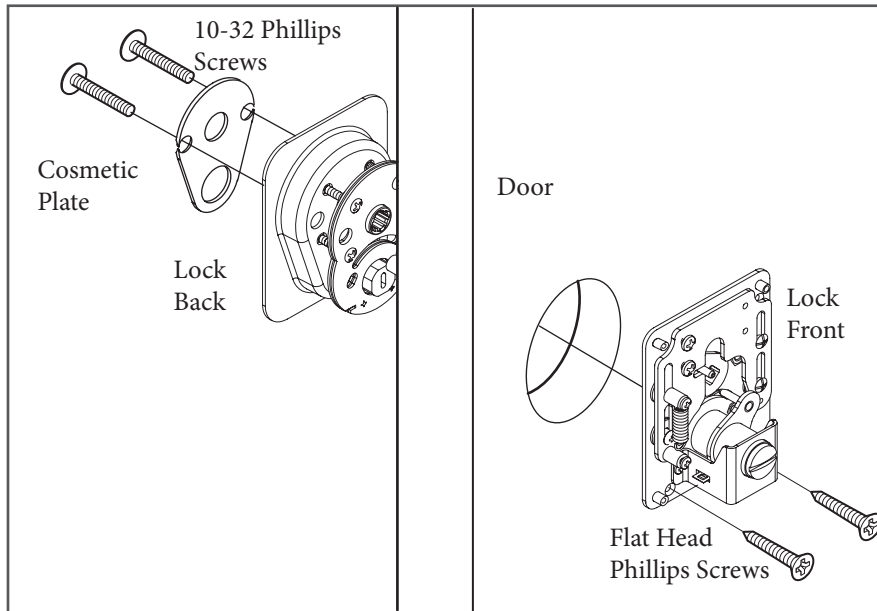

Figure 12

## LOCK INSTALLATION

18. Install the cosmetic plate on the back of the door lock using two 10-32 screws (provided).
19. Insert the lock back into the hole on the back of the door (Figure 12).
20. Insert the front of the lock through the hole in the front of the door (Figure 12).
21. Secure to the back of the door lock using two 10-32 screws (provided) from step 14.
22. Fasten the lock in place with two flat head phillips screws (provided).

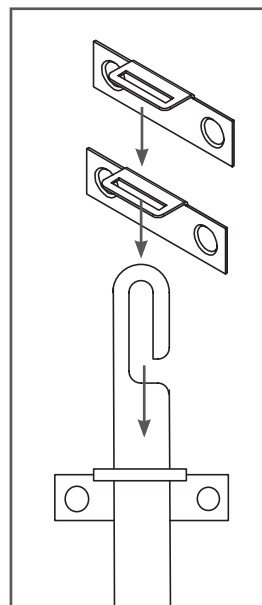
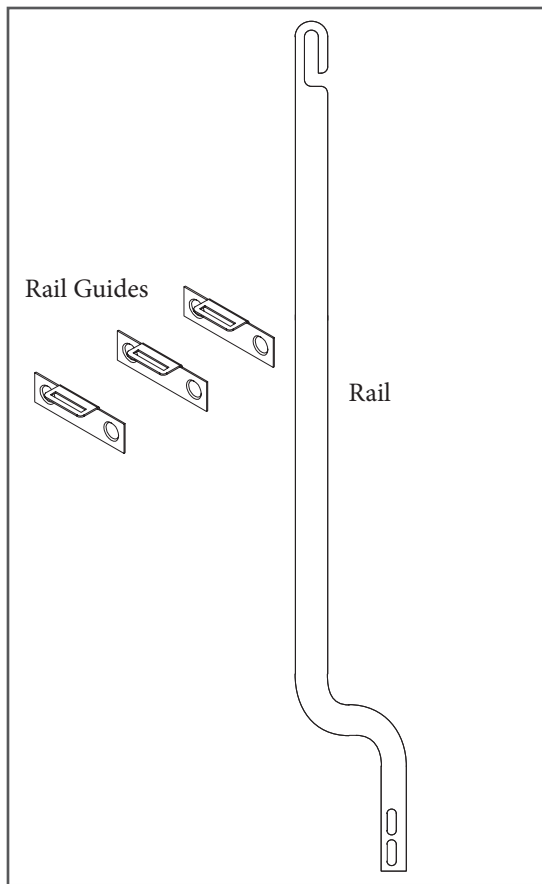

Figure 13

## RAIL INSTALLATION

23. Install rail guides onto the rail by sliding the rail guides over the top of the rail (Figure 13).



24. Ensure the lock mechanism is in the locked position (Figure 14A).

25. Hook the top end of the lock rail up into the top latch assembly. The hook will rest on the top of the lower rivet (Figure 14A).

26. Fasten the rail to the lock using two pan head phillips screws (provided) Figure 14B.

**NOTE:**  
If the lock latch is not latching over the stop, adjust the stop by loosening the lag bolt and the four adjustment screws on the door stop, then sliding the stop up or down. Re-tighten the lag bolt and adjustment screws.

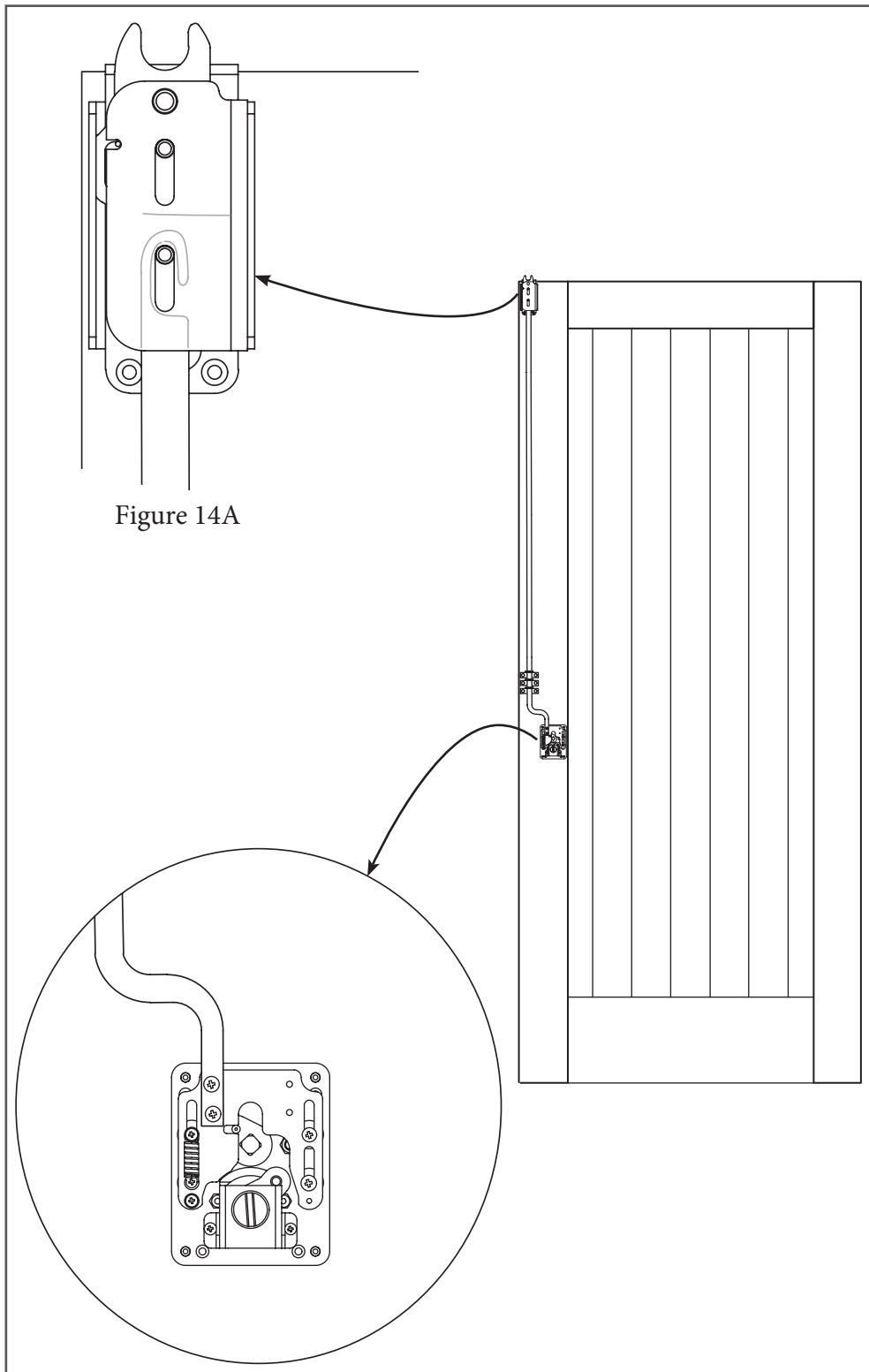
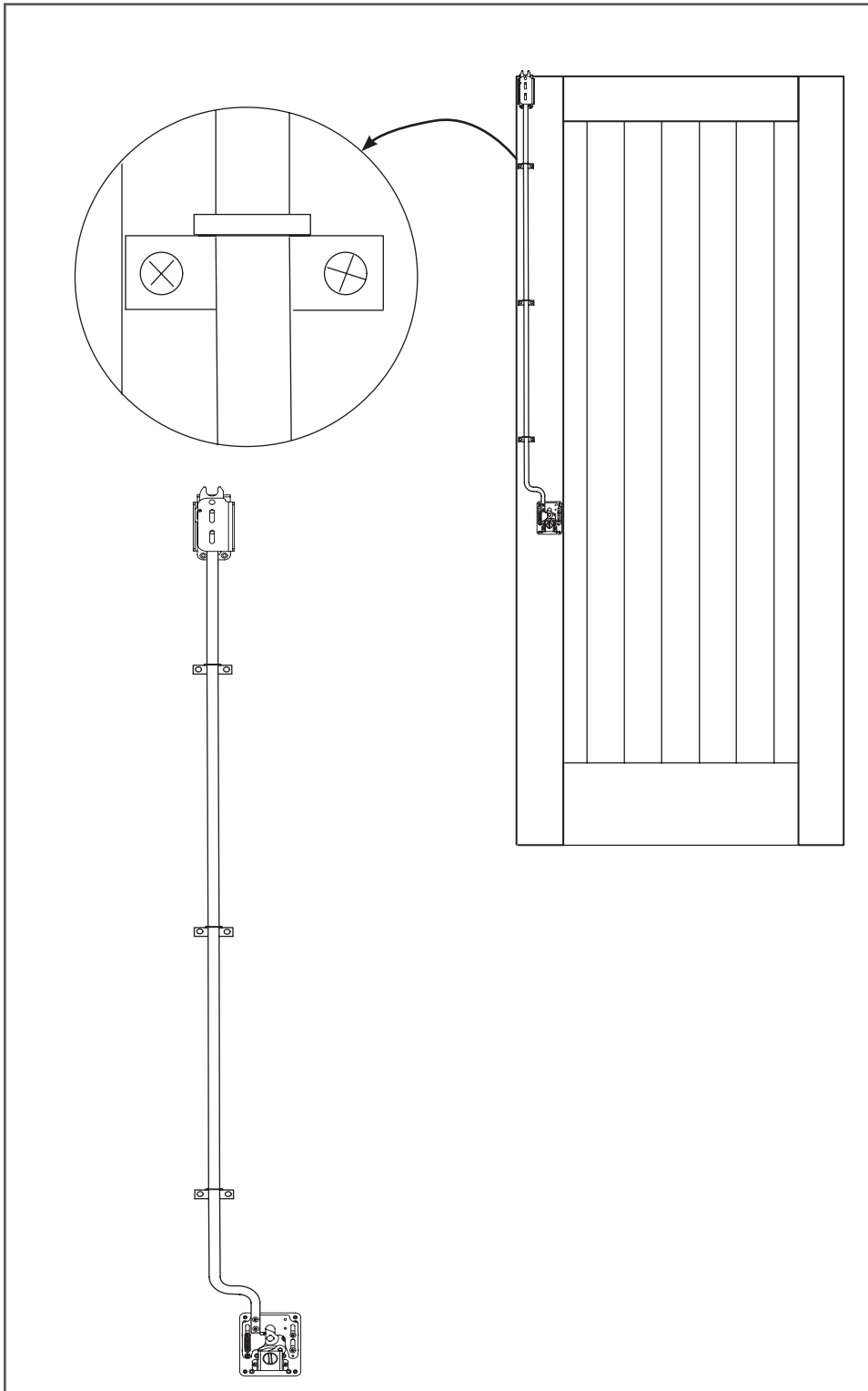

Figure 14A

Figure 14B



27. Space the rail guides evenly apart. Attach to the door with phillips flat head screws (provided) (Figure 15).

Figure 15

# RUSTICA LOCK Assembly Instructions

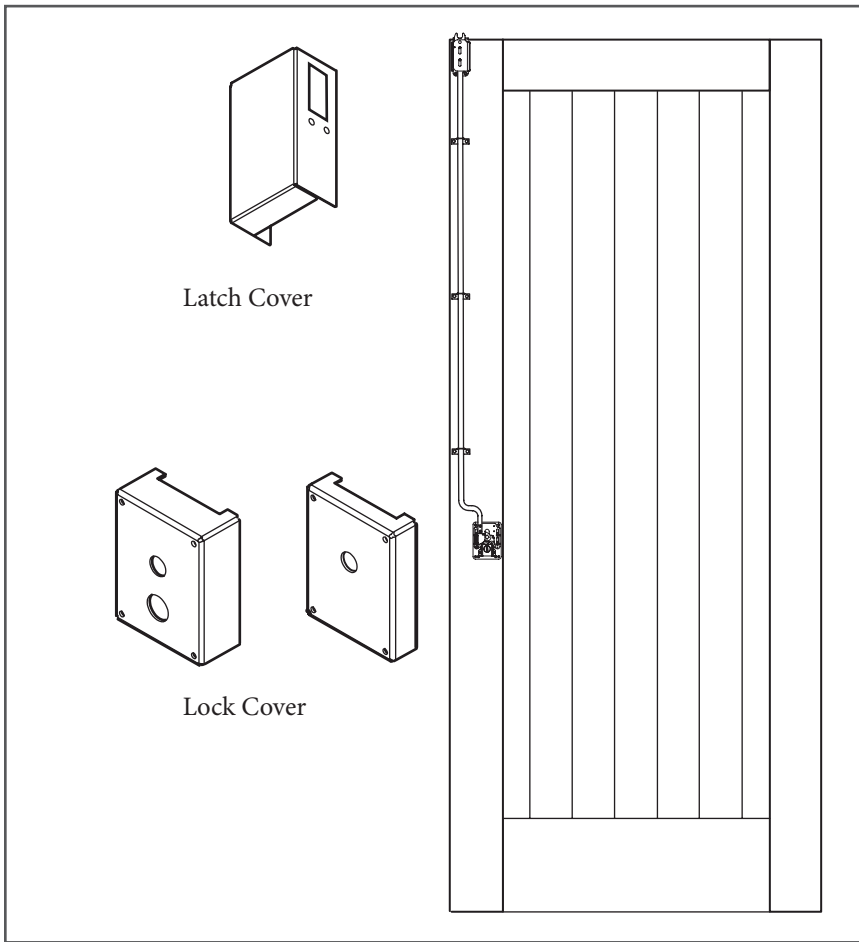

Figure 16

28. Install the latch cover over the latch, fastening with four screws (provided) (Figure 16).

29. Install the lock cover over the lock mechanism on the front and back of the door with the screws provided.

30. Insert the handle through the top hole of the lock on the front of the door. Slip the handle hold over the handle shaft and secure by tightening the set screw with an 1/8" Allen wrench (Figure 17).

### NOTE:

Leave a small gap between the handle rim and face plate of the lock mechanism (Figure 17A).

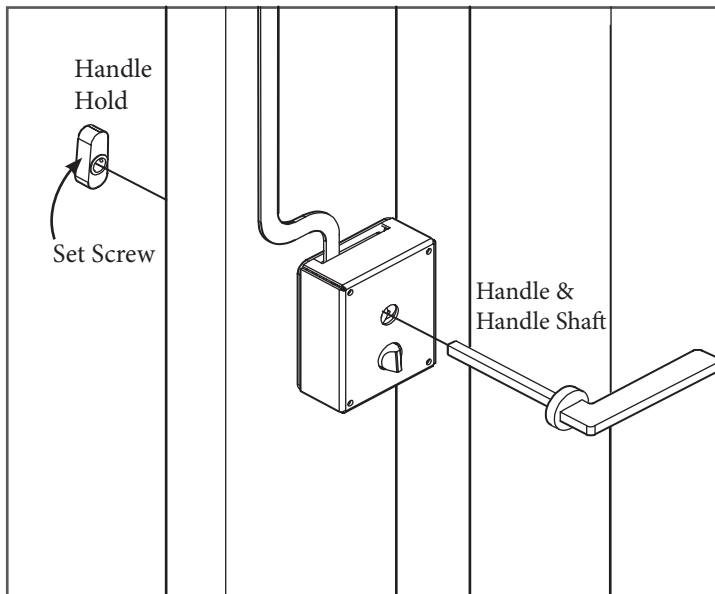

Figure 17

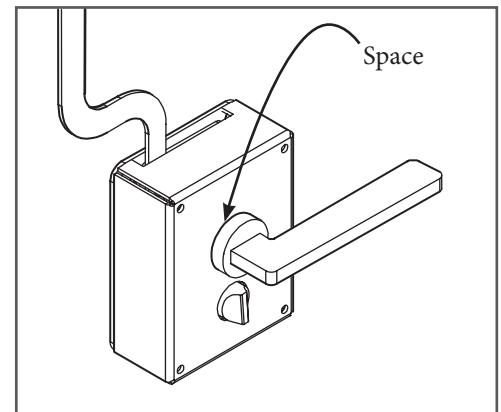

Figure 17A

VERSION

3

03 — 2017

ALTERNATE DOOR CONFIGURATIONS

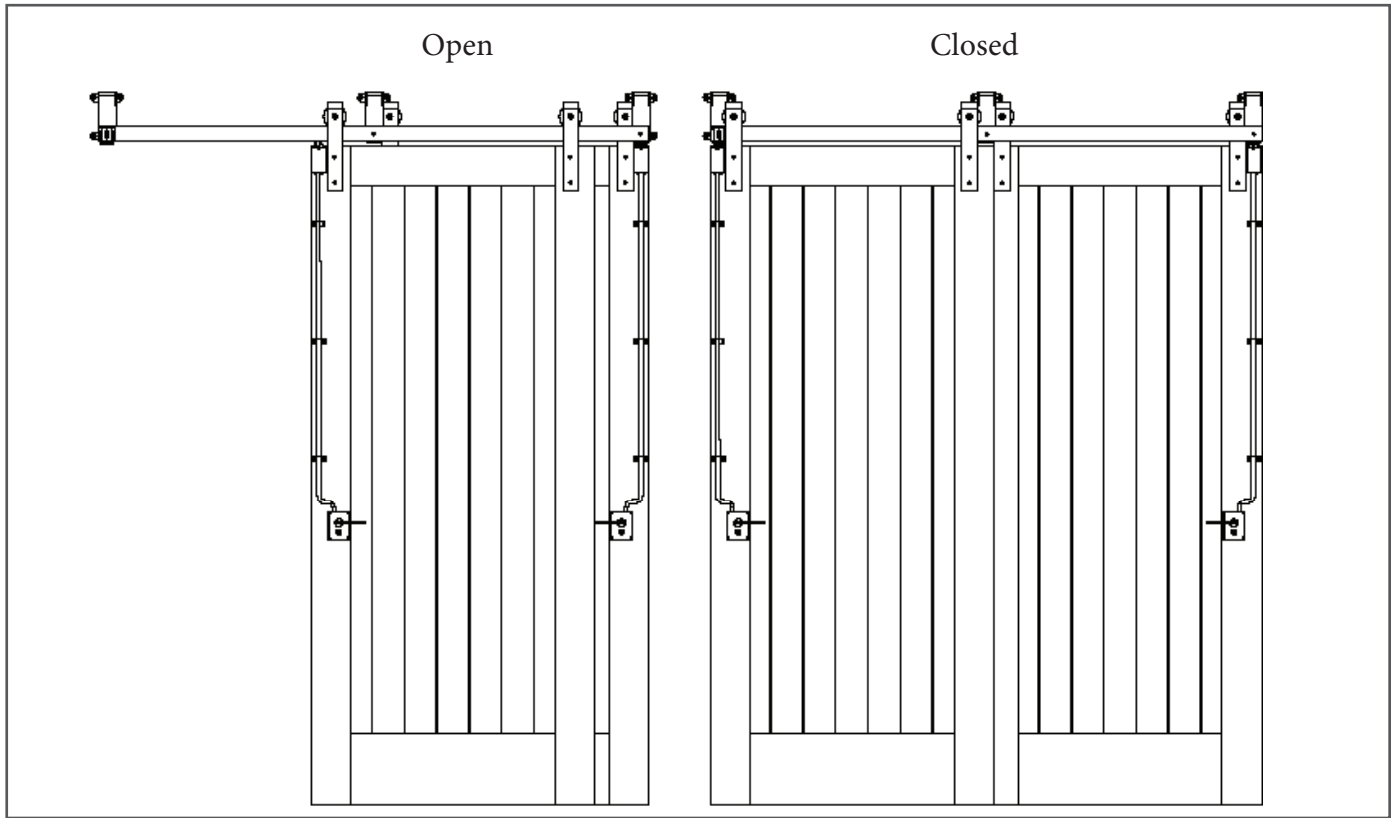

Figure 18

When installing a second lock on a bypass door system, install the first lock on the outside edge of the door per instructions. When finished follow all steps on the second lock, installing the lock on the outside edge of the second door (Figure 18).

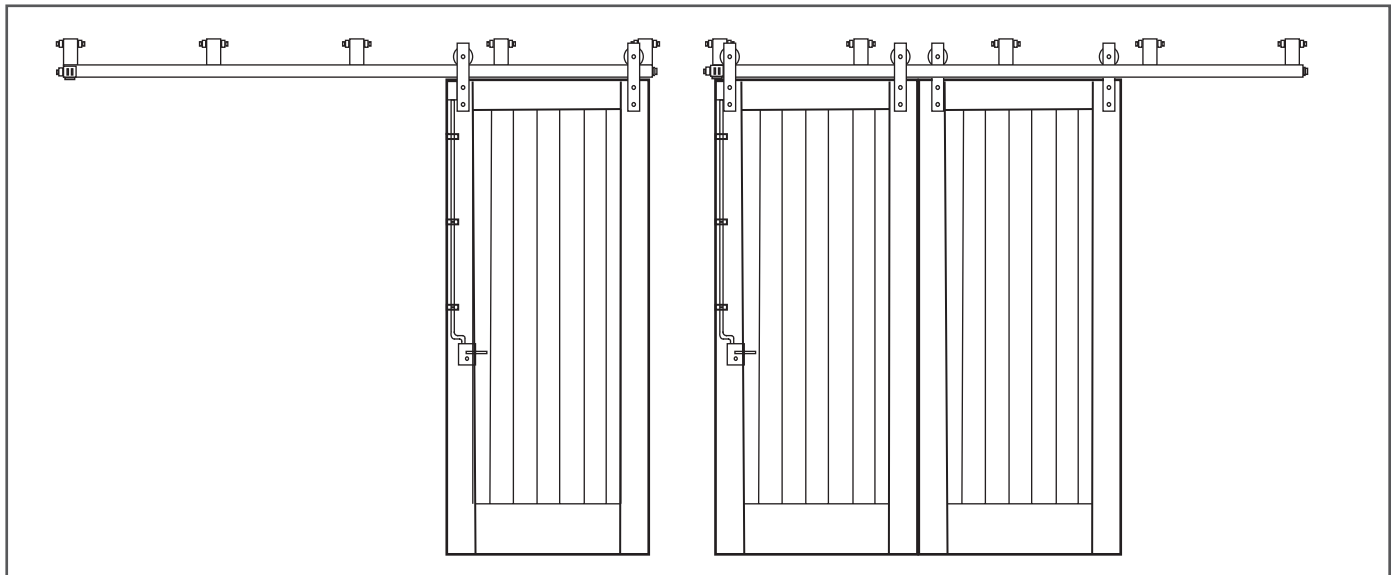

Figure 19

Only one lock mechanism is required for a bypass track system where a door guide is installed as a come-along that connects the two doors together. A second door stop is necessary for the rear track in the position the door will stop when closed and locked (Figure 19).

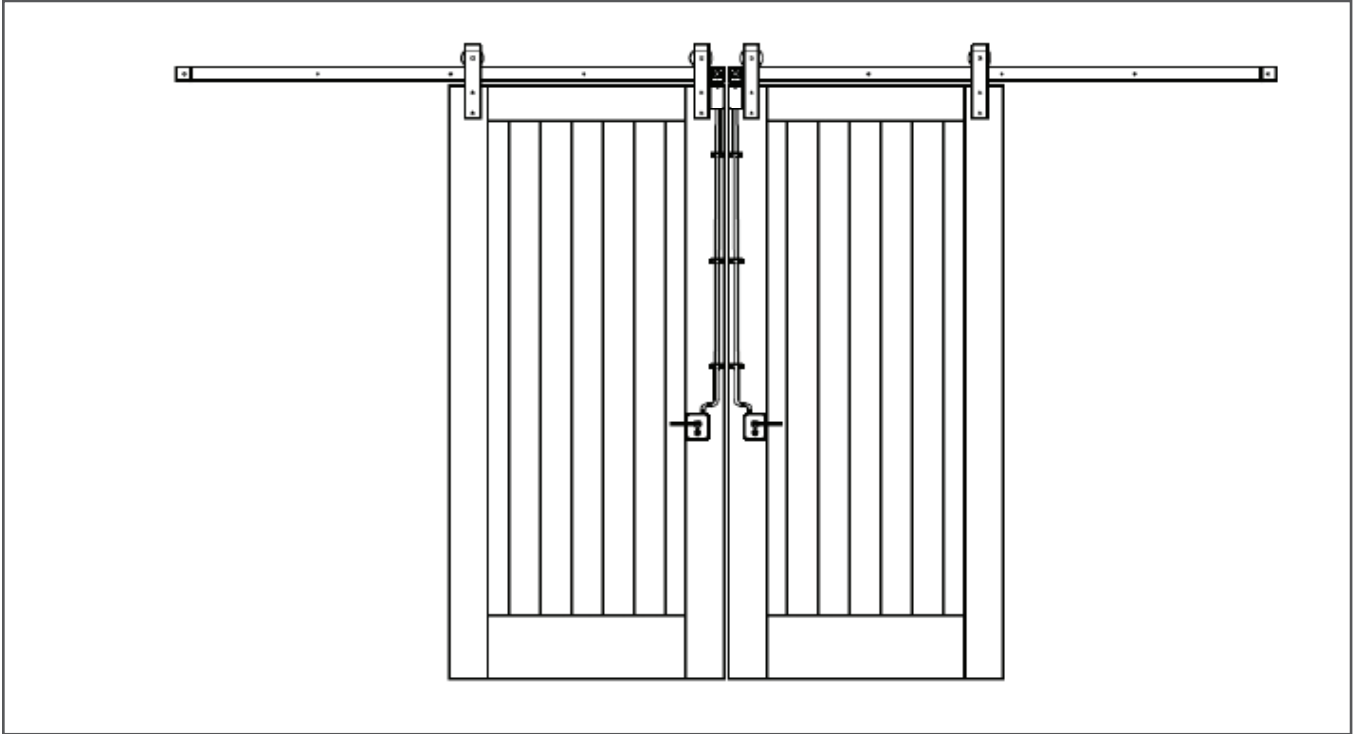

Figure 20

Bi-Parting track system with doors closed.

When installing the locks on a Bi-parting door system, mount the locks on the inside edge of the door (Figure 20).

# WE LOVE WHAT YOU ARE DOING WITH THE PLACE

CONGRATULATIONS ON YOUR DECISION TO BRING HOME  
AN AMERICAN MADE PRODUCT OF THE HIGHEST QUALITY.  
WE HOPE YOUR RUSTICA LOCK BRINGS ART AND FUNCTION INTO  
YOUR LIFE.

DESIGNED AND CRAFTED  
ENTIRELY IN THE

# U.S.A.



DON'T BE A STRANGER. FOLLOW US  
ON SOCIAL MEDIA.



[support@rusticahardware.com](mailto:support@rusticahardware.com)