

StubGuard® Data Sheet

No. 3.2

Product Description

This product comprises CNC cut, dense grade, specially formulated, mineral fibre blocks. Two equal sized and mirrored parts form the completed block. The three exposed sides of each block are wrapped in strong reinforced foil and are held together using pre-fitted self-adhesive flaps at the top and bottom of the encasement. They are individually designed to fit around a steel balcony support stub for each specific project, and cavity barrier make and type location.

The StubGuard® is an effective solution to achieve fire-stopping integrity and insulation requirements around a steel balcony support stub and has been tested to ASFP guidance document TGD17 and the general principles of BS EN 1366-4. The product is also covered by EWCL5 certification from Warringtonfire.

Features

- Suitable for cavities up to 300mm wide
- Achieves fire-stopping integrity for 120 mins
- Achieves fire-stopping insulation for 120 mins depending on cavity barrier type
- Simple and very quick to fit
- Removes possible installer inconsistencies
- Added benefit of reduced heat loss in the area
- Abutments made simpler due to shape
- Cavity barrier junction integrity assured



View of StubGuard® with jointing label fitted



StubGuard® showing cavity barrier inserted into side face



Left:
Minimum design StubGuard®

Right:
Standard design StubGuard®

Size: To suit stub and cavity sizes
Product Composition: Mineral fibre
Density: 140KG/m ³
Integrity/Insulation: 120/120 minutes
Wrapping: Reinforced aluminium foil
Max cavity width: 300mm
Fixing method: Wrap compression
Certification: EWCL5 cert. no ME5116

Installation Guide

Step 1: Unpack and Check

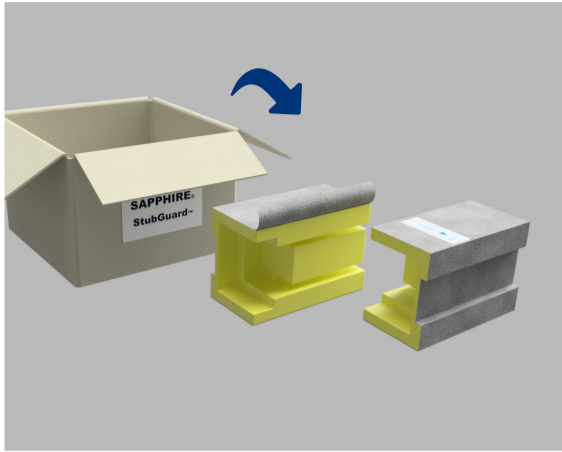

Unpack and check that the product is not damaged. The packaging is recyclable and should be disposed of responsibly.

Step 2: Measure Length

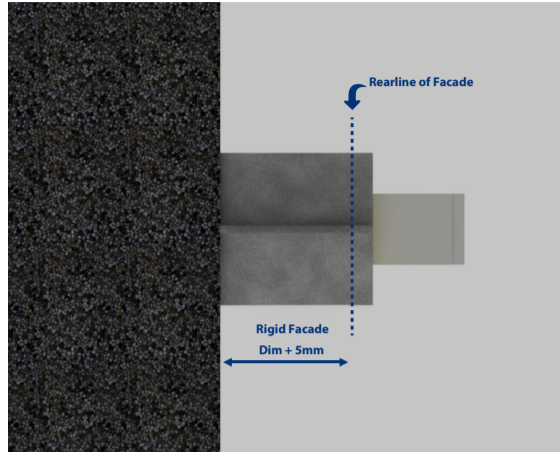

Check the length requirement for the StubGuard® by measuring from the floor slab edge to the back of the façade. Add 5mm to this dimension if the façade will be a rigid build where it can slightly compress the StubGuard® once fitted. The StubGuard® has been tested and is certified with cavity barriers from different manufacturers. Please check your cavity barrier make and type to ensure compatibility with StubGuard® for fire stopping duration compliance. Please check with our technical department if in doubt.

Step 3: Mark & Cut

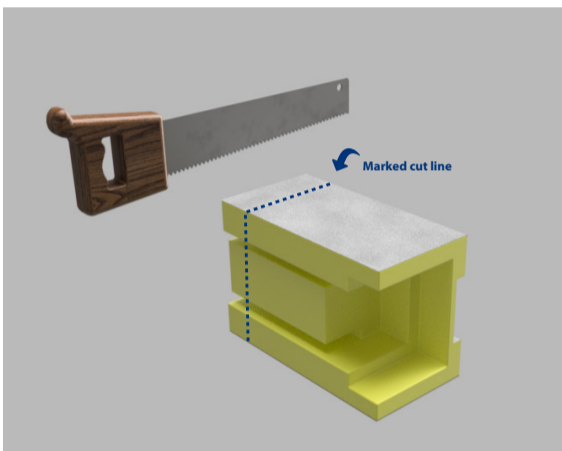

Mark the calculated dimension on the StubGuard® foil casing and use a handpoint saw or long insulation knife to cut both halves to the correct length.

Step 4: Fitting the StubGuard®

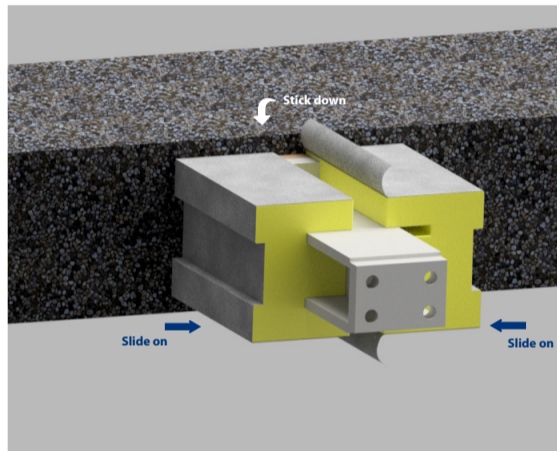

Fit the two halves of the StubGuard® to the balcony arm or stub from either side to meet at the centreline and push them firmly back against the slab edge. If it does not fit back snug against the face, a little local trimming can be carried out, but care should be taken not to remove the thickness of fibre material covering the arm end plate – i.e. the outer 25mm of the StubGuard®. Ensure the fixing flaps are not trapped in the vertical joint.

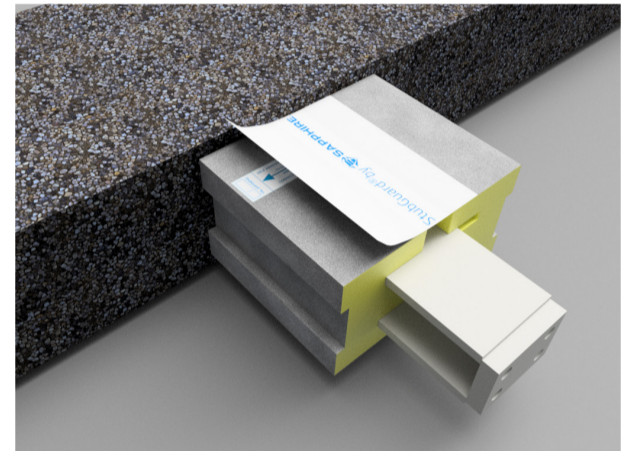

Step 5: Fitting Complete

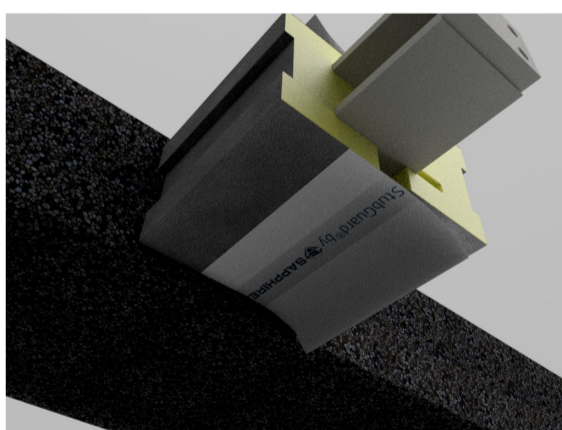

Peel the backing from the bottom flap and keeping the two halves pressed together, stick the flap onto the opposite half to join them together. Repeat this for the top flap. The edge of the flap should come up to the witness line on the serial label fixed to the top of the StubGuard. Rub the two flaps down firmly onto the casing foil to ensure a good adhesion has occurred.

Step 6: Fitting the Cavity Barrier



When fitting the cavity barrier into the side of StubGuard®, ensure it is fully engaged for height and pushed to the full depth of the notch.



Evidence should be provided of this by means of photographing for record purposes. Two cavity barrier insertion depth labels have been provided loose with each StubGuard to assist in carrying out this step.

Remember this process explains the install of a tested scenario. Your project specific application may differ from this. Always speak to your fire engineer, principal designer and relevant partners to define your project needs. Before using this document please visit www.balconies.global/StubGuardmustread. This will also help you determine if this is the current version.