

# FØRSTEGANGS INSTALLASJON ActivPanel 9 / 9 Premium

Følg stegene nøye!

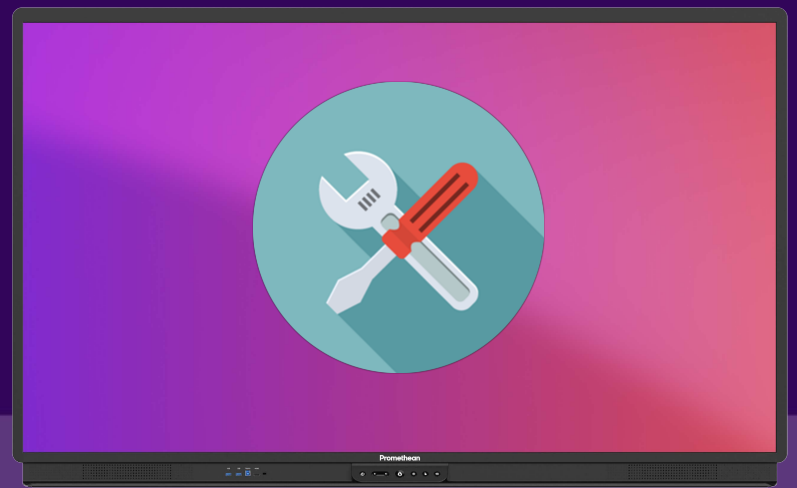

Slå på skjermen og start installasjon.

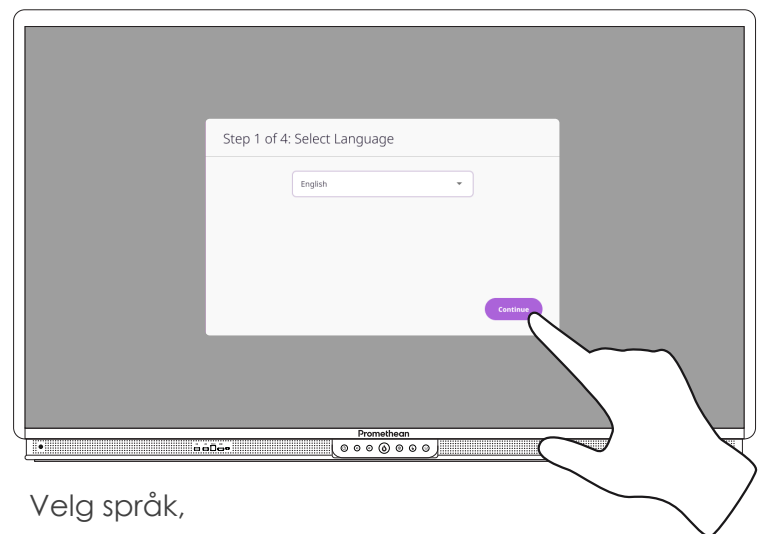

Velg språk,

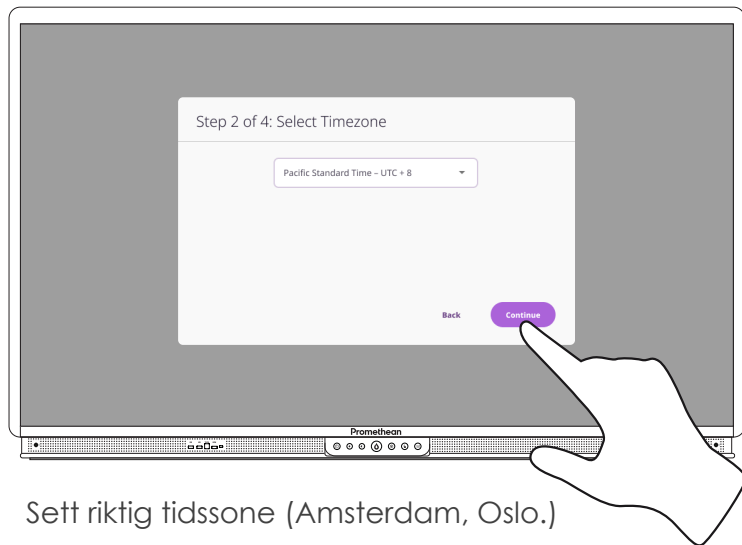

Sett riktig tidssone (Amsterdam, Oslo.)

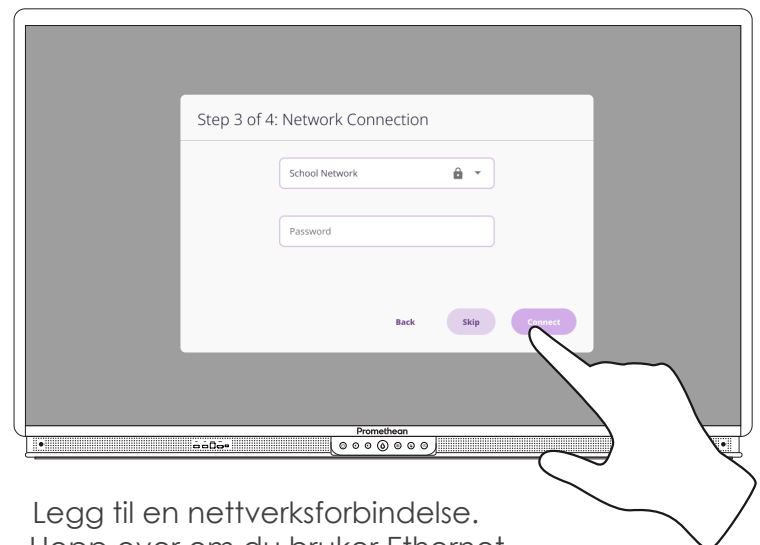

Legg til en nettverksforbindelse.  
Hopp over om du bruker Ethernet.

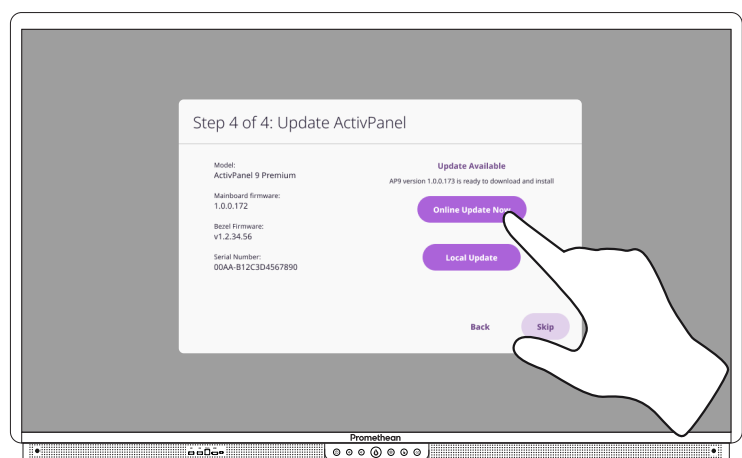

Oppdater skjermen over nett (OTA).

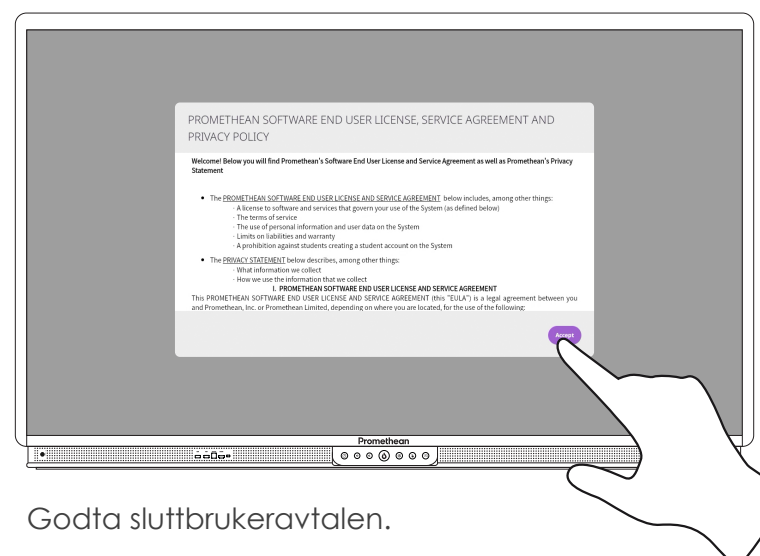

Godta sluttbrukeravtalen.