



Park to Park Trail

The Park to Park Trail starts in Seneca Lake State Park and ends at Sampson State Park. Along the way you'll see rolling vineyards and plenty of wineries where you can taste some of the region's best wines.

Start at Seneca Lake State Park entrance gatehouse, Routes 5 & 20, Geneva, NY

Leg	Notes	Total
0.2	Turn right on Routes 5 & 20 / Lakefront Dr.	0.2
1.0	Turn right on Route 96A (on ramp)	1.2
0.7	Turn right on Boody's Hill Rd.	1.9
0.6	Turn right on Route 96A	2.5
0.5	Turn right on E. Lake Rd.	3.0
8.2	Use pedestrian gate at north end of Sampson State Park	11.2
3.5	Reach south gate of Sampson State Park	14.7
Return same way		

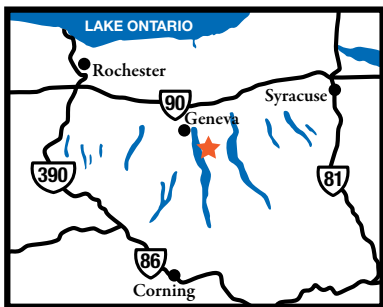

Distance 14.7 miles (one way)

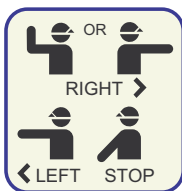
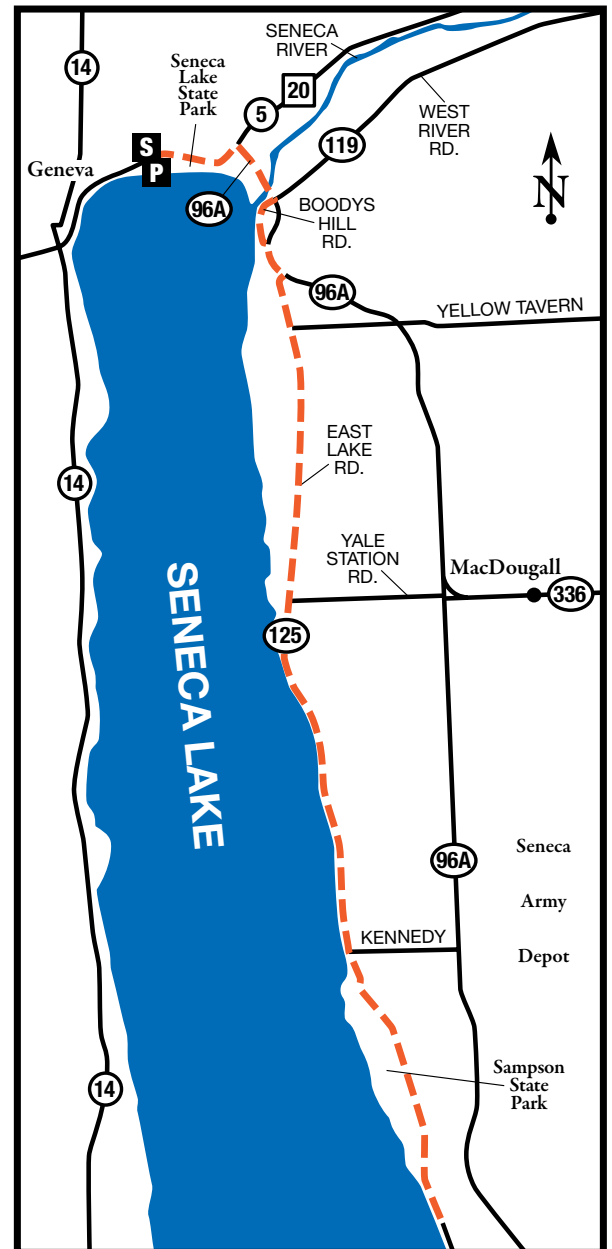

Use Hand Signals

Signal all turns and stops ahead of time. Look over your shoulder for any traffic, then make your intended move only when it is safe to do so.

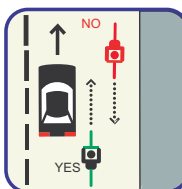

Never Ride Against Traffic *

Motorists are not looking for bicyclists riding on the wrong side of the street. Ride with traffic to avoid accidents.

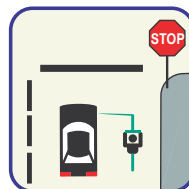

Obey Traffic Regulations *

Bicycles must be driven like other vehicles if they are to be taken seriously by motorists.

For more information on trails and attractions within this area:

Finger Lakes Visitors Connection
 Ontario County | 25 Gorham Street
 Canandaigua | NY 14424
 VisitFingerLakes.com | 877-386-4669