

# Welcome to Pennsylvania's LAUREL HIGHLANDS!

A magnificent mountainous region, the Laurel Highlands spans 3,000 square miles of Fayette, Somerset and Westmoreland counties in southwestern Pennsylvania. Located east of Pittsburgh, our beautiful year-round destination offers some of the Mid-Atlantic's most spectacular natural scenery, outstanding outdoor recreation venues, historic sites and attractions, classic family activities and world-class resorts.

Located within 200 miles of the major metropolitan areas of Pittsburgh, Baltimore, Cleveland and Washington D.C., the Laurel Highlands can be easily accessed from exits 67, 75, 91 and 110 of the Pennsylvania Turnpike.

Discover all that the Laurel Highlands has to offer!

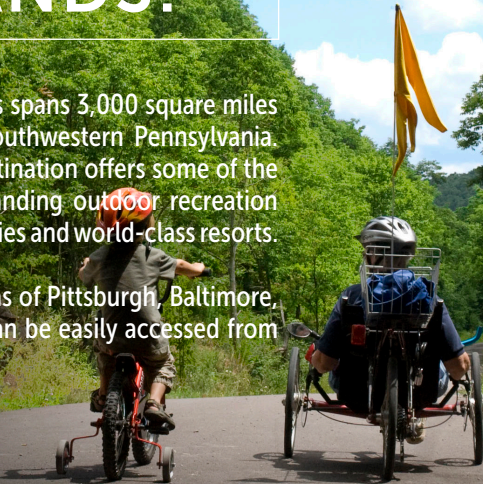

Great Allegheny Passage

## THE GREAT ALLEGHENY PASSAGE TURNS 40 IN 2018

What started as just a small bike trail between two charming Laurel Highlands towns has grown into a phenomenon that has beckoned bikers and hikers from all over the world. A converted rail-trail, which once felt the heavy rumble of freight trains, the Great Allegheny Passage (GAP) stretches 150 miles from Pittsburgh, through the Laurel Highlands and finally to Cumberland, Md. There, the GAP connects with the C&O Canal towpath, extending all the way to the Georgetown district of Washington, D.C. for a total length of 334.5 miles. Gear up for a long-haul adventure or pick a section and bike from trail town to trail town for shorter family-friendly trips.

## COMING SOON – THE TOWER OF VOICES AT FLIGHT 93 NATIONAL MEMORIAL

On September 11, 2001, four commercial airliners were hijacked in a planned attack against the United States. Two jet liners were flown into the World Trade Center Twin Towers and a third aircraft into the Pentagon. A fourth aircraft, United Airlines Flight 93, crashed into an open field near Shanksville, Pennsylvania, in the Laurel Highlands. The 40 passengers and crew of Flight 93 had time to realize that this was unlike any previous hijacking, and they developed a plan to try to take back the plane and not let it reach its intended target, Washington, D.C. They succeeded in this effort, but, unfortunately, lost their lives.

The final phase of the Flight 93 memorial, The Tower of Voices will begin with a "soundbreaking" event on Sept. 10, 2017. Once completed in September 2018, the Tower will contain 40 uniquely pitched chimes, a symbolic representation of the eternal voices of the passengers and crew members of Flight 93.

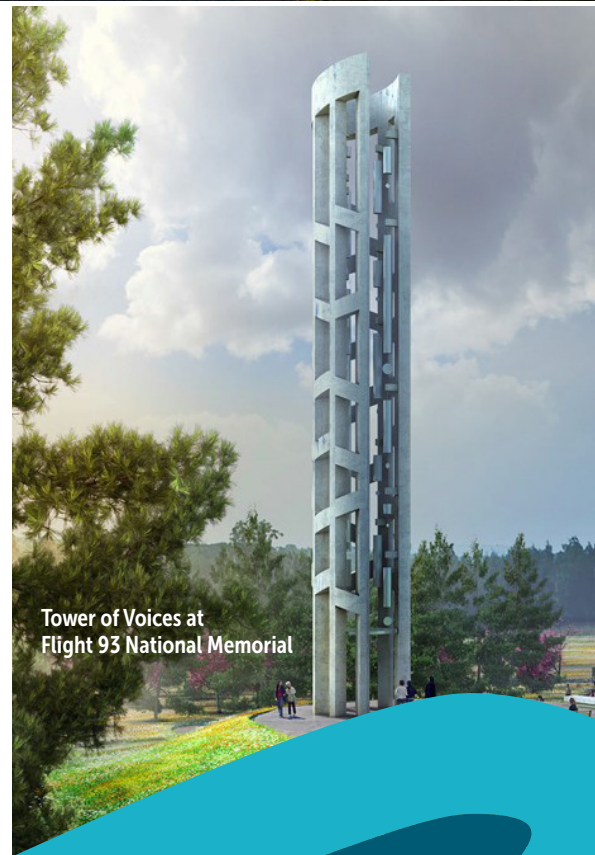

Tower of Voices at Flight 93 National Memorial



**ANNA WELTZ**  
Director of Public Relations



Fred Rogers Center

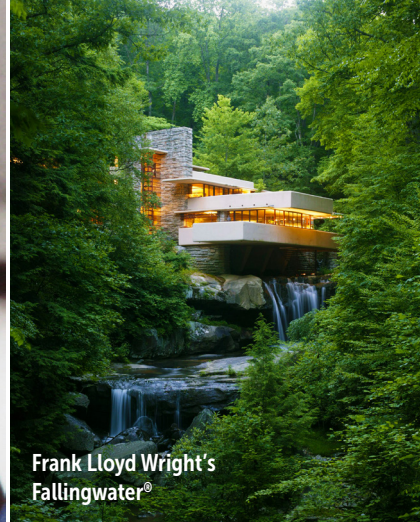

Frank Lloyd Wright's Fallingwater®

### CELEBRATING 90 YEARS OF LAUREL HIGHLANDS NATIVE AND ICON – MR. FRED ROGERS

"It's a beautiful day in the neighborhood. Won't you be, won't you be my neighbor?" Fred Rogers began his PBS children's television show Mister Roger's Neighborhood with this song every weekday from 1968 to 2001, a total of 895 shows. Come visit the real Mr. Rogers' neighborhood in Pennsylvania's Laurel Highlands! Tour the Fred Rogers Center at Saint Vincent College, where you will see artifacts from Mister Rogers' Neighborhood, including his iconic cardigan sweater and tennis shoes! Take a selfie with a statue of Mr. Rogers in downtown Latrobe, his hometown and birthplace of the banana split. Spend a day at Idlewild & Soak Zone where Daniel Tiger and friends invite you and your kiddos to ride the trolley through the Neighborhood of Make-Believe.

### NEW PETE DYE GOLF COURSE NOW OPEN AT NEMACOLIN WOODLANDS RESORT

The new Pete Dye-designed golf course, Shepherd's Rock, significantly enhances Nemacolin's reputation as a premier golf destination as it will join the celebrated Dye-designed Mystic Rock course, former home of the PGA TOUR's 84 Lumber Classic and ranked in the top-60 in Golf Digest's "America's 100 Greatest Public Courses." The Shepherd's Rock layout rivals the highest-rated courses in the country and is the perfect companion to Mystic Rock.



### FALL FOLIAGE THAT RIVALS NEW ENGLAND

Mountain vistas, historic highways, fertile farmlands and thousands of acres of unspoiled state parks, Pennsylvania's Laurel Highlands is the ideal destination for a fun, family leaf-peeping getaway. The region's towering trees are ablaze in a spectacular palette of red, orange, yellow, russet and bronze colors. Take a drive under a canopy of colors on scenic byways and through picturesque covered bridges. In addition to the wonderful foliage, autumn also brings fantastic fall festivals, harvest goods, haunted amusements and more.

### THE WRIGHT KIND OF GETAWAY

See two mountain retreats designed by legendary American architect Frank Lloyd Wright and spend the night in another. Stand on the cantilevered terraces of Fallingwater overlooking the rushing waterfall while basking in the magical natural setting that inspired Wright. Visit Kentuck Knob, a stunning home built from cypress, stone and copper with a sweeping view of the Youghiogheny River Gorge. End the Wright day with an overnight stay at the secluded Duncan House, tucked deep in the woods.



Nemacolin Woodlands Resort



New Pete-Dye Course, Shepherd's Rock



**ANNA WELTZ**  
Director of Public Relations