

PHOENIX CONVENTION CENTER

North Building | Exhibition Hall | 300 Level

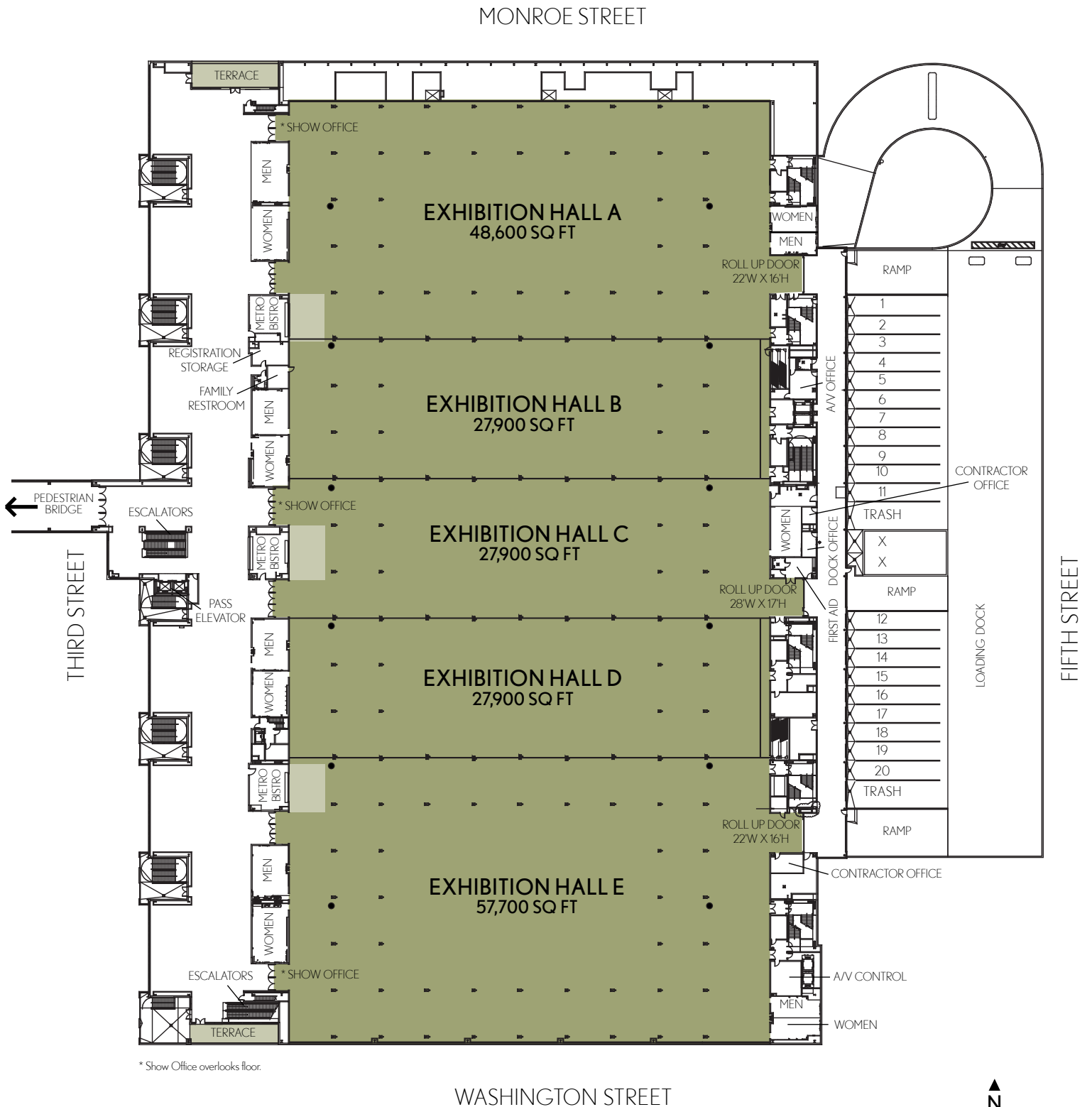

PHOENIX CONVENTION CENTER

North Building | Exhibition Hall | 300 Level

EXHIBITION SPACE

HALLS - UPPER LEVEL	AREA (SF*)	DIMENSIONS	CEILING HGT.	THEATER	SCHOOL	BANQUET	EXHIBITS
HALL A	48,600	153' x 310'	30'	3,960	2,672	1,890	277
HALL B †	27,900	90' x 310'	30'	1,000	1,000	1,000	169
HALL C ††	27,900	90' x 310'	30'	1,000	1,000	1,000	164
HALL D †	27,900	90' x 310'	30'	1,000	1,000	1,000	168
HALL E	57,700	183' x 310'	30'	4,000	3,325	2,410	331
TOTAL	190,000			12,500	10,300	7,430	1,099
OTHER SPACE							
PRE-FUNCTION	33,000						

*SF Area rounded.

† Halls B and D not booked independently.

†† Suggest Hall C not be utilized independently.

The Upper Level Exhibition Hall offers 190,000 square feet of virtually column-free exhibit space with a 300 pounds/square foot weight capacity. Columns are located on the east and west perimeters of the hall and have a clear span of 237 feet through the center of the space. The Exhibition Hall's concrete floor is scored on a 10' x 10' grid and features a 30' x 30' utility grid to expedite the move-in process. Three permanent, double-sided Metro Bistros provide convenient dining options for guests on this level.

Accessible by a semi-truck ramp with a clearance height of 16 feet, the 300 Level loading dock has 20 truck bays, three ramps and three convenient roll-up doors (22'Wx16'H, 22'Wx16'H and 28'Wx17'H). Gasket-sealed truck bays provide temperature-controlled move-in during inclement weather. The level also features a dedicated dock office, and three show offices that overlook the show floor. Trucks with a wheelbase of 73 feet or less can access the Exhibition Hall floor on this level.

33,000 square feet of spacious pre-function space is located just outside the 300 Level Exhibition Hall, and can be used for registration or a variety of event functions. An enclosed pedestrian bridge with Frank Lloyd Wright-inspired terrazzo flooring provides guests with a direct, climate-controlled connection to the West Building.

For more information, or to reserve event space at Arizona's latest greatest wonder, please call: 800.282.4842 or visit: phoenixconventioncenter.com

100 North Third Street | Phoenix, AZ 85004
602.262.6225 | TTY 602.495.5048

PHOENIX CONVENTION CENTER

North Building | Meeting Rooms | 200 Level

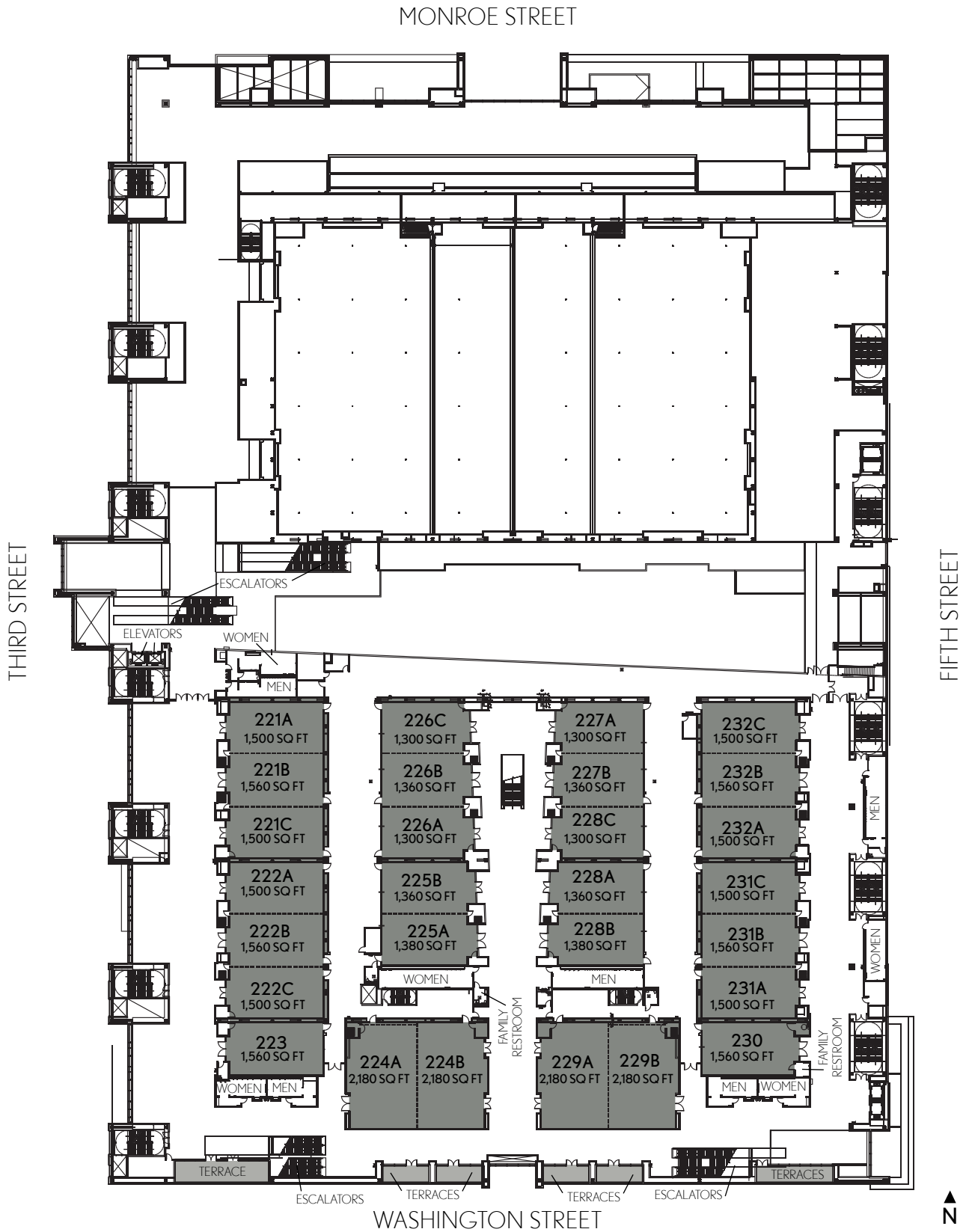

PHOENIX CONVENTION CENTER

North Building | Meeting Rooms | 200 Level

MEETING SPACE

ROOM - UPPER LEVEL	AREA (SF*)	DIMENSIONS	CEILING HGT.	THEATER	SCHOOL	BANQUET	RECEPTION
221A	1,500	54' x 29'	16'5"	125	70	50	210
221B	1,560	54' x 30'	16'5"	130	72	50	215
221C	1,500	54' x 29'	16'5"	125	70	50	210
222A	1,500	54' x 29'	16'5"	125	70	50	210
222B	1,560	54' x 30'	16'5"	130	72	50	215
222C	1,500	54' x 29'	16'5"	125	70	50	210
223	1,560	54' x 30'	16'5"	128	70	50	215
224A	2,180	38' x 60'	16'5"	180	100	70	305
224B	2,180	38' x 60'	16'5"	180	100	70	305
225A	1,380	52' x 29'	16'5"	120	68	50	190
225B	1,360	51' x 29'	16'5"	118	66	50	190
226A	1,300	49' x 29'	16'5"	115	64	50	180
226B	1,360	49' x 30'	16'5"	118	66	50	190
226C	1,300	48' x 29'	16'5"	112	62	50	180
227A	1,300	48' x 29'	16'5"	112	62	50	180
227B	1,360	49' x 30'	16'5"	118	66	50	190
227C	1,300	49' x 29'	16'5"	115	64	50	180
228A	1,360	51' x 29'	16'5"	118	66	50	190
228B	1,380	52' x 29'	16'5"	120	68	50	190
229A	2,180	38' x 60'	16'5"	180	100	70	305
229B	2,180	38' x 60'	16'5"	180	100	70	305
230	1,560	54' x 30'	16'5"	128	70	50	215
231A	1,500	54' x 29'	16'5"	125	70	50	210
231B	1,560	54' x 30'	16'5"	130	72	50	215
231C	1,500	54' x 29'	16'5"	125	70	50	210
232A	1,500	54' x 29'	16'5"	125	70	50	210
232B	1,560	54' x 30'	16'5"	130	72	50	215
232C	1,500	54' x 29'	16'5"	125	70	50	210
TOTAL	43,000						
OTHER SPACE							
PRE-FUNCTION	31,800						

*SF Area rounded.

The Second Level features 28 meeting rooms with more than 43,000 square feet of versatile break-out space. Rooms can easily be divided or expanded to meet the need of any event and are linked by a back-of-house corridor to ensure uninterrupted service. This level offers 31,800 square feet of comfortable pre-function space adjacent to the meeting rooms, and six outdoor terraces provide guests with an opportunity to enjoy the beautiful Arizona weather.

For more information, or to reserve event space at Arizona's latest greatest wonder, please call: 800.282.4842 or visit: phoenixconventioncenter.com

100 North Third Street | Phoenix, AZ 85004
602.262.6225 | TTY 602.495.5048

North Building | Ballroom & Meeting Rooms
100 Level | Street Level

BALLROOM SPACE

ROOMS – STREET LEVEL	AREA (SF*)	DIMENSIONS	CEILING HGT.	THEATER	SCHOOL	BANQUET
120A-D	45,600	276' x 165'	29'	4,200	2,750	2,470
120A	15,000	91' x 165'	29'	1,280	800	650
**120AB, 120CD	22,800	139' x 165'	29'	1,900	1,200	1,100
120B	7,800	47' x 165'	29'	740	450	380
**120BC	15,600	94' x 165'	29'	1,355	800	650
120D	15,000	91' x 165'	29'	1,280	800	650
TOTAL	45,600			4,200	2,750	2,470

OTHER SPACE

BALLROOM PRE-FUNCTION	25,000
FOOD COURT	20,750
PATIO 1	850
PATIO 2	900
PATIO 3	720
PATIO 4	720

*SF Area rounded.
**Room 120 C cannot be used alone. All specs for 120AB and 120CD are identical.

The Street Level features the 45,600 square-foot North Ballroom with a dedicated entrance, 25,000 square feet of pre-function space, and a porte cochere for guest drop offs. This exquisite ballroom is complete with dimmable lighting, sound system, and production balcony, and offers back-of-the-house load-in access. Decorative lighting, high-end wood finishes, and metallic fabric panels designed to replicate the desert sky, create an elegant setting for any occasion. The North Ballroom is the largest venue of its kind in Arizona.

This level also features 28 breakout meeting rooms with more than 43,000 square feet of meeting space and includes four unique indoor/outdoor reception patios, each offering between 720 to 900 useable square feet of space.

A Food Court with five themed eateries and a Starbucks kiosk, provides a variety of dining options for guests. The convention center's satellite ticket office, information desk and The UPS Store Business Center are also located on the Street Level.

North Building | Ballroom & Meeting Rooms
100 Level | Street Level

MEETING SPACE

ROOM - STREET LEVEL	AREA (SF*)	DIMENSIONS	CEILING HGT.	THEATER	SCHOOL	BANQUET	RECEPTION
121A	1,500	54' x 29'	16'5"	125	70	50	210
121B	1,560	54' x 30'	16'5"	130	72	50	215
121C	1,500	54' x 29'	16'5"	125	70	50	210
122A	1,500	54' x 29'	16'5"	125	70	50	210
122B	1,560	54' x 30'	16'5"	130	72	50	215
122C	1,500	54' x 29'	16'5"	125	70	50	210
123	1,560	54' x 30'	16'5"	128	70	50	215
124A	2,180	38' x 60'	16'5"	180	100	70	305
124B	2,180	38' x 60'	16'5"	180	100	70	305
125A	1,380	52' x 29'	16'5"	120	68	50	190
125B	1,360	51' x 29'	16'5"	118	66	50	190
126A	1,300	49' x 29'	16'5"	115	64	50	180
126B	1,360	49' x 30'	16'5"	118	66	50	190
126C	1,300	48' x 29'	16'5"	112	62	50	180
127A	1,300	48' x 29'	16'5"	112	62	50	180
127B	1,360	49' x 30'	16'5"	118	66	50	190
127C	1,300	49' x 29'	16'5"	115	64	50	180
128A	1,360	51' x 29'	16'5"	118	66	50	190
128B	1,380	52' x 29'	16'5"	120	68	50	190
129A	2,180	38' x 60'	16'5"	180	100	70	305
129B	2,180	38' x 60'	16'5"	180	100	70	305
130	1,560	54' x 30'	16'5"	128	70	50	215
131A	1,500	54' x 29'	16'5"	125	70	50	210
131B	1,560	54' x 30'	16'5"	130	72	50	215
131C	1,500	54' x 29'	16'5"	125	70	50	210
132A	1,500	54' x 29'	16'5"	125	70	50	210
132B	1,560	54' x 30'	16'5"	130	72	50	215
132C	1,500	54' x 29'	16'5"	125	70	50	210

TOTAL 43,000

OTHER SPACE

PRE-FUNCTION	30,000
--------------	--------

*SF Area is rounded.

North Building | Exhibition Hall | Lower Level

MONROE STREET

MONROE STREET

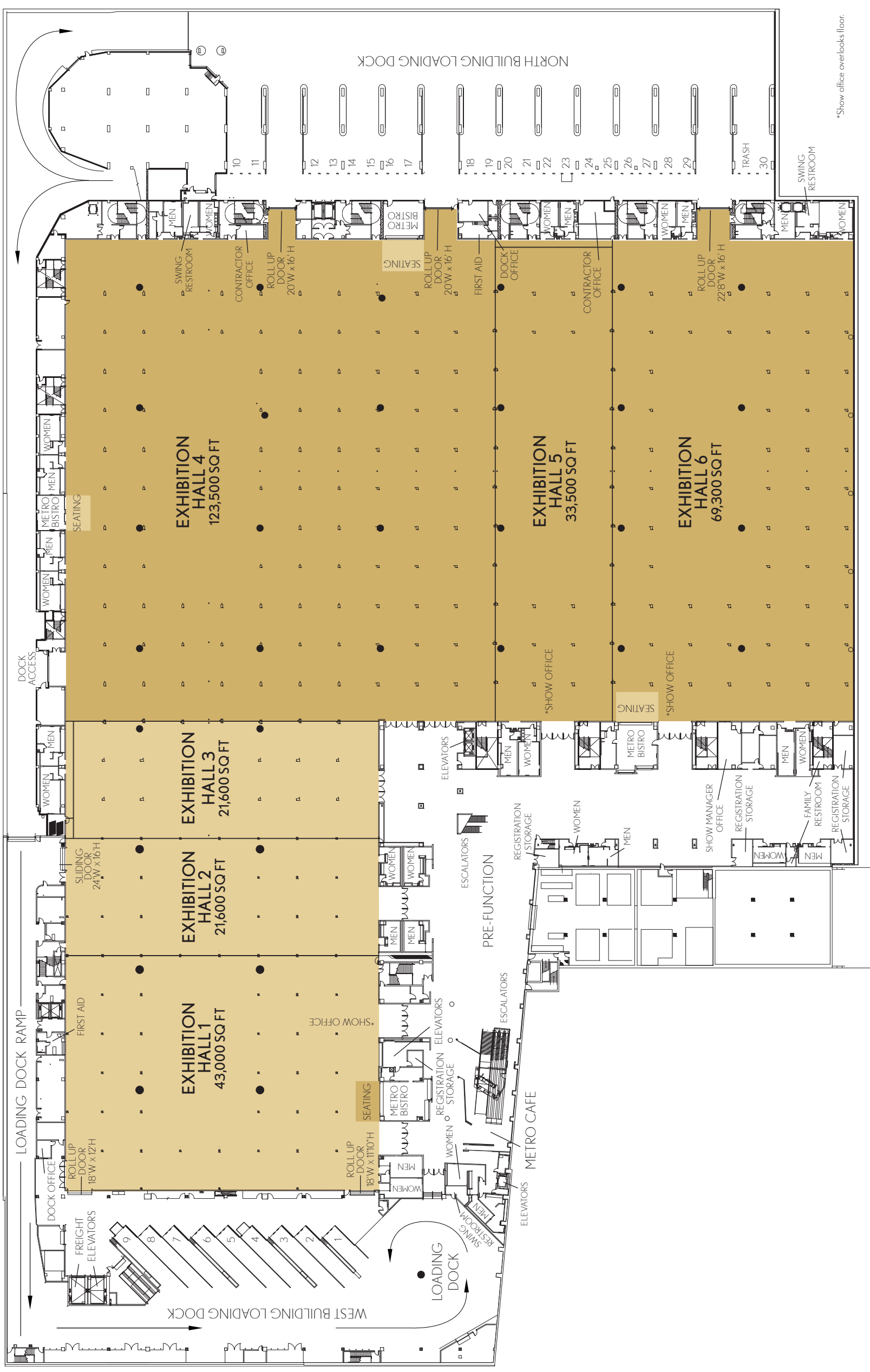

SECOND STREET

FIFTH STREET

WASHINGTON STREET

WASHINGTON STREET

*Show office overlooks floor.

PHOENIX CONVENTION CENTER

North Building | Exhibition Hall | Lower Level

EXHIBITION SPACE							
HALLS - LOWER LEVEL	AREA (SF*)	DIMENSIONS	CEILING HGT.	THEATER	SCHOOL	BANQUET	EXHIBITS
HALL 1	43,000	180' x 240'	32'				251
HALL 2	21,600	90' x 240'	32'				125
HALL 3 †	21,600	90' x 240'	32'				130
HALL 4	123,500	370' x 330'	32'				687
HALL 5 †	33,500	370' x 90'	32'				202
HALL 6	69,300	370' x 185'	32'				399
TOTAL	312,500						1,786
OTHER SPACE							
PRE-FUNCTION	40,000						

*SF Area rounded.

† Halls 3 and 5 not booked independently.

The Exhibition Hall offers 312,500 square feet of continuous exhibit space which connects the North and West Buildings under Third Street. Scored on a 10' x 10' grid and a 30' x 30' utility grid to expedite the move-in process, the Exhibition Hall has a 350 pounds/square foot weight capacity and rigging points ranging from 2,500-5,000 pounds/square foot. This level offers five functional show offices, three that overlook the show floor and two on the ground level in the adjacent pre-function areas.

The Lower Level features two convenient access points for move-in. The North Building loading dock features 21 truck bays, three ramps and three convenient roll-up doors (two at 20'Wx16'H and one at 22'8"Wx16'H). The West Building loading dock provides nine truck bays, two convenient roll-up doors (18'Wx11'10"H and 18'Wx12'H) and a semi-truck turnaround. Trucks with a wheelbase of 73' or less can access the Exhibition Hall floor on this level via a sliding door (24'Wx16'H).

40,000 square feet of spacious pre-function space, located just outside the Exhibition Hall, is available for registration and a variety of other event functions. Convenient dining options for guests include three, double-sided Metro Bistros, accessible from the pre-function area and the Exhibition Hall, and the Metro Café, located adjacent to Hall 1.

For more information, or to reserve event space at Arizona's latest greatest wonder,
please call: 800.282.4842 or visit: phoenixconventioncenter.com

100 North Third Street | Phoenix, AZ 85004
602.262.6225 | TTY 602.495.5048