

SACRAMENTO CALIFORNIA

# CONVENTION CENTER COMPLEX

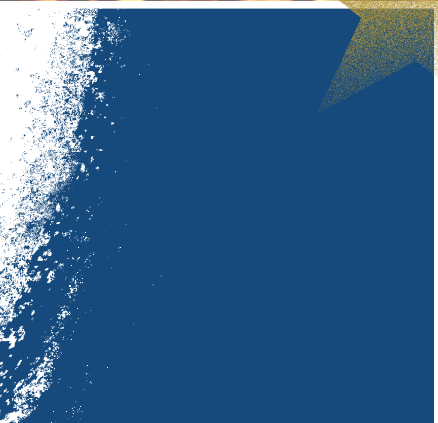

The mission of the Sacramento Convention Center Complex is to provide a quality, diverse service-oriented facility that enhances the economic and cultural vitality of the Sacramento Community.

## CALIFORNIA BEGINS HERE

# WELCOME TO SACRAMENTO!

Sacramento is the star on the map of California, a state capital with a character all its own. From the bounty of the urban farms to the hip style of Midtown to the historic preservation of Old Sacramento, you'll find cultural attractions to inspire you, cutting-edge cuisine to impress you, history to enrich you and surprises to put a smile on your face. Centrally located in Northern California, Sacramento is easy and convenient to access, whether by car, train or plane. Sacramento International Airport offers 130 non-stop flights to major destinations and one-stop flights to countless more.

The downtown Sacramento Convention Center Complex is a part of the City of Sacramento Convention, Culture and Leisure department. The Complex is made up of the Convention Center, which has over 137,000 square feet of exhibit space, 31 meeting rooms, including a 24,000 square foot ballroom; the 2,398-seat Community Center Theater; and the 3,849-seat Memorial Auditorium, which houses the 272-seat Jean Runyon Theater.

All the facilities are within walking distance of dining, nightlife and shopping areas. Headquarter hotels are just steps away and more than 2,000 first-class hotel rooms represented by some of the world's major brands are within walking distance.

Assuring a future-focused outlook, we continually modernize our facilities and work closely with our key partners to meet the needs of our customers. **Be confident that your Sacramento Convention Center Complex team can deliver excellent service for an event of any size and provide resources throughout each step of the planning stage to ensure you have a successful event.**



# SO MANY THINGS TO SEE & DO

**ATTRACTIONS** Sacramento's year-round attractions are tucked into a culturally diverse cityscape. Enjoy our local playhouses and the Broadway stage, museums and galleries, poetry readings and film festivals, ballet and opera.

**RECREATION** Our city is surrounded by two rivers—the American and the Sacramento—and recreation tops the list for outdoor activities with hundreds of miles of waterways, 2,000 acres of city parks, more than 50 golf courses, and two nearby lakes.

**PROFESSIONAL SPORTS** Sacramento's professional sports teams include the Sacramento Kings (NBA), Sacramento River Cats (Oakland A's Triple-A baseball affiliate), a USL pro soccer team, and the Sacramento Capitals (World Team Tennis Pro League).

**SHOPPING** From classic and chic, antique and unique, to designer threads and local creations are what you'll find in Sacramento. Shopping malls, boutiques and one-of-a-kind shops offer something for everyone.

**DINING** Sacramento has been named "America's Farm-to-Fork Capital." No other major metropolitan city has more farms, ranches and growers located within such close proximity. Many of the city's restaurants are prepared with food sourced within 50-70 miles of Sacramento. Dining spots range from casual to classic to fine. Throughout the city are home-grown coffee houses and local favorites serving ethnic specialties or vegetarian delights—all created by multi-talented chefs.

**NIGHTLIFE** A revitalized Downtown and Midtown has generated a surge of hip nightclubs, wine bars, live music venues, and comedy clubs. Sacramento has become a true cosmopolitan city.

**WINE TASTING** The greater Sacramento region and surrounding counties offer 200 wineries, vineyards and tasting rooms. The foothill wineries are quickly earning a reputation for producing countless varieties of award-winning wines.



**Centrally located in Northern California, Sacramento is just a short distance from the Gold Country, California Redwoods, San Francisco, Lake Tahoe, Reno, and Yosemite. Sacramento is one of California's most accessible major cities.**



# what people are saying

*“Our annual conference in Sacramento was a huge success! From a planning and implementation perspective, the Bureau, hotels and Convention Center were outstanding partners. The community is diverse, friendly and helpful. Meeting venues are, literally, two minutes door-to-door, which is very important for this group. Attendees remarked how they enjoyed quick walks to lovely parks, the State Capitol, an array of affordable restaurants, and the nightlife of Old Sacramento.”*

Christine M. Goldberg, Education & Conferences Consultant,  
Association for Marriage & Family Therapy

*“Sacramento is an excellent location for a conference. The Convention & Visitors Bureau and all the facilities worked with us to make the event successful. With the hotels and Convention Center in such close proximity, it was really easy for the attendees. And they appreciated the wide variety of restaurants and entertainment within walking distance of their hotels.”*

M. Elaine Gilliam, CMP, Meeting Manager  
Society for Technical Communication

*“As a local independent Meeting Planner who does business across the country, I find the Sacramento Convention Center is centrally located, provides outstanding customer service, has flexible meeting space, and offers farm-to-fork inspired catering menus.”*

Donna Leon, CMP, President  
Meetings & More, Inc



*“Sacramento is a city full of surprises! Good ones...*

*You’ll find a team of professionals waiting to implement your dreams and they have a few of their own. The CVB and Convention Center staffs are creative, friendly and have the experience necessary to make your event a great success. The convenient location of the downtown area makes it a breeze for your attendees to get from hotel to meeting space to great food to the Old West. The proximity to great agricultural areas means fresh food prepared in unique and traditional ways.*

*While Sacramento might not be one of the 10 cities on your list, once you try it I think it will be!”*

Dean Jones, CMP, Director of Conferences & Events  
Religious Conference Management Association

*“I had no idea that Sacramento was such a convenient city for mid-size meetings and conventions. The accessibility of the Convention Center—literally just steps from the two major hotels—is a tremendous convenience for conference attendees. And the city is very flexible in structuring Convention Center rental based on number of room nights used by a group. Immediately after my site visit, I recommended Sacramento to one of my clients.”*

Nancy Wise, Account Manager  
Experient Inc.



Memorial Auditorium

Marriot

15th Street  
(one way) →

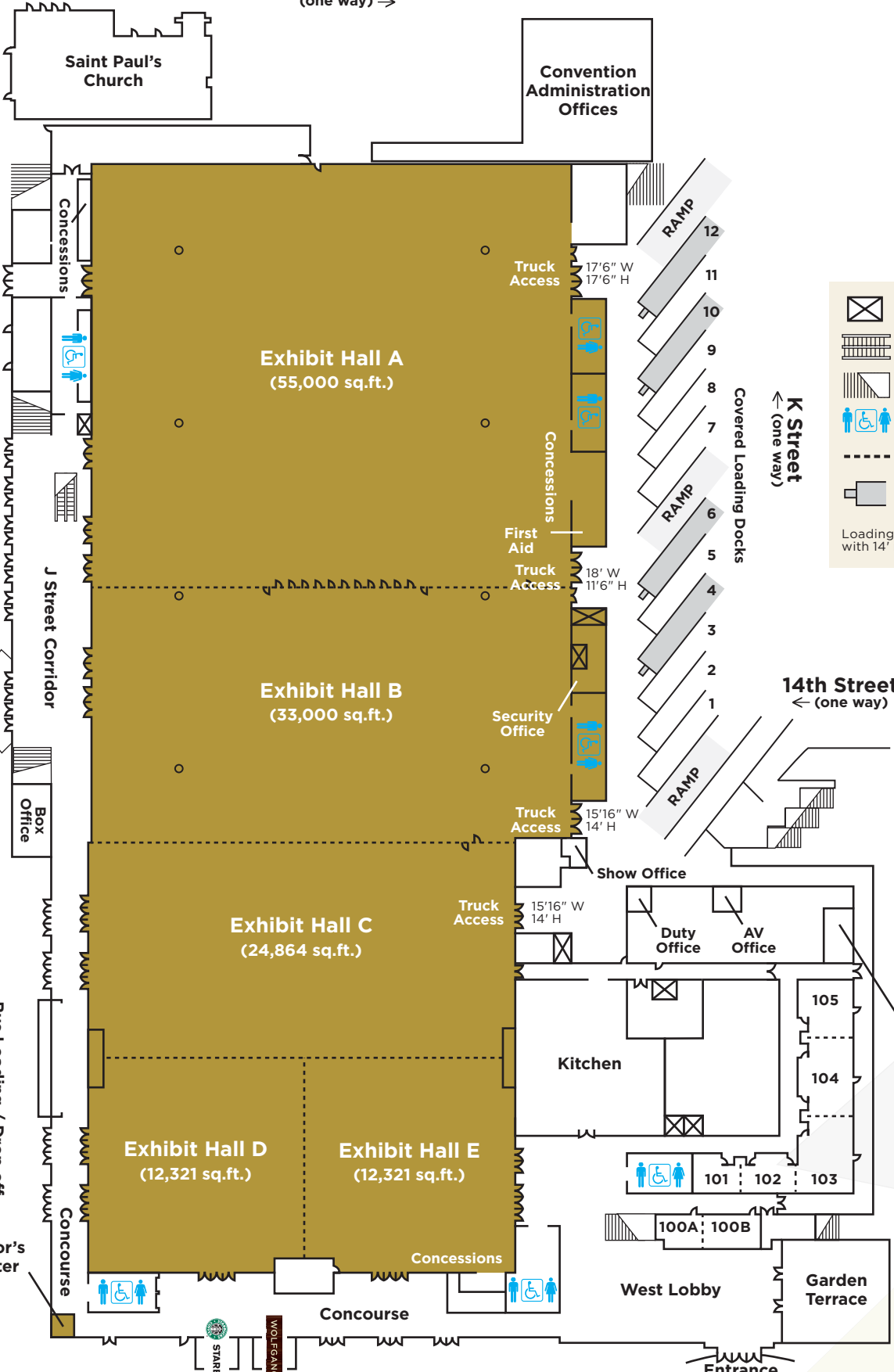

Saint Paul's Church

Convention Administration Offices

Exhibit Hall A  
(55,000 sq.ft.)

Exhibit Hall B  
(33,000 sq.ft.)

Exhibit Hall C  
(24,864 sq.ft.)

Exhibit Hall D  
(12,321 sq.ft.)

Exhibit Hall E  
(12,321 sq.ft.)

- Elevator
  - Escalator
  - Stairway
  - Restrooms
  - Airwall
  - Adjustable dock plates
- Loading Bays 68' long with 14' max height

K Street  
(one way) ←

14th Street  
(one way) ←

J Street  
(one way) ←

Sheraton Grand

K Street Mall

Hyatt Regency

Entrance

Entrance

Visitor's Center

Catering Offices

J Street Corridor

Bus Loading / Drop off

Concessions

Truck Access

Concessions

First Aid

Truck Access

Security Office

Truck Access

Truck Access

Kitchen

Concessions

Concourse

West Lobby

Garden Terrace

Show Office

Duty Office

AV Office

105

104

101

102

103

100A

100B

STARBUCKS COFFEE

WOLFGANG PUCK EXPRESS



# EXHIBIT HALL

FIRST FLOOR	Total sq.ft. (approx.)	Dimensions (approx.)	Ceiling Height	Exhibit Booths (10x10)	Theater Seating	Classroom 4 per 30" table	Classroom 4 per 18" table	Dining 8 per 60" table	Dining 10 per 72" table	Reception
Exhibit Hall A	55,000	220'x250'	30'	273	4,324	2,992	3,432	3,104	2,660	5,700
Exhibit Hall B	33,000	132'x250'	30'	161	2,856	1,672	2,024	1,904	1,580	3,500
Exhibit Hall C	24,864	112'x222'	20'	100	2,500	1,250	1,584	1,440	1,184	2,500
Exhibit Hall D	12,321	111'x111'	20'	64	1,250	625	700	648	560	1,250
Exhibit Hall E	12,321	111'x111'	20'	62	1,250	625	700	648	560	1,250
A-B Combined	88,000	352'x250'	30'	455	8,670	5,016	5,896	5,536	4,600	9,200
A-C Combined	112,864	—	—	602	10,252	5,914	7,080	6,448	5,784	11,700
A-D Combined	125,185	—	—	709	11,502	—	—	—	—	—
B-E Combined	82,506	—	—	434	7,856	—	—	—	4,300	8,500
C-E Combined	49,506	223'x222'	20'	251	5,250	2,464	3,256	3,200	2,720	5,000
D-E Combined	24,642	111'x222'	20'	128	2,500	1,250	1,584	1,440	1,184	2,500
Total A-E	137,506	—	—	728	—	—	9,352	7,744	7,320	14,200

CAPACITIES MAY VARY DEPENDING ON SET-UPS AND/OR SPECIAL REQUIREMENTS

## UTILITY SERVICE

### Electrical Power: Floor: Halls A & B (30ft. centers)

30amp 208/120/3ph  
100amp 208/120/3ph  
20amp 208/120/3ph  
20amp 120/1ph

### Electrical Power: Ceiling: Halls A & B (90ft. centers)

100amp 120/220/3ph  
(16) Exhibit Hall A  
(3) Exhibit Hall B  
100amp 220/460/3ph  
(6) Exhibit Hall A  
(6) Exhibit Hall B

### Electrical Power: Ceiling: Halls C, D & E (30ft. centers)

100amp 120/208/3ph  
(2) Exhibit Hall C  
(1) Exhibit Hall D  
(1) Exhibit Hall E

### Production Power

Exhibit Halls A or B  
(1) 100amp/3ph  
(2) 200amp/3ph  
(1) 400amp/3ph

### Plumbing water in/out

Natural gas (Halls C, D & E)

Compressed air

Telephone, Video, CATV DATA

Satellite downlink capability

Fiber optic capability

## FEATURES

- 12 loading docks
- 4 adjustable dock plates (bays 4, 6, 10, 12)
- 4 truck doors, direct access
- Show managers office
- First aid room
- Convertible restrooms
- Concession stands
- Floor load 350lbs per sq.ft.

**SECOND FLOOR**

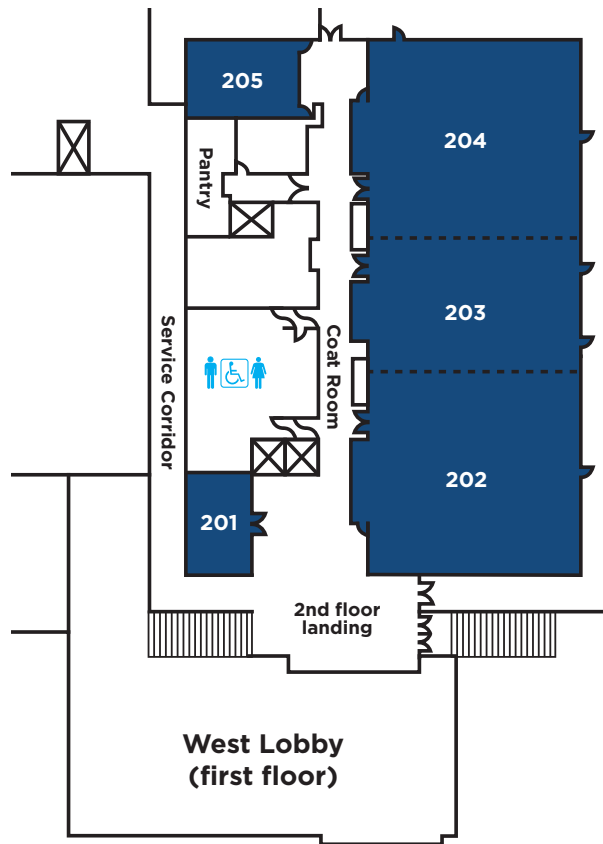

- Elevator
- Escalator
- Stairway
- Restrooms
- Airwall

**FIRST FLOOR**

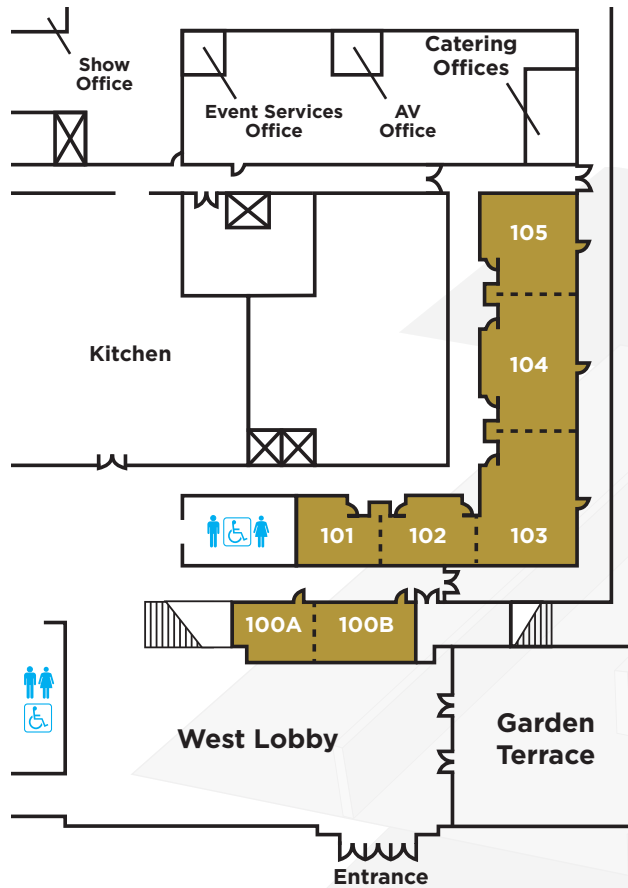





# MEETING ROOM LEVELS

FIRST FLOOR	Total sq.ft. (approx.)	Dimensions (approx.)	Ceiling Height	Hollow Square	Theater Seating	Classroom 4 per 30" table	Classroom 4 per 18" table	Dining 60" rounds 8 per table	Dining 72" rounds 10 per table	Reception
100A	253	11'x23'	10'	24	28	12	16	16	20	20
100B	480	16'x30'	10'	20	28	16	20	24	20	30
101	336	14'x24'	9'	20	30	12	16	16	20	30
102	406	14'x29'	9'	20	34	20	24	24	20	40
103	644	23'x28'	9'	40	90	40	48	64	60	100
104	920	23'x40'	9'	40	90	48	48	64	60	100
105	667	23'x29'	9'	32	70	40	48	40	75	
West Lobby	6,000	—	—	—	—	—	—	—	—	—
<b>SECOND FLOOR</b>										
201	522	18'x29'	12'	24	51	28	32	40	20	60
202	3,596	62'x58'	15'	96	364	192	200	240	200	450
202-204 Combined	9,610	155'x62'	15'	—	988	512	576	600	520	900
203	2,418	62'x39'	15'	72	208	112	144	160	150	300
204	3,596	62'x58'	15'	96	364	192	200	240	200	450
205	726	22'x33'	12'	36	80	32	40	48	20	60

CAPACITIES MAY VARY DEPENDING ON SET-UPS AND/OR SPECIAL REQUIREMENTS

## UTILITY SERVICE

**Electrical Power: Rooms 101-105**  
20amp/1ph

**Electrical Power: Rooms 202-204**  
(1) 100amp 120/208/ (per room)  
(2) 20amp 120/208/3ph (per room)  
20amp/1ph

## FEATURES

- Fully carpeted
- 12 meeting rooms
- Individually controlled lighting, floor to ceiling windows

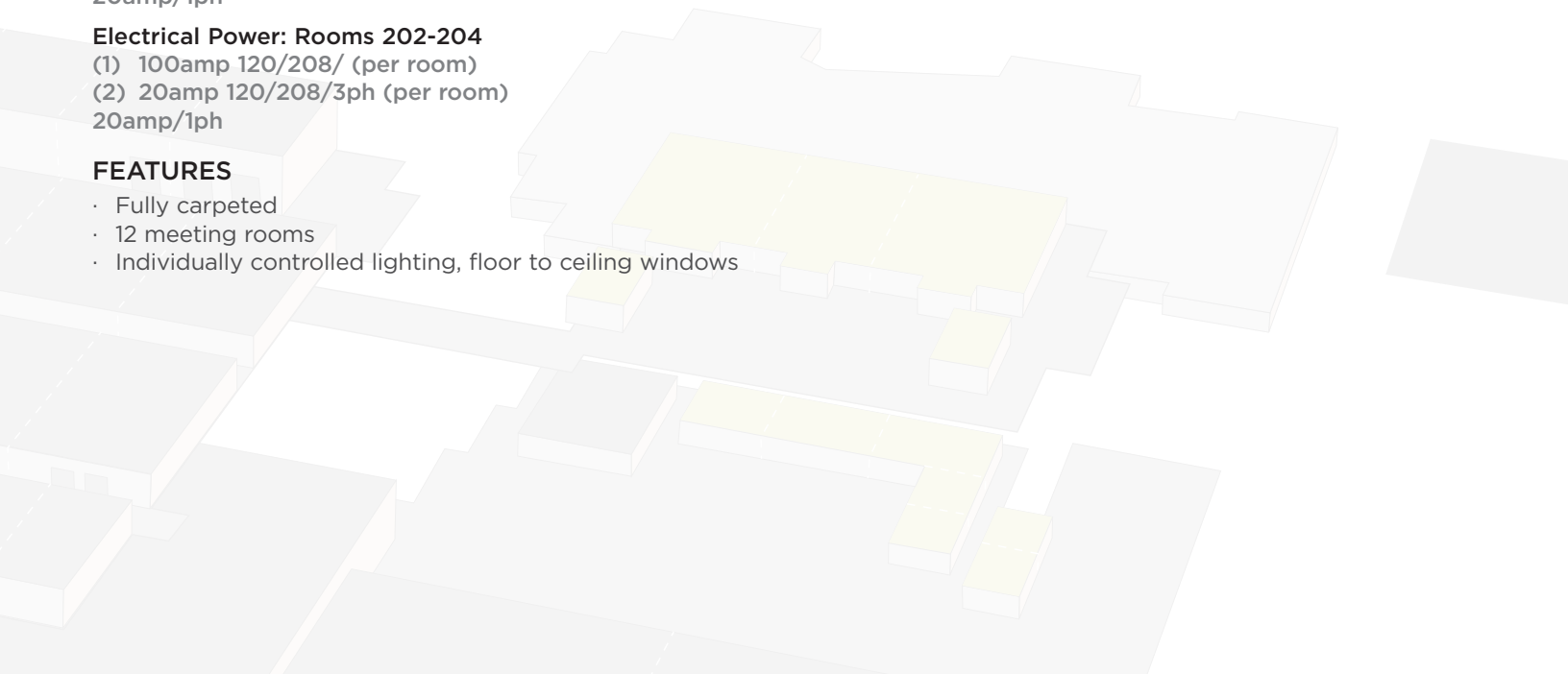

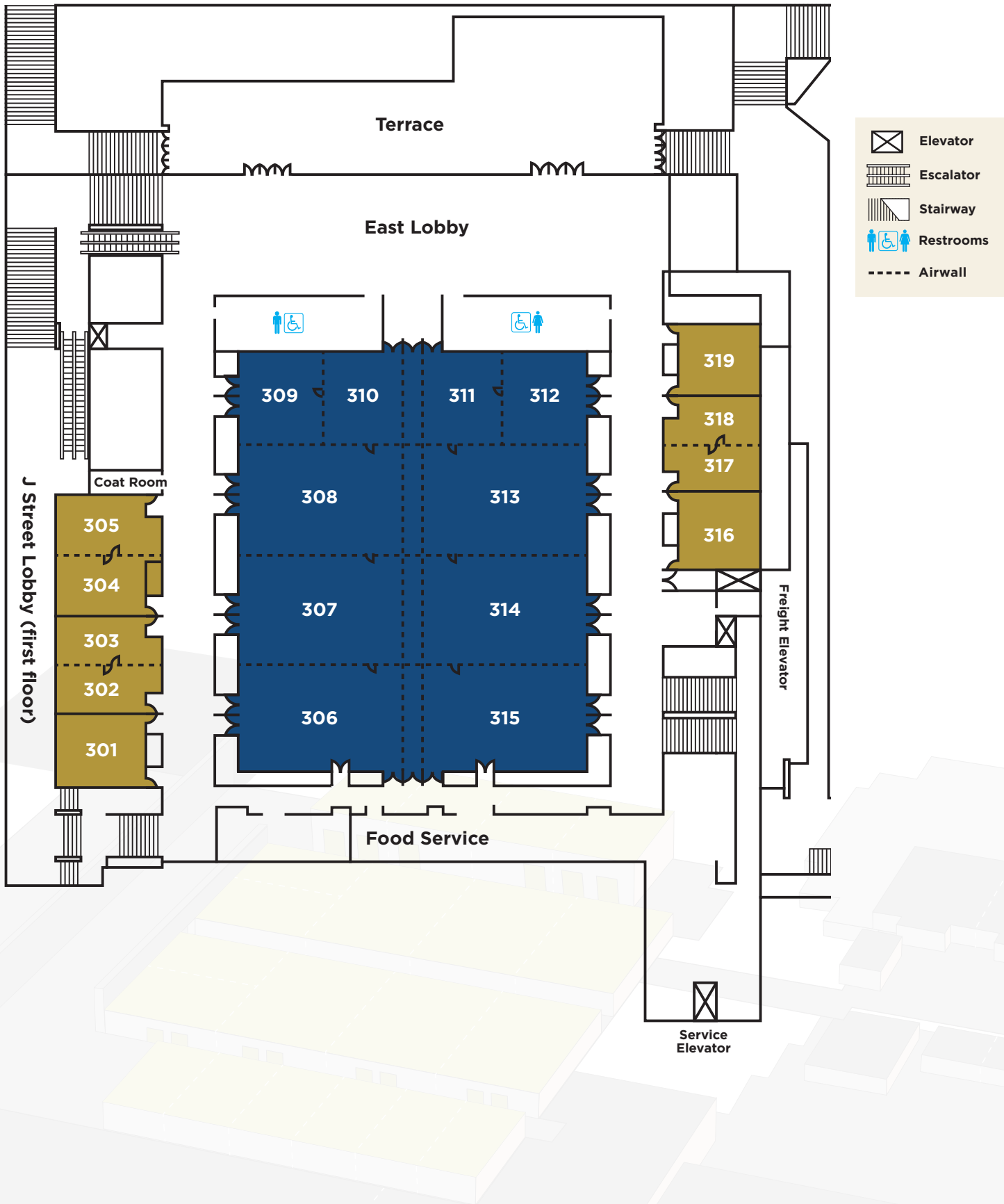

Terrace

East Lobby

J Street Lobby (first floor)

Coat Room

Food Service

Freight Elevator

Service Elevator

305  
304  
303  
302  
301

309 310 311 312  
308 313  
307 314  
306 315

319  
318  
317  
316

Restrooms



# BALLROOM LEVEL

THIRD FLOOR Meeting Rooms	Total sq.ft. (approx.)	Dimensions (approx.)	Ceiling Height	Hollow Square	Theater Seating	Classroom 4 per 30" table	Classroom 4 per 18" table	Dining 8 per 60" table	Dining 10 per 72" table	Reception
301	1,015	29'x35'	11'	36	91	32	40	48	50	102
302	665	19'x35'	11'	32	49	16	20	24	20	70
303	665	19'x35'	11'	32	49	16	20	24	20	70
304	875	25'x35'	11'	36	70	32	40	48	50	90
305	875	25'x35'	11'	36	70	32	40	48	50	94
<b>Ballroom</b>										
306	2,772	42'x66'	25'	72	280	144	176	160	120	337
307	2,904	44'x66'	25'	80	280	144	176	160	120	310
308	2,904	44'x66'	25'	80	280	144	176	160	120	310
309	1,258	37'x34'	25'	48	96	48	60	72	60	124
310	1,184	37'x32'	25'	48	128	48	60	72	60	124
311	1,184	37'x32'	25'	48	128	48	60	72	60	124
312	1,258	37'x34'	25'	48	96	48	60	72	60	124
313	2,904	44'x66'	25'	80	280	144	176	160	120	310
314	2,904	44'x66'	25'	80	280	144	176	160	120	310
315	2,772	42'x66'	25'	72	280	144	176	160	120	296
306-315 Combined	24,282	171'x142'	25'	—	2,652	1,296	1,536	1,560	1,440	2,595
<b>Meeting Rooms</b>										
316	896	28'x32'	11'	32	84	32	40	48	50	94
317	608	19'x32'	11'	32	49	16	20	24	20	70
318	576	18'x32'	11'	32	49	16	20	24	20	70
319	928	29'x32'	11'	32	91	32	40	48	50	102
East Lobby	9,000	—	—	—	—	—	—	—	—	845*

CAPACITIES MAY VARY DEPENDING ON SET-UPS AND/OR SPECIAL REQUIREMENTS

## UTILITY SERVICE

### Electrical Power: Ballrooms 306-315

#### West End Service

- (1) 100amp/3ph Camlock
- (2) 200amp/3ph Camlock
- (1) 400amp/3ph Camlock

#### Floor

30amp 120/208/3ph (30ft. x 40ft. grid)

#### Wall (in each room)

100amp, 60amp, 120/208/3ph

## FEATURES

- Fully carpeted ballroom & pre-function area
- 9,000 sq.ft. lobby
- Floor-to-ceiling lobby windows
- 10,000 sq.ft. outdoor terrace adjacent to lobby
- Flexible ballroom space divisible into 10 rooms
- Floor load 150lbs per sq.ft.
- 9 perimeter rooms surrounding the ballroom
- Individually controlled lighting in all rooms
- Freight elevator 1,500lbs capacity



## did you know?

**Sacramento Community Theater is located in the heart of the Downtown Entertainment District.**

**The Community Center Theater is home to season productions for the California Musical Theatre's Broadway Series, Sacramento Ballet, Sacramento Opera and Sacramento Philharmonic.**

**The Community Center Theater has played host to a variety of Broadway blockbusters that include *Phantom of the Opera*, *The Lion King*, *Mary Poppins*, *Wicked* and *Jersey Boys*, to name a few.**

**The Sacramento Ballet's production of *The Nutcracker* is a long-standing regional holiday tradition.**

**Sacramento Philharmonic and Opera have merged to become a non-profit organization known as the Sacramento Region Performing Arts Alliance. ([2intune.org](http://2intune.org))**



# COMMUNITY CENTER THEATER

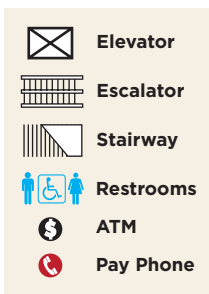
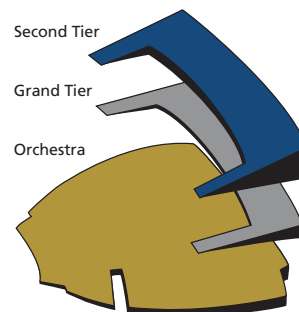
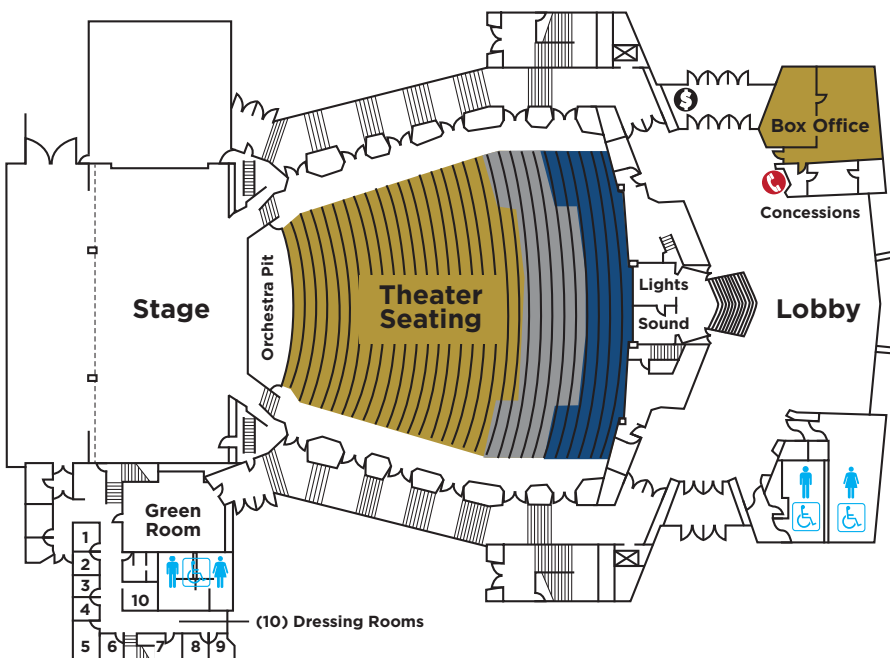

## BOX OFFICE INFORMATION

1301 L Street  
Sacramento, CA 95814

**Tel 916.808.5181**  
**Fax 916.808.7317**  
**TDD 916.808.7151**

To order tickets:  
**sacramento**  
**conventioncenter.com**  
Authorized tickets partner:  
**tickets.com**

Hearing Assistance  
System available

Section	Seating Space	Wheelchair
Orchestra Pit	72	0
Orchestra Level	1,456	37
Grand tier	379	8
Second tier	491	8
<b>Total Capacity</b>	<b>2,398</b>	<b>54</b>

## FEATURES

Adjustable Proscenium arch: H 16'0"-28'6", W 40'0"-56'0" · 52 Line Sets · 92'0" x 40'2" · Stage · Full curtains  
Public address system · Lighting system · Orchestra pit  
Sound and lights booth · Spotlight and projection booths

## BACKSTAGE

- 10 Dressing rooms (2 with private bathrooms)
- 2 Chorus rooms (with private bathrooms)
- 1 Green room
- Free Wi-Fi
- Direct loading from dock

## Electrical Power

(4) 400A/3ph, (1) 200A/3ph sound, (1) 225A/3ph,  
(1) 100A/3ph, (1) 60A/3ph motor power



## did you know?

**The Memorial Auditorium is a crown jewel of Sacramento, and is a registered historic landmark and an award winner of “Protecting America’s Treasure.”**

**The Memorial Auditorium was dedicated as a memorial and tribute to our city residents who gave their lives in service to our country.**

**Eleanor Roosevelt, along with former Presidents George W. Bush and Bill Clinton have all spoken at the Memorial Auditorium to sold out audiences.**

**Between 1967-1977, more than 60 rock groups performed here.**

**The Memorial Auditorium has been home to regional graduation ceremonies since opening in 1927.**



# MEMORIAL AUDITORIUM

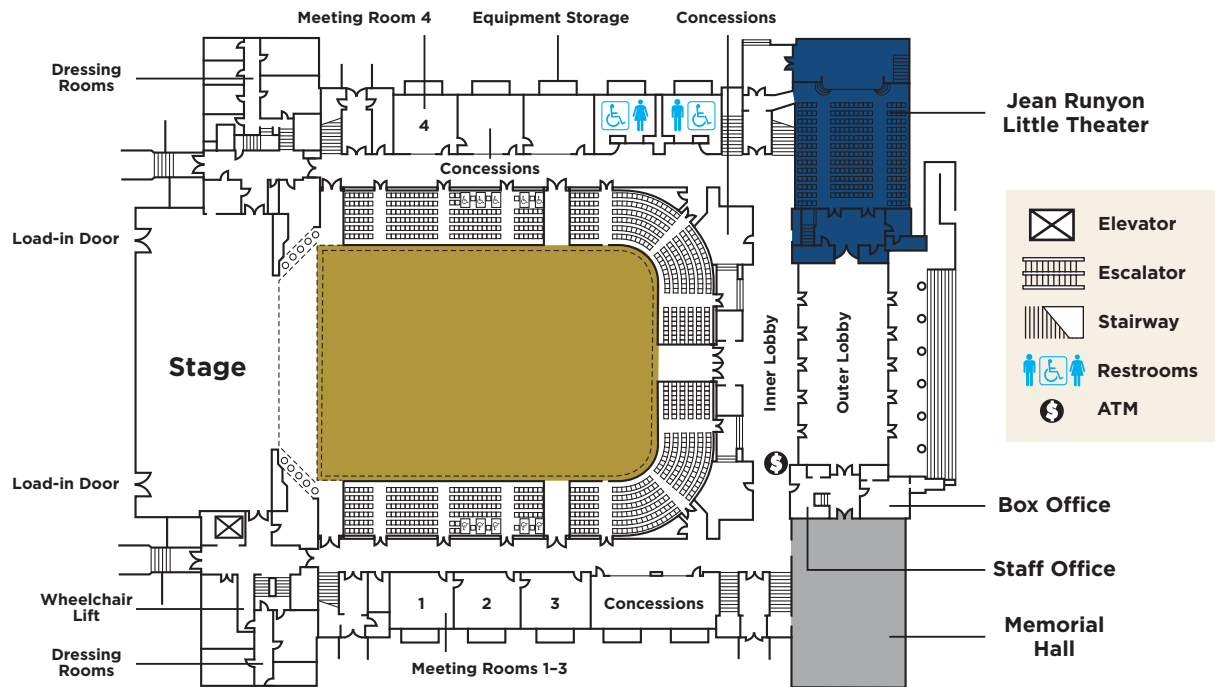

## BOX OFFICE INFORMATION

1301 L Street  
Sacramento, CA 95814

Tel 916.808.5181

Fax 916.808.7317

TDD 916.808.7151

To order tickets:  
**sacramento**  
**conventioncenter.com**

Authorized tickets partner:  
**tickets.com**

Hearing Assistance  
System available

## MEMORIAL AUDITORIUM

Section	Seating Space	Wheelchair
Floor	1,302	available
Dress Circle	807	6
First Balcony	688	—
Second Balcony	1,052	—
<b>Total Capacity</b>	<b>3849</b>	<b>—</b>

## FEATURES

56'6" x 37' Proscenium arch · 100' x 37' stage · Full curtains  
PA system · 2 Spotlights · 24 ETC Revolution lights on house  
truss · 113' x 79' Main floor · (4) 18' x 20' Meeting Rooms  
35 Line sets · Electrical power: (3) 400A/3ph, (1) 600A/3ph

## BACKSTAGE

- 21 dressing rooms (2 furnished rooms, free Wi-Fi)
- Direct loading from rear of stage at stage level
- Private restrooms

## LITTLE THEATER

Section	Seating Space	Wheelchair
Main Floor	204	available
Balcony	68	—
<b>Total Capacity</b>	<b>272</b>	<b>—</b>

## FEATURES

21'8" x 16'10" Proscenium arch, 32' x 18' stage,  
full curtains, lighting system

## BACKSTAGE

- 2 dressing rooms

## MEMORIAL HALL

Total Area sq.ft.	Dimensions sq.ft.	Theater Seating	Classroom 4 per table	Dining 8 per 60" table
1575	35'x45'	165	96	96



SACRAMENTO  
CONVENTION  
CENTER

# MAIN ENTRANCE 1400 J STREET

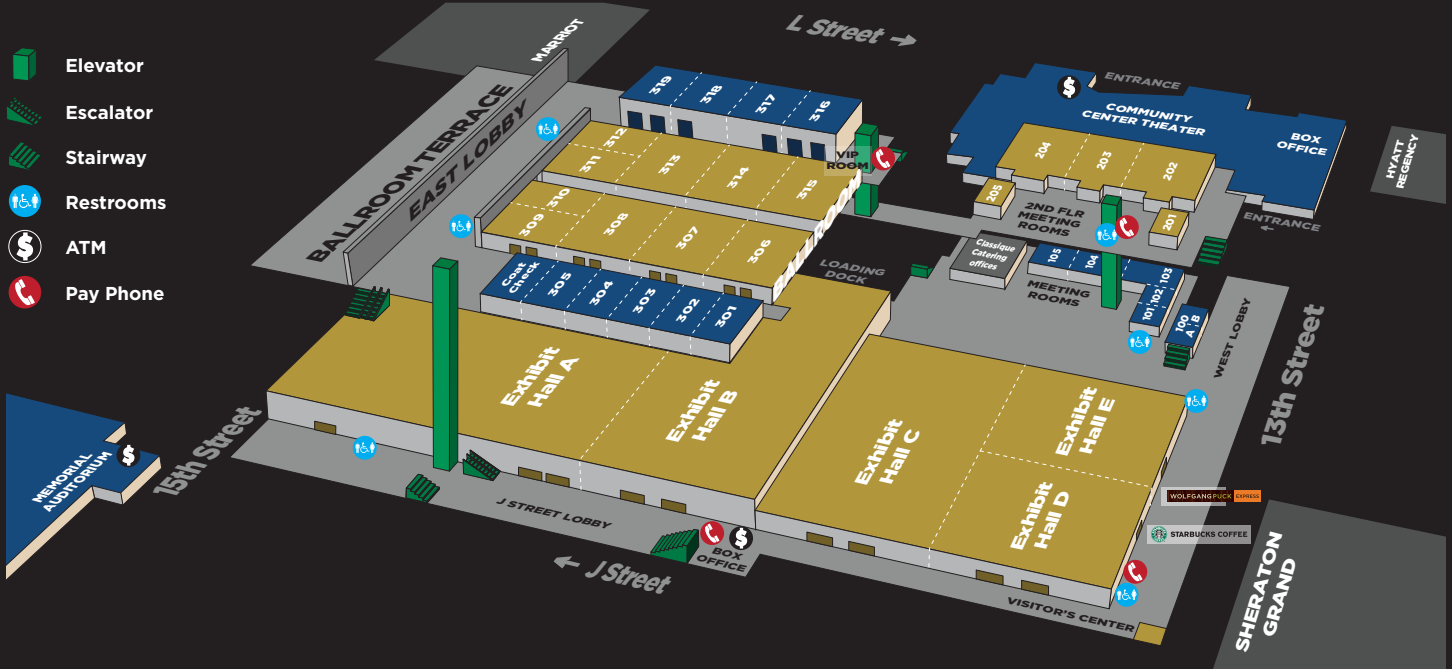

## CLASSIQUE CATERING

1100 14th Street · TEL 916.446.1215 · FAX 916.446.1302 · [classiquecatering.com](http://classiquecatering.com)

## MAIN BOX OFFICE

1301 L Street · TEL 916.808.5181 · FAX 916.808.7317 · [sacramentoconventioncenter.com](http://sacramentoconventioncenter.com)

## SALES & BOOKING INFORMATION

Sacramento Convention Center Administration Office  
1030 15th Street, Suite 100 · TEL 916.808.5291 · FAX 916.808.7687 · [sacramentoconventioncenter.com](http://sacramentoconventioncenter.com)

## VISITOR INFORMATION

Sacramento Convention and Visitors Bureau  
1608 I Street · TEL 916.808.7777 · FAX 916.808.7788 · [visitsacramento.com](http://visitsacramento.com)

## ON-SITE DINING

WOLFGANG PUCK EXPRESS



STARBUCKS COFFEE

The Sacramento Convention Center realizes the importance of renewable energy to protect the environment and is offsetting the electricity used to host events with Green-e certified renewable energy. This commitment to clean, renewable energy helps protect the environment from harmful emissions associated with fossil fuel-based energy and helps build a sustainable energy future.

