

OFFICIAL
LAS Vegas
GUIDE

LAS VEGAS **CASHMAN** CENTER



VegasMeansBusiness.com

PRESENTING **CASHMAN CENTER**

We'd like to introduce you to the affordable and flexible alternative for your next meeting or event: Cashman Center, near exciting Downtown Las Vegas.



FACILITIES DESIGNED WITH YOUR NEEDS IN MIND

Cashman Center was designed with three goals: convenience, workability and versatility. You'll not only find ample square footage, but will also discover that every square foot of Cashman Center was created to make your job as a meeting planner or exhibitor easier. Cashman Center consists of two flexible exhibit halls totaling 98,100 square feet of exhibit space with 14 meeting rooms, a 1,898-seat theater and a 9260-seat stadium. Each of these facilities can be used independently, or combined to suit your specific requirements. That means you use only what you need, thus reducing your costs.

CLUB LEVEL RESTAURANT

Cashman Stadium also boasts a full-service, climate-controlled restaurant at the club level, which offers beautiful panoramic views of the baseball complex, scenic mountains and surrounding area. The restaurant is ideal for parties, receptions and corporate meetings, and can accommodate small intimate groups to lavish receptions for 500 guests.

CASHMAN SERVICES

Centerplate

As the exclusive hospitality partner to the Las Vegas Convention Center and Cashman Center, Centerplate is proud to offer full-service catering, pop-up and fixed retail dining, themed to meet the needs of your planners, exhibitors and guests. Centerplate's world-class culinary team and service professionals are here to help you shine. Craft a memorable event with delicious, fun and inviting service and menus. Our catering and event managers specialize in getting it just right. Las Vegas means a wealth of possibilities: show-stopping buffets, elegant banquets, fun cocktail receptions – for breakfast, lunch, dinner or anything in between. Contact us today for a portfolio of events and options.

Our dedicated event professionals are committed to making the time you spend with us more enjoyable and more valuable. Please contact us at 702-943-6888 about your next event.

Cox Business – Advanced Convention Services

Cox Business is the exclusive full-service provider for all data, voice and video services at Cashman Center. Backed by the third largest cable company in the United States, we can customize a solution for all your communication needs.

Cox Business has a full array of products/services that includes some of the following:

- Shared and dedicated high-speed Internet access (up to 10 Gbps)
- Full voice services, including multi-line and Polycom conference phones
- Cable installation for specialized feeds
- Dynamic cable television service, including HD
- Best of class switches, hubs and cabling
- Award-winning, local 24-hour customer support
- 24/7 monitoring by Cox Network Operations Center

For complete details, please contact Cox Business at 855-519-2624 or visit www.tradeshows.coxhn.net.



THEATER

From hit Broadway shows to elaborate corporate presentations, your special event will take center stage when presented in Cashman's elegantly appointed theater facility.

Cashman Theater provides comfortable armchair seating for 1,898 persons (1,344 on the main floor and 554 in the balcony). The theater's facilities include 10 dressing rooms, chorus rooms, wardrobe, production/conference rooms, stage manager's office, ticket box office and a greenroom. All dressing rooms have intercom capability to the stage.



The stage encompasses 3,015 square feet with drapes. The theater includes a fly tower with 40 line sets, stage and audience lighting, stereo sound system house mixer controlled at balcony-level control platform, and Xenon Super Trouper spotlights located in catwalks. To facilitate an easy load in, direct access to the stage is conveniently located in the rear with a 23' high by 20' wide hangar-style freight door (no dock).

Additional technical information available upon request.

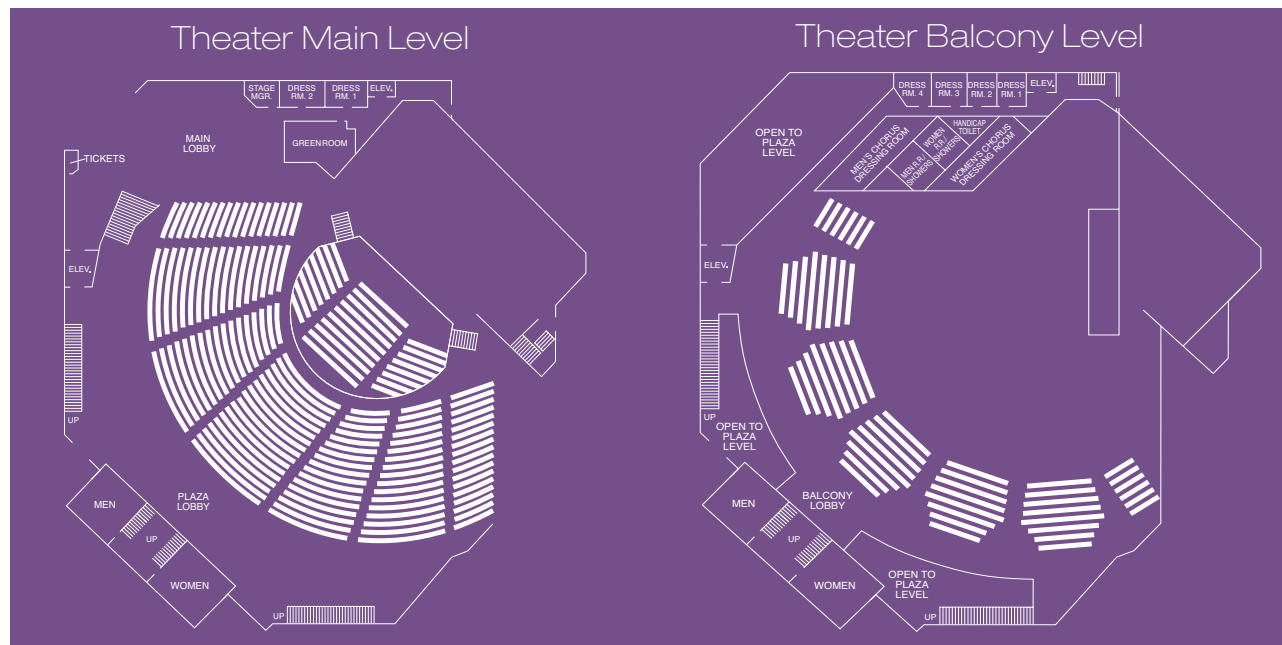

MEETING ROOMS

All meeting rooms are contiguous to the main exhibit hall and can be customized from 1,083 square feet for 60 people to 4,452 square feet for 425 people, or any number of variations in between.

Cashman Center offers more than 14,000 square feet of subdivided meeting space on two levels, with a maximum of eight rooms on level one and six rooms on level two.

There are 10' ceiling heights on the first level and 12' ceiling heights on the second level. There is a phone jack in each meeting room. The rooms also feature six ceiling microphone inputs and remote record room patches.

Level One Meeting Rooms

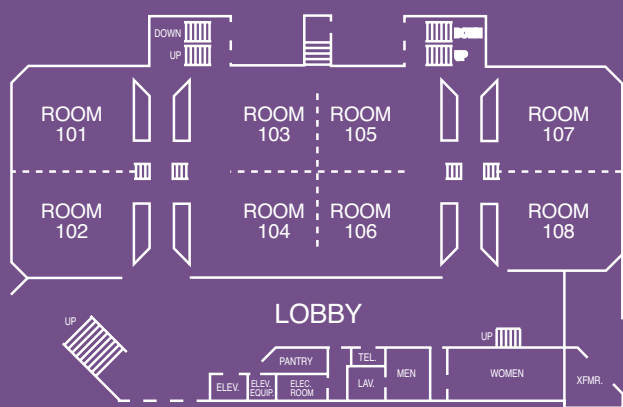

Level Two Meeting Rooms

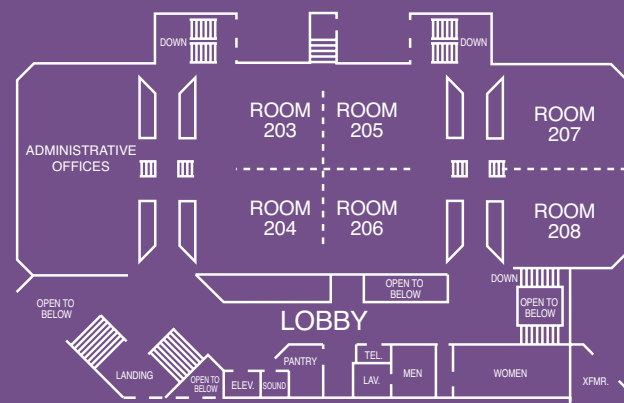

MEETING ROOM SIZE AVAILABILITY

room configurations*	square feet	theater seating	classroom seating	banquet seating
14 Single Rooms	1,083 each	100	60	60
Seven Double Rooms	2,166 each	200	120	150
Two Quadruple Rooms	4,452 each	425	280	300

*Room combinations provide a variety of seating capacities, ranging from 60 to 425 people.

EXHIBIT HALLS

Whether it's a sit-down banquet for 5,500, a trade show for 10,000 or an educational seminar for 150, Cashman Center's highly flexible exhibit halls can be custom-configured to suit your specific meeting requirements.

The two exhibit halls at Cashman Center feature a combined total of 98,100 square feet with ground-level freight entry via two 24' high by 28' wide hangar-style freight doors. Four smaller roll-up doors provide access to the meeting room area, theater lobby, stadium field and northeast exterior. Within the exhibit halls, 65,000 square feet have a ceiling height of 35' while 33,100 square feet have a 25' ceiling height.

Lighting, via overhead metal halide lights, is individually controlled. Electricity and water are located in seven columns and at various locations on the perimeter wall. There is also overhead delivery of electricity to exhibitors throughout the halls in the high-bay area; 480/277-volt single- and three-phase power is available.

The exhibit halls also feature six pedestrian entrances and a concession area. A movable wall equally divides the space into exhibit halls A and B, each with 49,050 square feet. Each exhibit hall has a ticket booth and coatroom.

EXHIBIT HALLS A AND B

square feet	minimum ceiling height	electric roll-up door	hangar door
98,100	2/3 @ 35' 1/3 @ 25'	2 - 7'9" x 30'	2 - 24' x 28' 1 - 24' x 24'

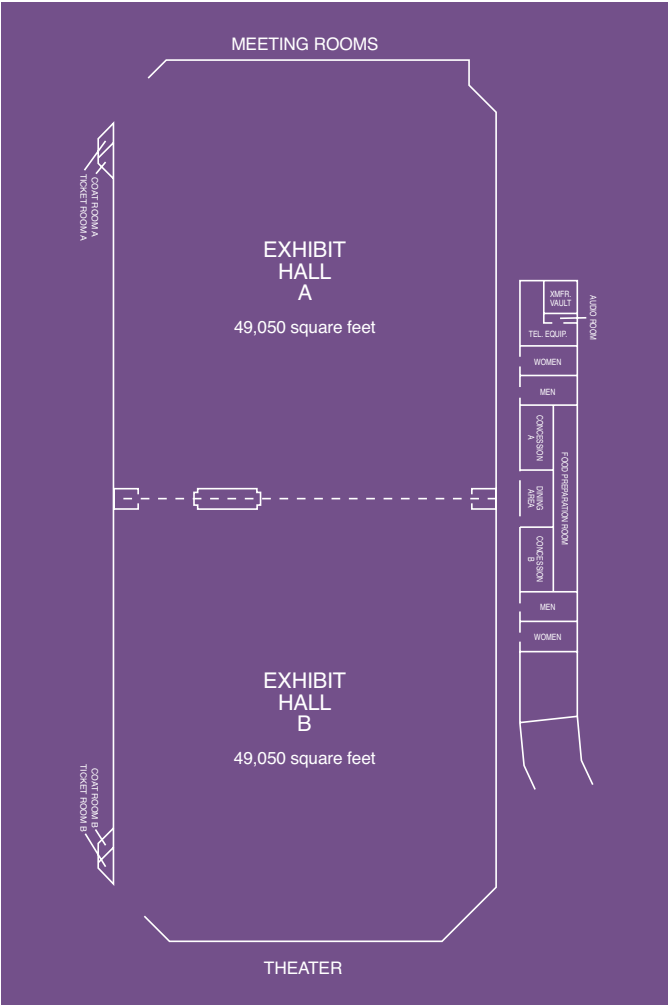

STADIUM

Cashman Stadium, situated on the east side of the exhibit halls and meeting rooms, is an integral component of the Cashman Center facility. It's the home of the Las Vegas 51s, the AAA affiliate of the Toronto Blue Jays' professional baseball team.

Cashman Stadium has a fixed seating capacity of 9,260, with seating options available to accommodate an additional 1,850 attendees. Accessible seating is located along each baseline on the top row of the concourse level. There is an accessible elevator located on the first level behind home plate. The natural-grass field encompasses 148,500 square feet. The right and left field lines are 328 feet, center field is 433 feet, and power alleys are 364 feet.

Other stadium amenities include team locker rooms, two concession areas, portable food and beverage sales areas, animated scoreboard, a media conference room, and direct field access from the adjoining exhibit hall. Power access includes 480/208 volt three-phase at 200 amps at field level.

Situated above the Cashman Center Stadium, the Club Level Restaurant features a beautiful panoramic view of the baseball complex, scenic mountains and the surrounding area. This three-tiered, fully enclosed room offers a dance floor, cassette and CD player, AM/FM tuner, and capacity to broadcast field-level sound. This area is ideal for parties, receptions and corporate meetings, and can accommodate intimate groups to lavish receptions for 500 guests.

Stadium Concourse Level (2nd level)

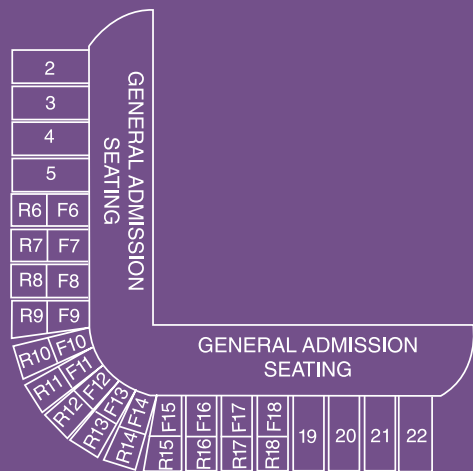

Stadium Club Level (3rd level)

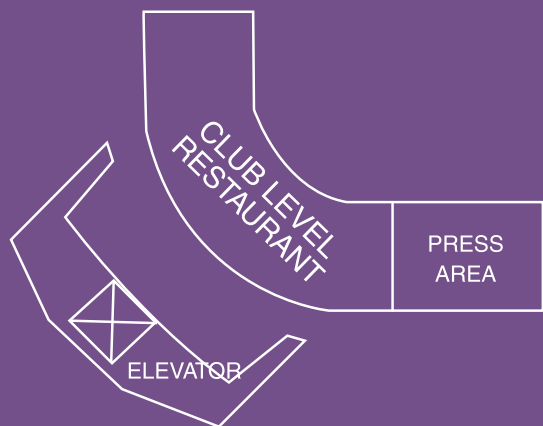

PARKING

Cashman Center can accommodate more than 2,500 cars in four separate, paved parking lots with ample ADA parking. There is convenient parking in front of the building allowing for direct accessibility from the parking lot to the floor.

Parking fees: The fee is \$5 per space with in and out privileges. Please display ticket stubs in view on your dashboard.

Parking space designation:

- White spaces designate general parking permitted with a proper pass or ticket stub.
- Red curbs designate fire lanes and must be kept clear at all times. Vehicles parked in a fire lane will be towed at the owner's expense.

Accessible parking: Accessible parking spaces are provided and are designated as reserved by a sign showing the symbol of accessibility. Van-accessible spaces are available.

CASHMAN PARKING MAP



WE'RE VERY ACCOMMODATING AND AFFORDABLE

Unlike many other facilities, Cashman does not require as much lead time to book events. Cashman's competitive rates also make it one of the nation's most affordable facilities. Best of all, Cashman Center's professional, courteous staff is ready to make even the toughest assignments look easy, with personalized treatment that will leave you smiling. We look forward to showing you all that we can do for you.

THE CENTER OF EXCITEMENT IS JUST AROUND THE CORNER

The best of Las Vegas is within minutes of Cashman Center. What's the vibe? With world-class performing arts at The Smith Center, design and style at World Market Center, a living gallery of street murals by internationally recognized artists, a handful of very Vegas museums, and free outdoor entertainment along Fremont Street Experience, downtown is the cultural centerpiece of Las Vegas. The Fremont East Entertainment District anchors one of the city's most exciting food and beverage districts, where visitors will find many of Las Vegas' hottest restaurants, bars and retail destinations, including Downtown Container Park.

GETTING HERE IS EASY

Both McCarran International Airport and Interstate 15 provide easy access to Las Vegas. Add to this the exceptional location of Cashman Center near two major freeways and you've got a convention complex that's one of the most easily accessible in the country.

