

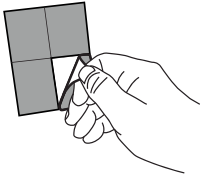

## INSTRUCTIONS

# HOW TO INSTALL TILES

Thank you for your felt right order. We want to ensure you have the best possible installation experience. Before beginning, please take a moment and watch our 3 minute installation video.



### 1. PEEL CORNER

Peel one of the adhesive tabs from the branded liner.

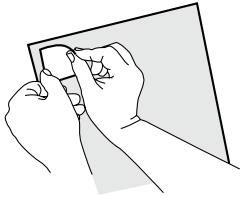

### 2. PLACE AND PRESS

Firmly press and rub the whole tab, including the edges, onto the back side of the tile. Place the tabs according to the **Tab Placement**.



*Ensure the adhesive tabs are firmly pressed and rubbed onto the tile to ensure proper adhesion.*

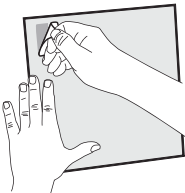

### 3. REMOVE LINER

Remove the backing, leaving the adhesive. If the adhesive removes with the tab as you lift, then press the corner again to re-attach the adhesive to the tile.

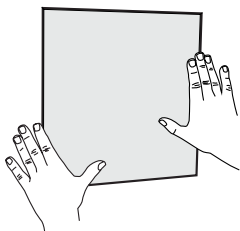

### 4. LINE UP AND PRESS

Using your phone or a level, place the tile against the surface. Apply pressure against the tile for up to 30 seconds for the best results.



### SCAN QR CODE

for 3-minute instructional video.

If you have any questions email:  
[support@feltright.com](mailto:support@feltright.com)

## TAB PLACEMENT

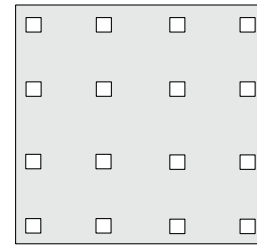

Large Square  
24x24

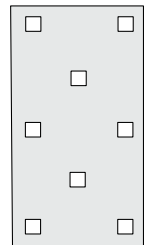

Large Halflap  
24x12

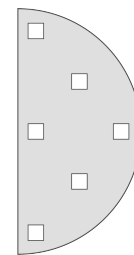

Large Half Circle  
24x12

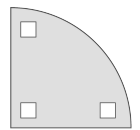

Quarter Circle  
12x12



Shiplap  
24x6

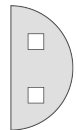

Half Circle  
12x12



Mini Shiplap  
12x3



Half  
12x6

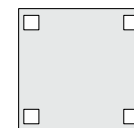

Square  
12x12



Quarter  
6x6



Pixel  
3x3

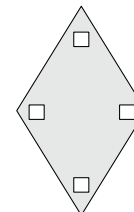

Large Diamond  
21x12

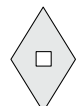

Diamond  
6x10

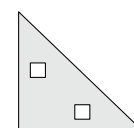

Triangle  
12x12

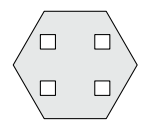

Hex  
10x12



## INSTRUCTIONS

# HOW TO REMOVE TILES

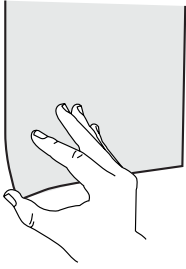

### 1. PULL UP CORNER

Starting with one corner, **SLOWLY** peel the tile from the wall, leaving the adhesive behind. Insert your finger behind the tile and slowly add pressure until the tile releases from one tab.

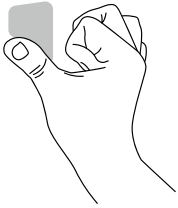

### 2. ROLL OFF ADHESIVE

Starting at the corner, roll your thumb across the adhesive to peel it off the wall.