

THIS COPY IS PROVIDED ON A RESTRICTED BASIS AND IS NOT TO BE USED IN ANY WAY DETRIMENTAL TO THE INTERESTS OF PANDUIT CORP.

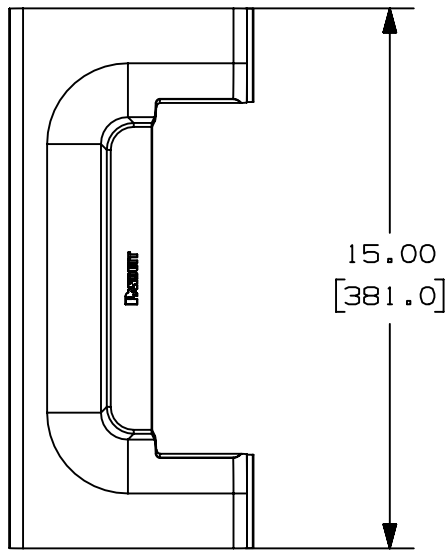

| PANDUIT PART NUMBER | WEIGHT | WEIGHT |
|---------------------|----------------------------|--------|
| FRSPJC46** | 0.5 LB/EACH (227g/EACH) | ABS |
| FRSPJC46L** | 0.5 LB/EACH (227g/EACH) | PC/ABS |



NOTES:

1. SEE CURRENT CATALOG FOR ADDITIONAL PART SUFFIXES TO INDICATE COLOR AND/OR PACKAGE QUANTITY.
2. DIMENSIONS IN PARENTHESES ARE IN METRIC.

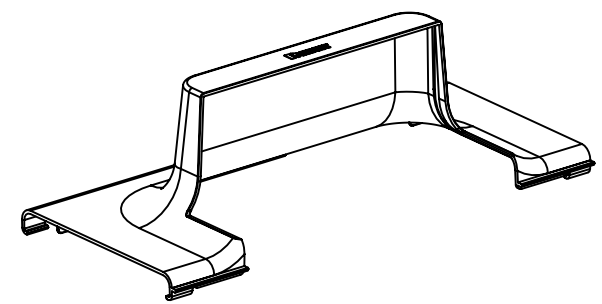
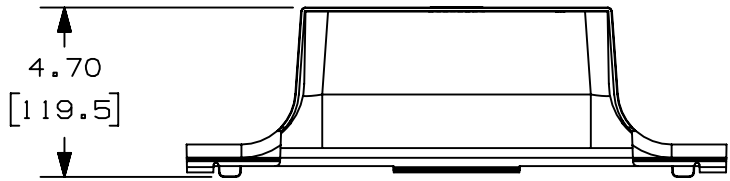
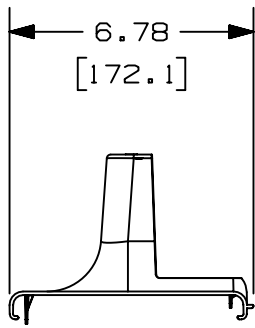

B

B

A

A

ANGLOBAL-ASIZE

| REV | DATE | BY | CHK | APR | DESCRIPTION | ECN |
|-----|----------|-----|-----|-----|----------------------------------|-------------|
| 01A | 01-16-20 | MES | DWR | DWR | A. ADDED FRSPJC46L** PART NUMBER | V09002DZ/01 |

| | | | | | |
|---|-----------------------|------------------------------|----------------------|--|------------------|
| TITLE FIBERRUNNER SPILL-OVER JUNCTION WITH 4x4 EXIT - FIBERRUNNER 6x4 CHANNEL COVER (FRSPJC46**, FRSPJC46L**) | | | | | |
| ITEM REVISION NAME D39851CB/00 | | | | | |
| DATASET FILE NAME D39851CB_DC/01A | | | | | |
| UNLESS OTHERWISE SPECIFIED, DIMENSIONAL TOLERANCES ARE: IN [mm] | | | | | |
| (.X) ± .03 (.XX) ± .03 (.8) | | (.XXX) ± .03 ANGLES ± .03 | | MATERIAL: SEE PART NUMBER TABLE ABOVE | |
| | | | | DRAWING NUMBER: 39851-25 | |
| DRAWN BY MSO | DATE 7-7-09 | CHK EB | SCALE NONE | SHT 1 OF 1 | SIZE A |