

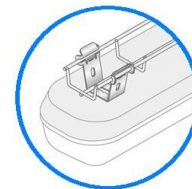

Chemin de câbles fil
(Mesh tray)

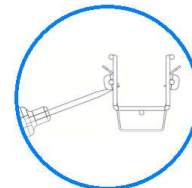

Description	Code	Masse/Weight Kg/p	Ep./Th. mm	 daN
SUL 50 I2	554118	0,070	1,75	40

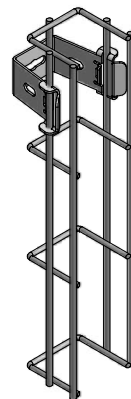

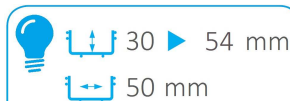
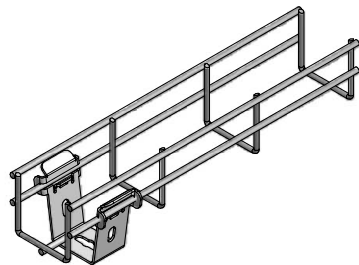
www.niedaxfrance.fr

SS304L : Stainless steel according to NF EN 10088-2 (304L).
I2 : Tôle d'acier inoxydable suivant NF EN 10088-2 (304L).

SUL 50 I2 SUL 50 BRACKET SS304L		CE
ASSISTANCE TECHNIQUE +33 (0)1 55 95 92 17 pole.technique@niedax.fr		NIEDAX France
FT03252		