

## E27 Thermoplastic Lampholders, One-piece

**For incandescent lamps with base E27**

E27 lampholders

Brass-finished versions are available on request.

E27 lampholders, for cover caps

Plain casing

Casing: PET GF, T210

Nominal rating: 4/250

Push-in twin terminals: 0.5–2.5 mm<sup>2</sup>

Fixing holes for screws M4

Weight: 17.4 g, unit: 500 pcs.

Type: 64401

**Ref. No.: 108936** white

**Ref. No.: 500810** black

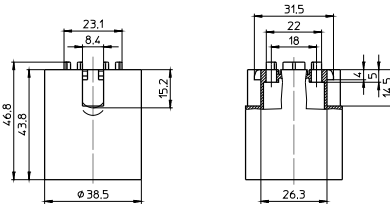

E27 lampholders, for cover caps

External thread 40x2.5 IEC 60399

Casing: PET GF, T210

Nominal rating: 4/250

Push-in twin terminals: 0.5–2.5 mm<sup>2</sup>

Fixing holes for screws M4

Weight: 19.1/18.8 g, unit: 500 pcs.

Type: 64501

**Ref. No.: 108965** white

**Ref. No.: 109429** black

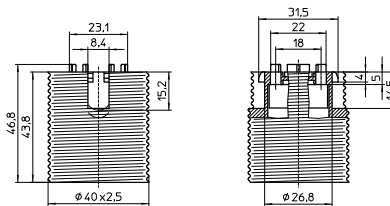

E27 lampholders, for cover caps

External thread 40x2.5 IEC 60399, with flange

Casing: PET GF, T210

Nominal rating: 4/250

Push-in twin terminals: 0.5–2.5 mm<sup>2</sup>

Fixing holes for screws M4

Weight: 21.4 g, unit: 500 pcs.

Type: 64601

**Ref. No.: 501358** white

**Ref. No.: 501356** black

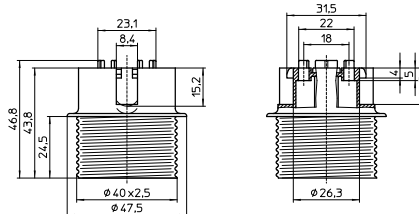

E27 lampholders, for cover caps

Profiled shape, external thread 40x2.5 IEC 60399

Casing: PET GF, T210, nominal rating: 4/250

Push-in twin terminals: 0.5–2.5 mm<sup>2</sup>

Fixing holes for screws M3

Rear fixing holes for self-tapping screws

acc. to ISO 1481/7049-ST3.9-C/F

Weight: 14.8/14.9 g, unit: 500 pcs.

Type: 64719

**Ref. No.: 504303** white

**Ref. No.: 504302** black

