

D fuse-links gG

500 to 690VAC/500VDC

LOW VOLTAGE IEC FUSES

DIN LV FUSE-LINKS D



The D fuse-system is the first generation of screw fuse-system in the German DIN standard. It is still used in many installations.

Applications are low voltage distribution units, where non trained persons are allowed to change the fuse-links.

The D fuse range comprises the sizes NDZ, DII, DIII, DIV, DV.

The range of applications for D fuse-links is the protection of cables and power lines. They limit and cut-off unacceptable overcurrents and short circuit currents up to their nominal breaking capacity. D fuse-links "gG" also protect equipments and installations against dynamic effects of high short circuit currents.

TECHNICAL DATA OVERVIEW

Voltage Range AC	500 ... 690 VAC
Voltage DC	500 VDC
Ampere Range (A)	2 ... 200 A
Speed/Characteristic	gG
I.R. AC (IEC)	50 kA
Product Size	NDZ to DV

FEATURES & BENEFITS

- Insulated body suitable for high mechanical and thermal impacts
- Top and bottom contacts made of nickel plated copper alloy
- Safe cut-off short circuits and over currents due to special design of fuse element
- Clear indication of operation condition due to coloured indicator on top contact
- Low power dissipation
- Optimized size
- Resistant to aging
- Free of lead, cadmium, mercury, chrome 6 (rohs conformity)

APPLICATIONS

- House incoming units
- Meter distribution units
- Distribution cabinets
- Installation cabinets
- Fuse boxes

STANDARDS

- DIN VDE 0636-301



D fuse-links gG

500 to 690VAC/500VDC

PRODUCT RANGE

Size NDZ gG



NDZGG50V16

Catalog number	Item number	Rated voltage AC (IEC)	Rated voltage DC (IEC)	Rated current I _n	Colour	Package	Weight
NDZGG50V2	W212539	500 V	500 V	2 A	pink	25	13.3 g
NDZGG50V4	G213055	500 V	500 V	4 A	brown	25	13.3 g
NDZGG50V6	C213557	500 V	500 V	6 A	green	25	13.3 g
NDZGG50V10	B214062	500 V	500 V	10 A	red	25	13.3 g
NDZGG50V16	J214575	500 V	500 V	16 A	grey	25	13.3 g
NDZGG50V20	Q215087	500 V	500 V	20 A	blue	25	13.3 g
NDZGG50V25	Q215593	500 V	500 V	25 A	yellow	25	13.3 g

Size DII gG



DIIIGG50V6

Catalog number	Item number	Rated voltage AC (IEC)	Rated voltage DC (IEC)	Rated current I _n	Colour	Power dissipation at I _n	Package	Weight
DIIIGG50V2	Z219718	500 V	500 V	2 A	pink	2.1 W	25	26.8 g
DIIIGG50V4	G222163	500 V	500 V	4 A	brown	2 W	25	26.8 g
DIIIGG50V6	B222917	500 V	500 V	6 A	green	1.2 W	25	26.8 g
DIIIGG50V10	K200707	500 V	500 V	10 A	red	1.6 W	25	26.8 g
DIIIGG50V16	K201765	500 V	500 V	16 A	grey	2.4 W	25	26.8 g
DIIIGG50V20	A211508	500 V	500 V	20 A	blue	2.1 W	25	26.8 g
DIIIGG50V25	X212540	500 V	500 V	25 A	yellow	3.5 W	25	26.8 g

Size DIII gG



DIIIIGG50V63

Catalog number	Item number	Rated voltage AC (IEC)	Rated voltage DC (IEC)	Rated current I _n	Colour	Power dissipation at I _n	Package	Weight
DIIIIGG50V32	M229091	500 V	500 V	32 A	black	-	25	51.6 g
DIIIIGG50V35	C214063	500 V	500 V	35 A	black	3.7 W	25	51.6 g
DIIIIGG50V50	K214576	500 V	500 V	50 A	white	5.2 W	25	51.6 g
DIIIIGG50V63	R215088	500 V	500 V	63 A	copper	6 W	25	51.6 g

Size DIII gG 690VAC



DIIIIGG69V2

Catalog number	Item number	Rated voltage AC (IEC)	Rated current I _n	Colour	Power dissipation at I _n	Package	Weight
DIIIIGG69V2	R215594	690 V	2 A	pink	-	25	73.58 g
DIIIIGG69V4	Z216107	690 V	4 A	brown	10 W	25	73.58 g
DIIIIGG69V6	W216610	690 V	6 A	green	12 W	25	73.58 g
DIIIIGG69V10	H217127	690 V	10 A	red	17 W	25	73.58 g
DIIIIGG69V16	N217638	690 V	16 A	grey	14 W	25	73.58 g
DIIIIGG69V20	W218151	690 V	20 A	blue	18 W	25	73.58 g
DIIIIGG69V25	H218668	690 V	25 A	yellow	20 W	25	73.58 g
DIIIIGG69V35	X219187	690 V	35 A	black	23 W	25	73.58 g
DIIIIGG69V50	A219719	690 V	50 A	white	36 W	25	73.58 g
DIIIIGG69V63	H222164	690 V	63 A	copper	55 W	25	73.58 g

D fuse-links gG

500 to 690VAC/500VDC

PRODUCT RANGE

Size DIV gG



DIVGG50V80

Catalog number	Item number	Rated voltage AC (IEC)	Rated voltage DC (IEC)	Rated current I _n	Colour	Power dissipation at I _n	Package	Weight
DIVGG50V80	V216609	500 V	500 V	80 A	silver	7.9 W	10	0.11 kg
DIVGG50V100	M217637	500 V	500 V	100 A	red	8.9 W	10	0.12 kg

Size DV gG



DVGG50V125

Catalog number	Item number	Rated voltage AC (IEC)	Rated voltage DC (IEC)	Rated current I _n	Colour	Power dissipation at I _n	Package	Weight
DVGG50V125	V218150	500 V	500 V	125 A	yellow	10 W	5	0.20 kg
DVGG50V160	G218667	500 V	500 V	160 A	copper	16.5 W	5	0.20 kg
DVGG50V200	W219186	500 V	500 V	200 A	blue	18 W	5	0.20 kg

TIME CURRENT CHARACTERISTIC CURVES

NDZ 2A-50A

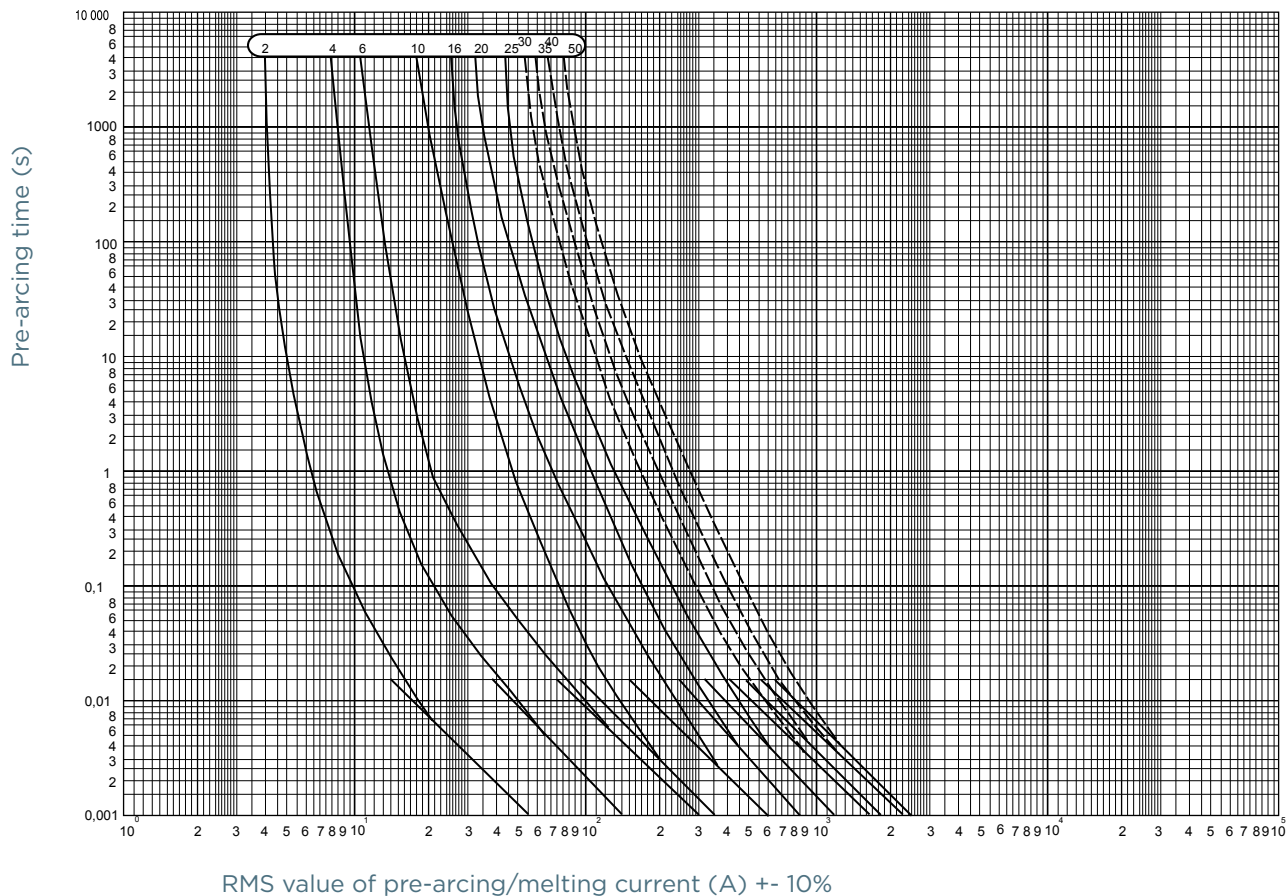

CUT-OFF CURRENT CHARACTERISTIC

NDZ 2A-25A

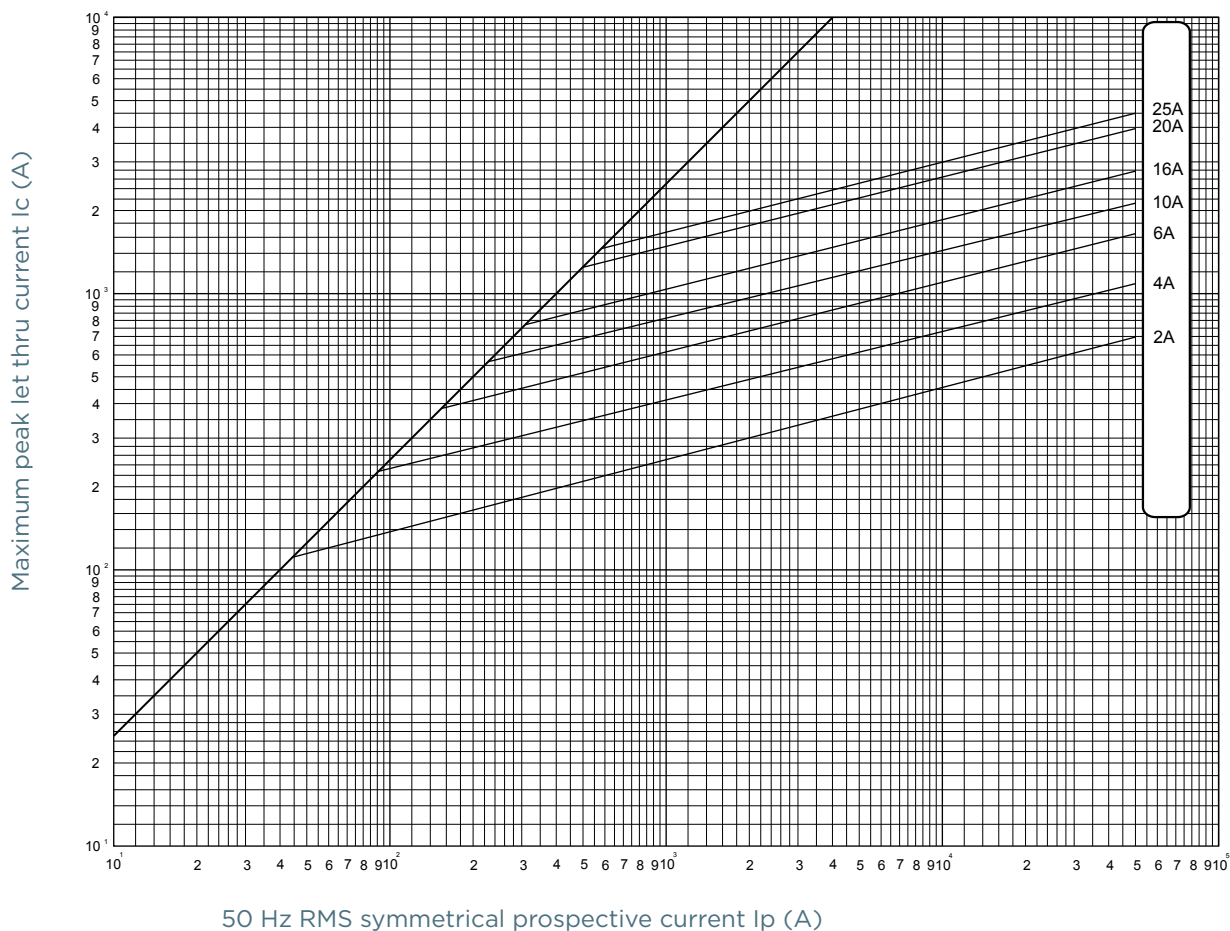

DIMENSIONS

D fuse-links

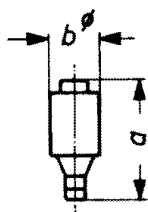

Size	a	bØ
NDZ	50	12
DII	50	22
DIII	50	27
DIV	63	37
DV	63	45

Dimensions in mm