

- Cassette obturatrice
- Afsluitcassette
- Blanking cassette

- Abdeckkassette
- Cassette obturador
- Cassete de obturação

- Κασέτα στεγάνωσης
- Κασετα-ζαγλυσκα
- Cassetta di copertura

- 端口封板
- كاسيت سداة

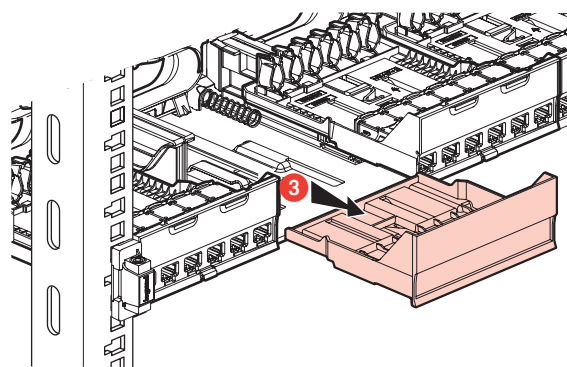
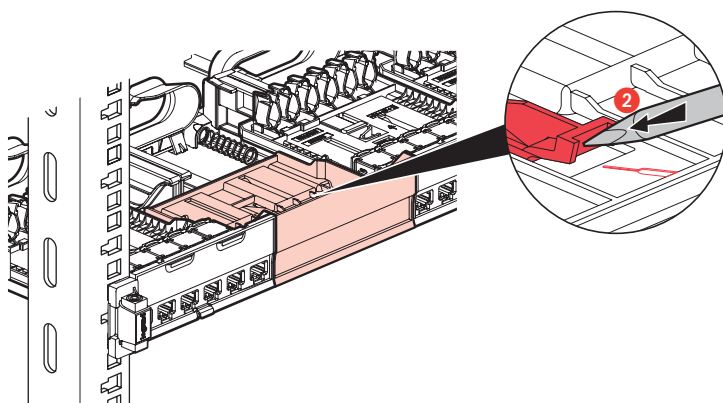
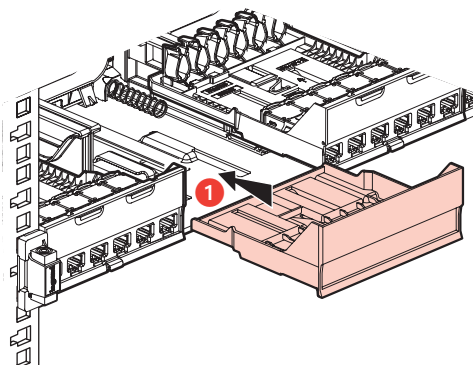

- Obturateur de ports
- Afsluitdop poorten
- Port blanking piece

- Portabdeckung
- Obturador de puertos
- Obturador de portas

- Τάπες θυρών
- Ζαγλυσκα πορτοβ
- Copri porta

- 端口挡片
- سداة المنافذ

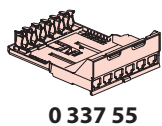

0 337 55

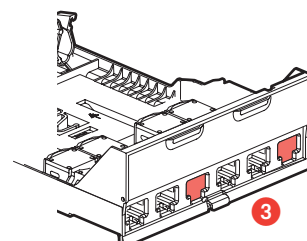
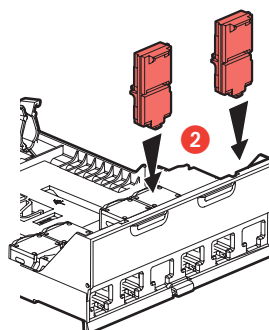
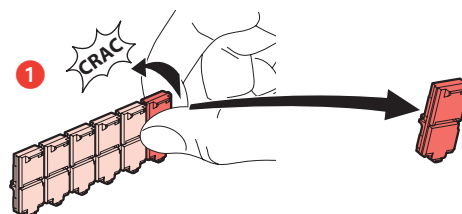
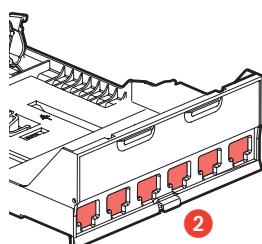
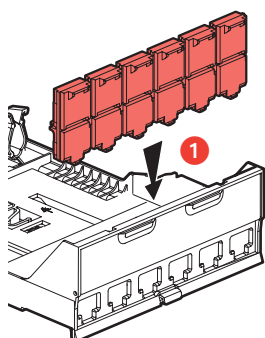

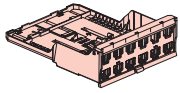

0 337 95

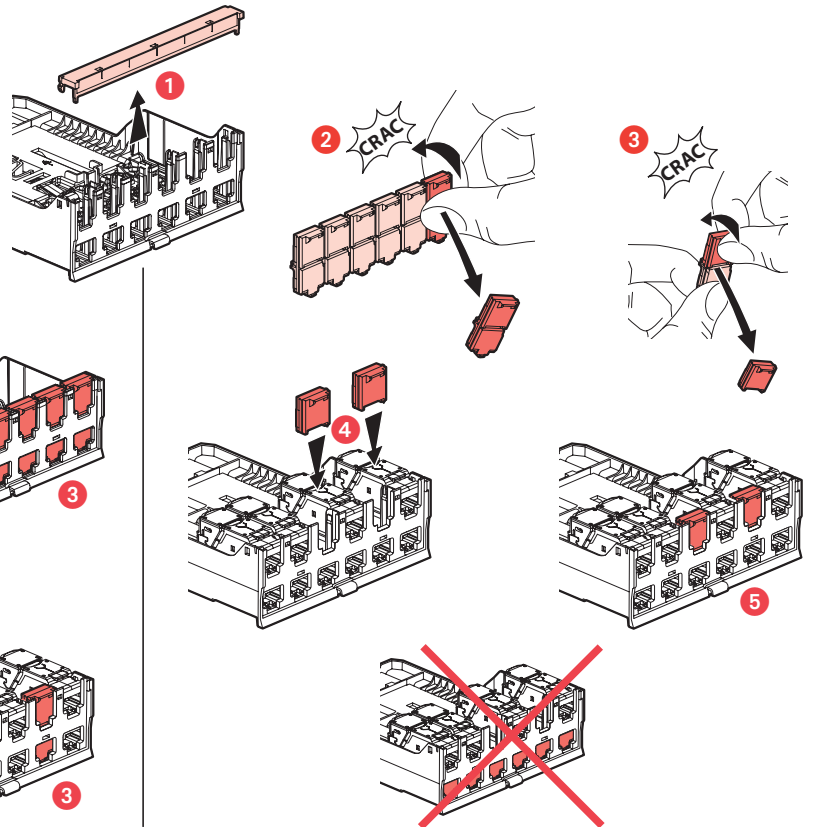
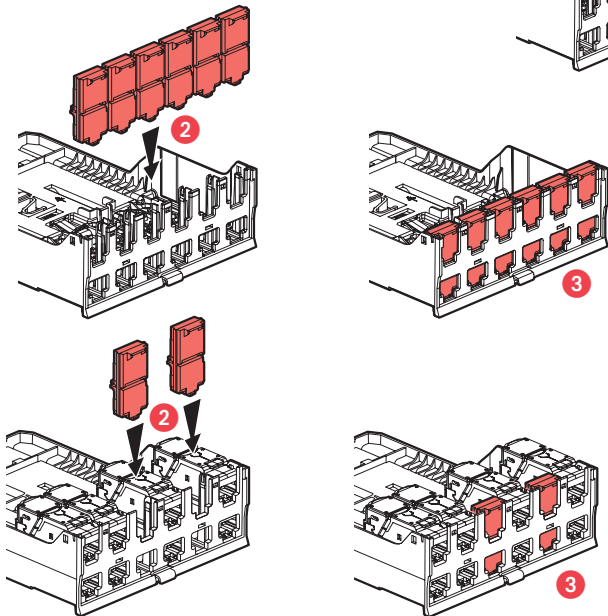

- Accessoire de gestion
- Accessoire voor beheer
- Management accessory

- Verwaltungszubehör
- Accesorio de gestión
- Acessório de gestão

- Αξεσουάρ διαχείρισης
- Вспомогательный аксессуар
- ملحقات الإدارة
- 理线附件
- Accessorio di gestione

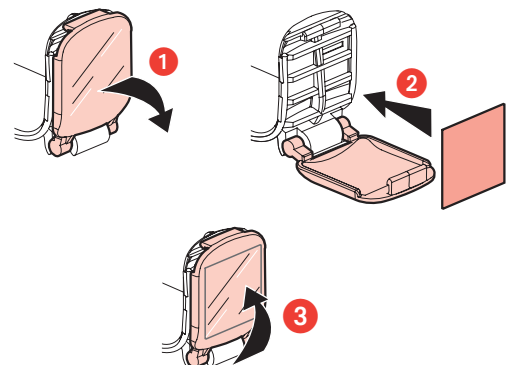
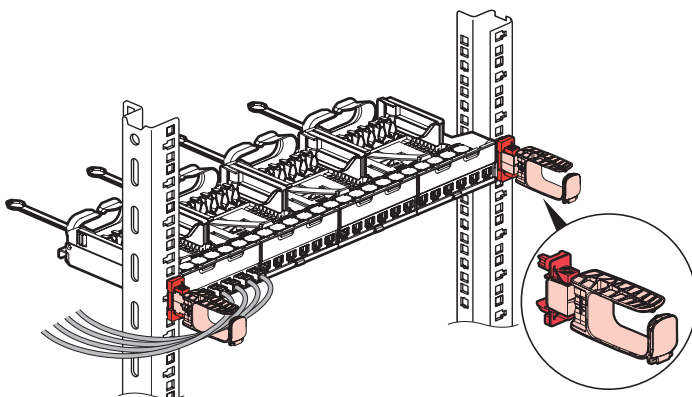
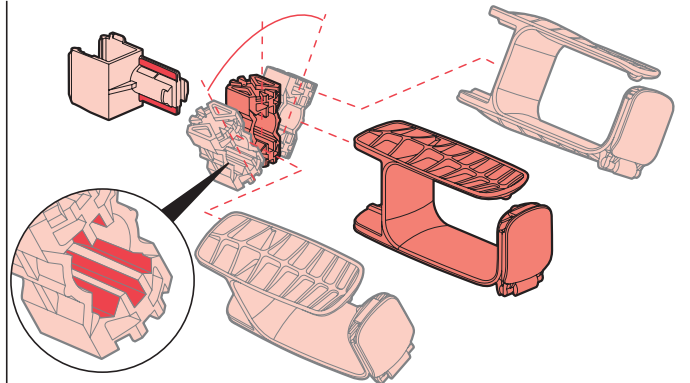
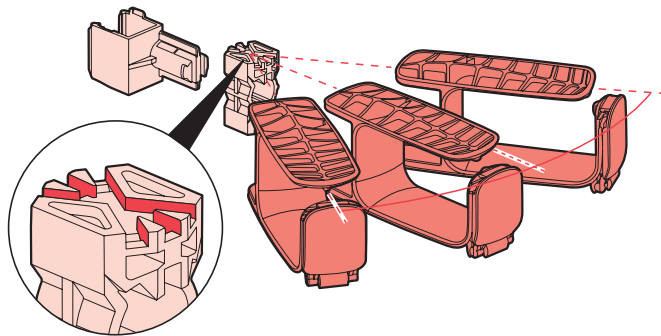

**⚠ Consignes de sécurité** (FR LU BE CH)  
Avant toute intervention, couper le courant.  
Respecter strictement les conditions d'installation et d'utilisation.

**⚠ Veiligheidsvoorschriften** (NL BE)  
Onderbreek voor enige ingreep de stroom.  
Neem de installatie- en gebruiksvoorwaarden nauwgezet in acht.

**⚠ Safety instructions** (GB IE)  
Make sure the power supply is disconnected before any intervention.  
Strictly comply with instructions for installation and use.

**⚠ Sicherheitshinweise** (DE CH)  
Vor jeglichem Eingriff die Spannungsfreiheit sicherstellen.  
Einbau- und Gebrauchsanleitungen sind genau zu beachten.

**⚠ Consignas de seguridad** (ES)  
Antes de realizar cualquier intervención, cortar la corriente eléctrica.  
Respetar estrictamente las condiciones de instalación y uso.

**⚠ Instruções de segurança** (PT)  
Antes de qualquer intervenção, desligar a corrente.  
Respetar rigorosamente as condições de instalação e de utilização.

**⚠ Συστάσεις ασφαλείας** (GR CY)  
Πριν από οποιαδήποτε επέμβαση, διακόψτε την παροχή ρεύματος.  
Να τηρείτε ανστηρά τις συνθήκες εγκατάστασης και χρήσης.

**⚠ Меры предосторожности** (RU)  
Отключить питание перед проведением любых ремонтных работ.  
Строго соблюдайте требования к условиям монтажа и эксплуатации.

**⚠ Istruzioni di sicurezza** (IT CH)  
Prima di qualsiasi intervento, interrompere l'alimentazione.  
Rispettare scrupolosamente le condizioni d'installazione e uso.

**⚠ 安全提示**  
在任何干涉以前一定要断电，严格遵守安全和使用的规定。

إرشادات الأمان:  
«اقطع التيار الكهربائي قبل أي تدخل. تقيماً تقيماً تماماً بملصق التركيب والاستخدام.»