

Unica - Connected Universal Rotary Dimmer LED

Device user guide

Information about features and functionality of the devices

10/2022

Legal Information

The Schneider Electric brand and any trademarks of Schneider Electric SE and its subsidiaries referred to in this guide are the property of Schneider Electric SE or its subsidiaries. All other brands may be trademarks of their respective owners.

This guide and its content are protected under applicable copyright laws and furnished for informational use only. No part of this guide may be reproduced or transmitted in any form or by any means (electronic, mechanical, photocopying, recording, or otherwise), for any purpose, without the prior written permission of Schneider Electric.

Schneider Electric does not grant any right or license for commercial use of the guide or its content, except for a non-exclusive and personal license to consult it on an "as is" basis. Schneider Electric products and equipment should be installed, operated, serviced, and maintained only by qualified personnel.

As standards, specifications, and designs change from time to time, information contained in this guide may be subject to change without notice.

To the extent permitted by applicable law, no responsibility or liability is assumed by Schneider Electric and its subsidiaries for any errors or omissions in the informational content of this material or consequences arising out of or resulting from the use of the information contained herein.

Table of Contents

Safety information	5
Unica - Connected Universal Rotary Dimmer LED	6
For your safety	6
About the device	7
Installing the device	7
Pairing the device	8
Configuring the device	9
Setting the device location	9
Renaming the device	9
Identifying the device	10
Setting RL-LED mode	10
Setting the brightness level	11
Removing the device from Wiser system	11
Resetting the device	12
Using the device	12
Switching/Dimming the device manually	12
Adjusting the brightness level using app	13
Turning On/Off device using app	13
Setting up a schedule	14
Moments	15
Automation	17
LED Indication	22
Troubleshooting	23
Technical Data	24

Safety information

Important information

Read these instructions carefully and look at the equipment to become familiar with the device before trying to install, operate, service, or maintain it. The following special messages may appear throughout this manual or on the equipment to warn of potential hazards or to call attention to information that clarifies or simplifies a procedure.



The addition of either symbol to a “Danger” or “Warning” safety label indicates that an electrical hazard exists which will result in personal injury if the instructions are not followed.



This is the safety alert symbol. It is used to alert you to potential personal injury hazards. Obey all safety messages that accompany this symbol to avoid possible injury or death.

DANGER

DANGER indicates a hazardous situation which, if not avoided, **will result in death or serious injury**.

Failure to follow these instructions will result in death or serious injury.

WARNING

WARNING indicates a hazardous situation which, if not avoided, **could result in death or serious injury**.

CAUTION

CAUTION indicates a hazardous situation which, if not avoided, **could result in minor or moderate injury**.

NOTICE

NOTICE is used to address practices not related to physical injury.

Unica - Connected Universal Rotary Dimmer LED



NU3516xxW

For your safety

⚠ DANGER

HAZARD OF ELECTRIC SHOCK, EXPLOSION, OR ARC FLASH

Safe electrical installation must be carried out only by skilled professionals. Skilled professionals must prove profound knowledge in the following areas:

- Connecting to installation networks.
- Connecting several electrical devices.
- Laying electric cables.
- Safety standards, local wiring rules and regulations.

Failure to follow these instructions will result in death or serious injury.

⚠ DANGER

RISK OF FATAL INJURY FROM ELECTRIC SHOCK

The output may carry electric current even when the load is switched Off.

Disconnect the device from the supply by means of the fuse in the incoming circuit before working on the device.

Failure to follow these instructions will result in death or serious injury.

⚠ CAUTION

THE DEVICE MAY BE DAMAGED

Only connect dimmable load.

Failure to follow these instructions can result in injury or equipment damage.

About the device

The Connected Universal Rotary Dimmer LED (hereinafter referred to as **dimmer**) has a rotary knob that can be used to switch and dim ohmic, inductive or capacitive loads manually or remotely.

Control options

Home control: To control the dimmer through the Wiser app you will need the **Wiser Hub**.

Direct operation: The dimmer can always be controlled directly on-site. You can also connect any number of mechanical push buttons.

Functions

- The device can detect the load automatically
- It provides thermal protection, overload-resistance and short-circuit protection

Installing the device

Refer to the installation instruction supplied with this product.

See [Connected Universal Rotary Dimmer LED](#).

Pairing the device

Using the Wiser Home app, pair your dimmer with the **Wiser Hub** to access and control the dimmer.

Follow the steps to pair the dimmer:

1. On the Home page, tap  icon.
2. Tap **Devices** >  icon and **Lights** > **Rotary Dimmer** > **Next**.

NOTE: The next screen shows the joining process of the dimmer.

3. Remove the knob and short-press the push button 3 times and make sure that the LED blinks amber.

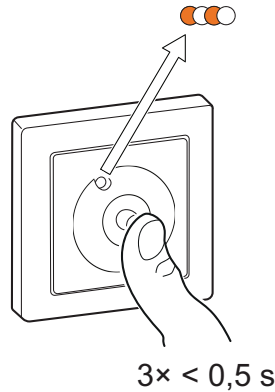

4. Wait for a few seconds until the LED turns green. You can also see in the app that the device is joined.

NOTE: If the LED is blinking green and red, see the instructions by tapping the link **LED blinking green and red?**

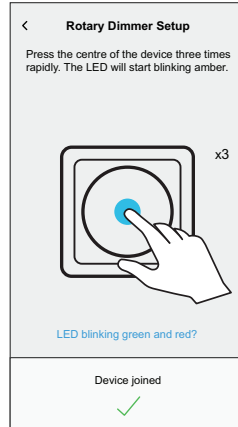

5. Tap **Next** to enter the name of the device and assign the device to a new room or an existing room.

The dimmer is now listed on the Home page under the **All** and **Room** tabs.

Configuring the device

Setting the device location

Using the Wisier Home app, add the dimmer to any room (such as living room, bedroom, kitchen etc).

1. On the Home page, tap  icon.
2. Tap **Devices > Lights > Rotary Dimmer > Location (A)** to assign the dimmer to an existing room or a new room (B) and tap **Submit**.

NOTE: Dimmer is the name given to the device by the user. Any name can be assigned when pairing with the **Wisier Hub**.

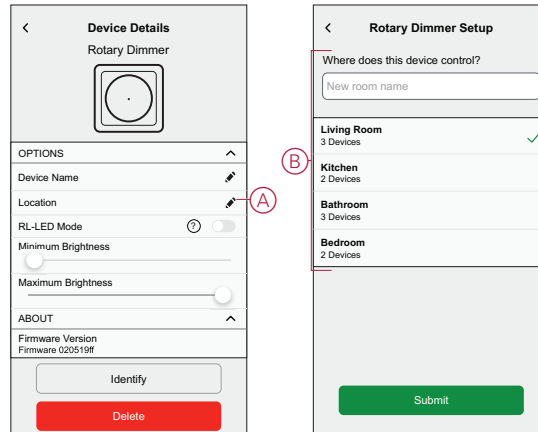

Renaming the device

Rename the dimmer using the Wisier Home app.

1. On the Home page, tap  icon.
2. Tap **Devices > Lights > Rotary Dimmer > Device Name (A)** to rename the dimmer.

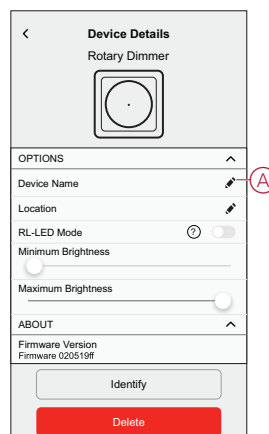

Identifying the device

Using the Wiser Home app, identify the dimmer among the devices available in a home.

1. On the Home page, tap  icon.
2. Tap **Devices > Lights > Rotary Dimmer > Identify (A)**.

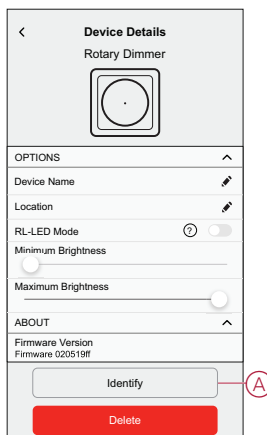

The status LED blinks red and connected lighting devices blinks On/Off, upon successful identification of the dimmer.

3. Tap **OK** to finish identifying the dimmer.

Setting RL-LED mode

You can change the dimming mode in the app if you have problems with light flickering. By changing the dimming mode, the dimming quality is also improved.

1. On the Home page, tap  icon.
2. Tap **Devices > Lights > Rotary Dimmer**.
3. Tap the toggle switch (A) to enable the **RL-LED Mode**.

NOTE: Refer to Technical Data, page 24 for more information.

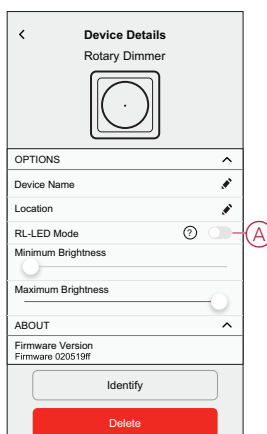

Setting the brightness level

If the dimmer is connected to an LED, the minimum and maximum brightness should be set to avoid flickering and switching off the LED.

1. On the Home page, tap  icon.
2. Tap **Devices > Lights > Rotary Dimmer** .
3. Drag the slider bar to increase or decrease the **Minimum Brightness** and **Maximum Brightness (A)**.

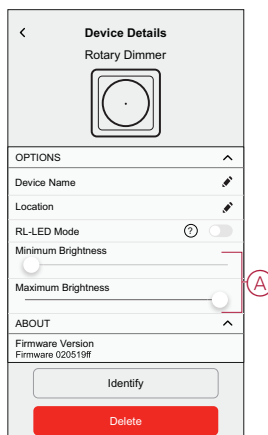

Removing the device from Wiser system

Using the Wiser app, you can remove the dimmer from the system. Follow the steps to remove the dimmer:

1. On the Home page, tap  icon.
2. Tap **Devices > Lights > Rotary Dimmer > Delete (A)**.

NOTE:

- Removing the device will reset the dimmer. After reset the LED turns amber indicating that the dimmer is ready for pairing.
- If there is a problem while pairing or resetting the dimmer, refer to [Resetting the device, page 12](#) .

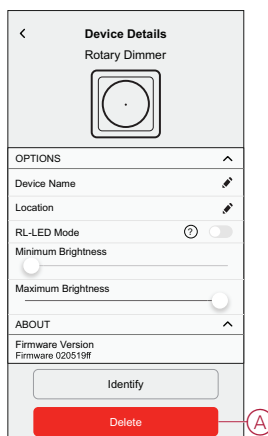

Resetting the device

You can reset the dimmer to factory default manually.

Remove the knob and short-press the push button 3 times (< 0.5 s) and then long-press the push button once (> 10 s).

The LED blinks red after 10 s, and then release the push button.

Upon successful reset, the LED stops blinking. Then, the dimmer restarts and blinks green for a few seconds.

NOTE: After reset, the LED turns amber indicating that it is ready for pairing.

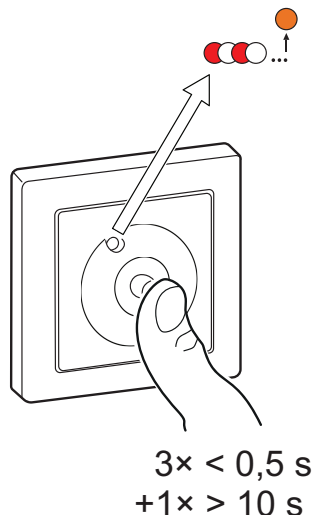

Using the device

Switching/Dimming the device manually

You can manually switch the dimmer on/off and adjust its brightness level. This will provide power to the load connected to it.

To turn on or off the dimmer, short-press the push button ($< 0,5$ s).

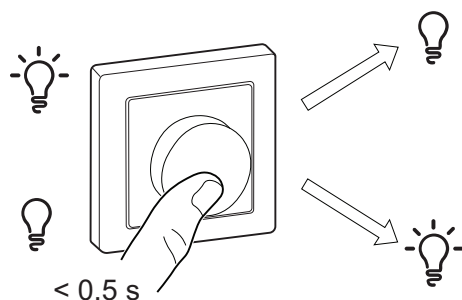

To increase brightness, turn the dimmer knob clockwise, and to decrease brightness, turn it anti-clockwise.

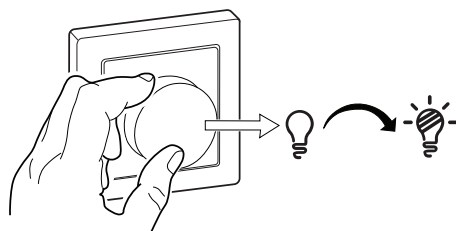

Adjusting the brightness level using app

By using the Wiser Home app, increase/decrease the brightness level in the dimmer.

Follow the steps to increase/decrease the brightness level:

1. Go to the Home page, tap **All** and find the device.
2. On the control panel page, drag the sliding bar up/down to increase/decrease the brightness (A).

TIP: You can also turn On/Off the dimmer on the control panel page, tap  (B) icon to turn On/Off dimmer.

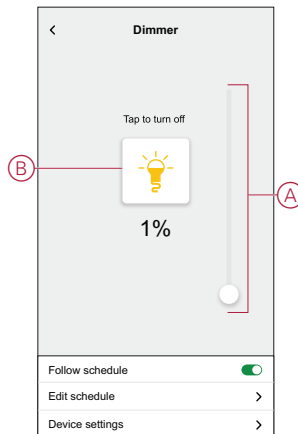

Turning On/Off device using app

Using the Wiser Home app, you can turn On/Off the dimmer remotely.

Follow the steps to turn On/Off the dimmer using the app:

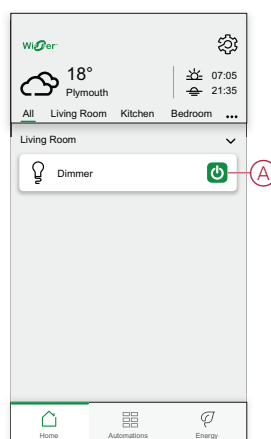

1. Go to the Home page, tap **All** and find the device.
2. Tap  (A) icon to turn On/Off dimmer.



Setting up a schedule

The dimmer can be fully controlled by schedule. Once the schedule is set, the dimmer operates at a given time.

Follow the steps to create a schedule:

1. On the **Home** page, tap  icon.
2. Go to **Schedules** >  icon to create a schedule.
3. Enter the name of the schedule (A).
4. In the **TYPE** menu, select **Lights** (B).
5. In the **APPLIES TO** menu, select **Dimmer** (C) from the listed devices.

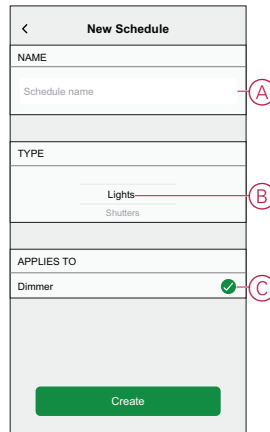

The screenshot shows a mobile application interface for creating a new schedule. The title bar at the top says '< New Schedule'. Below it are three sections: 'NAME' with a text input field labeled 'Schedule name' (marked with a red circle A), 'TYPE' with two radio button options 'Lights' and 'Shutters' (marked with a red circle B), and 'APPLIES TO' with a radio button option 'Dimmer' which has a green checkmark next to it (marked with a red circle C). At the bottom of the form is a green button labeled 'Create'.



6. Tap **Create** to setup events.
7. Tap  icon to add an event such as **STATE** (lights Off or dimming level in %) and **WHEN** (sunrise/sunset or specific time range).
8. Tap **Set** to save the schedule.

Moments

Moment allows you to group multiple actions that are usually performed together. By using the Wiser Home app, you can create moments based on your needs.

Creating a moment

Follow the steps to create a moment:

1. On the **Home** page, tap  icon.
2. Go to **Moments** and then tap  icon to create a moment.
3. Enter the name of the moment (A).
TIP: You can choose the cover image that represents your moment by tapping  icon.
4. Tap **Add actions** (B) to select the list of devices.

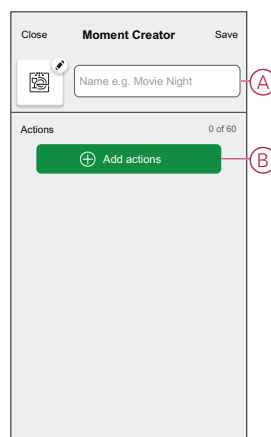

5. In the **Add actions** menu, you can select the devices (C).

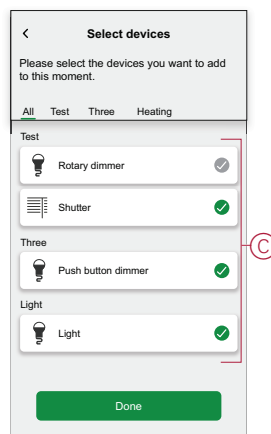

6. Once all the device are selected, tap **Done**.

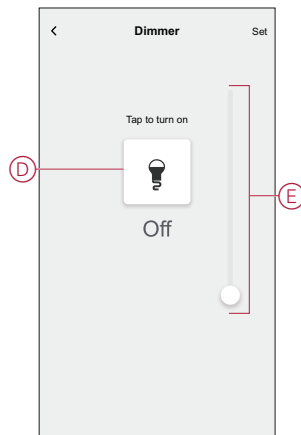

7. On the **Moment creator** page, tap on the device to set the condition:
 - Tap to turn on (D)
 - Drag the sliding bar up/down to increase/decrease the brightness (E) and tap **Set** in the upper right corner.



8. Once all conditions are set, tap **Save**.
Once the moment is saved, it is visible on the **Moments** tab. You can tap on the moment to enable it.

Editing a moment

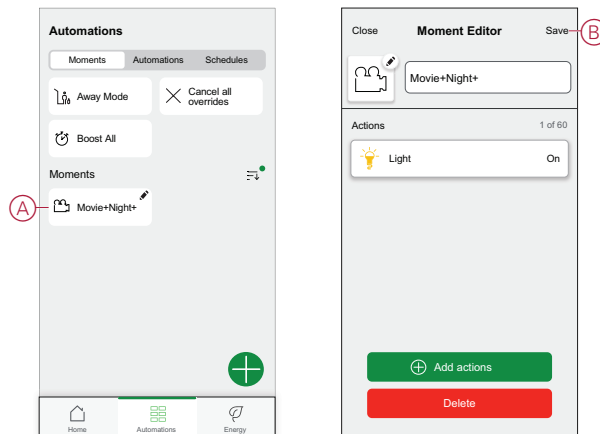

Follow the steps to edit a moment:

1. On the **Home** page, tap  icon.
2. Go to **Moments**, locate the moment you want to edit and tap  (A) icon.
3. On the **Moment Editor** page, you can tap each item to change the settings and tap **Save** (B).



Deleting a moment

Follow the steps to delete a moment:

1. On the **Home** page, tap  icon.
2. Go to **Moments**, locate the moment you want to delete and tap  (A) icon.
3. On the Moment Editor page, tap **Delete** (B) and tap **Ok**.

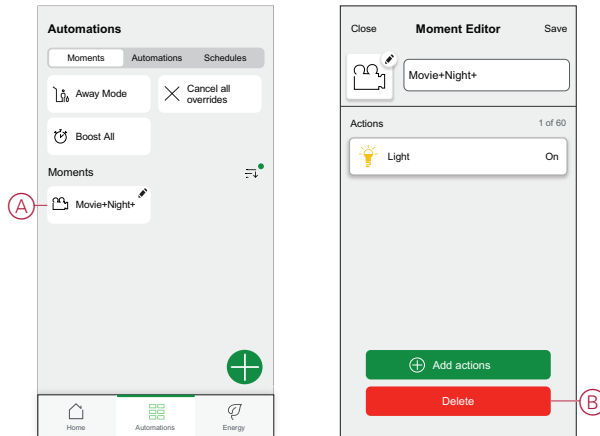



Automation

An automation allows you to group multiple actions that are usually done together, triggered automatically or at scheduled times. By using the Wiser app, you can create automations based on your needs. This example demonstrates how a device works when the condition is met.

Creating an automation

Follow the steps to create an automation:

1. On the **Home** page, tap  icon.
2. Go to **Automation** and then tap  icon to create an automation.
3. Enter the name of the automation (A) .

TIP: You can choose the cover image that represents your automation by tapping  icon.

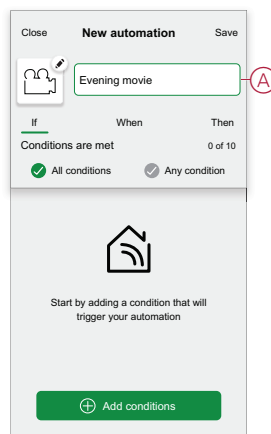

4. Tap **Add a condition** (B).**NOTE:**

- A Condition will be set to trigger an Automation for example when the shutter is opened, or the motion sensor is detecting the movement.
- You can add one condition to an automation; to add another condition, you must create another automation.

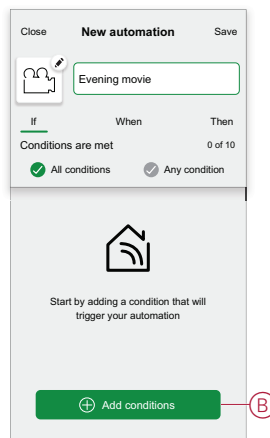

5. Select a device that will set the condition.

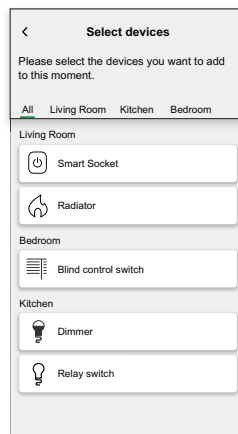

6. Select the state of the device that will trigger the automation, for example relay switch On/Off.

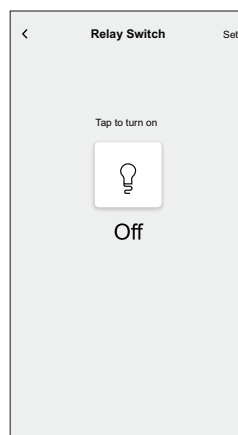
7. Tap **Set** on the upper right corner.

TIP: If you want to change the condition, swipe it to the left and tap the bin icon. Then add a new condition with the required parameters.

8. Tap **Action**> **Add an action**.

NOTE: You can add one action in an automation; to add another action, you must create another automation.

9. Select the type of action:

- **Control a device** - Select the device and set the desired state of the device.
- **Send notification** - You will be notified if the condition is met.
- **Activate a moment** - Select a Moment.

For this example, we will choose **Control a device**.

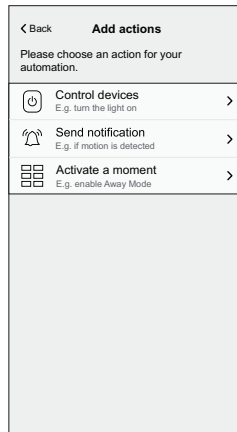

10. Select **Dimmer (D)** as a device that will trigger an action.

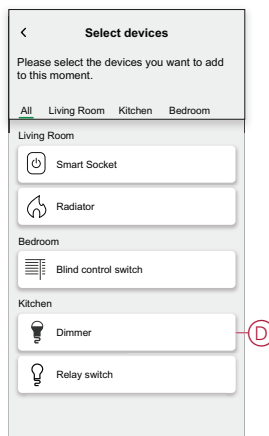

11. Set the state, for example increase/decrease the dimmer brightness or turning On/Off the dimmer. Then tap **Set** on the upper right corner.

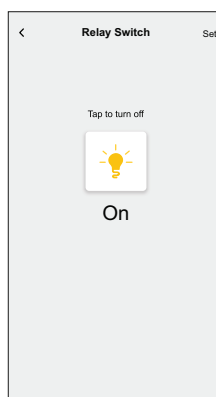

OR

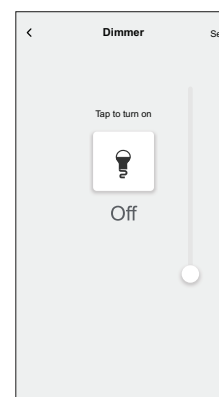

12. Tap **Save**. The saved Automation is displayed on the **Automation** page. Tap the toggle switch (E) on the Automation page to enable/disable the Automation.

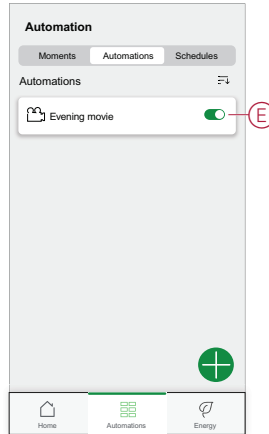

Editing an automation

Follow the steps to edit an automation:

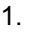
1. On the **Home** page, tap  icon.
2. Go to **Automation**, tap the automation you want to edit (A).

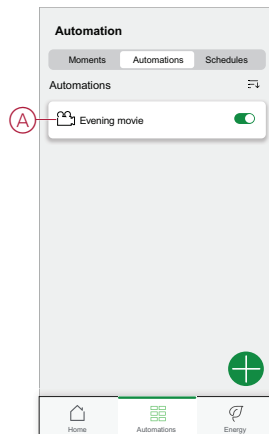

3. On the **Edit automation** page, you can:
 - Change the icon.
 - Rename the automation.
 - Change the condition or action.

4. Remove the Condition or Action by swiping it to the left and tapping the **bin** icon (B).

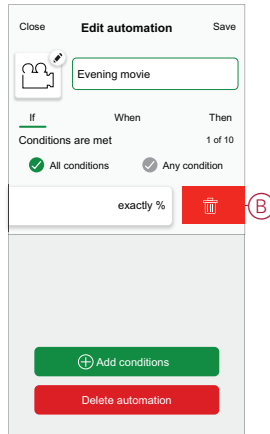

5. Add a new condition or action and then tap **Save**.

Deleting an automation

Follow the steps to delete an automation:

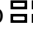
1. On the **Home** page, tap  icon.
2. Go to **Automation**, tap the automation you want to delete (A).

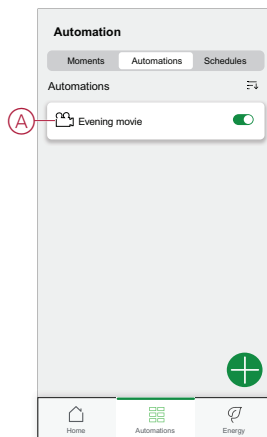

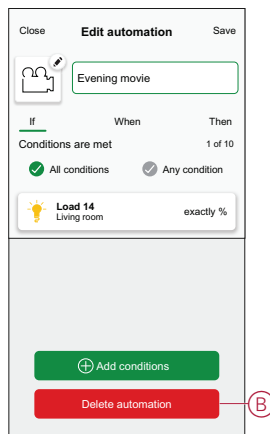

3. On the Edit automation page, tap **Delete Automation** (B) and tap **Ok**.





LED Indication

Pairing

User Action	LED Indication	Status
Press the push button 3 times	LED blinks amber per second. 	Pairing mode is active for 30 seconds. When pairing is completed, LED glows green for some time before turning Off. 

Resetting

User Action	LED Indication	Status
Press the push button 3 times and hold it down once for > 10 s.	After 10 s, the LED blinks red. 	The device is in reset mode. It is reset to the factory settings after 10 seconds. The device then restarts and the LED blinks green for a few seconds and then stays amber. 

Identifying the device

LED Indication	Status
The LED blinks red. 	The connected lighting devices blinks On/Off, upon successful identification of the dimmer

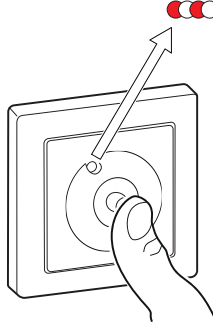

Different connectivity mode

LED Indication	Status
The LED blinks green and red while paring. 	The device is trying to connect to other connectivity mode. Short-press the push button 3 times and then hold for 20 seconds. When the LED blinks red rapidly, release the push button.  $3 \times < 0,5 \text{ s}$ $+1 \times > 20 \text{ s}$

Troubleshooting

Symptom	Solution
Dimming up not possible.	<ul style="list-style-type: none"> Reduce/increase load. Allow the Dimmer to cool in case of overheating. Change the load (if the load is incompatible with the Dimmer).
Switching On not possible.	<ul style="list-style-type: none"> Allow the Dimmer to cool in case of overheating. Reduce load. Change load. Check wiring between the push button and the Dimmer.
Flickering at minimum brightness.	<ul style="list-style-type: none"> Increase minimum brightness (if flickering still persists, install a 31LCDA load correction device). Change the load (if the minimum brightness is insufficient). Set to RL LED mode.
Flickering	<ul style="list-style-type: none"> Change load. Set to RL LED mode. Change the brightness settings.
Only slight dimming capability	<ul style="list-style-type: none"> Change dimming range. Set to RL LED mode. Change the load (if the load is incompatible with the Dimmer).
The device is not ready to pair after the device is removed from the app.	Reset to factory default settings, refer to Resetting the device , page 12.

Technical Data

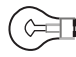
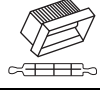
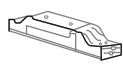
Nominal voltage	AC 230 V ~, 50 Hz		
Nominal power	Load type	Load name	Load value
	 LED	LED	7–100 VA ◀ RC 7–20 VA ◀ RL
		Iron core transformer	14–150 VA ◀ RL
		Incandescent lamp	14–200 W ◀ R
		Halogen lamp	14–150 W ◀ R
		Electronic step-down converter	14–150 VA ◀ RC
Standby	Max 0.4 W		
Neutral conductor	Not required		
Connecting Terminals	Screw terminals for max. 2 x 2.5 mm ² , 0.5 Nm		
Extension unit	Single Push-button, unlimited number, max. 50 m		
Fuse protection	16 A circuit breaker		
Operating frequency	2405 - 2480 MHz		
Max. radio-frequency power transmitted	< 10 mW		
Communication protocol	Zigbee 3.0 certified		

Compliance

Compliance information for Green Premium products

Find and download comprehensive information about Green Premium products, including RoHS compliance and REACH declarations as well as Product Environmental Profile (PEP) and End-of-Life instructions (EOLI).

General information about Green Premium products

Click the link below to read about Schneider Electric's Green Premium product strategy.

<https://www.schneider-electric.com/en/work/support/green-premium/>

Find compliance information for a Green Premium product

Click the link below to search for a product's compliance information (RoHS, REACH, PEP and EOLI).

NOTE: You will need the product reference number or product range to perform the search.

<https://www.reach.schneider-electric.com/CheckProduct.aspx?cskey=ot7n66yt63o1xblflyfj>

Trademarks

This guide makes reference to system and brand names that are trademarks of their relevant owners.

- Zigbee® is a registered trademark of the Connectivity Standards Alliance.
- Apple® and App Store® are brand names or registered trademarks of Apple Inc.
- Google Play™ Store and Android™ are brand names or registered trademarks of Google Inc.
- Wi-Fi® is a registered trademark of Wi-Fi Alliance®.
- Wiser™ is a trademark and the property of Schneider Electric, its subsidiaries and affiliated companies.

Other brands and registered trademarks are the property of their respective owners.

Schneider Electric
35 rue Joseph Monier
92500 Rueil Malmaison
France

+ 33 (0) 1 41 29 70 00

www.se.com

As standards, specifications, and design change from time to time,
please ask for confirmation of the information given in this publication.

© 2022 – Schneider Electric. All rights reserved.

DUG_Unica Rotary Dimmer_WH-01