

THIS COPY IS PROVIDED ON A RESTRICTED BASIS AND IS NOT TO BE USED IN ANY WAY DETRIMENTAL TO THE INTERESTS OF PANDUIT CORP.

NOTES:

1. VISIT OUR ON-LINE CATALOG AT WWW.PANDUIT.COM FOR A LIST OF CURRENT PARTS APPLICABLE FOR USE WITH THIS PRODUCT.
2. DIMENSIONS IN [] ARE METRIC
3. PART INCLUDES:
 - 1- 24-PORT SHIELDED 1 RU PATCH PANEL ASSEMBLY INCLUDES FRONT FACE AND INNER JACK MOUNT ASSEMBED. ALSO INCLUDES 4-PAPER LABELS AND 4 CLEAR PLASTIC PROTECTORS ASSEMBLED.
 - 1- PATCH PANEL SUPPORT BAR
 - 1- 18AWG GROUND WIRE ASSEMBLY, OVERALL LENGTH 15.75" [40cm]
 - 25 CABLE TIES, OVER ALL LENGTH 3.18" [81mm]
 - 1- M3-0.5 X 5mm GROUND SCREW
 - 4- MOUNTING SCREWS
 - 4- MOUNTING NUTS
 - 4- MOUNTING WASHERS
4. WEIGHT: 1.19 LBS/PCS [542grams/PCS]
5. ALL MATERIAL AND COMPONENTS USED MEET THE MATERIAL RESTRICTIONS OF RoHS (EUROPEAN DIRECTIVE 2011/65/EU ON THE RESTRICTION OF HAZARDOUS SUBSTANCES) AS PROPOSED BY THE RoHS TECHNICAL ADAPATION COMMITTEE.

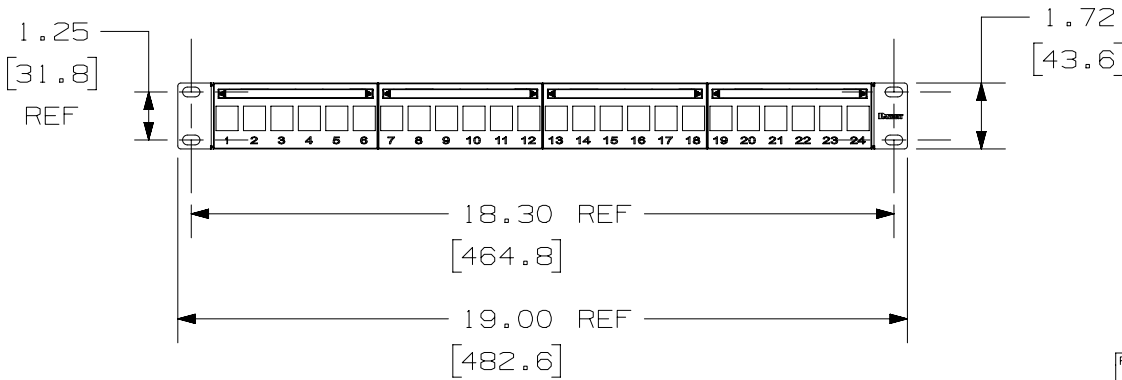
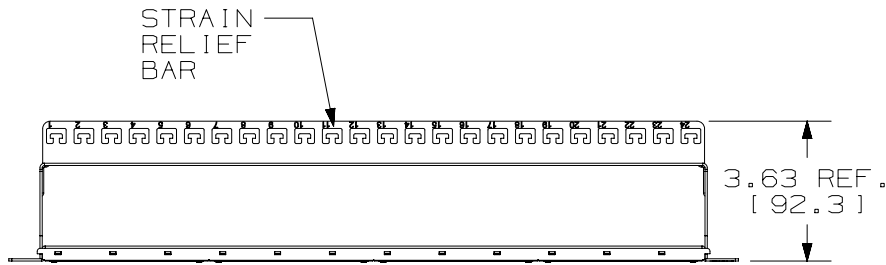

PART NUMBER		KP24WSBL		
TITLE		24 PORT SHIELDED KEYSTONE 1RU PATCH PANEL W/ STRAIN RELIEF BAR		
CUSTOMER DRAWING				
ITEM REVISION NAME		00326EAB/02		
DATASET FILE NAME		00326EAB_DC/02C		
MATERIAL		SEE NOTE 3		
DRAWING NUMBER		00326EAB-DC		
DRAWN BY		DATE	CHK	SCALE
BJN		9-14-18	DCS	1:5
SHEET 1 OF 1		A		

REV	DATE	BY	CHK	APR	DESCRIPTION	ECN
02C	9-28-18	BJN	DCS	DCS	UPDATED	00326EAB-DC
02B	9-20-18	BJN	DCS	RWI	UPDATED	00326EAB-DC
02A	9-14-18	BJN	DCS	RWI	RELEASED TO PRODUCTION	00326EAB-DC

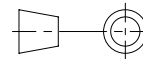

THIRD ANGLE
PROJECTION

A-SIZE CUSTOMER