

HWY231H

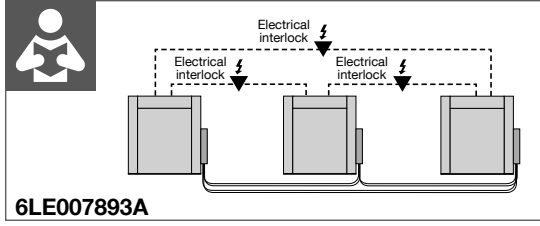
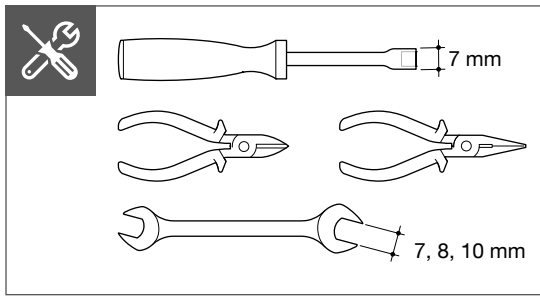

DO
3P-4P

OPEN

TEST

do

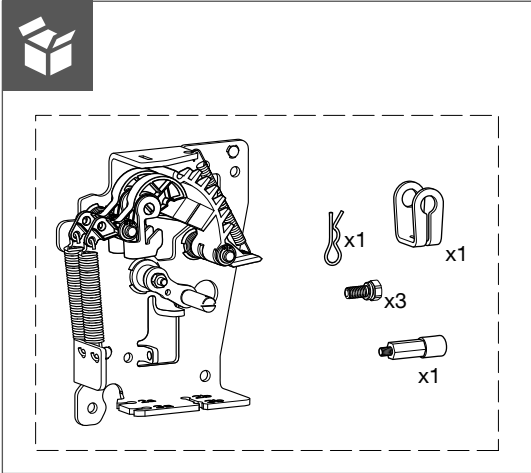

3C:3x

		1,5 m : HWY218H
		3 m : HWY228H
		5 m : HWY229H

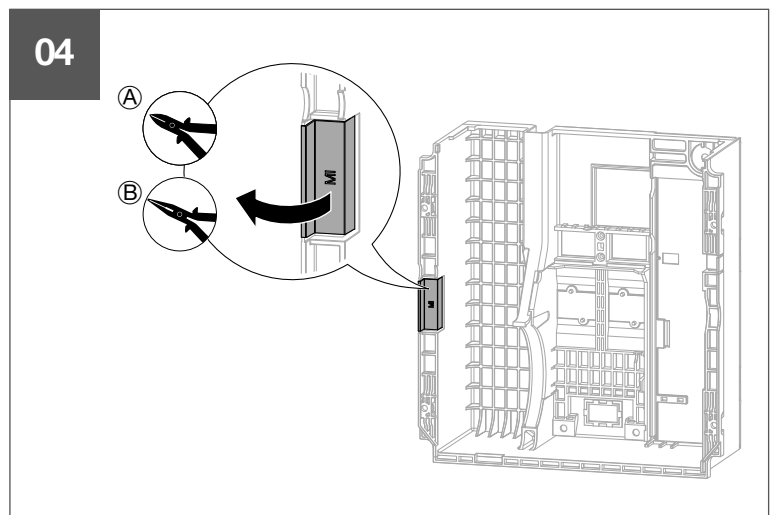
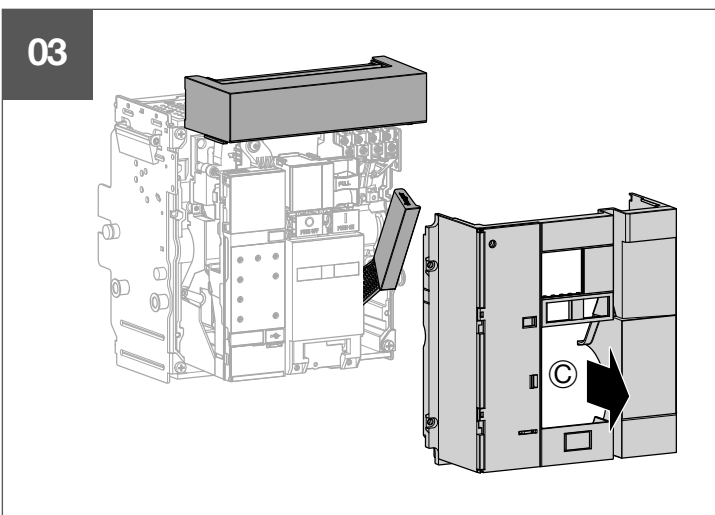
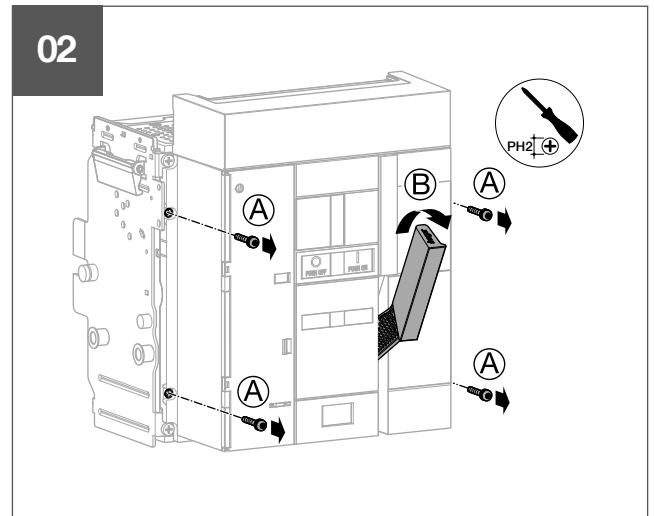
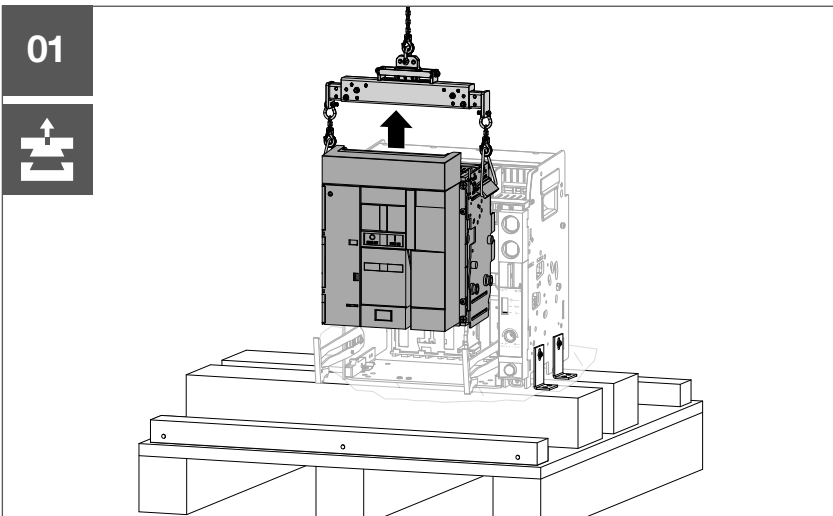

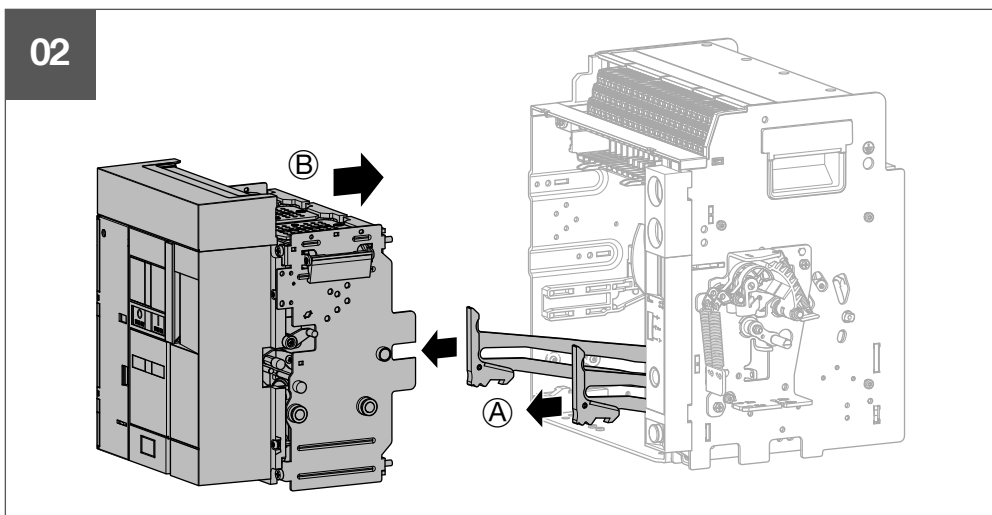
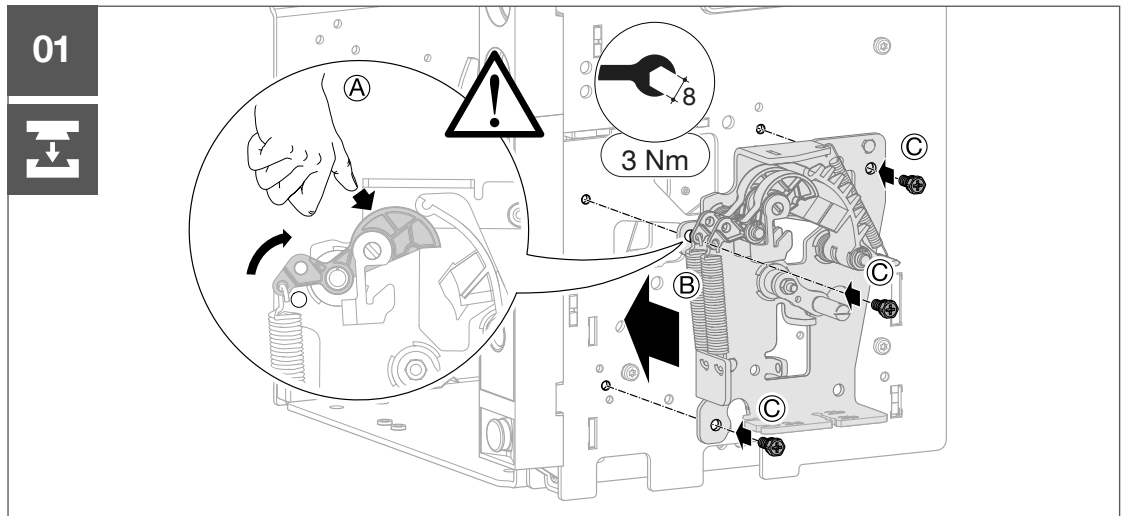
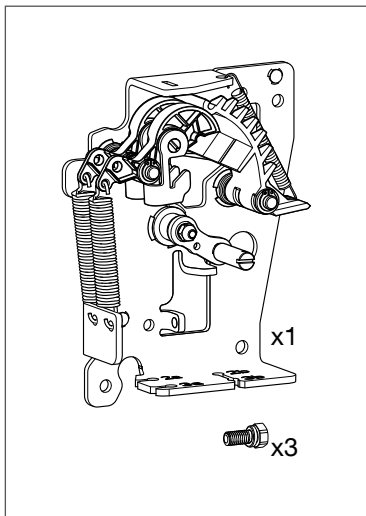
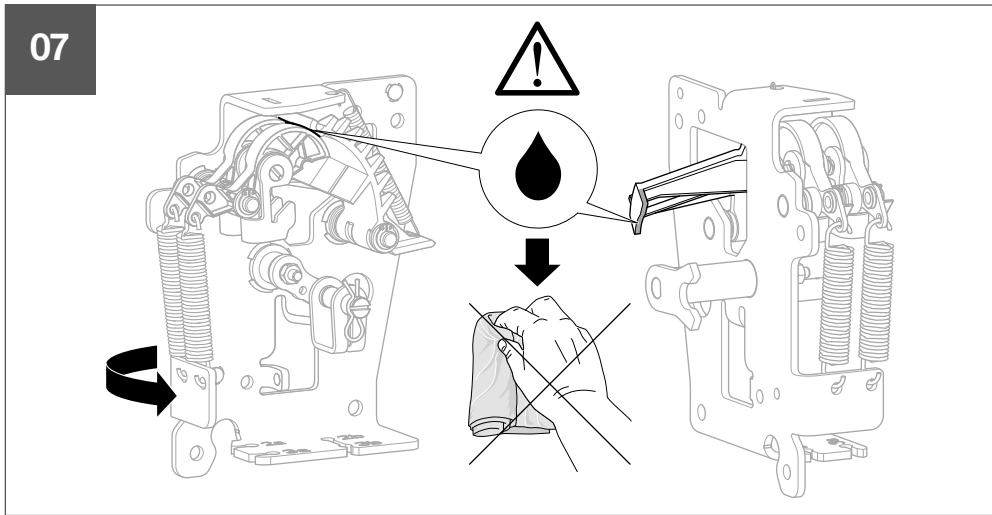
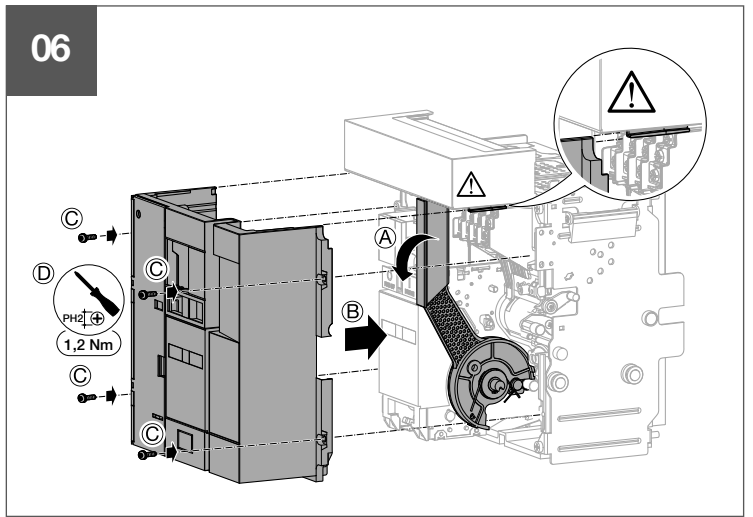
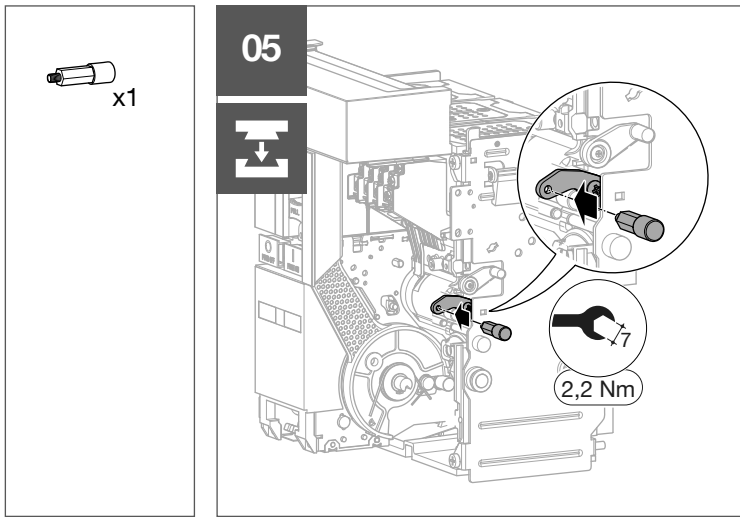

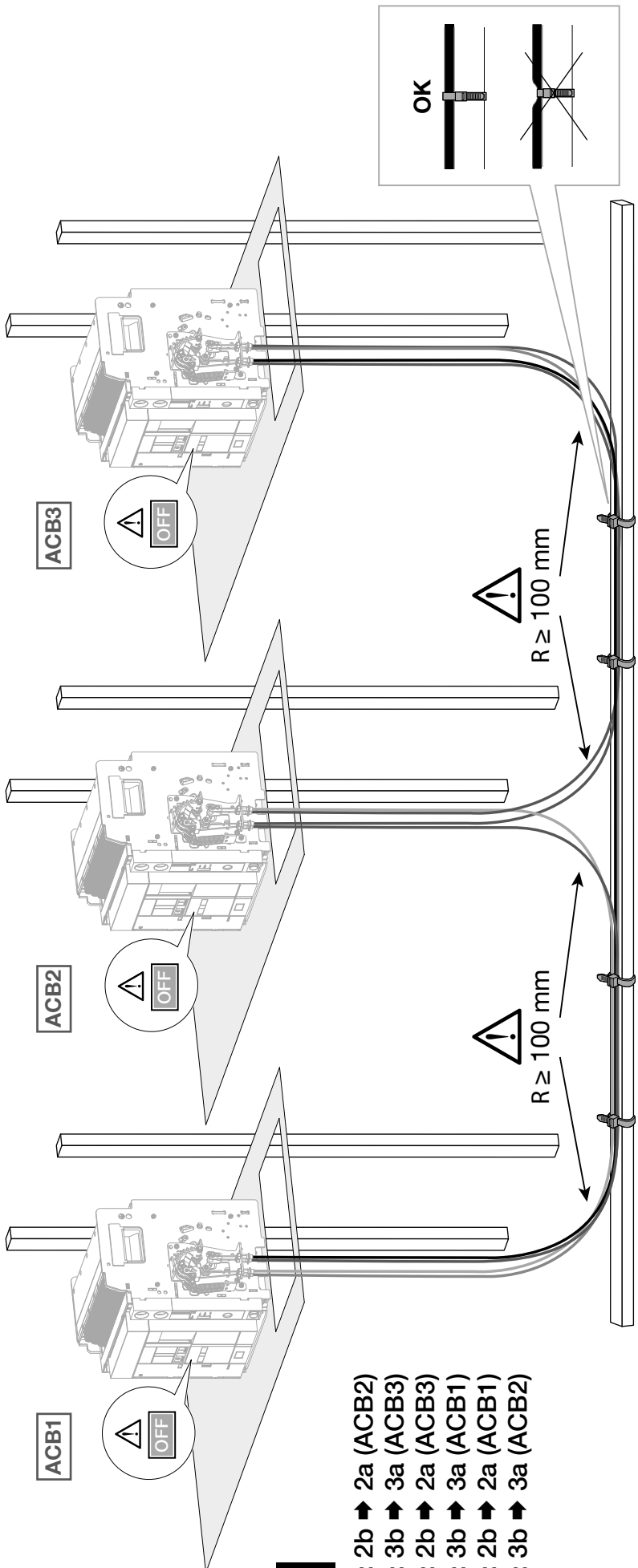

3C

- ACB1 : 2b ➔ 2a (ACB2)
- ACB1 : 3b ➔ 3a (ACB3)
- ACB2 : 2b ➔ 2a (ACB3)
- ACB2 : 3b ➔ 3a (ACB1)
- ACB3 : 2b ➔ 2a (ACB1)
- ACB3 : 3b ➔ 3a (ACB2)

Warning !
 After adjustment, if the cable management is changed, the setting must be redone.

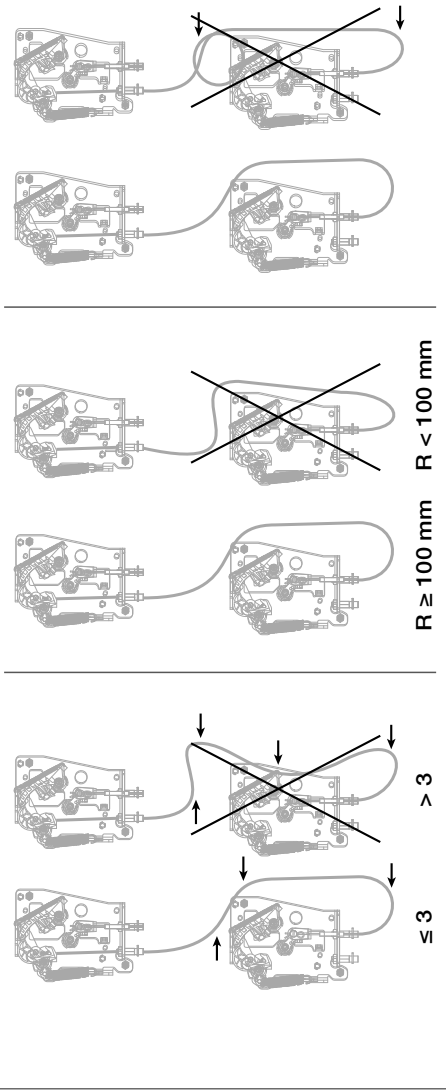
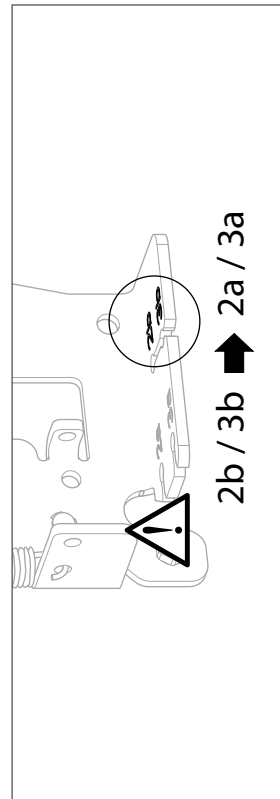

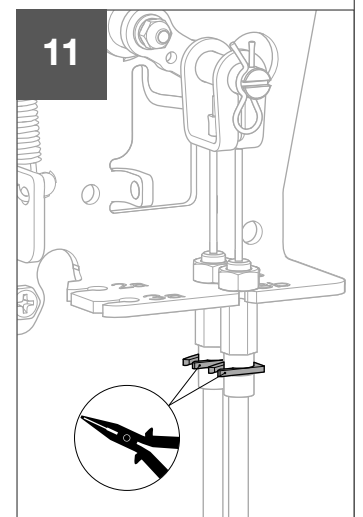
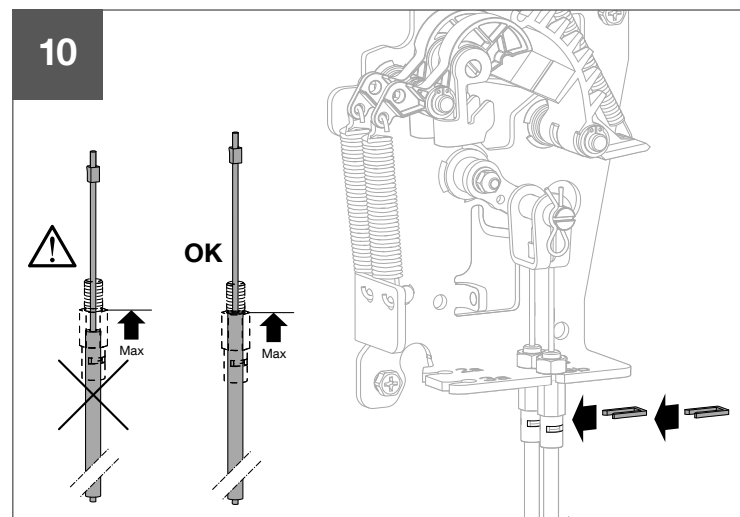
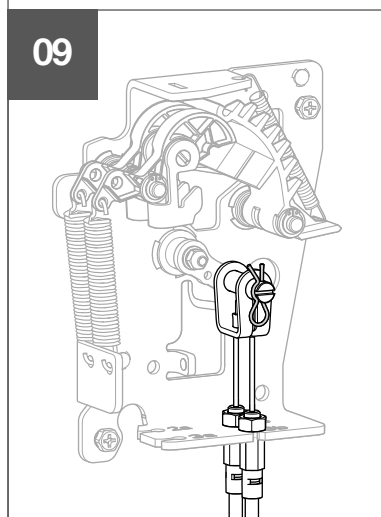
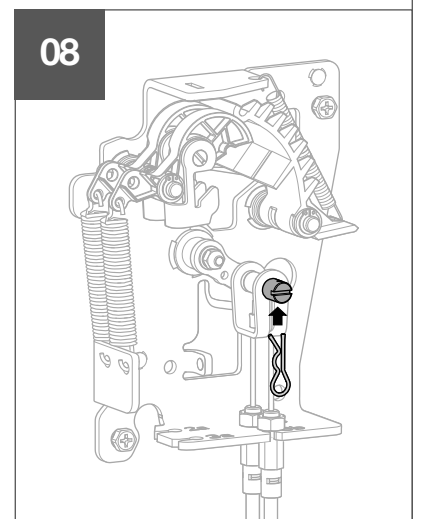
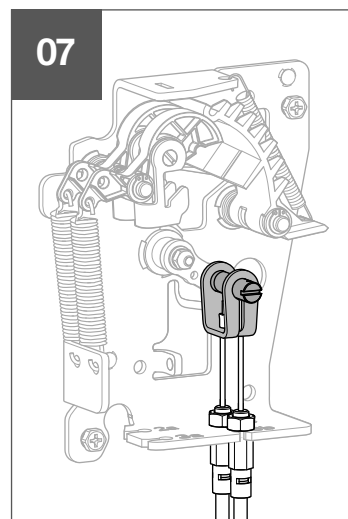
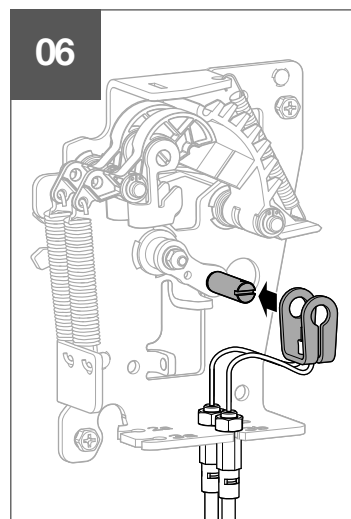
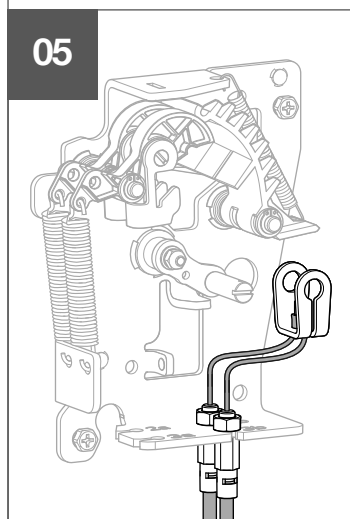
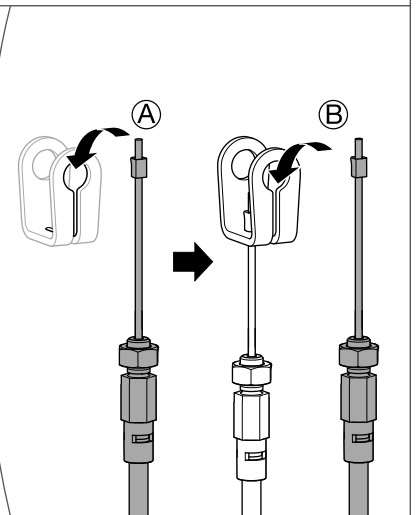
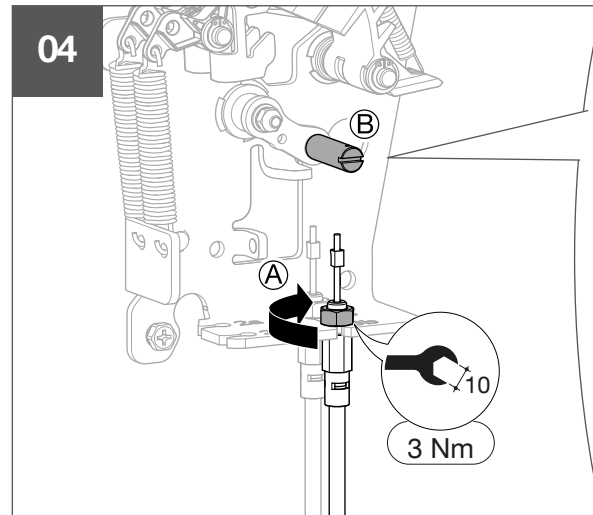
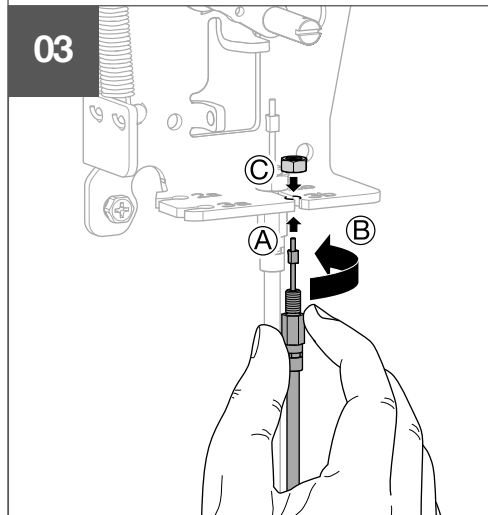
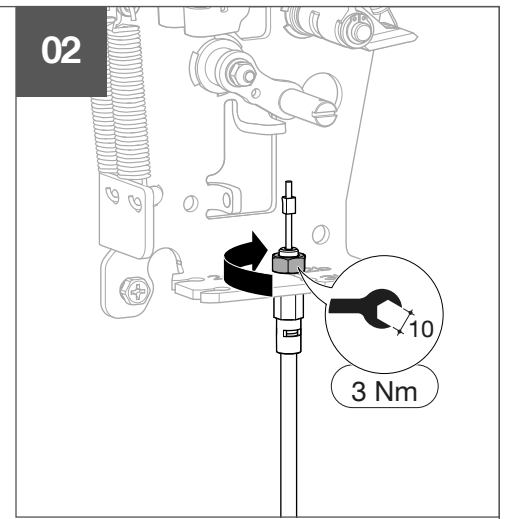
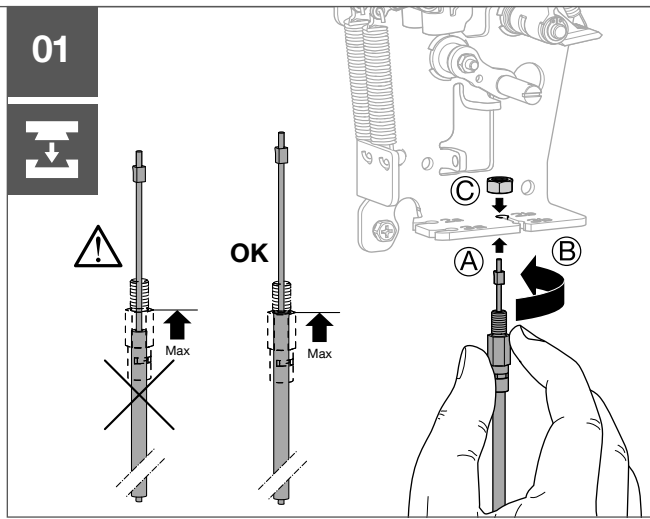
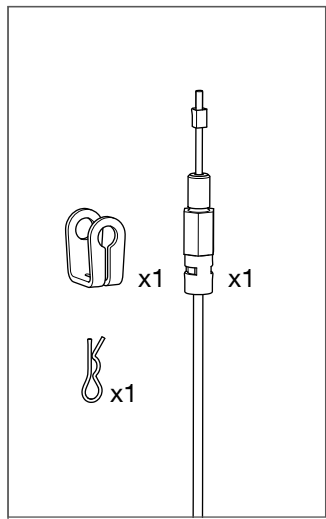

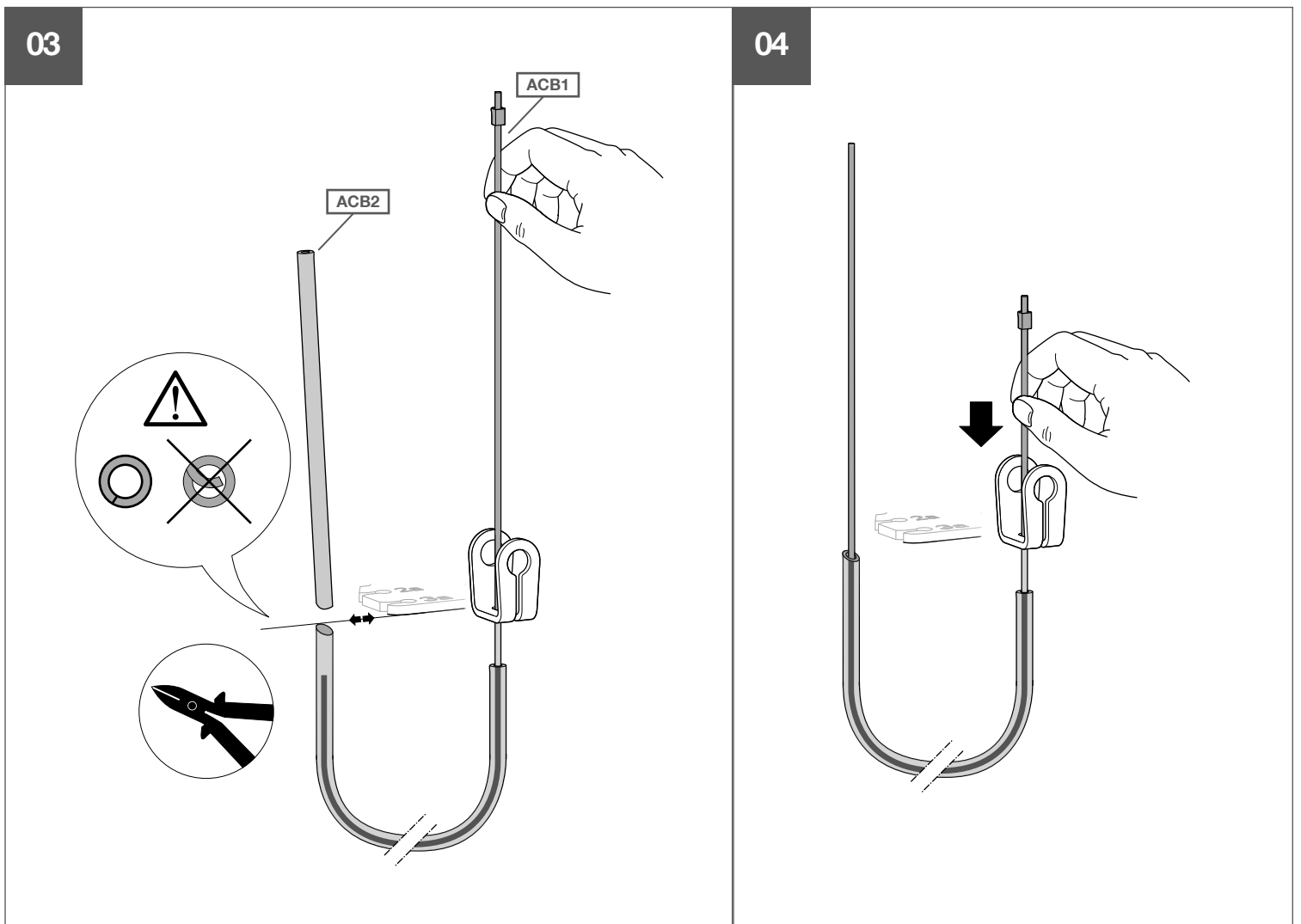
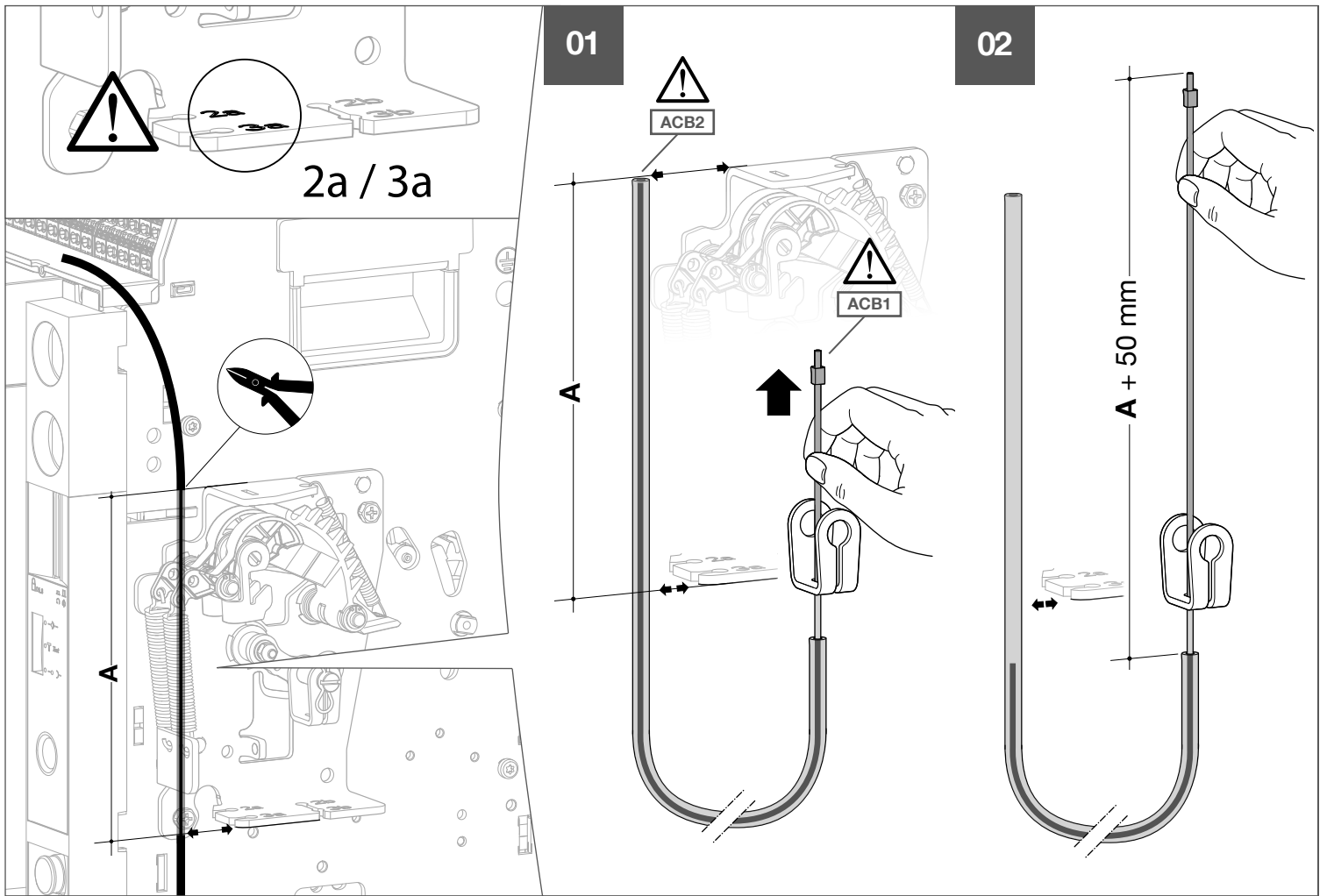

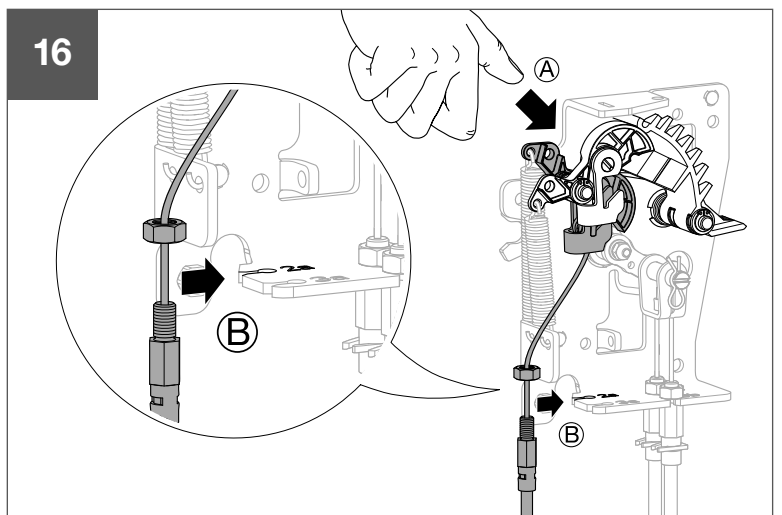
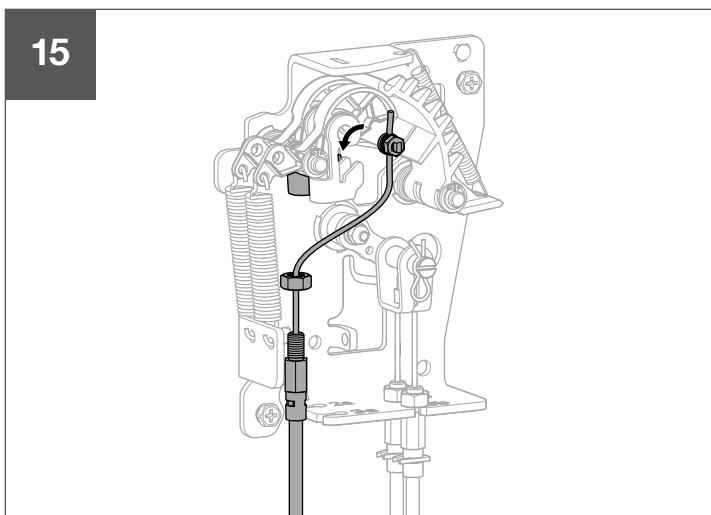
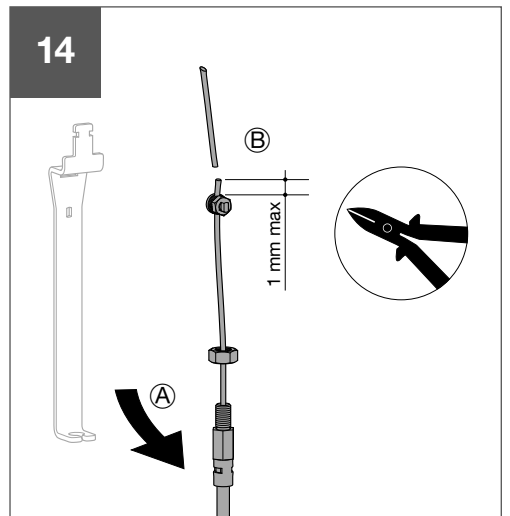
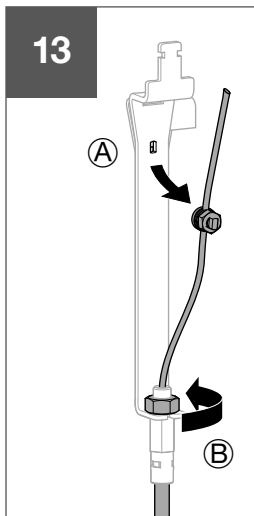
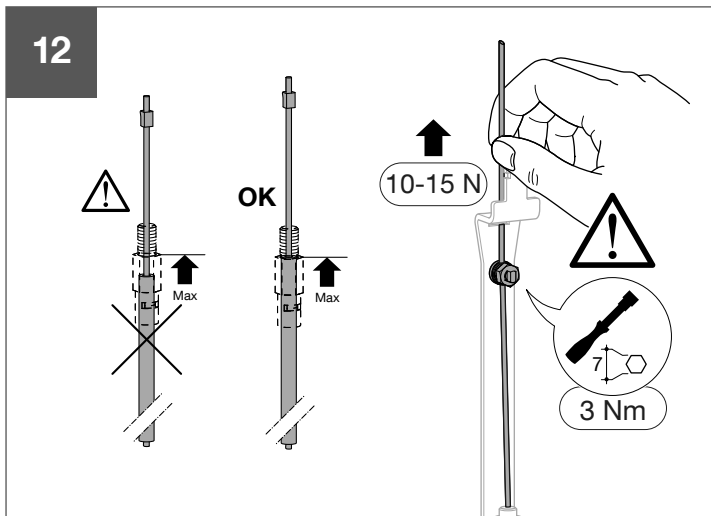
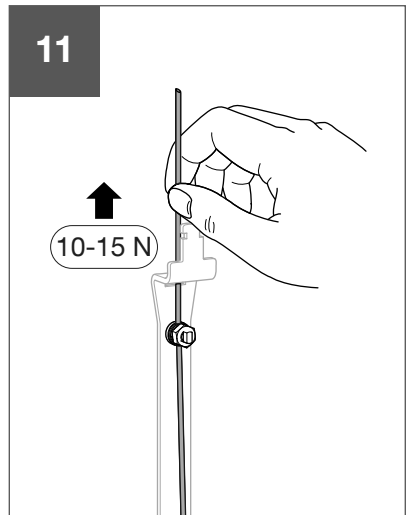
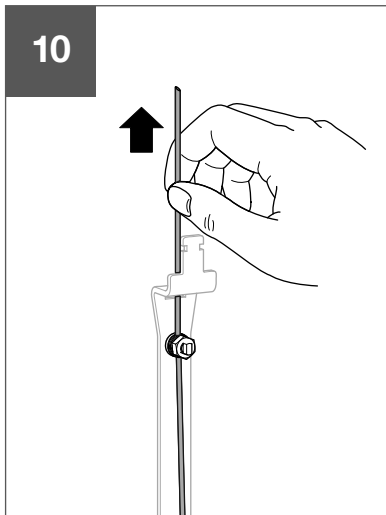
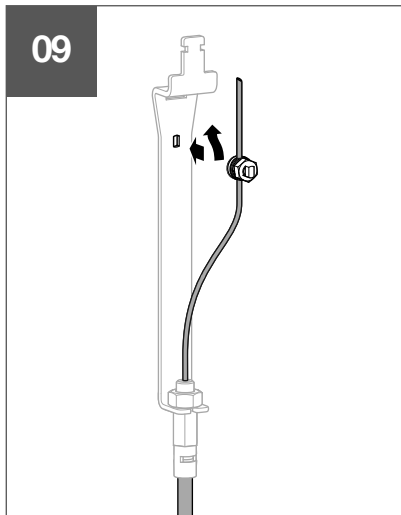
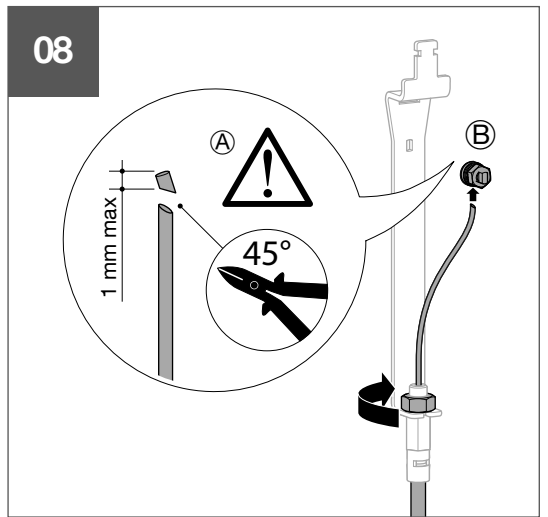
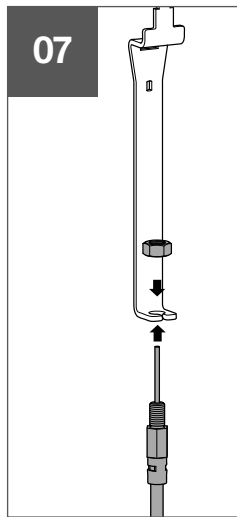
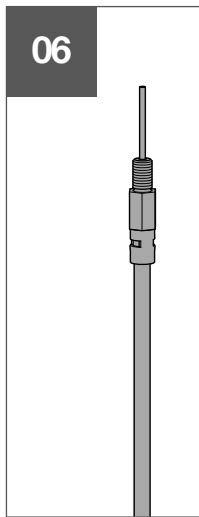
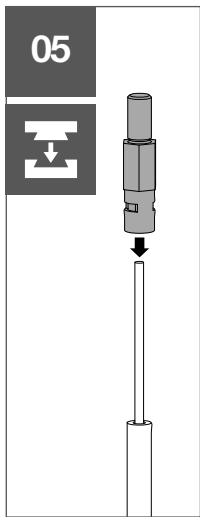
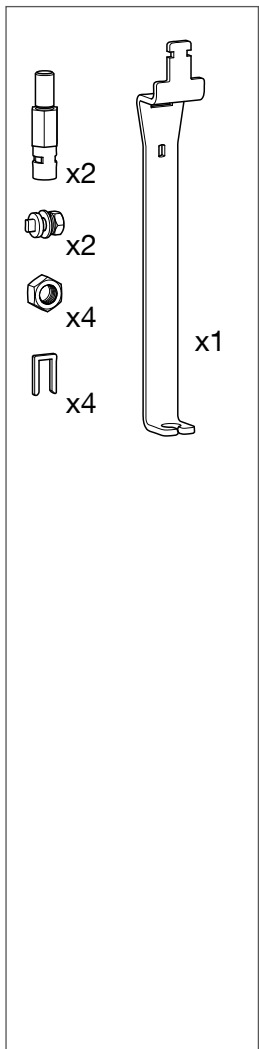

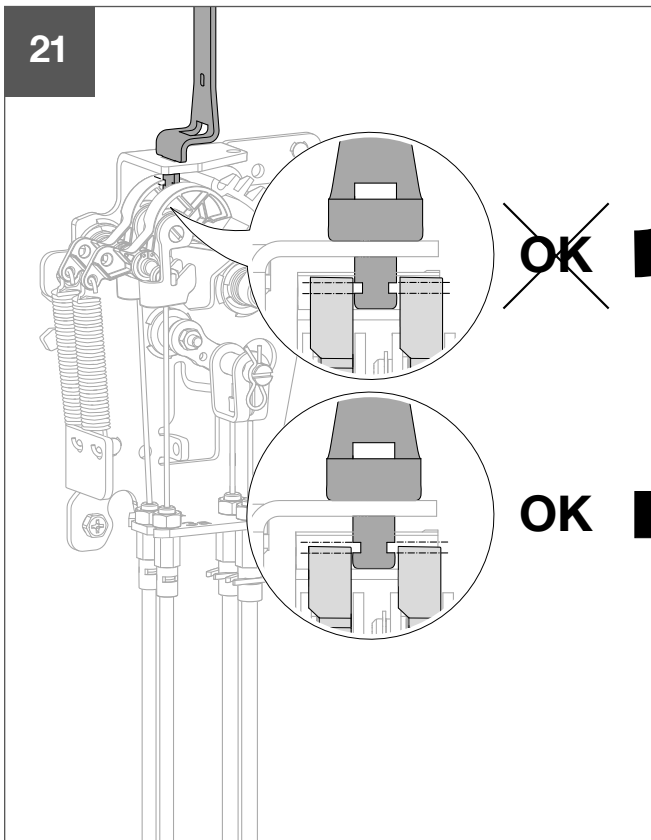
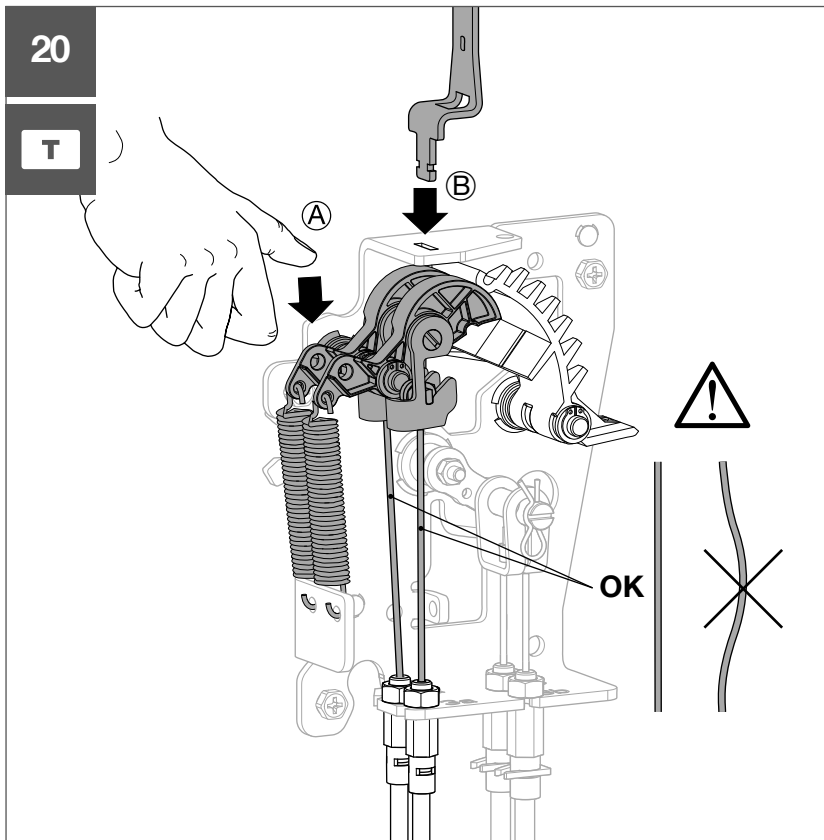
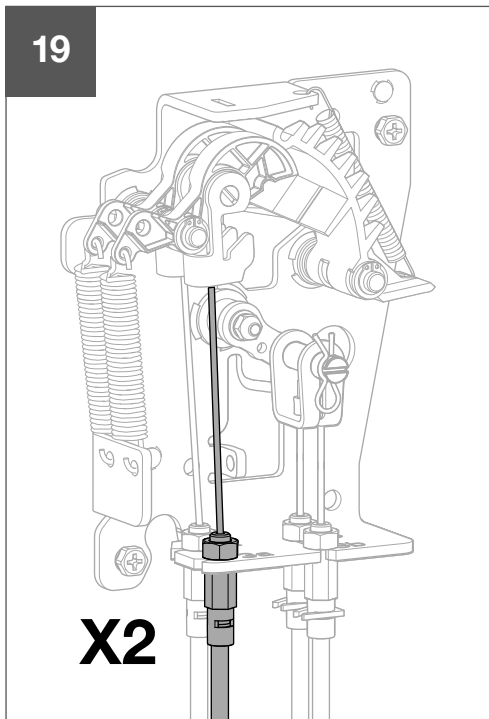
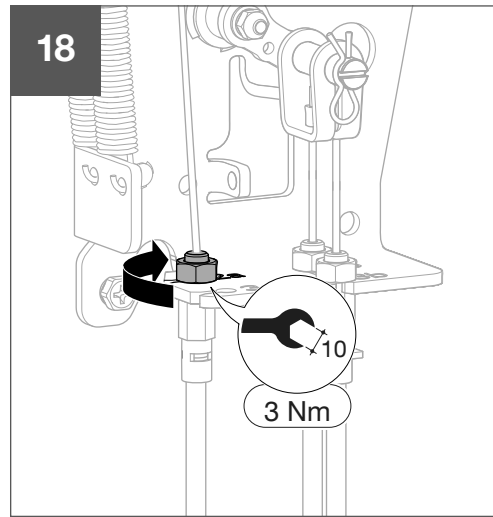
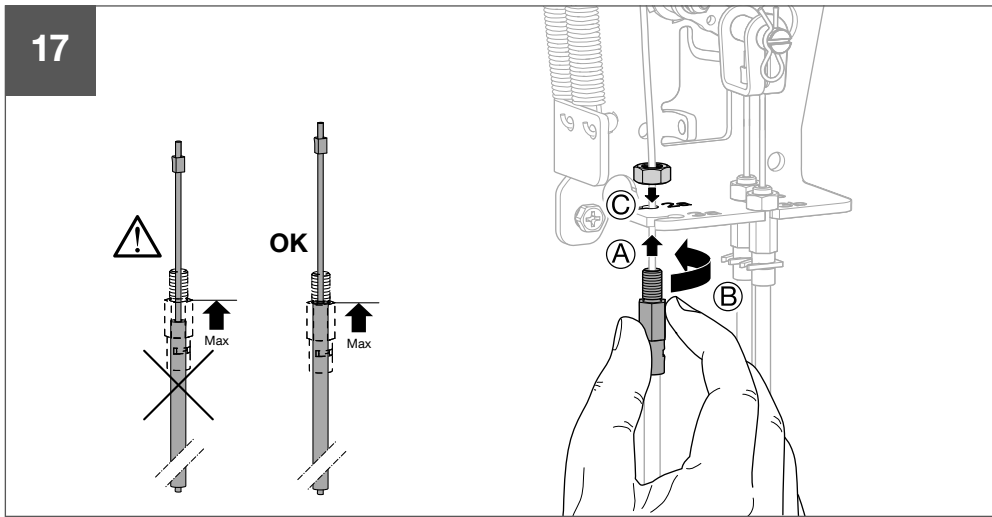

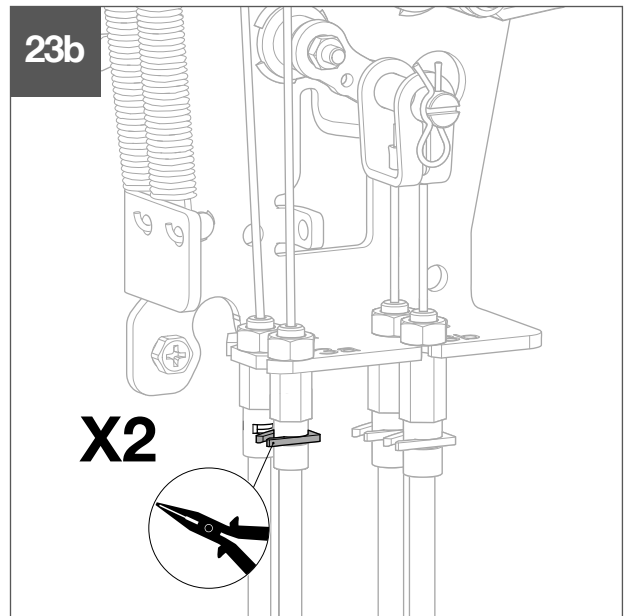
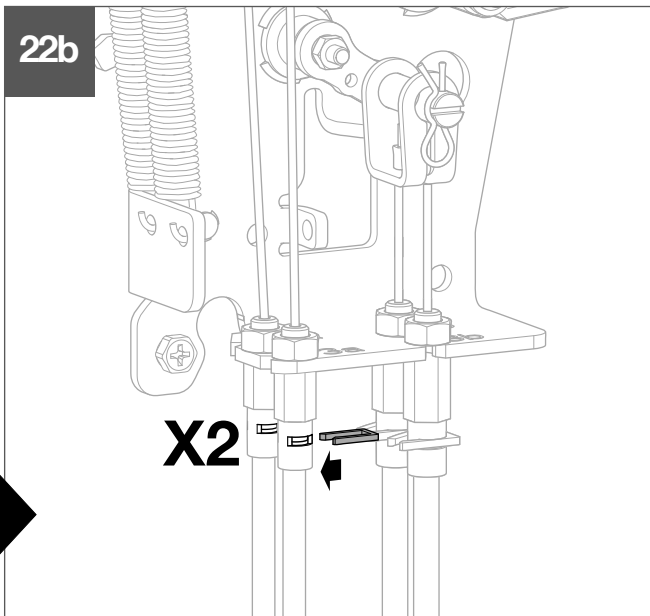
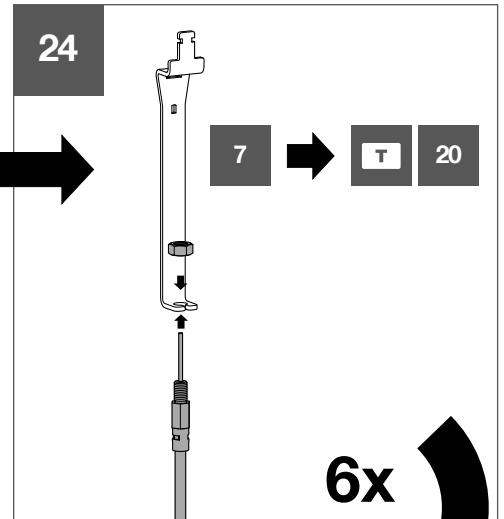
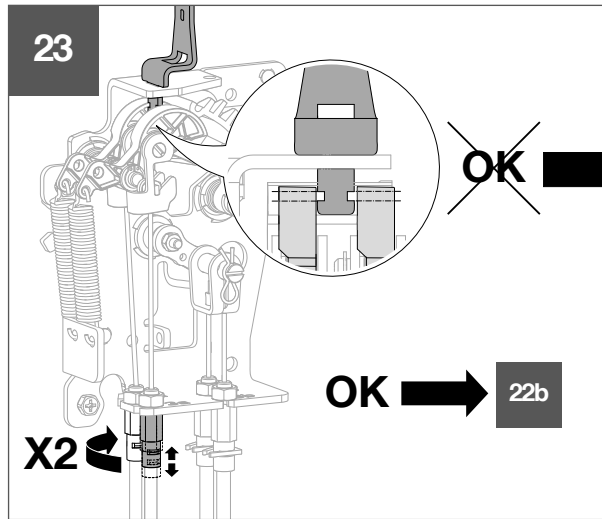
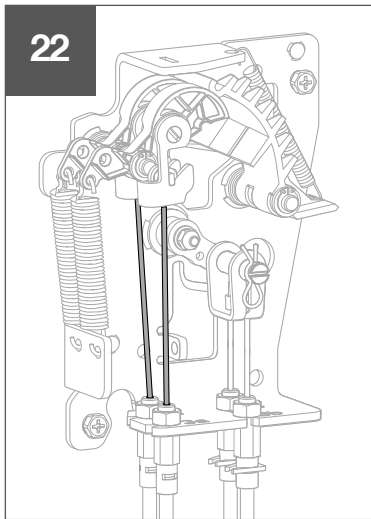

T

TEST WARNING → **6LE009729Aa**