

Serial No. = Order code

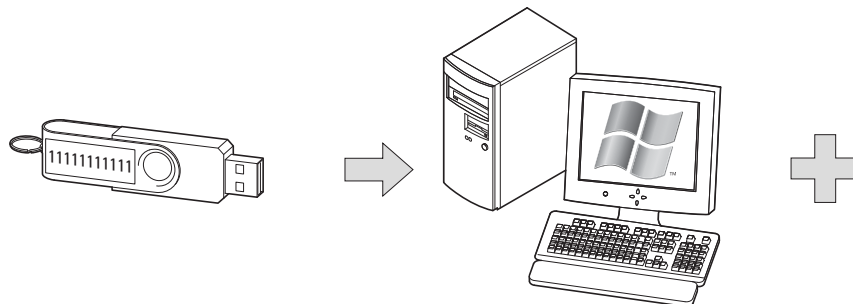

(en) Activation	(it) Attivazione	(da) Aktivering	(fi) Aktivointi	(lv) Aktivizēšana	(sk) Aktivácia
(de) Aktivierung	(zh) 激活	(el) Ενεργοποίηση	(cs) Aktivace	(lt) Aktyvavimas	(bg) активиране
(fr) Activation	(ru) включение	(pt) Ativação	(et) Aktiveerimine	(pl) Aktywacja	(ro) Activarea
(es) Activación	(nl) Activering	(sv) Aktivering	(hu) Aktiválás	(sl) Aktiviranje	(hr) Aktivacija

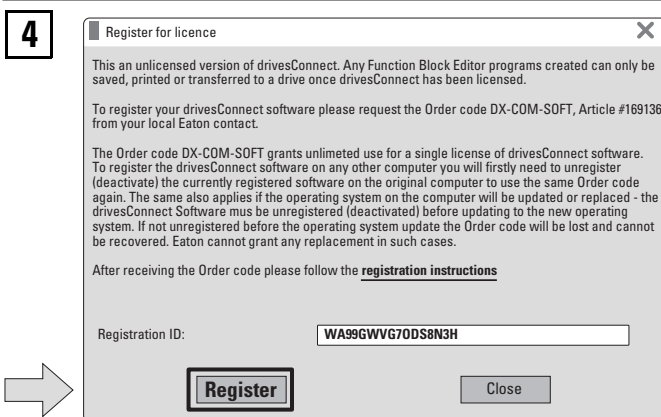
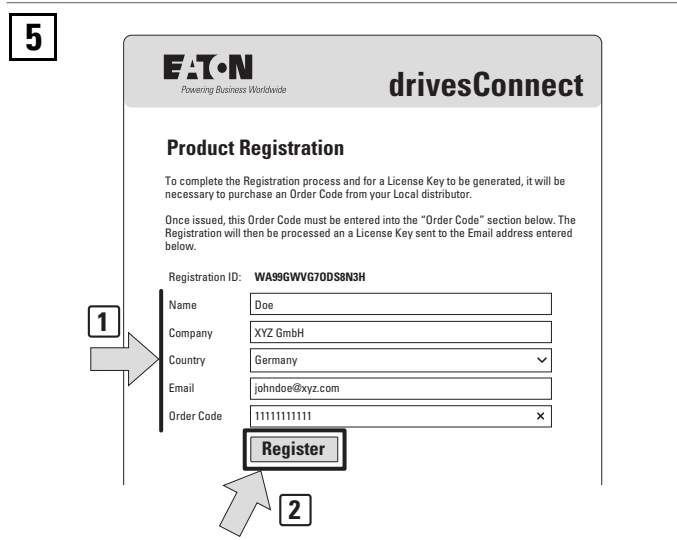
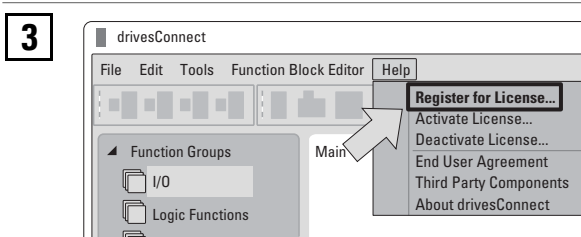
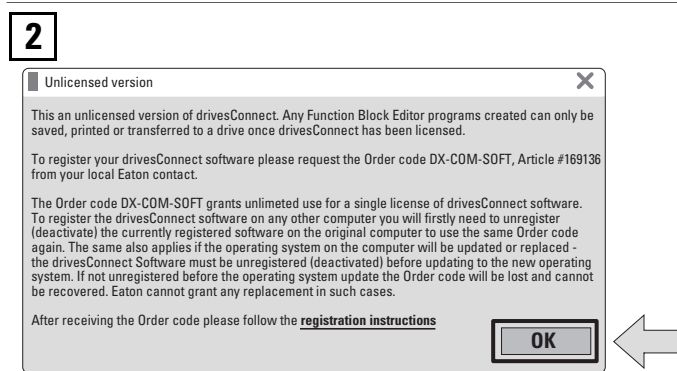
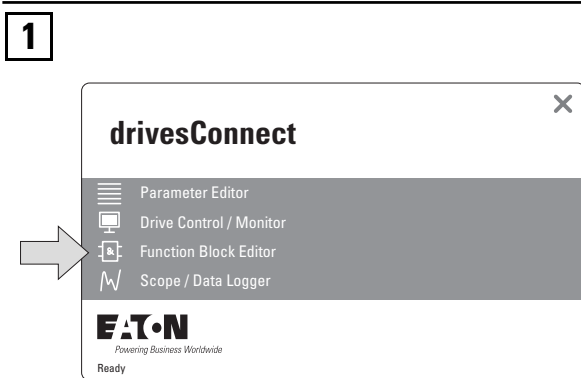

6  **be delayed**

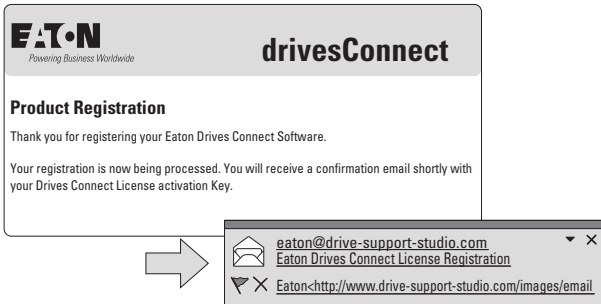

EAT·N **drivesConnect**
Powering Business Worldwide

Product Registration

Thank you for registering your Eaton Drives Connect Software.

Your registration is now being processed. You will receive a confirmation email shortly with your Drives Connect License activation Key.

Attachments:
 eaton@drive-support-studio.com
 Eaton Drives Connect License Registration
 Eaton-http://www.drive-support-studio.com/images/email

7

EAT·N **drivesConnect**
Powering Business Worldwide

This Email was sent using the Eaton Drives Connect License management system.

Thank you for registering your software.

Your License Key application is now being processed. You will be contacted again shortly using the Email address registered below.

Registration ID: WA99GWWG70DS8N3H

Name: Doe
 Company: XYZ GmbH
 Email: johndoe@xyz.com
 Country: Germany
 Order Code: 1111111111

CONFIDENTIALITY NOTICE AND LEGAL LIABILITY WAIVER: The content of this email is intended only for the person or entity to which it is addressed and its email attachments are CONFIDENTIAL and may contain privileged information. Any review, retransmission, dissemination or other use of, or taking of any action as reliance upon this information by persons or entities other than the intended recipient is unlawful. If you are not the addressee it may be UNLAWFUL for you to read, copy, distribute, disclose or otherwise use the information contained herein. The content of the message and or attachments may not reflect the view and opinions of the originating company or any party it is representing. If you are NOT the intended recipient then please email back to the sender and delete the material from any computer and destroy all and any printed copies.

8  **be delayed**

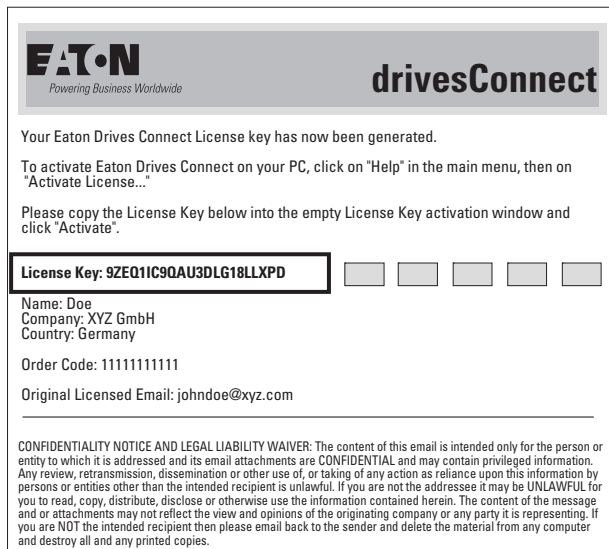

EAT·N **drivesConnect**
Powering Business Worldwide

Your Eaton Drives Connect License key has now been generated.

To activate Eaton Drives Connect on your PC, click on "Help" in the main menu, then on "Activate License..."

Please copy the License Key below into the empty License Key activation window and click "Activate".



License Key: 9ZEQ11C9QAU3DLG18LLXPD

Name: Doe
 Company: XYZ GmbH
 Country: Germany

Order Code: 1111111111
 Original Licensed Email: johndoe@xyz.com

CONFIDENTIALITY NOTICE AND LEGAL LIABILITY WAIVER: The content of this email is intended only for the person or entity to which it is addressed and its email attachments are CONFIDENTIAL and may contain privileged information. Any review, retransmission, dissemination or other use of, or taking of any action as reliance upon this information by persons or entities other than the intended recipient is unlawful. If you are not the addressee it may be UNLAWFUL for you to read, copy, distribute, disclose or otherwise use the information contained herein. The content of the message and or attachments may not reflect the view and opinions of the originating company or any party it is representing. If you are NOT the intended recipient then please email back to the sender and delete the material from any computer and destroy all and any printed copies.

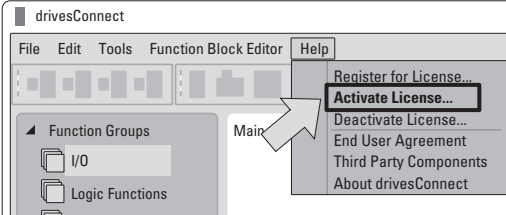
9

drivesConnect

File Edit Tools Function Block Editor Help

Register for License...
Activate License...
 Deactivate License...
 End User Agreement
 Third Party Components
 About drivesConnect

Activate licence

Please copy the 22 character License Key into the License key window below, then click button "Activate"

Registration ID: WA99GWWG70DS8N3H
 License Key (22 character): 9ZEQ11C9QAU3DLG18LLXPD

Activate Close

08/19 IL04012012Z

10

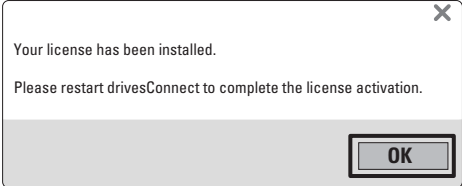

Your license has been installed.

Please restart drivesConnect to complete the license activation.

OK

11 **Restart drivesConnect**

12

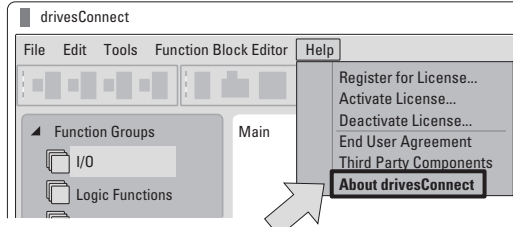

13



drivesConnect

File Edit Tools Function Block Editor Help

Register for License...
 Activate License...
 Deactivate License...
 End User Agreement
 Third Party Components
About drivesConnect

About drivesConnect

EAT·N
Powering Business Worldwide

drivesConnect V1.2.3.0
 Copyright © 2018 Eaton Industries GmbH
 http://www.eaton.eu
License status: Permanent

- (en) **Deactivation**
- (it) **Disattivazione**
- (da) **Deaktivering**
- (fi) **Deaktivointi**
- (lv) **Deaktivizēšana**
- (sk) **Deaktivácia**
- (de) **Deaktivierung**
- (zh) **停用**
- (el) **Δεενεργοποίηση**
- (cs) **Deaktivace**
- (lt) **Deaktyvavimas**
- (bg) **дезактивиране**
- (fr) **Désactivation**
- (ru) **отключение**
- (pt) **Desativação**
- (et) **Deaktiveerimine**
- (pl) **Dezaktywacja**
- (ro) **Dezactivare**
- (es) **Desactivación**
- (nl) **Deactivering**
- (sv) **Avaktivering**
- (hu) **Deaktiválás**
- (sl) **Deaktivacija**
- (hr) **Deaktiviranje**

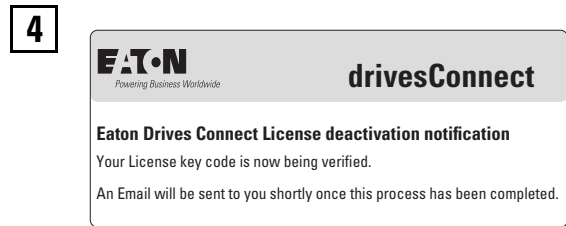
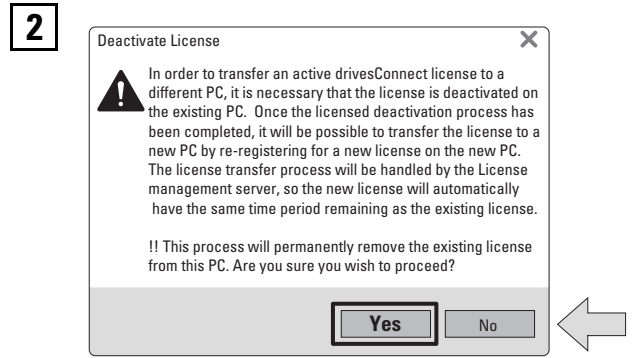
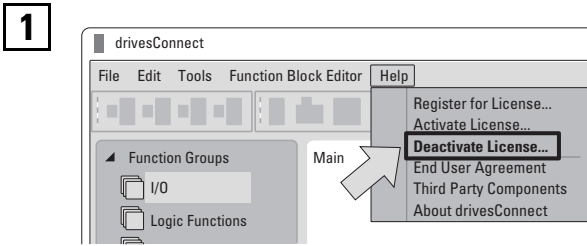

08/19 IL04012012Z

